



# PORTABLE BLENDER

Model Number:  
IA4022B (CORAL), IA4022C (TEAL), IA4022D (NAVY)

## Contents

02	General Information and Safety Instructions
04	Product Overview
05	Instructions
06	Other Useful Information
07	Repair and Refurbished Goods or Parts Notices

## General Information and Safety Instructions

### Retain For Future Use

Read this manual thoroughly before first use, even if you are familiar with this type of product. The Portable Blender is not intended for use by persons with reduced physical, sensory or mental capabilities, or lack of experience and knowledge, unless they have been given supervision or instruction concerning use of the product by a person responsible for their safety. Children should be supervised to ensure that they do not play with the appliance. Do not pull or carry the Portable Blender by the USB charging cable. Do not operate or place any part of the Portable Blender on or near any hot surfaces (such as a gas or electric burner, or a heated oven).

1. Read all instructions before using the Portable Blender.
2. The Portable Blender is not intended for use by persons with reduced physical, sensory or mental capabilities, or lack of experience and knowledge, unless they have been given supervision or instruction concerning use of the product by a person responsible for their safety.
3. Children should be supervised to ensure that they do not play with the appliance.
4. Do not use the Portable Blender for anything other than its intended use.
5. Do not pull or carry the Portable Blender by the USB charging cable.
6. Do not operate or place any part of the Portable Blender on or near any hot surfaces (such as a gas or electric burner, or a heated oven).
7. Do not expose the Portable Blender to water, rain moisture, liquids or dust. Do not store or use the Portable Blender anywhere near water, or where water drips and may come in contact with this product.
8. Do not operate the Portable Blender with wet hands.
9. Do not immerse the Portable Blender in water or any other liquids.
10. Do not use the Portable Blender if it has been dropped or damaged in any way.
11. The Portable Blender is intended for household use only and should not be used for commercial purposes.
12. This product is not a toy. Keep the Portable Blender out of reach of children.
13. Do not cover the Portable Blender whilst in use.
14. This unit has no user-serviceable parts contained within. Do not attempt to repair, disassemble or modify the Portable Blender.

## General Information and Safety Instructions (cont.)

### Handling and Usage

1. Always operate the Portable Blender on a dry, level surface. Operating on sinks or uneven surfaces should be avoided.
2. Do not come in contact with the moving parts.
3. Keep your hands and utensils away from the blades while blending foods and liquids to reduce the risk of injury or damage to the appliance. A scraper may be used only when the Portable Blender is not running.
4. Always ensure that the blending cup is tightly and securely fastened to the power base and the lid is screwed on tightly before using the Portable Blender. A medium to high amount of force should be used to fasten the blending cup to the power base.
5. Be careful when handling the power base, especially when cleaning as the blades are very sharp. Do not blend warm or hot foods and liquids as this may cause a build-up of pressure in the blending cup due to steam being generated from the heat. This pressure build-up may cause the food or liquid to be ejected from the blending cup or cause the blending cup to shatter.
7. Do not operate the Portable Blender when the blending cup is empty as this may damage the appliance.
8. Do not operate the Portable Blender without the lid securely attached. This is extremely dangerous and the contents may eject from the blender.
9. Never remove the blending cup from the power base until the power has come to a complete stop and the blending cup is empty.
10. Never remove the blending cup from the power base whilst it has contents. Removing the blending cup while it is full may result in the food or liquid spilling out.
11. Do not fill the blending cup past the MAX line when adding ingredients, as this can cause spillage.
12. Do not use the blending cup, strainer and lid if they are cracked or broken.
13. The blending cup, strainer and lid are not dishwasher safe. Wash with warm soapy water and dry thoroughly before each use.

### Handling and Usage

- NOTE:** Before first use, add water and press and hold the power button (for approx. 3 seconds) on your Portable Blender to rinse it.
- WARNING:** Hard foods such as coffee beans, nuts, ice and frozen foods should NOT be blended in this appliance. If such foods are blended in the Portable Blender, the warranty will be voided.
- NOTE:** Only charge the Portable Blender with the 5V USB cord that has been supplied with the product.
- WARNING:** Never operate the Portable Blender whilst it is empty. This can cause the blender to overheat and stop working.

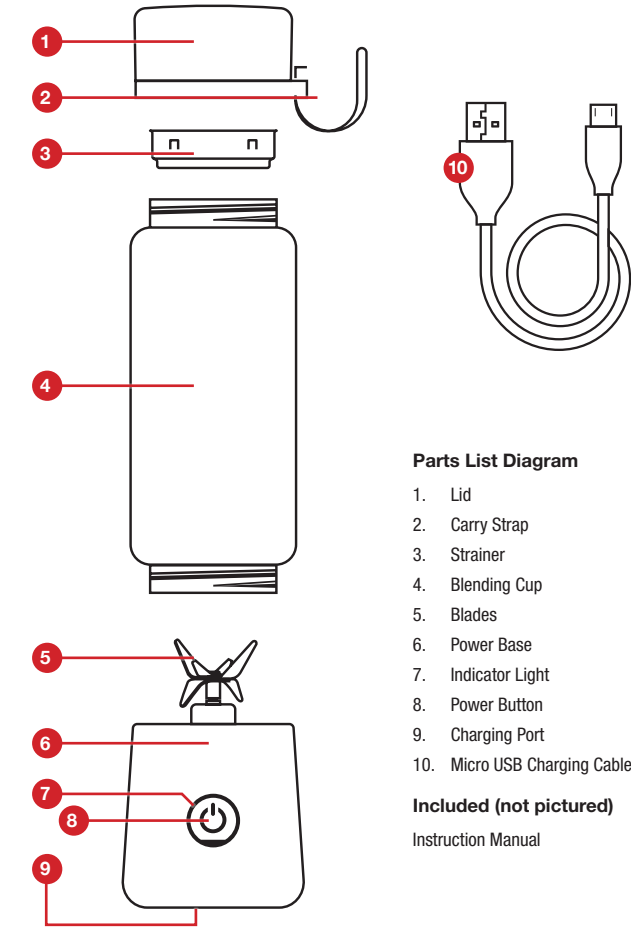

Parts List Diagram

- 1. Lid
- 2. Carry Strap
- 3. Strainer
- 4. Blending Cup
- 5. Blades
- 6. Power Base
- 7. Indicator Light
- 8. Power Button
- 9. Charging Port
- 10. Micro USB Charging Cable

Included (not pictured)

Instruction Manual

Other Useful Information

Cleaning and Maintenance

- 1. Always unplug the USB cable from the charging port on the Portable Blender before cleaning.
- 2. It is recommended to clean the Portable Blender immediately after use. To clean your Portable Blender, simply put water with an optional drop of dish soap inside, and run it one or more times as needed. To remove the strainer, use the handle provided and pull it up and out of the blending cup. We don't recommend putting the blending cup, lid or strainer in the dishwasher. Never submerge the power base.

Storage

- Before packing away the Portable Blender for storage, ensure it is clean and dry.
- We recommend storing the Portable Blender fully assembled in its original carton to protect it from dust, with the USB charging cable.
- Store the Portable Blender in a clean and dry place, out of children's reach.
- Do not place heavy objects on top during storage.

Warranty Information

Congratulations on your purchase

This Portable Blender is warranted to be free from defects in material and workmanship under normal use and service conditions for a period of 12 months from the date of purchase of this article. Evidence of unfair usage or incorrect adjustment by the owner will void this promise. Defects that occur within this warranty period, under normal use and care, will be repaired, replaced or refunded at our discretion. The benefits conferred by this manufacturer's warranty are in addition to all other rights and remedies in respect of the product which the consumer has under the Australian Consumer Law. Our goods come with guarantees that cannot be excluded under the Australian Consumer Law. You are entitled to a replacement or refund for a major failure and for compensation for any other reasonably foreseeable loss or damage. You are also entitled to have the goods repaired or replaced if the goods fail to be of acceptable quality and the failure does not amount to a major failure.

Conditions of Warranty

All warranty coverage extends only to the original retail purchaser from the date of purchase. Please keep your receipt, tax invoice or other proof of purchase. This warranty does not extend to any damage to a product caused by abuse, improper or abnormal usage, or repairs not provided by us or our Service Centre. Nor does this warranty extend to products used for commercial or rental purposes. This warranty does not cover ordinary wear, tear and weathering, failure to follow directions, improper installation, improper maintenance or acts of God (such as damage caused by storms, lightning, heavy winds and by snow or ice).

Operating the Portable Blender

This blender is designed to be used on the go. Simply charge the Portable Blender and prepare your ingredients in the blender in advance to blend your drink at your convenience.

- 1. Place the power base on a flat, stable and level surface.
- 2. Attach the blending cup to the power base by turning the blending cup in a clockwise direction. If the power button flashes red, then blue, this means that the blending cup has not been screwed on tight enough to the base.
- 3. Add the ingredients such as fruit and the liquid such as water, milk or juice into the blending cup.

**NOTE:** Do not overfill the blending cup when adding ingredients, as this could cause spillage. It is recommended to only fill the blending cup to the MAX line marked on the blending cup.

- 4. Attach the strainer to the blending cup by pushing it down into the top of the blender. It will click into place. Then attach the lid to the blending cup by turning in an clockwise direction. Your drink is now ready to blend.

**CAUTION:** Always ensure that the blending cup is tightly and securely fastened to the power base before using. A medium to high amount of force should be used to fasten the blending cup onto the power base.

**NOTE:** Always ensure you have securely tightened the blending cup, strainer and lid before operating.

- 5. Press and hold the power button (for approx. 3 seconds) to start blending. The Portable Blender will blend for up to 40 seconds depending on the quantity in the blender. The Portable Blender will automatically stop and the blue indicator light will flash five times. To continue blending press and hold the power button. Repeat until the contents are blended to your desire. Always allow the blender to rest for 5 seconds between each blend.
- 6. Check that the blender has completely stopped and is OFF. Remove the lid and strain the contents into a glass. You can also drink directly from the Portable Blender.

**WARNING:** Do not detach the blending cup from the power base whilst it is full, this will result in the contents spilling out.

**NOTE:** If the power button flashes red, then blue, this means that the blending cup has not been screwed on tight enough to the base. This is a safety feature of the Portable Blender.

**NOTE:** This blender has a press and hold power button function. This is a safety feature so that the blender doesn't accidentally turn ON whilst you are drinking from the Portable Blender.

**NOTE:** NEVER put your hands inside your Portable Blender or touch the blades.

**NOTE:** If the indicator light is red, the Portable Blender battery is low and needs to be recharged.

**CAUTION:** Do not immerse the power base in water or any other liquids.

**NOTE:** Your Portable Blender may take up to 3 hours to fully charge, but often charges much faster. It will arrive mostly charged, but for maximum power, charge it before your first use. The light turns red while charging and blue once fully charged.

**NOTE:** You can charge your Portable Blender with any USB port, from a powerbank, to your computer, to the USB port in your car. The USB charging inlet is found under the base of the blender.

**CAUTION:** Always unplug the USB cable from the Portable Blender when cleaning or assembling.

**CAUTION:** The blades are very sharp, handle the power base with care.

Making A Warranty Claim

In order to make a claim under this warranty please direct your enquiries to our Service Centre. You can contact them on our 1300 777 137 Phone Number from Australia

Uncle Bill's Service Centre:

2/24 Anderson Road, Smeaton Grange, NSW 2567 – if mailing please include your contact details. A service representative will then assist you in the appropriate action to be taken. For efficient processing of your enquiry please have proof of purchase, the date of purchase and the retailer name you purchased the item from, and the brand on the product. Photos of the product, and scans of receipts, may be requested to assist with your claim.

The service centre representative will assess the claim. If:

- 1. There is a minor fault, they can offer either a replacement spare part, replacement unit, repair or other suitable remedy;
- 2. There is a major fault, they can offer a replacement, repair or suggest you return to the store you purchased it from for a full refund.

**NOTE:** A request for compensation will need documentary evidence of the loss or damage suffered. It will also need to be evidenced that such a loss was a reasonably foreseeable result of a failure by Uncle Bill's to comply with a consumer guarantee under the Australian Consumer Law.

- 3. The product was damaged through abnormal use, no refund or repair can be offered.
- If the product needs to be returned and all the warranty criteria has been met, the consumer is to return the product to the place of purchase (along with their proof of purchase) and all costs involved with this will be the responsibility of the consumer.

Our sales and service centre has been set up to provide assembly assistance, technical support, replacement parts and accessories, and to efficiently handle all warranty related matters. Please note upon receiving your warranty claim our Service Centre will send, via post or email, a repair and refurbished goods or parts notice.

Service Centre

Contact details and hours of operation.

Phone: (AUS) 1300 777 137  
(NZ) 0800 824 556  
Email: service@unclebills.com.au  
9:00am – 4:30pm (AEST) Monday to Friday (excluding Public Holidays)  
9:00am – 3:00pm (AEST) Saturday

This product is warranted and imported by:  
Uncle Bill's (Australia) Pty Ltd  
48B Egerton Street, Silverwater NSW 2128, Australia  
Phone: 02 8799 3500  
Model: IA4022B (CORAL), IA4022C (TEAL), IA4022D (NAVY)  
Input voltage: Charge through USB Input 5V 1A  
Warranty: 12 months  
Maximum Capacity: 390mL

