

Serie | 6, Integrated Design Hood, 60 cm, clear glass black printed DBB67AM60A



Perfectly integrated design rangehood with extendable glass visor for superior extraction.

- **Seamless integration:** thanks to flush installation design hood is almost invisible in an upper cabinet.
- **Flexibility:** flexible kitchen planning, such as height, width, design and structure of the upper cabinet interior possible.
- **Glass panel with integrated TouchSelect control:** an automatic recognition of the glass panel position enables automatic operation of power level and light.
- **Expanded storage space:** the hood can hold up to 10 kg on each side. And even left and right beside the chimney shelves can be placed.
- **Silent:** maximum extractor performance with little noise

Technical Data

Typology : Built-in/Built-under
 Approval certificates : CE, VDE
 Length electrical supply cord : 130 cm
 Required niche size for installation (HxWxD) : 340mm x 560.0mm x 300mm mm
 Height of product, without chimney : 60 mm
 Minimum distance above an electric cooktop : 430 mm
 Minimum distance above a gas cooktop : 650 mm
 Net weight : 9.9 kg
 Type of control : Electronic
 Number of power settings : 3-stages + intensive setting
 Maximum output air extraction : 460 m³/h
 Boost position output recirculating : 652 m³/h
 Maximum output recirculating air : 451 m³/h
 Boost position air extraction : 749 m³/h
 Number of lights : 2
 Noise level : 63 dB(A) re 1 pW
 Diameter of air outlet : 120 / 150 mm
 Grease filter material : Washable stainless steel
 EAN code : 4242005307449
 Connection Rating : 256 W
 Voltage : 220-240 V
 Frequency : 50 Hz
 Plug type : AU plug
 Installation type : Built-in



Serie | 6, Integrated Design Hood, 60 cm, clear glass black printed DBB67AM60A

**Perfectly integrated design rangehood
with extendable glass visor for superior
extraction.**

Variant

- Appliance width: 597 mm
- Install into a 60cm wide wall cupboard
- Ducted and recirculated-air operation
- For recirculated extraction various recirculation kits are available as optional accessories.

Design

- Flush-fitted installation for a seamless integration in wall cupboards.
- Space efficient, compact design for extra storage possibilities on the hood and up to max. 10 kg storage weight per side.
- Glass panel with touch control for an easy operation and enhanced vapor capture.

Comfort

- Electronic controls with red Electronic display
- 3 power settings plus intensive setting
- Intensive setting with automatic switch back to previous setting
- Intensive operation automatic revert - 6min
- The fan and light are automatically turned on and off by opening and closing the glass panel.
- The light can also be independently turned on and off when the glass panel is closed by quick hand touch on control area.

Cleaning

- 2 x 2 W LED
- 2 x LM3-02_LED
- Colour Temperature: 3500 K
- Capacitor energy efficient
- Dishwasher safe metal grease filters
- Stainless steel filter covers
- Easy to clean smooth surfaces and materials.

Performance

- Extraction rate according to EN 61591 ø 15 cm:
max. Normal use 460 m³/h
Intensive 749 m³/h
- Noise level according to EN 60704-3 exhaust air:
Max. normal use: 63 dB(A) re 1 pW
Intensive: 73 dB(A) re 1 pW
- Noise min./max. Normal Level: 50/63 dB
- With the Clean Air Plus recirculation kit (available as accessory) your appliances reaches:
Extraction rate in recirculation mode:
Max. normal use: 451 m³/h
Intensive: 652 m³/h
Noise level in recirculation mode:
Max. normal use: 67 dB(A) re 1 pW
Intensive: 74 dB(A) re 1 pW

Planning and installation information

- Integrated Design Hood comfort installation: easy installation system
- Suitable for installation in bottomless wall cupboards.
- Enclosed spacers for installation in wall cupboards with maximum depth of up to 360 mm.
- Enclosed mats for protection against scratches and dirt of storage space on hood sides.
- For installation in higher wall cupboards chimney extensions are available as optional accessories.
- Chimney extensions are compatible with the available recirculation kits.
- Appliance dimensions (HxWxD): 340 x 597 x 298 mm
- Built-in dimensions (HxWxD): 340 x 560 x 300 mm
- Diameter pipe Ø 150 mm (Ø 120 mm enclosed)
- with one-way flap: prevents outside air from entering your kitchen
- Electrical cable length 1.3 m
- Please reference the built-in dimensions provided in the installation drawing

Consumption Data

- Energy Efficiency Class: B (at a range of energy efficiency classes from A++ to E)
- Average Energy Consumption: 62.7 kWh/year
- Power rating: 256 W

Serie | 6, Integrated Design Hood, 60 cm, clear glass black printed DBB67AM60A

Measurements in mm

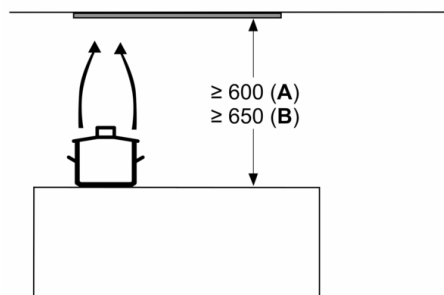

From upper edge of pan support

A: Electric
B: Gas

measurements in mm

Front view

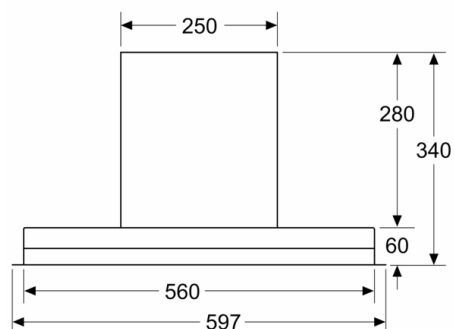

measurements in mm

Installation example

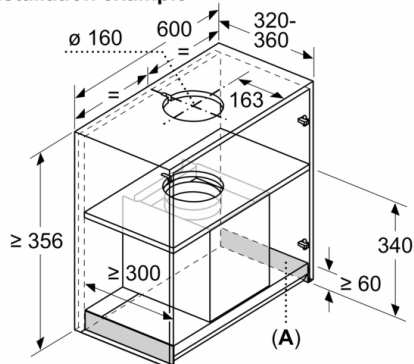

A: Area without hinges

measurements in mm

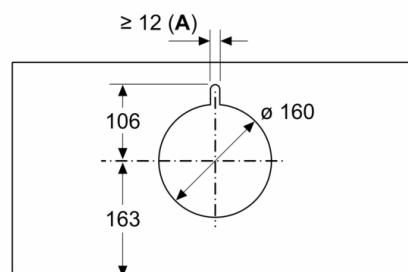

A: Cable bushing

measurements in mm

side view

