

INSTALLATION INSTRUCTIONS

CB615CKBLWH-6PK

Thank you for purchasing Cloudybay Smart LED Lighting Fixtures.



E26 5/6 INCH RGBCW SMART RECESSED CAN KIT



GENERAL: All electrical connections must be in accordance with local and National Electrical Code (N.E.C.) standards. If you are unfamiliar with proper electrical wiring connections, contact and obtain the services of a qualified electrician. Use UL or IEC approved wire only for input/output connections.

Remove fixture and mounting components from the box, and make sure that no parts are missing, by referencing the illustration in the illustration instructions.

This retrofit assembly is accepted as a component of a led luminaire where the suitability of the combination shall be determined by csa or canadian authorities having jurisdiction. This device is not intended for use with emergency exits.

This product is JA8-2022 certified

Turn power off before installation, inspection, or removal.
Use all necessary precautions while performing this procedure.
Properly ground electrical enclosure. IT IS IMPERATIVE THAT THE OUTLET BOX BE PROPERLY GROUNDED.

DO NOT REVERSE THE HOT AND NEUTRAL CONNECTIONS, OTHERWISE SAFETY WILL BE COMPROMISED.

This Integrated LED Fixture has no lamp/bulb to replace.

WARNING - RISK OF ELECTRIC SHOCK. DISCONNECT MAIN POWER AT FUSE OR CIRCUIT BREAKER BEFORE INSTALLING OR SERVICING THE FIXTURE.



PRODUCT CARE

After Sales Service

1. Please discontinue to use product right away if product shows any visible defect and contact customer service.

2. If there is any problem with our lights for non-human reasons, please contact customer service, we will send you brand new replacement without need to returning goods or full refund.

3. If you are not completely satisfied with product after installation but prefer not to disassemble, contact with us right away, we will provide comparable compensations.

3-Year Limited Warranty

LIMITED WARRANTY: This fixture is warranted to be free from defects in workmanship and material for up to 3-years. Based upon reasonable household usage, when used in accordance with package and included instructions. If this fixture does not last for the time period guaranteed, manufacture will send you a replacement fixture upon receipt of the returned fixture, register receipt, and proof of purchase. To contact us, please email us at smart@cloudybaylighting.com to find out how to return the fixture. We are committed to making high quality products. Returning the fixture will help us monitor and further improve product quality. This replacement is the sole remedy available, and LIABILITY FOR INCIDENTAL OR CONSEQUENTIAL DAMAGES IS HEREBY EXPRESSLY EXCLUDED

PLEASE READ CAREFULLY BEFORE INSTALLING FIXTURE
Save these instructions, as you may need them at a later date.

INSTALLATION & OPERATING INSTRUCTIONS

IMPORTANT SAFETY INFORMATION

READ ALL INSTRUCTIONS BEFORE INSTALLATION

This fixture operates on regular household power (120V, 60Hz).
This fixture needs to be grounded.

Disconnect the power at the breaker panel before installing this product.

GENERAL INSTRUCTIONS

Electrical connections must be made in accordance with local electrical codes and regulations. Consult a qualified electrician to ensure correct branch circuit conductor.

Package Content

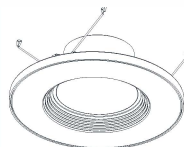

(1) LED
downlight



(1) MEDIUM
BASE ADAPTER

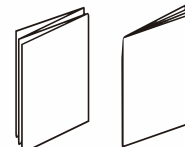

(1) USER MANUAL & VOICE
CONTROL GUIDE

WARNING

- Risk of fire or electrical shock. LED Panel installation requires knowledge of luminaires electrical systems. If not qualified, do not attempt installation. Contact a qualified electrician. The use of a licensed electrician is highly recommended.
- As with all electrical components there is always a risk of fire or electric shock if handled and/or installed incorrectly.
- Disconnect power at circuit breaker panel before any installation.
- Install this product only in situations as per the general instructions above.
- Do not make or alter any open holes in any enclosure or any electrical component during installation.
- To prevent wiring damage or abrasion to the wires do not expose wiring to sharp edges of sheer metal or other sharp objects.
- Do not use when the enclosure is damaged or broken in any way.
- Do not alter, relocate or remove wiring, lamp holder power supply or any other electrical component.
- Minimum operating temperature 4°F (-15.5°C). Lamp life may be affected outside these temperatures.

Note: This product is a smart light, using Direct Digital Controls rather than triac dimming. Here is two dimming way for you reference:

1. Download Cloudy Bay's APP, go to product group or single product page, adjust the brightness and CCT of white light or color light on control panel; you can also go to home page, click product group or single product's common function, adjust brightness and color temperature
2. Control with smart voice device such as Google Assistant or Amazon Alexa if you have installed it successfully.

⚠ If you only have a dimmer at hand, set it to highest level only, if light performance is not good, we strongly advise you to change to a regular On/Off switch instead.

FCC Statement

This equipment has been tested and found to comply with the limits for a Class B digital device, pursuant to part 15 of the FCC Rules. These limits are designed to provide reasonable protection against harmful interference in a residential installation. This equipment generates, uses and can radiate radio frequency energy and, if not installed and used in accordance with the instructions, may cause harmful interference to radio communications. However, there is no guarantee that interference will not occur in a particular installation. If this equipment does cause harmful interference to radio or television reception, which can be determined by turning the equipment off and on, the user is encouraged to try to correct the interference by one or more of the following measures:

- Reorient or relocate the receiving antenna.
 - Increase the separation between the equipment and receiver.
 - Connect the equipment into an outlet on a circuit different from that to which the receiver is connected.
 - Consult the dealer or an experienced radio/TV technician for help.
- Caution: Any changes or modifications to this device not explicitly approved by manufacturer could void your authority to operate this equipment.
- This device complies with part 15 of the FCC Rules. Operation is subject to the following two conditions: (1) This device may not cause harmful interference, and (2) this device must accept any interference received, including interference that may cause undesired operation.

RF Exposure Information

This equipment complies with FCC radiation exposure limits set forth for an uncontrolled environment. This equipment should be installed and operated with minimum distance 20cm between the radiator and your body.



INSTALLATION INSTRUCTIONS

PLEASE READ CAREFULLY BEFORE INSTALLING FIXTURE
Save these instructions, as you may need them at a later date.

INSTALLATION INTO EXISTING RECESSED FIXTURE WITH COMPATIBLE ORANGE CONNECTORS

- 1 Remove the existing trim installed in the recessed housing (if necessary).
- 2 Discard the medium base adapter.
- 3 Connect the two terminals together.

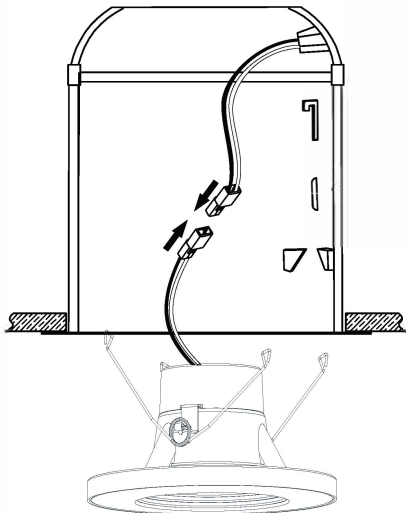

- 4 Insert the torsion springs into the fixture housing brackets. Gently push the product up and torsion springs so they begin to expand and lift the product in place.

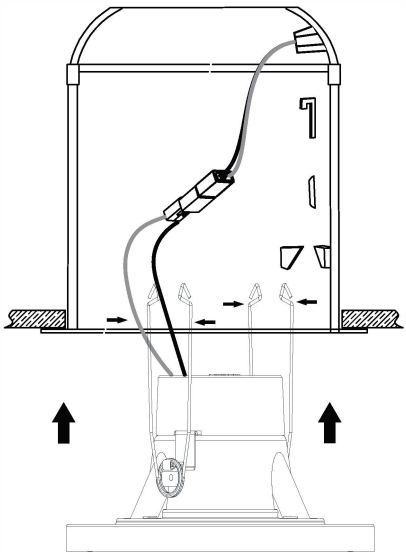

- 5 Gently push the product in until it is flush to the ceiling.

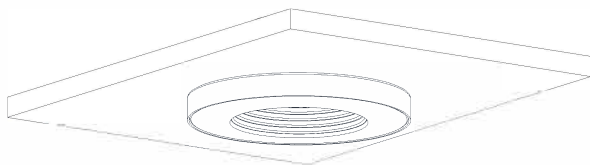

- 6 Refer to Owner Manual and Voice Control Guide to set up products.

INSTALLATION INSTRUCTIONS FOR EXISTING RECESSED FIXTURE

- 1 Remove the existing trim installed in the recessed housing (if necessary).
- 2 If applicable, slide the lampholder bracket to its upward maximum position. If necessary, remove the lampholder mounting bracket by removing the wing nut and the lampholder from the bracket, then attach the provided label to the existing luminaire.

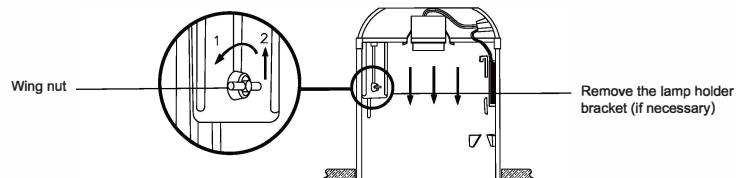

- 3 Install the medium base adapter into the socket.

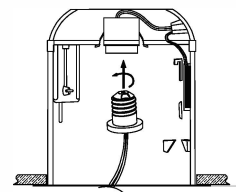

- 4 Connect the two terminals together.

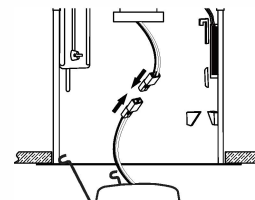

- 5 Insert the torsion springs into the fixture housing brackets.

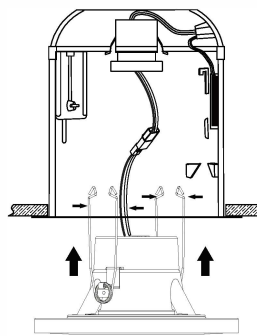

- 6 Gently push the product in until it is flush to the ceiling.

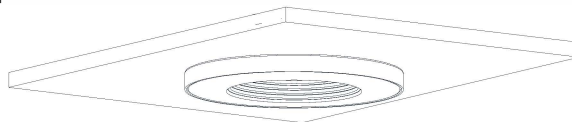

- 7 Refer to Owner Manual and Voice Control Guide to set up products.

QUESTIONS? COMMENTS? SUGGESTIONS? COMPLAINTS?
Please contact with us through smart@cloudybaylighting.com
or info@cloudybaylighting.com
We will do our best to make it right for you. Thank you very much!