

U-LINE

COMMERCIAL



Cultivated Experience

As a leading American manufacturing expert since 1962, U-Line is known for our advanced refrigeration systems, meticulous engineering, and comprehensive expertise across multiple markets including hospitality, foodservice, marine, and residential. Since our founding, the United States Patent and Trademark Office has issued over 50 patents to U-Line.

U-Line is also backed by the largest global manufacturer of commercial kitchen equipment, Middleby Corporation. Middleby products are chosen by 97 out of 100 U.S. food service chains. Middleby's patented innovations have earned top industry and customer awards, including Equipment Supplier of the Year.

*Our commercial products & components
are used in America's largest coffee chains,
retail giants, and restaurants.*

U-LINE
COMMERCIAL

Explore our Commercial Collection at u-line.com/commercial.

Agile Solutions

Our lineup offers modular and scalable solutions for hotels, restaurants, stadium suites, bars, serving stations, entertainment areas and other commercial applications. Our Commercial Collection offers a robust design with modern features:

- Durable stainless steel construction
- Versatile installation options
- Convection cooling for optimal air flow and temperature regulation
- 1-year parts and labor warranty; 5-year sealed system parts warranty

We offer solutions for a variety of applications, currently including over 50 models, with more to come.

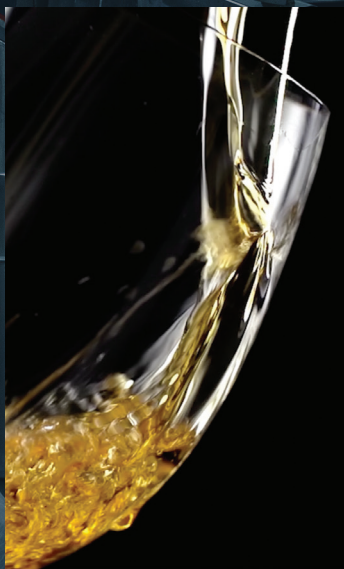



Refrigerators & Wine Refrigerators

Available in 15", 18", and 24" footprints, our undercounter options allow you to have what you need, where you need it most.



Dispensers

Creamy nitro cold-brew, refreshing beer, and chilled wine on-tap with our 15" and 24" ready-to-serve dispensing options that accommodate a variety of keg sizes and tanks.



Ice Machines

Serve the ever-popular nugget ice in your beverages and cocktail creations. Customize the ice density from soft and chewable to dense and compact with multiple adjustable ice settings.



Back Bar Refrigeration

With configurable options and multiple sizes, our refrigeration stations provide higher capacity refrigeration storage, fully stocked with the latest technology and adjustable interiors.



Reach-In Refrigerators & Freezers

Preserve produce, meats, and everything in between in varying size options with solid and glass door configurations.



Base Refrigerators & Freezers

Convenient drawer access to chilled & frozen items. Perfect for chef stations and beyond.



Blast Freezers/ Chillers

Rapidly chill ingredients for culinary creations. Powerful functionality fit for your space.



Pizza & Food Prep Table Refrigerators

Complete food preparation stations perfect for assembly of pizzas, sandwiches, and more.



U-Chill®

The incredible in-counter cooling cylinder designed to take serving chilled bottles to the next level. U-Chill® sets any space apart from the rest.



Product Specifications

Configurable Back Bar Refrigeration



CBR532-SS



CBR552-SS



CBR572-SS



CBR592-SS



CBR532-SG



CBR552-SG



CBR572-SG



CBR592-SG

Project:	Notes:
----------	--------

Features

- Convection cooling system provides a quick cool down and consistent temperature
- Stainless steel inside and out
- Temperature range: 33°F - 70°F
- Bright white & blue LED interior lighting
- Automatic defrost
- Field reversible door(s) with lock(s)
- Adjustable coated wire shelves
- High efficiency compressor
- NSF/ANSI Standard 7 compliant

Specifications

Model	CBR532/CBR632	CBR552/CBR652	CBR572/CBR672	CBR592/CBR692
Dimensions	34 9/16" H x 32" W x 24 3/4" D	34 9/16" H x 52" W x 24 3/4" D	34 9/16" H x 72" W x 24 3/4" D	34 9/16" H x 92" W x 24 3/4" D
Internal Volume	6.25 cu ft	12.52 cu ft	19.74 cu ft	28.5 cu ft
Refrigerant	R600a	R600a	R290	R290
Running Amps	1.7	1.7	2.0	2.0



Product Specifications Configurable Back Bar Refrigeration

Model Details			
Model	Description	Voltage/Hz	Shipping Weight
UCBR532-SS01A	32" Back Bar, 1 Solid Door, Lock, Condenser Right, 3 Wire Shelves, Solid Top, Stainless Steel	115v / 60hz	302 lb
UCBR552-SS01A	52" Back Bar, 2 Solid Doors, Locks, Condenser Right, 6 Wire Shelves, Solid Top, Stainless Steel	115v / 60hz	382 lb
UCBR572-SS01A	72" Back Bar, 3 Solid Doors, Locks, Condenser Right, 9 Wire Shelves, Solid Top, Stainless Steel	115v / 60hz	496 lb
UCBR592-SS01A	92" Back Bar, 4 Solid Doors, Locks, Condenser Right, 12 Wire Shelves, Solid Top, Stainless Steel	115v / 60hz	542 lb
UCBR532-SG01A	32" Back Bar, 1 Glass Door, Lock, Condenser Right, 3 Wire Shelves, Solid Top, Stainless Steel	115v / 60hz	302 lb
UCBR552-SG01A	52" Back Bar, 2 Glass Doors, Locks, Condenser Right, 6 Wire Shelves, Solid Top, Stainless Steel	115v / 60hz	382 lb
UCBR572-SG01A	72" Back Bar, 3 Glass Doors, Locks, Condenser Right, 9 Wire Shelves, Solid Top, Stainless Steel	115v / 60hz	496 lb
UCBR592-SG01A	92" Back Bar, 4 Glass Doors, Locks, Condenser Right, 12 Wire Shelves, Solid Top, Stainless Steel	115v / 60hz	542 lb
UCBR632-SS01A	32" Back Bar, 1 Solid Door, Lock, Condenser Right, 3 Wire Shelves, 1 Tap & Drain Hole, Stainless Steel	115v / 60hz	302 lb
UCBR652-SS01A	52" Back Bar, 2 Solid Doors, Locks, Condenser Right, 6 Wire Shelves, 1 Tap & Drain Hole, Stainless Steel	115v / 60hz	382 lb
UCBR672-SS01A	72" Back Bar, 3 Solid Doors, Locks, Condenser Right, 9 Wire Shelves, 2 Taps & Drain Holes, Stainless Steel	115v / 60hz	496 lb
UCBR692-SS01A	92" Back Bar, 4 Solid Doors, Locks, Condenser Right, 12 Wire Shelves, 2 Taps & Drain Holes, Stainless Steel	115v / 60hz	542 lb

Factory build options include: Condenser on left side, glass & solid door combinations

Accessories		
Model	Description	Shipping Weight
ULACOMLEGS4	4, 6" Adjustable leveling legs for CBR532 & CBR552	10 lb
ULACOMLEGS6	6, 6" Adjustable leveling legs for CBR572 & CBR592	14 lb
ULACOMCASTERS4	4, 6" Casters for CBR532 & CBR552	12 lb
ULACOMCASTERS6	6, 6" Casters for CBR572 & CBR592	17 lb
ULASHELF24	Slide out metal shelf	9 lb
ULAWINERACK24	Slide out wine rack	8 lb
ULABIN24	Slide out bin	9 lb
ULATAPSINGLE	Single Beer Tap Tower Kit	20 lb
ULATAPDOUBLE	Double Beer Tap Tower Kit	24 lb
ULABACKBARCOFFEE2	2 Tap Nitro Coffee Kit	10 lb
ULABACKBARCOFFEE3	3 Tap Nitro Coffee Kit	11 lb
ULABACKBARCOFFEE4	4 Tap Nitro Coffee Kit	12 lb
ULAWINETAP1	Single Tap, Low Profile Coupler, Regulator, & Nitrogen Tank	16 lb
ULAWINETAP2	Double Tap, Low Profile Coupler, Regulator, & Nitrogen Tank	20 lb



Product Specifications

Configurable Back Bar Refrigeration

CBR532

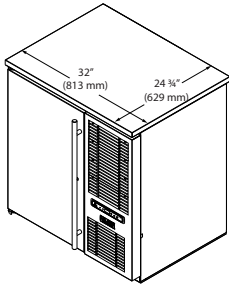

CBR552

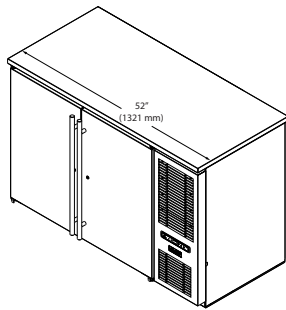

CBR572

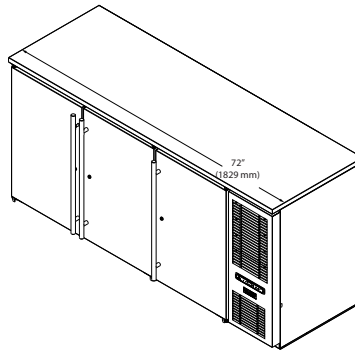

CBR592

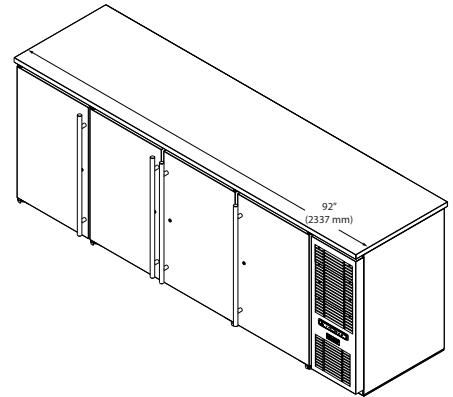

Side

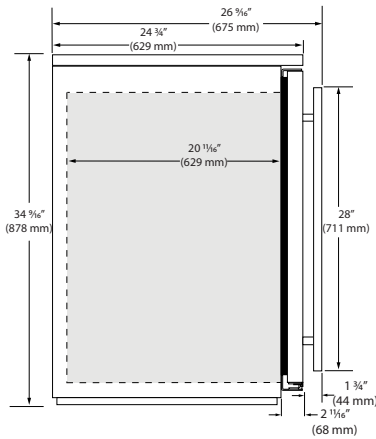

Front

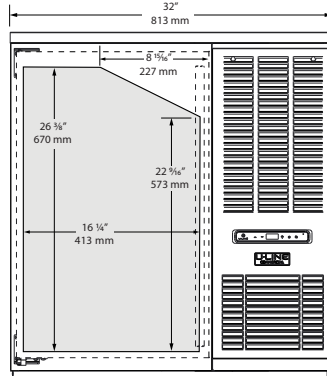

Top

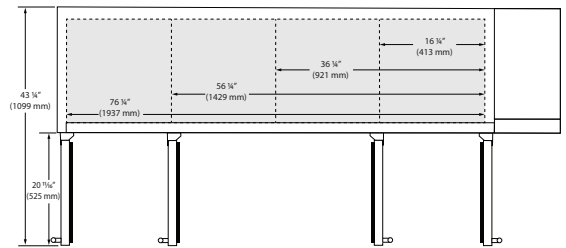

Tower 2 3/4" (70 mm)/Drain 1" (25 mm) Location

Back Panel

CBR672

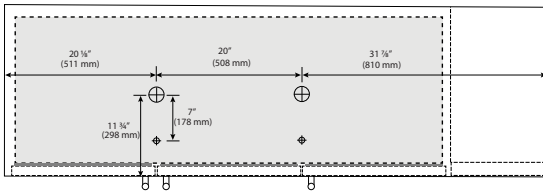

CBR652

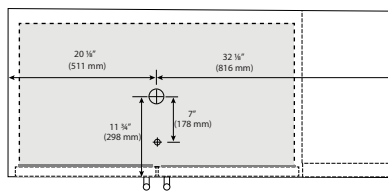

CBR692

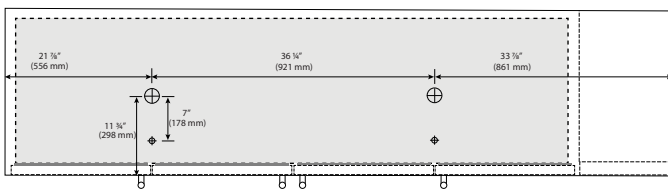

CBR632

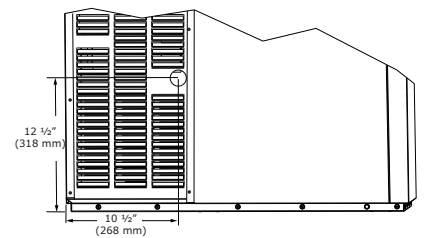
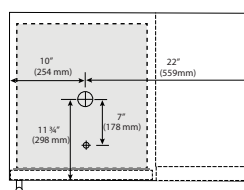

Commercial Warranty

1 Year (parts & labor) / 5 year sealed system (parts)
See complete warranty for details

Notes

- Dimensions/image shown are for refrigeration unit on right



Product Specifications

15" Refrigerators / Wine Refrigerators

CRE515: 15" Refrigerator

CWC515: 15" Wine Refrigerator



CRE515-SG CRE515-SS CWC515-SG CWC515-SS

Project:	Notes:
----------	--------

Features and Specifications

Convection cooling system provides a quick cool down and consistent temperature

U-Adjust™ Interior: 19 possible positions

Refrigerator models include 2 slide-out metal shelves

Wine Refrigerator models include 5 slide-out wine racks

Stainless steel cabinet, grille, and full-wrap door with lock

Full-depth lower interior with a volume of 2.9 cu ft

Dimensions: 33 1¹/₁₆" H x 14 1⁵/₁₆" W x 22 1⁵/₁₆" D

Designed for built-in or freestanding applications

Temperature range: 34°F - 70°F

High efficiency variable speed compressor with 1.2 running amps

Environmentally friendly R600a refrigerant

Model Details

Model	Description	Voltage/Hz	Shipping Weight
UCRE515-SG33A	Refrigerator 15" Reversible Hinge Stainless Glass	115v / 60hz	108 lb
UCRE515-SS33A	Refrigerator 15" Reversible Hinge Stainless Solid	115v / 60hz	96 lb
UCWC515-SG33A	Wine Refrigerator 15" Reversible Hinge Stainless Glass	115v / 60hz	111 lb
UCWC515-SS33A	Wine Refrigerator 15" Reversible Hinge Stainless Solid	115v / 60hz	99 lb

Accessories

Model	Description	Shipping Weight
ULACASTERKIT15	15" Caster Kit for UCWC & UCRE	13 lb
ULAWINERACK15	Slide-out rack	8 lb
ULABIN15	Slide-out bin	9 lb
ULASHELF15	Slide-out metal shelf	4 lb



Product Specifications • 15" Refrigerators / Wine Refrigerators

Top

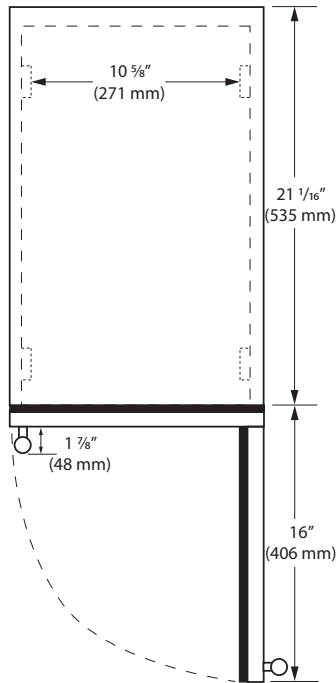

Front

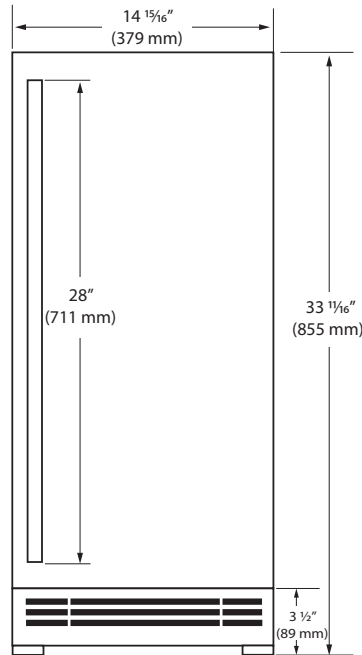

Side

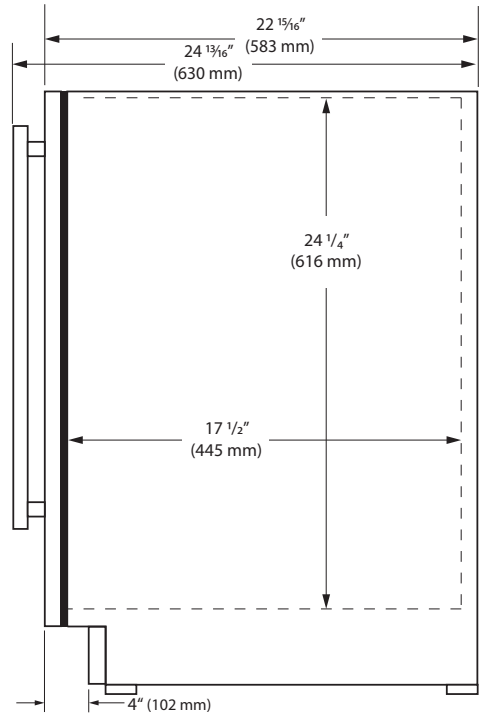

Back

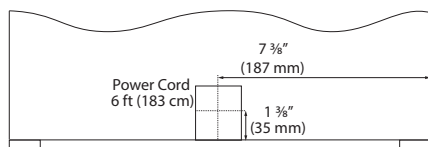

Cabinet Cut-Out

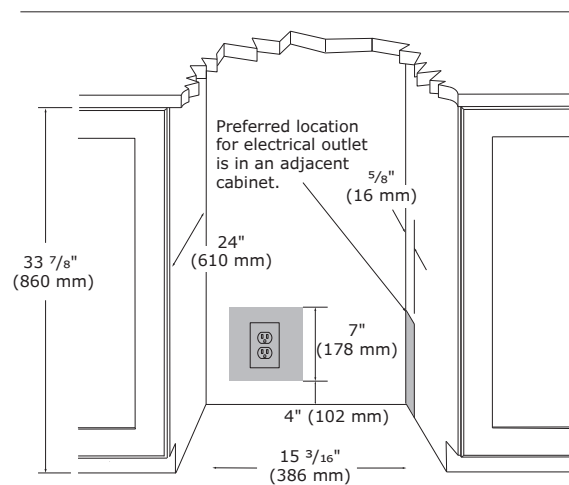

Commercial Warranty

1 Year (parts & labor) / 5 year sealed system (parts)
See complete warranty for details

Installation Notes

- Power cord extends 2" beyond total depth
- No additional clearance is needed for ventilation
- Do not obstruct front grille air flow

18" Refrigerators / Wine Refrigerators

CRE518: 18" Refrigerator

CWC518: 18" Wine Refrigerator



CRE518-SG



CRE518-SS



CWC518-SG



CWC518-SS

Project:	Notes:
----------	--------

Features and Specifications
Convection cooling system provides a quick cool down and consistent temperature
U-Adjust™ Interior: 19 possible positions
Refrigerator models include 2 slide-out metal shelves
Wine Refrigerator models include 5 slide-out wine racks
Stainless steel cabinet, grille, and full-wrap door with lock
Full-depth lower interior with a volume of 3.7 cu ft
Dimensions: 33 1/16" H x 17 3/4" W x 22 1/16" D
Designed for built-in or freestanding applications
Temperature range: 34°F - 70°F
High efficiency variable speed compressor with 1.2 running amps
Environmentally friendly R600a refrigerant

Model Details			
Model	Description	Voltage/Hz	Shipping Weight
UCRE518-SG33A	Refrigerator 18" Reversible Hinge Stainless Glass	115v / 60hz	131 lb
UCRE518-SS33A	Refrigerator 18" Reversible Hinge Stainless Solid	115v / 60hz	118 lb
UCWC518-SG33A	Wine Refrigerator 18" Reversible Hinge Stainless Glass	115v / 60hz	134 lb
UCWC518-SS33A	Wine Refrigerator 18" Reversible Hinge Stainless Solid	115v / 60hz	121 lb

Accessories		
Model	Description	Shipping Weight
ULACASTERKIT18	18" caster kit - for UCWC & UCRE	13 lb
ULAWINERACK18	Slide-out wine rack	8 lb
ULABIN18	Slide-out bin	9 lb
ULASHELF18	Slide-out metal shelf	4 lb



Product Specifications • 18" Refrigerators / Wine Refrigerators

Top

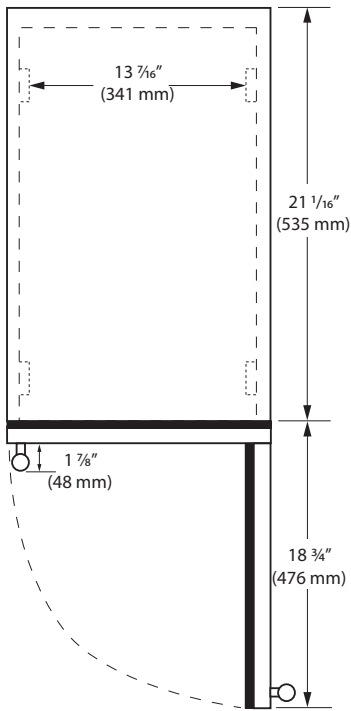

Front

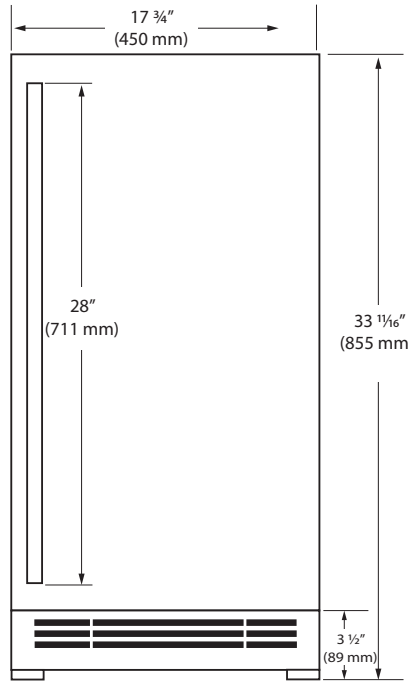

Side

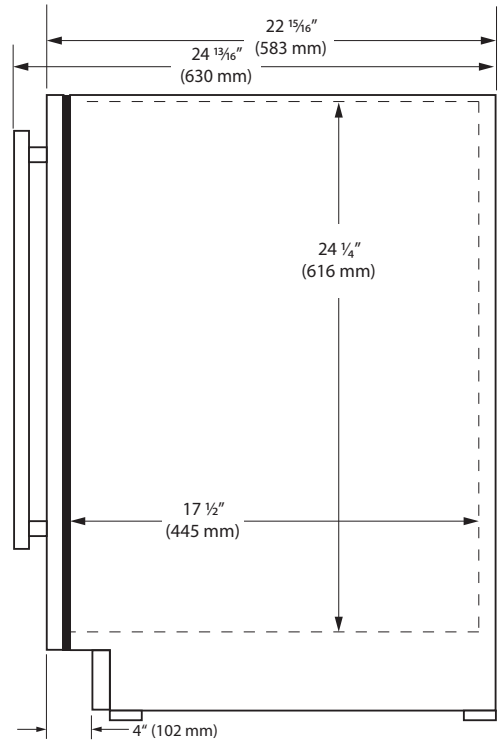

Back

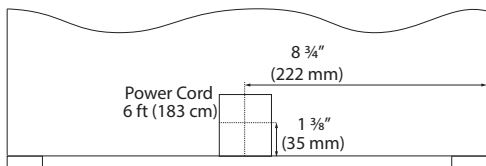

Cabinet Cut-Out

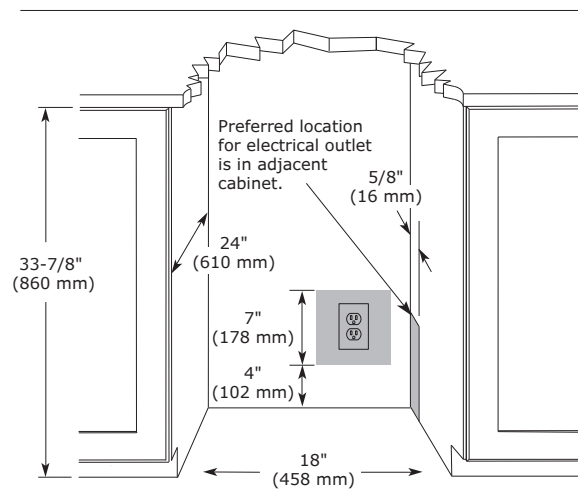

Commercial Warranty

1 Year (parts & labor) / 5 year sealed system (parts)
See complete warranty for details

Installation Notes

- Power cord extends 2" beyond total depth
- No additional clearance is needed for ventilation
- Do not obstruct front grille air flow

24" Refrigerators / Wine Refrigerators

CRE524: 24" Refrigerator

CWC524: 24" Wine Refrigerator



CRE524-SG



CRE524-SS



CWC524-SG



CWC524-SS

Project:	Notes:
----------	--------

Features and Specifications
Convection cooling system provides a quick cool down and consistent temperature
U-Adjust™ Interior: 19 possible positions
Refrigerator models include 2 slide-out metal shelves
Wine Refrigerator models include 5 slide-out wine racks
Stainless steel cabinet, grille, and full-wrap door with lock
Full-depth lower interior with a volume of 5.2 cu ft
Dimensions: 33 1 ¹ / ₁₆ " H x 23 5 ⁸ / ₈ " W x 22 1 ⁵ / ₁₆ " D
Designed for built-in or freestanding applications
Temperature range: 34°F - 70°F
High efficiency variable speed compressor with 1.2 running amps
Environmentally friendly R600a refrigerant

Model Details			
Model	Description	Voltage/Hz	Shipping Weight
UCRE524-SG33A	Refrigerator 24" Reversible Hinge Stainless Glass	115v / 60hz	165 lb
UCRE524-SS33A	Refrigerator 24" Reversible Hinge Stainless Solid	115v / 60hz	150 lb
UCWC524-SG33A	Wine Refrigerator 24" Reversible Hinge Stainless Glass	115v / 60hz	168 lb
UCWC524-SS33A	Wine Refrigerator 24" Reversible Hinge Stainless Solid	115v / 60hz	153 lb

Accessories		
Model	Description	Shipping Weight
ULACASTERKIT24	24" caster kit - for UCWC & UCRE	13 lb
ULAWINERACK24	Slide-out wine rack	8 lb
ULABIN24	Slide-out bin	9 lb
ULASHELF24	Slide-out metal shelf	4 lb



Product Specifications • 24" Refrigerators / Wine Refrigerators

Top

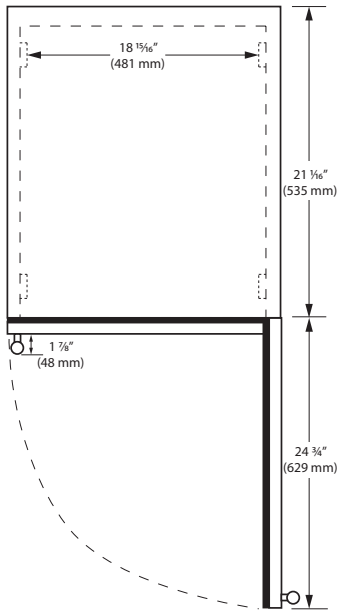

Front

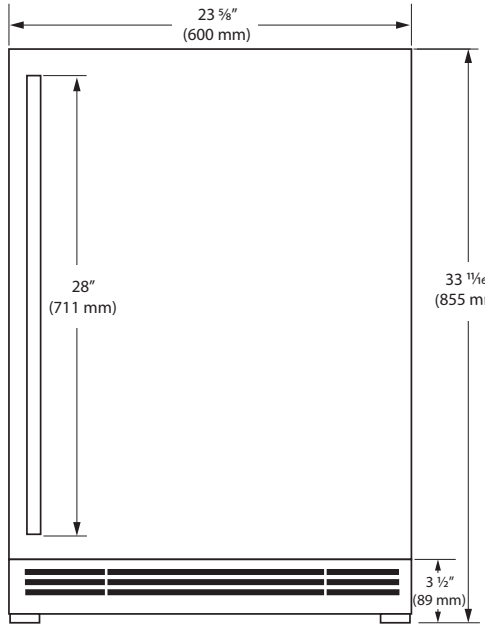

Side

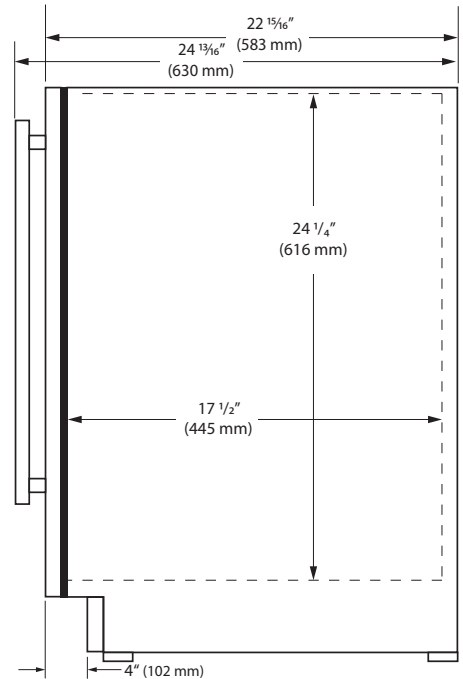

Back

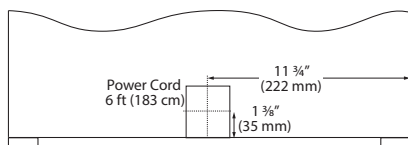

Cabinet Cut-Out

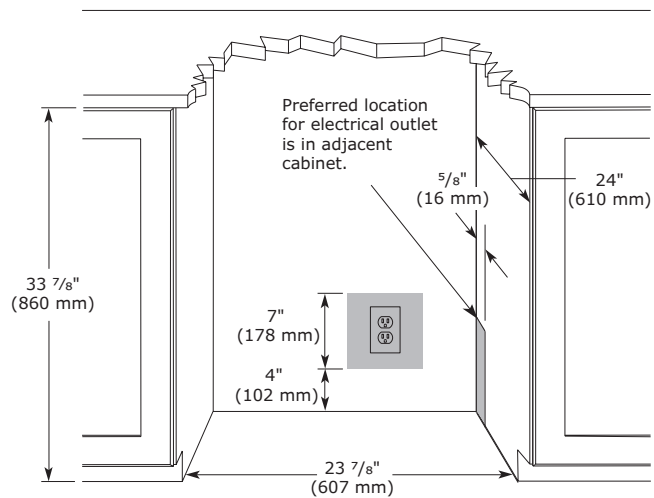

Commercial Warranty

1 Year (parts & labor) / 5 year sealed system (parts)
See complete warranty for details

Installation Notes

- Power cord extends 2" beyond total depth
- No additional clearance is needed for ventilation
- Do not obstruct front grille air flow



Product Specifications

15" Refrigerators / Wine Refrigerators

CRE515: 15" Refrigerator

CWC515: 15" Wine Refrigerator



CRE515-SG CRE515-SS CWC515-SG CWC515-SS

Project:	Notes:
----------	--------

Features and Specifications

Convection cooling system provides a quick cool down and consistent temperature

U-Adjust™ Interior: 19 possible positions

Refrigerator models include 2 slide-out metal shelves

Wine Refrigerator models include 5 slide-out wine racks

Stainless steel cabinet, grille, and full-wrap door with lock

Full-depth lower interior with a volume of 2.9 cu ft

Dimensions: 33 1/16" H x 14 5/16" W x 22 5/16" D

Designed for built-in or freestanding applications

Temperature range: 34°F - 70°F

High efficiency variable speed compressor with 1.2 running amps

Environmentally friendly R600a refrigerant

Model Details

Model	Description	Voltage/Hz	Shipping Weight
UCRE515-SG33A	Refrigerator 15" Reversible Hinge Stainless Glass	115v / 60hz	108 lb
UCRE515-SS33A	Refrigerator 15" Reversible Hinge Stainless Solid	115v / 60hz	96 lb
UCWC515-SG33A	Wine Refrigerator 15" Reversible Hinge Stainless Glass	115v / 60hz	111 lb
UCWC515-SS33A	Wine Refrigerator 15" Reversible Hinge Stainless Solid	115v / 60hz	99 lb

Accessories

Model	Description	Shipping Weight
ULACASTERKIT15	15" Caster Kit for UCWC & UCRE	13 lb
ULAWINERACK15	Slide-out rack	8 lb
ULABIN15	Slide-out bin	9 lb
ULASHELF15	Slide-out metal shelf	4 lb



Product Specifications • 15" Refrigerators / Wine Refrigerators

Top

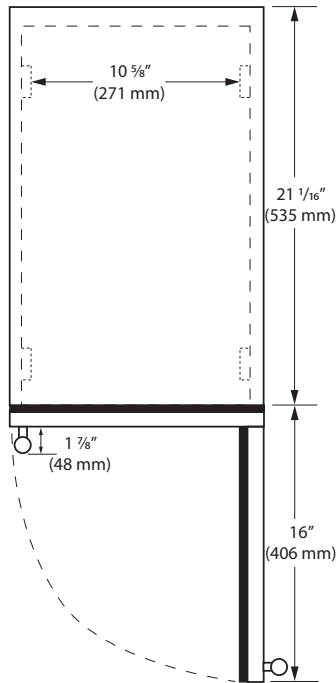

Front

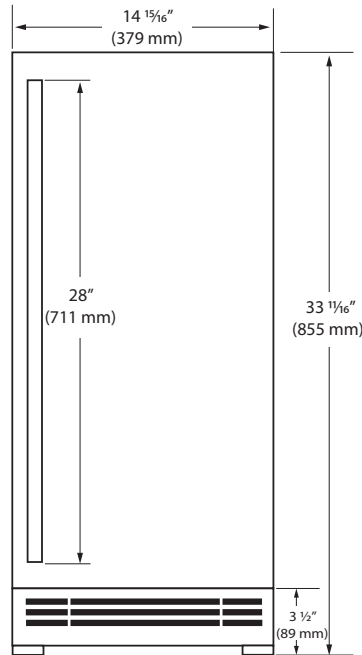

Side

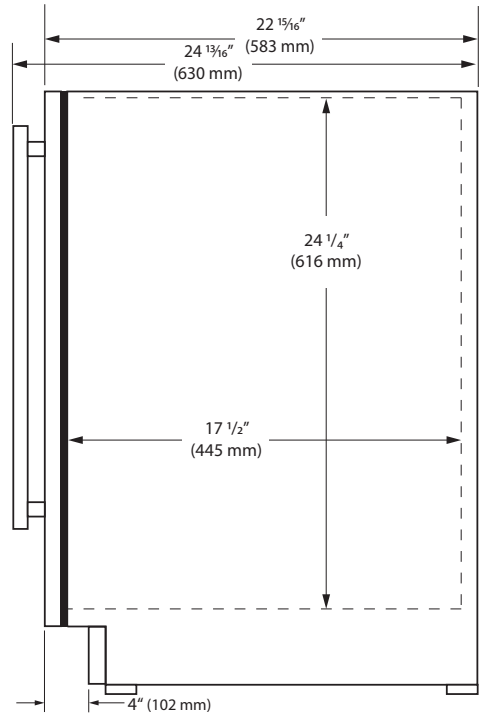

Back

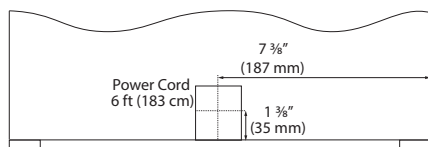

Cabinet Cut-Out

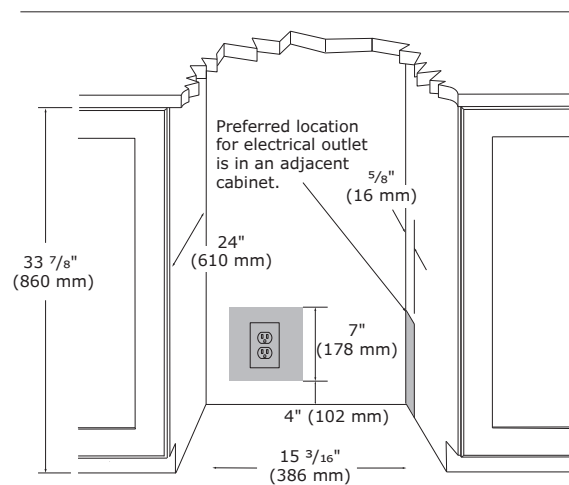

Commercial Warranty

1 Year (parts & labor) / 5 year sealed system (parts)
See complete warranty for details

Installation Notes

- Power cord extends 2" beyond total depth
- No additional clearance is needed for ventilation
- Do not obstruct front grille air flow

24" Dispensers

- CDE224B: Tap 1 & 2: Nitro Coffee • Tap 3: Still Coffee
- CDE224C: Tap 1 & 2: Nitro Coffee • Tap 3 & 4: Still Coffee
- CDE224D: Tap 1: Beer • Tap 2: Beer
- CDE224E: Tap 1: Nitro Coffee • Tap 2: Still Coffee • Tap 3: Wine • Tap 4: Beer



CDE224B

CDE224C

CDE224D

CDE224E



Coffee dispensers utilize patent-pending technology trusted by America's largest coffee chain

Project:	Notes:
----------	--------

Features and Specifications

Includes: refrigeration cabinet, dispensing tower, tubing, hardware, black tap handles, drip tray, and casters
Convection cooling system provides a quick cool down and consistent temperature
Stainless steel cabinet, grille, and full-wrap door
Full-depth lower interior with an interior volume of 6.3 cu ft
Removable lower interior stainless steel liner
CDE224B holds up to three 5 gallon cornelius kegs & one 10 lb / 38 cu ft nitro tank
CDE224C holds up to four cornelius kegs (two 5 gallon and two 3 gallon) & one 10 lb / 38 cu ft nitro tank
CDE224D holds up to one ½ barrel or three ¼ barrels & one 5 lb / 22 cu ft CO ² tank
CDE224E holds up to one 5 gallon cornelius keg, one ¼ barrel, one ¼ slim barrel, & two 5 lb / 22 cu ft tanks (one CO ² one nitro)
Cabinet Dimensions: 34 ½" H x 23 5/8" W x 23 1/8" D (see diagram for tower height)
Temperature range: 34°F – 60°F
Designed for built-in or freestanding applications
High efficiency variable speed compressor with 1.2 running amps
Environmentally friendly R600a refrigerant

Model Details

Model	Description	Voltage/Hz	Shipping Weight
UCDE224BSS03A	Cold Coffee 3 Dispenser 24" Reversible Hinge Stainless Solid	115v / 60hz	134 lb
UCDE224CSS03A	Cold Coffee 4 Dispenser 24" Reversible Hinge Stainless Solid	115v / 60hz	134 lb
UCDE224DSS03A	Beer 2 Dispenser 24" Reversible Hinge Stainless Solid	115v / 60hz	134 lb
UCDE224ESS03A	Cold Coffee, Beer, Wine 4 Dispenser 24" Reversible Hinge Stainless Solid	115v / 60hz	134 lb

Accessories

Model	Description	Shipping Weight
ULANITROTANK	22 cu ft Aluminum Nitro Tank	5 lb
ULACOFFEEKEG	2.5 gal Coffee Keg	6 lb
ULANITROREG	Nitrogen Regulator	3 lb
ULACOFFEECLEAN	Coffee Dispenser Cleaner (1 Box of 5 Packets)	1 lb



Product Specifications • 24" Dispensers

Top

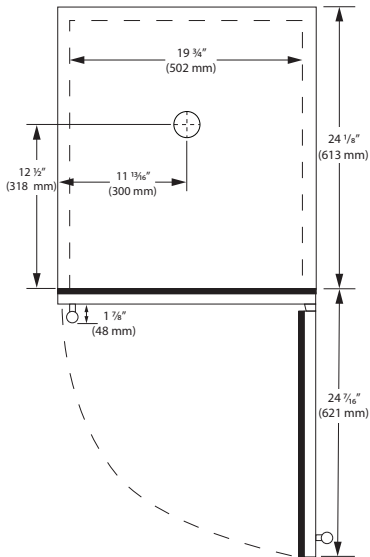

Front

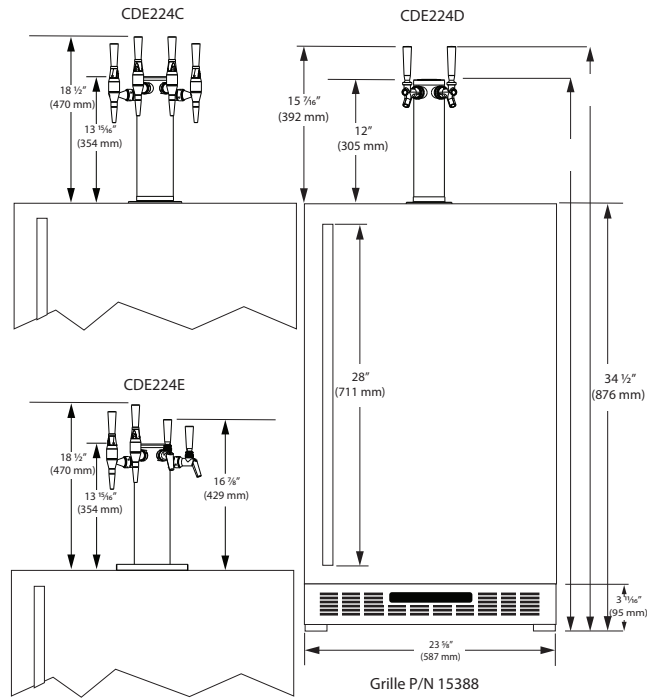

Side

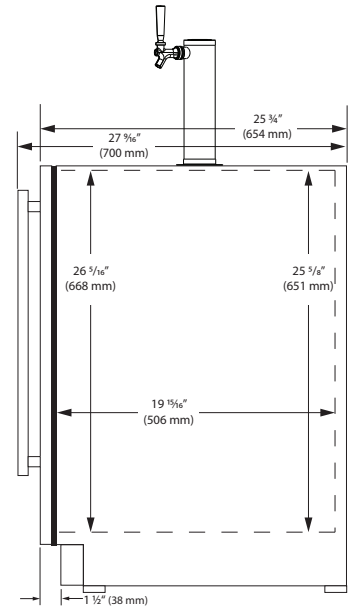

Back

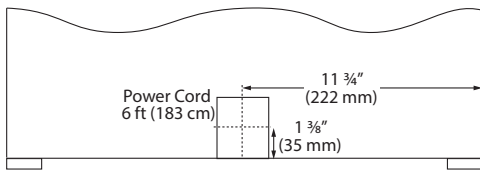

Cabinet Cut-Out

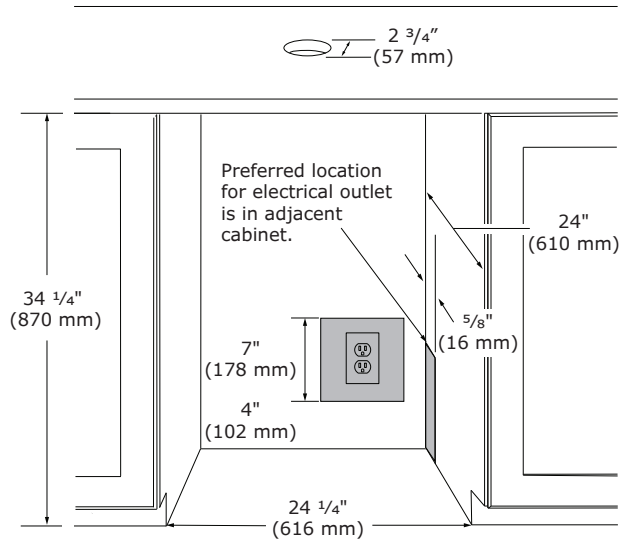

Commercial Warranty

1 Year (parts & labor) / 5 year sealed system (parts)
See complete warranty for details

Installation Notes

- Power cord extends 2" beyond total depth
- No additional clearance is needed for ventilation
- Do not obstruct front grille air flow



Product Specifications

15" Nugget Ice Machine

CNP115: 15" Nugget Ice Machine



CNP115

CNP115

Project:	Notes:
----------	--------

Features and Specifications
Industry exclusive U-Choose™ feature offers five levels of ice density
Produces up to 90 lb of ice per day
Stores 30 lb of ice
Makes cylindrical compressed ice bits approx. 3/4" L x 1/2" H
Indicator alert notifies when cleaning is needed
Stainless steel cabinet, grille, and full-wrap door
Dimensions: 34 11/16" H x 14 15/16" W x 22 15/16" D
Easiest nugget ice machine cleaning process in the industry
Designed for built-in or freestanding applications
Factory installed drain pump
High efficiency variable speed compressor with 1.2 running amps
Environmentally friendly R600a refrigerant

Model Details			
Model	Description	Voltage/Hz	Shipping Weight
UCNP115-SS01A	Nugget Ice Machine 15" Reversible Hinge Stainless Solid	115v / 60hz	96 lb

Accessories		
Model	Description	Shipping Weight
ULALINEFILTERHEAD	In-Line Water Filter Head 3/8" NPT (Required for initial setup)	1 lb
ULALINEFILTER	In-Line Water Filter (Standard)	4.5 lb
ULALINEFILTERL	In-Line Water Filter (Large)	7 lb
ULANUGGETCLEANKIT	Includes 1 Bottle Nugget Ice Cleaner, Funnel, & Hose	1 lb
ULANUGGETCLEAN	Nugget Ice Cleaner (Single 8 oz. bottle)	1 lb
ULAWATERHOOKUP	Braided Water Supply Line Kit	2 lb



Product Specifications • 15" Nugget Ice Machine

Top

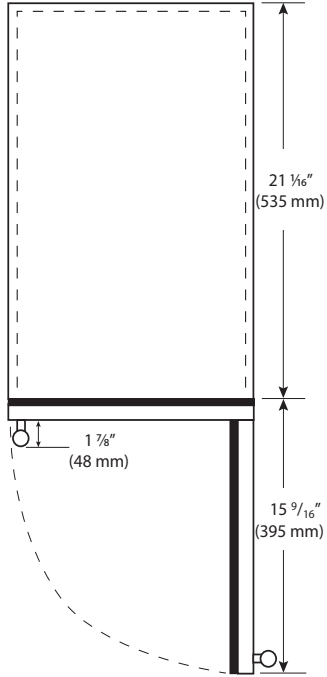

Front

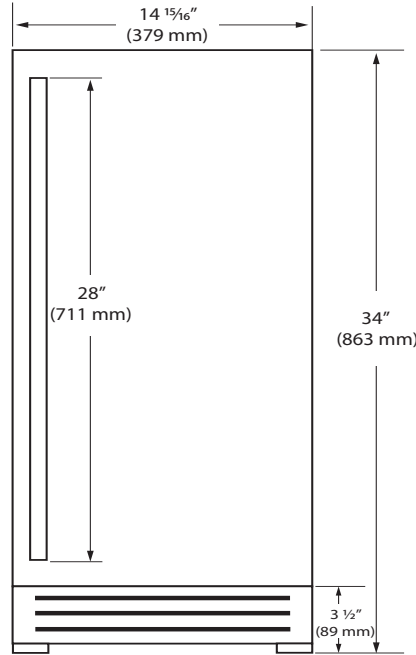

Side

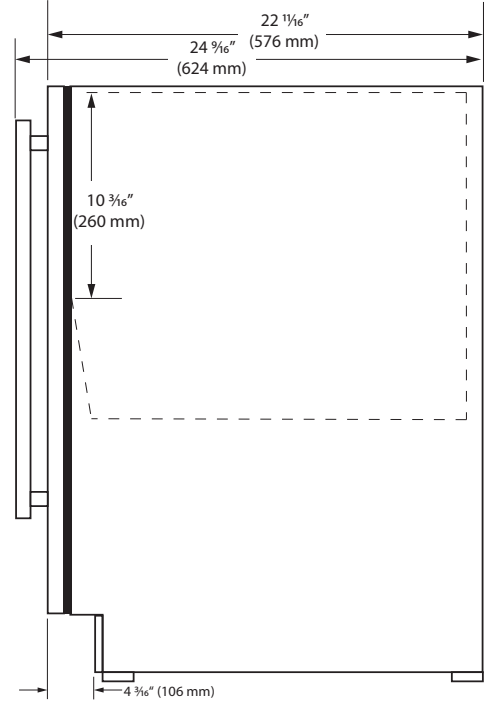

Back

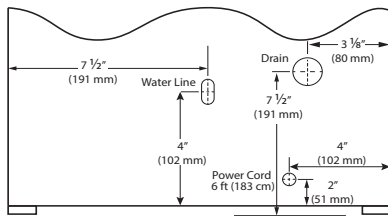

Cabinet Cut-Out

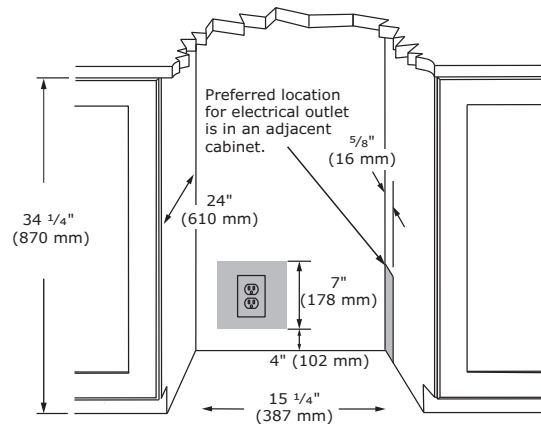

Commercial Warranty

1 Year (parts & labor) / 5 year sealed system (parts)
See complete warranty for details

Installation Notes

- Power cord extends 2" beyond total depth
- No additional clearance is needed for ventilation
- Do not obstruct front grille air flow



Product Specifications

23 cu ft Refrigerator

CRE427: Refrigerator



Designed in partnership with industry-leading Italian commercial manufacturer, Desmon.



CRE427

Project:

Notes:

Features and Specifications

Stainless steel
Volume of 23 cu ft
Electronic digital temperature control with alarms
Autodefrost
Epoxy coated, sealed evaporator eliminates potential of corrosion
High efficiency evaporator coil & condenser
Factory pre-wired for dedicated outlet
Includes 3 epoxy coated wire shelves
Dimensions: 80 ²³ / ₃₂ " H x 27 ⁹ / ₁₆ " W x 31 ¹ / ₂ " D
Temperature range: 28°F - 46°F
High efficiency compressor with 5.2 running amps
Environmentally friendly R290 refrigerant

Model Details

Model	Description	Voltage/Hz	Shipping Weight
UCRE427-SS01A	23 cu ft Refrigerator, Field Reversible Hinge	115v / 60hz	287 lb

Accessories

Model	Description	Shipping Weight
ULA4080584	Shelf Guide	.88 lb
ULAQ32-0002	Epoxy Coated Wire Shelf (20.86" x 25.6")	2.2 lb
ULA89020410	Adjustable Leg kit	11.02 lb
ULA89010340	Caster Kit	13.22 lb
ULA80010380	Door Lock Kit	2.2 lb
ULA80110300	Light Kit	2.2 lb



Product Specifications • 23 cu ft Refrigerator

Front (Open)

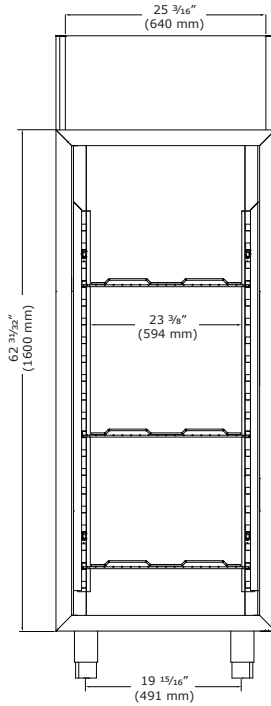

Front (Closed)

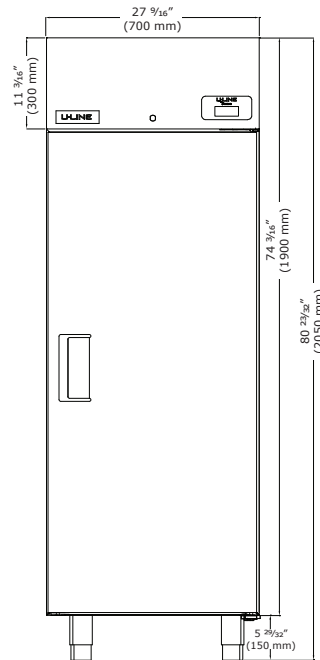

Top

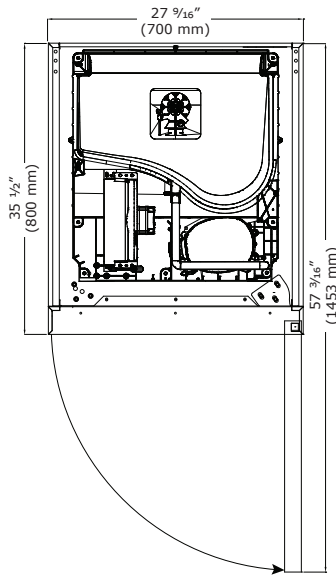

Side

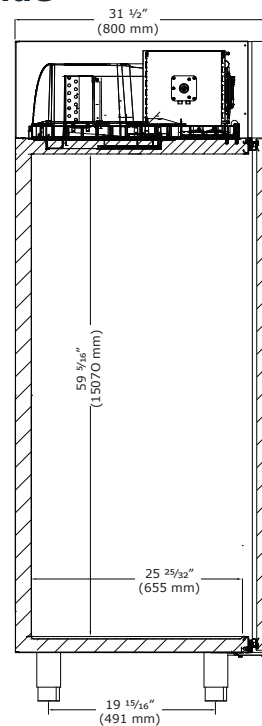

Commercial Warranty

1 Year (parts & labor) / 5 year sealed system (parts)
See complete warranty for details



Product Specifications 23 cu ft Refrigerators

CRE527-SS: Solid Door Refrigerator
CRE527-SG: Glass Door Refrigerator



Designed in partnership with industry-leading Italian commercial manufacturer, Desmon.



CRE527-SS



CRE527-SG

Project:

Notes:

Features and Specifications

Stainless Steel
Volume of 23 cu ft
Electronic digital temperature control with alarms
Autodefrost
Epoxy coated, sealed evaporator eliminates potential of corrosion
High efficiency evaporator coil & condenser
Factory pre-wired for dedicated outlet
Includes 3 epoxy coated wire shelves
Key lock
LED lighting
Dimensions: 82 9/32" H x 26 25/32" W x 31 1/2" D
Temperature range: 28°F - 46°F
High efficiency compressor with 3.2 running amps
Environmentally friendly R290 refrigerant

Model Details

Model	Description	Voltage/Hz	Shipping Weight
UCRE527-SS31A	23 cu ft Refrigerator Solid Door, Field Reversible Hinge	115v / 60hz	287 lb
UCRE527-SG41A	23 cu ft Refrigerator Glass Door, Right Hand Hinge	115v / 60hz	327 lb

Accessories

Model	Description	Shipping Weight
ULAQ32-0002	Epoxy Coated Wire Shelf (20.86" x 25.6")	2.2 lb
ULA89010340	Caster Kit	13.22 lb



Product Specifications • 23 cu ft Refrigerators

Front (Open)

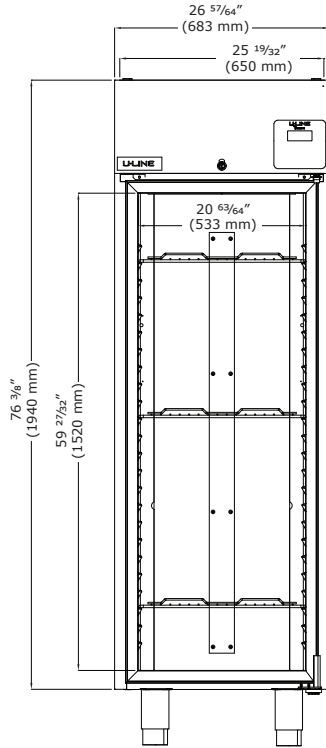

Top

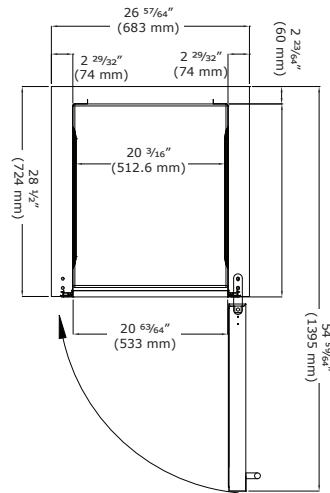

Side

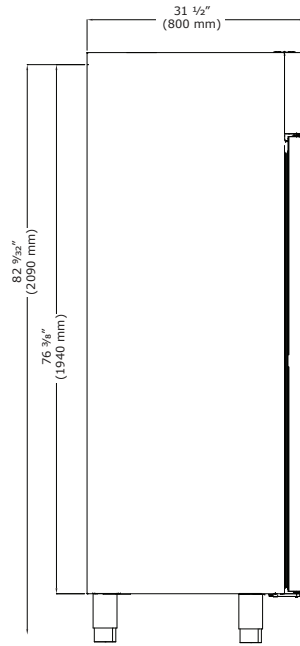

Side

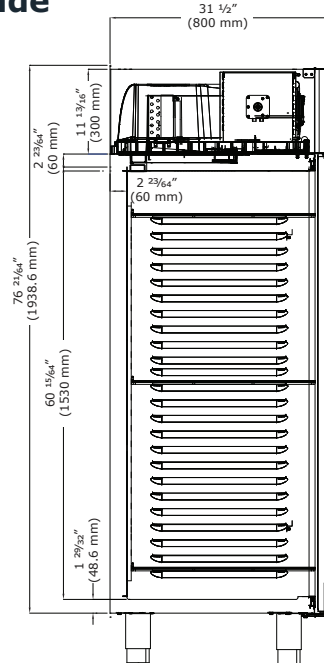

Front (Closed - Glass Door)

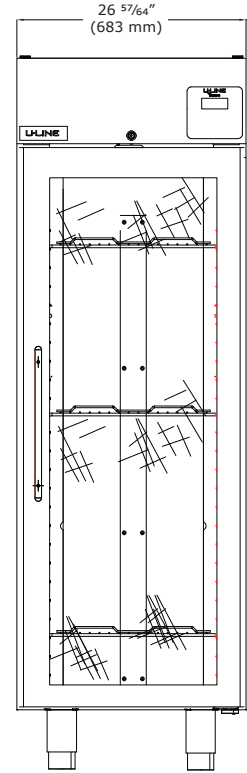

Commercial Warranty

1 Year (parts & labor) / 5 year sealed system (parts)
See complete warranty for details





Product Specifications

48 cu ft Refrigerator

CRE455: Refrigerator



Designed in partnership with industry-leading Italian commercial manufacturer, Desmon.



CRE455

Project:
Notes:

Features and Specifications

Stainless steel
Volume of 48 cu ft
Electronic digital temperature control with alarms
Autodefrost
Epoxy coated, sealed evaporator eliminates potential corrosion
High efficiency evaporator coil & condenser
Factory pre-wired for dedicated outlet
Includes 6 epoxy coated wire shelves
Dimensions: 83 15/32" H x 55 1/8" W x 31 1/2" D
Temperature range: 28°F - 46°F
High efficiency compressor with 5.4 running amps
Environmentally friendly R290 refrigerant

Model Details

Model	Description	Voltage/Hz	Shipping Weight
UCRE455-SS71A	48 cu ft Refrigerator	115v / 60hz	396 lb

Accessories

Model	Description	Shipping Weight
ULA4080584	Shelf Guide	.88 lb
ULAQ32-0002	Epoxy Coated Wire Shelf (20.86" x 25.6")	2.2 lb
ULA89030400	Adjustable Leg kit	11.02 lb
ULA81040300	Caster Kit	11.02 lb
ULA80010380	Door Lock Kit	2.2 lb
ULA80110300	Light Kit	2.2 lb



Product Specifications • 48 cu ft Refrigerator

Front (Open)

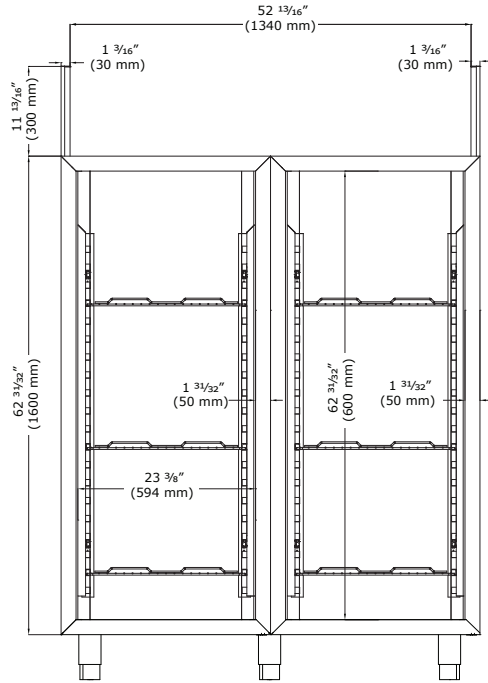

Front (Closed)

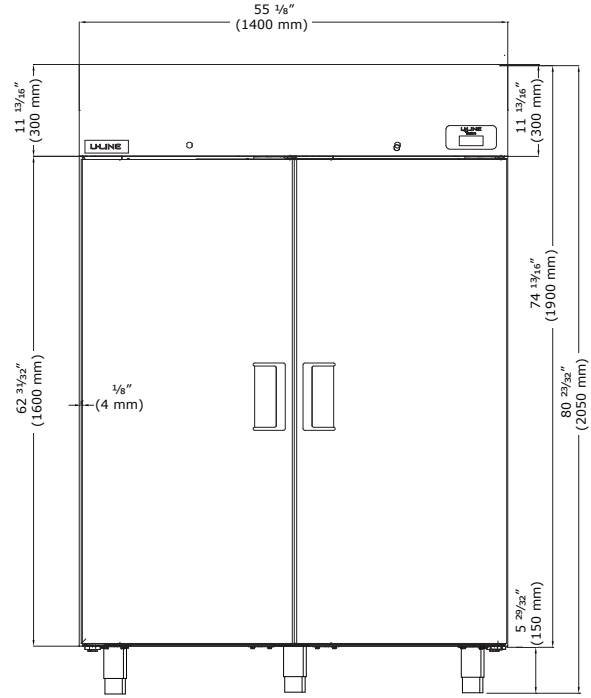

Top

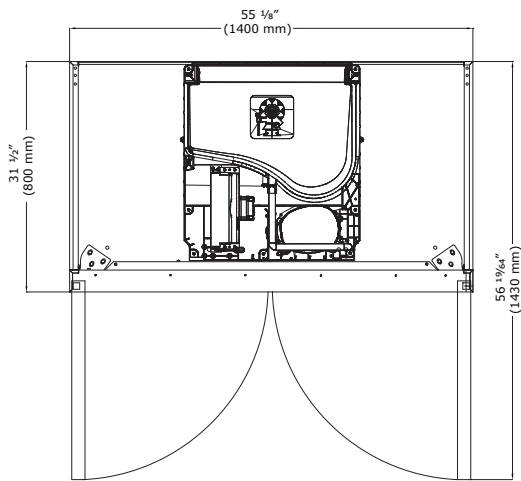

Side

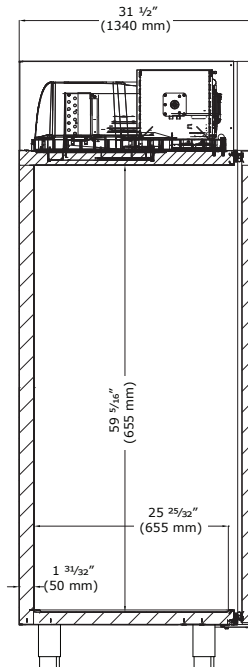

Commercial Warranty

1 Year (parts & labor) / 5 year sealed system (parts)
See complete warranty for details



CRE553-SS: Solid Door Refrigerator
CRE553-SG: Glass Door Refrigerator



Designed in partnership with industry-leading Italian commercial manufacturer, Desmon.



CRE553-SS



CRE553-SG

Project:

Notes:

Features and Specifications

Stainless steel
Volume of 49 cu ft
Electronic digital temperature control with alarms
Autodefrost
Epoxy coated, sealed evaporator eliminates potential corrosion
High efficiency evaporator coil & condenser
Factory pre-wired for dedicated outlet
Includes 6 epoxy coated wire shelves
Key lock
LED lighting
Dimensions: 82 9/32" H x 52 3/4" W x 31 1/2" D
Temperature range: 28°F - 46°F
High efficiency compressor with 5.4 running amps
Environmentally friendly R290 refrigerant

Model Details

Model	Description	Voltage/Hz	Shipping Weight
UCRE553-SS71A	49 cu ft Refrigerator Solid Door	115v / 60hz	419 lb
UCRE553-SG71A	49 cu ft Refrigerator Glass Door	115v / 60hz	518 lb

Accessories

Model	Description	Shipping Weight
ULA4080534	Shelf Guide	.88 lb
ULAQ32-0002	Epoxy Coated Wire Shelf (20.86" x 25.6")	2.2 lb
ULA81040300	Caster Kit	11.02 lb



Product Specifications • 49 cu ft Refrigerators

**Front
(Closed - Solid Door)**

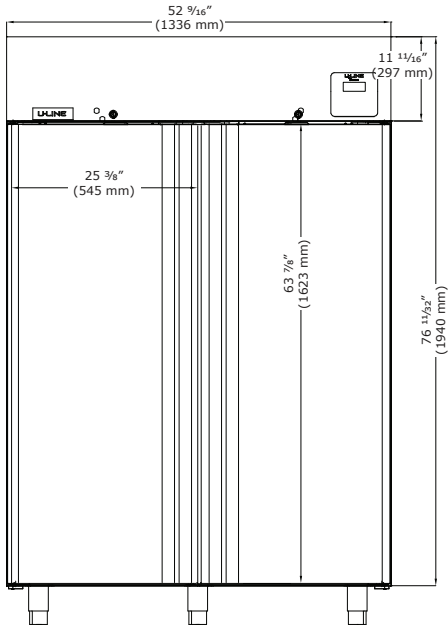

**Front
(Closed - Glass Door)**

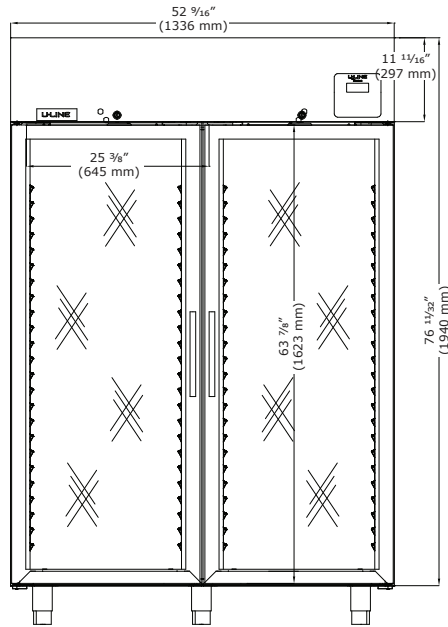

Side

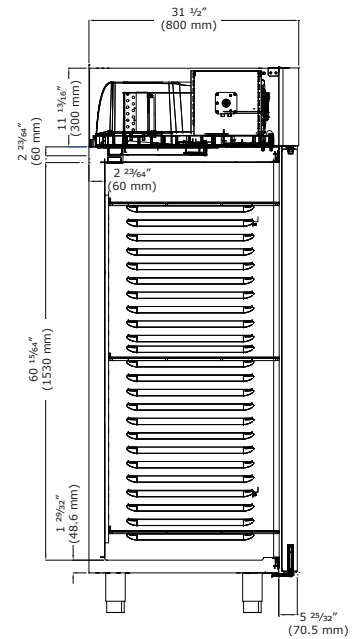

Top

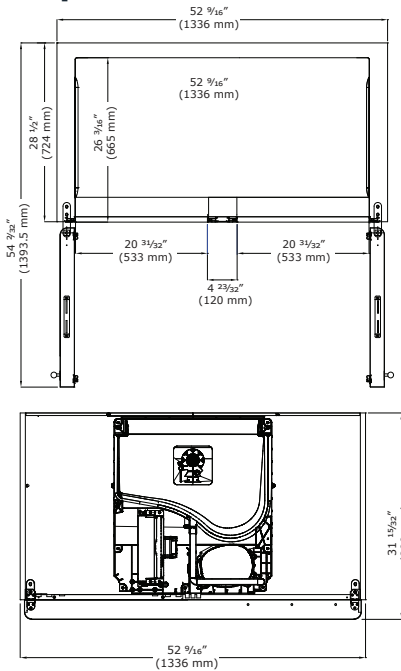

Back

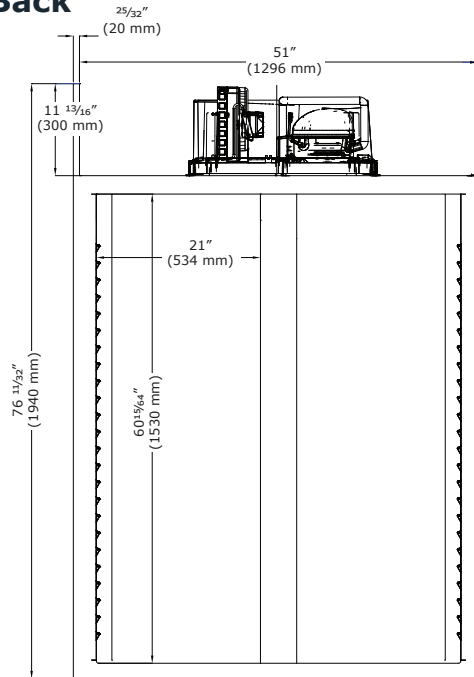

Side

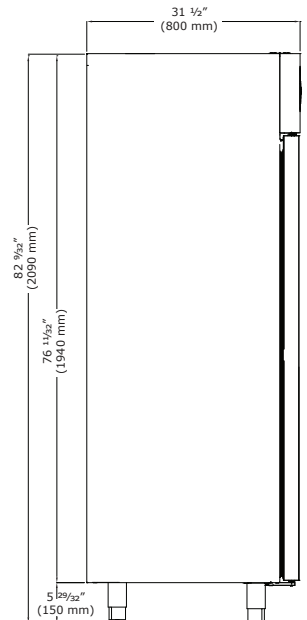

Commercial Warranty

1 Year (parts & labor) / 5 year sealed system (parts)
See complete warranty for details



CRE585-SS: 74 cu ft Solid Door Refrigerator
 CRE585-SG: 74 cu ft Glass Door Refrigerator



Designed in partnership with industry-leading Italian commercial manufacturer, Desmon.



CRE585-SS



CRE585-SG

Project:

Notes:

Features and Specifications

Stainless steel
Volume of 74 cu ft
Electronic digital temperature control with alarms
Autodefrost
Epoxy coated, sealed evaporator eliminates potential corrosion
High efficiency evaporator coil & condenser
Factory pre-wired for dedicated outlet
Includes 9 epoxy coated wire shelves
Key lock
LED lighting
Dimensions: 82 9/32" H x 85 3/64" W x 31 1/2" D
Temperature range: 28°F - 46°F
High efficiency compressor with 7 running amps
Environmentally friendly R290 refrigerant

Model Details

Model	Description	Voltage/Hz	Shipping Weight
UCRE585-SS71A	74 cu ft Refrigerator Solid Door	115v / 60hz	650 lb
UCRE585-SG71A	74 cu ft Refrigerator Glass Door	115v / 60hz	750 lb

Accessories

Model	Description	Shipping Weight
ULA4080584	Shelf Guide	.88 lb
ULAQ32-0002	Epoxy Coated Wire Shelf (20.86" x 25.6")	2.2 lb
ULA89010360	Caster Kit	13.22 lb



Product Specifications • 74 cu ft Refrigerators

Front (Closed - Solid Door)

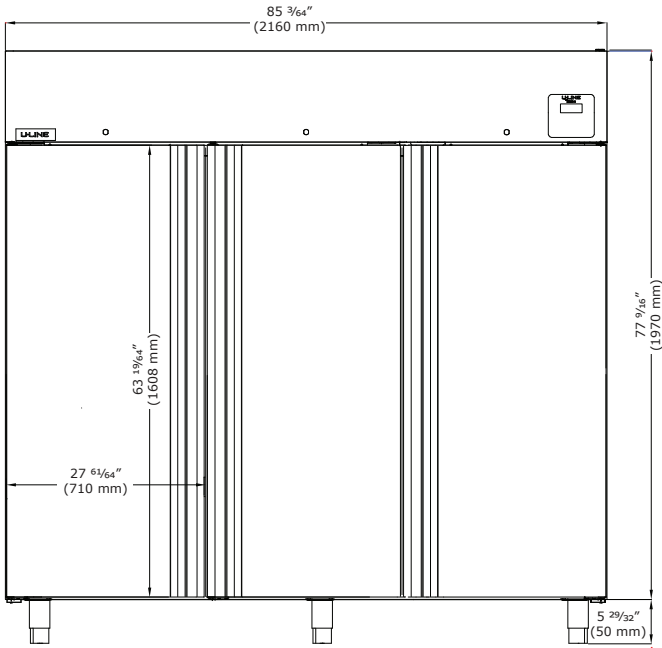

Front (Open)

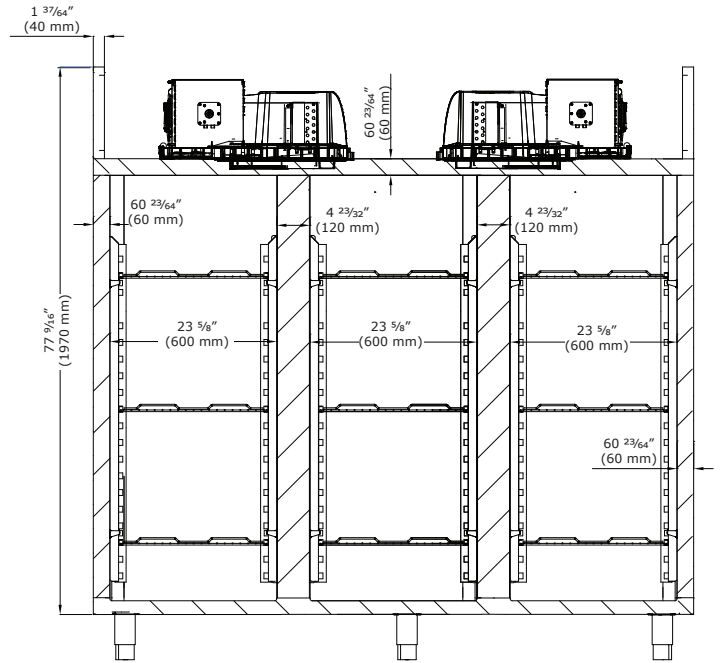

Front (Closed - Glass Door)

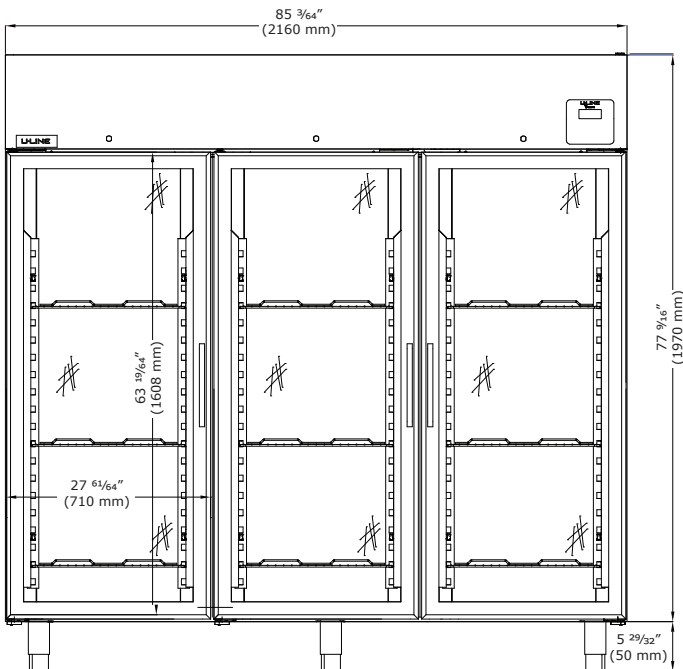

Side

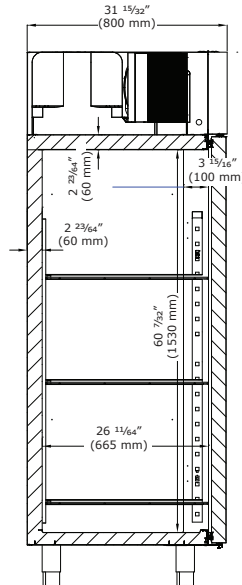

Top

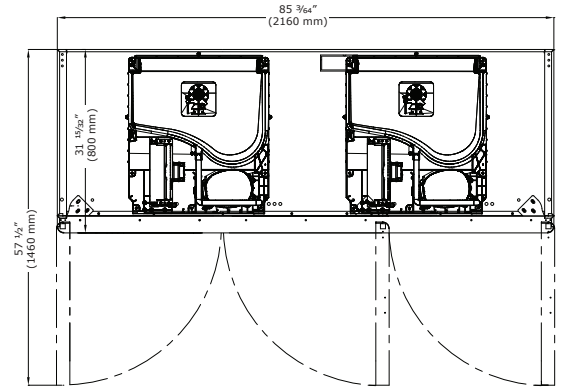

Commercial Warranty

1 Year (parts & labor) / 5 year sealed system (parts)
See complete warranty for details



CRB536: 36" Refrigerator Base
 CRB548: 48" Refrigerator Base
 CRB560: 60" Refrigerator Base
 CRB572: 72" Refrigerator Base



Designed in partnership with industry-leading Italian commercial manufacturer, Desmon.



CRB536



CRB548



CRB560



CRB572

Project:

Notes:

Features and Specifications

Stainless steel

CRB536 capacity: holds (2) standard size GN1/1 (12"x20"x4") pans (not included)

CRB548 capacity: holds (4) standard size GN1/1 (12"x20"x4") pans (not included)

CRB560 capacity: holds (4) standard size GN1/1 (12"x20"x4") pans (not included)

CRB572 capacity: holds (8) standard size GN1/1 (12"x20"x4") pans (not included)

Electronic digital temperature control with alarms

Autodefrost

Epoxy coated, sealed evaporator eliminates potential corrosion

High efficiency evaporator coil & condenser

Factory pre-wired for dedicated outlet

CRB536 dimensions: 26" H x 36" W x 32 1/2" D

CRB548 dimensions: 26" H x 48" W x 32 1/2" D

CRB560 dimensions: 26" H x 60" W x 32 1/2" D

CRB572 dimensions: 26" H x 72" W x 32 1/2" D

Temperature range: 28°F - 46°F

High efficiency compressor with 7.3 running amps

Environmentally friendly R452A refrigerant

Model Details

Model	Description	Voltage/Hz	Shipping Weight
UCRB536-SS61A	36" Refrigerator Base	115v / 60hz	340 lb
UCRB548-SS61A	48" Refrigerator Base	115v / 60hz	410 lb
UCRB560-SS61A	60" Refrigerator Base	115v / 60hz	549 lb
UCRB572-SS61A	72" Refrigerator Base	115v / 60hz	653 lb



Product Specifications • Refrigerator Bases

Front (CRB536)

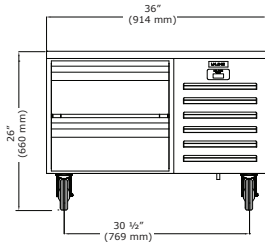

Side

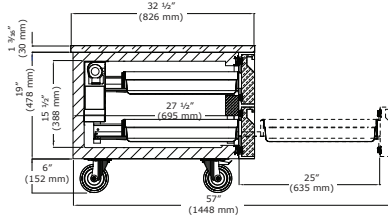

Top

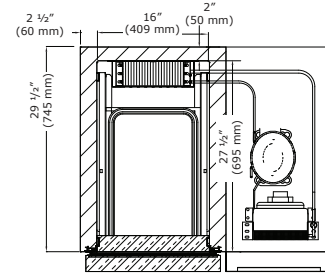

Front (CRB548)

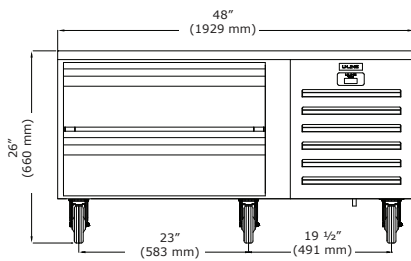

Side

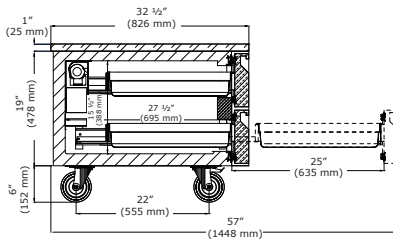

Top

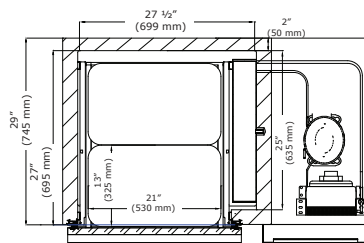

Front (CRB560)

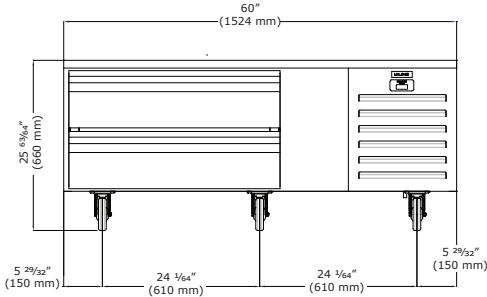

Side

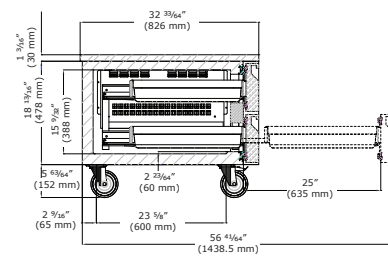

Top

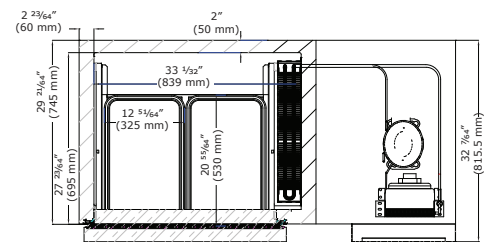

Front (CRB572)

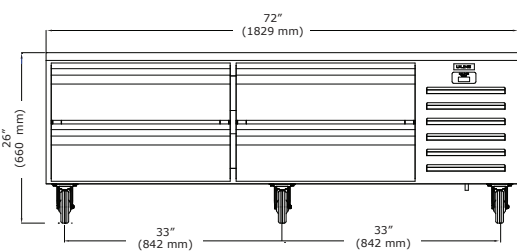

Side

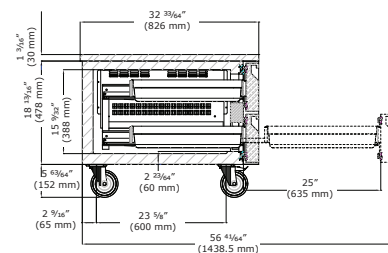

Top

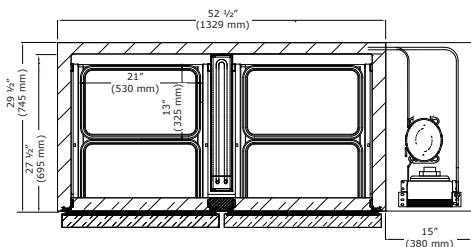

Commercial Warranty

1 Year (parts & labor) / 5 year sealed system (parts)
See complete warranty for details



23 cu ft Freezer

CFZ427: Freezer



Designed in partnership with industry-leading Italian commercial manufacturer, Desmon.



CFZ427

Project:

Notes:

Features and Specifications

Stainless steel
Volume of 23 cu ft
Electronic digital temperature control with alarms
Autodefrost
Epoxy coated, sealed evaporator eliminates potential corrosion
High efficiency evaporator coil & condenser
Factory pre-wired for dedicated outlet
Includes 3 epoxy coated wire shelves
LED lighting
Dimensions: 80 23/32" H x 27 9/16" W x 31 1/2" D
Temperature range: 14°F - (-13°F)
High efficiency compressor with 5.2 running amps
Environmentally friendly R290 refrigerant

Model Details

Model	Description	Voltage/Hz	Shipping Weight
UCFZ427-SS01A	23 cu ft Freezer, Field Reversible Hinge	115v / 60hz	287 lb

Accessories

Model	Description	Shipping Weight
ULA4080584	Shelf Guide	.88 lb
ULAQ32-0002	Epoxy Coated Wire Shelf (20.86" x 25.6")	2.2 lb
ULA89020410	Adjustable Leg kit	11.02 lb
ULA89010340	Caster Kit	11.02 lb
ULA80010380	Door Lock Kit	2.2 lb
ULA80110300	Light Kit	2.2 lb



Product Specifications • 23 cu ft Freezer

Front (Open)

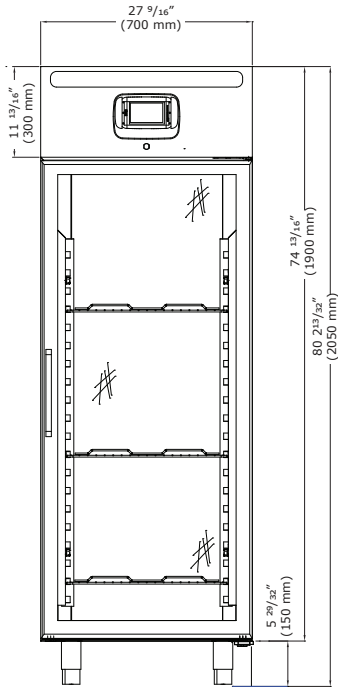

Top

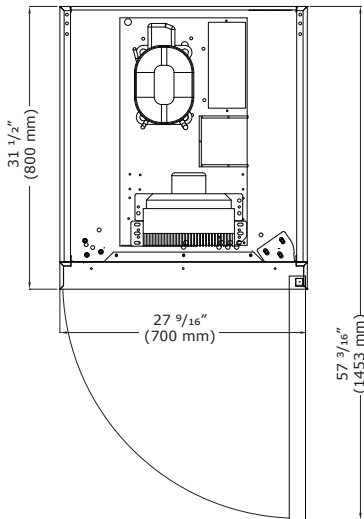

Front (Closed)

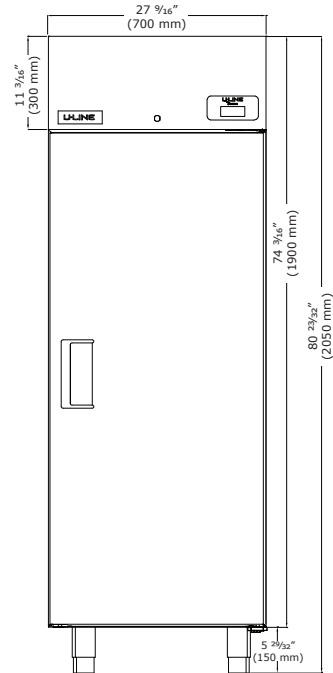

Side

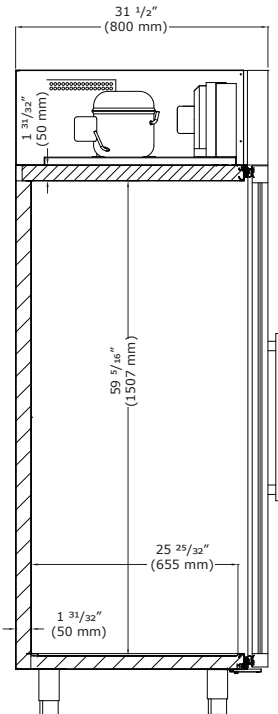

Commercial Warranty

1 Year (parts & labor) / 5 year sealed system (parts)
See complete warranty for details





Product Specifications

23 cu ft Freezer

CFZ527: Freezer



Designed in partnership with industry-leading Italian commercial manufacturer, Desmon.



CFZ527

Project:

Notes:

Features and Specifications

Stainless steel
Volume of 23 cu ft
Electronic digital temperature control with alarms
Autodefrost
Epoxy coated, sealed evaporator eliminates potential corrosion
High efficiency evaporator coil & condenser
Factory pre-wired for dedicated outlet
Includes 3 epoxy coated wire shelves
Key lock
LED lighting
Dimensions: 82 9/32" H x 26 25/32" W x 31 1/2" D
Temperature range: 14°F - (-13°F)
High efficiency compressor with 5.2 running amps
Environmentally friendly R290 refrigerant

Model Details

Model	Description	Voltage/Hz	Shipping Weight
UCFZ527-SS31A	23 cu ft Freezer, Field Reversible Hinge	115v / 60hz	297 lb

Accessories

Model	Description	Shipping Weight
ULAQ32-0002	Epoxy Coated Wire Shelf (20.86" x 25.6")	2.2 lb
ULA89010340	Caster Kit	11.02 lb



Product Specifications • 23 cu ft Freezer

Front (Open)

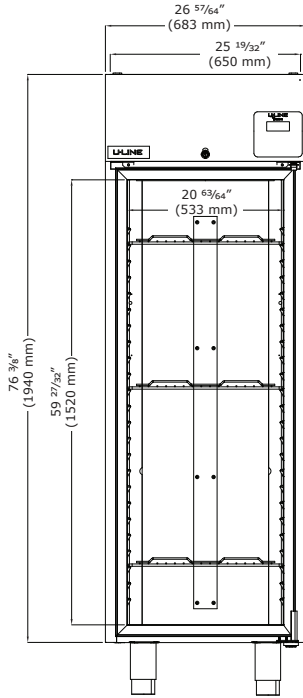

Front (Closed)

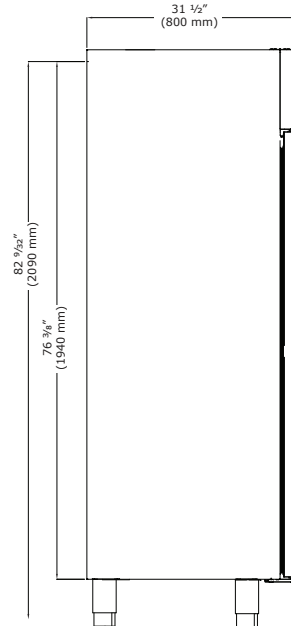

Top

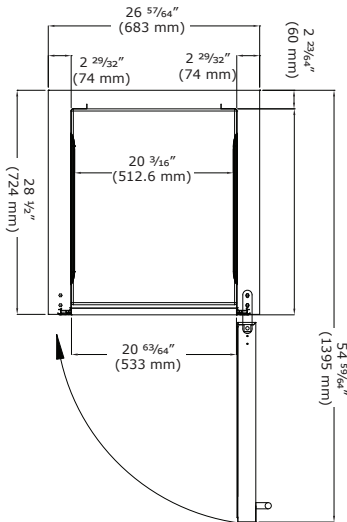

Side

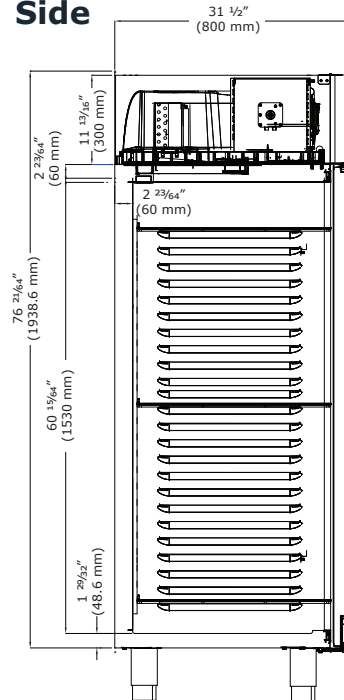

Commercial Warranty

1 Year (parts & labor) / 5 year sealed system (parts)
See complete warranty for details



48 cu ft Freezer

CFZ455: Freezer



Designed in partnership with industry-leading Italian commercial manufacturer, Desmon.



CFZ455

Project:

Notes:

Features and Specifications

Stainless steel
Volume of 48 cu ft
Electronic digital temperature control with alarms
Autodefrost
Epoxy coated, sealed evaporator eliminates potential corrosion
High efficiency evaporator coil & condenser
Factory pre-wired for dedicated outlet
Includes 6 epoxy coated wire shelves
Dimensions: 83 15/32" H x 55 1/8" W x 31 1/2" D
Temperature range: 14°F - (-13°F)
High efficiency compressor with 8 running amps
Environmentally friendly R290 refrigerant

Model Details

Model	Description	Voltage/Hz	Shipping Weight
UCFZ455-SS71A	48 cu ft Freezer	115v / 60hz	418 lb

Accessories

Model	Description	Shipping Weight
ULA4080584	Shelf Guide	.88 lb
ULAQ32-0002	Epoxy Coated Wire Shelf (20.86" x 25.6")	2.2 lb
ULA89030400	Adjustable Leg kit	11.02 lb
ULA81040300	Caster Kit	11.02 lb
ULA80010380	Door Lock Kit	2.2 lb
ULA80110300	Light Kit	2.2 lb



Product Specifications • 48 cu ft Freezer

Front (Open)

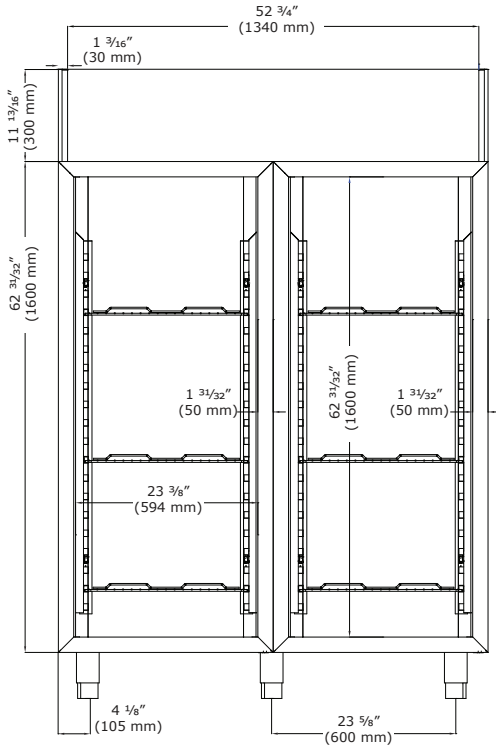

Front (Closed)

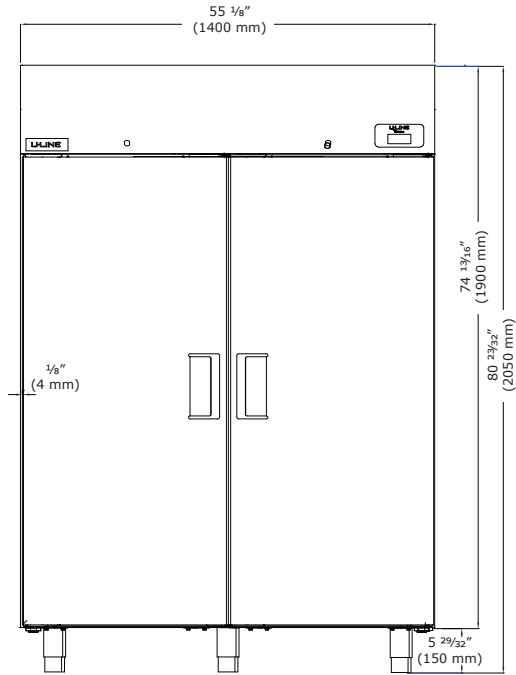

Top

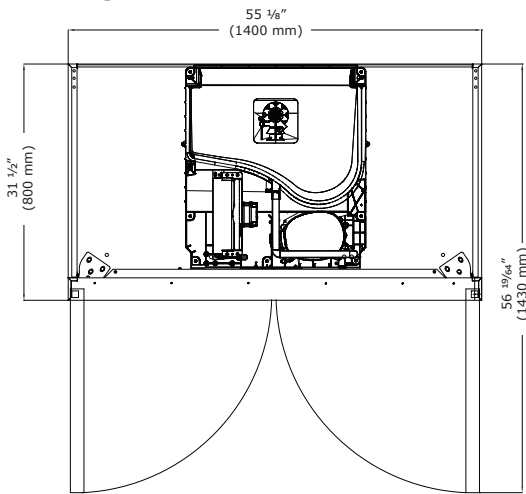

Side

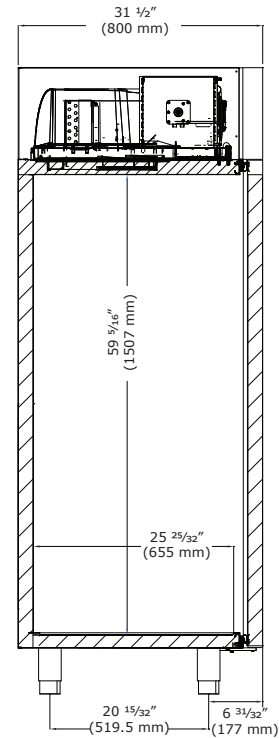

Commercial Warranty

1 Year (parts & labor) / 5 year sealed system (parts)
See complete warranty for details



49 cu ft Freezer

CFZ553: Freezer



Designed in partnership with industry-leading Italian commercial manufacturer, Desmon.



CFZ553

Project:

Notes:

Features and Specifications

Stainless steel
Volume of 49 cu ft
Electronic digital temperature control with alarms
Autodefrost
Epoxy coated, sealed evaporator eliminates potential corrosion
High efficiency evaporator coil & condenser
Factory pre-wired for dedicated outlet
Includes 6 epoxy coated wire shelves
Key lock
LED lighting
Dimensions: 82 9/32" H x 52 3/4" W x 31 1/2" D
Temperature range: 14°F - (-13°F)
High efficiency compressor with 5.4 running amps
Environmentally friendly R290 refrigerant

Model Details

Model	Description	Voltage/Hz	Shipping Weight
UCFZ553-SS71A	49 cu ft Freezer	115v / 60hz	441 lb

Accessories

Model	Description	Shipping Weight
ULA4080534	Shelf Guide	.88 lb
ULAQ32-0002	Epoxy Coated Wire Shelf (20.86" x 25.6")	2.2 lb
ULA81040300	Caster Kit	11.02 lb



Product Specifications • 49 cu ft Freezer

Front

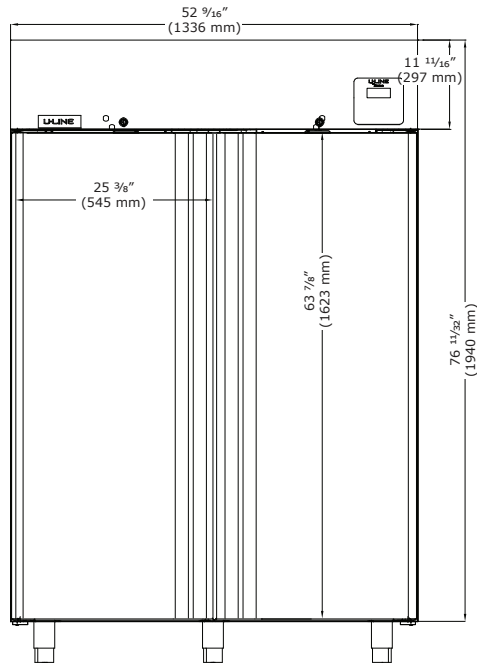

Side

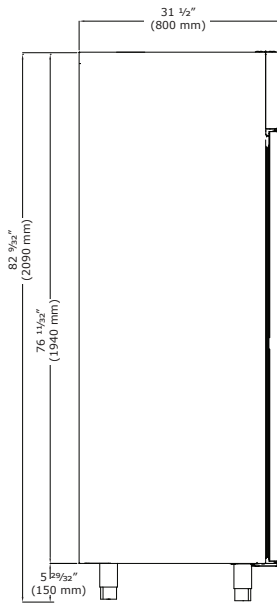

Top

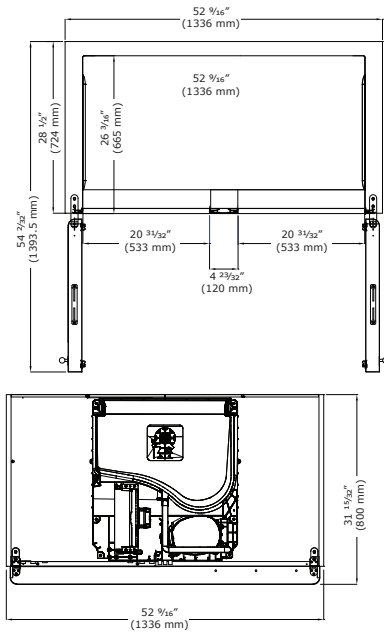

Back

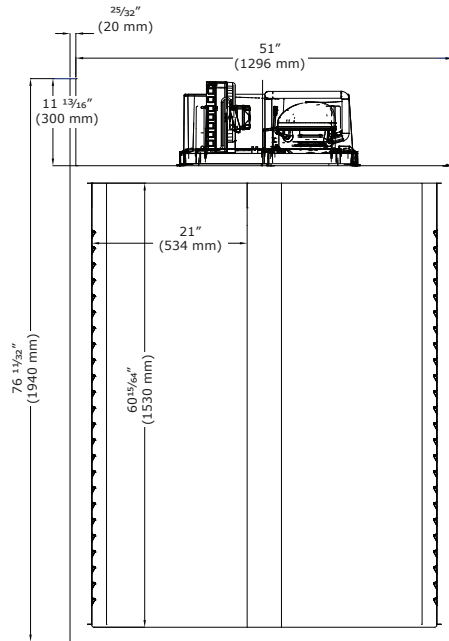

Side

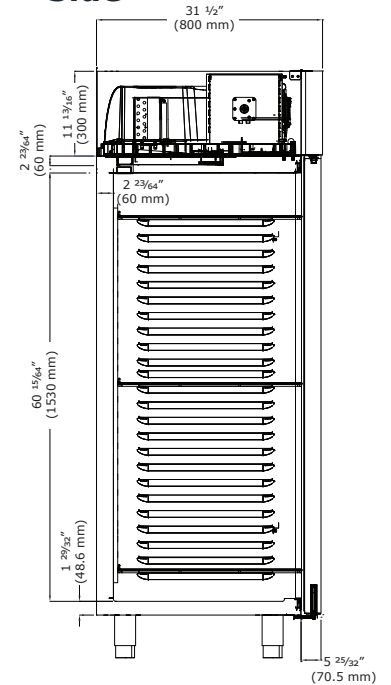

Commercial Warranty

1 Year (parts & labor) / 5 year sealed system (parts)
See complete warranty for details





Product Specifications

72 cu ft Freezer

CFZ585: Freezer



Designed in partnership with industry-leading Italian commercial manufacturer, Desmon.



CFZ585

Project:

Notes:

Features and Specifications

- Stainless steel
- Volume of 72 cu ft
- Electronic digital temperature control with alarms
- Autodefrosts
- Epoxy coated, sealed evaporator eliminates potential corrosion
- High efficiency evaporator coil & condenser
- Factory pre-wired for dedicated outlet
- Includes 9 epoxy coated wire shelves
- Key lock
- LED lighting
- Dimensions: 82 9/32" H x 85 3/64" W x 31 1/2" D
- Temperature range: 14°F - (-13°F)
- High efficiency compressor with 8 running amps
- Environmentally friendly R290 refrigerant

Model Details

Model	Description	Voltage/Hz	Shipping Weight
UCFZ585-SS71A	72 cu ft Freezer	115v / 60hz	650 lb

Accessories

Model	Description	Shipping Weight
ULA4080584	Shelf Guide	.88 lb
ULAQ32-0002	Epoxy Coated Wire Shelf (20.86" x 25.6")	2.2 lb
ULA89010360	Caster Kit	13.22 lb



Product Specifications • 74 cu ft Freezer

Front (Open)

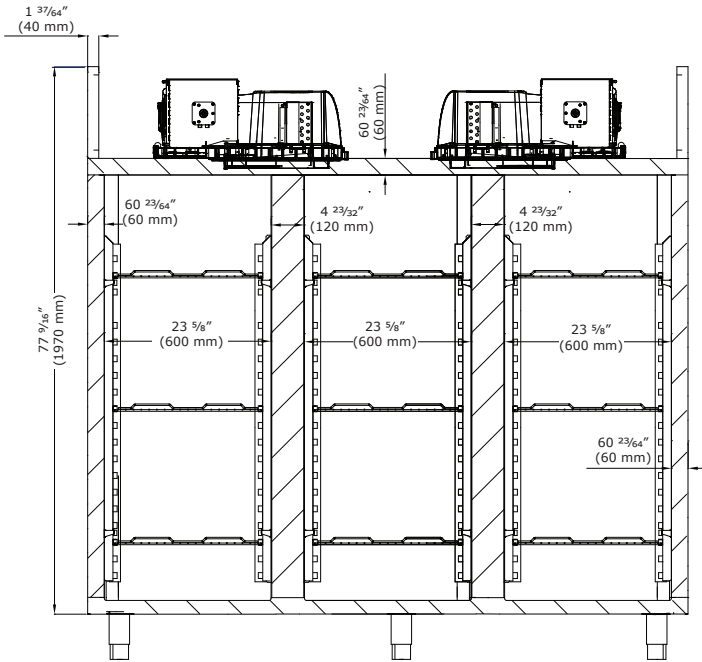

Front (Closed)

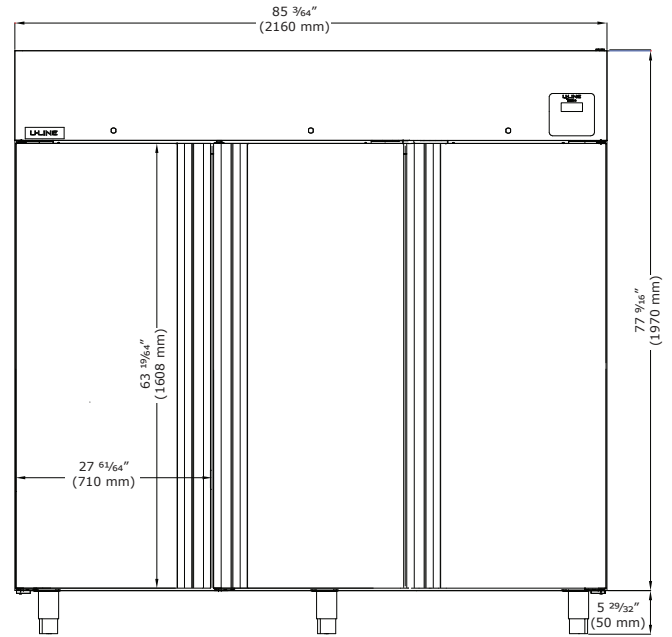

Side

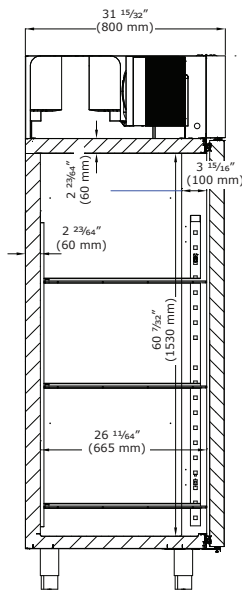

Top

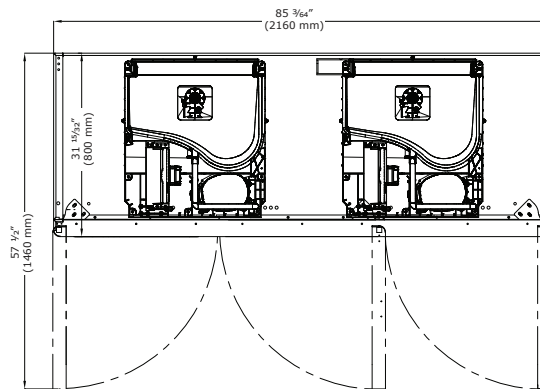

Commercial Warranty

1 Year (parts & labor) / 5 year sealed system (parts)
See complete warranty for details



Freezer Bases

CFB536: 36" Freezer Base
 CFB548: 48" Freezer Base
 CFB560: 60" Freezer Base
 CFB572: 72" Freezer Base



Designed in partnership with industry-leading Italian commercial manufacturer, Desmon.



CFB536



CFB548



CFB560



CFB572

Project:

Notes:

Features and Specifications

Stainless steel
CFB536 capacity: 2 drawers hold (2) 12"x20"x4" pans
CFB548 capacity: 2 drawers hold (4) 12"x20"x4" pans
CFB560 capacity: 2 drawers hold (4) 12"x20"x4" pans
CFB572 capacity: 4 drawers hold (8) 12"x20"x4" pans
Electronic digital temperature control with alarms
Autodefrost
Epoxy coated, sealed evaporator eliminates potential corrosion
High efficiency evaporator coil & condenser
Factory pre-wired for dedicated outlet
CFB536 dimensions: 26" H x 36" W x 32 1/2" D
CFB548 dimensions: 26" H x 48" W x 32 1/2" D
CFB560 dimensions: 26" H x 60" W x 32 1/2" D
CFB572 dimensions: 26" H x 72" W x 32 1/2" D
Temperature range: 14°F - (-13°F)
High efficiency compressor with 7.3 running amps
Environmentally friendly R452A refrigerant

Model Details

Model	Description	Voltage/Hz	Shipping Weight
UCFB536-SS61A	36" Freezer Base	115v / 60hz	340 lb
UCFB548-SS61A	48" Freezer Base	115v / 60hz	410 lb
UCFB560-SS61A	60" Freezer Base	115v / 60hz	549 lb
UCFB572-SS61A	72" Freezer Base	115v / 60hz	653 lb



Product Specifications • Freezer Bases

Front (CFB536)

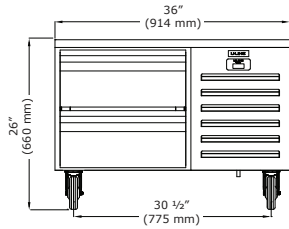

Side

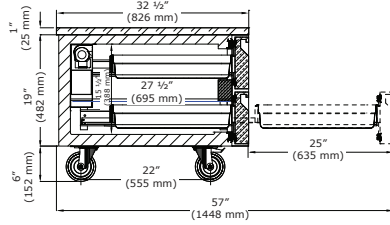

Top

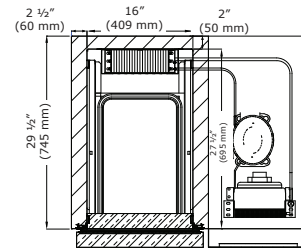

Front (CFB548)

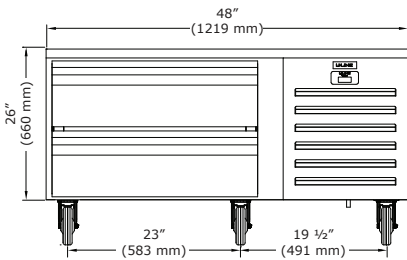

Side

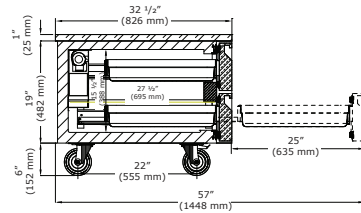

Top

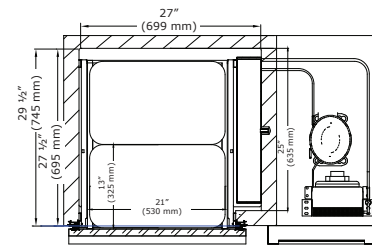

Front (CFB560)

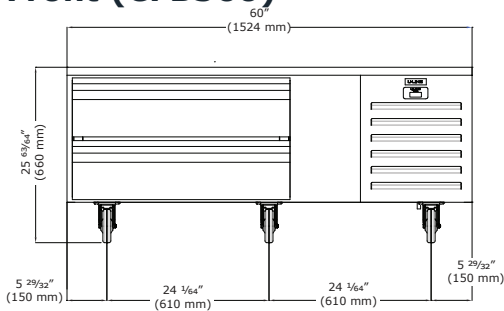

Side

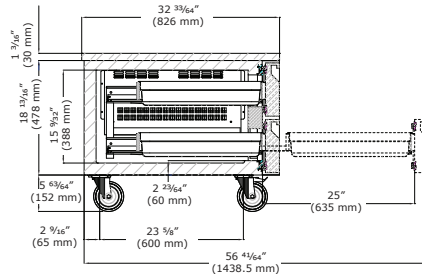

Top

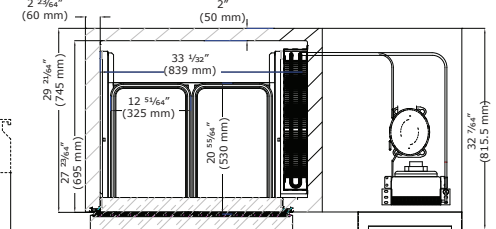

Front (CFB572)

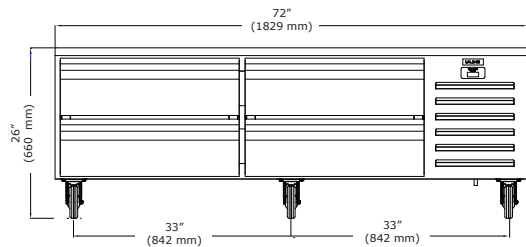

Side

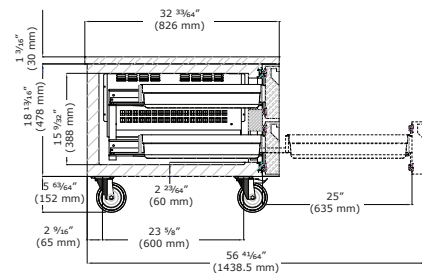

Top

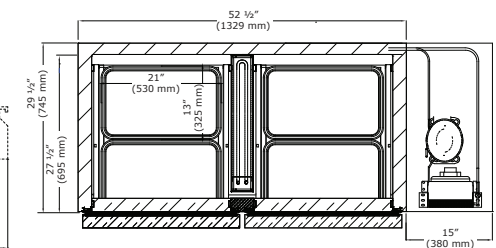

Commercial Warranty

1 Year (parts & labor) / 5 year sealed system (parts)
See complete warranty for details



CBF432: 5 Tray Blast Freezer/Chiller
 CBF532: 10 Tray Blast Freezer/Chiller
 CBF632: 15 Tray Blast Freezer/Chiller



Designed in partnership with industry-leading Italian commercial manufacturer, Desmon.



CBF432



CBF532



CBF632

Project:
Notes:

Features and Specifications

Stainless steel	
CBF432 capacity: 5 trays (2.58 sq ft shelf area)	
CBF532 capacity: 10 trays (2.58 sq ft shelf area)	
CBF632 capacity: 15 trays (2.58 sq ft shelf area)	
Probe	
CBF432 output chilling (194°F to 37.4°F in 90 min): 44.09 lb	CBF432 output freezing (194°F to -.4°F in 270 min): 26.46 lb
CBF532 output chilling (194°F to 37.4°F in 90 min): 77.16 lb	CBF532 output freezing (194°F to -.4°F in 270 min): 55.11 lb
CBF632 output chilling (194°F to 37.4°F in 90 min): 143.3 lb	CBF632 output freezing (194°F to -.4°F in 270 min): 110.23 lb
Touch screen temperature control with alarms	
Autodefrost	
Epoxy coated, sealed evaporator eliminates potential corrosion	
Factory pre-wired dedicated outlet, plug not included	
CBF432 dimensions: 33 15/32" H x 31 1/2" W x 31 11/16" D	
CBF532 dimensions: 64 11/32" H x 31 1/2" W x 32 7/8" D	
CBF632 dimensions: 77 5/16" H x 31 1/2" W x 32 7/8" D	
Temperature range: -40°F - 3°F	
High efficiency compressor	
Environmentally friendly R452A refrigerant	

Model Details

Model	Description	Voltage/Hz/Phase/Amps	Shipping Weight
UCBF432-SS11A	5 Tray Blast Freezer/Chiller, Right Hand Hinge	115v / 60 hz / 1 / 11	287 lb
UCBF532-SS12A	10 Tray Blast Freezer/Chiller, Right Hand Hinge	230v / 60 hz / 3 / 10	463 lb
UCBF632-SS12A	15 Tray Blast Freezer/Chiller, Right Hand Hinge	230v / 60 hz / 3 / 16	541 lb



Product Specifications • Blast Freezers/Chillers

Front (CBF432) Interior

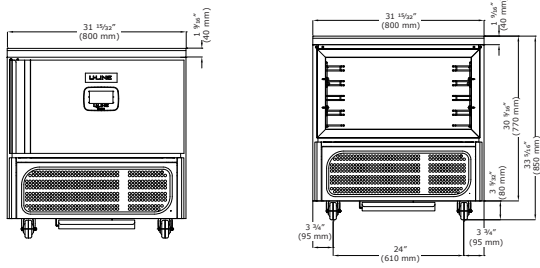

Side

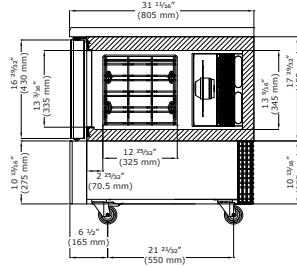

Top

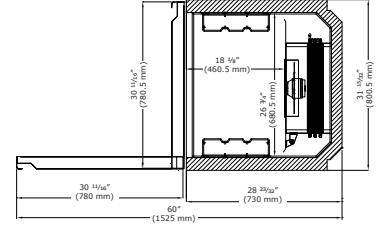

Front (CBF532) Interior

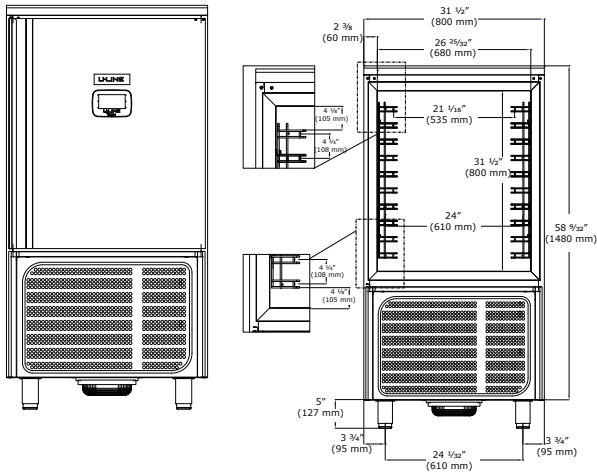

Side

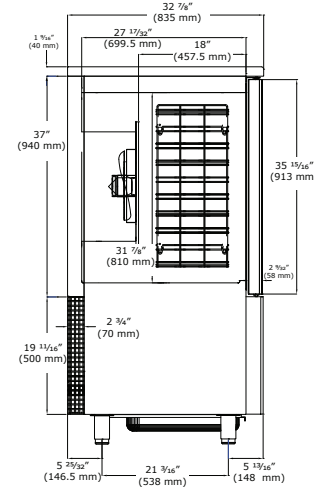

Top

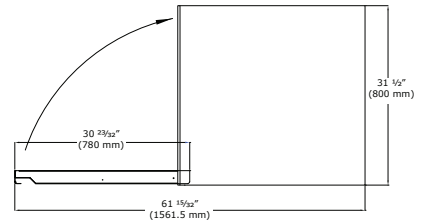

Front (CBF632) Interior

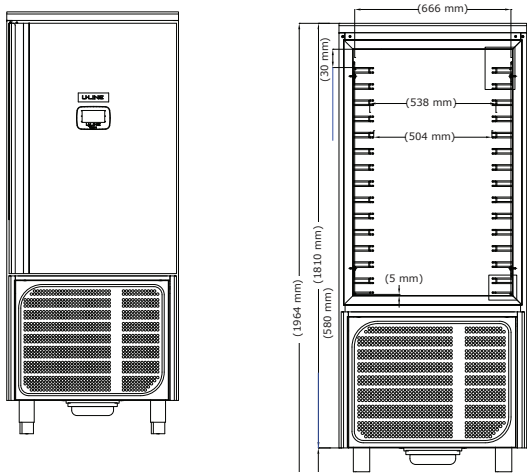

Side

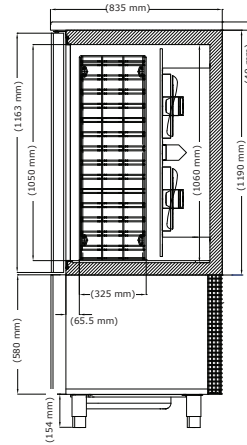

Top

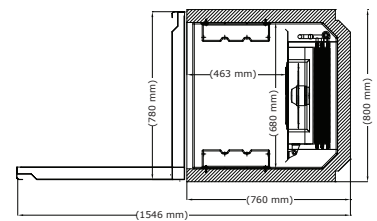

Commercial Warranty

1 Year (parts & labor) / 5 year sealed system (parts)
See complete warranty for details



CBF559: 20 Tray Blast Freezer/Chiller



Designed in partnership with industry-leading Italian commercial manufacturer, Desmon.



CBF559

(Cold Room)

Project:
Notes:

Features and Specifications

Stainless steel
CBF559 Capacity: 20 trays (3.445 sq ft shelf area)
Heated core probe, UV sterilizer, thawing function
CBF559 output chilling (194°F to 37.4°F in 90 min): 440.93 lb
CBF559 output freezing (194°F to -.4°F in 270 min): 385.81 lb
Touch screen temperature control with alarms
Autodefrost
Epoxy coated, sealed evaporator eliminates potential corrosion
Factory pre-wired for dedicated outlet, plug not included
Cold Room Dimensions: 88 7/8" H x 59 1/16" W x 52 11/16" D
Remote Condenser Dimensions: 55 1/8" H x 94 1/2" W x 55 29/32" D
Temperature range: -40°F - 3°F
Environmentally friendly R452A refrigerant
Remote condensing unit included
Cold room cord and plug not included
Remote condenser factory pre-wired for dedicated circuit, plug not included

Model Details

Model	Description	Voltage/Hz/Phase/Amps	Shipping Weight
UCBF559-SS12A	20 Tray Blast Freezer/Chiller, Right Hand Hinge (Cold Room)	230 / 60 / 1 / 4	1,478 lbs
	Remote Condenser	230 / 60 / 3 / 15	



Product Specifications • Blast Freezer/Chiller

Front (CBF559)

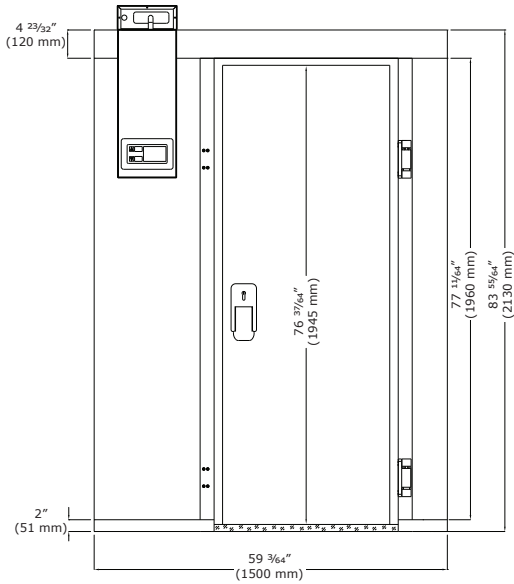

Top

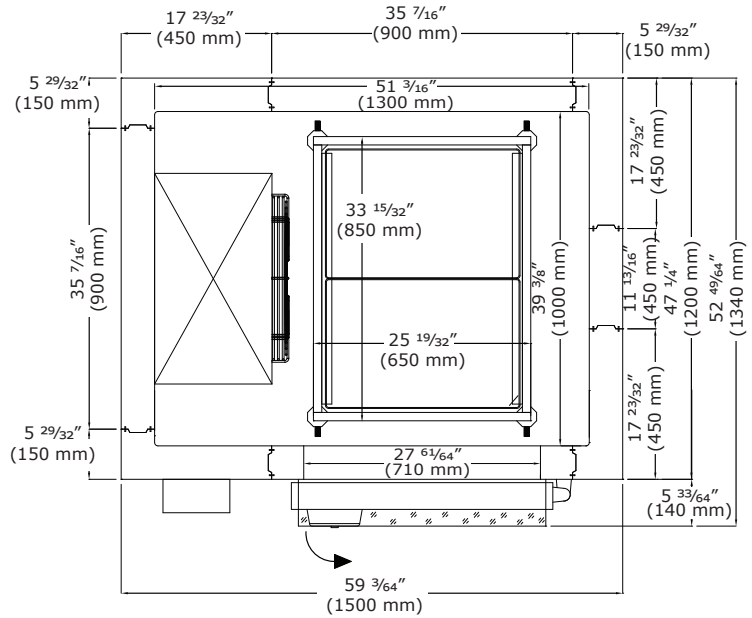

Interior

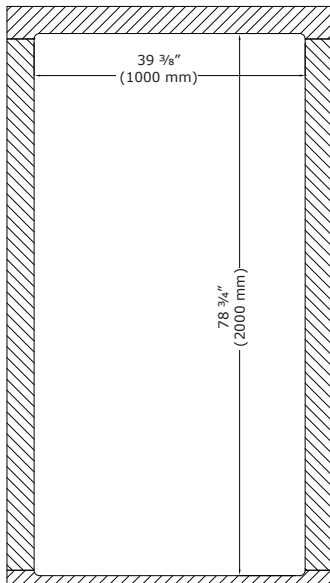

Commercial Warranty

1 Year (parts & labor) / 5 year sealed system (parts)
See complete warranty for details



Pizza Prep-Table Refrigerators

CPP466: 2 Door Pizza Prep-Table Refrigerator

CPP488: 3 Door Pizza Prep-Table Refrigerator



Designed in partnership with industry-leading Italian commercial manufacturer, Desmon.



CPP466



CPP488

Project:
Notes:

Features and Specifications

Stainless steel	
CPP466: volume of 14 cu ft	
CPP488: volume of 21.89 cu ft	
Electronic digital temperature control with alarms	
Autodefrost	
Epoxy coated, sealed evaporator eliminates potential corrosion	
High efficiency evaporator coil & condenser	
Factory pre-wired for dedicated outlet	
CPP466 includes 2 epoxy coated wire shelves	CPP488 includes 3 epoxy coated wire shelves
CPP466 Dimensions: 40 5/16" H x 65 1/8" W x 31 15/32" D	CPP488 Dimensions: 40 5/16" H x 88 3/8" W x 31 15/32" D
Temperature range: 28°F - 46°F	
High efficiency compressor with 5 running amps	
Environmentally friendly R290 refrigerant	

Model Details

Model	Description	Voltage/Hz	Shipping Weight
UCPP466-SS61A	2 Door Pizza Prep-Table Refrigerator	115v / 60hz	662 lb
UCPP488-SS61A	3 Door Pizza Prep-Table Refrigerator	115v / 60hz	882 lb

Accessories

Model	Description	Shipping Weight
ULA4082514	Shelf Guide	.88 lb
ULAQ32-4666-ETL	Epoxy Coated Wire Shelf	2.2 lb
ULAGN-1315-T	Stainless GN 1/3 Pan (6.93" x 12.79" x 5.9")	1.67 lb
ULAGNC-13	Stainless GN 1/3 Pan Top (6.93" x 12.79")	.77 lb
ULAGN-1615	Stainless GN 1/6 Pan (6.93" x 6.37" x 5.9")	.88 lb
ULAGNC-16	Stainless GN 1/6 Pan Top (6.93" x 6.37")	.77 lb
ULAGN-2815	Stainless GN 2/8 Pan (UCPP466 Only) (5.19" x 12.79" x 5.9")	1.3 lb
ULAGNC-28	Stainless GN 2/8 Pan top (UCPP466 Only) (5.19" x 12.79")	.77 lb



Product Specifications • Pizza Prep-Table Refrigerators

Front (2 Door)

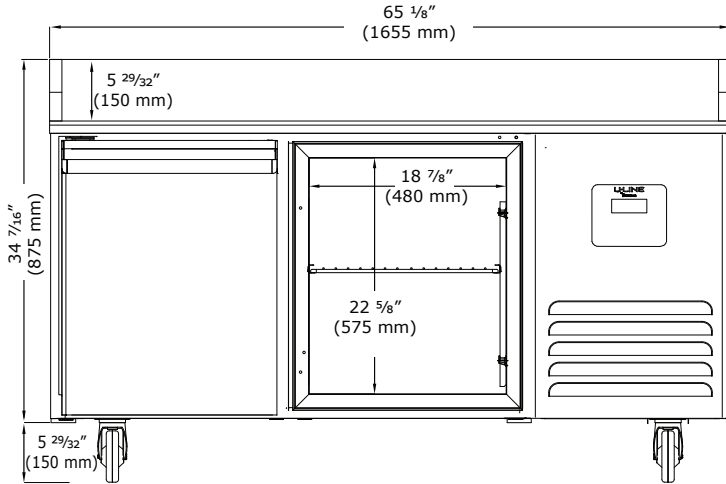

Side

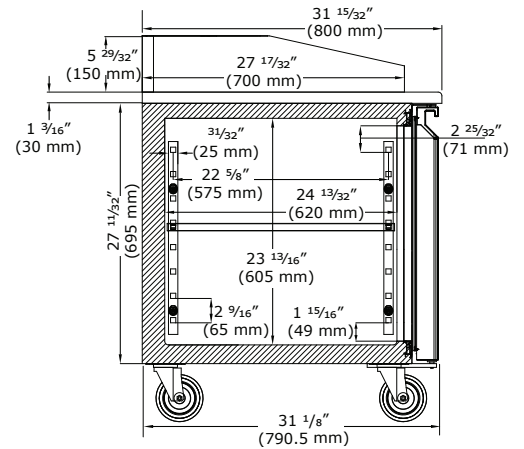

Front (3 Door)

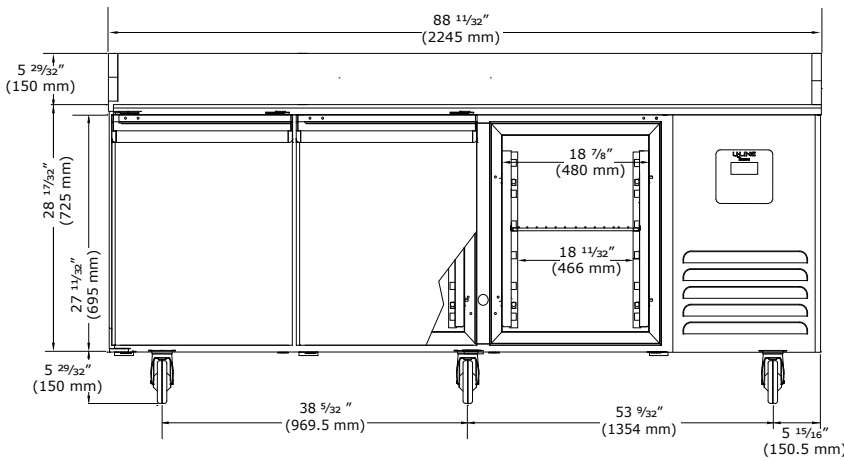

Top

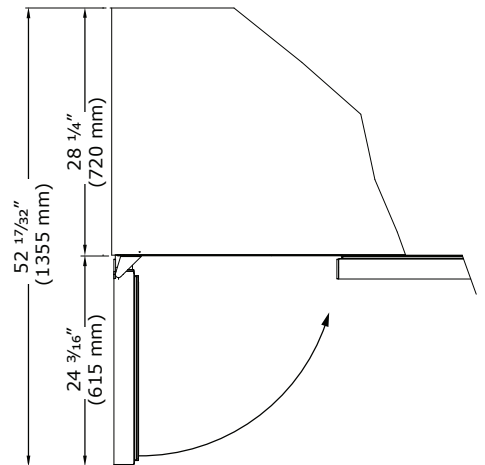

Commercial Warranty

1 Year (parts & labor) / 5 year sealed system (parts)
See complete warranty for details



Pizza Prep-Table Refrigerators

CPP566: 2 Door Pizza Prep-Table Refrigerator
+ Condiment Rail

CPP588: 3 Door Pizza Prep-Table Refrigerator
+ Condiment Rail



Designed in partnership with industry-leading Italian commercial manufacturer, Desmon.



CPP566



CPP588

Project:
Notes:

Features and Specifications

Stainless steel	
CPP566: volume of 14 cu ft	
CPP588: volume of 21.89 cu ft	
Electronic digital temperature control with alarms	
Autodefrost	
Epoxy coated, sealed evaporator eliminates potential corrosion	
High efficiency evaporator coil & condenser	
Factory pre-wired for dedicated outlet	
CPP566 includes 4 epoxy coated wire shelves	CPP588 includes 6 epoxy coated wire shelves
CPP566 dimensions: 63 15/16" H x 65 1/8" W x 31 1/8" D	CPP588 dimensions: 63 15/16" H x 88 11/32" W x 31 1/8" D
Temperature range: 28°F - 46°F	
High efficiency compressor with 6.5 running amps	
Environmentally friendly R290 refrigerant	

Model Details

Model	Description	Voltage/Hz	Shipping Weight
UCPP566-SS61A	2 Door Pizza Prep-Table Refrigerator + Condiment Rail	115v / 60hz	772 lb
UCPP588-SS61A	3 Door Pizza Prep-Table Refrigerator + Condiment Rail	115v / 60hz	992 lb

Accessories

Model	Description	Shipping Weight
ULA4082514	Shelf Guide	.88 lb
ULAQ32-4666-ETL	Epoxy Coated Wire Shelf	2.2 lb
ULAGN-1315-T	Stainless GN 1/3 Pan (6.93" x 12.79" x 5.9")	1.67 lb
ULAGNC-13	Stainless GN 1/3 Pan Top (6.93" x 12.79")	.77 lb
ULAGN-2815	Stainless GN 2/8 Pan (UCPP566 Only) (5.19" x 12.79" x 5.9")	1.3 lb
ULAGNC-28	Stainless GN 2/8 Pan top (UCPP566 Only) (5.19" x 12.79")	.77 lb
ULAGN-1615	Stainless GN 1/6 Pan (UCPP566 Only) (6.93" x 6.38" x 5.9")	.88 lb
ULAGNC-16	Stainless GN 1/6 Pan top (UCPP566 Only) (6.93" x 6.38")	.77 lb



Front (2 Door with Condiment Rail)

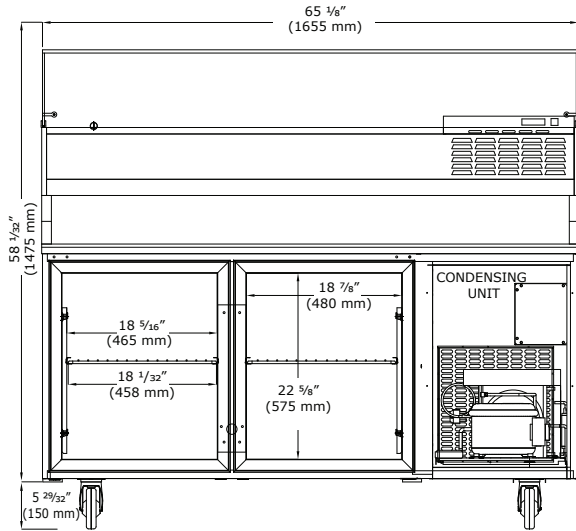

Side

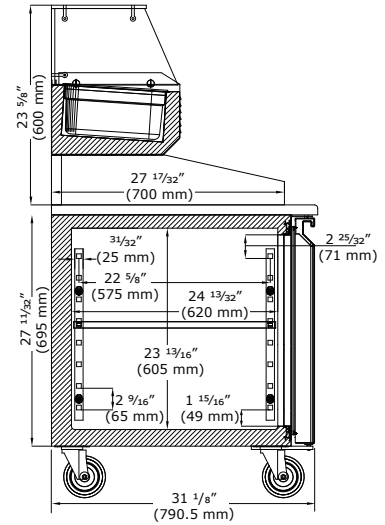

Front (3 Door with Condiment Rail)

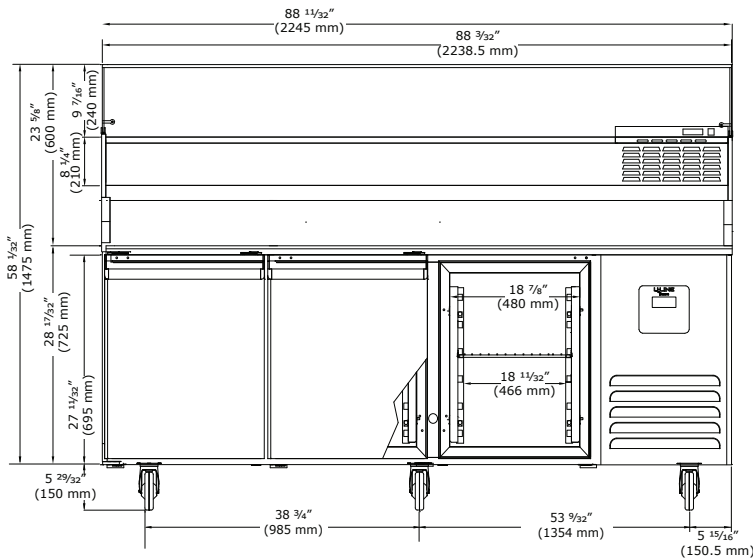

Top

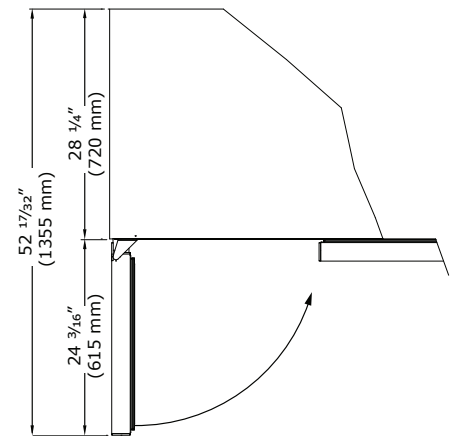

Commercial Warranty

1 Year (parts & labor) / 5 year sealed system (parts)
See complete warranty for details



CPT565: 2 Door Prep-Table Refrigerator
CPT588: 3 Door Prep-Table Refrigerator



Designed in partnership with industry-leading Italian commercial manufacturer, Desmon.



CPT565



CPT588

Project:

Notes:

Features and Specifications

Stainless steel	
CPT565: volume of 14.95 cu ft	
CPT588: volume of 21.89 cu ft	
Electronic digital temperature control with alarms	
Autodefrost	
Epoxy coated, sealed evaporator eliminates potential corrosion	
High efficiency evaporator coil & condenser	
Factory pre-wired for dedicated outlet	
CPT565 includes 4 epoxy coated wire shelves	CPT588 includes 6 epoxy coated wire shelves
CPT565 dimensions: 63 11/16" H x 65 5/16" W x 36 5/8" D	CPT588 dimensions: 63 11/16" H x 88 5/16" W x 36 5/8" D
Temperature range: 28°F - 46°F	
CPT565: high efficiency compressor with 7 running amps	
CPT588: high efficiency compressor with 9 running amps	
Environmentally friendly R290 refrigerant	

Model Details

Model	Description	Voltage/Hz	Shipping Weight
UCPT565-SS61A	2 Door Prep-Table Refrigerator	115v / 60hz	653 lb
UCPT588-SS61A	3 Door Prep-Table Refrigerator	115v / 60hz	741 lb

Accessories

Model	Description	Shipping Weight
ULA4082514	Shelf Guide	.88 lb
ULAQ32-4666-ETL	Epoxy Coated Wire Shelf	2.2 lb
ULAGN-1315-T	Stainless GN 1/3 Pan (6.93" x 12.79" x 5.9")	1.67 lb
ULAGNC-13	Stainless GN 1/3 Pan Top (6.93" x 12.79")	.77 lb
ULAGN-2815	Stainless GN 2/8 Pan (UCPT565 Only) (5.19" x 12.79" x 5.9")	1.3 lb
ULAGNC-28	Stainless GN 2/8 Pan top (UCPT565 Only) (5.19" x 12.79")	.77 lb



Product Specifications • Prep-Table Refrigerators

Front (2 Door)

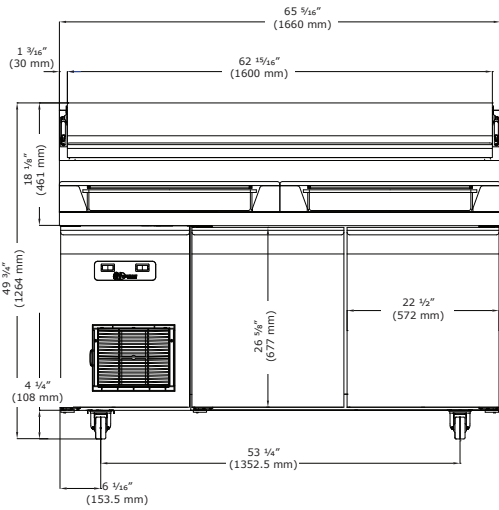

Front (3 Door)

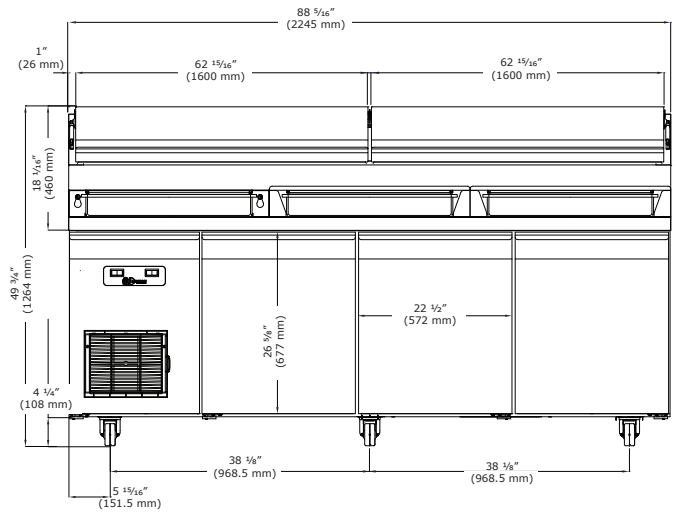

Side

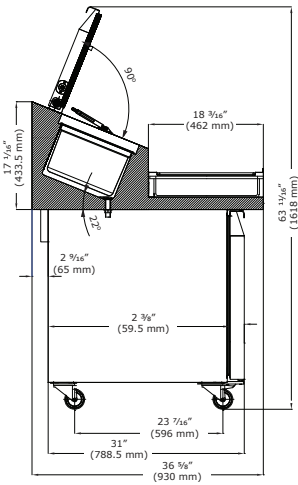

Top (2 Door)

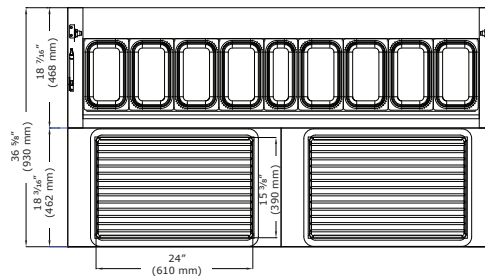

Top (3 Door)

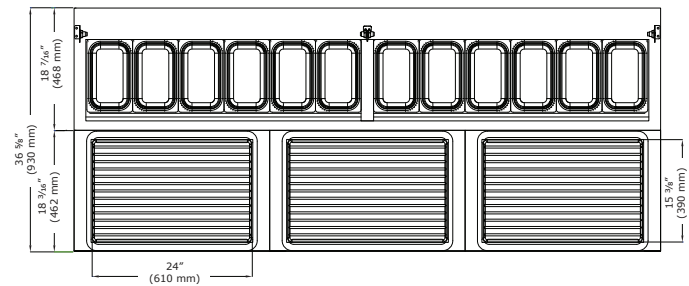

Commercial Warranty

1 Year (parts & labor) / 5 year sealed system (parts)
See complete warranty for details



Cool to the Last Drop

U-Chill® is an in-counter cooling cylinder that maintains the temperature of chilled beverages while they are being enjoyed. Perfect for wine, champagne, craft beer, carafes, bottled water, spirits, and other beverages.

This truly unique product integrates into any surface and incorporates into almost any setting - from bars to tables, spas to suites. U-Chill® is maintenance free, easy to clean, and nearly silent in operation. With 27 different color lighting options to gently light the bottle, this interactive, beautiful, and functional piece creates a one of a kind experience for your guests.





Product Specifications

UCC1A • U-Chill®

Smart-Touch Crown

- Control with just a touch
- Hand-polished marine-grade stainless steel (316L)
- Powers off automatically after 4 hours

Interactive LED Lighting

- 27 different color options
- Optional color-flow setting

Simple Installation

- Installs in 6 1/16" diameter opening in countertops from 1/16" to 2 1/2" thick
- Plugs into standard 115v/60Hz outlet
- AC/DC adapter included
- Width: 6 5/16"
- Height: 11 13/16"

Patented Kryolux™ Technology*

- Dry cooling
- Cold jacket of air surrounds your beverage
- Optimal ambient temp. range: 50°F - 90°F
- Energy efficient
- Near-silent operation



Surface Cutout

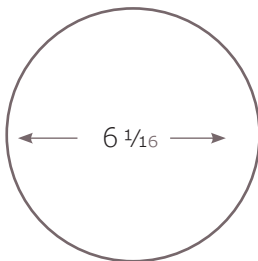

Use 6" hole saw

Minimum Space Below Crown

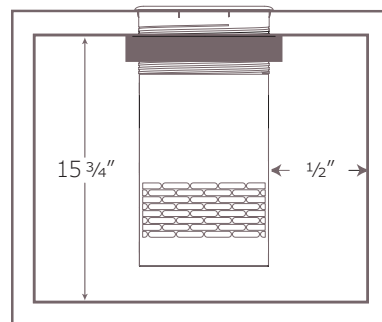

Craftsmanship Handmade in England

U-Line backs each U-Chill® with a 2 year warranty

Model Details

Model	Description	Finish	Shipping Weight
UCC1A	U-Chill® In-Counter Cooling Cylinder	Stainless	7 lb

*Kryolux™ is a registered trademark of Kaelo LTD.



CUSTOMER CARE

Our Customer Care group is equipped with the knowledge and skills to find a solution for you, and fast. Our facility is equipped to handle any service request. With live products readily available for diagnostics, our Customer Care group can walk you through a solution while doing it themselves on the same model. Our efficient call center management system ensures minimal wait time for consumers. We believe product support should be quick, simple, and frustration-free.

INQUIRIES

Monday - Friday 8:00 am to 4:30 pm CST
8900 North 55th Street
Milwaukee, Wisconsin 53223 USA
T: +1.414.354.0300
Inquiries: commercial@u-line.com
Customer Care: customercare@u-line.com
u-line.com/commercial

