

# Quickstart Manual



## Introduction 1.0

Welcome to the Symphonic Quickstart Guide. This shortened guide is supplementary to the main manual which should be referred to for full safety and operational information.

Please note, more information on any of these topics is listed within the full manual found under the product page:

[chordelectronics.co.uk/product/symphonic](http://chordelectronics.co.uk/product/symphonic)

## Warranty 1.1

The Symphonic comes with a comprehensive 5-year warranty. To activate this warranty, please register your device via the Chord Electronics website:

[chordelectronics.co.uk/register-product](http://chordelectronics.co.uk/register-product)



## Connecting your source to Symphonic 2.0

In order to use the Symphonic, you must connect your source to any input of the device. There is 2 balanced XLR inputs and 2 unbalanced RCA inputs for connecting your turntable to Symphonic.

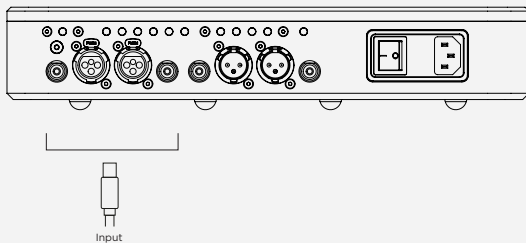

## Connecting a pre-amplifier to Symphonic 3.0

Once your vinyl player is connected to Symphonic, you then need to connect Symphonic to your pre-amplifier. This can be done by using either the balanced XLRs or the unbalanced RCA outputs.

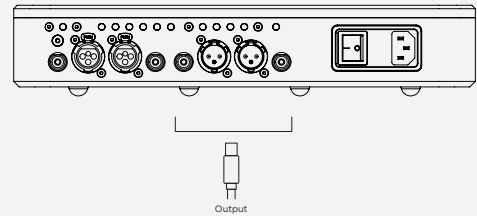

## Connecting the power to Symphonic 4.0

Connect the supplied mains IEC cable to the input of Symphonic. Once connected to the Symphonic, it may start automatically. Please make sure none of your other devices are switched on at this point.

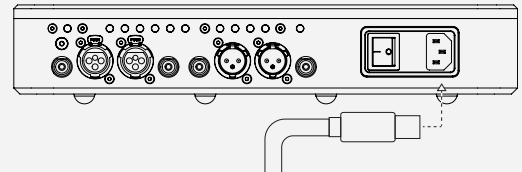

## Switch on the Symphonic 5.0

Once all inputs are connected you should not yet initiate playback. Turn on the Symphonic by pressing the power button on the rear panel, the device will run its start-up sequence before it is ready to be used.

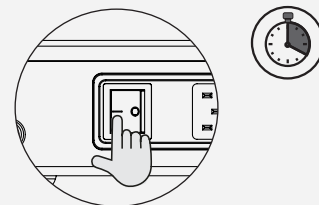

# Quickstart Manual



## Selecting correct gain

6.0

Once you have your system all set up, for optimum performance you must match the gain from your turntable to the Symphonic. To do so ensure you have the correct measurement from your turntable device manual, then using the image below select the correct gain setting. To add a particular input gain into the signal path, press the appropriate switch in. To remove a selected input gain, simply press the switch again to release.

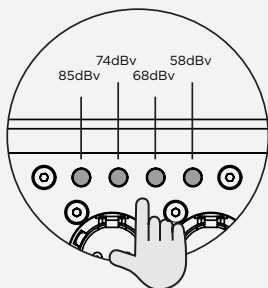

## Selecting correct impedance

7.0

There are six selector switches to the left of the input gain switches that are used to set up the required input impedance on the Symphonic. Without using any additional impedance the Symphonic features 50pF input impedance when using unbalanced inputs. If you are using balanced inputs then all impedance values are doubled. Using the image below select the correct impedance setting, press the appropriate switch in. To remove a selected input impedance, simply press the switch again to release.

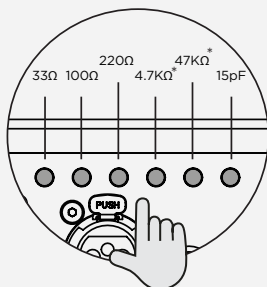

\* 47KΩ refers to 47000 ohms and 4.7KΩ refers to 4700 ohms

## Selecting input

9.0

The selector switch that is situated furthest left is the balanced/unbalanced input selector switch. If you wish to use balanced input connections press this switch in. If you are using unbalanced input connections that this switch should be out. Once selected you are ready for playback.

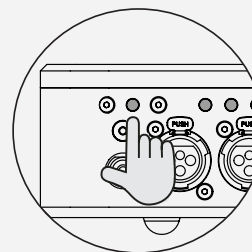

## LED windows

8.0

On the top panel of the Symphonic, there are two viewing portals. Through these are LEDs that illuminate to show the current settings that are selected on the Symphonic. For each setting that you make on the selector switches on the back of the Symphonic, a pair of coloured LEDs will light on the boards through the viewing portals. Each pair represent the left and right channels of each selection.

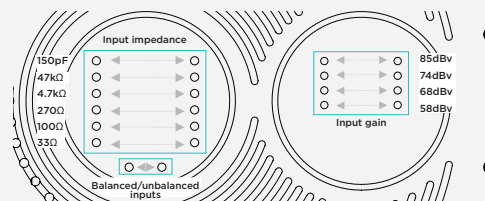

## Product registration

10.0

Now that you have successfully completed the setup of your Symphonic you can immediately begin to experience its transformational quality on your digital music collection. However, we advise that you register your product with us. Registering helps us give you the best possible support and protects your investment:

[chordelectronics.co.uk/register-product/](http://chordelectronics.co.uk/register-product/)