

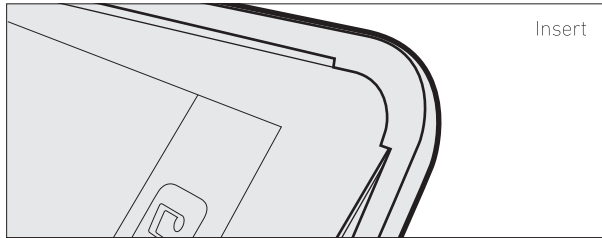

To start using your Crux® Monaco please visit:
bodyguardz.com/crux/start

Inserting and Removing the iPad®

The Crux Monaco has clips on both the top and bottom that hold the iPad in place. Follow the instructions below for inserting and removing the iPad. Also, you may refer to the videos at bodyguardz.com/crux/start for more information on inserting and removing the iPad.



Inserting the iPad

Begin by placing the top side of the iPad UNDER the two corner clips on either side at the top of the Crux Monaco. Then gently push the bottom side of the iPad to engage under the clips on either corner at the bottom of the Crux Monaco.

Removing the iPad

to remove the iPad please refer to the instructional videos at: bodyguardz.com/crux/start

Turning Crux® Monaco ON & OFF

To turn the Crux Monaco ON simply press down the power button until the light glows BLUE. To turn OFF the Crux Monaco simply press down the power button until the BLUE light starts to blink.

Crux Monaco Buttons and Port

The illustration below shows the Crux Monaco's various buttons, lights, and USB port. Please refer to the next section for instructions on how to turn ON and Pair the Crux Monaco to the iPad®.

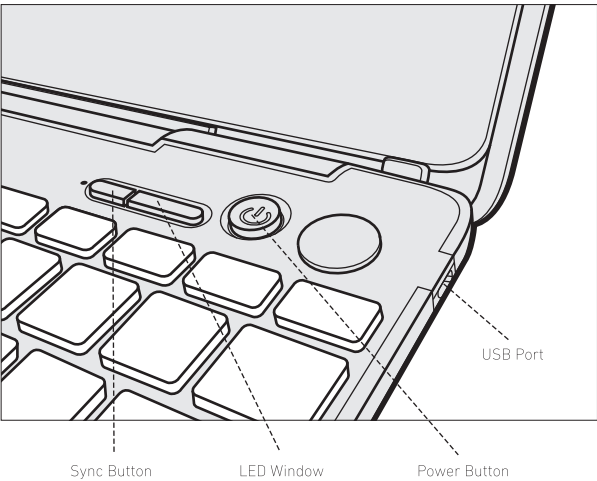

Special Keys

Below is the list of The Crux® Monaco's keyboard special keys and functions.

	home	<i>Return the iPad's screen to the home screen</i>
	keyboard	<i>Display and hide the iPad's keyboard</i>
	search	<i>Display and hide the search screen</i>
	less bright	<i>Decrease brightness of iPad® Screen</i>
	more bright	<i>Increase brightness of iPad® Screen</i>
	language	<i>Change the language on the iPad</i>
	copy	<i>Copy selected text from the screen to the clipboard</i>
	paste	<i>Paste text from the clipboard to the screen</i>
	last track	<i>Go to last song or video</i>
	play/pause	<i>Play or pause current song or video</i>
	next track	<i>Go to next song or video</i>
	mute	<i>Mute the speaker volume</i>
	volume down	<i>Lower volume of speaker</i>
	volume up	<i>Increase volume of speaker</i>
	lock	<i>Lock the iPad</i>

BODYGUARDZ
bodyguardz.com



Crux Monaco is a trademark of NLU Products, LLC. ©2015 All rights reserved 2015. Designed in USA. Made in China. Apple and iPad are registered trademarks of Apple Inc. Bluetooth is a registered trademark of Bluetooth SIG Inc.

PATENTED

Warning: Changes or modifications to this unit not expressly approved by the party responsible for compliance could void the user's authority to operate the equipment. **Note:** This equipment has been tested and found to comply with the limits for a Class B digital device, pursuant to Part 15 of the FCC Rules. These limits are designed to provide reasonable protection against harmful interference in a residential installation. This equipment generates, uses and can radiate radio frequency energy and, if not installed and used in accordance with the instructions, may cause harmful interference to radio communications. However, there is no guarantee that interference will not occur in a particular installation. If this equipment does cause harmful interference to radio or television reception, which can be determined by turning the equipment off and on, the user is encouraged to try to correct the interference by one or more of the following measures:

- Reorient or relocate the receiving antenna.
- Increase the separation between the equipment and receiver.
- Connect the equipment into an outlet on a circuit different from that to which the receiver is connected.
- Consult the dealer or an experienced radio/TV technician for help.

The device has been evaluated to meet general RF exposure requirement. The device can be used in portable exposure condition without restriction.

Pairing iPad® and Crux® Monaco

- A** 1) On your iPad, tap Settings > Bluetooth® and make sure the iPad's Bluetooth is ON.
- 2) On the Crux Monaco keyboard, press down the power button and the BLUE colored indicator light will glow solid.
- 3) On the Crux Monaco keyboard, press down the Bluetooth button and the BLUE-colored indicator light will start to blink. The Crux Monaco is now ready to be paired with the iPad.
- B** 4) "CRUX" will appear on the iPad's screen. Tap "CRUX" to select the device.
- C** 5) The iPad screen will display a passkey. Enter that passkey on the Crux Monaco keyboard and press enter.
- D** 6) Your iPad is now connected to the Crux Monaco.

Once the Crux Monaco is paired with your iPad, It will remain paired even if your Crux Monaco is turned off.

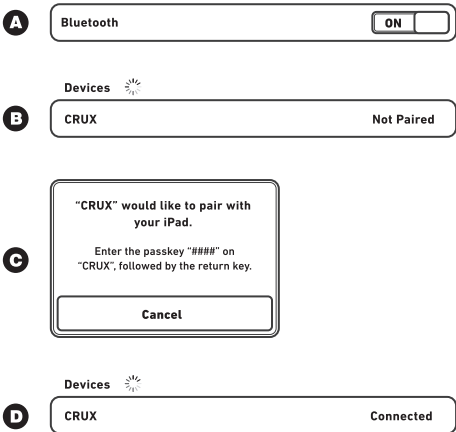

Troubleshooting

If you are having trouble pairing the Crux® Monaco to the iPad®, try the following solutions:

- 1) Ensure that the battery on both the iPad and the Crux Monaco are fully charged.**
- 2) Ensure that the Bluetooth® on the iPad is set up correctly.**
- 3) Disconnect all other Bluetooth devices from the iPad and then attempt to reconnect to the Crux Monaco.**
- 4) Reset the iPad by holding down the "Home" and "Lock" buttons for 3 seconds.**
- 5) Make sure your iPad is running the latest version of Apple's IOS.**
- 6) If none of these solutions corrects the problem then email BodyGuardz® support at: support@bodyguardz.com**

Charging Battery

To charge the Crux Monaco plug the Micro-USB cord into its port and then plug the other end into either your laptop or the iPad's charger. A RED-colored indicator light will glow while the Crux Monaco's battery is being charged. When the battery is fully charged the RED-indicator light will turn off. Use care when connecting and disconnecting the cord to the micro-USB connector. When the Crux Monaco's battery is low, a BLUE-indicator light will start to blink.

Requirements

Operate in temperatures between 32° F and 95° F (0° C to 35° C). Do not operate in non-condensing humidity levels above 95%. Maximum non-pressurized operating altitude is 10,000 ft (3000 m).

Power Save / Deactivate Keyboard

If the Crux Monaco keyboard is idle for more than 2 minutes, it will go into "Power Save" mode. This feature helps to extend the life of the battery between charges. Power save mode will automatically turn off as you once again begin typing on the keyboard. To deactivate the keyboard, simply turn the power off. To reactivate the keyboard, simply turn the power back on.