

Safety Information..... 2  
 Warranty..... 2  
 Single Bulb Pairing Instructions..... 3  
 Two Bulb Pairing Instructions..... 3  
 Remote Operation.....4  
 Battery Replacement.....4  
 Resetting Bulb to Color Light Cycling.....4

1. Power on the bulb. The bulb will sound a chime when available to pair.
2. Using a compatible Bluetooth device, search for the bulb "Speaker Bulb".
3. Connect, wait for the chime that signifies successful pairing, and play music.

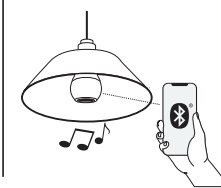
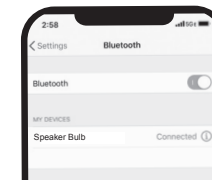

# USE AND CARE GUIDE

## Color Changing Bluetooth Speaker Bulb

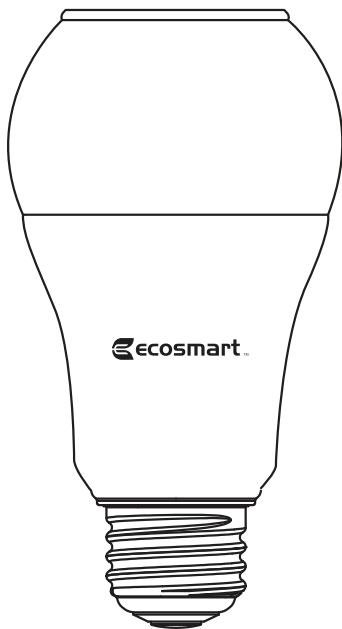

### Safety Information



**CAUTION:** This device is not intended for use with emergency exits. Only use the control provided with or specified by these instructions to control this lamp. This lamp will not operate properly when connected to a standard dimmer or dimming control.



**WARNING:** KEEP BATTERIES OUT OF THE REACH OF CHILDREN! BATTERIES ARE NOT A TOY! If swallowed, they can cause severe injury or death within 2 hours. In case of swallowing, call emergency services immediately. Tell others of the risks associated with button batteries to keep kids safe.



**CAUTION:** The remote control included utilizes a 3V CR2032 battery; Do not dispose of batteries in fire as they may explode or leak. Please dispose of used batteries immediately and safely. Only replace with the same battery type. Examine devices and make sure the battery compartment is correctly secured, e.g. that the screw or other mechanical fastener is tightened. Do not use if compartment is not secure.

### FCC Regulation

This device complies with part 15 of the FCC Rules. Operation is subject to the following two conditions: (1) this device may not cause harmful interference, and (2) this device must accept any interference received, including interference that may cause undesired operation. Changes or modifications not expressly approved by the party responsible for compliance could void the user's authority to operate the equipment.

**NOTE:** This equipment has been tested and found to comply with the limits for a Class B digital device, pursuant to Part 15 of the FCC Rules. These limits are designed to provide reasonable protection against harmful interference in a residential installation. This equipment generates, uses and can radiate radio frequency energy and, if not installed and used in accordance with the instructions, may cause harmful interference to radio communications. However, there is no guarantee that interference will not occur in a particular installation. If this equipment does cause harmful interference to radio or television reception, which can be determined by turning the equipment off and on, the user is encouraged to try to correct the interference by one or more of the following measures:

- Reorient or relocate the receiving antenna.
- Increase the separation between the equipment and receiver.
- Connect the equipment into an outlet on a circuit different from that to which the receiver is connected.
- Consult the dealer or an experienced radio/TV technician for help.

This device complies with FCC radiation exposure limits set forth for an uncontrolled controlled environment. This device should be installed and operated with a minimum distance of 20cm between the radiator and your body.

### Warranty

#### FIVE-YEAR LIMITED WARRANTY

Limited Warranty: Guaranteed to last 5 years based on 3 hours use per day, 7 days per week. If this bulb does not last 5 years after date of purchase (based on 3 hours per day / 7 days per week) due to a defect in materials or workmanship, please bring the defective bulb and a receipt indicating proof of purchase to any Home Depot store. The Home Depot will provide a replacement or, at our discretion, a store credit for the value of the original purchase price. This warranty will be voided for misuse of product per the caution statement. Some states do not allow the exclusion of limitation or consequential damages, so the above exclusion may not apply to you. This warranty gives you specific legal rights and you may also have other rights that vary from state to state and province to province. Please see a store for more details.

### Two Bulb Pairing Instructions (TWS)

1. Power on two bulbs at the same time. Both bulbs will sound a chime when available to pair.
2. Wait until the bulbs automatically connect to each other. One will become the primary and the other will become the secondary. The secondary bulb will sound a chime once complete, indicating that it is successfully connected to the primary bulb.

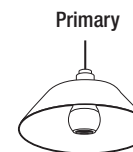
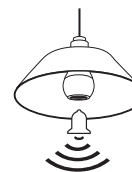

### Two Bulb Pairing Instructions (TWS) (continued)

3. Using a compatible Bluetooth device, search for the primary bulb "Speaker Bulb".
4. Connect to the primary bulb, wait for the chime that signifies successful pairing, and play music.

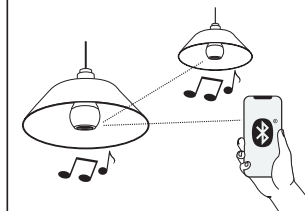
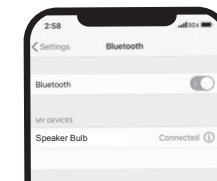

**NOTE:** The default name is "SpeakerBulb", this name can be changed according to preferred location.

Questions, problems, missing parts? Before returning to the store, call  
 EcoSmart Customer Service  
 8 a.m. - 7 p.m., EST, Monday - Friday, 9 a.m. - 6 p.m., EST, Saturday

1-877-910-7164  
 HOMEDEPOT.COM/EcoSmart

**THANK YOU**

We appreciate the trust and confidence you have placed in EcoSmart through the purchase of this bulb. We strive to continually create quality products designed to enhance your home. Visit us online to see our full line of products available for your home improvement needs. Thank you for choosing EcoSmart!

## Remote Operation



**NOTE:** Remove the insulating tab before operation. The remote will not operate without pulling out the insulating tab.

1. Light On/Off:  
Turns the light On or Off
2. Audio On/Off:  
Turns the audio On or Off
3. White Light Dimmer:  
Press to choose between brightness levels of white light
4. Color Light Cycling:  
Press to continuously cycle through all six colors: Red, Green, Blue, Yellow, Magenta, Cyan
5. Color Light Solid:  
Press to select one of the six color options

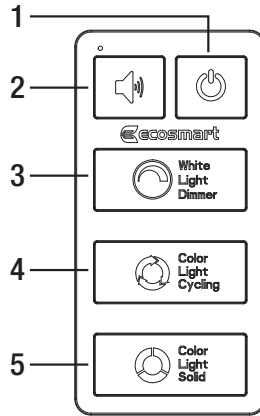

### For the Remote:

This device complies with FCC radiation exposure limits set forth for an uncontrolled environment.

# ecosmart™

## Battery Replacement

1. Use a Philips head screwdriver to unscrew the battery cover screw.
2. Use a flat head screwdriver to turn the battery cover counter-clockwise and pull to access the battery.

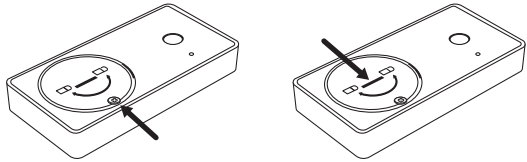

3. Replace with a CR2032 battery and close the battery cover.

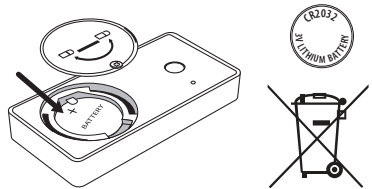

Questions, problems, missing parts? Before returning to the store, call  
EcoSmart Customer Service  
8 a.m. - 7 p.m., EST, Monday - Friday, 9 a.m. - 6 p.m., EST, Saturday

1-877-910-7164  
[HOMEDEPOT.COM/EcoSmart](http://HOMEDEPOT.COM/EcoSmart)

## Resetting Bulb to Color Light Cycling

If the remote is lost or not working properly, reset the bulb to color light cycling by flipping the wall switch three times.

