

SIRIUS ACT ID key-operated switches

Basic information

Reliable identification of personnel for greater plant security

The SIRIUS ACT ID key-operated switch is designed to ensure that only authorized persons can carry out work on plants and machinery. It is an electronic key-operated switch and has up to four switch positions.

Customer benefits/applications

- Access system for machinery and plants
- Authorization management for groups or individuals
- Identification of users
- Increased plant safety
- The use of several key-operated ID switches in a system and operation with only one key is possible while complying with personal access rights
- Different colors of the keys reduce the search for the right key; the rod-like shape of the key reduces the size of the bunch of keys

Product information

- Defined encoding of the four differently colored keys or special locks by encoding the white key
- High degree of protection IP65
- A unique RFID chip code in each key
- Restricted access rights and clear assignment of the authorizations and functions
- Saving of the authorization information not in the key but in the electronic module



Keys and functionality

- **Colored keys:**
Authorization levels are encoded at the factory
- **White key:**
Authorization level 1-4 freely programmable via IO-Link (individual special locks)
- Simple disabling when keys for special locks are lost
- Easy plant integration via TIA Portal (Port Configuration Tool)

Selection of the position by turning the key:

Selecting the authorization levels

- Turning the key to the right

Resetting the authorization level

- Shortly turning the key to the right and then immediately to the left to the upstream authorization level

Deactivating the authorization levels

- Turning the key to the left without quick turn to the right beforehand

Visual display of functions using the 1st authorization level as an example (green key)

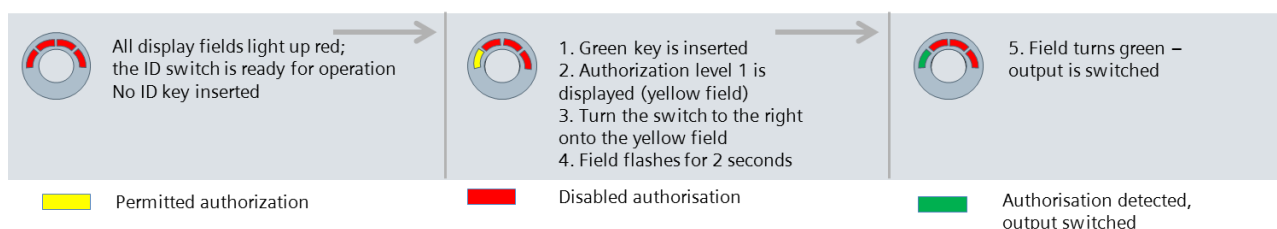

Article number overview

Product		Material	Article number
Actuator (4 switch positions, latching)		Plastic	3SU1000-4WS10-0AA0
		Plastic with metal frontring	3SU1030-4WS10-0AA0

Required accessories, please order separately

Holder		Plastic	3SU1500-0AA10-0AA0
		Metal	3SU1550-0AA10-0AA0
Electronic module for ID key-operated switch		Standard module for basic functionality, selection of authorization level	3SU1400-1GC10-1AA0
		IO link module for manipulation-proof system (identification of user)	3SU1400-1GD10-1AA0
ID keys (easy distinction of the keys due to color coding)		1st authorization level	3SU1900-0FV40-0AA0
		2nd authorization level	3SU1900-0FW30-0AA0
		3rd authorization level	3SU1900-0FX20-0AA0
		4th authorization level	3SU1900-0FY50-0AA0
		5th individually codiert	3SU1900-0FU60-0AA0