

Series 4, Built-in oven, 60 x 60 cm HBA534BB0A



Included accessories

1 x grill tray
2 x combination grid
1 x universal pan

Optional accessories

HEZ317000 : Pizza pan, grey enamelled
HEZ327000 : Pizza stone
HEZ333001 : Lid for professional pan
HEZ530000 : Half tray
HEZ531010 : Baking tray, non-stick ceramic coated
HEZ538000 : 1fold telescopic rail, level independent
HEZ538200 : 2 level telescopic shelf rails

The built-in oven with 3D hot air: achieve perfect baking and roasting results on up to three levels simultaneously.

- **Pop-out controls:** Make the front of the oven easy to clean and provide a sleek and stylish front.
- **Red LED display control:** easy-to-use thanks to the time functions.
- **Cleaning Assistance:** less cleaning effort thanks to the new cleaning option, which should be used for light cleaning.
- **EcoClean Direct:** A special coating of the rear wall that automatically absorbs cooking residue.

Technical Data

Color / Material Front : Black
Built-in / Free-standing : Built-in
Door opening : Drop down
Integrated Cleaning system : Catalytic partial, Hydrolytic
Control Panel Material : Glass
Door Material : Glass
Dimensions : 595 x 594 x 548 mm
Dimensions of the packed product (HxWxD) : 675 x 690 x 670 mm
Min. required niche size for installation (HxWxD) : 585-595 x 560-568 x 550 mm
Cavity dimensions : 357 x 480 x 415 mm
Usable volume of cavity : 71 l
Number of interior lights : 1
Net weight : 34.4 kg
Gross weight : 36.6 kg
EAN code : 4242005293322
Connection Rating : 3400 W
Fuse protection : 16 A
Voltage : 220-240 V
Frequency : 50; 60 Hz
Length electrical supply cord : 120 cm



4 242005 293322

Series 4, Built-in oven, 60 x 60 cm HBA534BB0A

The built-in oven with 3D hot air: achieve perfect baking and roasting results on up to three levels simultaneously.

Dimensions:

- Appliance dimension (HxWxD): 595 mm x 594 mm x 548 mm
- Installation dimensions (HxWxD): 585 mm - 595 mm x 560 mm - 568 mm x 550 mm

Heating Functions

- Oven with 7 PCh heating methods:
 - Full width grill
 - Hotair gentle 3D Hotair Top/Bottom heating Pizza setting
 - Bottom heating Hot-air grilling
- Temperature range 50 °C - 275 °C
- Rapid heating up
- Cavity volume: 71 l

Rails

- Number of shelf levels: 5
- Telescopic rails: telescopic rails available as optional accessory

Design

- Rotary Control Knobs, Round, Retractable rotary control knobs
- LED-display control (red)
- Extra large capacity oven with grey enamel
- Halogen lighting
- Cooling fan
- Stainless steel bar handle

Cleaning

- Eco Clean: A microfine ceramic beaded coating on the oven's interior Rear wall with EcoClean
- Cleaning Assistance - cleaning option for light residue

Convenience

- Child lock

Accessories

- grill tray, combination grid, universal pan

Safety Features

- Full glass inner door
- Maximum window temperature 40° C

Technical Information

- Length of mains cable: 120 cm
- Nominal voltage: 220 - 240 V
- Total connected load electric: 3.4 KW

Series 4, Built-in oven, 60 x 60 cm HBA534BB0A

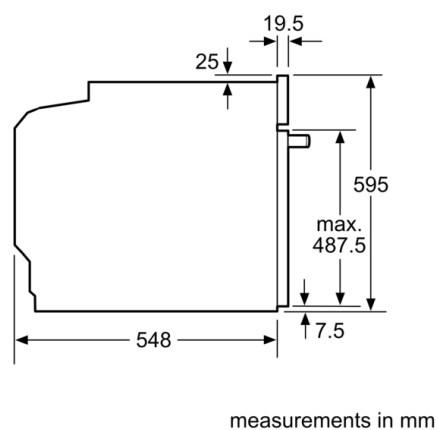
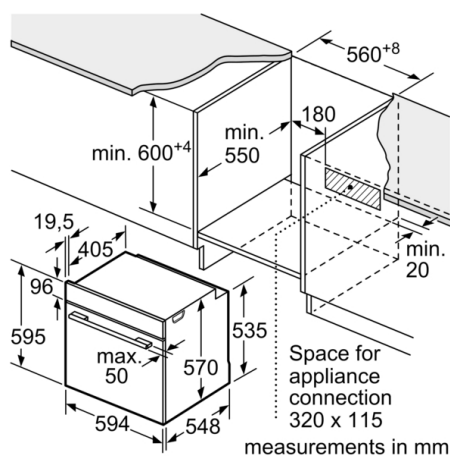

Installation with a hob.

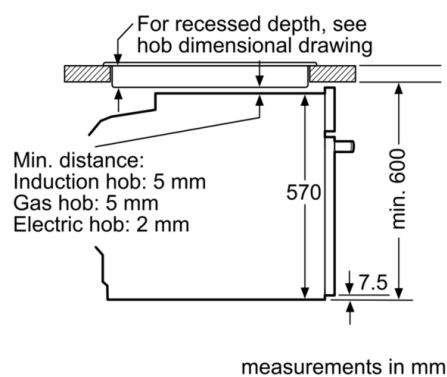

Measurements in mm

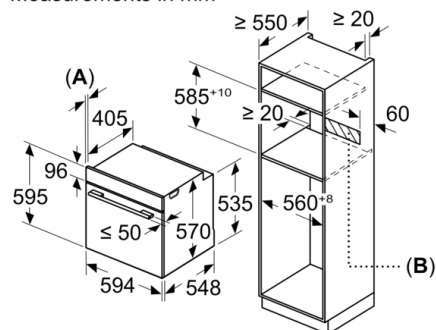

A: 19.5 mm
B: Space for appliance connection 320 x 115 mm