

Hamilton Beach®

Air Purifier

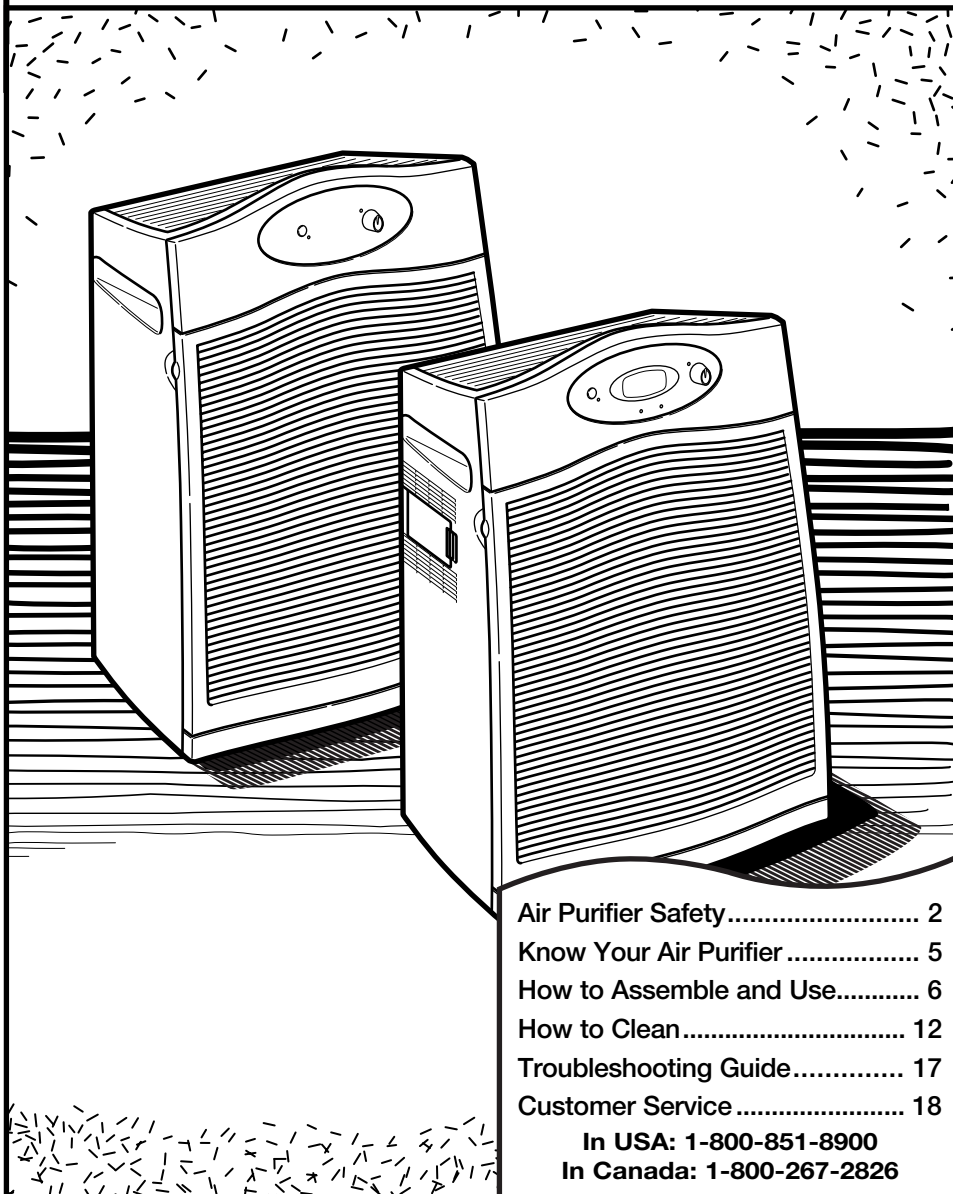

Air Purifier Safety..... 2
Know Your Air Purifier 5
How to Assemble and Use..... 6
How to Clean..... 12
Troubleshooting Guide..... 17
Customer Service 18

In USA: 1-800-851-8900
In Canada: 1-800-267-2826

840071100

Air Purifier Safety

IMPORTANT SAFEGUARDS

READ AND SAVE THESE INSTRUCTIONS.

In order to prevent the risk of fire, electric shock, personal injury or damage to property, follow these instructions carefully. When using electric appliances, basic safety precautions should be followed, including the following:

1. Read all instructions before using this air purifier. Save these instructions for reference.
2. Direct ultraviolet light exposure to the eyes can cause temporary or chronic adverse effect to your eyesight.
3. Do not immerse this product in water or splash water on it. An electrical short may result in shock or fire.
4. Do not handle the plug with wet hands; electrical shock may occur, resulting in injury or death.
5. Never attempt to disassemble or alter the product in any way not instructed by this manual. Shock, fire, or bodily injury may occur. Contact Hamilton Beach at 1-800-851-8900 for assistance.
6. Do not place your face directly on the outlet grille or look into the ultraviolet light.
7. Do not operate this product in any greasy environment such as in the kitchen. This product is not intended to filter oil or grease from the air.
8. Do not operate this product near an open fire. It may ignite and cause fire, resulting in bodily injury or property damage.
9. Do not operate this product in a garage or other area with oil or chemicals such as solvents or insecticides.
10. Always unplug the power cord from the receptacle when the air purifier is not in use, before cleaning, replacing parts, or before moving to another location.
11. Do not insert foreign objects into the product for any reason. Bodily injury or property damage may occur.
12. Do not use this product outdoors. It is intended for indoor use only.
13. Do not operate this appliance without the outlet grille in place or if the outlet grille is broken or damaged.
14. This air purifier is equipped with safety interlock switches that turn the unit off if the intake or outlet grilles are removed. DO NOT attempt to defeat or override this safety feature.
15. **WARNING:** To reduce the risk of fire or electric shock, do not use this purifier with any solid-state speed control device.

SAVE THESE INSTRUCTIONS!

Consumer Safety Information

This appliance is intended for household use only.

This appliance is equipped with a polarized plug. This type of plug has one blade wider than the other. The plug will fit into an electrical outlet only one way. This is a safety feature intended to help reduce the risk of electrical shock. If you are unable to insert the plug into the outlet, try reversing the plug. If the plug should still fail to fit, contact a qualified electrician to replace the obsolete outlet. Do not attempt to defeat the safety purpose of the polarized plug by modifying the plug in any way.

If a longer cord is necessary, an approved extension cord may be used. The electrical rating of the extension cord must be equal to or greater than the rating of the air purifier. Care must be taken to arrange the extension cord so that it will not drape over the countertop or tabletop where it can be pulled on by children or accidentally tripped over. Route the electrical or extension cord clear of furniture to prevent damage from pinching.

⚠ WARNING

Germicidal Light Radiation Hazard

- **Never operate with damaged, broken or missing outlet grille louvers or without the outlet grille.**
- **Never operate with damaged, broken or cracked housing.**
- **Always unplug unit before cleaning, servicing or replacing the UV bulb.**
- **Never look directly at UV bulb or place face directly on outlet grille.**
- **Use only Hamilton Beach replacement UV bulb: Part No. 04810.**
- **Read all instructions before using.**

Failure to follow these instructions can result in direct exposure to germicidal light, which can cause temporary or chronic damage to your eyesight, or even blindness.

About Your Air Purifier

The air purifier functions as an air cleaner by helping to disinfect airborne bacteria and removing particulates from the air.

The air is cleaned in three stages:

1. A fan draws air through the intake grille on the front of the air purifier. Then it passes through the carbon pre-filter which traps large dust particles and reduces odors.
2. The white HEPA filter then removes particles as small as 0.3 microns from the air at 99.97% effectiveness.
3. The clean air is then exposed to germicidal-grade ultraviolet light to reduce the level of airborne bacteria, molds, and viruses. The purified air is then released through the outlet grille on the top of the unit.

To Order Replacement Parts

Replacement bulbs may be available where the air purifier was purchased or can be obtained directly from Hamilton Beach.

Purifier Model	Control Type	Room Size* (sq. ft.)	Carbon Pre-Filter	HEPA Filter	UV Bulb	Starter Type FS-5 or FS-22
04160	Manual	200 ft ²	04922	04912	04810	904004100
04161	AirSmart™	200 ft ²	04922	04912	04810	904004100
04162	Manual	350 ft ²	04923	04913	04810	904004100
04163	AirSmart™	350 ft ²	04923	04913	04810	904004100

* Each air purifier is designed to filter the room five times per hour at high speed. Factors such as room shape and ceiling height can affect this rate. It is normal that the air flow will be reduced as the filters become clogged. See “Checking the Filters” on page 13 for more information.

Know Your Air Purifier

Parts and Features

1. Outlet Grille
2. Ultraviolet (UV) Bulb
3. Control Panel
4. AirSmart™ Sensor*
5. UV Starter
6. UV Bulb Check Window
(not shown – see page 8 for location)
7. Filter Check Gauge
8. Air Sensor Cleaner*
9. HEPA Filter
10. Carbon Pre-Filter
11. Intake Grille

* Available on AirSmart™ models only.
Manual control models do not include these features.

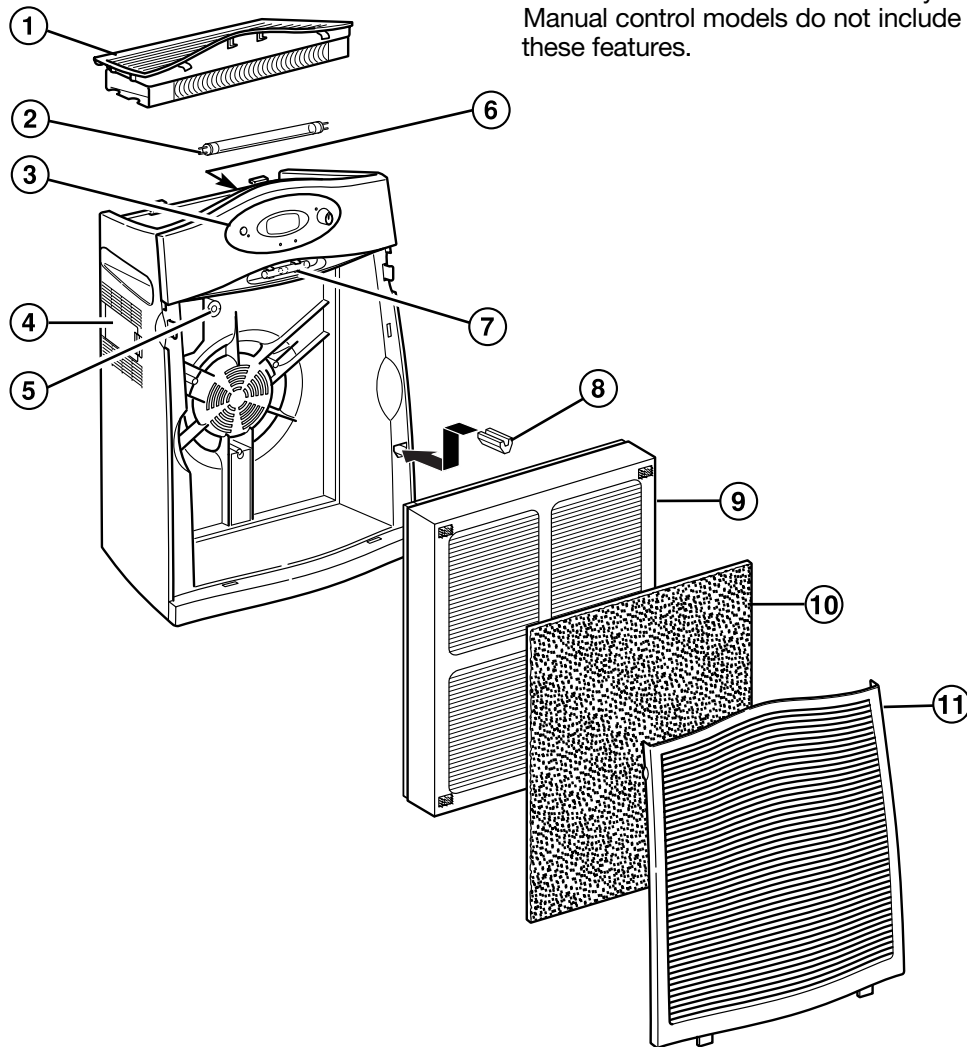

How to Assemble and Use

IMPORTANT: Your Hamilton Beach air purifier is designed for easy use and maintenance. Make sure that the UV bulb, HEPA filter, and carbon pre-filter are properly installed before use.

Before First Use

Be sure to remove all packing materials. The filters and UV bulb are packed in plastic bags inside the air purifier for shipping. Refer to pages 7 to 9 for unpacking and installation instructions.

Selecting the Proper Location

To prevent the risk of personal injury or damage to the air purifier and provide the best possible performance of your air purifier, follow the placement guidelines below:

DO:

- Place the air purifier on a flat, stable surface.

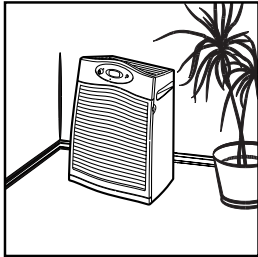

- Place the air purifier near an electrical outlet where it is out of the way. Make sure that the air purifier and the cord do not present tripping hazards.
- Select a central location with adequate air circulation.
- Turn off and unplug the air purifier before moving or servicing it, or if it will not be used for several days.
- Route the electrical cord clear of furniture to prevent damage from pinching.

DO NOT:

- Do not stand, sit, or place any objects on the air purifier. It is not designed to support additional weight.

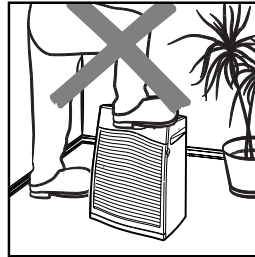

- Do not block the air intake and outlet grilles with drapes, curtains, or blinds. This may cause reduced performance.
- Do not use in a kitchen, garage, or area with grease, oil or chemicals such as solvents or insecticides.
- Do not place on or near heat sources such as stoves, radiators, or heaters, or in direct sunlight.
- To reduce electrical noise and interference, do not place on or near, or plug into the same outlet as TVs, baby monitors, or cordless phones.

Installing the Carbon Pre-Filter

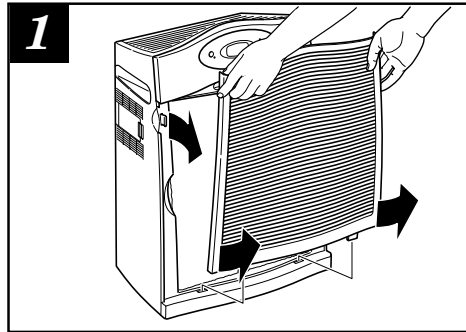

NOTE: The carbon pre-filter should be replaced approximately every three months.

Remove the intake grille by carefully pulling the upper two side tabs away from the body of the air purifier and lifting up.

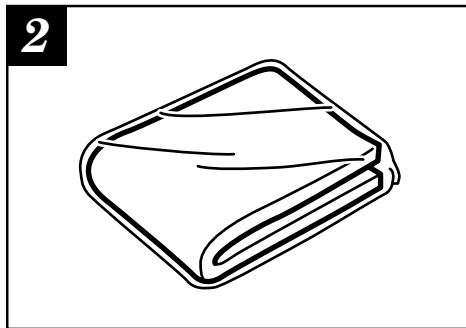

Locate the black carbon pre-filter. It will be folded inside a plastic bag. Remove and discard the plastic bag.

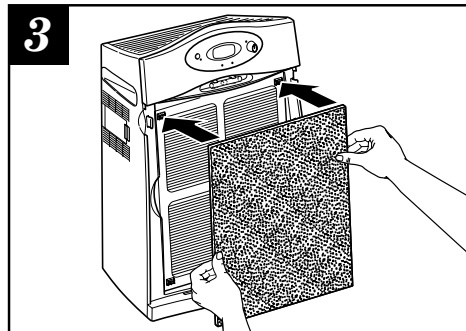

Unfold and flatten out the black carbon pre-filter. Attach the four corners of the carbon pre-filter to the four hook fasteners on the HEPA filter.

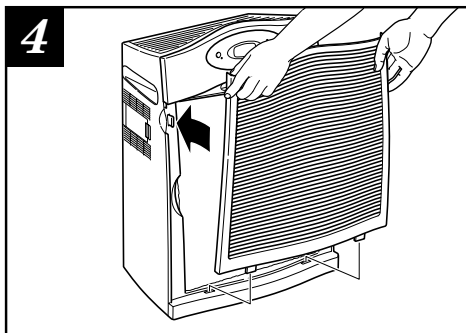

Insert the two tabs on the bottom of the intake grille into the holes on the bottom ledge of the air purifier. Pivot the intake grille into place and lightly press on the upper corners of the grille to snap it into place.

NOTE: The air purifier has a safety switch that prevents operation if the intake grille is not properly installed. DO NOT attempt to override or disable this safety switch.

Installing the UV Bulb

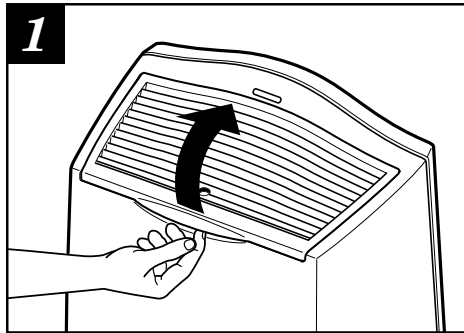

Open and remove the outlet grille by pulling up on the handle on the upper back of the air purifier.

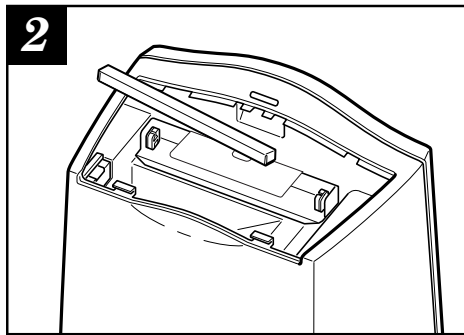

Remove the packaged UV bulb from inside the air purifier. **Be careful not to touch the glass part of bulb.** Handle by metal ends only. Oil from fingertips on the glass bulb will shorten the life of the bulb. Carefully unpack the bulb and discard the packaging.

NOTE: Make sure no loose packing material remains inside the air purifier.

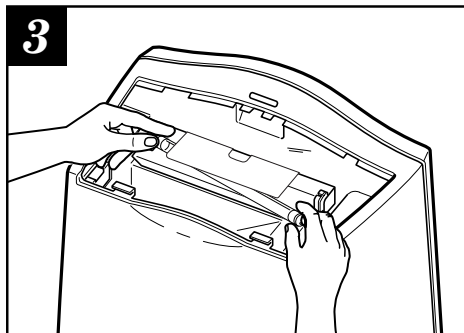

Make sure the unit is unplugged. Starting with one end of the bulb, then the other, gently insert the metal pins on the bulb into the white slotted socket one pin at a time.

NOTE: Only one pin will fit in the socket at a time. **DO NOT** force the pins into the socket—you could break the bulb.

Installing the UV Bulb (continued)

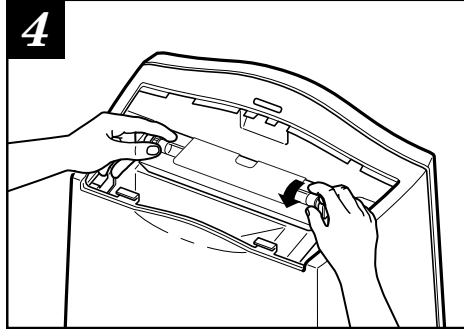

Once the ends of the bulb are completely inserted into the socket, rotate the bulb a quarter turn until it locks into place.

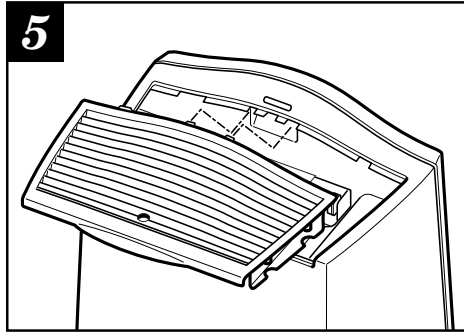

Insert the two center tabs on the front of the outlet grille into the middle slots on the front of the opening. Pivot the grille down toward the back of the air purifier.

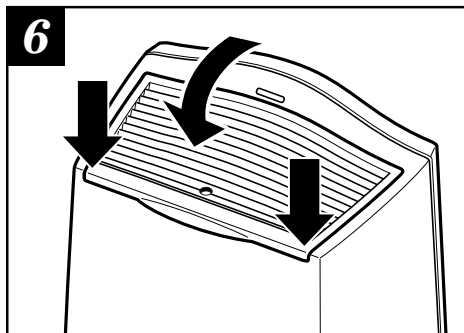

Press lightly down on the back corners of the outlet grille to snap it into place.

NOTE: The air purifier has a safety switch that prevents operation when the top outlet grille is not properly installed. DO NOT attempt to override or disable this safety switch. See the Germicidal Light Hazard Warning on page 3.

Plugging in the Air Purifier

WARNING: To reduce the risk of electrical shock, never plug in the air purifier while your hands are wet. Always unplug the air purifier before moving or servicing the unit.

NOTE: The polarized plug will only fit in one direction—DO NOT try to force the plug. If you are unable to insert the plug into the outlet, try reversing the plug. If the plug still does not fit, contact a qualified electrician to replace the obsolete outlet.

Setting the Controls – Manual Control Models

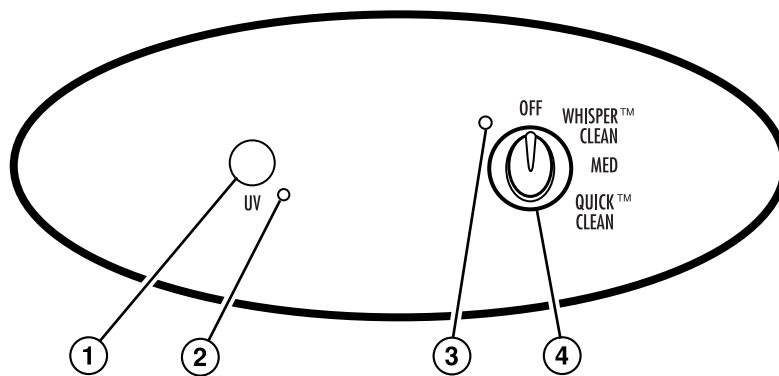

1. Germicidal UV Button – Turns on the germicidal UV lamp to reduce harmful bacteria from the filtered air. When this button is on, a bluish glow should be visible through the UV bulb check window on the top of the unit.

NOTE: The light will not come on if the fan is turned off.

2. UV “On” Indicator – Lights when the germicidal UV lamp is on.

3. Power On Indicator – Lights when unit is on.

4. Fan Speed Knob – Turn the fan speed knob to the desired setting. There are four settings:

- *Off*
- *WhisperClean™* – Use for quiet, nighttime operation or for constant low-speed filtration.
- *Medium* – Provides a higher fan speed; use for quickly filtering dust, pollen, smoke, etc. from a room.
- *QuickClean™* – Provides cleaning during acute needs.

Setting the Controls – AirSmart™ Models

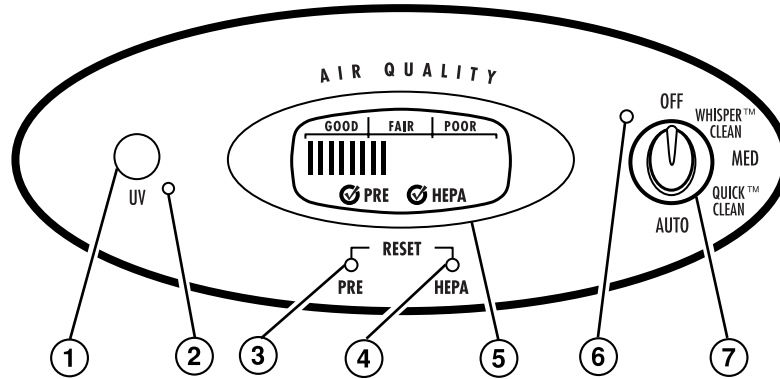

1. Germicidal UV Button – Turns on the germicidal UV lamp to reduce harmful bacteria from the filtered air. When this button is on, a bluish glow should be visible through the viewing window on the top of the unit.

NOTE: The light will not come on if the fan is turned off.

2. UV “On” Indicator – Lights when the germicidal UV lamp is on.

3. Pre-Filter Timer Reset Button

4. HEPA Filter Timer Reset Button

5. AirSmart™ Display – When the air purifier is first turned on, the AirSmart™ sensor will analyze the air to determine the current air quality. A bar will move back and forth across the display panel until the air quality is determined. This will take about one minute. The sensor will then continue to monitor and show the air quality (poor, fair, or good) in a bar graph in the display. If the fan is set to Auto, the sensor automatically adjusts the fan speed for the most effective air purification.

AIR QUALITY	AUTO SELECTED FAN SPEED
Poor	QuickClean™
Fair	Medium
Good	WhisperClean™

The Display also has check marks that will appear to indicate that it is time to check the carbon pre-filter or HEPA filter. See “Checking the Filters” on page 13. Once the filters have been checked, and if necessary, replaced, press the recessed RESET button with the end of a pen, toothpick, or small nail. This will reset the “timer-like” control.

6. Power On Indicator – Lights when unit is on.

7. Fan Speed Knob – Turn the fan speed knob to the desired setting. There are five settings:

- *Off*
- *WhisperClean™* – Use for quiet, nighttime operation or for constant low-speed filtration.
- *Medium* – Provides a higher fan speed; use to quickly filter dust, pollen, smoke, etc., from a room.
- *QuickClean™* – Provides cleaning during acute needs.
- *Auto* – Functions with the AirSmart™ sensor and automatically selects the fan speed depending on the air quality detected. This is the normal setting for continuous use.

How to Clean

Your air purifier is designed to provide years of trouble-free service with minimal maintenance. The following instructions will help you maximize the life and efficiency of your air purifier.

	⚠ WARNING
	To reduce risk of electric shock: <ul style="list-style-type: none">• Always unplug before cleaning.• Do not immerse in water or other liquid.

Cleaning the Air Purifier

- Wipe the enclosure, control panel, and cord with a damp cloth or sponge.
- The intake grille can be removed and washed in warm, soapy water. Do not place in dishwasher. Make sure the grille is completely dry before reinstalling.
- The outlet grille should simply be dusted. It should not be immersed in water.
- No part of the air purifier should be placed in a dishwasher.

Cleaning the AirSmart™ Sensor

On models equipped with the AirSmart™ sensor, it is recommended to clean the sensor monthly.

1. Remove the air sensor cleaner from the storage compartment behind the intake grille (see item 8, page 5).

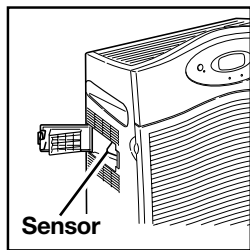

2. The sensor is located on the side of the unit. Open the sensor compartment (as illustrated), then place the air sensor cleaner into the sensor opening.

3. Push the air sensor cleaner in and out of the sensor opening several times to clean the sensor lens.
4. Close the sensor compartment and put the air sensor cleaner back in the storage compartment. Replace the intake grille. Make sure the sensor door is fully closed. If it is not, the sensor may not operate properly.

Checking the Filters

A special filter check gauge is included with your air purifier to allow you to check the condition of the filters. It is stored in a compartment behind the front intake grille. See item 7 on page 5 for location.

The **HEPA filter** should last approximately 12 months with continuous use, less in areas with a high level of airborne particles such as dust or pollen.

The **carbon pre-filter** will last approximately three months.

NOTE: You must reinstall and snap the intake grille before checking the filters with the gauge. The air purifier will not operate if the grille is not in place.

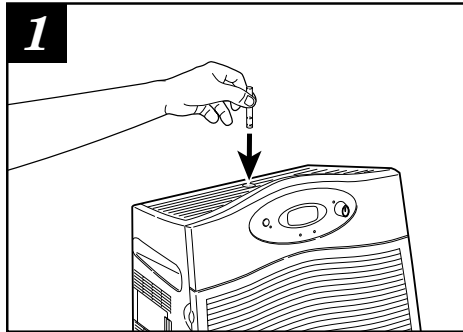

Insert either end of the filter check gauge into the recessed hole on the top of outlet grille. Turn the fan on QuickClean.™

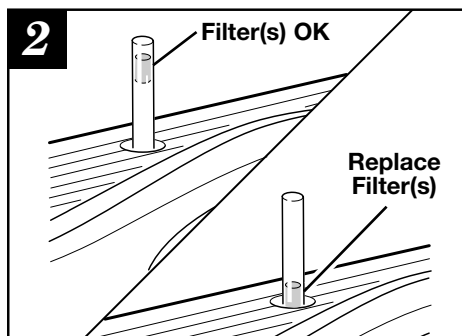

The colored cylinder should float up the filter check gauge. If it does not move from the bottom of the gauge, the filter(s) are clogged and need to be replaced.

Replacing the HEPA Filter

The HEPA filter will normally last about 12 months before it must be replaced, or approximately every fourth time the carbon pre-filter is replaced.

If the filter check gauge indicates that the filter requires replacement, it is recommended that you first replace the carbon pre-filter and then use the filter check gauge to check the filter again. If the colored cylinder still does not float up the gauge, the HEPA filter must also be replaced.

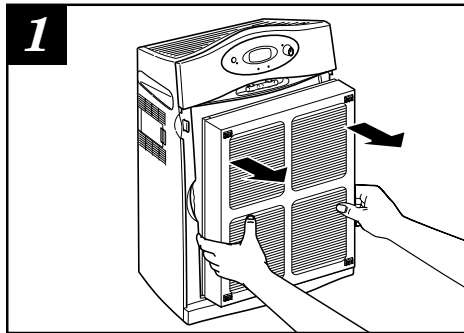

Turn off and unplug air purifier. Remove the used HEPA filter by gripping the sides and pulling outward, as shown. Discard the used filter. It cannot be cleaned.

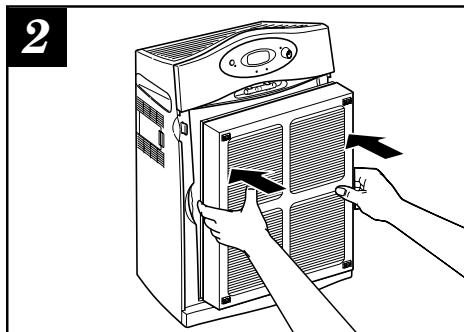

Obtain a replacement HEPA filter. Insert the unwrapped HEPA filter, hook fastener side out, into the air purifier.

NOTE: Improper filter installation will result in poor air filtration.

Replacing the UV Bulb

The UV bulb is designed to provide approximately one year of continuous, effective operation. After this time, the bulb may remain illuminated, but its effectiveness is greatly reduced.

For maximum germicidal protection, replace the UV bulb when replacing the HEPA filter, or if the UV bulb

check window does not glow when the UV switch is on. The UV replacement bulb cannot be purchased in stores. Replacement bulbs may be available where the air purifier was purchased or can be obtained directly from Hamilton Beach.

To Remove the UV Bulb:

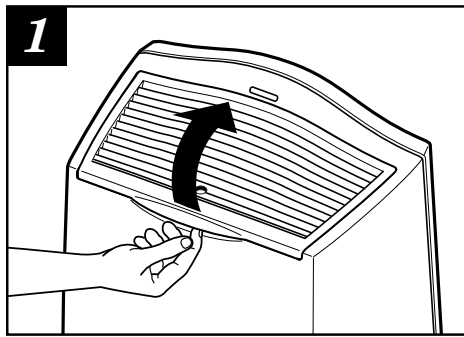

Turn off and unplug the air purifier. Open and remove the outlet grille by pulling upon the handle on the upper back of the air purifier.

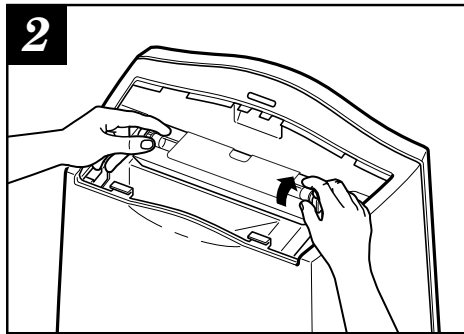

Gently rotate the bulb a quarter turn in either direction until it unlocks from the socket. Pull the pins out the sides of the socket, one end at a time.

To Install the New UV Bulb:

Refer to steps 3 through 6 on pages 8 and 9 to install the new UV bulb. Be sure to discard the old UV bulb in a safe and responsible manner in accordance with any applicable local, state, and federal regulations.

If the UV bulb check window still does not glow, replace the starter.

Remember, oils from fingertips will shorten the life of the bulb. Do not touch the glass part of the bulb.

Replacing the UV Starter

If the UV bulb does not light after installing a new bulb, the starter should be replaced. See page 4 for replacement parts.

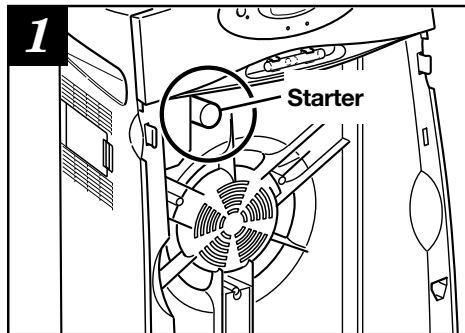

Turn off and unplug air purifier. Remove the intake grille and filters. The starter is the small cylinder-shaped part located behind the filter.

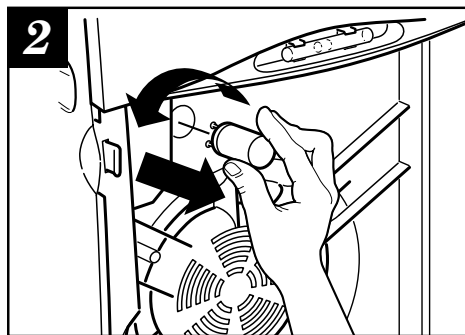

Turn the starter counterclockwise until it unlocks, then pull it out. To install the new starter, insert the starter and turn clockwise. Replace filters and intake grille.

Troubleshooting Guide

The following section provides the solutions to many common problems and questions. If your air purifier is not working correctly, review these solutions first. If your problem is still not solved after reviewing this guide, call our toll-free customer service number, listed on the front cover of this manual, for assistance.

The Air Purifier Will Not Turn On

- Are the intake grille and the outlet grille installed and locked into place?
- Is the fan speed knob turned on?
- Is the air purifier plugged into a powered outlet?

The Air Purifier Changes Speed

- AirSmart™ models are designed to sense the level of contaminants in the air and adjust the fan speed to provide the most effective air purification possible. If the AirSmart™ control is set to Auto, it will automatically change fan speeds to adjust for changing air quality.

Reduced Air Flow or Poor Filtering

- The intake or outlet grille may be blocked. Make sure nothing is in front of or on top of the air purifier.
- The carbon pre-filter or the HEPA filter may be clogged. Check the filters with the filter gauge and replace them, if necessary.

Germicidal UV Bulb Does Not Light

- Is the UV switch turned on?
- Is the fan running? The UV bulb will not work unless the fan is on.
- The bulb may be burned out. See “Replacing the UV Bulb” for replacement instructions.
- The UV starter may need replacement. See “Replacing the UV Starter” for replacement instructions.

Customer Service

If you have a question about your air purifier, call our toll-free customer service number. Before calling, please note the model, type, and series numbers and fill in that information below. These numbers can be found on the back of the air purifier. This information will help us answer your question much more quickly.

MODEL: _____ **TYPE:** _____ **SERIES:** _____

THREE-YEAR LIMITED WARRANTY

Hamilton Beach/Proctor-Silex, Inc. warrants this appliance to be free from defects in material and workmanship for a period of three (3) years from the date of original purchase, except as noted. There is no warranty with respect to the following, which may be supplied with this appliance: carbon pre-filter, HEPA filter, UV germicidal bulb, or starter. This warranty extends only to the original consumer purchaser and does not cover damage from abuse, neglect, use for commercial purposes, or any other use not found in the printed directions. HAMILTON BEACH/PROCTOR-SILEX, INC. EXPRESSLY DISCLAIMS ANY AND ALL IMPLIED WARRANTIES, INCLUDING WARRANTIES OF MERCHANTABILITY AND FITNESS FOR A PARTICULAR PURPOSE. ANY LIABILITY HEREUNDER IS EXPRESSLY LIMITED TO THE REPAIR OR REPLACEMENT OF A DEFECTIVE PRODUCT OR AN AMOUNT EQUAL TO THE PURCHASE PRICE PAID THEREFOR, AND ALL CLAIMS FOR SPECIAL AND CONSEQUENTIAL DAMAGES ARE HEREBY EXCLUDED. Some states or provinces do not allow this exclusion or limitation of incidental or consequential losses, so the foregoing disclaimer may not apply to you. If you have a claim under this warranty, DO NOT RETURN THE APPLIANCE TO THE STORE! Please call our CUSTOMER SERVICE NUMBER. (For faster service please have model, series, and type numbers ready for operator to assist you.)

CUSTOMER SERVICE NUMBERS

In the U.S. 1-800-851-8900

In Canada 1-800-267-2826

Web site address: www.hamiltonbeach.com

KEEP THESE NUMBERS FOR FUTURE REFERENCE!

This warranty gives you specific legal rights, and you may also have other legal rights which vary from state to state, or province to province.

HAMILTON BEACH ♦ PROCTOR-SILEX, INC.

263 Yadkin Road
Southern Pines, NC 28387

PROCTOR-SILEX CANADA, INC.

Picton, Ontario K0K 2T0

840071100

Web site address: www.hamiltonbeach.com

9/00