

PHILIPS

hue personal
wireless
lighting

40967/**/**



S/N:4AB33D

HUE



User manual
Notice d'emploi
Manual de usuario

Incl.

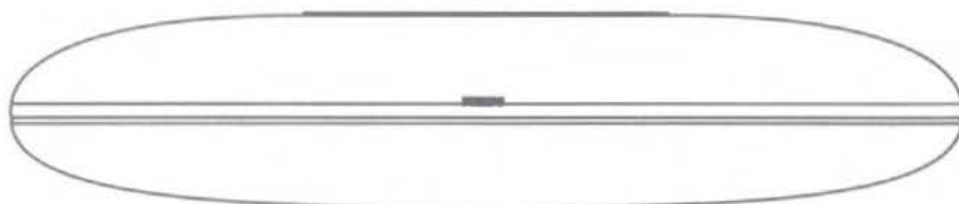

Excl.

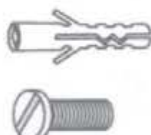
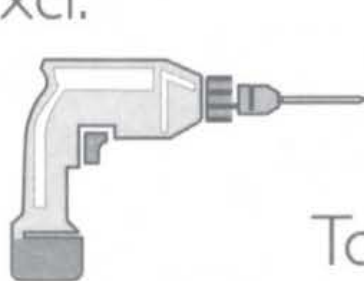

3x

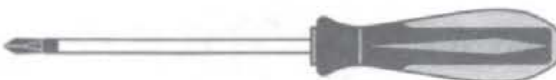
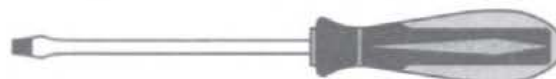

Torx TX20

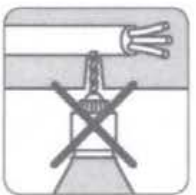
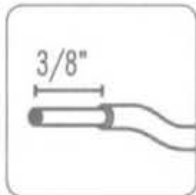

www.philips-hue.com/getstarted



EN IMPORTANT SAFETY INSTRUCTIONS

Product appearance may vary from image shown.

CAUTION - RISK OF FIRE

THIS PRODUCT MUST BE INSTALLED IN ACCORDANCE WITH THE APPLICABLE INSTALLATION CODE BY A PERSON FAMILIAR WITH THE CONSTRUCTION AND OPERATION OF THE PRODUCT AND THE HAZARDS INVOLVED.

DANGER - RISK OF SHOCK - DISCONNECT POWER BEFORE INSTALLATION.

FR MESURES DE SÉCURITÉ À RESPECTER

L'apparence du produit peut différer de l'image montrée.

ATTENTION - RISQUE D'INCENDIE

CE PRODUIT DOIT ÊTRE INSTALLÉ SELON LE CODE D'INSTALLATION PERTINENT? PAR UNE PERSONNE QUI CONNAÎT BIEN LE PRODUIT ET SON FONCTIONNEMENT AINSI QUE LES RISQUES INHÉRENTS.

DANGER - RISQUE DE CHOC - COUPER L'ALIMENTATION AVANT L'INSTALLATION.

ES INSTRUCCIONES DE SEGURIDAD IMPORTANTES

La apariencia del producto puede variar de la imagen mostrada.

PRECAUCION - RIESGO DE INCENDIO

ESTE PRODUCTOR DEBE SER INSTALADO SEGUN EL CODIGO DE INSTALACION APLICABLE POR UNA PERSONA QUE CONOZCA LA CONSTRUCCION Y EL FUNCIONAMIENTO DEL PRODUCTO Y LOS RIESGOS QUE SUPONE.

PELIGRO - RIESGO DE DESCARGA ELÉCTRICA - DESCONECTE LA ENERGÍA ANTES DE LA INSTALACIÓN.

Disassemble luminaire before installation
Démonter du luminaire avant l'installation
Desmontar de la luminaria antes de la instalación

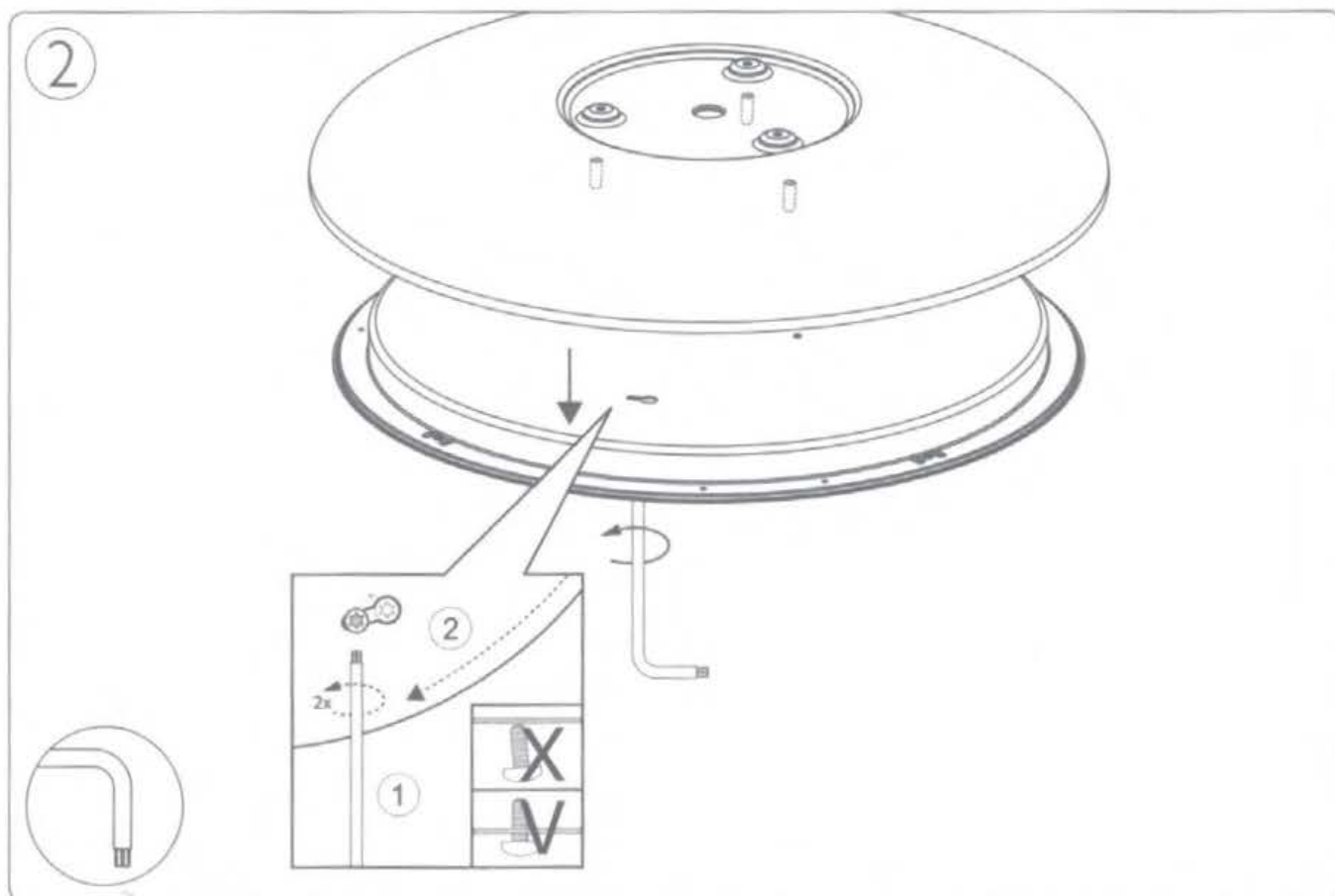
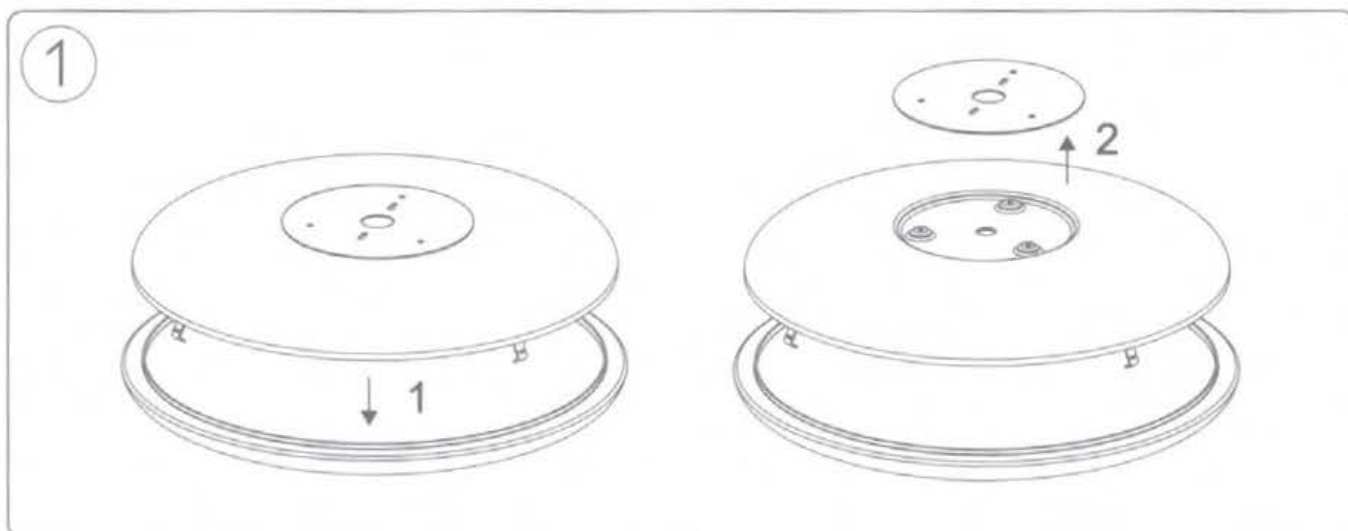

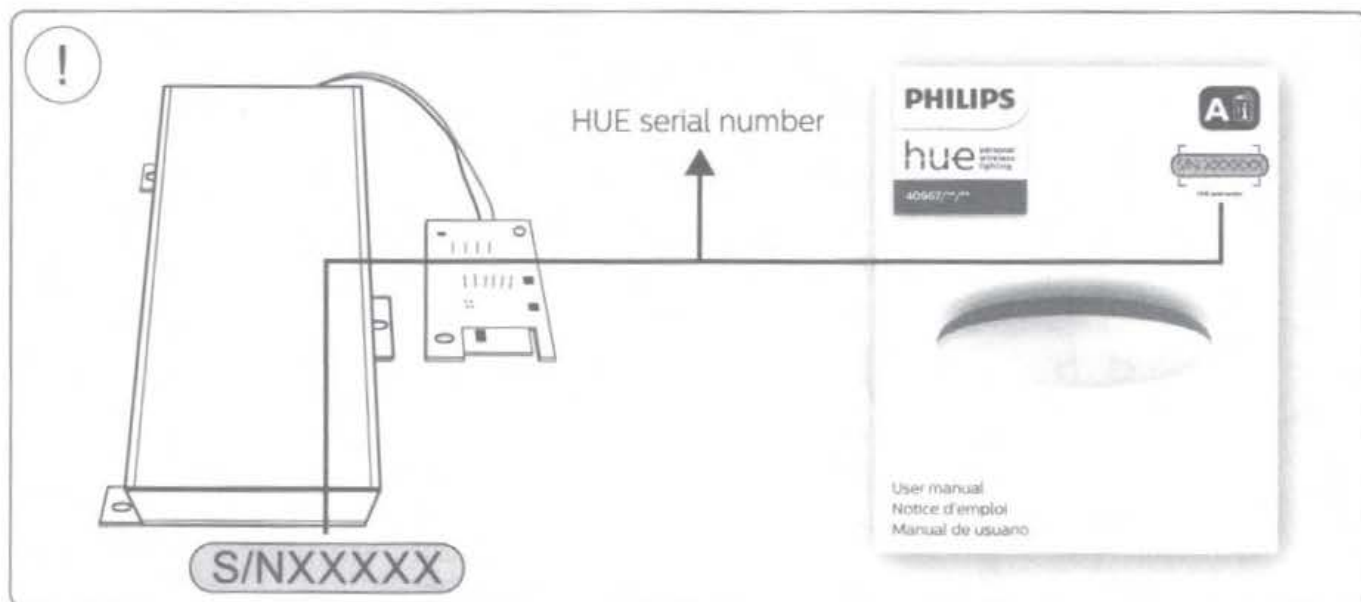

Mounting instructions
Instructions de montage
Instrucciones de montaje

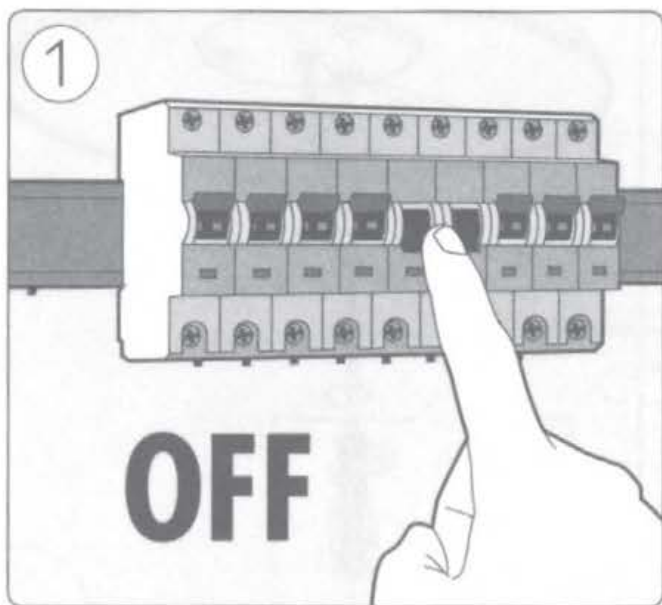

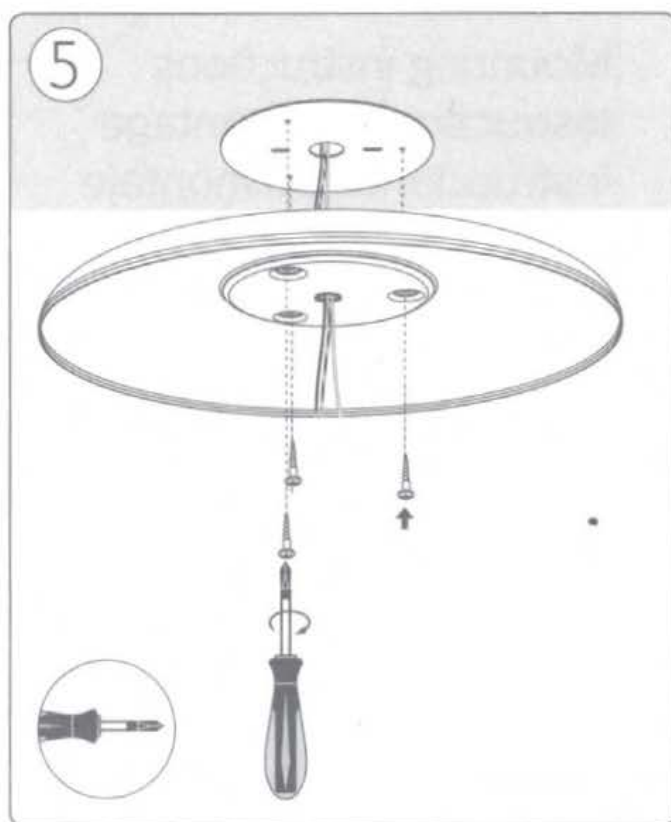
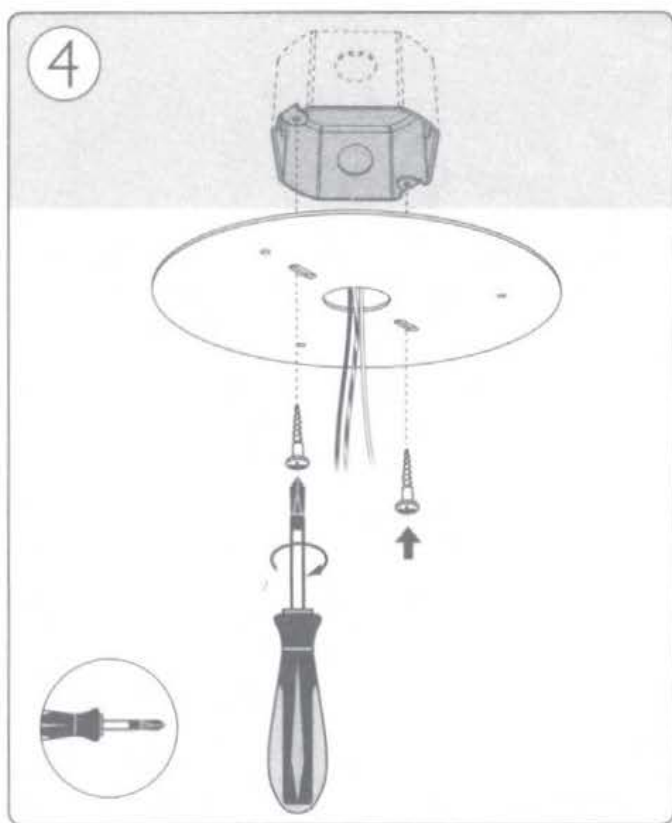
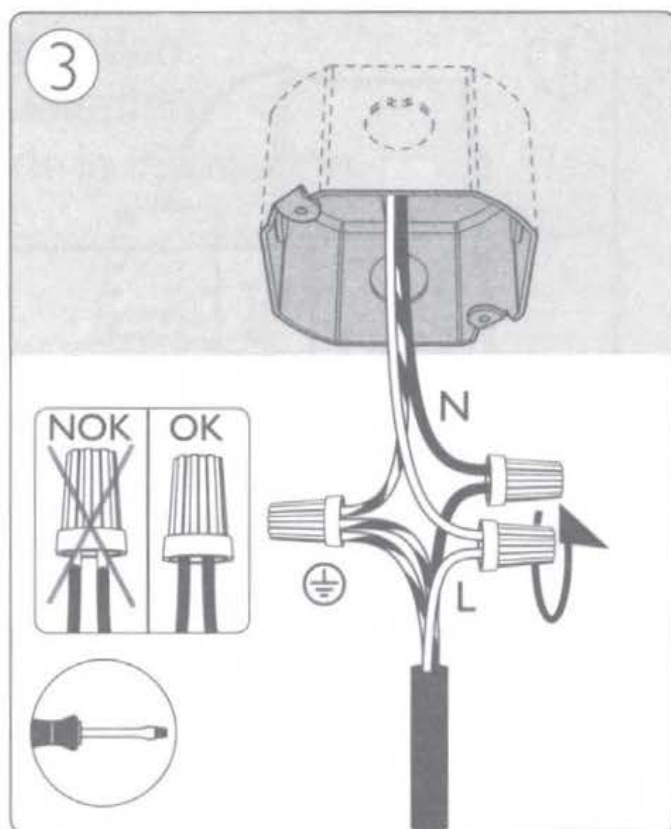
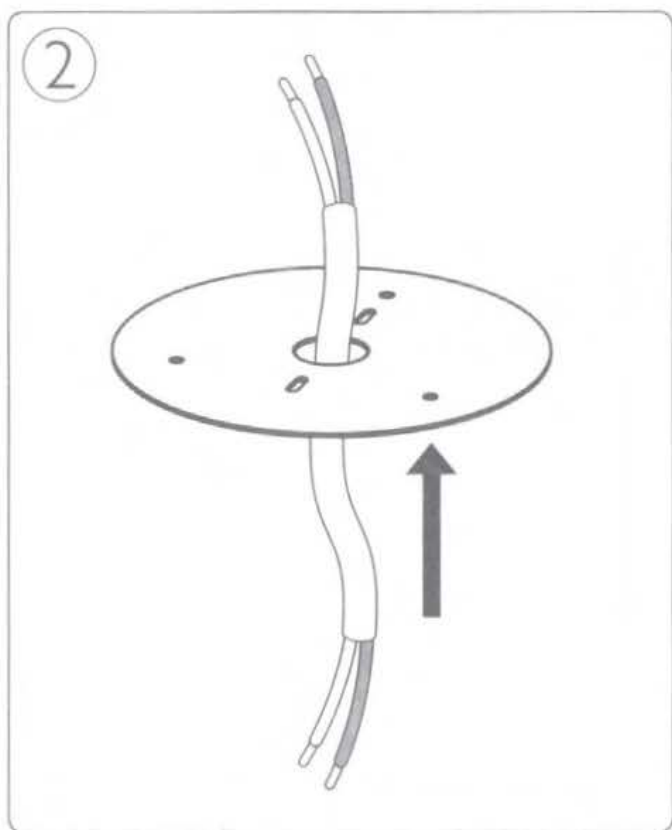

6

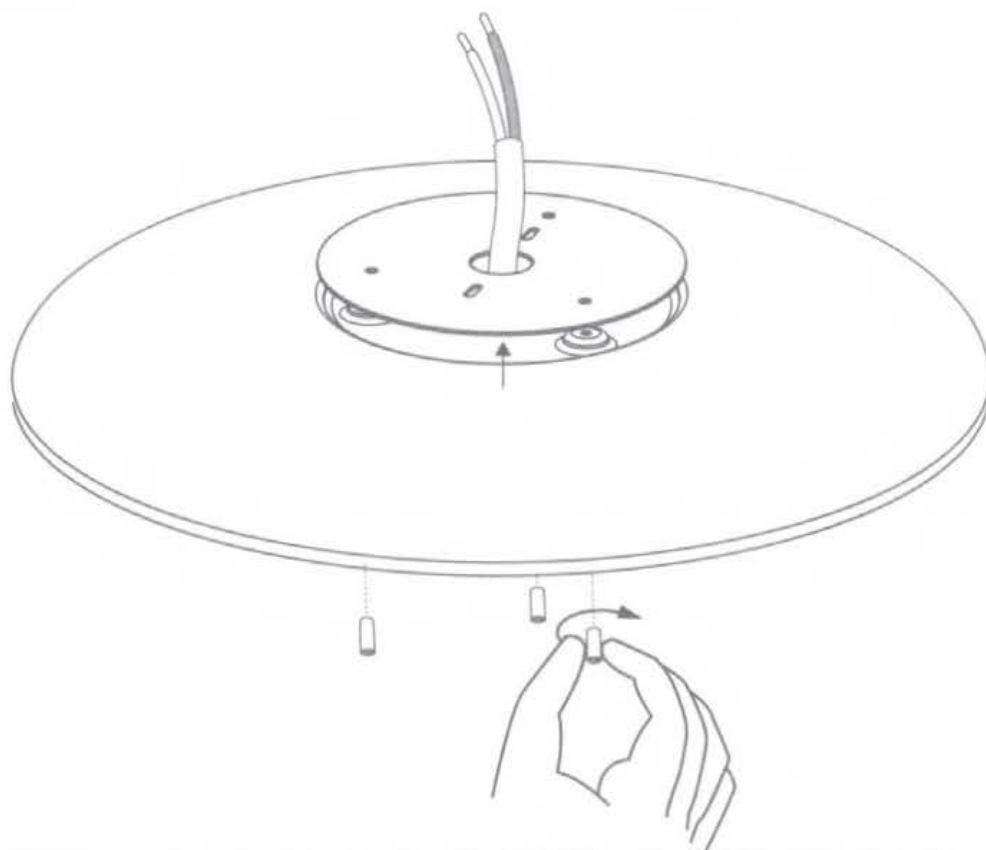

7

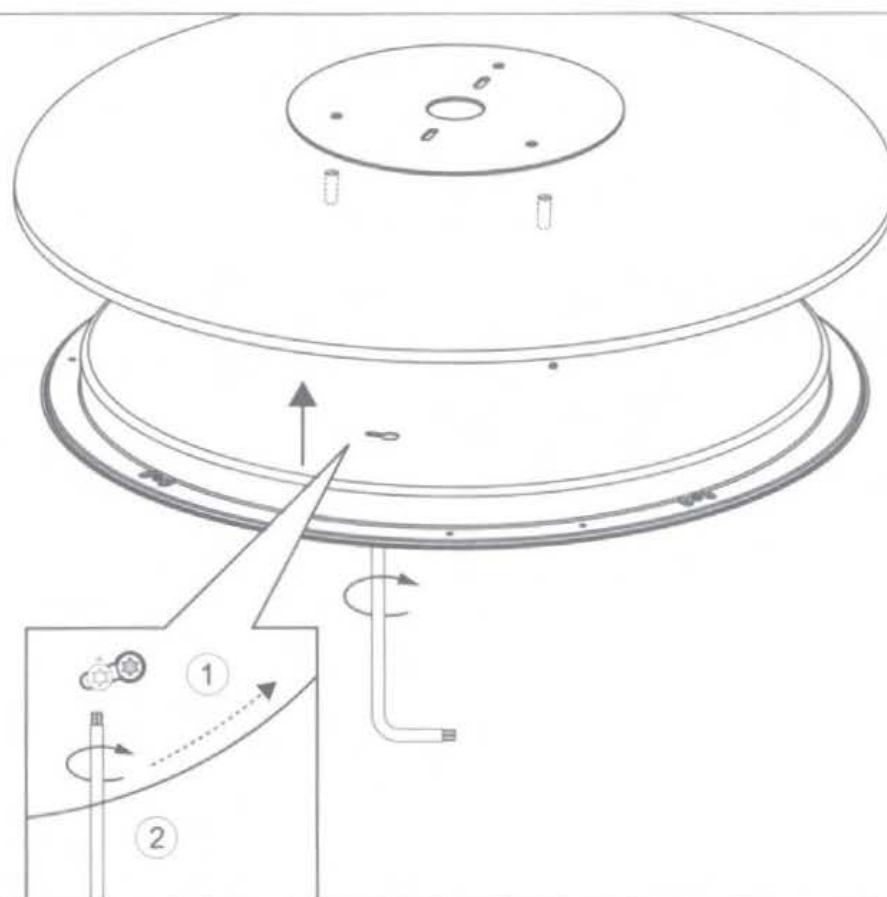

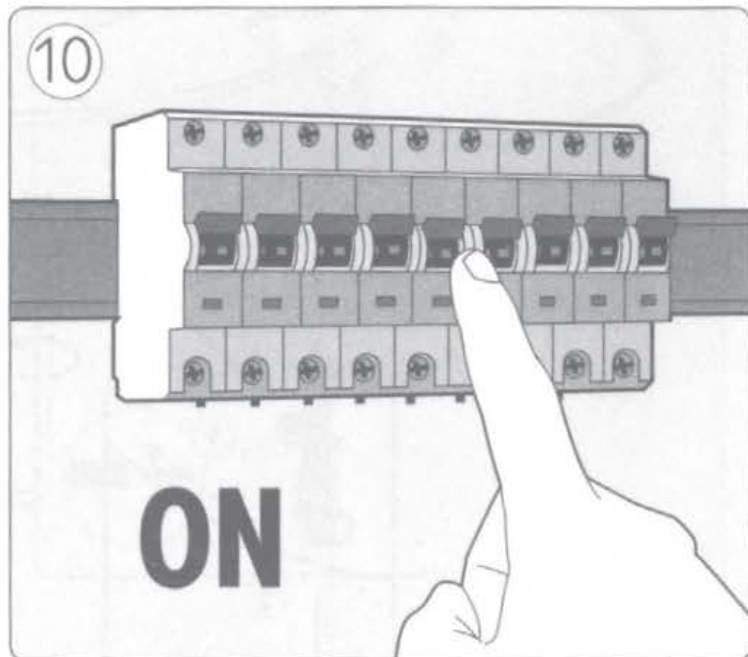
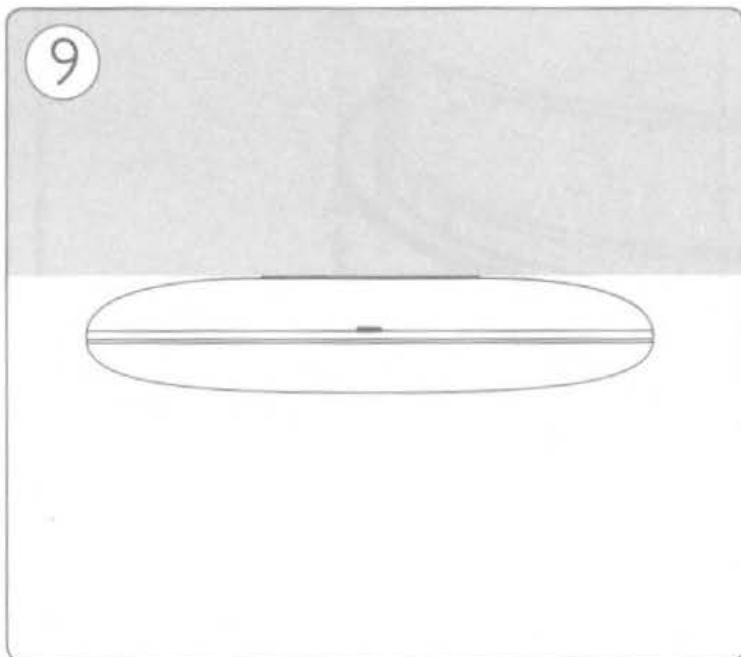
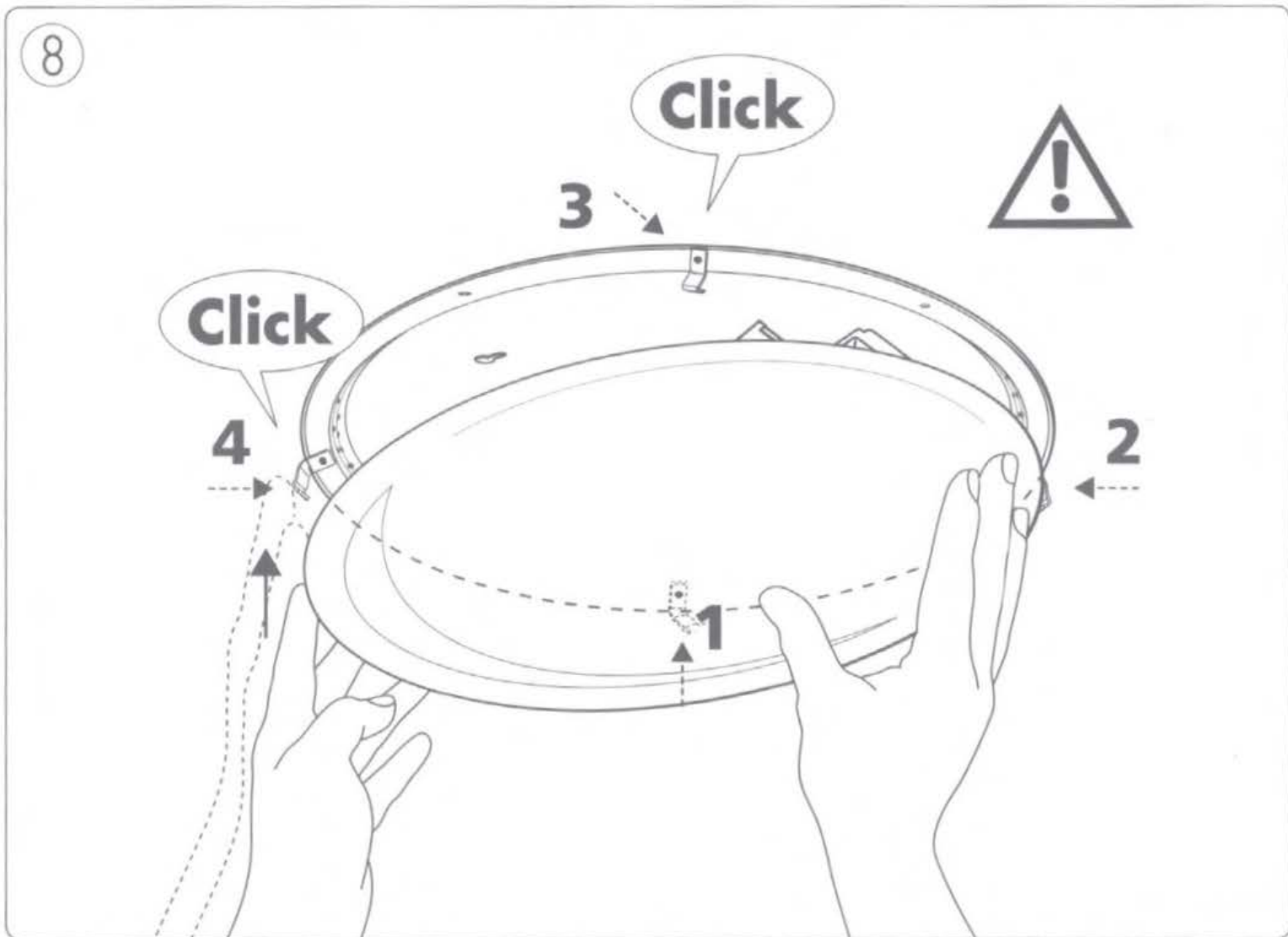



www.philips-hue.com

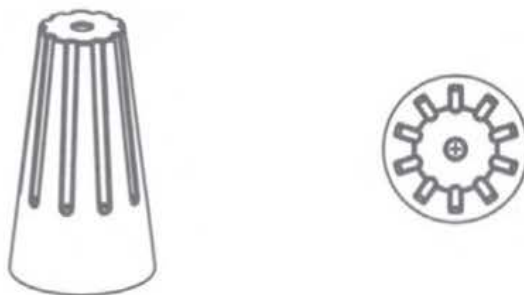

EN Wire Connectors Instructions:

1. Turn off power before installing or removing connectors.
2. Strip wires 5/16"(7.9mm). For #16 and smaller wires, strip 3/8"(9.5mm).
3. Pre-twisting unnecessary, hold stripped wires together with ends even.
Lead stranded wires slightly.
4. Align any frayed strands or conductors.
5. Push wires into connector and screw on until two twists are visible in wires.

For use with copper to copper conductor

Temperature Rating: 105°C(221 °F) Max.

Voltage Rating: 600V Max. building wiring; 1000V Max. in fixtures and signs

Listed as a PRESSURE-TYPE wire connector on the following Solid and /or Stranded wire combinations:

For UL Listed, CSA and CQC Certified

2#16	1#14 w/1 to 3#20 or #22	2#16 w/1#18	1#18 w/3 or 4#22
2 to 4#18	1#16 w/1 or 2#18	2#16 w/1 or 2#20	1 or 2#18 w/1#20 w/1#22
1#14 w/1#16	1#16 w/1#18 w/1#22	2#16 w/1 to 3#22	2#18 w/1 or 2#20 or #22
1#14 w/1#16 w/1#18	1#16 w/1 to 3#20 or #22	1#18 w/2 to 4#20	3#18 w/1#20 or #22
1#14 w/1 or 2#18	1 or 2#16 w/1#20 w/1#22		

FR Instructions de pose des connecteurs :

1. Coupez le courant avant d'installer ou d'enlever les connecteurs.
2. Dénudez les fils de 7,9 mm (5/16 po). Pour les fils de calibre 16 et plus petits, dénudez de 9,5 mm (3/8 po).
3. Il n'est pas nécessaire de pré-torsader, tenez les fils dénudés ensemble avec les extrémités à égalité. Torsadez légèrement les fils toronnés (en brins).
4. Alignez tous les brins ou conducteurs effilochés.
5. Insérez les fils dans le connecteur et vissez jusqu'à ce que deux torsades soient visibles dans les fils.

Pour utilisation avec fils conducteurs de cuivre à cuivre

Température de service : 105 °C (221 °F) max.

Tension de service : 600 V max. pour le câblage de bâtiment; 1 000 V max. pour les appareils d'éclairage et les enseignes

Homologué en tant que connecteur de type à pression pour les combinaisons de fils massifs et toronnés suivantes :

Pour fils homologués UL, CSA et CQC

2#16	1#14 w/1 à 3#20 ou #22	2#16 w/1#18	1#18 w/3 ou 4#22
2 à 4#18	1#16 w/1 ou 2#18	2#16 w/1 ou 2#20	1 ou 2#18 w/1#20 w/1#22
1#14 w/1#16	1#16 w/1#18 w/1#22	2#16 w/1 à 3#22	2#18 w/1 ou 2#20 ou #22
1#14 w/1#16 w/1#18	1#16 w/1 à 3#20 ou #22	1#18 w/2 à 4#20	3#18 w/1#20 ou #22
1#14 w/1 ou 2#18	1 ou 2#16 w/1#20 w/1#22		

ES Instrucciones para los conectores para alambres:

1. Apague la alimentación eléctrica antes de instalar o quitar los conectores.
2. Pele 5/16" (7.9mm) de los alambres. Si los alambres son del #16 o más pequeños, pele 3/8" (9.5mm).
3. No es necesario torcerlos primero. Sostenga los alambres pelados juntos, con las puntas parejas. Enderece ligeramente los alambres torcidos.
4. Alinee todos los hilos o conductores que no estén chuecos.
5. Introduzca los alambres en el conector y atornille hasta que vea dos vueltas en los alambres.

Para uso con conductores de cobre

Temperatura máxima: 105°C (221 °F).

Tensión nominal: 600V máx. cableado de edificios; 1000V máx. en aparatos eléctricos y letreros

Clasificado como conector TIPO A PRESIÓN en las siguientes combinaciones de alambres sólidos y/o torcidos:

Para alambres con certificación UL Listed, CSA y CQC

2#16	1#14 w/1 a 3#20 o #22	2#16 w/1#18	1#18 w/3 o 4#22
2 a 4#18	1#16 w/1 o 2#18	2#16 w/1 o 2#20	1 o 2#18 w/1#20 w/1#22
1#14 w/1#16	1#16 w/1#18 w/1#22	2#16 w/1 a 3#22	2#18 w/1 o 2#20 o #22
1#14 w/1#16 w/1#18	1#16 w/1 a 3#20 o #22	1#18 w/2 a 4#20	3#18 w/1#20 o #22
1#14 w/1 o 2#18	1 o 2#16 w/1#20 w/1#22		



Signify North America Corporation
200 Franklin Square Drive
Somerset, NJ 08873, USA

Signify Canada Ltd./Signify Canada Ltée.
281 Hillmount Road,
Markham, ON, Canada L6C 2S3

Questions or Comments / Questions ou commentaires :
1-800-555-0050

Importado y/o distribuido en México por:
Signify Mexico S.A. de C.V.
Av. La Palma N° 6-Col. San Fernando,
La Herradura Huixquilucan
Edo. De México, C.P. 52784 - R.F.C. PME-620620-E84

Centro de contacto:
01-800-508-9000

© 2020 Signify Holding
All rights reserved.

www.philips-hue.com

4404 029 13251
Last update: 07/2020

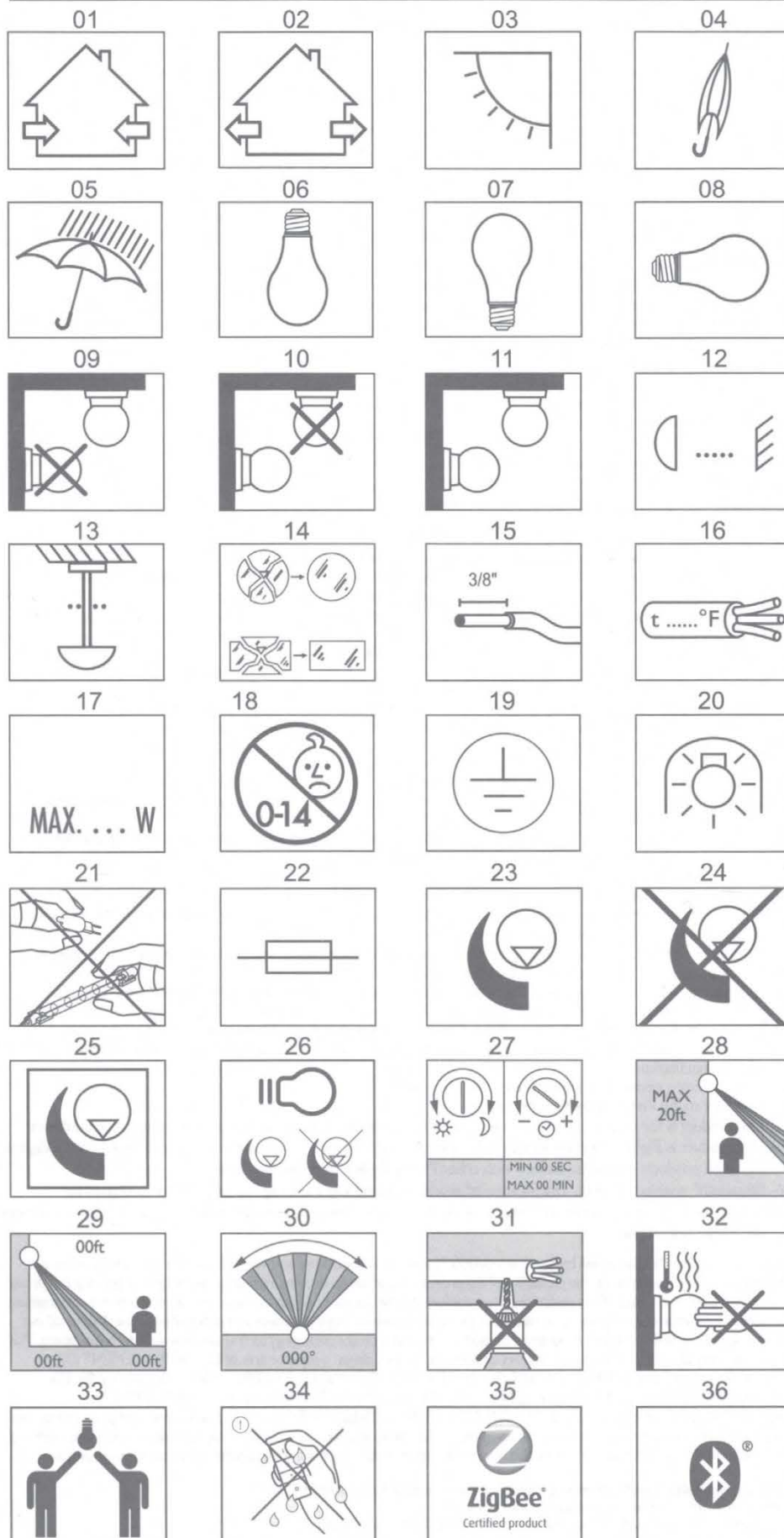

- The manufacturer advises the correct use of Luminares (lighting fixtures)! Therefore always follow these instructions to ensure correct and safe installation and functioning of the luminaire and keep it for future reference.
- Turn off electrical power at main fuse or circuit breaker box before commencing installation, maintenance or repair.
- If in doubt, consult a qualified electrician or contact your retail outlet. Ensure that you always install the luminaire to the local electrical code. Certain regulations indicate that luminaires should be installed by a qualified electrician.
- Observe the correct color of the wiring before installation: white (N), black (L) and green or bare copper wire (Ground).
- Do not connect this luminaire to a non-grounded electrical system. **WARNING:** Installing this fixture in a non-grounded electrical system could allow metal parts of the luminaire to carry electrical current if any wires or wire connections become broken or loose. Under this condition, anyone coming in contact with the luminaire is subject to electric shock which could cause injury or death.
- Always use wire nuts/connectors rated for the correct gauge and number of wires used. **CAUTION:** Be certain that no bare wire strands are exposed outside of the wire nuts/connections (if applicable).
- Be careful not to damage or cut the wire insulation (covering) during installation. Do not permit wires to contact any sharp edges.
- Do not remove thermal insulation pad(s). Doing so will result in increased temperatures and possible risk of fire.
- Maintain interior lighting with a dry cloth duster; do not use abrasives or solvents. Avoid liquid on all electrical parts.
- Always consider all the technical specifications of the luminaire. Verify the stated icons on the identification label on the luminaire and the icons that are shown in part A of your safety instructions.

ATTENTION: Below you will find all the explanations with numeric reference to the icons respectively in front of these PART-B safety instructions. Applicable icons to your fixture are shown in PART-A safety instructions.

- 01- This luminaire should only be installed indoors.
- 02- The luminaire is suitable for outdoor usage.
- 03- Only suitable for dry locations.
- 04- Suitable for damp locations.
- 05- Suitable for wet locations.
- 06- Luminaire is suitable for base up mounting.
- 07- Luminaire is suitable for base down mounting.
- 08- Luminaire is suitable for horizontal mounting.
- 09- The luminaire is only suitable for fixing to the ceiling.
- 10- The luminaire is only suitable for fixing to the wall.
- 11- The luminaire is suitable for fixing to the wall and to the ceiling.
- 12- Always observe the minimum distance between the lamp and the surface being lit as indicated on the icon.
- 13- Free air space of at least 4 inches must be kept between top of shade and bottom of canopy.
- 14- Immediately replace a cracked or broken safety glass and use only manufacturer approved parts.
- 15- Strip the wire as indicated in the diagram.
- 16- Use heat-resistant cable for wiring the luminaire into the mains.
- 17- MAX. ...W: only use lamps suitable for this luminaire and keep within the maximum specified wattage.
- 18- This product is not suitable for children under 14 years
- 19- The Luminaire has a ground conductor identified with green insulation or bare copper wire..
- 20- The luminaire is only suitable for a lamp with built-in safety or a low pressure lamp. An extra safety glass is not necessary.
- 21- Capsule and linear halogen lamps may not be touched by bare hands.
- 22- The luminaire is equipped with a fuse. If the luminaire is out of order after the bulb has been replaced, the internal fuse has to be replaced. If contact with the internal wiring can be made during this operation, this should be done by a competent electrician.
- 23- The luminaire can be used with a dimming circuit. Consult a qualified electrician for choosing the right type (especially important for low voltage luminaires).
- 24- The Luminaire cannot be used with a dimming circuit.
- 25- The luminaire is dimmable with the supplied dimmer **ONLY**. Do not connect to an additional dimmer.
- 26- The dimmability features depend on the chosen lamp. More information on the dimmability features is available in the information pack provided with the bulb.
- 27- Luminaire with time and light setting options. Minimum and maximum will be shown in the icon in part A.
- 28- The luminaire can be placed at a maximum of 20ft height.
- 29- To reach an optimal working, you have to place the luminaire on the height mentioned in the icon. The maximum and minimum reach of the detector is also mentioned in the icon in part A.
- 30- The standard active range of vision of the detector covers the given degrees mentioned in the icon.
- 31- Ensure that you don't drill through electrical wires or any other obstruction in the wall or ceiling during installation!
- 32- This luminaire contains in some places very hot parts.
- 33- Product to be installed by two people.
- 34- The product is for indoor use only. Do not use in wet locations, areas directly exposed to water or outdoors.
- 35- The product is ZigBee certified. Zigbee is an open standard for indoor wireless communication. All Philips ZigBee Certified products can be connected with other Philips ZigBee Certified products.
- 36- Bluetooth® enabled product. The Bluetooth® word mark and logos are registered trademarks owned by Bluetooth SIG, Inc. and any use of such marks by Signify is under license. Other trademarks and trade names are those of their respective owners.

Signify warrants that this device will be free from defects in material and workmanship and will operate for 2 years, unless a different period is stated in or on the packaging of the product, based on up to 3 hours average working time per day/7 days per week, when used as directed. If this device does not conform to the warranty, Signify will send you, at its election, a replacement device or refund your original price upon receipt of the returned device, register receipt and proof of purchase. Please call our toll-free number, 1-800-555-0050, or write to us (address indicated on the packaging) to find out how to return the device. This limited warranty does not cover devices subject to accident, neglect, abuse, misuse or acts of God. **REPLACEMENT OR REFUND IS YOUR SOLE REMEDY. EXCEPT TO THE EXTENT PROHIBITED BY APPLICABLE LAW, ANY IMPLIED WARRANTIES ARE LIMITED IN DURATION TO THE DURATION OF THIS WARRANTY. LIABILITY FOR INCIDENTAL OR CONSEQUENTIAL DAMAGES IS HEREBY EXPRESSLY EXCLUDED.** Some states and provinces do not allow exclusion of incidental or consequential damages, so the above limitation or exclusion may not apply to you. This warranty gives you specific legal rights, and you may also have other rights which vary from state to state and province to province.

Philips and the Philips Shield Emblem are registered trademarks of Koninklijke Philips N.V.
Alterations in design and technical specifications reserved.
"Hue Personal Wireless Lighting" is a trademark owned by Signify Holding B.V.



Signify North America Corporation
200 Franklin Square Drive
Somerset, NJ 08873, USA

Signify Canada Ltd./Signify Canada Ltée.
281 Hillmount Road,
Markham, ON, Canada L6C 2S3

Questions or Comments /
Questions ou commentaires :
1-800-555-0050
www.meethue.com

Importado y/o distribuido en México por:
Signify Mexico S.A. de C.V.
Av. La Palma N° 6-Col. San Fernando, La Herradura
Huixquilucan Edo. De México, C.P. 52784 - R.F.C. PME-620620-E84
Centro de contacto
01-800-508-9000



PHILIPS

hue personal wireless lighting

4404 029 07292
Last update: 07/02/19

EN

Please go to www.meethue.com to learn more about Hue and how to use it.

FCC ID: 2AGBW9290012630X
IC: 20812-2630X

This device complies with Part 15 of the FCC Rules and with RSS-210 of Industry Canada. Operation is subject to the following two conditions:

- (1) this device may not cause harmful interference, and
- (2) this device must accept any interference received, including interference that may cause undesired operation.

This equipment has been tested and found to comply with the limits for a Class B digital device, pursuant to part 15 of the FCC Rules.

These limits are designed to provide reasonable protection against harmful interference in a residential installation. This device generates, uses, and can radiate radio frequency energy and, if not installed and used in accordance with the instructions, may cause harmful interference to radio communications.

IC Certification:
- Hue Engine: company number: 20812 UPN: 2630X

This Class B digital apparatus complies with CAN ICES-3(B)/NMB-3(B).

This digital apparatus does not exceed the class B limits for radio-noise emissions from digital apparatus as set out in the Radio Interference Regulations of the Canadian Department of Communications.

NOTICE: Changes or modifications made to this device not expressly approved by Signify North America Corporation (USA) and Signify Canada Ltd./Signify Canada Ltée. (Canada) (collectively "Signify") may void the U.S. FCC and Canadian authorization to operate this device.

The advanced interface module complies with FCC radiation exposure limits set forth for an uncontrolled environment.

This device should be installed and operated with a minimum distance of 20 centimeters between the radiator and your body.

The manufacturer is not responsible for any radio or TV interference caused by unauthorized modifications to this equipment. Such modifications could void the user's authority to operate the equipment.

However, there is no guarantee that interference will not occur in a particular installation. If this device does cause harmful interference to radio or television reception, which can be determined by turning the device off and on, the user is encouraged to try to correct the interference by one or more of the following measures:

- Reorient or relocate the receiving antenna
- Increase the separation between the device and receiver
- Connect the device into an outlet on a circuit different from that to which the receiver is connected
- Consult the dealer or an experienced radio/television technician for help

WARNINGS AND CAUTIONS:

- Risk of electric shock – Do not use device where directly exposed to water.
- The device is for indoor use only.
- Dry location use only.

OPERATING INSTRUCTIONS:

- This device is not a toy designed to be played with by children.
- Do not place the device on hot surfaces.
- For safety reasons, do not open device, which will also void the warranty.
- Only use the adaptor supplied; using a different adaptor can damage the device.

LIMITED WARRANTY:

Signify warrants that this device will be free from defects in material and workmanship and will operate for 2 years based on up to 3 hours average usage per day/7 days per week, when used as directed. If this device does not conform to the warranty, Signify will send you, at its election, a replacement device or refund your original purchase price upon receipt of the returned device, register receipt and proof of purchase. Please call our toll free number 1-800-555-0050, write to Signify (address indicated on the packaging) or send an email at the website www.philips.com/lighting to find out how to return the device. This limited warranty does not cover devices subject to accident, neglect, abuse, misuse or acts of God. REPLACEMENT OR REFUND IS YOUR SOLE REMEDY. EXCEPT TO THE EXTENT PROHIBITED BY APPLICABLE LAW, ANY IMPLIED WARRANTIES ARE LIMITED IN DURATION TO THE DURATION OF THIS WARRANTY. LIABILITY FOR INCIDENTAL OR CONSEQUENTIAL DAMAGES IS HEREBY EXPRESSLY EXCLUDED. Some states and provinces do not allow exclusion of incidental or consequential damages, so the above limitation or exclusion may not apply to you. This warranty gives you specific legal rights, and you may also have other rights which vary from state to state and province to province.

CLEANING AND MAINTENANCE:

Do not clean the device when it is on and connected to the power supply. To avoid scratching the device, clean only with a soft dry cloth. Do not use cleaning agents to clean the device.

Manage in accordance with disposal laws in your area.

"Hue Personal Wireless Lighting" is a trademark owned by Signify Holding B.V.

Wireless Specification:

Wireless RF mode frequency band: 2400-2483.5 MHz
Wireless communications protocol: IEEE 802.15.4
Operating channels: channels 11 – 26

Environmental specification:

Temperature (operation): 0-35 °C
Temperature (Storage): -25-60 °C
Relative humidity: 5-95 % non condensing

FR

Pour en savoir plus sur le système Hue et son utilisation, visitez le site www.meethue.com.

FCC ID: 2AGBW9290012630X
IC: 20812-2630X



Signify North America Corporation
200 Franklin Square Drive
Somerset, NJ 08873, USA

Signify North America Corporation
Imported by / Importée par:
Signify Canada Ltd./Signify Canada Ltée.
281 Hillmount Road,
Markham, ON, Canada L6C 2S3

Questions or Comments /
Questions ou commentaires :
1-800-555-0050
www.meethue.com

Importado y/o Distribuido por:
Signify Mexico S.A. de C.V.
Av. La Palma N° 6-Col. San Fernando, La Herradura Huixquilucan
Edo. De México, C.P. 52784 - R.F.C. PME-620620-E84
Centro de Contacto 01-800-508-9000
www.meethue.com

© 2019 Signify Holding

PHILIPS

hue personal wireless lighting

How to get started
with Philips Hue
Commencez
avec Philips Hue

Discover
Découverte

For more information visit
www.meethue.com

Pour plus d'informations rendez-vous sur:
www.meethue.com

4404 025 11561

To connect your new Hue luminaire, select the installation instruction (A, B, C) that is applicable for you.
Pour connecter votre nouveau luminaire Hue, choisissez les instructions d'installation (A, B, C) qui vous sont applicables.

