

## Frequently Asked Questions

Click on a question to go directly to the answer:

1. Where is the model and serial number of my Philips Male Groomer?
2. What do the symbols on my Philips Groomer mean?
3. Can I rinse my Philips Groomer with water?
4. How do I replace the attachments of my Philips Groomer?
5. How do I change the length settings of my Philips Groomer?
6. How do I charge my Philips Groomer?

### 1. Where is the model and serial number of my Philips Male Groomer?

If you own a Philips Trimmer or Hair Clipper and want to know where its model and serial number is located, please check the information below.

The model number is often needed when registering your product or when looking for information about your specific model. The serial number can be used to identify the production date of your product.

#### Back of the device

For some grooming devices like the OneBlade, the model and serial numbers are located on the back of the handle. The model number usually starts with 2 alphabets followed by 4 digits, e.g. QP2540. The serial number has the format of YYWW (Year and week).



#### Top of the device

Some hair clippers and beard trimmers have the model number located on the top of the device, just below the cutting teeth. The serial number is usually located under the cutting unit. Try pulling off the upper part of your groomer and see if you can find 4 digits in the format of YYWW in there, e.g. 1823.

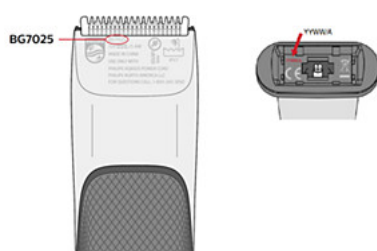

### Inside the handle

For nose trimmers the model and serial number is located inside the battery compartment. Remove the lower part of the handle of your trimmer to see the battery compartment. The model and serial number will be printed over there.

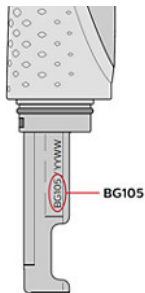

## 2. What do the symbols on my Philips Groomer mean?

If you are wondering, what do the lights and symbols on your Philips Male Grooming device mean, then please read our answer below.

### Charging indications

Most Philips Hair Clippers and Trimmers have charging indications and lights on them to indicate when your device needs to be charged and is fully charged. Depending on the device you own the charging indications may be displayed in many different ways, as shown in the image below. Some grooming devices do not have any charging indication on them. In that case, check the product's charger to see if has a light on it. This light lights up when the charger is connected to the power supply. For these products, follow the advised charging time as instructed in the user manual.

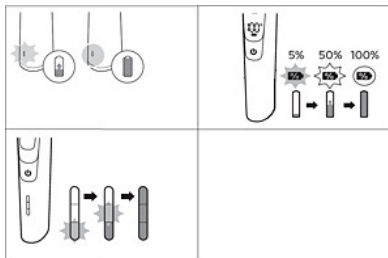

### Travel lock

Some grooming devices come with a travel lock functionality to prevent your groomer from turning on by accident while travelling.

To activate the travel lock press and hold the on/off button for 3 seconds. The lock symbol will flash briefly to indicate that the device is locked now. If you try to switch it on it will not work, rather the travel lock symbol will flash to remind you to deactivate it.

To deactivate the travel lock you can again press and hold the power button for 3 seconds. The symbol will again flash briefly and then the groomer will turn on.



### Turbo mode

Some Philips Hair Clippers and Multigroomers are equipped with a Turbo Mode. This is usually indicated with a T shaped symbol on the clipper. Press this button when you need extra power from your clipper. This can be useful when you are trimming very thick hair.

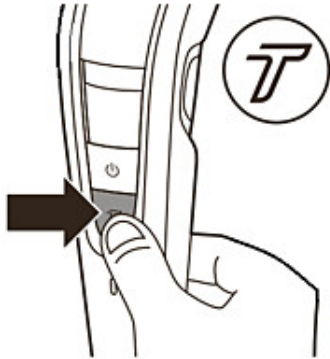

### Quiet mode

Some Philips Hair Clippers have the symbol of a baby printed on them. This is the quiet mode, which you can use while trimming your child's hair. This reduces the noise coming from the machine and helps keep children calm while clipping their hair.

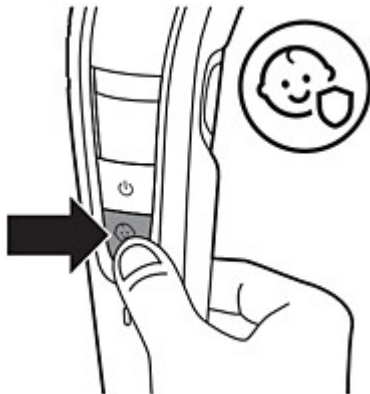

### Oil reminder

If you see the image of an oil drop flashing on your grooming device, this is a reminder for you to oil your groomer. You should regularly clean and oil your groomers with the oil provided in the package or sewing machine oil.

Depending on the grooming device you own, you may find other symbols printed or flashing on it. For more information regarding your exact model please refer to the user manual or contact us.

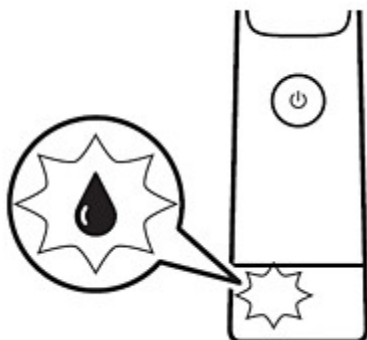

### 3. Can I rinse my Philips Groomer with water?

You can rinse your Philips Groomer or Trimmer only if it is waterproof. You can check that by looking at the signs and symbols printed on your groomer's box or body.

#### Crossed out tap symbol

If you see a crossed out tap symbol on the box or body of your groomer, it means that the groomer is not washable and should be cleaned without water.



#### Tap symbol

A tap symbol printed on your grooming device indicates that it is washable and its parts (cutters and combs) can be cleaned with water. However, this does not mean that you can use it to clip or trim your hair in the shower or bath.



#### Bath or shower symbol

If you see a shower or bath symbol printed on your groomer, it means that your device is waterproof. It can be safely cleaned with water and used while taking a shower or a bath. For safety reasons, these waterproof groomers can only be used cordless and will not turn on if they are connected to the power supply.

**Note:** Please keep in mind that the symbols on your Philips Groomer vary per model type. If you are still unsure whether it is safe to clean your Philips Groomer with water then please contact us for further support.



## 4. How do I replace the attachments of my Philips Groomer?

Your Philips Groomers, Hair Clippers and Beard Trimmers may come with a lot of different attachments. Find out here how to replace and use these attachments.

### Click-on cutting element

The cutting element is the main unit of your Philips Groomer. It has short, sharp edges and is used to give you a fast and clean trim.

To remove the cutting unit from the body of your groomer, check if there is a release button on the body of your groomer. If yes, press the button to detach the unit.

If the groomer does not have a release button, then place a finger under the teeth of the cutting unit and pull it upwards to take it off. To reattach it, first insert its bottom part in the body of the groomer and then push in the teeth part until you hear a click. Do not force the attachment in, as this may damage the device.

If you are having difficulty attaching it, check if there is something stuck inside the body, and try cleaning it with a small brush or cotton bud.



### Cutting units with legs

Some cutting units have long legs on the side. To remove these type of attachments, hold them from both sides and pull them off the appliance. To reattach them, push them back in the slot, until you hear a click.

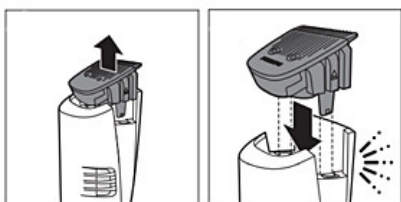

### Combs with legs

Trimming combs can be added on top of the cutting unit of your Philips Groomer. These can be used to clip the hair on your head or trim your beard to a certain length.

Removing these types of combs is easy. Just pull them off the body of your groomer. To attach the comb gently slide it down on top of your cutting element, so that the legs fit in the designated slots at the side.

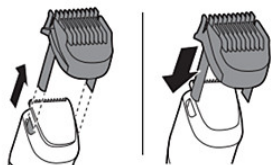

### Combs for Philips Kids' Hair Clippers

The Philips Kid's Hair Clippers have a different way to replace the trimming comb. You have to push the comb backwards from one side until it completely comes off.

To attach this comb, make sure the side with the desired hair length points upwards. Start by fitting one side of the comb in the clipper's body. Then push the other side also in and press to hear a click.

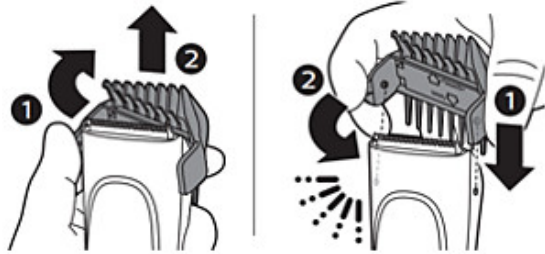

### Shaving foil

Some Philips Groomers come with a shaving foil, which can be used to comfortably shave body hair.

To remove the shaving foil, pull it off the shaver head. Be careful that you hold the shaving foil by its edges as the middle part can be very sharp. To reattach the shaving foil, snap it back on to the shaving head until you hear a click.

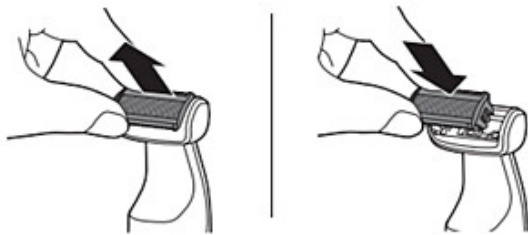

### Body grooming combs

Philips Body Groomers come with a special comb, which is specially designed to be used on your body. To remove the comb carefully pull the back part off the appliance and then remove it from the shaving unit or push it off upwards.

To attach this comb, snap it on to the shaving foil.

Keep in mind that the attachments may vary based on the model of trimmer or clipper you are using. Always check the user manual for detailed instructions or contact us.

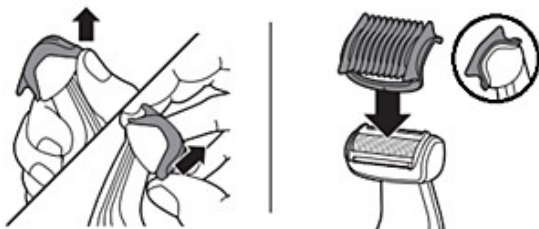

### Nose trimming attachments

Philips MultiGroomers which come with a nose trimmer attachment can also be easily removed and attached.

To take off the trimming head, firmly grip the handle of your device and turn it clockwise, until its aligned with a small indication point(^). Then just pull the attachment off.

To attach the trimming head, place it on the handle and turn it until the indicators arrows on the body and attachment are aligned.

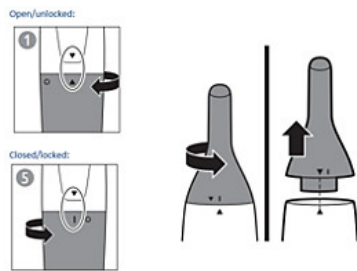

## 5. How do I change the length settings of my Philips Groomer?

Your Philips Groomer may come with different trimming combs and attachments. These products can also be used without any attachment to clip the hair very close to your skin. Find out here how to adjust the length settings when using these attachments.

### Click-on combs

If your groomer comes with multiple click-on combs, you can use these to get the desired hair length. The numbers on the combs indicate the length of the remaining hair after trimming. Simply click-on the appropriate comb onto the appliance and start grooming.

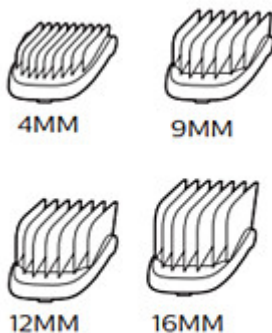

### Adjustable comb

Some combs are adjustable. These have a slide beneath them with different numbers or settings that correspond to the remaining hair length you will have after trimming your hair or beard. You can slide the button from left to right, to select the desired hair length you want to keep.



### Zoom wheel

Some Philips Groomers come with a rotating button on their body, also called the zoom wheel. You can slide the wheel to match the length setting indicated on the handle.

Some models have a two rows of length settings. In these models, the different rows refers to short length settings and the other for longer lengths. Always make sure you have attached the compatible comb or cutter for your desired length settings.

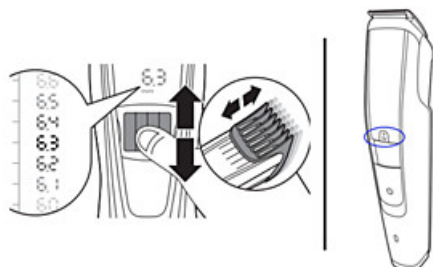

### Push & Slide

Your Philips Groomer may have a different kind of sliding button to adjust length settings. For these models, you may find the button on the handle of the device or on the comb itself. To change the settings just push the button and then slide it up or down.

You may refer to your user manual for detailed instructions or contact us.

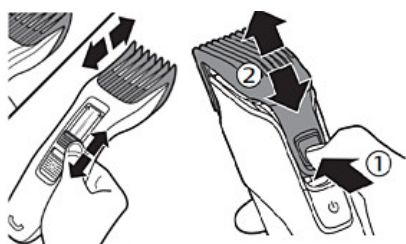

## 6. How do I charge my Philips Groomer?

Follow our instructions below on how to charge your Philips Groomers, Beard Trimmers and Hair Clippers.

### Charging instructions for Philips Groomers

You should charge your Philips Male Grooming devices when the charging indicator on the body of your groomer signals low battery. If your device does not have a battery indicator on it, then charge it whenever the groomer is working slower than usual.

1. Insert the charging plug in to you grooming device's charging socket. Make sure the plug's shape matches the socket and is completely inserted. Do not force it in.
2. The charging indicator on your device will start flashing to indicate that the groomer is charging. Once the groomer is fully charged, the charging indicator lights up continuously for approximately 30 minutes and then automatically turns off to save energy.
3. After charging, unplug the charger from the power outlet and the groomer. Your groomer is now ready to use.
4. For most groomers, normal charging time is between 1 to 8 hours. If you are charging your device for the first time, we recommend letting it charge for at least 3 hours. Check your user manual for specific charging instructions of your model.





### Charging your Philips Groomer with a charging stand

If your Philips Groomer comes with a charging station, follow the instructions below on how to charge it.

1. Connect the charging station to a working power outlet.
2. Place your groomer in the charging stand. You may see a light on your groomer or charging stand to indicate that the charging process has begun.
3. Once the groomer is fully charged, unplug the charging stand and continue using your groomer.

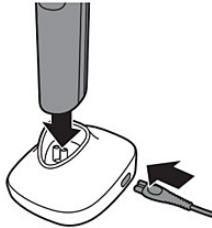

### Battery operated devices

Some Philips grooming devices run on disposable AA batteries. To charge these devices you need to ensure that the disposable batteries have not run out. In case your trimmer does not switch on or runs slower than before, it's time to replace the batteries.

Only use the disposable batteries as specified in your user manual. Do not mix different types of or old and new batteries. When putting in new batteries make sure the + and - poles of the battery point in the right direction.