

How to add your Matter-Certified device into multiple controllers

Configuration Guide

Updated 07-12-2023 19:12:25 PM  6238

This Article Applies to: 

Matter's multi-admin support allows your Matter-enabled smart home device to be controlled using multiple Matter-enabled third-party Apps. For example, your TP-Link Matter-enabled device could be set up with Alexa, then could be shared with Google Home or more Matter-enabled smart home apps.

This article will show you how to share your connected Matter-enabled device with another Matter-enabled third-party App or assistant.

If you are setting up a Matter-compatible device with another assistant and it fails, please refer to this [FAQ](#)

Note: A Matter setup code can only be used once. If you have already successfully used the code provided with the product you will need to generate a new code to add your Matter-enabled device to another controller.

The general steps to set up your Matter device with a third-party Controller are:

Step 1. Open the app the Matter device originally paired with and go to the device's settings menu.

Step 2. Create an 11-digit setup code. (or QR code)

Step 3. Copy the setup code

Step 4. Open another app that you want to use for controlling the Matter device and follow the app-specific instructions for entering the code (or scan the QR code).

Note: Before you begin the setup process, please ensure your Matter device, your phone, and the Matter-enabled Hub are connected to **the same Wi-Fi network**. (Your Matter device and phone are required to connect to **2.4 GHz Wi-Fi**)

The following is the guidance for specific apps:

How to set up the Alexa-connected Matter device with another Matter-enabled third-party App

Launch the Alexa app and go to the device Settings page.

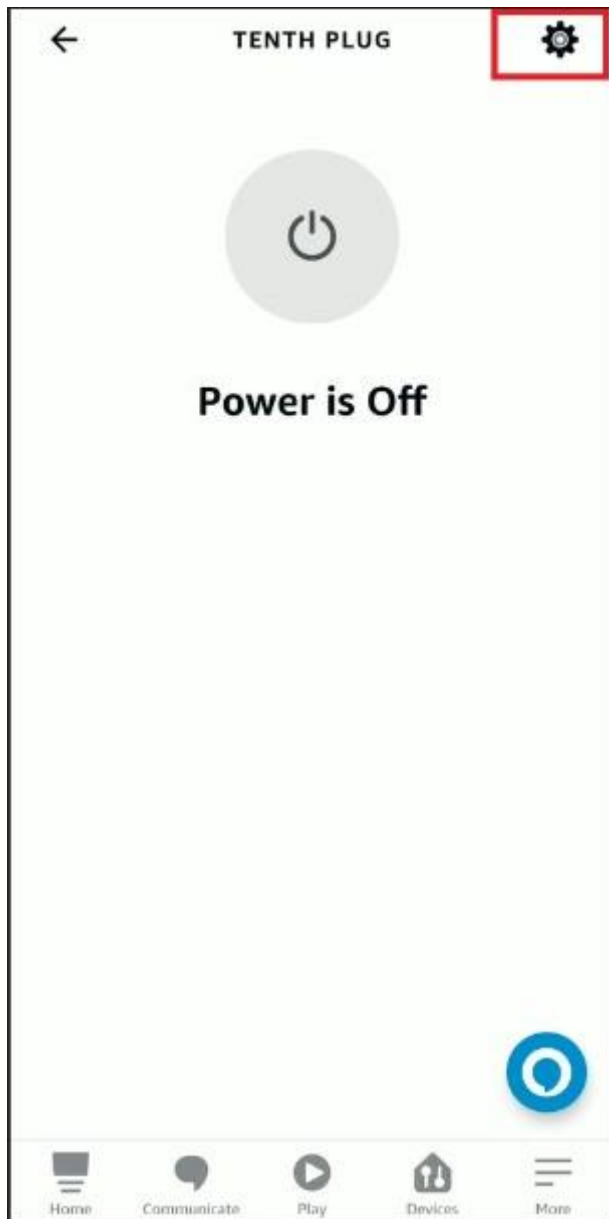

Tap **Other Assistants and Apps**, then tap **Add Another** to create an 11-digit setup code.

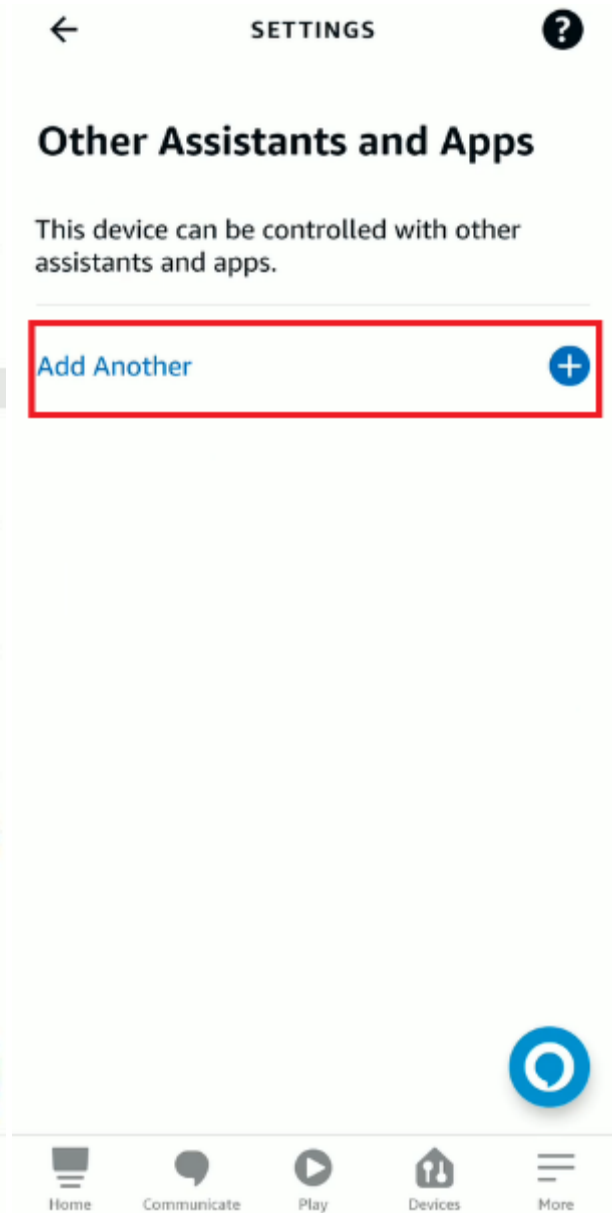
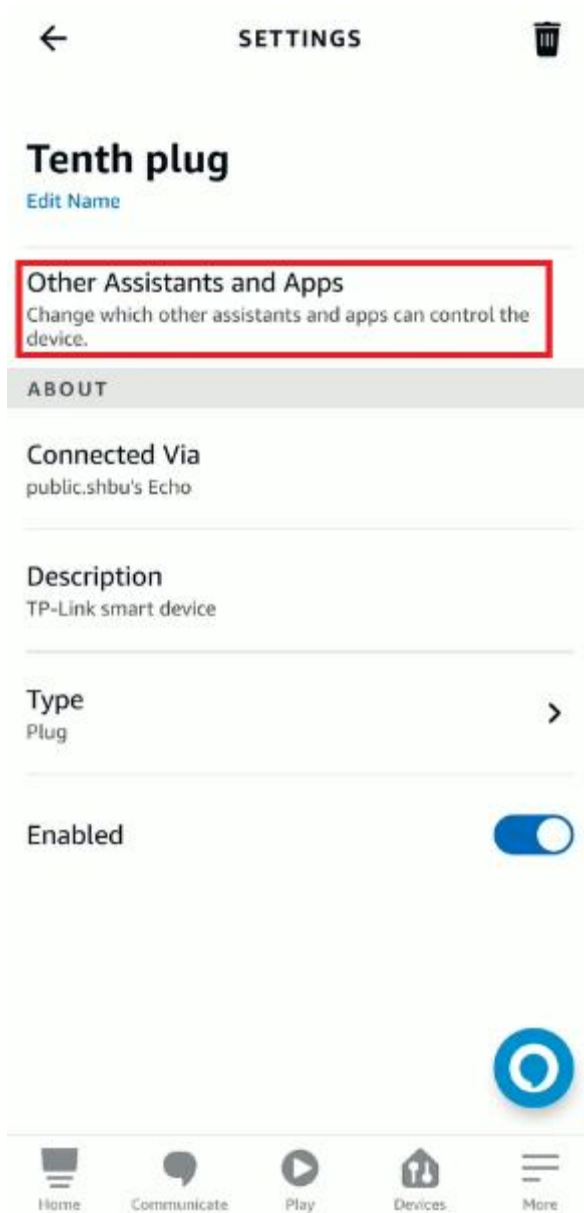

CONNECT AN APP



Control device with another assistant or app

Copy the code and enter it in the app you want to use to control this device. [Learn more](#)



Creating setup code

Copy the setup code.

Note: The pairing code will expire in 15 minutes. You will need to reset the device to renew the timer

CONNECT AN APP

×

Control device with another assistant or app

Copy the code and enter it in the app you want to use to control this device. [Learn more](#)

0433-972-8190

Copy

Expiring in 14:53 minutes

Done

Launch the other controller app and follow the setup instructions to enter the code. Follow the remaining on-screen instructions to complete the setup process.

For more instructions about Matter setup in Alexa, please refer to [Alexa Smart home FAQs](#)

How to set up the Google Home connected Matter device with another Matter-enabled third-party App

Launch the Google Home app, then go to the device settings page.



P125M

Back door



On



← P125M settings



General

Name

P125M

Home

Matter

Room

Back door

Linked Matter apps & services

Can control and manage this device

Technical information

Wi-Fi, model, versions, more



Remove device



Tap **Linked Matter apps & services**, then tap **Link apps & services**.



General

Name

P125M

Home

Matter

Room

Back door

Linked Matter apps & services

Can control and manage this device

Technical information

Wi-Fi, model, versions, more



Remove device





Linked Matter apps & services

You can control and manage this Outlet with these Matter-enabled apps & services

 **Link apps & services**

Linked apps & services (1)

Vendor ID: 6006



Android, Google Home, Google Assistant



Unlink all Matter apps & services from this device



When you unlink a Matter app or service, you can no longer use it with this device. Other connection types might still have access.



Create a new pairing code:

Using the Pairing Code:

(1) Choose **Using pairing code**.



Linked Matter apps & services

Link a Matter-enabled app

Choose a Matter-enabled app that can control and manage this device. You can also link or invite others using a code.



Home



Use pairing
code



Share with
QR code



(2) Copy the pairing code.

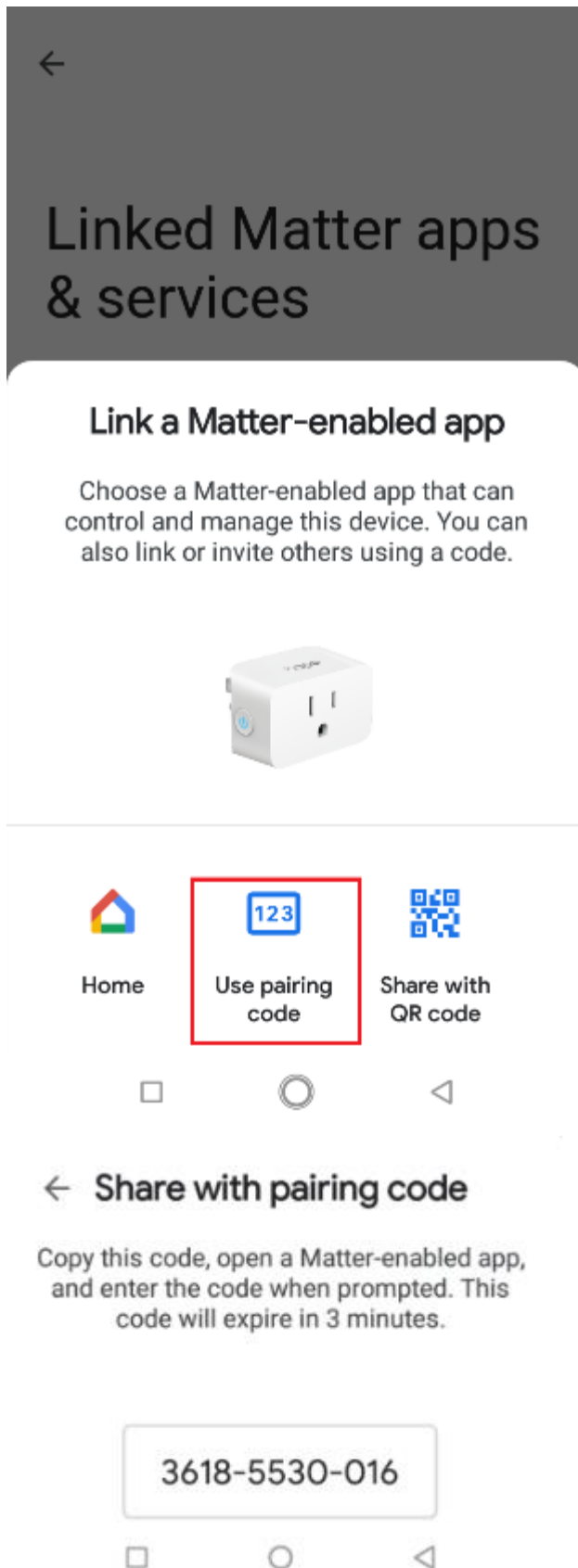

(3) Launch Another app and follow the setup instruction to enter the pairing code.

Note: Make sure that the pairing code page of Google Home remains open when you are setting up your Matter device in another app with the pairing code.

The pairing code will expire in 3 minutes.

Using a QR Code:

(1) Choose **Share with QR code**.



Linked Matter apps & services

Link a Matter-enabled app

Choose a Matter-enabled app that can control and manage this device. You can also link or invite others using a code.



Home



Use pairing
code



Share with
QR code



← Share with QR code

To allow others to control this device, they need to open a Matter-enabled app on their phone or tablet and scan this QR code. This code will expire in 3 minutes.



(2) Open the Apple Home app on another mobile device and scan this QR code.

Launch the other controller app and follow the setup instructions to enter the code. Follow the remaining on-screen instructions to complete the setup process.

For more instructions about Matter setup in Google Home, please refer to the link [Manage Matter-enabled devices in the Google Home app](#)

How to set up the Apple Home connected Matter device with another Matter-enabled third-party App

Launch your Home app, then go to the Device Settings page.



Matter Accessory



Powered On





Matter Accessory

Powered Off



Matter Accessory



Room

Bedroom

Display As

Outlet

Add to Home View



Include in Favorites



Tiles hidden from Home View will still appear in the Room View. Favorites will appear in their own section.

GROUP

Group with Other Accessories...

Group this accessory with others to treat them like one accessory.

Add Automation

Status



Tap **Turn On Pairing Mode**, then **Copy Code**.

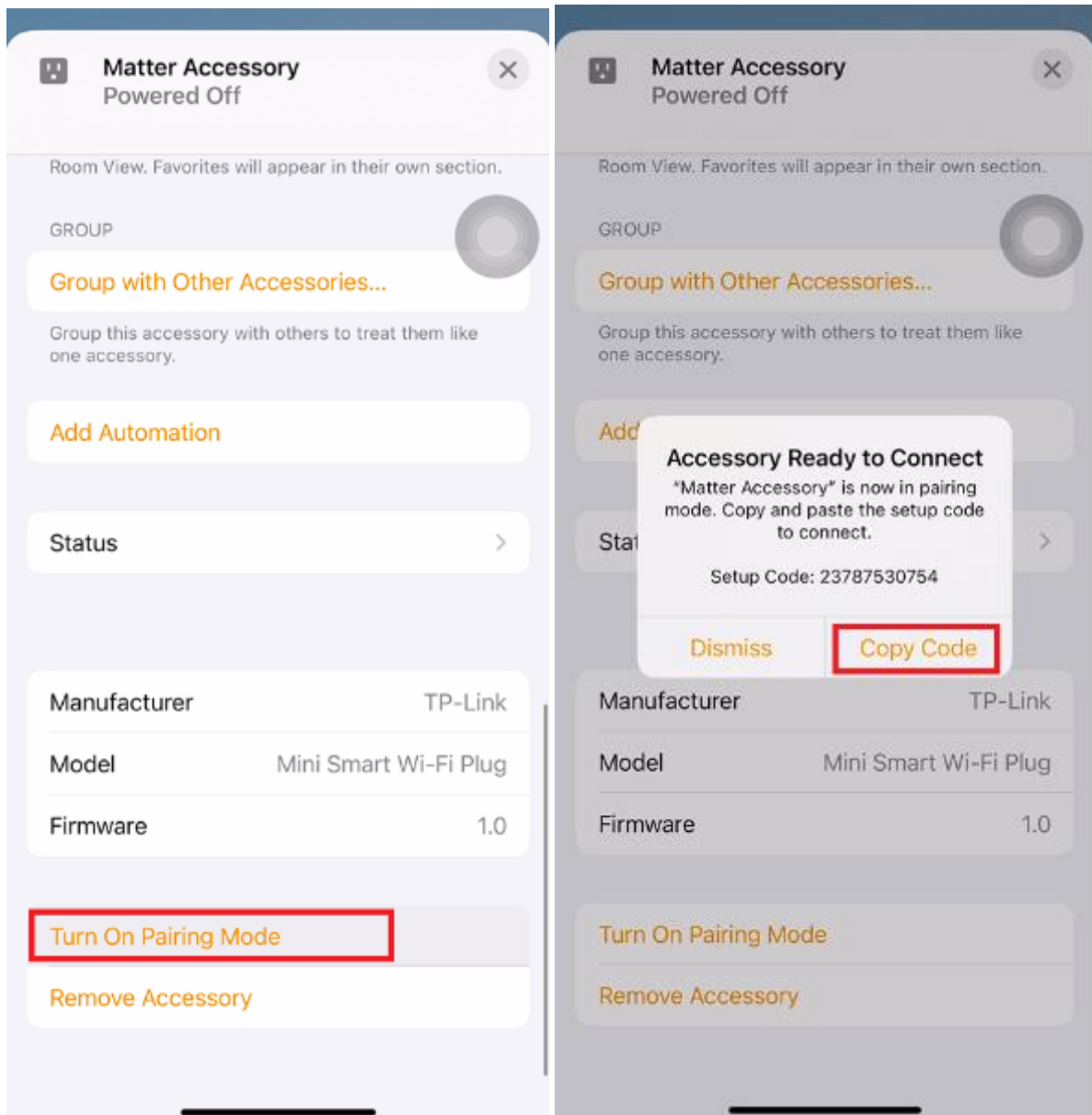

Launch the other controller app and follow the setup instructions to enter the code. Follow the remaining on-screen instructions to complete the setup process.

Note: If you Tap '**Dismiss**', you must wait 5 minutes to create a new code. Please copy the code or take a screenshot to keep the code. Alternatively, you can restart your device to generate a new code immediately.

The pairing code will expire in 5 minutes.

For more instructions about Matter setup in Apple Home, please refer to the link [Apple Home Matter support](#).

How to set up the SmartThings connected Matter device with another Matter-enabled third-party App

For Android SmartThings:

Launch your SmartThings app, tap your Matter device and tap the settings icon in the top right corner.

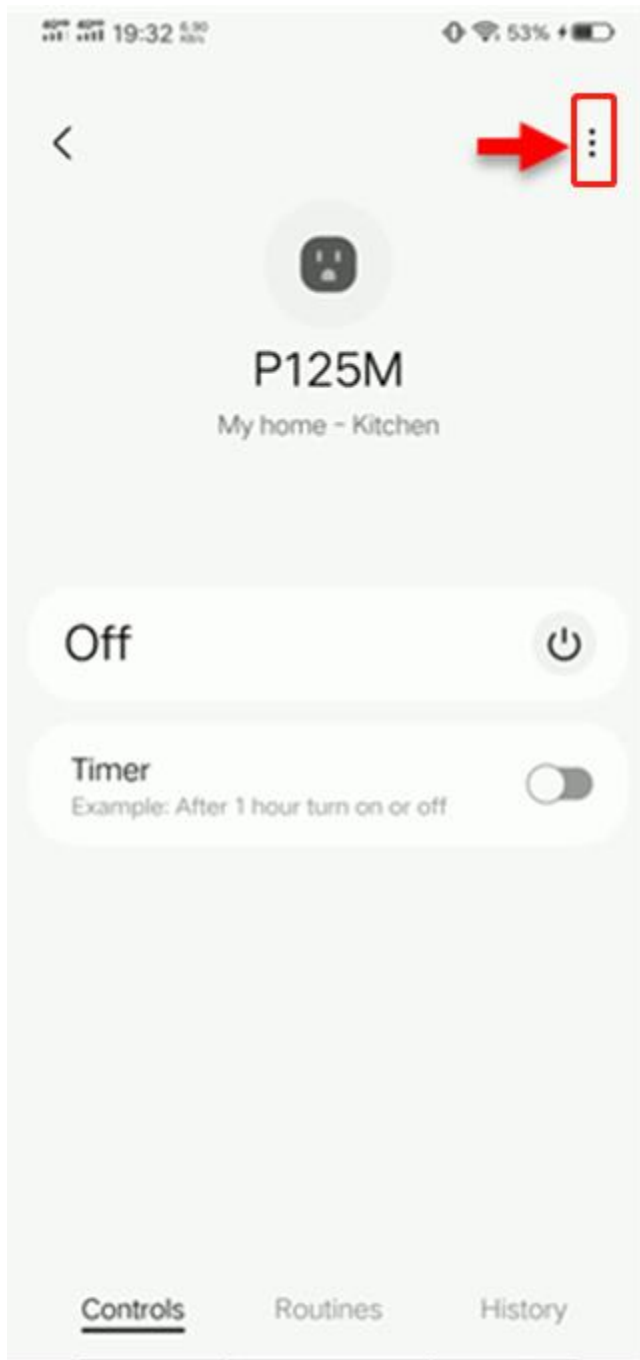

Tap **Share with other services**.

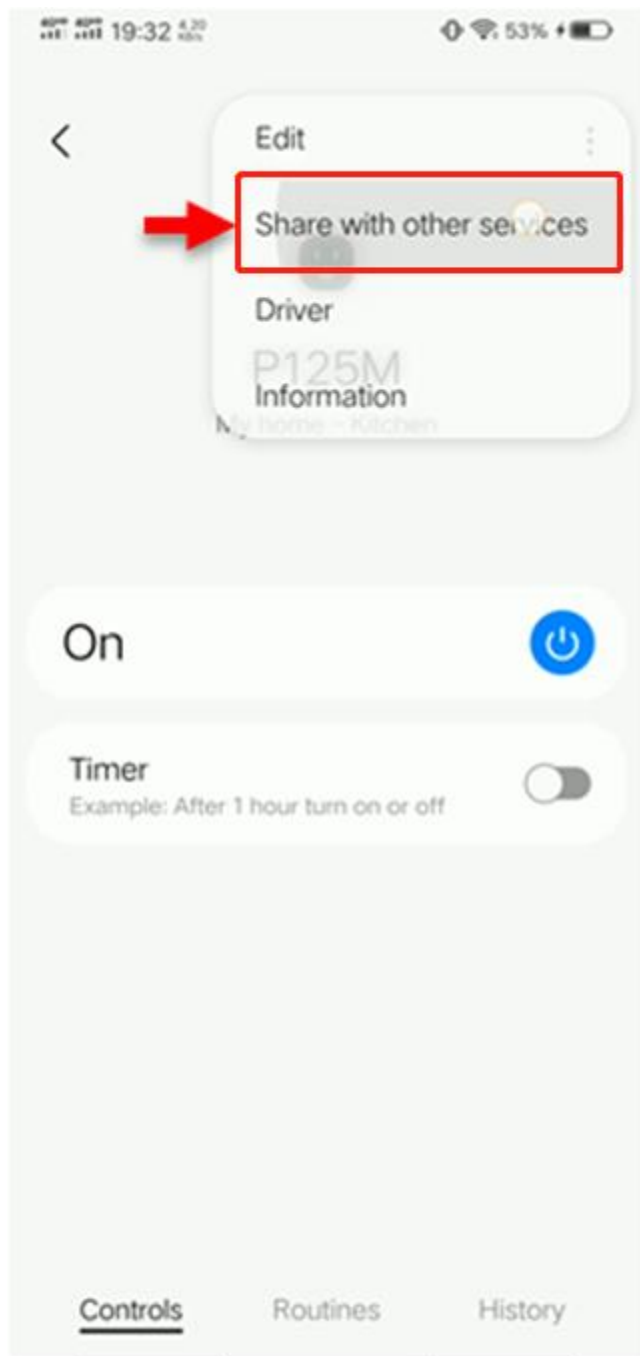

Share with other services.

(1) Tap **Share**, your Matter device can be shared to the available Matter service (Here take Google as an example, SmartThings APP has linked Google in advance.).

(2) Tap **QR code** to generate QR code and Numeric code. (The following process is for after tapping **QR code**.)

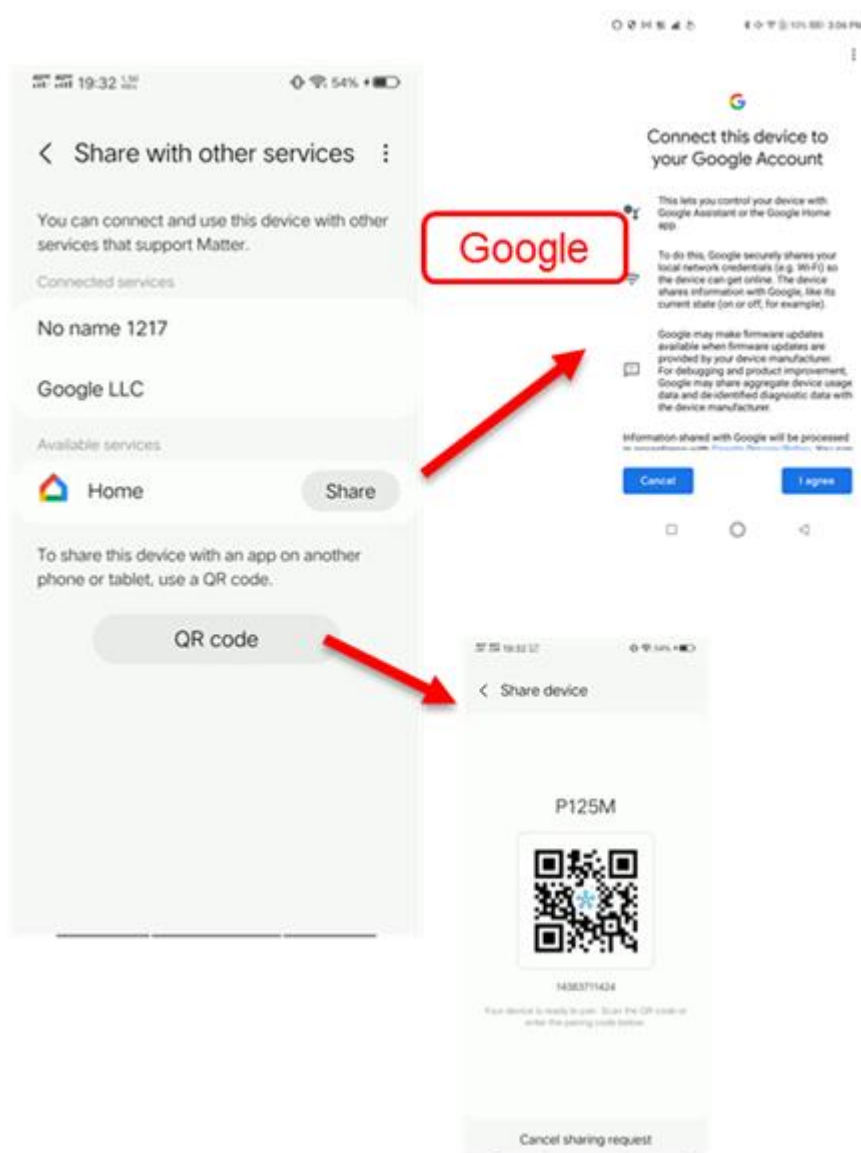

Launch the other controller app and follow the setup instructions to use the code. Follow the remaining on-screen instructions to complete the setup process.

Note: Make sure that the pairing code page of SmartThings remains open when you scan or enter the sharing code.

The pairing code will expire in 15 minutes.

For iOS SmartThings:

Launch your SmartThings app, Tap your Matter device and Tap the settings icon on the top right corner. Then tap **Share with other services**.

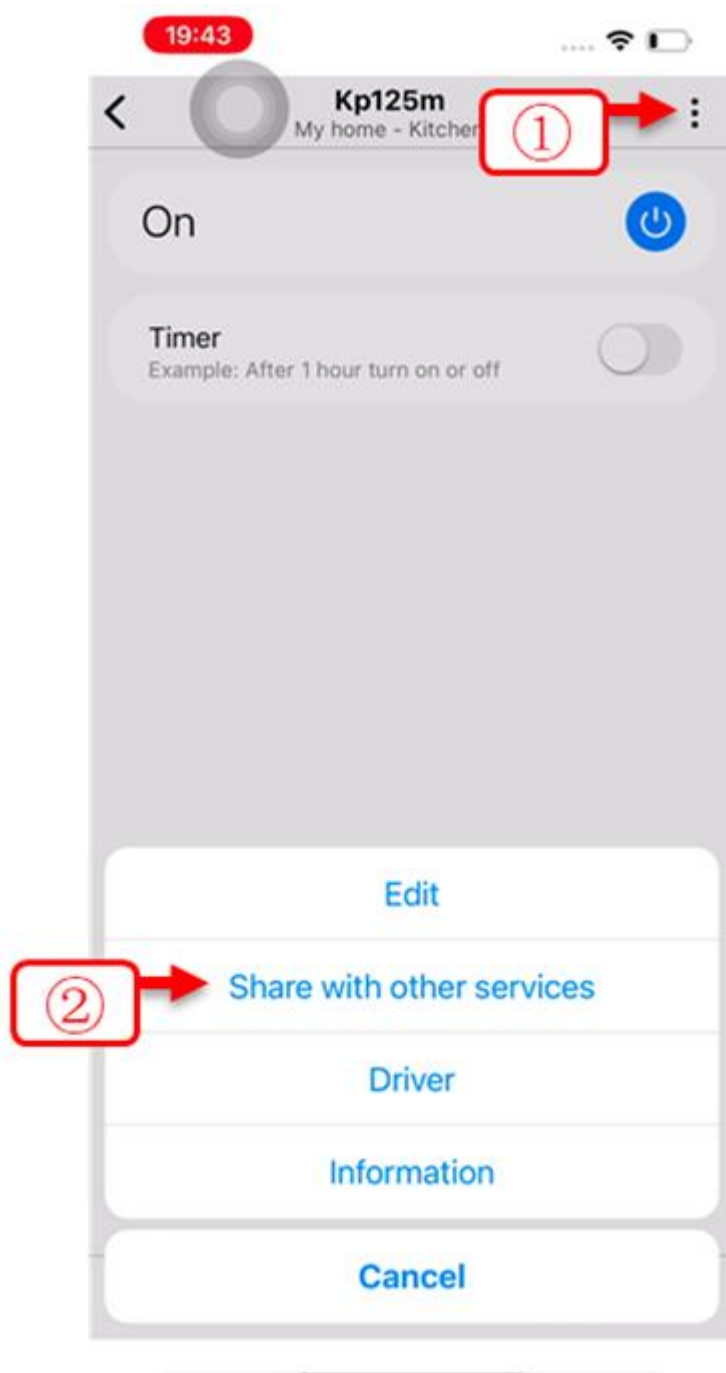

Tap **Share device** to generate QR code and Numeric code.

19:43



Share with other services



You can connect and use this device with other services that support Matter.

Connected services

Apple Keychain

Already Added



Share device



Launch the other controller app and follow the setup instructions to use the code. Follow the remaining on-screen instructions to complete the setup process.

Note: Make sure that the pairing code page of SmartThings remains open when you scan or enter the sharing code.

The pairing code will expire in 15 minutes.

For more instructions about Matter setup in SmartThings, please refer to the link [SmartThings x Matter Integration](#)

Supported Load types for UK plug

User Application Requirement

Updated 11-22-2023 03:22:33 AM  55

This Article Applies to: 

This article applies to:

All Tapo&Kasa plugs

The device load must Not Exceed the plug's power/current rating range specified in the below list. Otherwise, the relay contacts inside the plug will easily stick together, which may cause the plug to be unable to disconnect the power to the appliance.

Supported load types for the following models:

Tapo P110(UK) 1.0

Tapo P100(UK) 1.0/2.0

Tapo P105(UK) 1.0/2.0

Tapo P110M(UK) 1.0

KP105(UK) 1.0/2.0

KP115(UK) 1.0

Load Type	Max Current	Max Power(at 230V~)
Steam Iron	13A	2990W
Kettle	13A	2990W
Heater	13A	2500W
Toaster	13A	2500W
Coffee Maker	13A	2000W
Desk Lamp	0.75A	80W
TV	2A	350W
PC	3.5A	600W
Fan	0.7A	120W
Water Pump	0.7A	120W(1/6HP)
Power Adapter/ USB Charger *	1.2A	200W

Note:

1. *Power Adapters/USB Chargers under 75W do not support PFC (Power Factor Correction), while PFC can reduce the inrush starting current generated at the moment the relay is turned on. Therefore, using a 60-75W Power Adapter/USB Charger may damage the device due to excessive current.
2. Avoid plugging your appliances with a motor/compressor higher than 1/6HP, such as the air conditioner. Frequent switching may damage the compressor. You can check the motor/compressor value on your appliances or consult their Support.
3. EV charging is not supported since it typically has a higher power and its charging current required exceeds the rated current of the plug.

4. It's Not recommended that connect the plug to the power strip for powering on multiple load devices.

Supported load types for the following models:

KP303(UK) 1.0

Load Type	Max Current	Max Power(at 230V~)
Steam Iron	13A	2990W
Kettle	13A	2990W
Heater	13A	2500W
Toaster	13A	2500W
Coffee Maker	13A	2000W
Desk Lamp	0.75A	80W
TV	2A	350W
PC	3.5A	600W
Fan	1.0A	200W
Water Pump	3.5A	735W(1HP)
Power Adapter/ USB Charger *	1.2A	200W

Note:

1. *Power Adapters/USB Chargers under 75W do not support PFC (Power Factor Correction), while PFC can reduce the inrush starting current generated at the moment the relay is turned on. Therefore, using a 60-75W Power Adapter/USB Charger may damage the device due to excessive current.
2. Avoid plugging your appliances with a motor/compressor higher than 1HP, such as the air conditioner. Frequent switching may damage the compressor. You can check the motor/compressor value on your appliances or consult their Support.
3. EV charging is not supported since it typically has a higher power and its charging current required exceeds the rated current of the plug.

How to make my Tapo device (smart plug, smart camera, smart lighting) work with Amazon Alexa

Configuration Guide

Updated 08-04-2023 07:06:48 AM  305108

This Article Applies to: 

This guide will show you how to add your Tapo device to Amazon Alexa. Once added, you can use simple voice commands to control Tapo smart plug and smart bulb, or stream your Tapo camera videos to Amazon Echo Show or Fire TV.

NOTE: Please update both the Tapo APP and Tapo devices to the least one first.

To get started, make sure your Tapo device is set up and online. Here we take the Tapo camera as an example.

There are two options for connecting the Tapo device and Amazon Alexa.

Option 1. Open the **Tapo** app, go to **Me > Third-Party Services**, select **Amazon Alexa** and follow the app guidance.

Option 2. Open the **Amazon Alexa** app to add your Tapo device. Refer to the detailed instructions below.

1. Open the **Amazon Alexa** app. Then tap on **More** in the lower right corner and select **Skills & Games**.

9:18

📶 🔋 42%



Add a Device



Lists & Notes



Reminders & Alarms



Routines



Things to Try



Skills & Games



Blueprints



Settings



Activity



Home



Communicate



Play



Devices



More

2. Click the magnifying glass in the upper right corner and search for Tapo

15:16

Bluetooth, Signal, Wi-Fi, App Store, Battery 21%



SKILLS & GAMES



EN

Discover

Categories

Your Skills

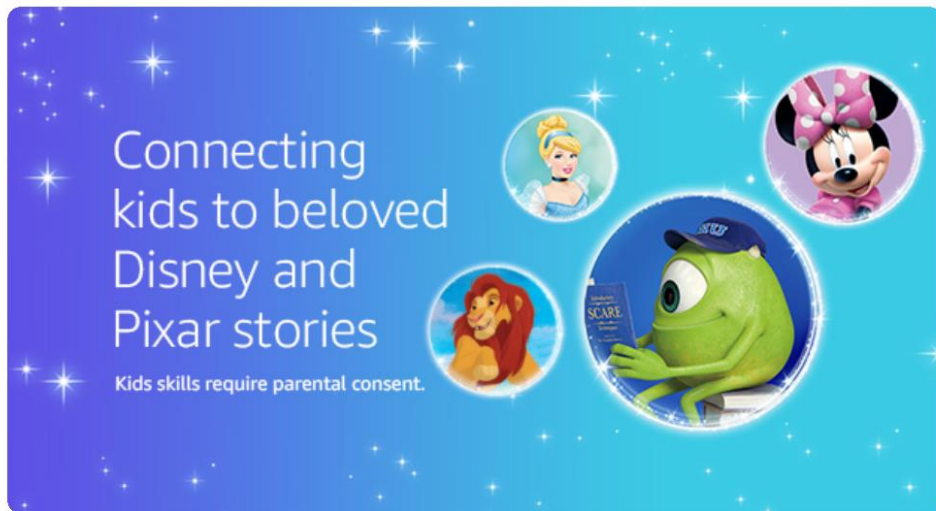

Disney Stories

"Alexa, open Disney Stories."

Magical stories read aloud

LAUNCH

setup required

Editor's Picks

[See More](#)



Cursed Painting

"Alexa, open Cursed Painting"

Games



Song Quiz

"11 ... 18 ... 0 ... i"



Home



Communicate



Play



Devices



More

15:17

Bluetooth, Signal, Wi-Fi, App Store, 21%



SEARCH

Search

Keyword or skill name

Tapo



tapo

tapo tp link

tapo camera

Tapo

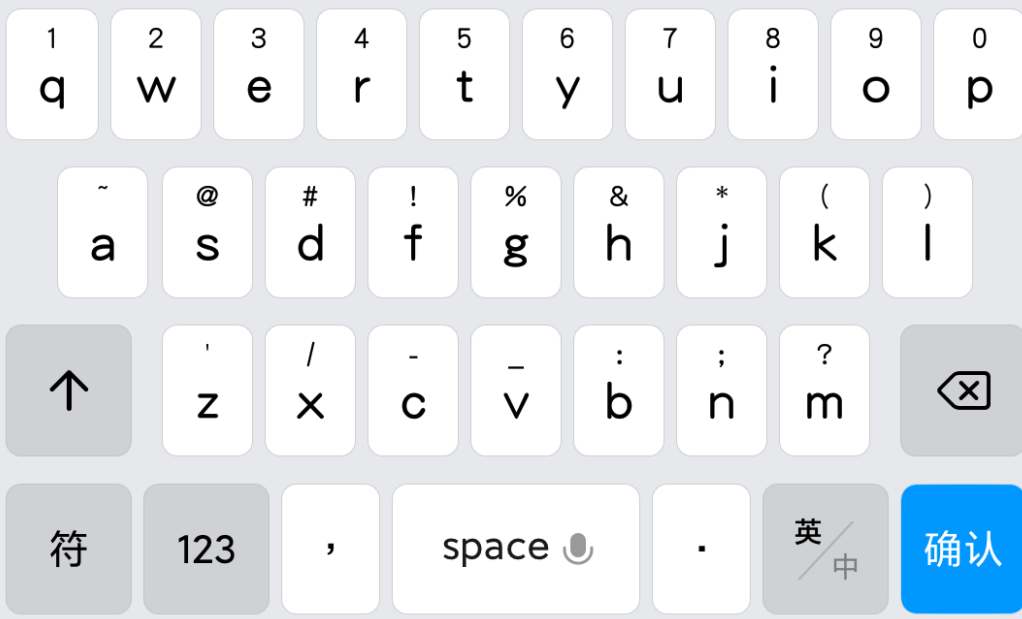

15:17

Bluetooth, Notifications, Wi-Fi, App Store, 20%



SEARCH

Search

tapo

1 Result

Sort: Relevance ▾



Tapo

"Alexa, change the brightness of bedroom lamp to 50%"

Smart Home



Home



Communicate



Play



Devices



More

3. Tap the **ENABLE** button.

15:55

📶 🔊 🔌 🔋 17%



TAPO



Tapo

TP-Link

Rated: Guidance Suggested



ENABLE TO USE

Account linking required

With the Tapo and Alexa, you can now access your Tapo smart plug via voice control by simply saying "Alexa, turn on my bedroom lamp.", access your Tapo camera via voice control by simply saying "Alexa, show my baby room camera.", and access your Tapo smar...

[See More](#)

Start By Saying

English (US) ▾

"Alexa, turn on my bedroom lamp"

"Alexa, turn off living room fan"



Home



Communicate



Play



Devices



More

4. Log in with your TP-Link ID that has bound to your Tapo device, and tap **Authorize**. After authorized successfully, the message **Tapo has been successfully linked** will come up. Close the window to go to the next step.

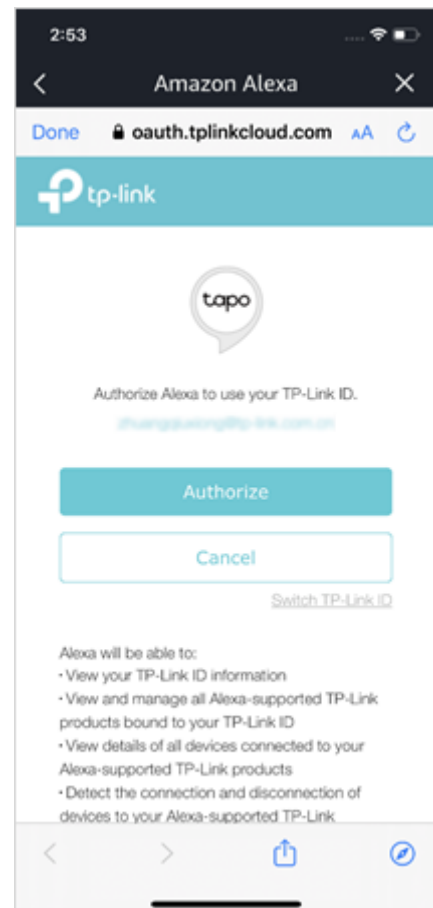
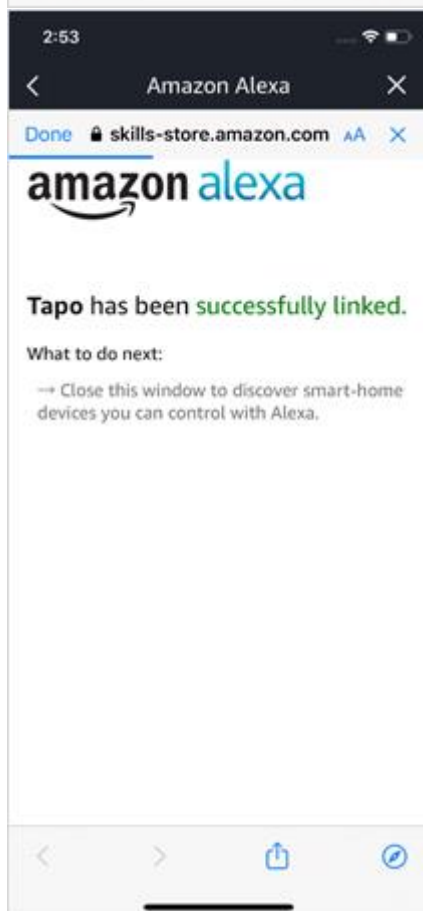
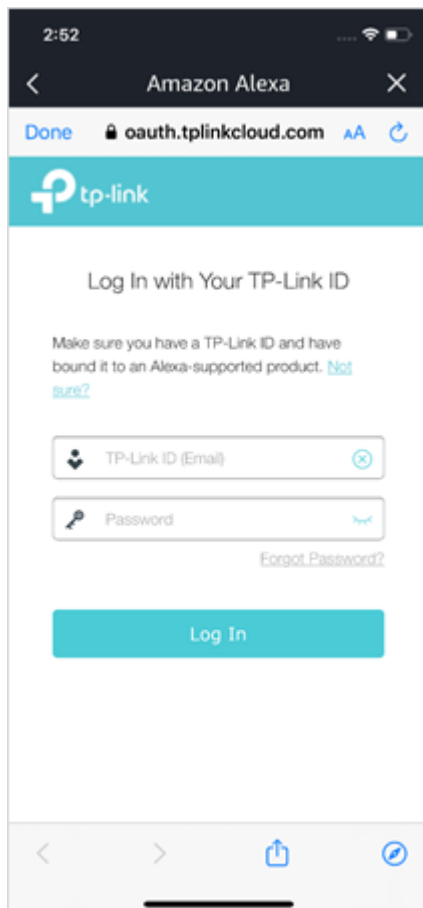

5. Tap the **DISCOVER DEVICES** button to discover devices bound to your TP-Link ID. And Tapo devices discovered are ready to use.

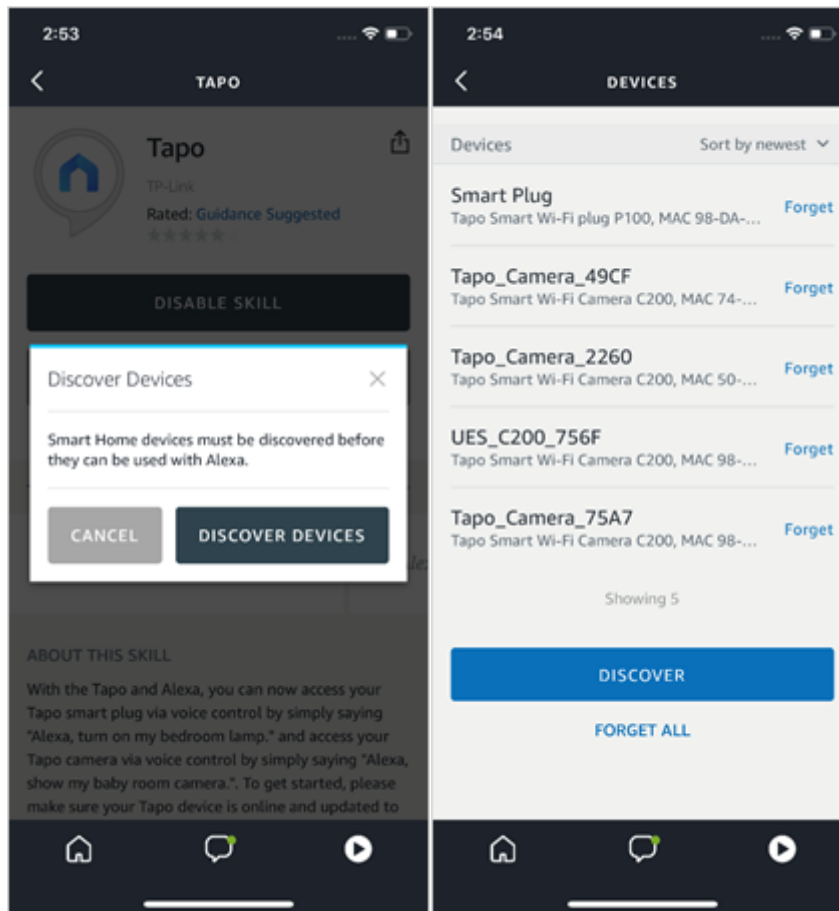

Enjoy!

You can stream your Tapo camera videos to Amazon Echo Show or Fire TV using simple voice commands. For example: “Alexa, show my *Living Room* camera”.

Note: Every time you change the name of the Tapo device, you will need to discover the device again to update its name.

The length of time you can stream the live feed on Amazon devices

Watching the live feed of Tapo cameras through Amazon Alexa will use your internet traffic as it's a Cloud-to-Cloud service. In consideration of your extranet traffic and performance, the live feed will stop automatically after 10 minutes. However, you can ask Alexa to show the camera again if you want to continue streaming.

Related FAQs

- [What should I do if I cannot make Tapo smart devices \(smart plug, smart camera, smart lighting\) work with Alexa or Google Home](#)
- [How to control Tapo camera by Amazon Alexa with voice commands](#)
- [How to control Tapo camera by Google Home with voice commands](#)
- [How to connect my Tapo device \(smart plug, smart camera, smart lighting\) to Google Home](#)