

Job Name \_\_\_\_\_

Purchaser \_\_\_\_\_

Submitted to \_\_\_\_\_

Unit Designation \_\_\_\_\_

Location \_\_\_\_\_

Engineer \_\_\_\_\_

Reference \_\_\_\_\_ Approval \_\_\_\_\_ Construction \_\_\_\_\_

Schedule # \_\_\_\_\_

MHC-015EE, MHC-015EEU			
Power	Rated Voltage	208V	230V
	Power Input	123W	150W

Applicable outdoor unit models

System	Model
DVM S Eco Heat Recovery	AM036NXMDCR/AA
	AM048NXMDCR/AA
	AM053NXMDCR/AA
	AM060NXMDCR/AA
DVM S Eco Heat Pump	AM036TXMDCH/AA
	AM048TXMDCH/AA
	AM053TXMDCH/AA

- MHC-015EE(U) base pan heater kit includes: base pan heater, control PCB and wire harness, and all necessary screws and clips for installation.

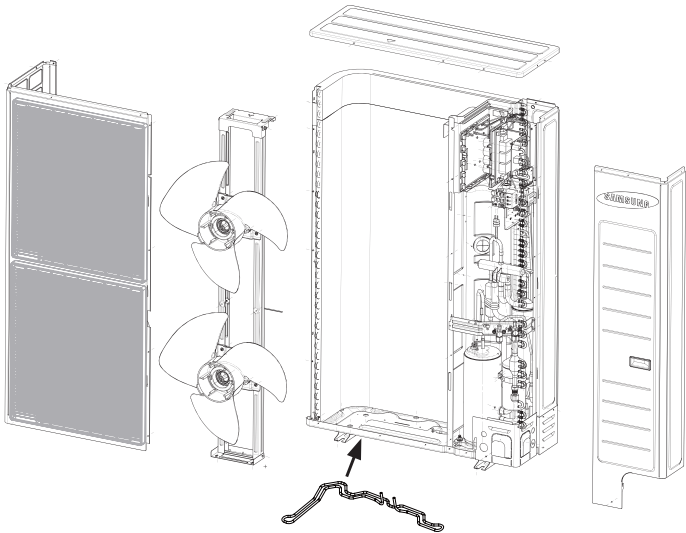

Description

- Base pan heater is used to prevent ice formation in the bottom of DVM S Eco outdoor units and to promote water drainage after defrost cycles in extreme low ambient temperatures.
- Powered and controlled by the DVM S Eco outdoor unit.
- The base pan heater control PCB will install inside the DVM S Eco outdoor unit.
- Application of base pan heaters is recommended when:
  - The outdoor unit will operate in low temperature, high humidity conditions for periods 72 hours or longer.
  - When outside temperatures will drop below freezing for 24 hours.
- The base pan heater shall activate when:
  - The outdoor unit is in heating or main heating mode and outdoor temperature is below 30°F (-1°C)
  - or
  - If snow accumulation prevention is enabled: When an outdoor unit has been idle for 30 minutes and outside temperature is 41°F (5°C) or lower the base pan heater will turn on every 30 minutes for 5 minutes and the fan will operate for 1 minute
- Outdoor option setting must be enabled for base pan heater use.

