

Ausanat



AN-H50
Ultrasonic Humidifier
User Manual



Get 24/7 Assistance at



Use camera or QR scanner to scan

Or Visit: <https://ausanat afterservice.vip>

ausanat@afterservice.vip

Product overview

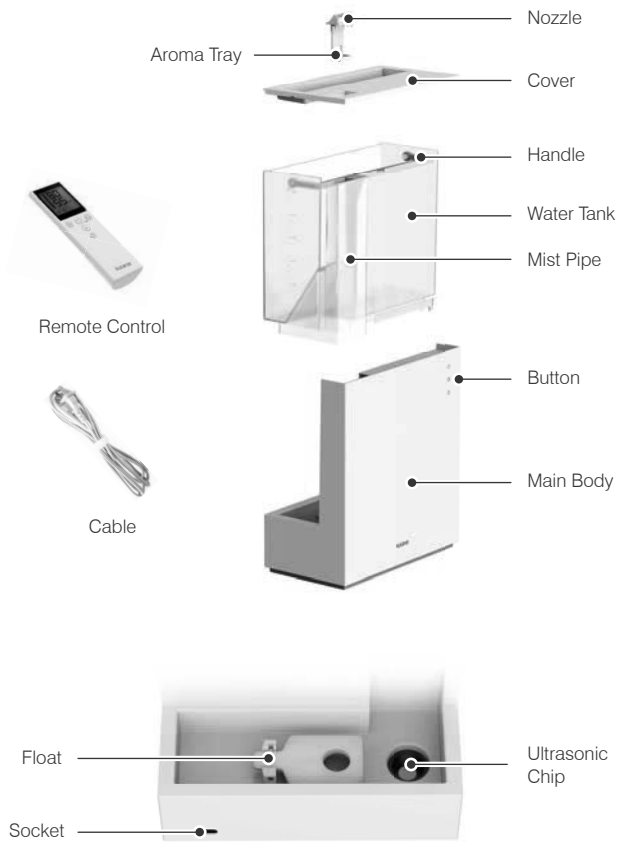



NOTE: Please take notice of below instructions and the separately included warning sheet before using the product.

FCC STATEMENT

1. This device complies with Part 15 of the FCC Rules. Operation is subject to the following two conditions:

(1) This device may not cause harmful interference, and
(2) This device must accept any interference received, including interference that may cause undesired operation.

2. Changes or modifications not expressly approved by the party responsible for compliance could void the user's authority to operate the equipment.

This equipment has been tested and found to comply with the limits for a Class B digital device, pursuant to part 15 of the FCC Rules. These limits are designed to provide reasonable protection against harmful interference in a residential installation. This equipment generates, uses and can radiate radio frequency energy and, if not installed and used in accordance with the instructions, may cause harmful interference to radio communications.

However, there is no guarantee that interference will not occur in a particular installation. If this equipment does cause harmful interference to radio or television reception, which can be determined by turning the equipment off and on, the user is encouraged to try to correct the interference by one or more of the following measures:

- Reorient or relocate the receiving antenna.
- Increase the separation between the equipment and receiver.
- Connect the equipment into an outlet on a circuit different from that to which the receiver is connected.
- Consult the dealer or an experienced radio/ TV technician for help.

Installation

- Please do not set up the device in a place where humidity directly hits curtains, furniture, indoor plants or doors. It can cause stains and deformation.
- Please place the device on a horizontal and stable surface, otherwise it might be a risk of water spilling.
- Please do not set up the device in a place where only children are present such as children's room. It can lead to injury or breakdown if the device is knocked over or climbed on.
- Please do not place the device anywhere where it may fall from above. It can lead to ignition or a breakdown.

- Please do not set up the device near devices that are not compatible with water such as PCs or smartphones. It can cause ignition or a breakdown.
- Please do not use up the device in any surrounding that could lead to the water in the water tray or in the device to freeze. However, if the water in the water tray or the device is frozen please do not operate the device until the ice has thawed. It can cause ignition or a breakdown.

Placement

Please place the device away from walls, window and furniture.

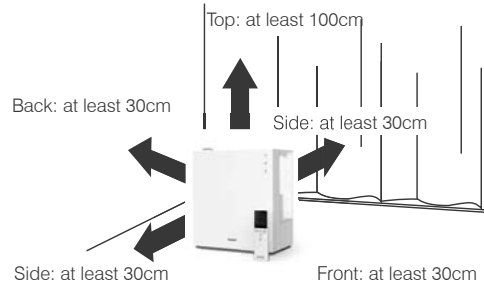

- Even when it is placed at a sufficient distance from walls or furniture, if it is used in the same place for a long period of time, it can become dirty with scale. We recommend regular cleaning. Please refer to maintenance instructions.
- Please avoid placing the device under direct sunlight.
- If there is interference with TV, radio or other electrical devices, please move the device.
- When moving the device, please hold the base of the device carefully.
- A comfortable humidity level is between 40-60%. If you notice condensation on the walls or windows you should turn off your humidifier as the humidity level is too high.

Filling the water tank

- 1 Pour the water slowly from the top.
- 2 Remove the cover, then fill the water tank.
Please do not fill water exceeding the max water line marked in the main body.
Please try to fill water slowly. And do not pour water into the air outlet and mist pipe. This will cause the mist to stop. If there is water in the mist pipe, remove the mist pipe and drain and try again.
- 3 Remove the water tank from the base. Fill the water tank under the tap directly. Do not pour water into the air outlet and mist pipe.

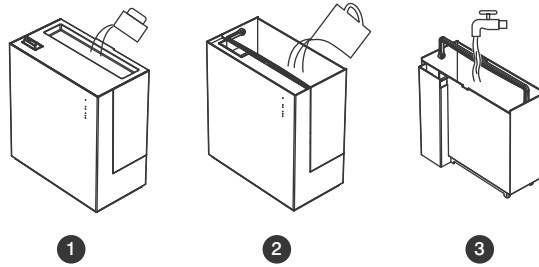

Operation

Plug the power cable into the power socket of the device, and insert the AC plug firmly into the outlet.

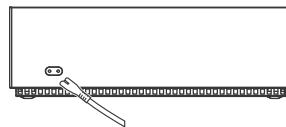

Control panel and function

Power indicator light — • (I) — Power

Timer indicator light — • (clock) — Timer

Mist volume indicator light — • (drop) — Mist volume

(I) Power button

When connecting the power, the power indicator light will turn red, and the device will be standby. Touch the button, the device will be turned on/off.

(clock) Timer button (2/4/6hours)

When you touch the timer button for the 1st time, the timer will be set 2 hours. When you touch the button for the 2nd time, it will be set 4 hours. When you touch the button for the 3rd time, it will be set 6 hours. Each time you touch the setting button, the display of humidifier indicator light is as below.

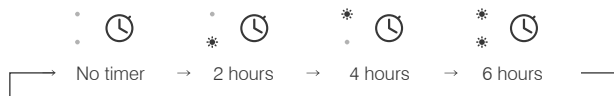

Remaining time	4 to 6 hours	2 to 4 hours	less than 2 hours
Indicator light	* (clock) *	* (clock) .	. (clock) *

💧 Mist volume setting button

The mist volume can be set in three-stage: about 120(low) /170(medium) / 220(high) ml/h. Each time you touch the setting button, the display of humidifier indicator light is as below.



Remote control

The device also synchronizes with the remote control when operating the speed, timer and switching the device on and off. Remote control for 2.4 g induction, 360 degrees operation and remote operation (more than 10 meters).

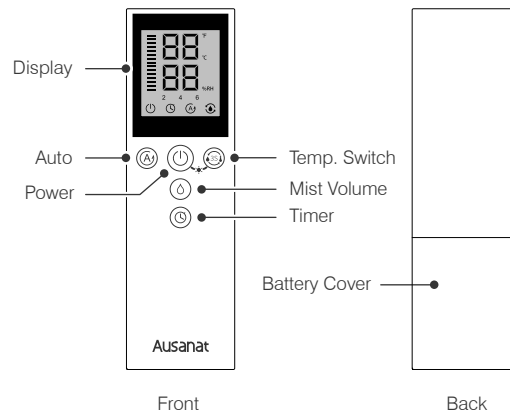

Display

15s without operation, remote Control will automatically light off, and you can press the button to light up the screen.
Displayed on the remote control are synchronized with the contents displayed on the device.

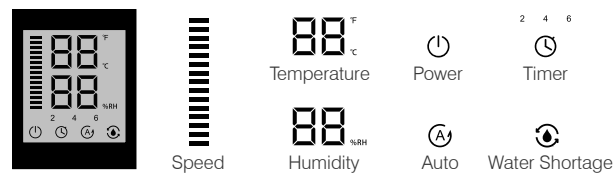

 Power button

When connecting the power, the power indicator light will turn red, and the device will be standby. Touch the button, the device will be turned on/off.

 Timer button (2/4/6hours)

You set 2/4/6 hours by pressing the timer button, in the same time, the display will show: 2/4/6.

 Mist volume setting button

The default speed is low speed, press the button to cycle with five indicators per speed (low, medium, high).

 Auto button

Press the auto button, the device will adjust automatically according to humidity.

 Temp. Switch button

Long press the temp. switch button for 3s to switch the temperature.
The device can be turned off by the switch button to see the current temperature and humidity.

How to add the aroma

Hold on the handle of the aroma tray, and then remove the aroma tray.

Drop 1~2 drops onto the aroma cotton.

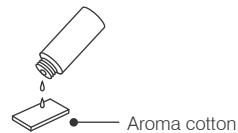
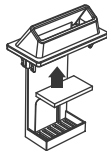

Specification

Size: 322*280*153mm

Weight: 2.2kg

Main materials: HIPS, ABS, GPPS, PP

Voltage: AC100~240V 50/60Hz

Power consumption: 22W

Water tank capacity: 5L

Mist output: 220ml/h Max

Timer: 2/4/6 hours

Manufacturer information

Manufacturer: Guangdong Mixwell Technology Co., Ltd.

Address: 1-4#F, A Building, NO.7 Yu Hua Street, 138 Industrial Area,
Tangxia, Dongguan, China

Disclaimer

Thank you for purchasing our product! By using this product, you hereby signify that you have read the Disclaimer and all warnings carefully and that you understand and agree to abide by the terms and conditions herein. The user should observe safe and lawful practices including, but not limited to, those set forth in this document. Our company therefore holds no liability for damages caused by force majeure, used by a third party, incorrect use, non-compliance with this user manual or intentional misconduct on the part of the user.

Except for the scope prohibited by the applicable laws, the company is not responsible for any incidental, indirect, special or consequential damages, including but not limited to the loss of profits, income or data due to the violation of explicit or implied warranties or conditions mentioned in this user manual.

Information in this user manual is for informational purposes only. It is subject to change without prior notice, due to the manufacturer's continuous development program. This document supersedes and replaces all information supplied prior to the publication hereof.

Warranty

We warrants all products to be of the highest quality in material, craftsmanship, and service. It is effective starting from the date of purchase. We will replace any product found to be defective due to manufacturer flaws based on eligibility. Refunds are only available to the original purchaser of the product. This warranty extends only to personal use and does not extend to any product that has been used for commercial, rental, or any other use in which the product is not intended for. There are no warranties other than the warranties expressly set forth with each product.

This warranty is non-transferrable. We are not responsible in any way for any damages, losses or inconveniences caused by equipment failure or by user negligence, abuse, or use noncompliant with the user manual or any additional safety, use, or warnings included in the product packaging and manual.

This warranty does not apply to the following:

- Damage due to abuse, accident, alteration, misuse, tampering or vandalism.
- Improper or inadequate maintenance.
- Damage in return transit.
- Unsupervised use by children under 18 years of age.

we assume no liability for damage caused by the use of the product other than for its intended use or as instructed in the user manual. Some states do not allow this exclusion or limitation of incidental or consequential losses so the foregoing disclaimer may not apply to you. This warranty gives you specific legal rights and you may also have other rights which may vary from state to state.

RF Exposure

The device has been evaluated to meet general RF exposure requirement.

The device can be used in portable exposure condition without restriction

Get 24/7 Assistance at



Use camera or QR scanner to scan

Or Visit: <https://ausanat.afterservice.vip>

ausanat@afterservice.vip



MADE IN CHINA