



- Software update
- User manual
- Product guide
- Limited warranty

SOFTWARE UPDATE

※ **IMPORTANT: MAKE SURE YOUR SOFTWARE VERSION IS UP TO DATE**

1. Check your software version.



1. Pair the keyboard with your smartphone.
(Note: You'll need to pair with your smartphone only to perform the update.)
2. Please open any application that you can type.
3. Press and hold the Fn key and press the following keys in the correct order.
[V]→[E]→[R]→[S]→[I]→[O]→[N]
4. Please take your finger off the key.
5. Your software version will be showing on the screen.
6. Please proceed to update your keyboard if your software version is not a latest version.

How to pair Bluetooth



1. Press and hold the "fn" key and press one of the Bluetooth "Channel keys" (F9, F10, F11) for 2 seconds.
2. When the LED indicator at the top of the "Channel key" blinks, the pairing is ready.
3. Find and select "Mokibo" in the Bluetooth setting window of your smart device.
4. Confirm your pairing if you are asked.
5. Pairing is successful when the LED stops flashing.

2. Check before updating

1. iPhone or Android phone

Updating the keyboard is only available on iPhone or Android phone.

2. Battery

Please check your battery level first by pressing Fn key and F8. If the red color shows up, please charge your keyboard. Yellow or Green is totally fine to update your keyboard.

3. Chrome Browser

We would recommend you use Chrome Browser, but still, you can use other browsers too.

3. Download and install following application

1. iPhone

Select the app showing the below image for iOS.
Or download "nRF Toolbox" on your apple device from the app store.

2. Android

Select the app showing the below image for Android.
Or download "DFU" from the play store.



SOFTWARE UPDATE

4. Check the Model and download the software.

Product	Universal	For iPad Pro 11"	For iPad Pro 12.9"
Model	MKB420-U1	MKB420-A11	MKB420-A12



Software



5. Please open the file you downloaded.



• iPhone

1. Please complete downloading the file.
 2. Please touch "Open in..."
 3. Choose "nRF Toolbox"
- * In case that you can't find "nRF Toolbox", please touch "... (more)" icon.
- * Still you can't find "nRF Toolbox", please re-install the app.

• Android

1. Please complete downloading the file.
2. Please touch "Open".
3. Please select "DFU".
4. In case you can't find "DFU" icon, please reinstall the app again.

SOFTWARE UPDATE



6. Find DFU and Select on the application.

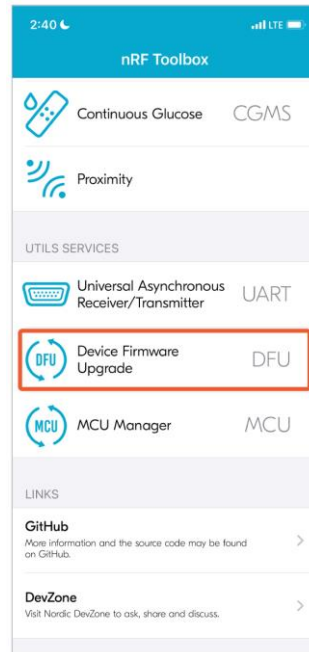

- **iPhone**

1. Please select "DFU" in the UTILS SERVICES section.



6. Select the latest update file.

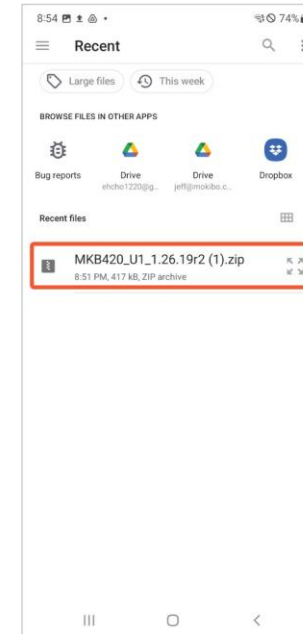
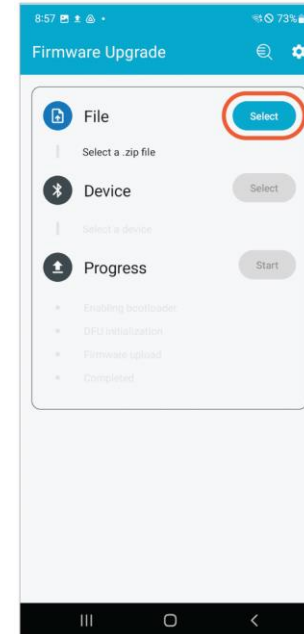

- **Android**

1. Please touch "Select" button.
2. Select the software file you downloaded.

SOFTWARE UPDATE



7. Set your keyboard with the Update mode.



- **iPhone**

1. Press and hold Fn key and press the following keys in correct order.
[U]→[P]→[D]→[A]→[T]→[E]
2. Please take your finger off from the key.
3. Four LED lights will be blinking three times with the green color.
4. The LED light above "F8" key will change to the light blue color.
5. Completed to set your keyboard with the software update mode.



android

7. Set your keyboard with the Update mode.



- **Android**

1. Press and hold Fn key and press the following keys in correct order.
[U]→[P]→[D]→[A]→[T]→[E]
2. Please take your finger off from the key.
3. Four LED lights will be blinking three times with the green color.
4. The LED light above "F8" key will change to the light blue color.
5. Completed to set your keyboard with the software update mode.

SOFTWARE UPDATE



8. Connect "Mokibo Update" channel.

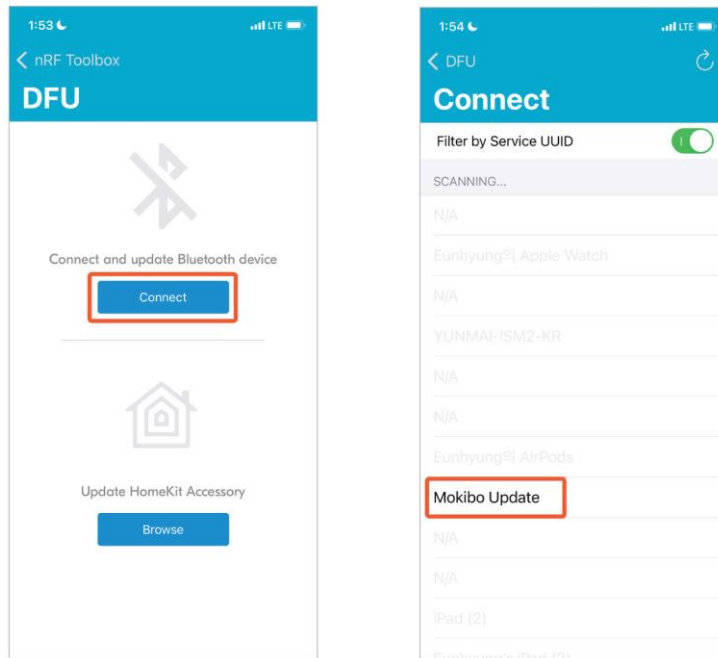

• iPhone

1. Please select "Connect" on nRF Toolbox
2. Find "Mokibo Update" channel and select.
 - * Please DO NOT select "Mokibo CH1" or "Mokibo folio".
 - * If you can't find "Mokibo Update", please go to the step 7 and try it again.



android

8. Connect "Mokibo Update" channel.

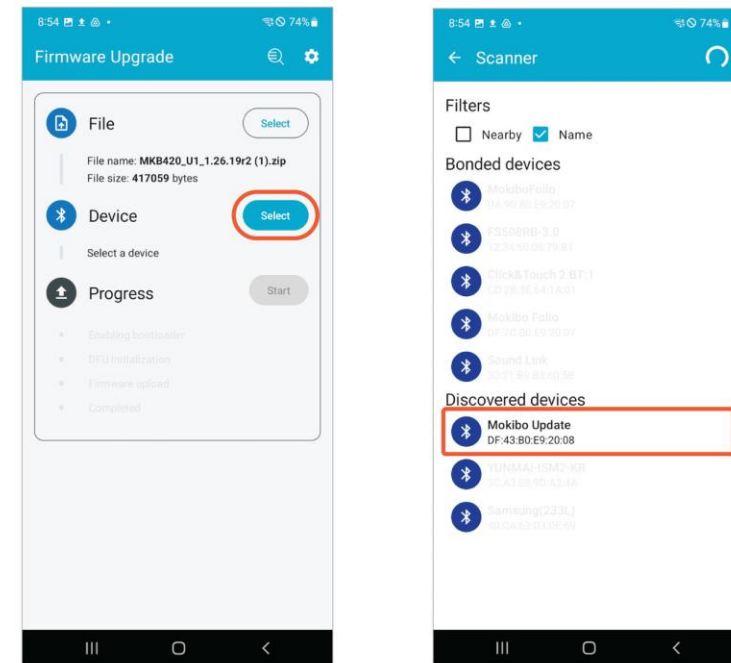

• Android

1. Please touch "Select" in Device category.
2. Find "Mokibo Update" channel and select.
 - * Please DO NOT select "Mokibo CH1" or "Mokibo folio".
 - * If you can't find "Mokibo Update", please go to the step 7 and try it again.

SOFTWARE UPDATE



9. Select the Update file.

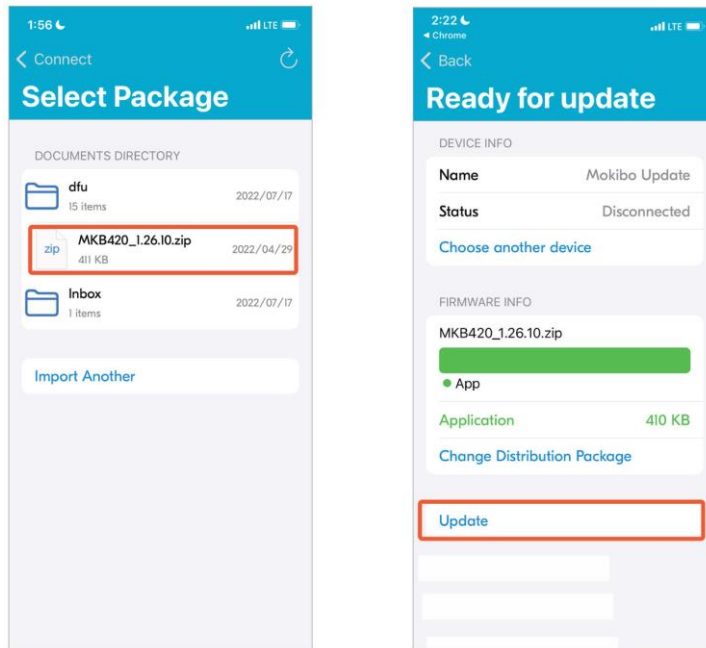

• iPhone

1. Please select the latest version of software.
2. Select "Update"
3. Now, your keyboard is updating.
4. Please wait until the updating is completed.
5. Once it is completed, please touch "Done" button.



android

9. Proceed your update!

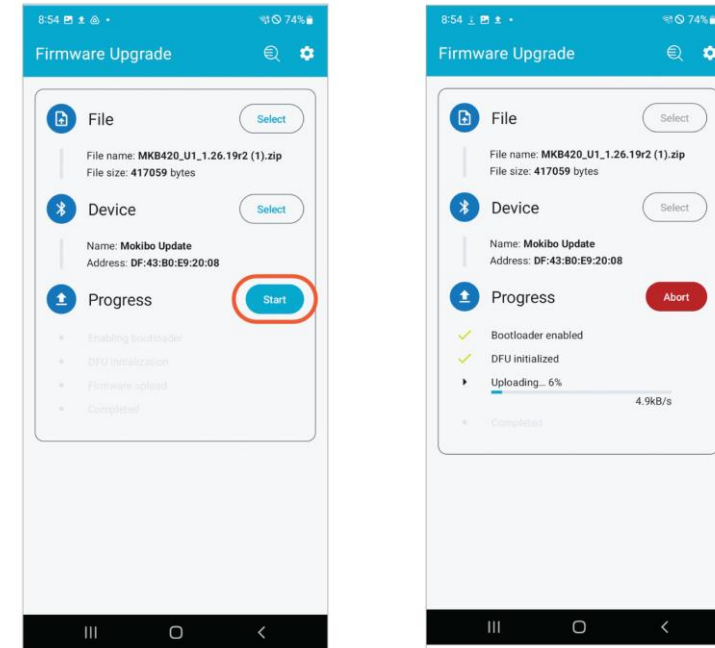

• Android

1. Please press "Start" button in Progress category.
2. Wait until the progress bar reaches to 100%.
3. Once it is completed, please touch "Done" button.

SOFTWARE UPDATE



10. Congratulation! Your keyboard is successfully updated.

• iPhone / Android

1. Please turn off and on your keyboard. (just close the cover and open)
2. Delete all Mokibo pairing information from your smart device.
3. Please pair again.
4. Please double-check your software version is up-to-date.
5. **Your keyboard is successfully updated.**

How to check software version



1. Pair the keyboard with your smartphone.
(Note: You'll need to pair with your smartphone only to perform the update.)
2. Please open any application that you can type.
3. Press and hold the Fn key and press the following keys in the correct order.
[V]→[E]→[R]→[S]→[I]→[O]→[N]
4. Please take your finger off the key.
5. Your software version will be showing on the screen.

How to pair Bluetooth



1. Press and hold the "fn" key and press one of the Bluetooth "Channel keys" (F9, F10, F11) for 2 seconds.
2. When the LED indicator at the top of the "Channel key" blinks, the pairing is ready.
3. Find and select "Mokibo" in the Bluetooth setting window of your smart device.
4. Confirm your pairing if you are asked.
5. Pairing is successful when the LED stops flashing.

USER MANUAL

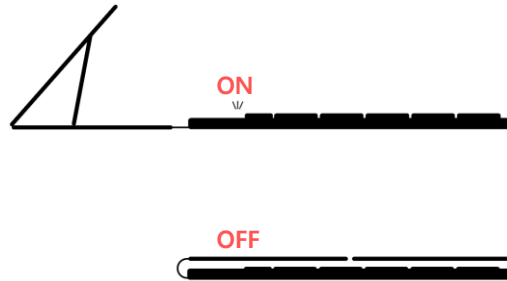

1. Power On/Off

- Power is turned on automatically when the cover is opened.
- The LED channel indicator will blink and stop.
- Pressing the "fn" key will light an LED to indicate the current battery level and paired channel.
- When the cover is closed, the power is turned off.
- When the power is turned on and there is no input for 20 minutes, it enters hibernation mode to save power. If any input is received in hibernation mode, it will return to active mode.



2. Bluetooth pairing

- Press and hold the "fn" key and press one of the Bluetooth "Channel keys" (F9, F10, F11) for 2 seconds.
- When the LED indicator at the top of the "Channel key" blinks, the pairing is ready.
- Find and select "Mokibo" in the Bluetooth setting window of your smart device.
- Confirm your pairing if you are asked.
- Pairing is successful when the LED stops flashing.



3. OS selection

- Press and hold the "fn" key and press the "OS selection key" (F12) repeatedly until the color you want is displayed on the LED channel indicator.



- The OS selected for each of the three Bluetooth channels is memorized until Bluetooth is reset by step 2.
- For Linux, set as Windows OS(blue color).

USER MANUAL



4. Multi-pairing

- Repeat steps 2 and 3 with different "Channel keys"(F9~F11). You can pair it with up to three devices.
- If you want to change the paired device, press the "fn" key and the corresponding "Channel key" shortly.
- The LED will blink for a short time (2-5 seconds) and then stop.
- Channel switching is complete.



5. Left, Right Click

- The red key in the center of the space bar works the same as the normal left-click button of the mouse.
- If you press and hold the "fn" key and press the red key, it works the same as the right-click button of a normal mouse.
- If you tap the touch area with one finger once, it works as the left-click button of a normal mouse. A double-tap is a double-click, and a triple-tap is a triple-click.
- If you tap the touch area once with two fingers, it works as a right-click button of a normal mouse.



6. Scrolling

- If two fingers are placed on the keyboard(not pressed) and moved up, down, left and right, it functions as up-down scrolling, left-right scrolling.

USER MANUAL



7. Active touch area

- Mokibo has a right-handed mode and a left-handed mode, and the area used as the touchpad is as shown in the figure above. By default, it is set to right-handed mode.
- For how to set right-handed mode and left-handed mode, refer to the 9.User settings section.



8. Dynamic Touch Area (DTA)

- When a touch input crosses the boundary of the active touch area, the touch area automatically extends to the Dynamic Touch Area (DTA).

9. User settings

- If you press and hold the “fn” key and press the word below, the user settings are activated.

✓ Left-handed mode

Fn + L E F T

✓ Right-handed mode

Fn + R I G H T

✓ Update mode

Fn + U P D A T E

- Place the cursor in notepad and press the next keys to print the information.

✓ Print battery level

Fn + B A T T E R Y

✓ Print software version

Fn + V E R S I O N

✓ Print HELP information









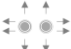

Fn + H E L P

10. Combination key

	Function
 + 	Home
 + 	Mic mute*
 + 	Camera mute*
 + 	Speaker mute
 + 	Volume down
 + 	Volume up
 + 	Screen shot
 + 	Battery level
 + 	Virtual keyboard
 + 	Bluetooth CH 1
 + 	Bluetooth CH 2
 + 	Bluetooth CH 3
 + 	OS Selection
 + 	Insert key
 + 	Touchpad off-on

* Works with Zoom and WebEx video conferencing programs and supports Windows, iPad, and Mac. (Android not supported)

11. Gestures

Gestures	Windows	Android	iPad	Mac
	Scrolling	Scrolling	Scrolling	Scrolling
	Switch web pages	Switch web pages	Switch web pages	Switch web pages
	Zoom in/out*	-	-	Zoom in/out*
	Mission control	All open apps	All open apps	Mission control
	Desktop	Home	Home	Application windows
	Previous app	Previous app	Previous app	Previous app
	Select task	Select task	Select task	Select task
	Search bar	Search bar	Show dock	Look up
	Mission control	All open apps	All open apps	Mission control
	Desktop	Home	Home	Application windows
	Switch desktops	-	-	Switch desktops

* Transmit Control +/- on Windows and Android, and cmd +/- on iPad, supported only by some apps.

CAUTION

1. Do not disassemble the keycaps from the keyboard.
2. Please prevent liquid, dust, and debris from entering the keyboard.
3. If your keyboard becomes contaminated, clean the affected part of the keyboard with warm water. DO NOT submerge the entire keyboard in water. Once cleaned, make sure to dry the keyboard completely before use.
4. DO NOT press, twist, or bend the keyboard.
5. Use only the certified charger for charging the Fusion keyboard.
6. DO NOT use the keyboard in environments that are too hot or humid.

⚠ Please make sure that your keyboard is unplugged from the power.
 ⚠ Any damages caused by the above reasons or being exposed to unusual circumstances may not be covered by the warranty.

mokibo

©2023 Mokibo, Inc., All right reserved.

Product guide

⚠ WARNING: Improper installation, use, or careless handling of the product can cause serious injury, death, or damage of the device.

Read this product guide and keep all of your printed guide materials for future reference.

⚠ Important safety information

1. Device using battery power

The following precautions apply to every product that uses rechargeable or disposable batteries. Improper use of batteries may cause electrolyte leakage, overheating or explosion. Leaked battery electrolyte is corrosive. Therefore, it may be toxic. Skin or eye contact may cause burns. It is harmful if swallowed.

2. To reduce the injury risks

- Keep the battery out of children's reach.
- Do not disassemble, heat, cut, incinerate, or pierce the battery with sharp objects.
- Do not mix up the battery with new batteries, used batteries, or different types of batteries (i.e. zinc-carbon batteries and alkaline batteries).
- Do not allow metal objects to reach the battery terminals of the device. It may cause overheating and burns.
- Disconnect the battery from the device if the device has not been used for a long time or when the battery is expired.
- Expired batteries must be immediately removed from the device and recycled or disposed of in accordance with local or international waste treatment regulations.
- Remove all batteries if one of the batteries is leaked and make sure that the electrolyte leaking from the battery does not get on your skin or clothing. If electrolyte from the battery gets on your skin or clothing, immediately wipe it off with water. Before putting in new batteries, wipe the battery compartment thoroughly with a paper towel moistened with water or clean it using the method recommended by the battery manufacturer.

3. Wireless device

Remove the battery or turn off the power (if there is a power switch) of the wireless device before you go on a plane or put the wireless device on cargo that passes through an airport security checkpoint. When the wireless device is accidentally powered on with the battery in place, it will send a radio frequency (RF) signal just like a cell phone.

4. Game controller, keyboard and mouse device

[Health information]

The use of game controller, keyboard, mouse, and other electronic input devices can lead to serious injuries or disabilities. If you use your computer for too long, you may feel uncomfortable on your hands, arms, shoulders, throat, or other parts of the body. Do not take these issues lightly if such discomforts, pain, stiffness, soreness or paralysis continue or occur repeatedly. If symptoms persist even while you are not working on the computer, consult a medical specialist immediately. Such symptoms can cause pain in the nerves, muscles, tendons or other parts of the body, which can lead to permanent injury or disability to the musculoskeletal system. Examples of musculoskeletal disorders (MSD) include carpal tunnel syndrome, tendinitis, and aponeurosis. The direct cause of MSD has not been found yet, but it is known to be related to individual's health and physical conditions, stress, how to relieve stress, habits while working on a computer, posture (including mouse and keyboard use), and work time. Consult a medical specialist about your lifestyle, activities, or your physical and health conditions.

[Photosensitive epilepsy]

A very small number of people get a seizure when they are exposed to flashing lights, or visual images such as a wooden pattern in video games. Even those without the history of seizure or epilepsy can also experience such "photosensitive epilepsy" for unknown reasons while playing video games. Photosensitive epilepsy has a variety of symptoms, such as dizziness, hallucinations, eye twitching or face convulsions, spasms or tremors in the arms or legs, loss of direction, delirium, and temporary loss of consciousness. In addition, seizures can lead to unconsciousness or convulsions that can throw down or hit nearby objects. If you experience any of these symptoms, stop playing the game immediately and consult a medical specialist. Because children and adolescents are more prone to seizures than adults, parents should see if their child has any of these symptoms. To reduce the risk of photosensitive epilepsy, take the following precautions.

- Keep a distance from the TV screen.
- Use a small screen TV.
- Play games under bright lights.
- Do not play games when you are tired or drowsy

If you or your relatives have a history of seizures or epilepsy, consult a medical specialist before playing a game.

[Prohibition of disassembly and self-repair]

Do not disassemble, disseminate, repair, or alter this product. There is a danger of electric shock. If there is any evidence of disassembly and / or alteration of the device, including label damage or removal, it will void the Limited Warranty.

[Choking hazard]

Keep the small parts contained in this device out of the reach of toddlers under the age of three due to choking hazards.

[Usage and cleaning]

Use the device in accordance with following instructions.

- Do not use the device near a heat source.
- Use the components or accessories designated by MOKIBO.
- Use a dry cloth for cleaning.

• Do not allow water to enter the product. Do not expose the product to rain, humidity, or moisture to reduce the risk of fire or electric shock.

5. Tablet stand

Do not pull up the tablet stand excessively to the point it falls in order to prevent damage to the device mounted to tablet stand.

6. Regulatory Information

Do not use the device for mechanical, medical or industrial applications.

If you make changes or modifications not expressly approved by MOKIBO, it may void the user's authority to operate the device. This product is intended for use in NRTL registrations (UL, CSA, ETL, etc) and / or IEC / EN 60950-1 compatible (CE marked) information technology device. Parts that are subject to service support are not included.

The device is classified as a commercial product operating from 5°C–35°C (41°F–95°F). To comply with RF exposure requirements, do not move or remove antennas installed by the manufacturer.

Do not use the wireless device with any other types of antennas or transmitters or place near them. Antennas and body of the wireless device, except for headsets or hand-held devices must be at least 20cm apart.

• Korea Electromagnetic Compatibility Registration

This device has been registered as the electromagnetic compatible device that can be used everywhere including residential areas. When using frequencies within the 2400MHz to 2410MHz band, there is a possibility of interferences with radio equipment using frequencies within the 2390MHz to 2400MHz band.

• Korean Format Registration Information (for wireless products)

Life safety services are not available due to the possibility of radio interference.

• Disposal of Waste Batteries and Waste Electrical and Electronic Equipment (WEEE)

If a product, battery, or package has this sign on it, do not dispose of the product and its batteries together with household waste. Instead, dispose of such items at your local battery, electrical and electronics recycling collection point. Separate collection and recycling can help save resources and can help protect your health and the environment from harmful substances that may remain in batteries, electrical and electronic devices.

For proper disposal of batteries and electrical and electronic waste, contact your local city hall office or the town / township / village office, your household waste disposal service company or the store where you purchased the product. Please contact support@mokibo.com for more information on WEEE (waste electrical appliances) and waste batteries.

• MOKIBO Hardware Customer Support Service

If you have questions about MOKIBO's hardware products, read the instructions or help.

If you have any questions about MOKIBO's hardware product information and technical support services, please contact our customer support center to check the problem and receive the service from the hardware after sales service center. In order to receive services for the product, you must register as a customer and bring the receipt with the date of purchase.

[Customer Support Center]

Please leave an inquiry to support@mokibo.com with following information.

- Manufacturer and model name of the product you are using
- The exact message on the screen
- Situation / task you were doing when a problem occurred

For product problems that occur during the warranty period, contact the MOKIBO Customer Support Center, not the store where you purchased the product. Services that you may receive after hardware product registration are available for one year from the date of receipt for software and the period specified in the MOKIBO user right agreement included in the software or manual for hardware. If the product is provided by a PC manufacturer or purchased under a license agreement, such as MOKIBO Select Program, no general support will be provided. Please contact the store where you purchased the product or use online services and annual contract based technical support programs. Information on MOKIBO products and service centers may change without notice. The contents and perspectives of this instruction manual, including URLs and website references may change without notice. This manual does not grant you any intellectual property rights of MOKIBO products.

Limited Warranty

Read the following content carefully and understand your rights and obligations.

"Hardware Device" means the MOKIBO® hardware products. "You" means an individual or a single corporate body. "Software" means the software provided by MOKIBO to use with the hardware device and may include approved upgrades or additional components provided by MOKIBO, such software, such as media (including copies), printed materials, "online" or electronic documentation.

A. Warranty

1. Express Warranty – According to the express warranty conditions, MOKIBO guarantees that the software and hardware will work normally if you follow the disclosed MOKIBO packaging and documents for one year since the day of receipt specified on your receipt. In the case of defects found after the warranty period, no warranty or condition of any kind shall be applied. The subjective or aesthetic appearance of a hardware device or software shall not be applied to this Limited Warranty. The foregoing warranty set forth above is the only Express Warranty provided to you, including but not limited to other express warranties, implied warranties (Except for implied warranties that cannot be denied), or conditions. No warranties or conditions shall be established by MOKIBO and its agents, affiliates, suppliers, or their staff or agents, in any form (oral or written), and the scope of this Limited Warranty shall not be extended.

2. Limitations on the period of implied warranty - If you are a consumer, you may be subject to implied warranties and / or conditions in accordance with the laws of your jurisdictions, which is hereby limited to the warranty period set forth above. The limitations specified above may not apply to you since some jurisdictions may not allow limitations on how long implied warranty or conditions persist.

B. The only remedy

MOKIBO shall give you a refund or repair parts or all of defective software or hardware devices or compensate you for your loss based on reasonable calculation in accordance with applicable laws and the following terms and conditions if you return the software or hardware device with a proof or copy or receipt (in case the place of purchase refused to return) within the warranty period. However, the amount for compensating for damages shall not exceed the amount of reasonable depreciation rates based on the amount you paid for the software and / or hardware device.

The following shall be applied to the remedies specified above. Software or hardware devices may be repaired or exchanged, refurbished, or otherwise exchanged for used products, in principle, and may contain third party items with the same function and performance as the original hardware device (or software). Any software or hardware device repaired or exchanged pursuant to this Limited Warranty shall be warranted for either the remaining the warranty period or 30 days from the date of shipment of the product. If software upgrades are shipped with a new Limited Warranty, the new limited warranty terms shall apply only to the upgraded software and not to the original hardware device. Unless otherwise required by laws in your jurisdiction, shipping costs (including packaging) for the warranty service are your responsibility. MOKIBO shall disclaim warranty with respect to services provided in accordance with the Limited Warranty.

C. Exclusion of other damages

To the maximum extent permitted by applicable laws, MOKIBO and its suppliers, affiliates and agents shall not take responsibility for (i) any consequential or incidental damages, (ii) loss of profits, business interruption, loss of data, privacy or secret, or any other kind of loss or damage, not being able to use the service, injury, or any obligation (including, but not limited to, negligence, obligation of faith, duty of endeavor) (iii) indirect, special, punitive damages arising out of or related the software or hardware devices. The above content shall apply to MOKIBO, its suppliers, affiliates or agents who have been aware of the possibility of such loss, damage, or for failure, illegal acts (including negligence), liability without fault, product responsibility, or false statement. Since some jurisdictions do not allow the exclusion or limitation of incidental or consequential damages, the above limitation or exclusion may not apply to you.

D. Exclusion of Warranty

This Limited Warranty shall not be applied if the software or hardware device is used for the commercial purpose (including renting or leasing), used beyond the scope of the software license, modified or altered, or in the case of force majeure, overvoltage, misuse, abuse, negligence, manipulation, or for any other reason not related to defects of the hardware device or software, including damages caused by programs, data, viruses, files, shipment or transmission, usage not in accordance with the enclosed documentation and instructions, being repaired, modified or altered at any place other than MOKIBO authorized repair center and service center. This Limited Warranty does not include warranties related to legal rights or abilities or express and implied warranties.

E. Registration

It is not necessary to register for the acquisition of software and hardware devices for the Limited Warranty to take effect.

F. Beneficiary

To the extent permitted by applicable laws, the Limited Warranty shall apply only to you, the user of the software or the buyer of the hardware device. The third party shall not be given the Limited Warranty. Unless otherwise required by law this Limited Warranty shall not be applied to other parties, including any other person, including grantees.

H. Governing Law, Independent Jurisdiction

If the hardware device and / or software is purchased in the United States, all of the contents of this agreement including the Limited Warranty shall be construed and implemented in accordance with the laws of the State of Washington, USA. You are subject to the exclusive jurisdiction of the federal courts amended in King County, Washington. If you are not subject to the federal jurisdiction, you shall be subject to the exclusive jurisdiction of the High Court in King County, Washington. If this hardware device is purchased in Canada, Ontario law shall apply unless otherwise expressly prohibited by the local laws. Each party hereby shall agree to the jurisdiction of the courts of York, Ontario in the case of lawsuits. If this hardware device is purchased in another country not mentioned above, local laws shall be applied.

FCC ID : 2ATQS-MKB420

FCC Part 15.19

This device complies with part 15 of the FCC Rules. Operation is subject to the following two conditions:

(1) This device may not cause harmful interference, and (2) this device must accept any interference received, including interference that may cause undesired operation.

FCC Part 15.21

Any changes or modifications (including the antennas) to this device that are not expressly approved by the manufacturer may void the user's authority to operate the equipment.

FCC RF Radiation Exposure Statement: This equipment complies with FCC RF Radiation exposure limits set forth for an uncontrolled environment.

This device and its antenna must not be co-located or operating in conjunction with any other antenna or transmitter.

[EN] This device contains licence-exempt transmitter(s)/receiver(s) that comply with Innovation, Science and Economic Development Canada's licence-exempt RSS(s).

Operation is subject to the following two conditions:

(1) This device may not cause interference.

(2) This device must accept any interference, including interference that may cause undesired operation of the device.

[FR] L'émetteur/récepteur exempt de licence contenu dans le présent appareil est conforme aux C NR d'Innovation, Sciences et Développement économique Canada applicables aux appareils radio exempts de licence.

L'exploitation est autorisée aux deux conditions suivantes :

(1) L'appareil ne doit pas produire de brouillage;

(2) L'appareil doit accepter tout brouillage radioélectrique subi, même si le brouillage est susceptible d'en compromettre le fonctionnement.

[EN] IC RF Radiation Exposure Statement: This equipment complies with IC RF Radiation exposure limits set forth for an uncontrolled environment.

This device and its antenna must not be co-located or operating in conjunction with any other antenna or transmitter.

This equipment should be installed and operated with a minimum distance of (문리거리)cm between the radiator and your body.

[FR] RF du IC d'exposition aux radiations: Cet équipement est conforme à l'exposition de la IC rayonnements RF limites établies pour un environnement non contrôlé.

L'antenne pour ce transmetteur ne doit pas être même endroit avec d'autres émetteur sauf conformément à la IC procédures de produits Multi-émetteur. Cet équipement doit être installé et utilisé avec une distance minimale de (문리거리)cm entre le radiateur et votre corps.