

MODEL ODH2-5ICAT

Description

- 5" Line Voltage Recessed Housing
- New construction
- Air tight
- Thermally protected
- Lamp Type: R30 65W Max, Par-30 90W Max
(maximum lamp wattage us subject to limitations as listed with trims)
- Commercial or residential applications
- Wire through junction box
- Adjustable hangar bar from 14"-24"
- Rated for damp locations
- Meets State of WA energy code ASTM E283 for Air Tight

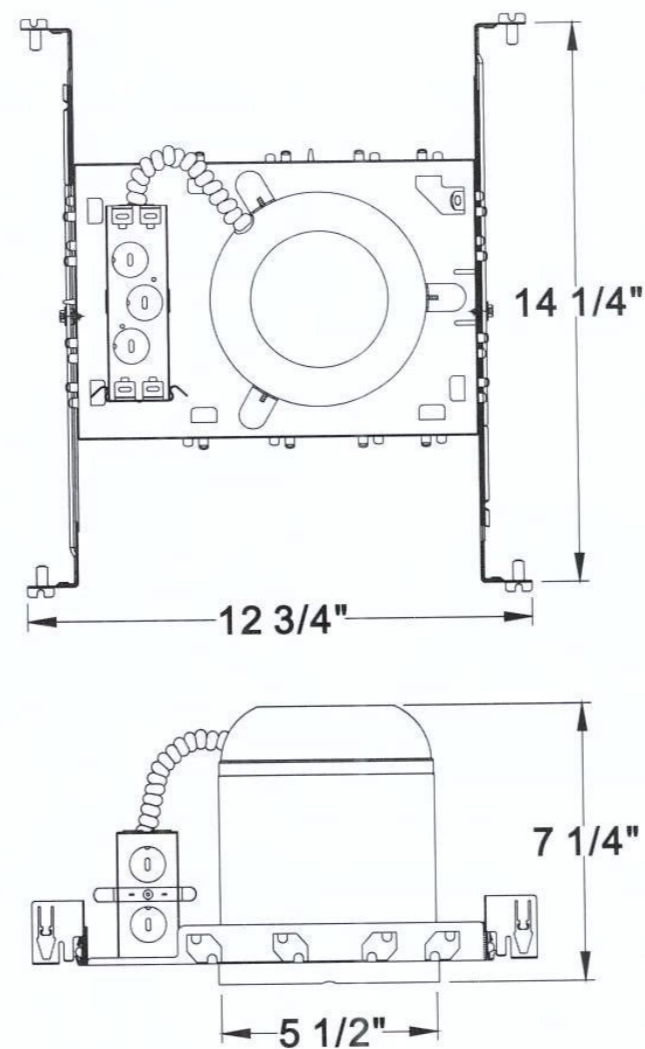
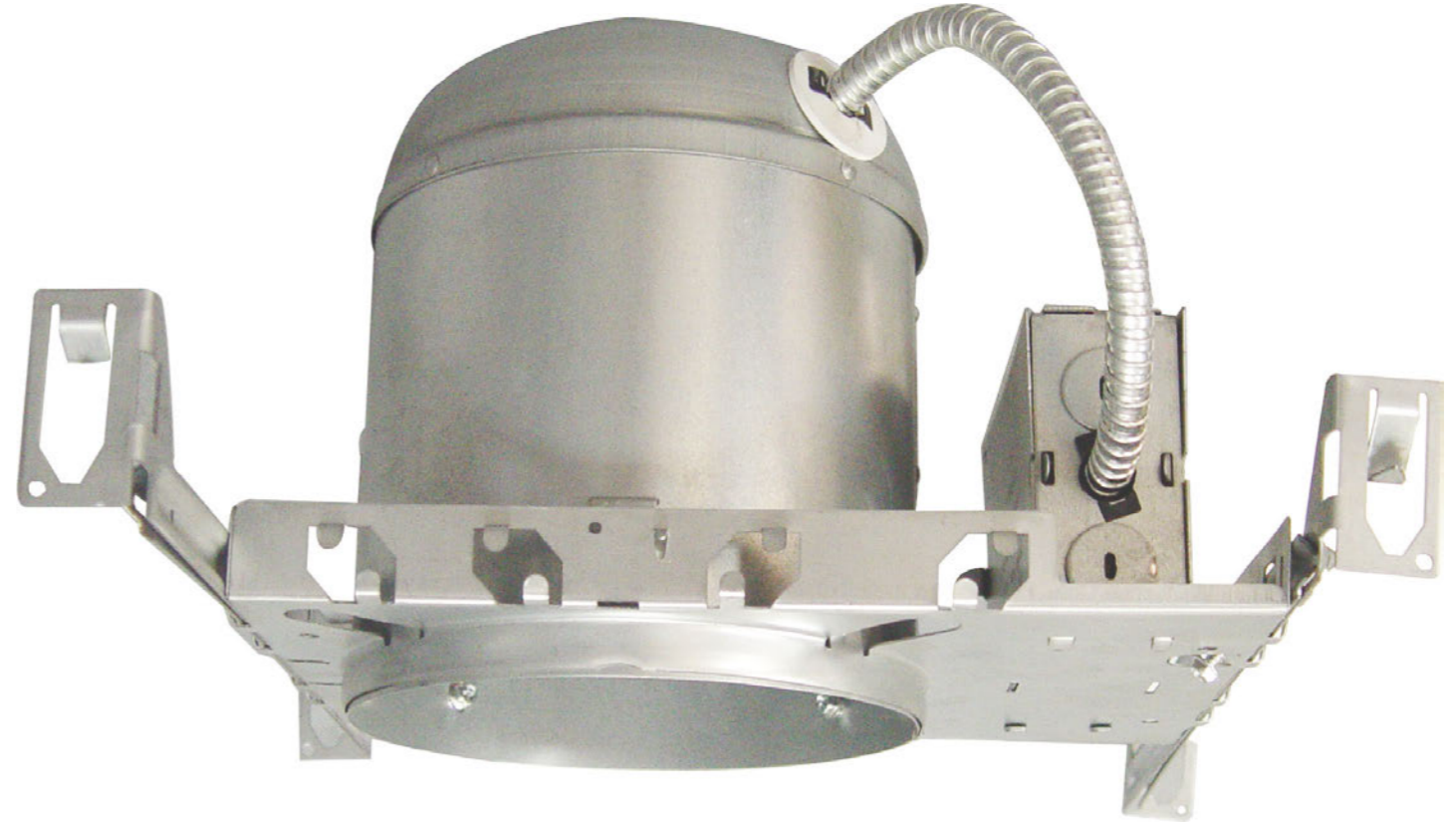

ORTECH ODH2-5ICAT shall be a 5" new construction, airtight housing, for use with insulated or non insulated ceilings.

Reference	QTY.	Remarks	Project:
			Location:
			Architect:
			Engineer:
			Contractor:
			Submitted by:
			Date:

CERTIFICATIONS

