

**Series 4, washing machine, front loader, 8 kg  
WAN24122AU**



**Enjoy the EcoSilence Drive motor quiet operation and durability with the convenience of having a wash program suited for pretty much anything**

- **ActiveWater Plus** load sensing technology that adapts the water flow automatically for the relevant load size
- **EcoSilence Drive™**: quiet and energy-efficient drive, with a 10-year warranty.
- **Reload function**: forgot an item? Add it easily to the wash.
- **VarioPerfect**: allows you to clean your laundry with 50% less energy or reduce cleaning time by 65%
- **AntiVibration Design**: extremely stable and especially quiet thanks to special vibration protection

**Technical Data**

Built-in / Free-standing : Freestanding  
 Height of removable worktop : -2 mm  
 Dimensions of the product : 848 x 598 x 550 mm  
 Height for building under : 850.00 mm  
 Net weight : 70.0 kg  
 Connection Rating : 2300 W  
 Fuse protection : 10 A  
 Voltage : 220-240 V  
 Frequency : 50 Hz  
 Length electrical supply cord : 160 cm  
 Water consumption : 80 l  
 Door hinge : Left  
 Wheels : No  
 EAN code : 4242005329816  
 Capacity cotton - NEW (2010/30/EC) : 8.0 kg  
 Energy consumption : 0.85 kWh  
 Spin drying performance class : C  
 Maximum spin speed : 1200 rpm  
 Noise level washing : 53 dB(A) re 1 pW  
 Noise level spinning : 74 dB(A) re 1 pW  
 Installation typology : Freestanding



4 242005 329816

## Series 4, washing machine, front loader, 8 kg WAN24122AU

**Enjoy the EcoSilence Drive motor  
quiet operation and durability with the  
convenience of having a wash program  
suited for pretty much anything**

### Capacity

- Capacity: 8 kg

### Consumption rates

- 4 Star energy rating
- 4 Star water rating (WELS)
- 80 litres water consumption per wash and 311 kWh energy consumption per year, based on the Cottons program with EcoPerfect and 60°C temperature setting, 1200 spin speed, and a cold water connection

### Programs

- Standard programs:
  - Cottons: hard-wearing items made from cotton, linen or blended fabrics
  - Cottons+PreWash: for stubborn stains and heavily soiled garments
  - Easy care: items made from synthetic or blended fabrics
  - Delicate/Silk: Delicate, washable items made from Silk, viscose and synthetics
  - Wool: hand or machine washable items that are made from wool or contain wool
- Additional specialty programs:
  - Drum Clean: cleaning and care program for the drum with reminder function
  - Shirts/Blouses: non-iron shirts and blouses made from cotton, linen, or blended fabrics
  - Kidswear: energy optimised program for heat-resistant items made of cotton or linen
  - Mixed: lightly soiled items made from cotton, linen, or blended fabrics
  - Sportswear: sports and leisure items made from synthetic fibres, microfibre or fleece
  - Rinse: rinses and then spins the laundry, and then drains the water
  - Spin/Drain: spins and drains the water
  - Quilts: items stuffed with down and synthetic fibres, such as pillows, quilts and bedspreads
  - Super 15'/30': short program for small lightly soiled items
  - Jeans/Dark Wash: dark coloured cottons and dark coloured easy care fabrics

### Performance

- ActiveWater Plus: for highly efficient use of water even with small loads thanks to automatic load detection.
- EcoSilence Drive: quiet, durable, and energy-efficient brushless motor (BLDC) with 10-year motor warranty
- Spin speed 400 - 1200 rpm

### Design

- Large LED display for program status, temperature, spin speed, and time remaining
- AntiVibration Side Panels reduce vibrations and noise levels, making it extremely quiet during the spin cycle

### Convenience

- Touch control option settings include:
  - Finish in (delayed start): delay the start of the program by up to 24 hours
  - Rinse Plus: Adds more rinse cycles, suited for highly soiled clothing
  - EcoPerfect/SpeedPerfect: Speed up the selected program without compromising the wash result, or opt for EcoPerfect to reduce energy consumption
  - Start/Pause with Reload function: allows you to add a forgotten garment even after the wash cycle has started
  - Temperature selection: manually adjust the temperature
  - Spin Speed: manually adjust the spin speed
- Reload function to pause machine operation for adding in last minute laundry items
- SpeedPerfect: allows you to reduce cleaning time by up to 65%
- Time delay to select end of time of your wash (1-24 hours) and time remaining indicator
- Large porthole with 180° opening door for easy loading/unloading

### Safety

- Child lock for door and buttons

### Technical Information

- Dimensions (H x W x D): 84.8 cm x 59.8 cm x 55.0 cm (60.0 cm including door handle)
- Operating noise level (based on Cotton 60°C program): wash 53 / 74 spin dB(A)

**Series 4, washing machine, front loader, 8 kg  
WAN24122AU**

---

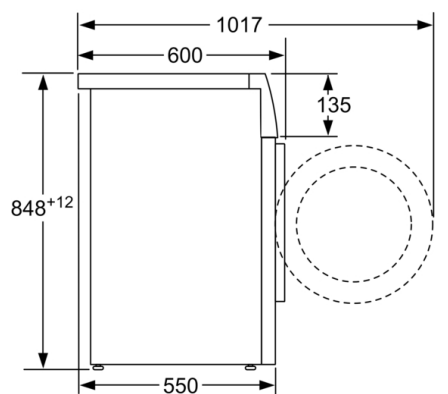

measurements in mm

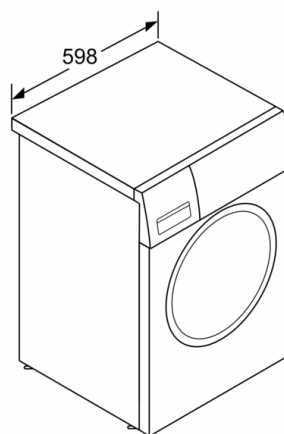

measurements in mm