

ASUS ExpertCenter D700MA

Secure, reliable and business-ready



Advanced performance and security for business

ASUS ExpertCenter D7 Mini Tower is a high-performance desktop PC with enterprise-grade security and management designed for business, while its compact, modern and versatile design accommodates different workspaces and usage scenarios. Built to last, it meets MIL-STD-810G US military standards and offers a highly-expandable chassis, ensuring long-term reassurance and easy future upgrades for professionals.



Powered by Intel® Core™ i7 processor.

Intel's most powerful processor for what's coming.

Intel, the Intel Logo, Intel Inside, Intel Core, and Core Inside are trademarks of Intel Corporation or its subsidiaries in the U.S. and/or other countries.



Starting at \$599

* Specification may vary by model.

Exceptional performance, whatever the task

To make light work of all your business tasks, ExpertCenter D7 Mini Tower is powered by cutting-edge 10th Gen Intel® Core™ processors with the latest DDR4 RAM. It can also support professional-grade graphics cards for those requiring advanced graphics performance for demanding visual tasks such as short online videos, full-length features, animation or 3D modeling, or graphics design.

Built to last

To minimize the total cost of ownership (TCO) to your business, ExpertCenter D7 Mini Tower is designed deliver supreme reassurance for long-term usage.



World's #1 ASUS motherboards*

To offer 24/7 stability and comprehensive system protection



US military-grade standards

for proven reliability in all aspects



100% solid capacitors

to increase thermal capacity and longevity



Optimized thermal design

for consistent performance after hours of use

Ready for the business world

A full array of I/O ports ensures ExpertCenter D7 Mini Tower is ready to connect to a wide range of business peripherals. Flexible serial and parallel ports on chassis leave more PCI slots available for additional upgrades. A smart-card reader and an SD card reader are optional for an easy transaction, data transfer, or other business-related tasks.

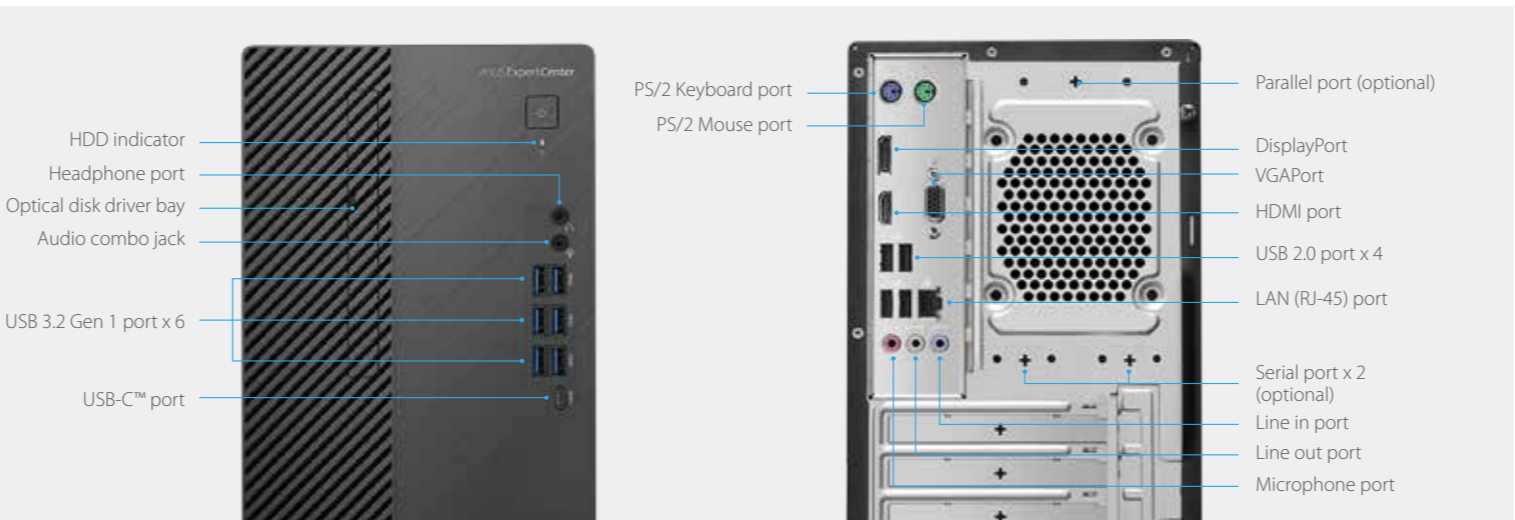

ASUS ExpertCenter D700MA

- The 10th Gen Intel® Core™ i7 Processor
- Intel® B460 chipset
- Windows 10 Pro / Home
- **Up to NVIDIA® GeForce® RTX2060**
- 4 x DIMM SLOT, DDR4 2933MHz, support max.128GB
- Up to 3TB 7200rpm HDD, up to 2TB PCIe® 3.0 x4 SSD

- **Tool-free chassis design for hassle-free maintenance and upgrades**
- Up to Wi-Fi 6(Gig+)(802.11ax)+Bluetooth 5.0 (Dual band) 2*2
- **3 year global warranty**

*ASUS secured the #1 spot for motherboard market share as of 2017, with DigiTimes reporting that the Taiwanese PC component giant owns 45% of the motherboard market.

ASUS ExpertCenter D700MA	
CPU	Intel® Core™ i7-10700 Processor 2.9 GHz (16M Cache, up to 4.7 GHz) Intel® Core™ i5-10600 Processor 3.3 GHz (12M Cache, up to 4.8 GHz) Intel® Core™ i5-10400 Processor 2.9 GHz (12M Cache, up to 4.3 GHz) Intel® Core™ i3-10100 Processor 3.6 GHz (6M Cache, up to 4.3 GHz) Intel® Pentium® G6400 Processor 4.0 GHz (4M Cache) Intel® Pentium® G6500 Processor 4.1 GHz (4M Cache) Intel® Celeron® G5900 Processor 3.4 GHz (2M Cache)
Chipset	Intel® B460
Operating System	Windows 10 Home - ASUS recommends Windows 10 Pro for business Windows 10 Pro - ASUS recommends Windows 10 Pro for business Endless OS Clean OS
Discrete GPU	NVIDIA® GeForce® PH RTX2060 6GB : 1x DVI, 2x HDMI, 1x DP NVIDIA® GeForce® PH GTX1660S 6GB : 1x DVI, 1x HDMI, 1x DP NVIDIA® GeForce® GTX1650 : 1x HDMI, 1x DVI, 1x DP NVIDIA® GeForce® GT710 2GB DDR5 : 1x D-SUB, 1x HDMI, 1x DVI NVIDIA® GeForce® GT1030 2GB : 1x HDMI, 1x DVI
Integrated GPU	Intel® UHD Integrated Graphics
Memory	4 x DIMM Slot, Dual Channel DDR4 2933/2666 MHz Support max.128GB 32GB DDR4 U-DIMM / 16GB DDR4 U-DIMM / 4GB DDR4 U-DIMM / 8GB DDR4 U-DIMM
Wireless	Wi-Fi 5 (802.11ac) + Bluetooth 5.0 (Dual band) 1*1 Wi-Fi 5 (802.11ac) + Bluetooth 4.2 (Dual band) 2*2 Wi-Fi 6(Gig+)(802.11ax)+Bluetooth 5.0 (Dual band) 2*2
Expansion Slots	1 x PCIe® 3.0 x16 / 2 x PCIe® 3.0 x1 / 1 x PCI® / 2 x M.2 connector for storage / 1 x M.2 connector for WiFi
Serial ATA	3 x SATA 6.0Gb/s ports
Storage	1 x 3.5" + 1 x 2.5" HDD, up to 3TB 7200rpm (support HDD tool-free design) 2 x M.2 SSD, up to 2TB PCIe® 3.0 x4 SSD (both support PCIe Gen3 x4 and SATA) 1TB SATA 7200RPM 2.5" HDD / 1TB SATA 7200RPM 3.5" HDD / 2TB SATA 7200RPM 3.5" HDD / 128GB M.2 NVMe™ PCIe® 3.0 SSD / 1TB M.2 NVMe™ PCIe® 3.0 x4 SSD / 256GB M.2 NVMe™ PCIe® 3.0 SSD / 512GB M.2 NVMe™ PCIe® 3.0 SSD
Drive Bays	1 x Slim type ODD External Bay / 1 x 3.5" Internal Bay / 1 x 2.5" Internal Bay
Optical Drive	Slim type DVD ROM (Optional) / Slim type DVD RW (Optional)
Audio	High Definition 7.1 Channel Audio
Front IO Port	6 x USB 3.2 Gen 1 Type-A / 1 x USB 3.2 Gen 1 Type-C / 1 x 3.5mm combo audio jack / 1 x Headphone / Smart Card Reader & SD Card Reader(Optional)
Rear IO Port	1 x DisplayPort / 1 x HDMI 1.4 / 1 x VGA Port / 1 x RJ45 Gigabit Ethernet / 4 x USB 2.0 Type-A / 2 x PS2 / 3 x Audio jacks / 1 x Parallel port (Optional) / 2 x Serial port (Optional)
Power Supply	180W power supply (80+ Bronze, peak 228W) / 300W power supply (80+ Platinum, peak 390W) / 500W power supply (80+ Gold, peak 550W)
Dimension (cm)	16.20(W) x 29.13(D) x 35.50(H) cm
Dimension with Carton	23.2(W) x 49.2(D) x 49.0(H) cm
Weight (kg)	7 kg
Security	Trusted Platform Module (TPM) 2.0 / Buzzer Cable (Optional) / Kensington Lock Slot / Pad Lock Slot / BIOS Booting User Password Protection / HDD User Password Protection and Security
Software	ASUS Business Manager / ASUS Control Center (Optional) / MyASUS / Image Builder (Taiwan only) / AI Recovery (China only and Taiwan only)
Included in the Box	Power Cord, Warranty Card, Quick Start Guide, Keyboard/Mouse (Optional)
Optional accessories	Serial port cable / Serial port bracket / Parallel port cable / Trusted Platform Module (TPM) 2.0 / Audio Module / Buzzer cable / WiFi PCIe raiser card (M.2) / Smart card reader+ SD card reader
Certificates	Energy Star CECP
Warranty	
Price	\$599