

# User Manual



## Specification

---

Size: 180\*180\*280mm

Weight: XXkg

Main materials: ABS

Power: AC100~240V 50/60Hz

Power consumption: 10W

Speed: 1/2/3

CADR:

Airflow:

Noise Level: 35~55 dBA

## Product overview

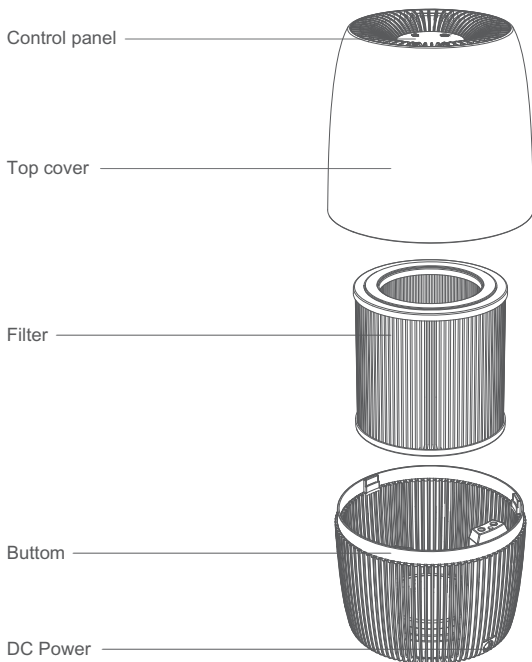

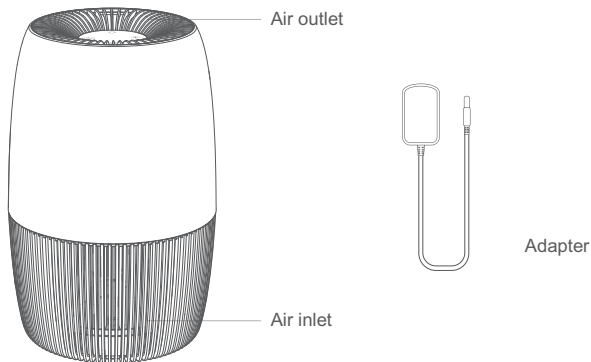

**NOTE:** Please take notice of below instructions and the separately included warning sheet before using the product.

## Installation

- Please do not set up in a place where humidity directly hits curtains, furniture, indoor plants or doors. It can cause stains and deformation.
- Please place on a horizontal and stable surface, otherwise the might be a risk of water spilling.
- Please do not set up in a place where only children are present such as children's room. It can lead to injury or breakdown if the device is knocked over or climbed on.
- Please do not place anywhere where items may fall from above. It can lead to ignition or a breakdown.
- Please do not set up near devices that are not compatible with water such as PCs or smartphones. It can cause ignition or a breakdown.
- Please do not use in any surrounding that could lead to the water in the water tray or in the device to freeze. However, if the water in the water tray or the device is frozen please do not operate the device until the ice has thawed. It can cause ignition or a breakdown.

## Advantages

·High CADR with True HEPA.

·Purify the air through 360° and filter pm2.5 particles.

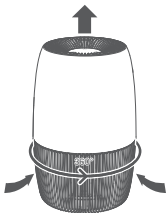

## FCC STATEMENT

1. This device complies with Part 15 of the FCC Rules. Operation is subject to the following two conditions:

- (1) This device may not cause harmful interference, and
- (2) This device must accept any interference received, including interference that may cause undesired operation.

2. Changes or modifications not expressly approved by the party responsible for compliance could void the user's authority to operate the equipment.

This equipment has been tested and found to comply with the limits for a Class B digital device, pursuant to part 15 of the FCC Rules. These limits are designed to provide reasonable protection against harmful interference in a residential installation. This equipment generates, uses and can radiate radio frequency energy and, if not installed and used in accordance with the instructions, may cause harmful interference to radio communications.

However, there is no guarantee that interference will not occur in a particular installation. If this equipment does cause harmful interference to radio or television reception, which can be determined by turning the equipment off and on, the user is encouraged to try to correct the interference by one or more of the following measures:

- Reorient or relocate the receiving antenna.
- Increase the separation between the equipment and receiver.
- Connect the equipment into an outlet on a circuit different from that to which the receiver is connected.
- Consult the dealer or an experienced radio/ TV technician for help.

FCC Radiation Exposure Statement:

This equipment complies with FCC radiation exposure limits set forth for an uncontrolled environment. In order to avoid the possibility of exceeding the FCC radio frequency exposure limits, Human proximity to the antenna shall not be less than 20cm (8 inches) during normal operation

## Placement

Please place away from walls, window and furniture.

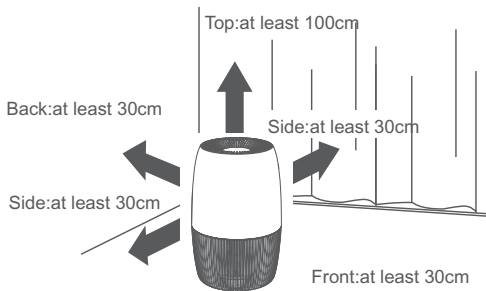

·Even when it is placed at a sufficient distance from walls or furniture, if it is used in the same place for a long period of time, it can become dirty with scale. We recommend regular cleaning. Please consult chapter 4 for maintenance instructions.

·Please avoid places with direct sunlight. There is a risk that the device discolors.

·If there is interference with TV, radio or other electrical devices, please move the device.

·When, moving the device please move it with the base of the device held securely.

·The device does not have an automatic humidity adjustment feature. Wet floors and condensation can form easily in rooms with lower temperatures or high levels of humidity.

·Adjust the level of humidity with the mist button, with adequate consideration of the space the device is located in, and by either raising the room temperature or turning off the device.

## Operation Guides

### Plug in

Plug the power cable into the power socket of the main unit, and insert the DC plug firmly into the outlet. The unit turns to the standby mode, the indicator light on the top turns red.



### Power button/WIFI button

Press the button for 1st time to turn on the unit with 1 beep.The indicator is in white.Press 2nd time to turn off the unit.Then recycle.  
Hold the button for 5s when working,the unit will connect WIFI after 1 beep,then the power indicator will flash with red.



Remark:In the state of turning-off,the indicator will be off after 3 mins.

### Night light setting (Light color:red,blue,green,yellow,purple)

When turning on the unit, the default setting is all color cycle one by one. When touching the night light button, you can select the light color currently. When touching the button for the 2nd time, the light color will cycle again. Hold on the button for 3 seconds, the night light will be turned off. And then touch the button again, you can turn on the night light. In the state of stand-by,the night light can use individually.

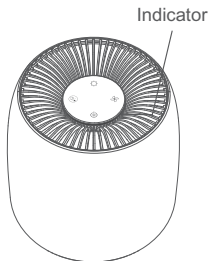

### Speed button

Turning on the unit,the default setting is in low speed with light LED .Press 1st time,it's 2nd speed with lighter LED;Press 2nd time,it's 3rd speed with lightest LED; Press 3rd time,it's returning to 1st speed with light LED.

Remark:There's memory function.Turn on the unit again to back to the last speed after turning off. If plug out the unit,then it's back to the default setting when turn on again.

 Sleep mode/Filter reset button

Press the button, enter into sleep mode, all LED are off with 1 beep. Press any key to recover the sleep mode with 1st speed automatically. Press again to turn off the sleep mode.

When the lifespan of filter used for 4320 hours, the indicator and all LED will flash 10sec with beep. Then all LED and beep turn off. Every 30 mins, the indicator and all LED will flash 3sec.

Hold the filter for 5s to reset the filter with two beeps and power indicator flash 3s in red, then it shows resetting is successful.

## Replacing the Filter

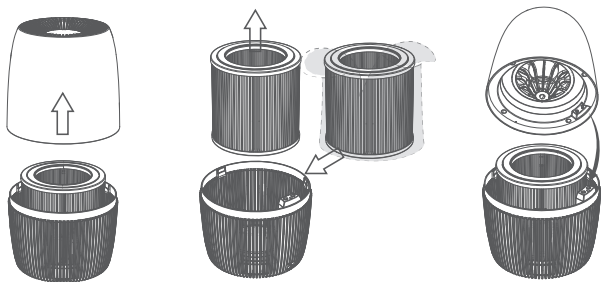

Open the top cover, take out the old filter, then put a new filter inside. Please remove the plastic bag for the filter before using. After install the top cover, press the “+” button for 5s to reset the filter timer.

**Remark:** It's recommended to replace the filter every 6 months. It depends on where and how the product is used. For example, if it's used in heavily contaminated areas, ect., the replacement cycle of the filter may be shortened.

Also, you can replace the filter immediately if the filter is dirty, judging by its transparent cover.