

Quick Installation Guide

AC4000 MU-MIMO Tri-Band Wi-Fi Router

Archer C4000

Connect the Hardware

If your internet connection is through an Ethernet cable from the wall instead of through a DSL / Cable / Satellite modem, connect the Ethernet cable directly to the router's Internet port, then follow steps 1, 5 and 6 to complete the hardware connection.

- 1 Place the router horizontally and extend the antennas to the maximum angle.

Note: For best performance, horizontal installation is recommended.
Antenna's direction and position can affect performance in vertical installation situations.

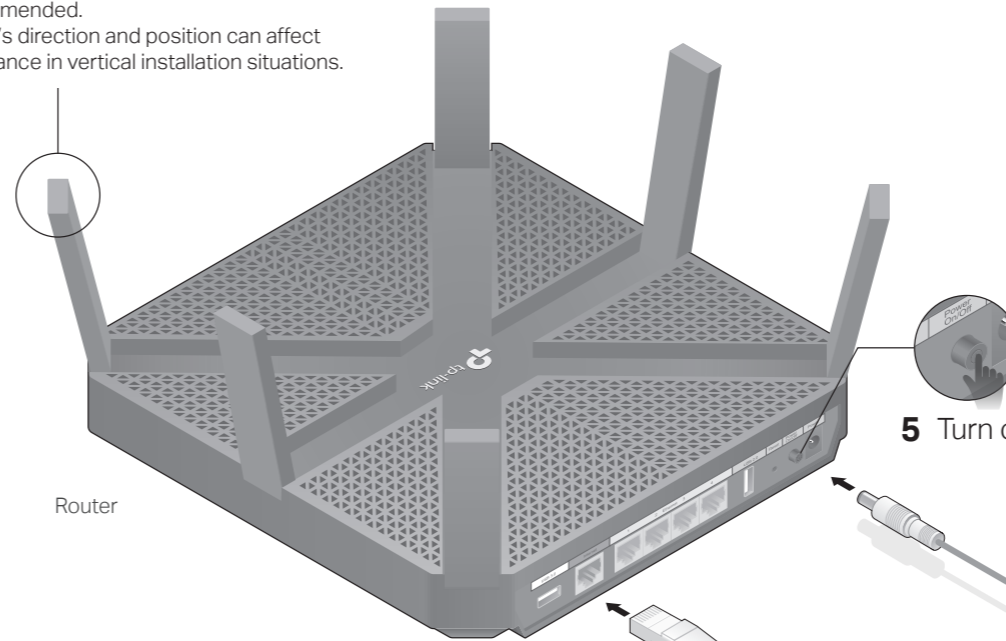

- 5 Turn on the router.

- 6 Verify that the following LEDs turn solid on before continuing with the configuration.

Power On	2.4GHz On	5GHz-1 On	5GHz-2 On	Internet On



Notes:

1. If all the LEDs are off, press the LED On/Off button for about 1 second, then check the LEDs again.
2. If the 2.4GHz, 5GHz-1, and 5GHz-2 LEDs are off, press the Wi-Fi On/Off button for about 1 second, then the three LEDs should turn solid on.

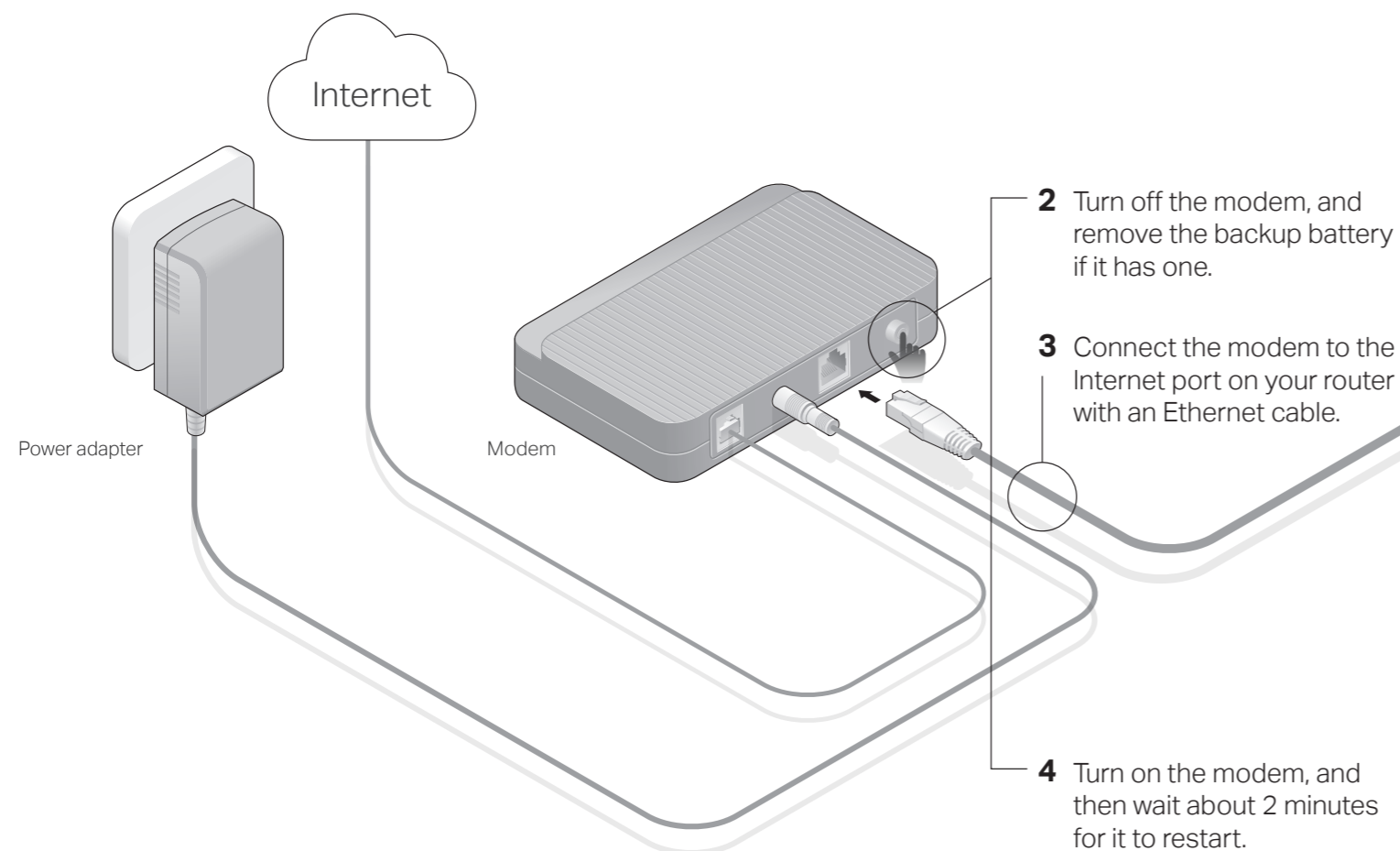

Configure the Cloud Router

Method ONE: Via TP-Link Tether App

1. Download the Tether app.



2. Connect your smartphone to the router.

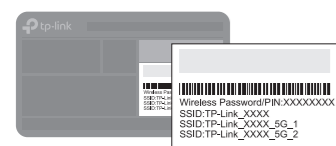

The default wireless network names (SSIDs) and password are printed on the label at the back of the router.

3. Connect the router to the internet.

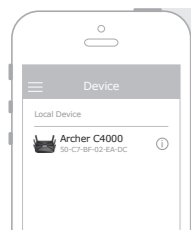

- Launch the Tether app. Select Archer C4000 from the local device list.
- Create a login password.
- Follow the steps to connect to the internet.

4. Register the TP-Link Cloud service.

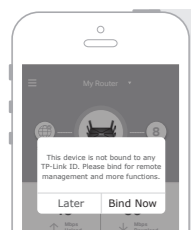

To enjoy a more complete service from TP-Link, tap **Bind Now** when prompted and follow the instructions to register and bind a TP-Link ID to your cloud router.

With TP-Link ID, you can conveniently manage your home network from your smartphone or tablet via the Tether app, no matter where you find yourself.

😊 Enjoy the internet !

Method TWO: Via a Web Browser

1. Connect your device to the router (wired or wireless).

• Wired

Turn off the Wi-Fi on your computer and connect the devices as shown below.

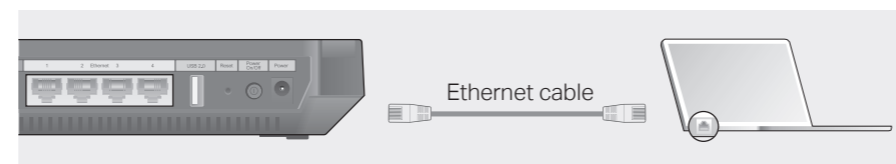

• Wireless

- Find the SSID and wireless password printed on the label of the router.
- Click the network icon of your computer or go to Wi-Fi settings of your smart device, and then select the SSID to join the network.

2. Connect the router to the internet.

- Launch a web browser, and enter <http://tplinkwifi.net> or <http://192.168.0.1> in the address bar. Create a login password for secure management purposes, and then click **Let's Get Started**.

Note: If the login window does not appear, please refer to Q1 of Need Help? in this guide.

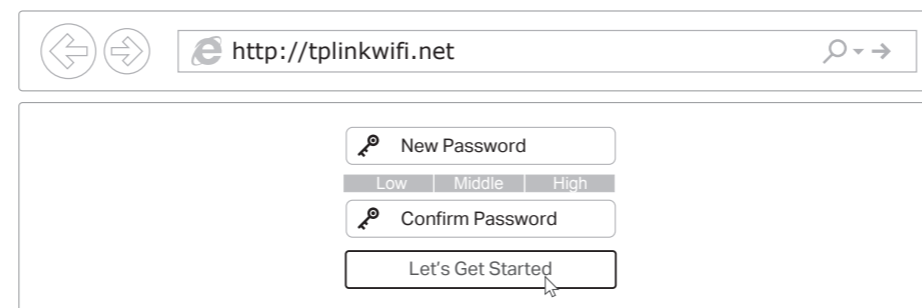

- Follow the step-by-step instructions to set up an internet connection and register the TP-Link Cloud service.

😊 Enjoy the internet !

USB Applications

With the dual USB ports, it's easy to share printers, files and media with multiple devices.

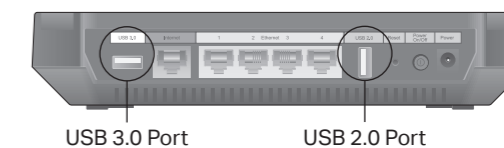

- Local Storage Sharing**
Share files from the USB drive with devices on your home network
- Printer Sharing**
Share a printer with multiple computers connected to the router
- Remote Access**
Access the USB drive when you are away from home
- Media Server**
Play media from the USB drive on your computer and smart devices



To learn more about the USB applications, visit <http://www.tp-link.com/app/usb>, or simply scan the QR code.

TP-Link Cloud Service

TP-Link Cloud service provides a better way to manage your cloud devices. For example:

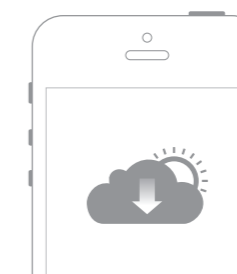

- Remote Management**
Easily manage your home network when you are out and about via the Tether app on your smartphone or tablet.
- Timely Upgrade Notifications**
Keep you informed of the latest firmware updates, ensuring that your router stays at its best.
- One for All**
Manage multiple TP-Link Cloud devices, all from a single TP-Link ID.

You can set up and enjoy cloud functions via the **Tether app** or through the web management page at <http://tplinkwifi.net>.

To learn more about TP-Link Cloud service and other useful features supported by the router (including Guest Network, Parental Controls, Access Control and more), please refer to the User Guide at www.tp-link.com.

Need Help?

Q1. What should I do if I cannot access the web management page?

- If the computer is set to a static IP address, change its settings to obtain an IP address automatically.
- Verify that <http://tplinkwifi.net> is correctly entered in the web browser. Alternatively, enter <http://192.168.0.1> or <http://192.168.1.1> in the web browser and press Enter.
- Use another web browser and try again.
- Reboot your router and try again.
- Disable then re-enable the network adapter being used.

Q2. What should I do if I cannot access the internet?

- Check if you have an internet connection by connecting a computer directly to the modem using an Ethernet cable. If you don't, contact your internet service provider.
- Log in to the web management page of the router, and go to the **Basic > Network Map** page to check whether the internet IP address is valid or not. If it is, please run the Quick Setup again; otherwise, recheck the hardware connection.

- For cable modem users, log in to the web management page of the router. Go to **Advanced > Network > Internet > MAC Clone**, click **Use Current Computer MAC Address** and click **Save**, then reboot both the modem and the router.
- Reboot your router and try again.

Q3. How do I restore the router to its factory default settings?

- While the router is powered on, press and hold the **Reset** button on the back until all LEDs go off, then release the button.
- Log in to the web management page of the router. Go to **Advanced > System Tools > Backup & Restore**, and click **Factory Restore**. The router will restore and reboot automatically.

Q4. What should I do if I forget my web management page password?

- If you are using a TP-Link ID to log in, click **Forgot password** on the login page and then follow the instructions to reset the password.

- Alternatively, press and hold the **Reset** button on the back until all LEDs go off to reset the router, and then visit <http://tplinkwifi.net> to create a new login password.

Q5. What should I do if I forget my wireless network password?

- If you haven't changed the default wireless password, it can be found on the product label at the bottom of the router.
- If you have changed the default wireless password, log in to the router's web management page, and go to **Basic > Wireless** to obtain or reset your wireless password.

📞 For technical support, User Guide and more information, please visit <http://www.tp-link.com/support>, or simply scan the QR code.

