

Pan/Tilt Home Security Wi-Fi Camera

Quick Start Guide

FCC Warning
This device complies with part 15 of the FCC rules. Operation is subject to the following two conditions: (1) this device may not cause harmful interference, and (2) this device must accept any interference received, including interference that may cause undesired operation.

Changes or modifications not expressly approved by the party responsible for compliance could void the user's authority to operate the equipment.

NOTE: This equipment has been tested and found to comply with the limits for a Class B digital device, pursuant to part 15 of the FCC Rules. These limits are designed to provide reasonable protection against harmful interference in a residential installation. This equipment generates uses and can radiate radio frequency energy and, if not installed and used in accordance with the instructions, may cause harmful interference to radio communications. However, there is no guarantee that interference will not occur in a particular installation. If this equipment does cause harmful interference to radio or television reception, which can be determined by turning the equipment off and on, the user is encouraged to try to correct the interference by one or more of the following measures:

- Reorient or relocate the receiving antenna.
 - Increase the separation between the equipment and receiver.
 - Connect the equipment into an outlet on a circuit different from that to which the receiver is connected.
 - Consult the dealer or an experienced radio/TV technician for help.
- Radiation Exposure Statement
This equipment complies with FCC radiation exposure limits set forth for an uncontrolled environment. This equipment should be installed and operated with minimum distance 20cm between the radiator and your body.

Model: E418

What's in the box

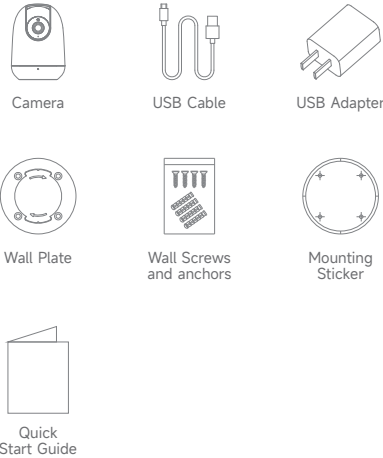

01

Interfaces Introduction

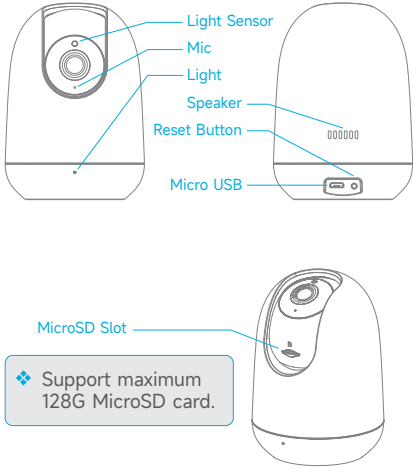

02

Power your camera

Use a data cable to connect the Micro USB interface on the back of the camera to the power socket. When the green light on the camera stays on, it indicates that the power is connected.

Please use the power adapter that comes with the product to power the device. (Using a different power adapter or not following the instructions to use the power adapter may cause damage to the device.)

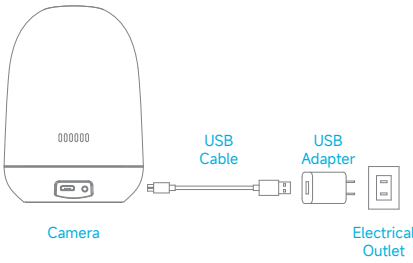

03

Get the app

Download the free Camtells app to get started.



Scan QR Code to download app

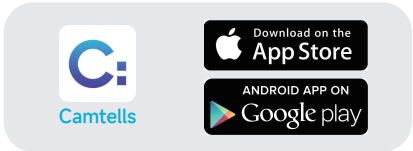

Open Camtells app, tap + to add your camera by following app guides.

04

Install your camera

The device can be placed upright on a desktop for use.
• When you need to mount or hang the device on a wall, please refer to the following instructions:

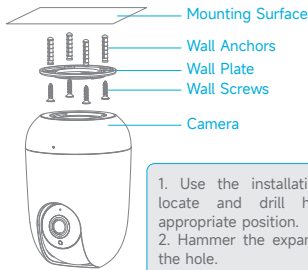

1. Use the installation sticker to locate and drill holes in the appropriate position.
2. Hammer the expansion bolt into the hole.
3. Use the installation screw to secure the quick installation plate to the installation surface.
4. Align the camera with the quick installation plate and rotate to fix it.

05

Safety Information

1. During transportation, storage, and installation, please prevent damage to the product caused by heavy pressure, severe vibration, and immersion, etc.
2. Please use the power adapter that comes with the product to power the device.
3. Do not disassemble the camera yourself to avoid danger or damage to the camera.
4. This model cannot be installed outdoors (including but not limited to corridors, eaves, and courtyards with roofs).
5. Do not place the camera in places with oil fumes, extreme temperatures, long-term direct sunlight, or a lot of dust.
6. Do not expose the device to rain or use it in wet environments near water.
7. Do not aim the camera at strong light (spotlights, direct sunlight) when using it, as it may reduce the life of the photosensitive element.
8. The camera's pan-tilt rotation is operated on the app side. Do not manually rotate the camera's pan-tilt to avoid damaging the motor.
9. When cleaning the camera, you can use a soft cloth dipped in water (or professional lens cleaner) to gently wipe the lens, and then use a dry soft cloth to wipe it dry.
10. This product packaging contains plastic bags and small parts. To avoid danger, please keep the product packaging away from infants and young children.

06

Warranty Services

Thank you for choosing our product. In order for you to fully enjoy our comprehensive after-sales support, please read carefully and keep safe the warranty card upon purchase.

The user can exchange the product for free within 7 days from the date of purchase if there is a quality issue, and the warranty period is one year.

- The following are not covered by the warranty:
- Inability to present a valid warranty certificate and purchase receipt.
 - Product malfunction due to inappropriate environment or conditions, such as unsuitable power supply, temperature, humidity, lightning, etc.
 - Product malfunction caused by accidents, negligence, disasters, improper operation or misuse, cyber attacks, etc.
 - Malfunction or damage caused by unauthorized personnel who are not authorized by the company to install, repair, modify or disassemble the product.
 - The product is beyond the warranty period specified by the company.

For more questions or suggestions, please visit our official website at www.eapil.com or send an email to support@camtells.com.

07

Hazardous Element Declaration Table

Substance Name	Restricted Substances or Elements in accordance with "Administrative Measures for the Pollution Control of Electronic Information Products"					
	Lead (Pb)	Mercury (Hg)	Cadmium (Cd)	Hexavalent Chromium (CrVI)	Polybrominated Biphenyls (PBB)	Polybrominated Diphenyl Ethers (PBDE)
Metal parts	×	○	○	○	○	○
Plastic parts	○	○	○	○	○	○
Printed circuit boards	×	○	○	○	○	○
Sheet metal parts	×	○	○	○	○	○
Lenses	×	○	○	○	○	○
Power supplies	×	○	○	○	○	○

Explanation:
○ indicates that the content of the restricted substance in all homogeneous materials of the component is below the limit specified in the SJ/T 11363-2006 standard.
× indicates that the content of the restricted substance in at least one homogeneous material of the component exceeds the limit specified in the SJ/T 11363-2006 standard.

08

Warranty Card

Product Name: Pan/Tilt Home Security Wi-Fi Camera
Product Model: E418

Date of Sale: _____

Distributor: _____

User Name: _____

Contact Number: _____

Email Address: _____

User Address: _____

This warranty card is issued by
Chengdu Eapil Technology Co., Ltd.

**QUALIFIED
CERTIFICATE**

(QC): PASS

09