

# INTELLIGENT TOILET SEAT

ZN2101-001

ZN2101-002

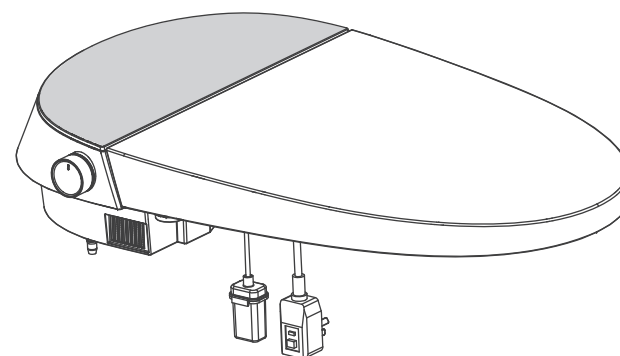

## XIAMEN OLT CO.,LTD.

📍 155 Dutian Road, Jimei District, Xiamen City, Fujian Province

✉️ Nina.lin@china-olt.com

🌐 <https://www.tck.com.cn>

📞 0592-5927961

Manual version number: V1.0

Note: The product outline in this manual is for reference only.  
We reserve the right to modify the product outline. If the appearance  
of the product is changed, the physical object shall prevail

Please read the instructions carefully before use

## 01 IMPORTANT SAFEGUARDS

When using electrical products, especially when children are present, basic safety precautions should always be followed, including the following:

### READ ALL INSTRUCTIONS BEFORE USING

**DANGER** – To reduce the risk of electrocution:

1. Always unplug this product immediately after using.
2. Do not use while bathing.
3. Do not place or store product where it can fall or be pulled into a tub or sink.
4. Do not place in or drop into water or other liquid.
5. Do not reach for a product that has fallen into water. Unplug immediately.



**WARNING** – To reduce the risk of burns, electrocution, fire, or injury to persons.

1. Close supervision is necessary when this product is used by, on, or near children or invalids.
2. Use this product only for its intended use as described in this manual. Do not use attachments not recommended by the manufacturer.
3. Never operate this product if it has a damaged cord or plug, if it is not working properly, if it has been dropped or damaged, or dropped into water. Return the product to a service center for examination and repair.
4. Keep the cord away from heated surfaces.
5. Never block the air openings of the product or place it on a soft surface, such as a bed or couch, where the air openings may be blocked. Keep the air openings free of lint, hair, and the like.
6. Never use while sleeping or drowsy.
7. Never drop or insert any object into any opening or hose.
8. Do not use outdoors or operate where aerosol (spray) products are being used or where oxygen is being administered.
9. Connect this product to a properly grounded outlet only. See Grounding Instructions.



## SAVE THESE INSTRUCTIONS



## 01 SAFETY PRECAUTIONS



Before installation, please read this manual carefully and install it in strict accordance with the instructions. After reading, please put this manual in a prominent position. Keep the place properly. In order to avoid injury and property damage to users and others, please strictly observe the safety warnings and precautions.



Sign	Meaning
 <b>Warning</b>	It means that if the regulations in this warning are not observed and misoperation is made, serious injury or death may be caused.
 <b>Be careful</b>	It means that if the regulations in this warning are not observed and misoperation is made, serious injury or death may be caused.

The following signs are used to indicate important safety precautions when using the product.

Sign	Meaning
	This figure indicates that it is not feasible and [prohibited].
	This figure shows the content that must be enforced.

	Warning
	The lit cigarettes and other combustibles cannot be put into the toilet cover, otherwise it may cause fire. It is forbidden to disassemble, repair or modify the product by yourself, otherwise it may cause fire or electric shock.
	<p>Please pull out the power plug when it thunders.</p> <p>Do not place the product where it may fall or be pulled into the bathtub or sink.</p> <p>Do not put this product in water or other liquids.</p> <p>Do not touch the product that has fallen into water or soaked in water, and immediately unplug the power plug.</p> <p>Do not stand on the ceramic toilet, and do not hit the ceramic with gravity to prevent damage and water leakage.</p> <p>It is forbidden to embed cementitious materials (cement mortar) into the base of the ceramic toilet, otherwise the ceramic toilet may be cracked due to expansion.</p> <p>Do not exert strong force or impact, do not stand on the seat ring, toilet cover or this product, and do not place heavy objects.</p> <p>Banana water, gasoline, liquid medicine, detergent, insecticide, toilet cleaner and hard brush are prohibited to clean this product.</p> <p>Do not use water other than tap water, otherwise it may cause skin inflammation and other problems.</p> <p>Do not let the sun shine directly on the product to avoid discoloration and affect the reception effect of the remote control.</p> <p>The seat ring and toilet cover of this product have the function of lowering slowly. Do not press hard to avoid damaging the retarder.</p> <p>Do not connect the water pipe with the outlet pipe of the water heater. The water inlet temperature is 3-35 °C. If it exceeds the specified range, it may cause internal heating</p> <p>The component does not work properly.</p> <p>When using this product, do not lean back on the toilet cover to avoid damaging the product.</p> <p>Please do not flush newspaper, paper urinal pads, women's sanitary napkins and other easily clogged items into the toilet.</p> <p>In case of abnormal function or failure of the product, please immediately stop using and cut off the power supply, and contact the service provider in time.</p>

	<p>Do not install and use this product in damp places.</p> <p>This product must be reliably grounded, and the reliable connection of AC socket ground wire to the ground should be ensured. The grounding wire should use a tripod socket.</p> <p>If you are not sure whether it has been reliably grounded, please ask a qualified electrician or maintenance personnel to check and confirm. Please ensure that the The wiring of the power socket conforms to the national standard (zero on the left and fire on the right) and cannot be reversed.</p>
	<p>This product must be connected to a special standard socket and wiring with a 120V/60HZ load current of at least 10A, and the socket must be equipped with Earth fault circuit breaker or earth leakage protector or similar high sensitive and fast leakage switch (rated sensitive current Below 10mA).</p> <p>The socket shall be installed in a place that is not easy to be soaked by water. It is recommended to use waterproof socket.</p> <p>The new hose assembly and other attached or designated parts attached with the appliance shall be used for installation. The old hose assembly cannot be reused.</p> <p>Otherwise, it may cause water leakage, fire or electric shock.</p> <p>When the product is moved indoors from a cold or wet place, it should be stored for 2 hours to fully volatilize the condensed water in the machine, and then it can be started for use.</p> <p>To avoid short circuit of products.</p>

	Be careful
	<p>Do not put this product in water or other liquids.</p> <p>Do not touch the product that has fallen into water or soaked in water, and immediately unplug the power plug.</p> <p>Do not exert strong force or impact, do not stand on the seat ring, toilet cover or this product, and do not place heavy objects.</p> <p>Banana water, gasoline, liquid medicine, detergent, insecticide, toilet cleaner and hard brush are prohibited to clean this product.</p> <p>Do not use water other than tap water, otherwise it may cause skin inflammation and other problems.</p> <p>Do not let the sun shine directly on the product to avoid discoloration and affect the reception effect of the remote control.</p> <p>The seat ring and toilet cover of this product have the function of lowering slowly. Do not press hard to avoid damaging the retarder.</p> <p>Do not connect the water pipe with the outlet pipe of the water heater. The water inlet temperature is 3-35 °C. If it exceeds the specified range, it may cause internal heating</p> <p>The component does not work properly.</p> <p>When using this product, do not lean back on the toilet cover to avoid damaging the product.</p> <p>Please do not flush newspaper, paper urinal pads, women's sanitary napkins and other easily clogged items into the toilet.</p> <p>If the product function is abnormal or fails, please stop using it immediately and cut off the power supply, and contact the service provider in time.</p>
	<p>When installing, disassembling, repairing and maintaining the product, you must unplug the power plug and close the water supply valve.</p> <p>Do not use the product in an environment below 0 °C. If the room temperature is lower than 0 °C, the water in the water supply line of the product must be drained,</p> <p>Prevent the water way from freezing and cracking, causing water leakage or fire during later use.</p> <p>If it is not used for a long time, the power supply and water supply must be cut off.</p> <p>When used by people (including children) with physical, cognitive and intellectual disabilities or lack of experience and common sense, it is necessary to.</p> <p>When using this product under supervision, patients with heart disease should use it carefully.</p> <p>Do not let children play with this product.</p> <p>To prevent damage caused by freezing, please take measures to keep warm and increase the temperature of the toilet.</p>

## 02 TECHNICAL SPECIFICATIONS

Host	Rated voltage	120V~
	Rated frequency	60Hz
	Rated power	1230W
	Water pressure range	The minimum necessary water pressure is 0.08MPa, and the maximum water pressure is 0.8MPa
Cleaning device	Heating mode	Instant heating
	Heating power	1300W
	Warm water temperature	6th gear adjustment
	Cleaning flow	5th gear adjustment
	Cleaning method	Hip wash/mobile wash, women wash/mobile wash, pulse massage (optional)
	Spray position	5th gear adjustment
	Water pressure protection	Pressure stabilizing device and automatic pressure relief device
	Antifouling device	Nozzle automatic cleaning device, anti-siphon device, anti-backflow device, filtering device
	Safety device	Temperature fuse, water temperature sensor, grounding protection, temperature controller, over-temperature protection, leakage protection plug
Drying device	Heating air volume	Greater than 0.2m <sup>3</sup> / min
	Warm air temperature	6th gear adjustment
	Heating power	250W
	Safety device	Temperature controller, temperature fuse, leakage protection plug
Deodorizer	Deodorization method	Activated carbon deodorization
Insulating seat ring	Surface temperature	6th gear adjustment
	Heating power	40W
	Low temperature scald prevention	After 10 minutes of and automatic temperature will automatically slow down to the low gear
	Safety device	Seating inductor, temperature sensor, temperature fuse, temperature controller, leakage protection plug
Careful settings	Night light setting	Intelligent (some models have), always off, always on
	User code setting	Prevent mutual interference when multiple products are used by multiple users
	Automatic flushing function	Automatic flush toilet function after toilet
	Power-off flushing function	It can realize the function of manual flushing toilet after toilet
	Automatic flip function	Can realize automatic sensing flip or remote control flip
Bacteriostati		Seat ring, nozzle
Product executive standard		UL1431

### Remarks:

Rated power: the product starts to power on and start up under the conditions of ambient temperature of 23 ℃, static water inlet pressure of 0.8MPa ± 0.02MPa, and water inlet temperature of 5 ℃. After setting the water pressure, seat temperature and water temperature to the highest level in turn, immediately start the hip wash and continue to work steadily for the average power of a cleaning cycle.

## BILL OF MATERIALS 03

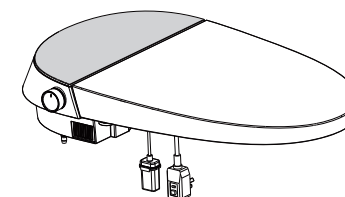
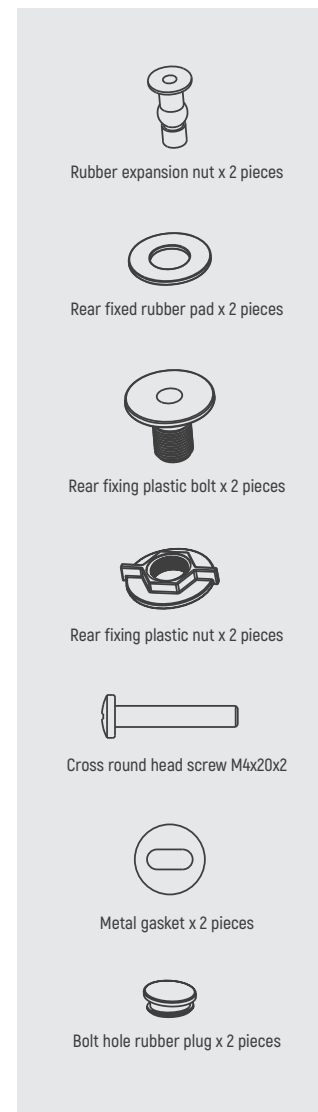

Electronic cover



Remote control assembly



Manual



warranty card  
(Attached to the manual)

## 04 TECHNICAL DRAWINGS

Dimension drawing of side

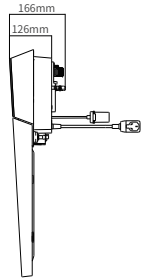

Dimensional drawing of upper cover

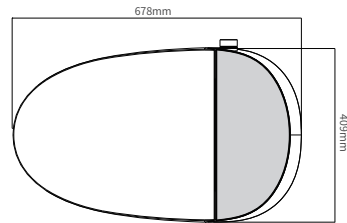

## 05 NAME OF EACH PART

Left side of product

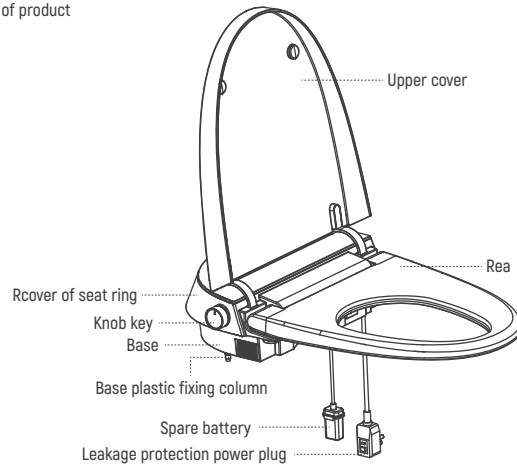

## INSTALLATION STEPS 06

### 1. Install the rubber expansion nut

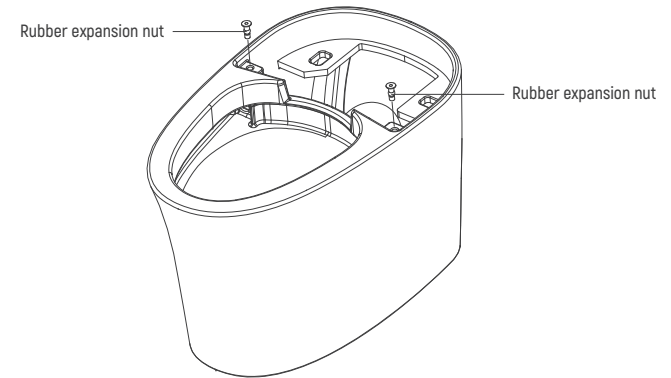

### 2. Install the rear fixing plastic bolts and rubber pads

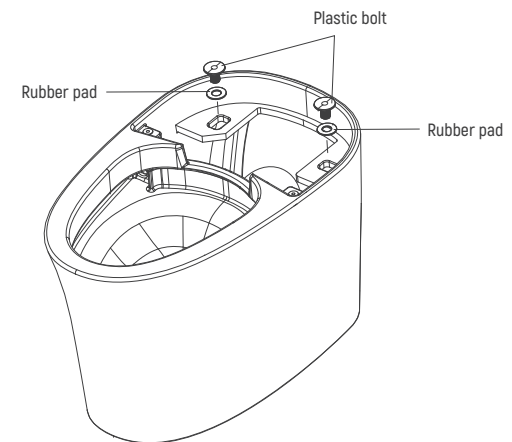

### 3. Install the rear fixed plastic nut

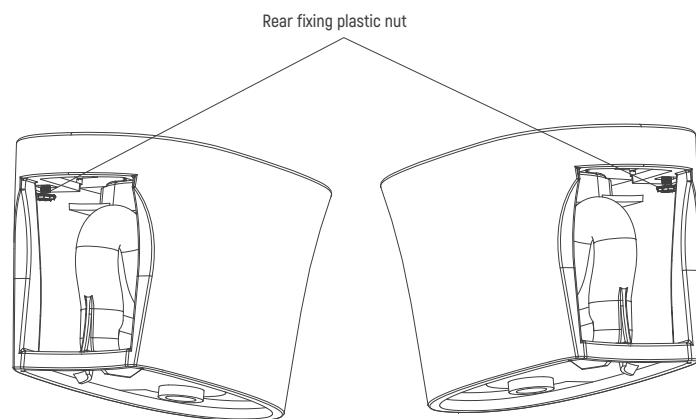

4. As shown in the figure, place the electronic cover on the ceramic. Pay attention to align the plastic fixing column at the base of the electronic cover with the rear fixing plastic bolt hole on the ceramic.

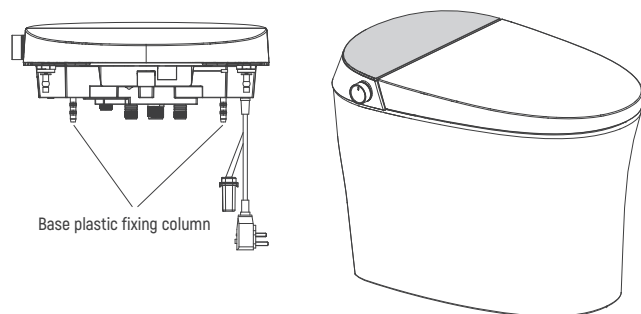

### 5. Installation and fixation of electronic cover

Use two M4x20 cross round head screws with metal gaskets to lock the electronic cover and ceramic, and then tighten the two rear fixed plastic nuts.

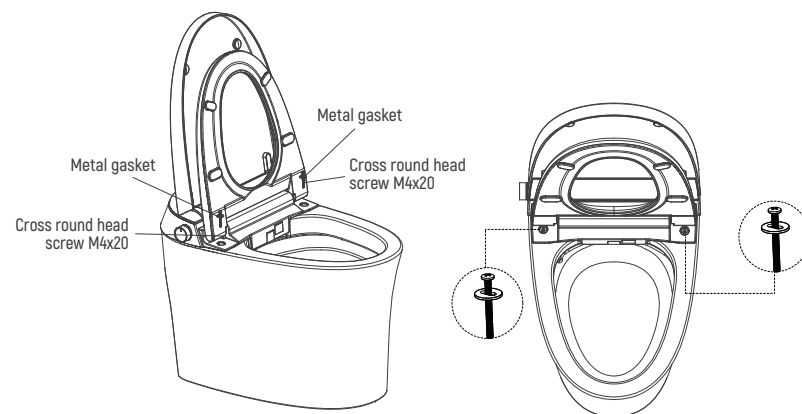

### 6. Installation of bolt hole rubber plug

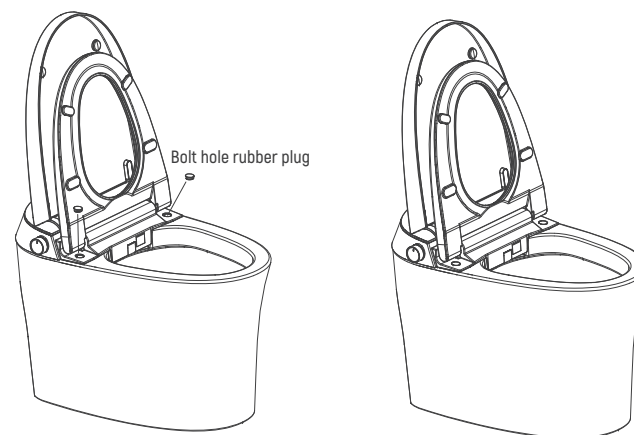

## 7. Connect the hose as shown in the following figure

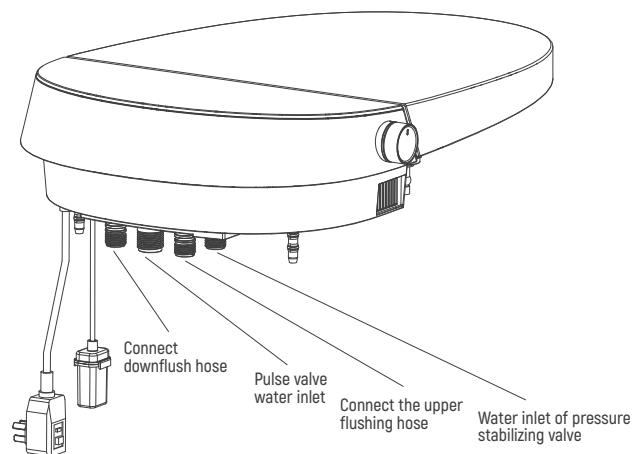

## 1. Open the angle valve

Check the tightness of the threaded connection to make sure there is no water leakage. Turn the angle valve counterclockwise and adjust the opening to the maximum.

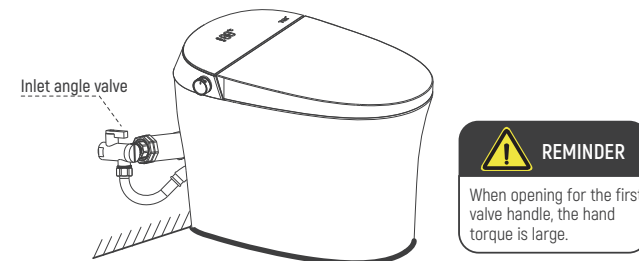

## 2. Power on

Plug the power line leakage protection plug into the power socket, press the reset switch, and the plug indicator light will be on, indicating that it is powered on.

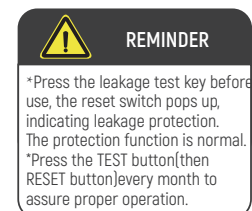

\*It is applicable to the model with leakage protection plug. The leakage protection plug is subject to the actual object.

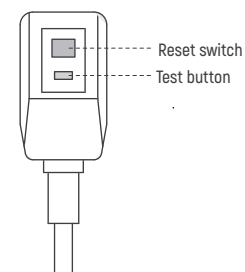

## 3. Safety self-inspection

1. The buzzer of the main engine beeps, the blue light of the knob flashes, and the self-test starts;
2. The buzzer of the main engine rings another "tick", and the knob turns on white light after self-inspection;
3. The function mode is on and can be used normally.

## 08 DAILY MAINTENANCE

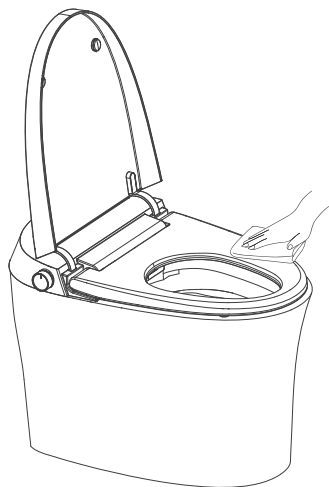

### Maintenance of body

#### 1. Cut off the power supply

Please cut off the power supply before maintenance.

#### 2. Wipe with soft cloth

Please wipe the dirty part with a soft cloth that has been screwed dry.

#### 3. Safety self-inspection

Please reconnect the power supply after wiping.

### Nozzle maintenance

#### 1. Nozzle extends

Press and hold the "Stop" button and "Hip wash" button on the remote control for 3s at the same time to enter the manual cleaning procedure.

#### 2. Nozzle cleaning

Please wipe with a soft cloth or soft brush.

#### 3. Cleaning is completed

Press the "Stop" button to exit the manual cleaning mode and the spray bar will retract automatically.

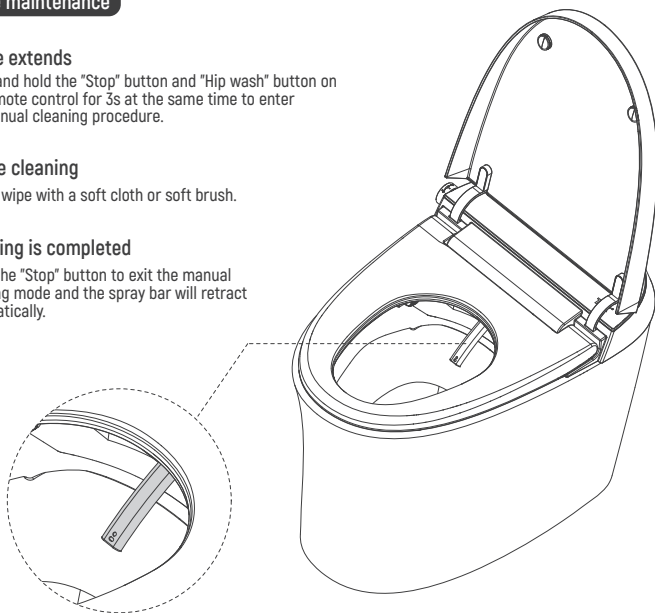

### Replace activated carbon

1. Open two rubber plugs, loosen two screws, and pick up two screws and gaskets.

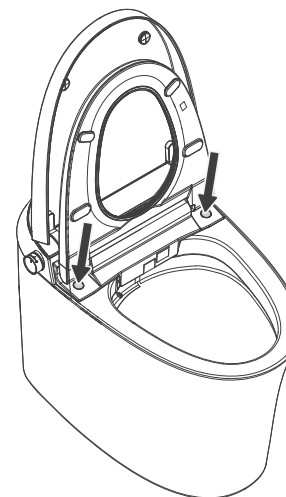

2. Remove the four water pipes, gently lift the base and put it upside down, loosen the screws of the activated carbon and remove the cover.

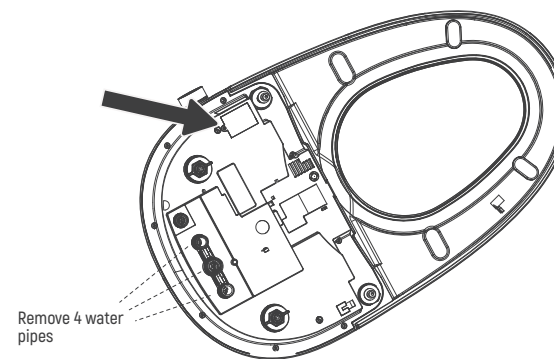



3. After loosening the tape, pull out the activated carbon, replace it with a new one, and then install the cover and lock it.

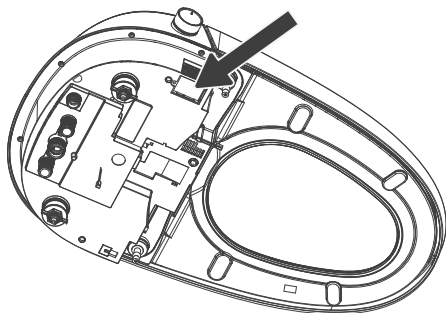

4. Connect and tighten the four removed water pipes in turn. Put the cover back into the ceramic body, lock the screw and cover the rubber plug.

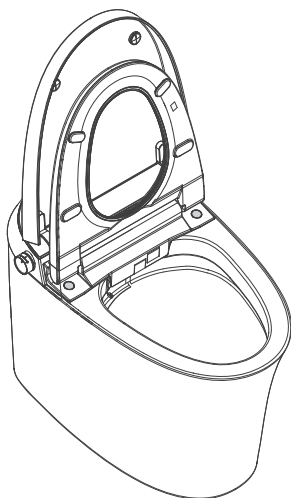

## 09 FUNCTION DIAGRAM OF MAIN ENGINE KNOB

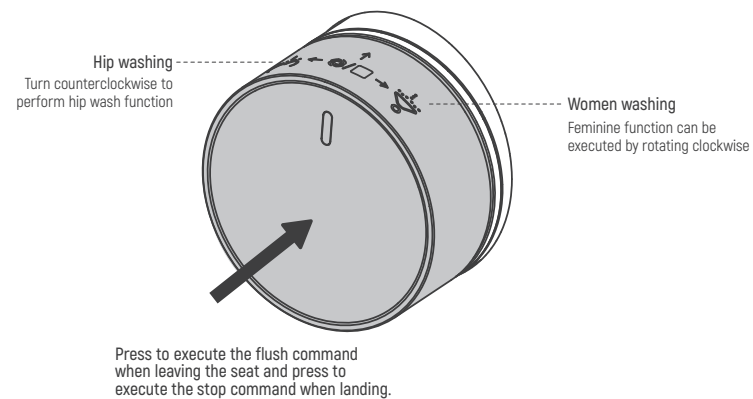

### Battery replacement

1. Remove the battery box from the back of the toilet and pull out the battery box connector.
2. Open the battery box, remove the old battery and replace it with a new one.
3. Plug in the battery box connector and the toilet cable and put them back on the back of the toilet.

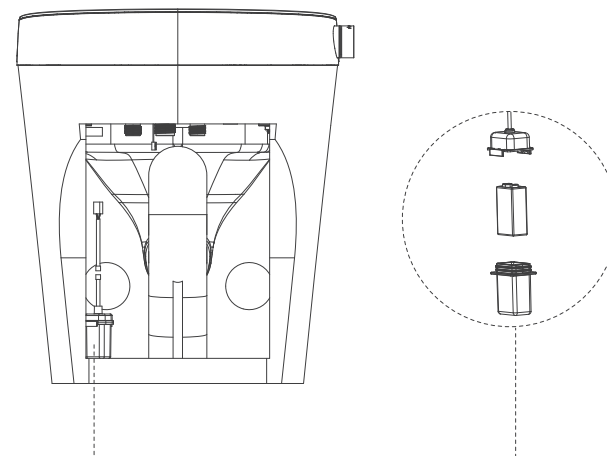

## 10 AUTOMATIC FLAP FUNCTION (SOME MODELS HAVE THIS FUNCTION)

If you buy an electronic toilet with automatic flap function, this product can realize automatic opening/closing of the toilet cover.

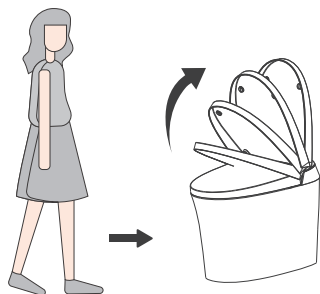

### 1. When close to the toilet

When the human body is close to the toilet, the toilet lid will open automatically after the human body movement is detected.

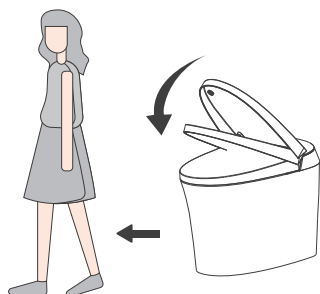

### 2. When using the toilet seat

When the human body leaves the toilet for about 60 seconds, the toilet cover automatically closes.

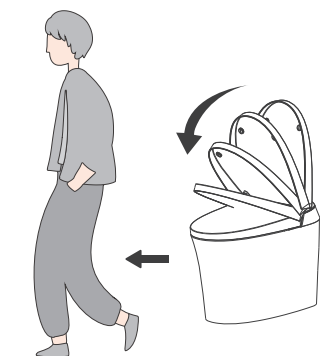

### 3. When men urinate while standing

Open the seat using the remote control or manually. When a man leaves the toilet more than 10 seconds before standing, he will automatically small flush the water once in about 10 seconds (this function is turned off by default and can be turned on through the remote control). After use, the toilet cover and seat ring will close automatically about 60 seconds after people leave the toilet.

## REMOTE CONTROL 11 DESCRIPTION

### Install remote control

#### Install the remote control rack

1. Stick the remote control rack vertically to the pre-installation area on the wall, and mark the position of two installation holes on the wall with a marker. Use a drill bit with a diameter of 6mm to drill holes at the marked positions on the wall, with a depth of 35mm.

2. Install the expansion pipe into the wall hole, attach the hanger to the wall, align the hole on the hanger with the expansion pipe, and place the screw to lock it.

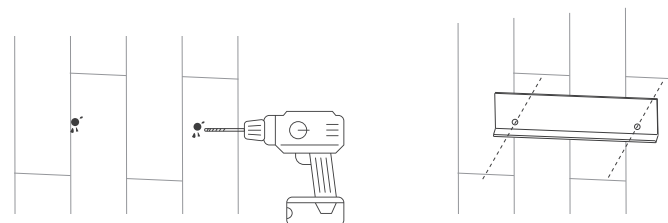

#### Install the remote control hanger (only for the hanger with fixed plate and foam rubber pad)

1. Clean and dry the pre-installed area of the remote control rack on the wall.

2. Tear off the double-sided adhesive sticker on the back of the hanger and stick it horizontally to the wall.



3. Install the battery into the remote control and cover the battery cover.

4. Place the remote control in the rack.



### KIND TIPS

When determining the installation position, pay attention to ensure that the remote control can be reached by hands when people sit in the seat. Do not install and use this product in wet places in the bathroom. Do not put it in places that are easy to get wet.

## Remote control function keys

### Remarks

- The spray bar can be adjusted to 5th gear.
- The water temperature can be adjusted at the 6th gear. If the light is off, the water temperature will not be heated.
- The water temperature can be adjusted at the 6th gear. If the light is off, the water temperature will not be heated.
- The seat temperature gear is adjustable at 6th gear, and when the light is off, the seat temperature is not heated
- The wind temperature gear is adjustable at 6th gear. If the light is off, it is in neutral, and it is natural wind.

### Seat temperature adjustment button

The 0-5 gear can be switched to different temperatures. The 0 gear is the ambient temperature.

### Drying air temperature adjustment button

The 0-5 gear can be switched to different temperatures. The 0 gear is the natural wind.

### Cleaning water temperature adjustment button

The 0-5 gear can be switched to different temperatures. The 0 gear is the no heating.

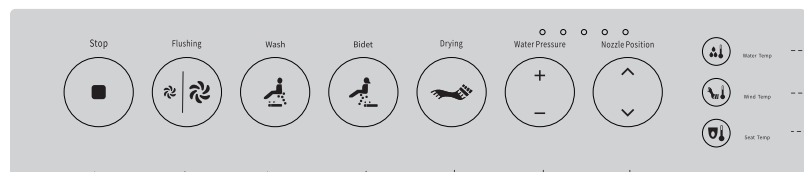

**Small punch**  
Short press small punch  
long press big punch

**Women washing**  
Press again to perform  
mobile massage in the  
process of women washing

**Water pressure  
regulation**  
The proper water pressure  
can be adjusted according  
to different positions up  
and down during cleaning

**Stop it**  
Stop all operations

**Hip washing**  
After going to the toilet,  
press once to perform hip  
wash and then press once  
to perform mobile massage

**Dry**  
Press this key to perform  
warm air drying after cleaning,  
and the temperature  
can be adjuste

**Spray rod adjustment**  
The length of spray bar can  
be adjusted according  
to different positions up  
and down during cleaning

### Massage

Press this key to perform  
strong and weak massage when  
cleaning and moving massage

### Flip/flip

The cover will automatically turn when the human body approaches.  
If you need to turn the circle, you can press this key to perform the  
function of turning the circle. Press the cover/circle again to close  
the cover/circle automatically after the person leaves



**Night light**  
Night light on key



### Stop it

Stop all operations



### Big/small punch Press

The big/small punch button on the remote control to perform the small flush function. Press and hold the large/small flush button on the remote control to perform the large flush function.

Note: When the human body approaches the toilet, opens the seat ring, and stands at the front of the toilet for more than 10 seconds, it will automatically flush about 10 seconds after leaving.



### Hip wash mobile massage

Press the buttock wash button on the remote control or turn the knob on the machine backward to perform the buttock wash operation. Press the hip wash button on the remote control again to perform mobile massage. If you press the "Stop" key halfway, you can stop immediately.

Note: The mobile massage is the telescopic cleaning of the spray bar.



### Women's washing mobile massage

Press the washing button on the remote control or turn the knob on the machine forward to perform the washing operation. Press the washing button on the remote control again to perform mobile massage. If you press the "Stop" key halfway, you can stop immediately.

Note: The mobile massage is the telescopic cleaning of the spray bar.



### Drying

Press this button to perform warm air drying. The air temperature can be adjusted at 6th gear. If it is pressed to "stop" button on the way, the air drying can be stopped immediately.



### Water pressure regulation

When performing the hip wash or women wash function, press the water pressure adjustment button on the remote control to adjust according to personal habits Outlet pressure.

Note: The water pressure regulation gear is adjustable at 5. Press the water pressure regulation [+] key to increase the water pressure at 1 gear, and press the water pressure regulation [-] key to decrease the water pressure at 1 gear.



### Spray rod adjustment

When performing the hip wash or women wash function, you can press the spray bar adjustment button on the remote control to extend according to your personal habits. The telescopic length of the spray bar.

Note: The spray bar can be adjusted to the 5th gear. Press the spray bar adjustment [^] key on the remote control to extend the spray bar forward one section, and press the spray bar adjustment [v] key the spray bar to retract one section inwards.



### Water temperature regulation

When performing the hip wash or women wash function, press the water temperature button on the remote control to adjust the outlet water temperature according to personal habits.

Note: The water temperature is adjustable at the 6th gear, and the water temperature is not heated when the light is off and in neutral.



### Air temperature regulation

When performing the drying function, press the air temperature button on the remote control to adjust the air outlet temperature according to personal habits.

Note: The wind temperature gear is adjustable at 6th gear, and when the light is off, it is neutral, it is natural wind.



### Seat temperature adjustment

After power-on, the temperature can be adjusted through the seat temperature button on the remote control according to personal habits. After power-on, the seat automatically keeps constant temperature with the parameters set by the customer.

The temperature of the seat is adjustable at 6th gear, and the ambient temperature is at this time when the light is off at neutral gear. Please do not cover anything on the seat to prevent the sensor from being unable to sense and causing the function not to work properly. The human body automatically switches to the first gear after sitting down to prevent low-temperature scald.



### Strong and weak massage

When performing hip washing and women washing functions, press the massage button on the remote control to enter the strong and weak massage mode.

Note: The strong and weak massage is an automatic mutation of water pressure to achieve the effect of strong and weak massage.



### Night light function

Press the night light button on the remote control to turn on/off the night light function.



### Flipping function

When the human body approaches, the toilet will automatically open.

If you need to open the seat, you can use the function of flipping the seat ring on the remote control, and press the button again to close it.

When the human body leaves for about 60 seconds, the toilet will automatically close.

## control function setting

### 1. Night light setting

Briefly press the "Night Light" button on the remote control, and the night light status will switch between the normally on and off status;

### 2. Nozzle manual cleaning function

· Press the "Stop" button and "Hip wash" button on the remote control for 3S at the same time to enter the manual cleaning procedure.

**Manual cleaning procedure: from the reversing valve to the self-cleaning port, the water flows out, and the spray bar extends to the longest position for 10 minutes. If the countdown is 10 seconds, the "tick" sound prompt will sound once every 1 second.**

· During the manual cleaning process, press the "Stop" button on the remote control or knob to exit the manual cleaning mode and the nozzle will retract;

· After the manual cleaning is completed or stopped halfway, the spray bar retracts and sprays water automatically.

### 3. Nozzle automatic cleaning function

· Press the "Stop" button and "Women Wash" button on the remote control for 3S at the same time to enter the nozzle automatic cleaning mode. Automatic cleaning procedure: from the reversing valve to the self-cleaning port, the spray bar will be cleaned from the longest to the reset cycle for 10 times, and the function can be terminated by pressing the remote control or local stop button halfway.

· In the automatic cleaning state, if the seat ring sensor becomes conductive, it will exit the automatic cleaning mode, the nozzle will stop flowing water, and the spray bar will retract.

### 4. Mute function

· Press the "Stop" and "Drying" keys on the remote control for 3S at the same time to enter the mute mode.

· The buzzer function is off in mute mode.

### 5. Remote control pairing

Before the machine is powered on, press and hold the feminine washing button on the remote control. The five lights on the remote control will flash and enter the pairing mode. At this time, the machine is powered on, wait for the indicator on the knob to turn into red light and green light flash alternately, then press the machine knob, and when you hear a beep, the pairing is successful. After the pairing is successful, press the stop button on the remote control to exit the pairing mode.

### 6. Open/close the automatic flip function

At the same time, press and hold the "night light" button and "flip" button on the remote control for 5s, and the buzzer will beep to turn on or off the automatic flip function.

## 12 Simple fault analysis and elimination

Product part or function	Phenomenon	Troubleshooting items	Exclusion method
complete machine	inoperation	Whether to turn on the power	Power on
		Whether the leakage protector jumps off	Press the leakage switch again
		Power failure or not	Wait for power supply
Hip wash	The nozzle does not discharge water or cannot function normally	Whether the water supply switch is on	Turn on the water supply switch
		Whether to stop water supply	Wait for water supply to recover
		Whether the orifice is blocked by foreign matters	Remove foreign matters and manually clean the nozzle
		The seat sensor is not connected	Readjust the sitting position so that it is connected with the seat sensing
	Low water pressure	Is the water pressure gear set to low gear	Reset the water pressure gear
		Whether the water supply channel is normal	Clean the filter screen at the water supply outlet and supply water again
	water temperature is low	Is the water temperature gear set to the low gear	Reset the water temperature gear
	Stop water halfway	Whether the automatic stop time is exceeded	Re-execute the function
		Whether the landing sensor is disconnected halfway	Readjust the sitting position so that it is connected with the seat sensing
Warm air drying	Low heating temperature	Whether the wind temperature gear is set to low gear	Reset the water temperature gear
	Half-way stop	Whether the automatic stop time is exceeded	Re-execute the function
		Whether the landing sensor is disconnected halfway	Readjust the sitting position so that it is connected with the seat sensing
Seat ring heating	Insufficient seat ring temperature	Is the seat temperature gear set to low gear	Reset the seat temperature gear
Deodorization	Do not start	The seat sensor is not connected	Readjust the sitting position so that it is connected with the seat sensing
Remote control		Is there any foreign object blocking the reception of the remote control	Remove foreign objects
		Whether the use angle and distance of the remote control are correct	Adjust distance and angle
		Is the remote control battery discharged	Replace with a new battery

## Fault code 13

category	Fault classification	Fault location	Enter fault condition	Symptoms	Remove fault conditions	Fault alarm	Fault display code
one	Complete machine failure	random	Multiple sensors have failed	The whole machine does not work normally	Remove the fault after the whole machine works normally	All lights flash and buzzer sounds for 3s	E E
two	Instant heating module	Abnormal communication	Abnormal communication with hot plate	Water stop heating and cleaning stop	The fault is removed after communication is restored	All lights flash and buzzer sounds for 3s	E1
three	flow	Do not stop water after stopping work	After the function is stopped, the buttock woman washes all the time	Uncontrolled hip washing	Fault removal after control	All lights flash and buzzer sounds for 3s	E2
four		Inlet flow	The flow meter has no flow after the inlet valve is opened	The water stops heating and other functions work normally	Fault removal after flow recovery	All lights flash and buzzer sounds for 3s	E3
five	Gearbox	Gearbox stuck	Can't flip	Flip function stop	Fault removal after recovery	All lights flash and buzzer sounds for 3s	E4
six	knob	Knob does not respond	No response when the knob is turned counterclockwise	The buttock wash function knob light flashes	Fault removal after recovery	The three-color light on the knob flashes in turn, and the buzzer rings for 3s	E5
seven			No response when the knob is turned clockwise	The knob light of the women's washing function does not flash	Fault removal after recovery	The three-color light on the knob flashes in turn, and the buzzer rings for 3s	E6
eight			No response when pressing the knob	Stop function knob lamp flashes	Fault removal after recovery	Tri-color on knob Lights flash in turn, buzzer sounds for 3s	E7

nine	water temperature	Inlet NTC	Water inlet NTC open circuit or short circuit	Water stop heating and cleaning stop	Fault removal after NTC recovery	The water temperature indicator flashes and the buzzer sounds for 3s	<b>A1</b>
ten		Inlet NTC	Inlet water temperature > 42 °C	Water stop heating and cleaning stop	Fault removal after temperature recovery	The water temperature indicator flashes and the buzzer sounds for 3s	<b>A2</b>
eleven		Inlet NTC	Outlet NTC open circuit or short circuit	Water stop heating and cleaning stop	Fault removal after NTC recovery	The water temperature indicator flashes and the buzzer sounds for 3s	<b>A3</b>
twelve		Inlet NTC	Outlet water temperature > 42 °C	Water stop heating and cleaning stop	Fault removal after temperature recovery	The water temperature indicator flashes and the buzzer sounds for 3s	<b>A4</b>
thirteen		Inlet NTC	Inlet water temperature is the same as outlet water temperature (no temperature rise)	Water stop heating) Cleaning stop	Fault removal after temperature recovery	The water temperature indicator flashes and the buzzer sounds for 3s	<b>A5</b>

fourteen	Wind temperature	Wind temperature NTC	Air temperature NTC open circuit or short circuit	Drying stop heating	Fault removal after temperature recovery	The wind temperature indicator flashes and the buzzer sounds for 3s	<b>C1</b>
fifteen			Wind temperature NTC > 65 °C	Drying stop heating	Fault removal after NTC recovery	The wind temperature indicator flashes and the buzzer sounds for 3s	<b>C2</b>
sixteen			No temperature rise	Drying stop heating	Fault removal after temperature recovery	The wind temperature indicator flashes and the buzzer sounds for 3s	<b>C3</b>
seventeen	Seat temperature	Seat temperature NTC	Seat temperature NTC open circuit	Seat temperature stop heating	Fault removal after temperature recovery	Seat temperature indicator flashes and buzzer	<b>H1</b>
eighteen			Seat temperature NTC > 42 °C	Seat temperature stop heating	Fault removal after NTC recovery	Seat temperature indicator flashes and buzzer sounds for 3s	<b>H2</b>

14 Restriction indicator of electronic and electrical hazardous substances

Part name	Hazardous substances					
	铅 (Pb)	汞 (Hg)	镉 (Cd)	六价铬 (Cr) (VI)	多溴联苯 (PBB)	多溴二苯醚 (PBDE)
Power cord	×	○	○	○	○	○
Circuit	×	○	○	○	○	○
Seat sensor	×	○	○	○	○	○
Temperature sensor	×	○	○	○	○	○
Angle valve	×	○	○	○	○	○
Earty lug	×	○	○	○	○	○
Motor assembly	×	○	○	○	○	○
Water inlet hose	×	○	○	○	○	○
Expansion bolt	×	○	○	○	○	○
Temperature sensor	○	○	×	○	○	○
Stabilizer assembly	×	○	○	○	○	○
○: means that the content of the hazardous substance in all homogeneous materials of the component is below the limit specified in GB/T 26572. ×: It means that the content of the hazardous substance in at least one homogeneous material of the component exceeds the limit specified in GB/T 26572.						

Environmental Protection Use Period

The number of years in this sign is based on the environment of SJ/T 11364-2014 [Requirements for Restriction of Use of Hazardous Substances in Electronic and Electrical Products]  
Protection period. As long as the precautions for safety and use of this product recorded in the user manual are observed  
Within a certain period of time, there will be no leakage or mutation of harmful substances caused by the use of the product, no serious pollution to the environment or users  
Serious personal and property damage. [Environmental protection service life] is not a safe service life nor a quality assurance period, and the product is not suitable  
If it needs to be discarded for further use, please comply with the relevant laws and regulations on the recycling of electronic and electrical products. Thank you for your cooperation.  
Note: Depending on the product model, the product you purchased may not contain all the above components.

15 Label illustration

Illustration	explain
	Sitting induction point
	Antibacterial identification of

Product warranty card 16

Product name	Smart toilet	Product model		Customer
Purchase date		serial number		
Customer		Warranty	2 years	
Contact				
Maintenance record	Fault and	Repair	Repair date	
Receipt				
User name		contact		Send it back to our company or the place of purchase
Contact				
Buyer		Purchase		
Product		Satisfaction	<input type="checkbox"/> Satisfied <input type="checkbox"/> Ordinary <input type="checkbox"/> Dissatisfied	
serial		Customer		

Matters related to product warranty

\*The customer must carefully fill in the warranty card and receipt form and properly keep the warranty card to avoid unnecessary delay caused by affecting the later maintenance.  
\*Please contact the purchasing point or after-sales service department of the company when finding product quality problems.  
\*When purchasing this product, please fill in the product warranty card carefully and keep it properly.  
\*Within 30 days from the purchase date, if the product is found to have quality problems under normal use, the company will be responsible for replacement after confirmation by the company's technical personnel.  
\*During the warranty period, except for the problems mentioned in the instruction manual, precautions, labels and other prompts, the company will provide free maintenance if the customer fails in normal use.  
\*During the warranty period, the company will charge the corresponding maintenance fee for the fault caused by the misoperation of the user without following all the prompts such as the instructions, precautions, labels, etc.  
\*For the failure caused by unauthorized disassembly or unauthorized modification, the company will charge corresponding maintenance costs as appropriate.  
\*For the failure caused by force majeure such as fire, typhoon, flood, earthquake, lightning, etc., the company will charge corresponding maintenance costs as appropriate.  
\*If the consumable parts need to be replaced after reaching the service life, the company will charge corresponding fees as appropriate.  
\*If the product has been repaired by maintenance personnel not certified by our company, and it fails in the later period, our company will charge corresponding maintenance fees as appropriate.  
\*Faults and damages caused by use outside ordinary families (such as public places, etc.) will be subject to corresponding post-maintenance treatment after being identified by the company's technical personnel [the company's certified maintenance personnel].  
\*If there is no purchase invoice, it may affect the later maintenance problems. (such as extended confirmation time, etc.)  
\*If the warranty card information is not filled in and the "user receipt" is not sent back to the company, it may affect the later maintenance problems. (such as extended confirmation time, etc.)