

# NOMA<sup>®</sup> MD

## Turin LED Ceiling Fan

model no. 052-6972-6

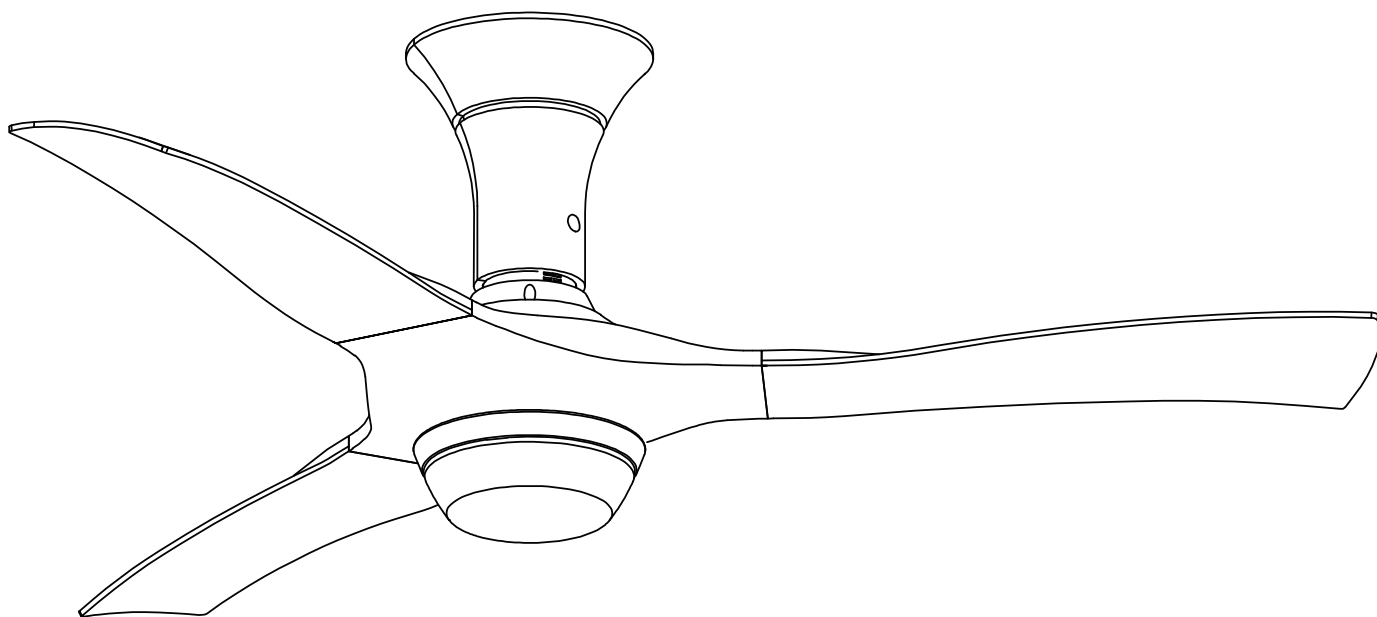

### Instruction Manual

Toll-free: 1-866-827-4985

**IMPORTANT:** Please read and understand this manual before any assembly. Before beginning assembly of product, make sure all parts are present. Compare parts with exploded view. If any part is missing, or if you have any questions, contact customer service at 1-866-827-4985 (toll-free).

Exploded view .....	1
Important safety instructions .....	2
Rules for safe installation .....	2
Tools required for assembly .....	3
Assembly .....	3
Operation .....	7
Maintenance .....	8
Care and cleaning .....	8
Troubleshooting .....	8
Environmental protection .....	9
Warranty .....	10

## EXPLODED VIEW

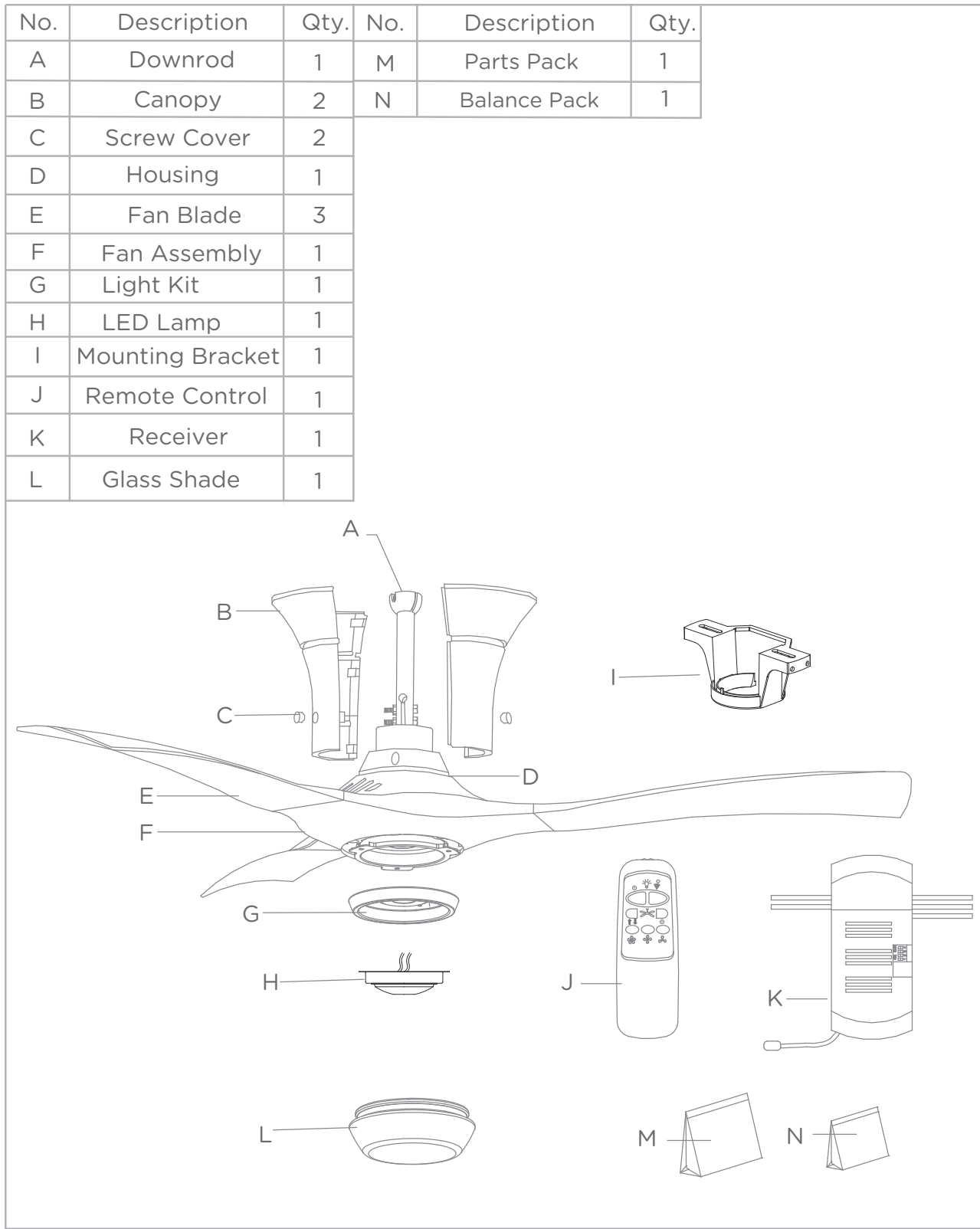

## IMPORTANT SAFETY INSTRUCTIONS

Please retain this manual for future reference.



**Note:** Always turn the power off before servicing the ceiling fan.

- A dry dust cloth is suitable for most cleanings.
- Should the ceiling fan become wet, have a qualified electrician inspect it before next use.
- In order to comply with safety regulations and to avoid safety hazards, ceiling fan repairs must be carried out by qualified personnel.
- Pay attention to the ceiling fan blades when cleaning, painting or working nearby.
- Children do not recognize the dangers that may occur when operating ceiling fan. Keep children away from ceiling fans.

- DO NOT:**
- Expose the ceiling fan to water or immerse it in water.
  - Operate the ceiling fan if it shows any signs of damage or if it has been dropped.
  - Attempt to remove any parts of the housing or insert any object while the ceiling fan is operating.
  - Position the ceiling fan on or near hot surfaces such as stove tops, or near open flames.
  - Expose the ceiling fan to rain or moisture.
  - Operate the ceiling fan outdoors or with wet hands.
  - Use the reverse switch while the fan blades are in motion. This could result in damage to the ceiling fan.

## RULES FOR SAFE INSTALLATION

This ceiling fan is designed for household use only and not for commercial applications. No responsibility is accepted for damage resulting from improper use or noncompliance with the instructions.



### CAUTION!

- To avoid possible electric shock, be sure electricity at the fuse box or the circuit breaker is turned off before wiring.
- All wiring must be done in accordance with national and local wiring codes. Consult a qualified electrician to ensure correct branch circuit conductor.
- Follow the recommended instructions for the proper method of wiring for the new ceiling fan. The ceiling fan must be grounded as a precaution against possible electric shock.
- If you do not have sufficient electrical wiring knowledge, have the fan installed by a licensed electrician.
- The outlet box and joist must be securely mounted and capable of reliably supporting at least 35 lb (15.9 kg).
- Mount the lowest moving parts at least 6' 11" (2.1 m) above floor or ground level.
- Make sure all electrical connections are sealed with proper connectors and electrical tape inside the outlet box.
- Make sure the ceiling fan is securely fastened to the ceiling.
- All set screws must be checked and re-tightened where necessary before fan operation.



### WARNING!

- Mount only to an outlet box marked acceptable for fan support.
- To prevent injury, make sure the fan blades are not bent and that there are no objects within the rotation area.
- The important precautions, safeguards and instructions appearing in this manual are not meant to cover all possible situations. It must be understood that common sense and caution are factors which cannot be built into the product.
- Not suitable for use with solid-state speed controls.





## TOOLS REQUIRED FOR ASSEMBLY

This manual is designed to make it as easy as possible for you to assemble, install, operate and maintain the ceiling fan. The following tools listed are required for assembly and installation:

	1 x star-head screwdriver		1 x stepladder
	1 x flat screwdriver		1 x wire stripper/pliers
	1 x wrench		1 x electrical tape

After opening the package you should find all the necessary parts for installing this ceiling fan. The box should also contain:

Parts Pack Containing:

- 2 wood screws with flat washers 
- 2 5/32" screws with lock washers 
- 3 4x10 screws 
- 4 blade screws 
- 1 "J" hook 

1 zip tie 

3 balance pieces

1 balancing clip

1 instruction sheet

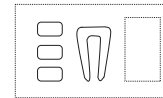

## ASSEMBLY

### Preparing for installation

#### Getting ready

- Unpack and inspect carefully to make sure all parts are included and not damaged (see Fig. 1). Lay all pieces out on a working space.
- Turn off power at fuse box or circuit breaker to avoid possible electric shock (see Fig. 2).

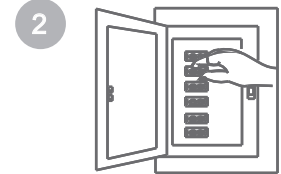
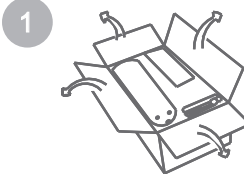

#### Choosing a location for the ceiling fan

- For effective air circulation, fans should be located in the centre of the room, or a minimum of 32" (81.3 cm) from adjacent walls or obstructions.
- Choose a location where there is a high enough ceiling clearance (at least 6' 11" (2.1 m) from the floor to the ceiling fan's lowest moving part).
- Ensure that the outlet box in the room's ceiling can support the weight of the fan. Typically, if the outlet box is marked "acceptable for fan support", it can hold the fan securely.

### Mounting option

#### Drop-mount (for normal ceilings)

- This method is preferred if the ceiling is sloped or vaulted, or if the ceiling is extra high, requiring the need of a downrod (see Fig. 3).

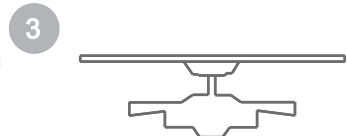

## ASSEMBLY

### Installation

#### 1. Mounting bracket



**Note:** The mounting bracket depicted will vary depending on the model.

- Remove the four sets of side screws from mounting bracket and save for future use.

##### Normal masonry ceiling

- Securely attach the mounting bracket to an outlet box marked “Acceptable for Fan Support”, using the supplied outlet box screws with lock washers (see Fig. 4a).

##### Wooden ceiling

- Drill two mounting holes in the ceiling joist. Securely attach an outlet box marked “**Acceptable for Fan Support**”, using the supplied outlet box screws with lock washers (see Fig. 4b).

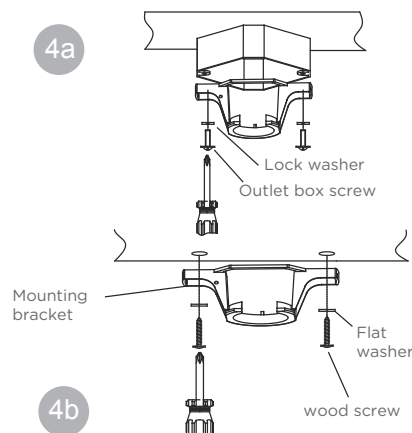

#### 2. Drop-mount



**Note:** Canopy picture may vary depending on style of ceiling fan.

##### Downrod assembly

- Loosen 2 screws on the motor coupling. Insert the downrod and thread the safety cable and wire through the downrod (see Fig. 5)

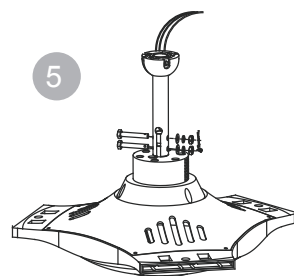

- Lock the downrod to the motor, tighten the 2 screws on the motor coupling (see Fig. 6).

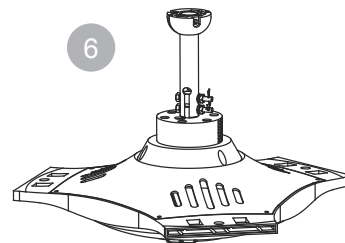

##### Hands-free wiring

- Carefully lift the fan assembly onto the mounting bracket.
- Rotate the fan until the notch (b) on the aluminum ball fits against the ridge (a) on the mounting bracket (see Fig. 7).
- With the mounting bracket holding the fan assembly, follow wiring instructions (step 3).

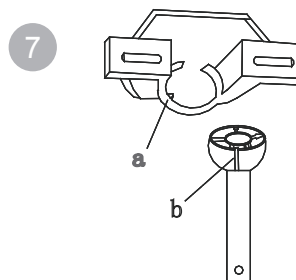

**NOTE:** For added security, attach safety cable from fan unit to “J” hook in outlet box. Secure by looping zip tie through safety cable and “J” hook. Tighten zip tie securely.

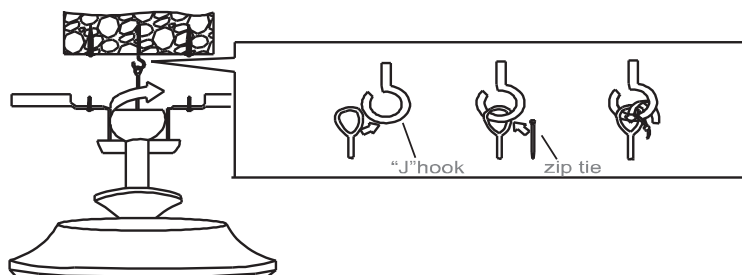

## ASSEMBLY

### 3. Wiring instructions

**⚠ IMPORTANT:** If you are not sure if the electrical outlet box and fan are grounded, contact a licensed electrician for advice. They must be grounded for safe operation.

**⚠ WARNING:** To avoid possible electric shock, be sure electricity is turned off at the main fuse box before wiring.

#### Remote and Receiver Pairing

Codes are set by pushing the location of the dip switches located on the transmitter and receiver up or down. It is important that the code used for both the remote and receiver are identical for the two devices to be able to communicate; otherwise the remote will not be able to control the fan.

**⚠** If you plan to install more than one fan then each fan will require the remote and receiver to use a unique code, or else one remote will be able to control more than one fan.

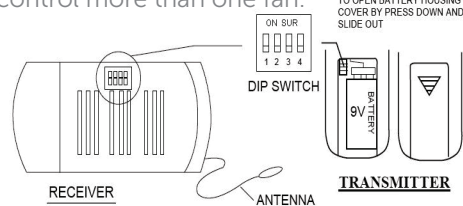

#### Installing Receiver Assembly

Once the connection has been made, the receiver inserts into the drop rod hanging bracket. The canopy comes up to cover the receiver and bracket.

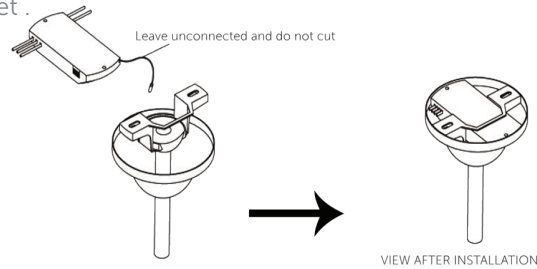

#### Between fan and receiver:

- Connect the black wire marked "L" from the fan to the black wire marked "TO MOTOR L" from the receiver.
- Connect the blue wire marked "FOR LIGHT" from the fan to the blue wire marked "FOR LIGHT" from the receiver.
- Connect the white wire marked "N" from the fan to the WHITE wire marked "TO MOTOR N" from the receiver.

#### Between receiver and mains :

- Connect the black live wire marked "AC IN L" from the receiver to the live wire (typically black) from the outlet box.
- Connect the white neutral wire marked "AC IN N" from the receiver to the neutral wire (typically white) from the outlet box.
- Connect the green ground wires from the mounting bracket and hanging ball to the ground wire (bare or green) from the outlet box.

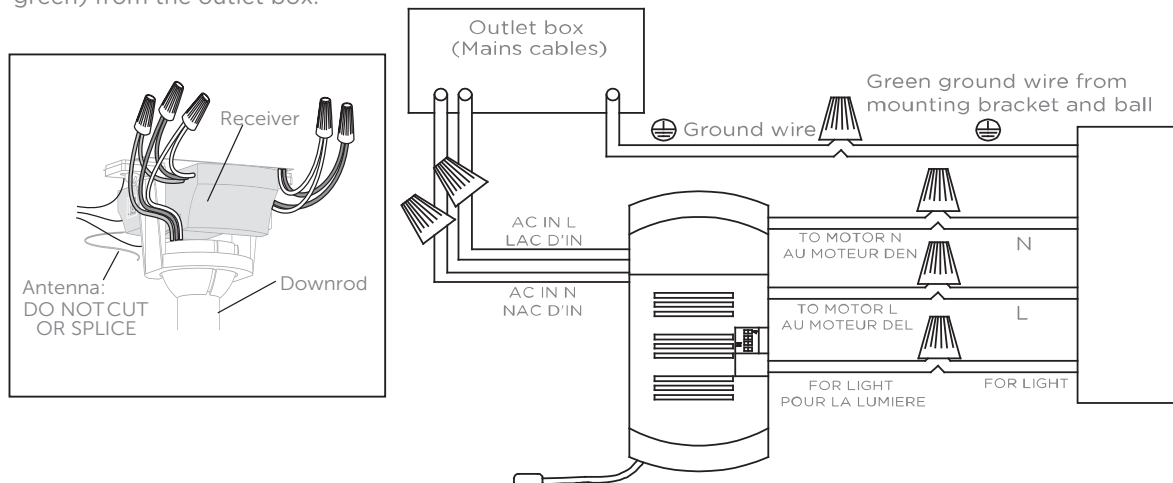

## ASSEMBLY

- When wires are matched up, connect them by twisting frayed ends together (see Fig. 8a).
- Screw wire connectors (3 are provided) onto the tops of the twisted wires (see Fig. 8b).
- Fasten them with electrical tape (see Fig. 8c).

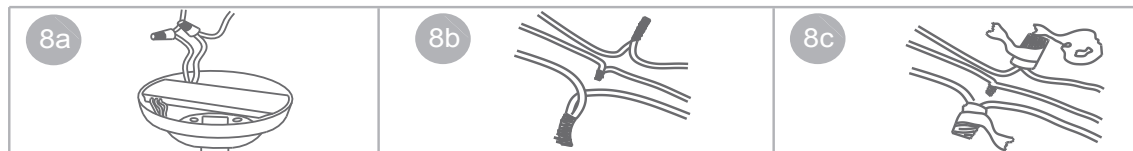

**⚠ WARNING:** Be sure no bare wire or wire strands are visible after making connections. Place green and white connections on opposite side of box from the black and blue (if applicable) connections.

### 4. Attach canopy to motor

- Raise the upper canopy and tighten it. Be sure the upper canopy does not touch the ceiling. Insert the screw cover (2 pcs) as shown (see Fig. 9).

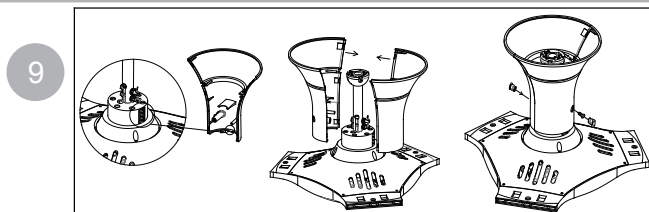

### 5. Attach blade assembly to motor

- Insert fan blade into slot of motor assembly (see Fig. 10).
- Ensure all screws holding the blades are tightly secured (see Fig. 11).

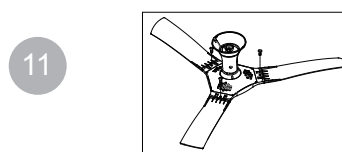
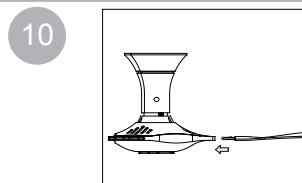

### 6. Connect switch housing and light kit

- Secure the fan light up to the bottom of the motor with fan light screws (see Fig. 12a).
- Make wire connection. Plug the connector from the motor into the connector from the fan light. Carefully put the wires into the switch box. Secure the fan light up to the bottom of the motor with fan light screws (see Fig. 12b).

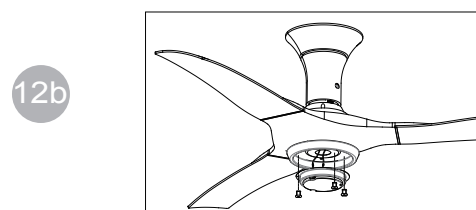
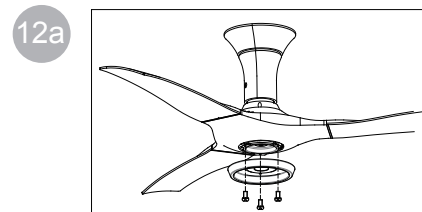

### 7. Mounting light kit glass

- Install the glass shade by screwing it onto the central fan fixture. Make sure the glass shade is securely attached, but DO NOT over tighten (see Fig. 13).

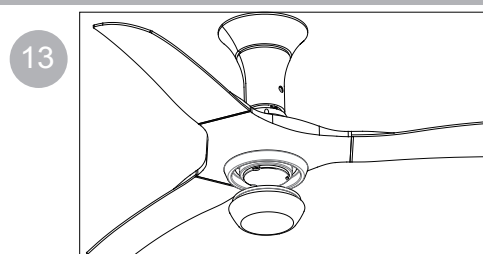



## OPERATION

Install the 9 V battery (included). To prevent damage to transmitter remove the battery if not used for long periods .

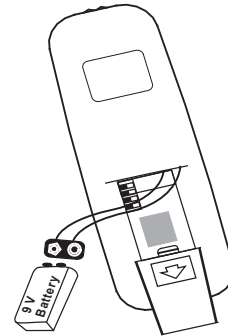

Turn fan on/off and select fan speed

- Restore power to ceiling fan and test for proper operation.
- The fan remote control controls the fan settings:

OFF: Turn off the ceiling fan.

HI: Turn on the fan at high speed.

MED: Turn on the fan at medium speed.

LOW: Turn on the fan at low speed.

LIGHT: ON/OFF: Press and release immediately to turn on or off the light.

DIMMER: Press and hold on to dim or brighten lights to the desired level and release (only for the tungsten bulb).

REVERSE ROTATION: Turn on the fan with reverse rotation

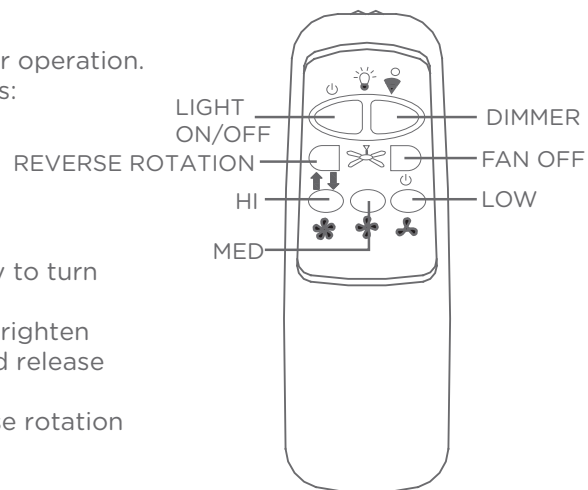

**Note:** Do not use the reverse switch when the fan blades are in motion.

### Forward function

- On this setting, the fan will turn counter-clockwise to create a cooling effect. Use this function during warmer weather to circulate the hot air away from your living space (see Fig. 14).

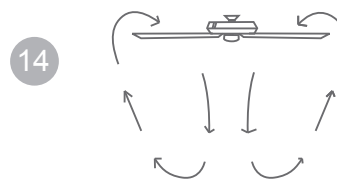

### Reverse function

- On this setting, the fan will turn clockwise. Use this function during cooler weather to re-circulate warm air (see Fig. 15).

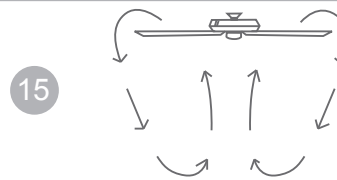

## MAINTENANCE

- Because of the fan's natural movement, some connections may become loose. Check the support connections, brackets and blade attachments twice a year. Make sure they are secure.
- There is no need to oil your fan. The motor has permanently-lubricated bearings.

## CARE AND CLEANING

- Dust your fan periodically with a soft, dry cloth. Do not use harsh cleaners or materials as they may damage the unit.
- To prevent bending the blades during cleaning, support the blades so that no pressure is applied to them.



### Caution!

Do not allow water to come in contact with fan blades or the ceiling fan. Doing so will create fire and /or shock hazards, damaging property.

## TROUBLESHOOTING

If problems persist, seek help from a certified electrician.

Problem	Possible reason	Solution
Fan is noisy during operation	<ul style="list-style-type: none"> <li>• Blade screws are loose.</li> <li>• The mounting bracket or canopy is loose.</li> <li>• Screws securing decorative housing to hanger are loose.</li> <li>• Lamp shades or bulbs are loose.</li> <li>• Screws securing downrod to hanger are loose.</li> <li>• Wire connectors are vibrating against the inside of canopy.</li> <li>• Light kit or light bulb is not firmly attached.</li> <li>• Canopy is rattling against ceiling.</li> <li>• Motor housing screws have come loose.</li> </ul>	<ul style="list-style-type: none"> <li>• Tighten screws on blades with a screwdriver.</li> <li>• Check and tighten the screws.</li> <li>• Check and tighten the screws.</li> <li>• Tighten by hand, as necessary.</li> <li>• Check and tighten screws.</li> <li>• Disconnect power at fuse box, loosen canopy and re-position connectors.</li> <li>• Remove and re-attach.</li> <li>• Be sure canopy is not touching ceiling.</li> <li>• Check and tighten the screws.</li> </ul>
Fan does not start	<ul style="list-style-type: none"> <li>• Fuse is blown, or circuit breaker has tripped.</li> <li>• Loose or in correct power line connections to the fan or switch wires.</li> </ul>	<ul style="list-style-type: none"> <li>• Check main fuse and branch circuit fuses or circuit breaker. Repair as necessary.</li> <li>• Check all the wire connections to fan and housing wiring. Repair as necessary.</li> </ul> <div>  <b>Caution!</b> Make sure the main power is turned off.         </div>

## TROUBLESHOOTING

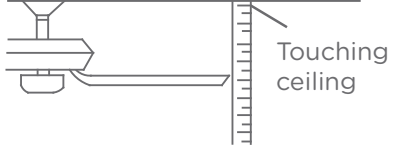
Problem	Possible reason	Solution
Light does not work	<ul style="list-style-type: none"> <li>Wires are not properly connected.</li> <li>Light bulbs are faulty.</li> <li>This fan is equipped with a 190 W LIMITER that will automatically turn the light off total wattage exceeds the maximum wattage level.</li> </ul>	<ul style="list-style-type: none"> <li>Ensure wire connector in switch housing is connected.</li> <li>Unscrew light bulbs and discard properly.</li> <li>Turn the power OFF and replace the bulbs with lower wattage bulbs so that the total wattage is below 190 W.</li> </ul>
Fan does not seem to move much air	<ul style="list-style-type: none"> <li>Fan is in reverse (blades are moving in clockwise direction).</li> <li>Fan is not properly located.</li> </ul>	<ul style="list-style-type: none"> <li>Counter-clockwise (forward) is recommended in warm weather. Turn off fan and power and wait for rotation to stop. Use the eraser end of a pencil to change the forward/reverse slide switch.</li> <li>Place fan in the centre of the room so there is at least 12" (30 cm) between the end of the blades and walls or other obstructions.</li> </ul>
Fan wobbles or shakes excessively	<ul style="list-style-type: none"> <li>Screws securing fan blade clips to motor are loose.</li> <li>Fan blade and its blade clip are not fastened securely.</li> <li>Canopy and mounting bracket are not tightened securely.</li> <li>Blades are unbalanced.</li> </ul> <div>  <p>13</p> <p>Touching ceiling</p> </div>	<ul style="list-style-type: none"> <li>Make sure that screws which attach fan blade clips to motor are fastened and tightened.</li> <li>Tighten screws of fan blade to blade clip securely.</li> <li>Ensure that canopy and mounting bracket are tightened securely to ceiling joist.</li> <li>Check by selecting a point on the ceiling above the tip of one of the blades. Measure this distance and ensure all blades are even (see Fig. 13). If all blade levels are not equal, adjust accordingly (see Balancing Kit Manual).</li> </ul>

## ENVIRONMENTAL PROTECTION



Discarded electrical appliances are recyclable and should not be discarded in your regular domestic waste! Please actively support us in conserving resources and protecting the environment by returning this appliance to a collection centre (if available).

Battery reclamation (please keep to comply with the local law).

## WARRANTY

This Noma product carries a limited ten (10) year warranty against defects in the motor, and a one (1) year warranty against defects in workmanship and materials. Noma Canada agrees to replace the defective product free of charge within the stated warranty period, when returned by the original purchaser with proof of purchase. This product is not guaranteed against wear or breakage due to misuse and/or abuse.

Subject to the conditions and limitations described below, this product, if returned to us with proof of purchase within the stated warranty period and if covered under this warranty, will be repaired or replaced (with the same model, or one of equal value or specification), at our option. We will bear the cost of any repair or replacement and any costs of labor relating thereto.

These warranties are subject to the following conditions and limitations:

- a) A bill of sale verifying the purchase and purchase date must be provided;
- b) This warranty will not apply to any product or part thereof which is worn or broken or which has become inoperative due to abuse, misuse, accidental damage, neglect or lack of proper installation, operation or maintenance (as outlined in the applicable owner's manual or operating instructions) or which is being used for industrial, professional, commercial or rental purposes;
- c) This warranty will not apply to normal wear and tear or to expendable parts or accessories that may be supplied with the product that are expected to become inoperative or unusable after a reasonable period of use;
- d) This warranty will not apply to routine maintenance and consumable items such as, but not limited to, fuel, lubricants, vacuum bags, blades, belts, sandpaper, bits, fluids, tune-ups or adjustments;
- e) This warranty will not apply where damage is caused by repairs made or attempted by others (i.e. persons not authorized by the manufacturer);
- f) This warranty will not apply to any product that was sold to the original purchaser as a reconditioned or refurbished product (unless otherwise specified in writing);
- g) This warranty will not apply to any product or part thereof if any part from another manufacturer is installed therein or any repairs or alterations have been made or attempted by unauthorized persons;
- h) This warranty will not apply to normal deterioration of the exterior finish, such as, but not limited to, scratches, dents, paint chips, or to any corrosion or discoloring by heat, abrasive and chemical cleaners; and
- i) This warranty will not apply to component parts sold by and identified as the product of another company, which shall be covered under the product manufacturer's warranty, if any.

### Additional Limitations

This warranty applies only to the original purchaser and may not be transferred. Neither the retailer nor the manufacturer shall be liable for any other expense, loss or damage, including, without limitation, any indirect, incidental, consequential or exemplary damages arising in connection with the sale, use or inability to use this product.

### Notice to Consumer

This warranty gives you specific legal rights, and you may have other rights, which may vary from province to province. The provisions contained in this warranty are not intended to limit, modify, take away from, disclaim or exclude any statutory warranties set forth in any applicable provincial or federal legislation

Made in China

Imported by  
Noma Canada, Toronto, Canada M4S 2B8