



## Magnetic Shock Absorbing PhoneHolder

X3

Please read this user guide before installing and using this product, and keep it for future use



## Product Features

---

- Hold your phone with one hand
- Universal adjustment, multi-angle adjustment
- Anti-theft buckle adjustment, safety guarantee
- The industry's first magnetic levitation buffer design, greatly reducing the chance of mobile phone vibration damage
- 15W Qi standard wireless fast charging
- 10W USB wired charging interface
- IP68 level dustproof and waterproof, no fear of wind, rain, sand and dust
- Applicable to various car models
- CNC aluminum alloy panel, stable and durable

Note:mobile phone bracket, magnetic levitation barrel punch design, appearance design structure are protected by national patents. Very low standby current with negligible zero current indicator (theoretical standby time of 12V/10AH battery is 50 years). The mobile phone shock absorber is designed to filter high-frequency and high-intensity strong shocks. The main function is to protect the mobile phone, and it cannot completely isolate the shock.

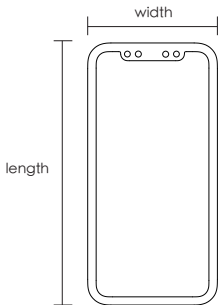

Compatible with a wide range:  
4.8-7 inch mobile phones

Length range (including mobile phone case): 115-172mm

Width range (including mobile phone case): 62-79mm

Thickness range (including mobile phone case): <12.5mm

Note: The above size is the limit size range. It is recommended to use a mobile phone protective case to increase the locking friction. Please refer to the size with the protective case.

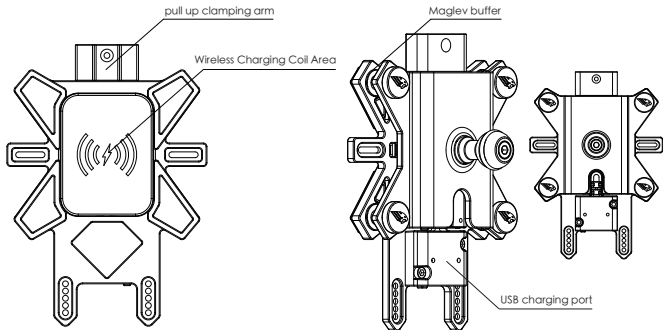

Note: The wireless charging and receiving module of the mobile phone must be aligned with the wireless charging coil area of the mobile phone bracket to charge

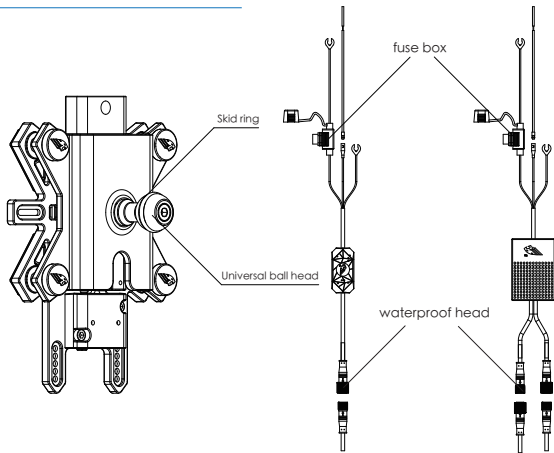

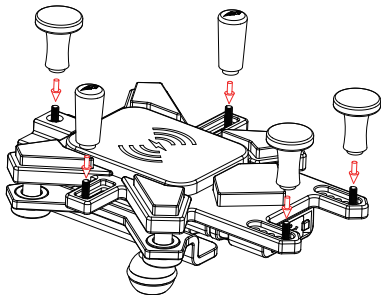

\* Install the screws, mushroom heads and posts on the mobile phone holder

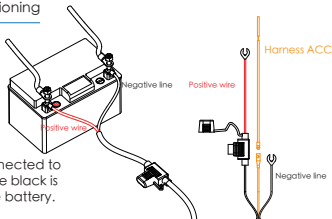

The red of the power connector is connected to the positive pole of the battery, and the black is connected to the negative pole of the battery.

Place it under the power connection terminal of the original car, and use the original car torque to lock it.

\* Note: There is also a yellow ACC line in the mobile phone holder harness, which can be connected to the positive pole of the battery, or to the positive pole of the lock head.

Tail light positive wire, etc. The input voltage is between 12V-24V

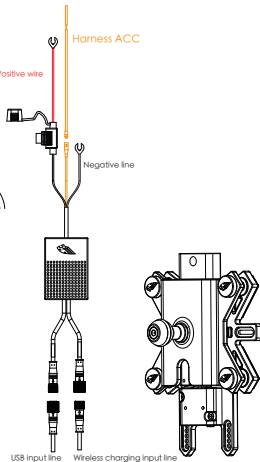

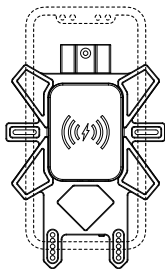

Wireless charging

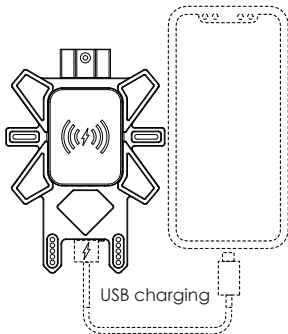

USB charging

Use a mobile phone with wireless charging function to test the wireless charging function, and use a USB charging cable to test wired charging



1 The waterproof level of the mobile phone bracket is IP68, including the USB interface, even if the USB interface is not set in the dustproof cover, it is also waterproof.

Putting in the dust cover can prevent the USB interface from accumulating dust and prolong the service life

2 For daily car washing operations, do not use corrosive cleaning agents to scrub the product (may cause damage to the waterproof structure), try to avoid direct washing with high-pressure water guns, if necessary, keep a washing distance of more than 1 meter

3 Try to avoid using wired charging when it is raining to avoid corrosion of the charging interface

4 Please use a plastic phone case together to increase locking friction

product name	Magnetic Shock Absorbing PhoneHolder
model	X3
Dimensions	162*125*170mm
weight	165g
Input voltage	DC12V
Input Current	2.5A Max
stand-by current	<20uA
Wireless Charging Power	15W Max
Wireless Charging Protocol	Qi 15W/Apple 7.5W
USB charging power	10W Max
charging interface	USB-A
USB charging protocol	PD3.0/QC3.0/SCP/FCP/VOOC/Apple
Fuse Specifications	3A Mini Fuse
IP rating	IP68

Symptoms	Reason Analysis	Symptoms
Power does not work	The positive and negative poles of the power supply are reversed, the yellow wire ACC of the wiring harness is not connected, Low battery voltage	Check the power connection, connect the yellow wire ACC to the positive pole of the power supply Or the original car ACC or the positive pole of the original car lock, Battery voltage needs DC12v
Wireless charging doesn't work	Charging module misaligned / damage to wiring harness components	Move the phone up and down to adjust the charging position If it still can't charge, replace the wiring harness
Excluding the above problems still cannot support the work	circuit damage	Contact us for factory repair

This equipment generates uses and can radiate radio frequency energy and, if not installed and used in accordance with the instructions, may cause harmful interference to radio communications.

However, there is no guarantee that interference will not occur in a particular installation.

If this equipment does cause harmful interference to radio or television reception, which can be determined by turning the equipment off and on, the user is encouraged to try to correct the interference by one or more of the following measures:

- Reorient or relocate the receiving antenna.
- Increase the separation between the equipment and receiver.
- Connect the equipment into an outlet on a circuit different from that to which the receiver is connected.
- Consult the dealer or an experienced radio/TV technician for help.

The device has been evaluated to meet general RF exposure requirement.