



1MORE, HEAR MORE!

1MORE One-Year Warranty: 1MORE Inc., ("1MORE") warrants to the original retail purchaser that this product is to be free from defective materials and workmanship for a period of one year from the date of purchase if it is properly used and maintained.

All emails are answered within 24 hours. Please provide the product you have questions or comments about.

North America Email: support@1moreusa.com

European Countries Email: euservice@1more.com

Asian Pacific Countries Email: globalservice@1more.com

Website: www.1more.com

First Time Setup

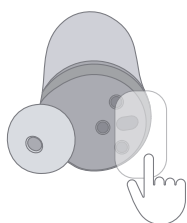

a. Take earbuds out of the charging case and remove stickers and put the earbuds back to the charging case.

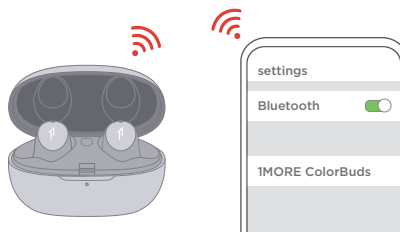

b. The LED indicator of right earbud will flash blue and red alternately, which will indicate ready to pair to your device.

c. Find "1MORE ColorBuds" in the Bluetooth connections of your device and tap on the name to connect.

Adding New / Additional Bluetooth Devices

Turn OFF Bluetooth from any previously connected device. Turn on Bluetooth from new device. Earbuds will automatically enter Bluetooth Pairing. Select "1MORE ColorBuds" in new device settings to connect.

Troubleshooting---Disconnected/No Sound(Manual Reset)

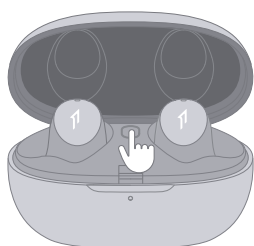

If the left earbud failed to connect with the right earbud

- Place both earbuds back into the charging case.
- Press the button in the middle of the charging case for three times quickly and contentiously to reset the pairing process.

If the earbuds failed to connect with your device

- Go to the Bluetooth settings on your device and forget the 1MORE ColorBuds.
- Place both earbuds into the charging case, press and hold the button in the middle of the charging case for 8 seconds to clear pairing history.
- Reconnect the earbuds with your device.

Fitting

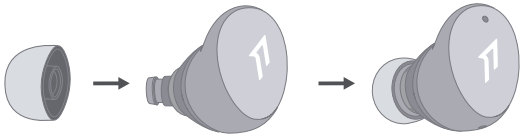

Try all ear tips and find the best fit and proper seal for your ear canals.

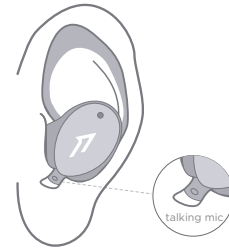

To perfect your wearing and phone call experience, please twist the earbud towards your mouth, and leave the talking mic uncovered.

Touch controls

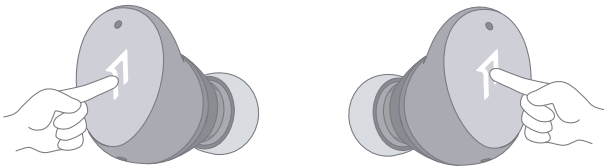

Playback

Play/Pause: Double-tap

Phone Call

Answer/End call: Double-tap

Voice control on cellphone

Tap 3 times when Bluetooth on and no phone calls

Smart Playback

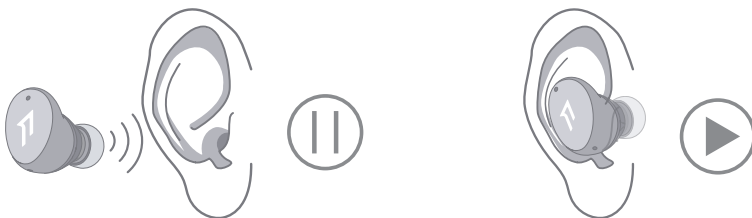

An IR Sensor automatically detects when you take out your headphones to stop playback intuitively and resumes playback when you put them back in.

Power On/Off and Charging

Power On/Off

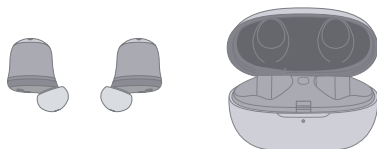

Power On

Take the headphones out of the charging case (with charge), the headphones will turn on automatically.

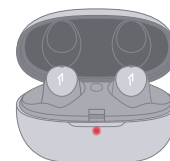

Power Off

Put the headphones back into the correct slot of the charging case and close the lid, they will automatically turn off and start charging.

Charging

Case Charging

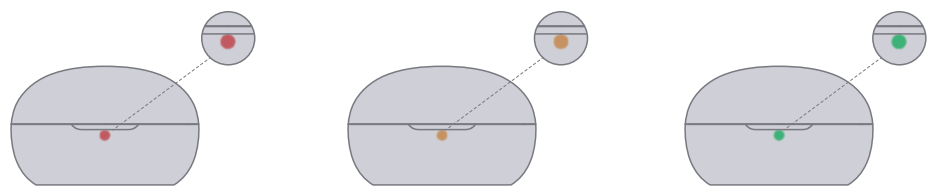

- a. Use the original cable in the package and connect the 1MORE ColorBuds to computer or USB 5V 1A output device. Full charge will take around 85 mins.
- b. The LED light of charging case will indicate different battery status: red light indicates low battery, orange light indicates medium battery and green light indicates full battery.

Earbuds Charging



Put headphones in correct slot until it locks in via magnetic slot. Red light of headphones will indicate headphones are charging.



Full charge will take around 70 mins. Red light of headphones turning off indicates charging is complete.

DOWNLOAD THE APP



Customize 1MORE ColorBuds features and update the latest software.

Download the 1MORE Music APP in Apple/Google Play Store.