

# Instruction Manual

# G7



idw

Instruction Manual



## FOR YOUR FUTURE REFERENCE

- Thank you for using our product. This manual will guide you in getting the best use of your cooler.
- Remember to record the model and serial number located on the back of the cooler.
- Staple your receipt to your manual. **You will need it to obtain Warranty Service.**

Model #: \_\_\_\_\_

Serial #: \_\_\_\_\_

Date of Purchase: \_\_\_\_\_

## TABLE OF CONTENTS

Parts and Identification.....	2
Safety Instructions.....	3
Installation.....	4
Electrical Requirements.....	4
Light Control.....	6
Light Replacement.....	7
Start.....	8
Maintenance .....	8
Cleaning.....	10
Troubleshooting .....	10
Warranty.....	11

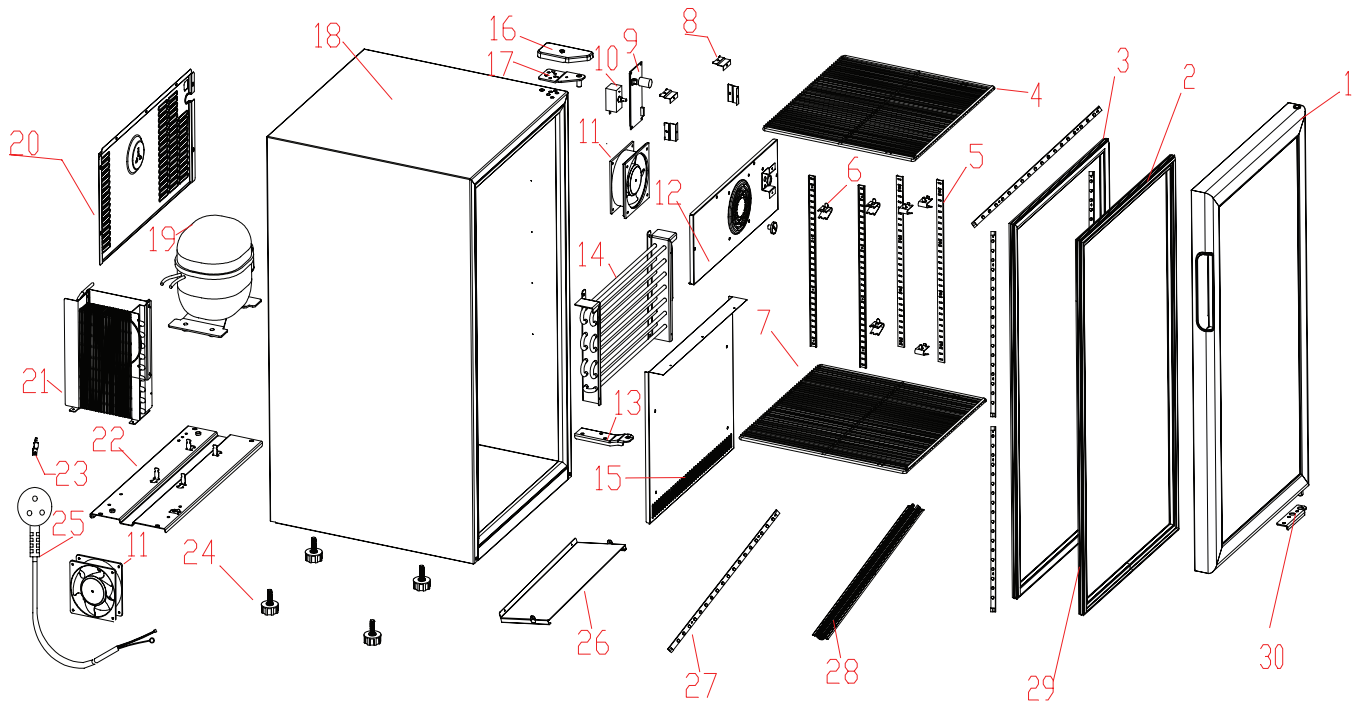

## PARTS (Model SC-148/G-7)

- |  |   |
|--|---|
| 1. Glass Door                            | 16. Top hinge cover                           |
| 2. Horizontal light cover for glass door | 17. Upper hinge                               |
| 3. Glass door seal gasket                | 18. Cabinet                                   |
| 4. Upper Flat shelf                      | 19. Compressor                                |
| 5. Shelf strip (short/long) (2/2)        | 20. Compartment grill                         |
| 6. Shelf clip (6)                        | 21. Condenser                                 |
| 7. Lower Flat shelf                      | 22. Compressor base                           |
| 8. Evaporator baffle brace (2)           | 23. Wire clip                                 |
| 9. Switch power board                    | 24. Adjustable leg (4)                        |
| 10. Thermostat                           | 25. Power cord                                |
| 11. Evaporator fan                       | 26. Supporting board                          |
| 12. Fan baffle                           | 27. LED board (6)                             |
| 13. Bottom hinge                         | 28. Cabinet light cover                       |
| 14. Evaporator                           | 29. Horizontal light cover for glass door (2) |
| 15. Evaporator baffle                    | 30. Door stop (bottom)                        |

## SAFETY INSTRUCTIONS

When using this appliance, always follow the basic safety precautions:

1. Read the entire User's Manual before operating this appliance.
2. Use this appliance only for its intended purpose as described in this User's Manual.
3. This cooler must be properly installed in accordance with the installation instructions before being used. See grounding instructions on page 4.
4. IDW requires that a dedicated circuit be used for the unit. Failure to do so voids warranty.
5. Never unplug your cooler by pulling on the power cord. Always grasp the plug firmly and pull it straight out from the outlet.
6. Unplug your cooler before cleaning or making any repairs. *Note: If for any reason this product requires service, we strongly recommend that a certified technician perform the service.*
7. Immediately repair or replace all electrical cords that have become frayed or otherwise damaged. Do not use a cord that shows cracks or abrasion damage along its length, the plug or the connector end.
8. This cooler should not be recessed or built into an enclosed cabinet. It is designed for freestanding installation only.
9. Do not operate or store your cooler near or around explosive fumes, gasoline or other flammable vapors and liquids.
10. Do not use flammable liquids to clean unit.
11. Setting the temperature control to the 0 position does not remove power to the light circuit, perimeter heaters, or evaporator fans.

**Please save these instructions!**  
**DANGER!**  
**Proper Disposal of the Refrigerator**

### PRE-CAUTION, NON-OPERATING COOLERS SHOULD HAVE:

1. Door removed.
2. Shelves kept in place in order to prevent any small child from climbing inside cooler.

**FOR PROPER DISPOSAL OF COOLER:** Distributors / retailers need to contact a qualified service technician:

1. To recover all Freon/refrigerant from the cooler
2. To remove the compressor or remove the oil from the compressor

Then the distributor/ retailer can contact their local metal recycling center to pick up the remaining cabinet, shelves, etc. By law, disposal of hazardous wastes may be subject to fines and imprisonment under the provisions of the environmental regulations. For more information please visit: <http://www.epa.gov/osw/hazard/index.htm>

## INSTALLATION

### Ambient Environment

- Place cooler on an even surface to reduce vibration and noise.
- To transport, do not tilt the cooler beyond a 45 degree angle.
- Do not place cooler in direct sunlight or near any heat sources.
- Do not place cooler in environment temperatures that exceed 109°F.
- Do not place cooler in below normal temperatures.
- Do not place cooler in extreme humid environments, this may cause components to rust.
- Do not place cooler near constant running or splattering water, this may cause immediate damage to refrigeration system.
- Must allow at least 2" between rear of cooler and wall for proper ventilation and heat dissipation of cooler.
- Do not place furniture or other articles with sharp edges near the cooler in order to prevent damage to the glass door.

## PREPARATION PRIOR TO OPERATION

### Unpackaging

- Remove all packaging materials before using cooler.  
This includes: foam pedestal, adhesive tape (used to fix accessories) and protective gaskets.
- Inspect cooler for concealed damage. Immediately file a claim with the freight carrier if there is damage. IDW is not responsible for damage incurred during shipping.
- Cooler must remain unplugged in an upright position for 1 hour prior to use.
- Clean the interior surface with a soft cloth and lukewarm water before operation.
- Ensure that drain hose or hoses are positioned in the pan.
- Remove plug and cord from inside the lower rear of the cooler.

### Electrical Requirements

- This model operates with a 110V/60Hz power supply. Check the electrical outlet for proper voltage.
- Dedicate one outlet for the use of the cooler.
- Do not use an extension cord or any other multiple connectors as this can lead to compressor failure.
- If the cord is damaged, it must be replaced.
- For your safety, plug the unit into a grounded wall outlet. Please check with a certified electrician for details.

**WARNING:** Do not use extension cords.

**WARNING:** Compressor warranties are void if compressor burns out due to low voltage.

**WARNING:** Power supply cord should not be removed!

## Leveling/Location

- Place unit in a well-ventilated area.  
**WARNING:** Warranty is void if ventilation is insufficient.
- For proper operation, place the cooler on a dry, level surface
- Unit must be leveled for proper operation, this will help prevent condensation.
- The cooler should be leveled front to back and side to side with a leveler.



## Shelving Installation

- Hook shelf clips on shelf strip



- Position all shelf clips equal in distance from the floor to flat shelves



- Place shelf on shelf clips

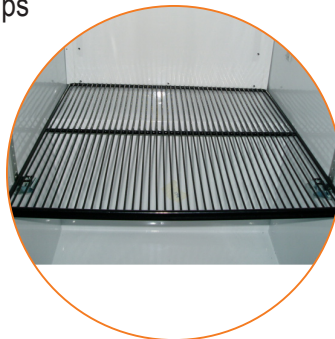



## Removal of Light Canopy and Instruction

- The top-placed independent light canopy is removable in the G-7 cooler.

1 Unplug the cooler, then unscrew (6) Screws using a Phillip's screwdriver.

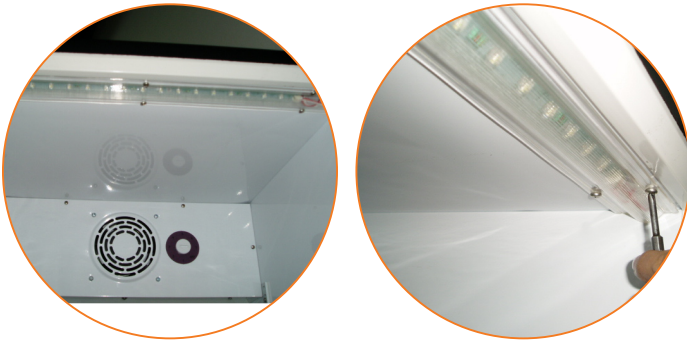

2 Pull the LED light strip out of its protective cover.



3 Disconnect the LED light strip at the Quick Disconnect.



4 Replace the old LED light strip with a new light strip.

5 To install LED lights follow the above directions in reverse order.





## Lamp Decoration, Illumination and Switches

- There are LED lights inside the top of the cabinets and in the door. G7 coolers have top canopy lights and inner side lights.

### Replacement of LED Lights in the Door

- 1 Unplug the cooler.
- 2 Remove plastic cover. Gently wedge a flat-head screwdriver under the cover to help loosen the cover.



- 3 Unscrew light strand



- 4 Disconnect light strand at the Quick Disconnect.



- 5 Remove entire light strand.
- 6 To install LED lights follow the above directions in reverse order.

**Notes:** If there are any malfunctions with the main control panel of LED lights, please contact a professional for replacement.

## Startup, Operation and Temperature Adjustment

### Operation

- Prior to stocking cooler with product, it should be operated empty for a half an hour.

### Temperature Adjustment

- It is recommended that the thermostat is set position 3 for the most efficient performance.



## REPAIR AND MAINTENANCE FOR REFRIGERATION COMPONENTS

**\* A CERTIFIED TECHNICIAN IS REQUIRED TO REPAIR ALL REFRIGERATION COMPONENTS FOR WARRANTY PURPOSES.**

- For convenient repair, the refrigeration components (compressor, evaporator, condenser, evaporation fan, condensation fan and filter) are designed using a split system; any component can be easily replaced. Replacement procedure is as follows:



- 1 Unplug the unit.
- 2 Remove the (7) screws from the grill and then remove the grill.



- 3 Unplug all connections and terminals that are in need of repair.



- 4 Using a screwdriver, remove screws from component.
- 5 After repair, re-install all parts using the reverse procedure.

## Condenser Maintenance

- It is essential to keep the condenser coils clean and free of dust and debris at all times.
- It is required to periodically clean the condenser coils with a soft bristle brush or vacuum-cleaner to properly maintain the refrigeration system.
- Failure to clean the condenser at regular intervals may cause failure of the refrigeration system could void the warranty.



- 1 Unplug the unit. Using a small Phillips head screwdriver, remove the (7) screws from the grill as shown.



- 2 The grill can now be removed.



- 3 Using plastic bristle brush, carefully clean the coil being aware that coils can bend or be damaged if too much force is used shown below.



- 4 Replace grill and utilize the Phillips screwdriver to tighten the screws into place.

## MAINTENANCE

### Cleaning Shutdown Questions and Answers

#### Cleaning

- Unplug the cooler before cleaning.
- Use a soft cloth or sponge with water or soap (non-corrosive mild detergent), while cleaning. After cleaning, wipe the cooler using dry cloth to keep the cooler from rusting.
- Do not spray water on the cooler, and do not use hard or steel brushes to clean the cooler.
- Clean the inside cabinet of the cooler with a clean, damp cloth or with mild soap.
- Do not use organic solvents, boiling water, washing powder or acid while cleaning.

**If cooler's power will be off for a long period of time, unplug it, clean as instructed above, and keep door open until dry.**

#### Troubleshooting

The following are not Malfunctions:

Issues	Solutions
Liquid flowing noise within cooler	This liquid is the sound of the cooling agent flowing through the pipes.
Refrigeration system is shutdown for longer periods of time while temperature inside is still very low.	This refrigerator has a strong level of heat preservation and can maintain a relatively ambient temperature.
Condensation on glass door	This may be due to a high indoor humidity or a low inside temperature value may be set. Wipe the door dry with a towel.

- 1 This refrigerator has been designed and manufactured according to National standards.
- 2 If there are any questions during use, refer to this operation manual to help troubleshoot problems.
- 3 When disposing of the cooler, please remove the door and lock to avoid children accidentally becoming trapped inside the cooler.

#### After Sales Service

Any product has the possibility of malfunction. Please observe the cooler's operation and any changes to product being stored. If there are any abnormal cases, refer to the following table. If there is still no change after following the instructions, please inform our service center in a timely manner to avoid a further loss of the unit.

Issues	Solutions
Cooler is not functioning.	Please check power supply: <ul style="list-style-type: none"> <li>• Fuse damage</li> <li>• The plug is not securely inserted into the wall socket</li> <li>• Check for low voltage</li> </ul>
Cooler is not keeping product cool.	<ul style="list-style-type: none"> <li>• Provide ample space between all products to ensure proper circulation of air.</li> <li>• Keep unit away from direct sunlight or other heating source.</li> <li>• Keep door closed as often as possible.</li> </ul>
Excessive noise	<ul style="list-style-type: none"> <li>• Be certain the cooler is placed on a level surface.</li> <li>• Be certain cooler is not touching external objects or walls.</li> </ul>

## WARRANTY INFORMATION (U.S.A. & CANADA ONLY!)

### One Year Parts & Labor Warranty

IDW warrants to the original purchaser of every new IDW refrigerated unit, the cabinet and all parts thereof, to be free from defects in material or workmanship, under normal and proper use and maintenance service as specified by IDW and upon proper installation and start-up in accordance with the instruction packet supplied with each IDW unit. IDW's obligation under this warranty is limited to a period of one (1) year from the date of original installation or 15 months after shipment date from IDW, whichever occurs first.

Any part covered under this warranty that are determined by IDW to have been defective within one (1) year of original installation or fifteen (15) months after shipment date from manufacturer, whichever occurs first, is limited to the repair or replacement, including labor charges, of defective parts or assemblies. The labor warranty shall include standard straight time labor charges only and reasonable travel time, as determined by IDW.

### Additional Four Year Compressor Warranty

In addition to the one (1) year warranty stated above, IDW warrants its hermetically and semi-hermetically sealed compressor to be free from defects in both material and workmanship under normal and proper use and maintenance service for a period of four (4) additional years from the date of original installation but not to exceed five (5) years and three (3) months after shipment from the manufacturer.

Compressors determined by IDW to have been defective within this extended time period will, at IDW's option, be either repaired or replaced with a compressor or compressor parts of similar design and capacity. The four (4) year extended compressor warranty applies only to hermetically and semi-hermetically sealed parts of the compressor and does not apply to any other parts or components, including, but not limited to, cabinet, paint finish, temperature control, refrigerant, metering device, driers, motor starting equipment, fan assembly or any other electrical component, etcetera.



### 134A Compressor Warranty

The four year compressor warranty detailed above will be voided if the following procedure is not carefully adhered to:

- 1 This system contains R134A refrigerant and polyol ester lubricant. The polyol ester lubricant has rapid moisture absorbing qualities. If long exposure to the ambient conditions occur, the lubricant must be removed and replaced with new. For oil amounts and specifications please call IDW technical service department (909-447-8254). Failure to comply with recommended lubricant specification will void the compressor warranty.
- 2 Drier replacement is very important and must be changed when a system is opened for servicing. A drier using XH-7 desiccant or an exact replacement solid core drier must be used. The new drier must also be the same capacity as the drier being replaced.
- 3 Micron level vacuums must be achieved to insure low moisture levels in the system. 500 microns or lower must be obtained.

### Warranty Claims

All claims for labor or parts must be made directly through IDW. All claims should include: model number of the unit, the serial number of the cabinet, proof of purchase, date of installation, and all pertinent information supporting the existence of the alleged defect.

In case of warranty compressor, the compressor model tag must be returned to IDW along with above listed information. Any action or breach of these warranty provisions must be commenced within one (1) year after that cause of action has occurred.

### What Is Not Covered By This Warranty

IDW's sole obligation under this warranty is limited to either repair or replacement of parts, subject to the additional limitations below. This warranty neither assumes nor authorizes any person to assume obligations other than those expressly covered by this warranty.

**NO CONSEQUENTIAL DAMAGES.** IDW IS NOT RESPONSIBLE FOR ECONOMIC LOSS; PROFIT LOSS; OR SPECIAL, INDIRECT, OR CONSEQUENTIAL DAMAGES, INCLUDING WITHOUT LIMITATION, LOSSES OR DAMAGES ARISING FROM FOOD OR PRODUCT SPOILAGE CLAIMS WHETHER OR NOT ON ACCOUNT OF REFRIGERATION FAILURE.

**WARRANTY IS NOT TRANSFERABLE.** This warranty is not assignable and applies only in favor of the original purchaser/user to whom delivered. ANY SUCH ASSIGNMENT OR TRANSFER SHALL VOID THE WARRANTIES HEREIN MADE AND SHALL VOID ALL WARRANTIES, EXPRESS OR IMPLIED, INCLUDING ANY WARRANTY OF MERCHANTABILITY OR FITNESS FOR A PARTICULAR PURPOSE.

**IMPROPER USAGE.** IDW ASSUMES NO LIABILITY FOR PARTS OR LABOR COVERAGE FROM COMPONENT FAILURE OR OTHER DAMAGES RESULTING FROM IMPROPER USAGE OR INSTALLATION OR FAILURE TO CLEAN AND/OR MAINTAIN PRODUCT AS SET FORTH IN THE WARRANTY PACKET PROVIDED WITH THE UNIT.

**ALTERATION, NEGLECT, ABUSE, MISUSE, ACCIDENT, DAMAGE DURING TRANSIT OR INSTALLATION, FIRE, FLOOD, ACTS OF GOD.** IDW is not responsible for the repair or replacement of any parts that IDW determines have been subjected after the date of manufacture to alteration, neglect, abuse, misuse, accident, damage during transit or installation, fire, flood, or act of God.

**IMPROPER ELECTRICAL CONNECTIONS.** IDW IS NOT RESPONSIBLE FOR THE REPAIR OR REPLACEMENT OF FAILED OR DAMAGED COMPONENTS RESULTING FROM ELECTRICAL POWER FAILURE, THE USE OF EXTENSION CORDS, LOW VOLTAGE, OR VOLTAGE DROPS TO THE UNIT.

**NO IMPLIED WARRANTY OF MERCHANTABILITY OR FITNESS FOR A PARTICULAR PURPOSE:** THERE ARE NO OTHER WARRANTIES, EXPRESSED, IMPLIED OR STATUTORY, EXCEPT THE ONE (1) YEAR PARTS & LABOR WARRANTY AND THE ADDITIONAL FOUR (4) YEAR COMPRESSOR WARRANTY AS DESCRIBED ABOVE. THESE WARRANTIES ARE EXCLUSIVE AND IN LIEU OF ALL OTHER WARRANTIES, INCLUDING IMPLIED WARRANTY AND MERCHANTABILITY OR FITNESS FOR A PARTICULAR PURPOSE. THERE ARE NO WARRANTIES WHICH EXTEND BEYOND THE DESCRIPTION ON THE FACE HEREOF.

**OUTSIDE U.S.:** This warranty does not apply to, and IDW is not responsible for, any warranty claims made on products sold or used outside the United States.

**REMOTE CONDENSERS:** IDW warrants the original purchaser of the remote cabinet one year parts and labor coverage for all cabinet parts thereof to be free from defects in material or workmanship, under normal and proper use and maintenance service, as specified by IDW. This warranty is limited to the cabinet only. IDW assumes no liability for remote condensing units.





*Innovative DisplayWorks, Inc.*  
990 N. Amelia Avenue, San Dimas, CA 91773  
toll free: 877.307.2665  
office: 909.447.8254  
fax: 909.305.8756  
[www.idw-usa.com](http://www.idw-usa.com)

---