

# Greenspace Flex

## RS378B P42 927 PSU-E NB M102

927 warm white - Electronic transformer - Grey

GreenSpace Flex is a performance portfolio dedicated to the hospitality segment for GC/GM countries. With a modular design concept, the light engines and different trims have multiple combinations to satisfy diversified customer requirements.

### Product data

General Information	
Lamp colour code	927 warm white
Number of gear units	1 unit
Driver/power unit/transformer	ET [ Electronic transformer]
Driver included	Yes
Optical cover/lens type	Lens
Luminaire light beam spread	18°
Control interface	-
Connection	CE [ External connector]
Cable	-
Protection class IEC	Safety class II (II)
Glow-wire test	60030 [ Temperature 600 °C, duration 30 s]
CE mark	CE mark
Warranty period	3 years
Constant light output	No
Number of products on MCB (16 A type B)	40
EU RoHS compliant	Yes
Light source engine type	LED

### Operating and Electrical

Input Voltage	220 to 240 V
---------------	--------------

Input frequency	50 to 60 Hz
Average CLO power consumption	2815 W
Power factor (min.)	0.9

### Controls and Dimming

Dimmable	No
----------	----

### Mechanical and Housing

Housing material	Aluminium
Optic material	Polymethyl methacrylate
Optical cover/lens material	Acrylate
Fixation material	Aluminium
Optical cover/lens finish	Textured
Overall length	0 mm
Overall width	0 mm
Overall height	116 mm
Overall diameter	102 mm
Colour	Grey

### Approval and Application

Ingress protection code	IP20 [ Finger-protected]
-------------------------	--------------------------

Mech. impact protection code	IK04 [ 0.5 J standard plus]
<b>Initial Performance (IEC Compliant)</b>	
Initial luminous flux (system flux)	3990 lm
Luminous flux tolerance	+/-10%
Initial LED luminaire efficacy	95 lm/W
Lamp colour temperature	2700 K
Colour Rendering Index	>90
Initial chromaticity	SDCM<3
Initial input power	42 W
Power consumption tolerance	+/-10%
<b>Over Time Performance (IEC Compliant)</b>	
Median useful life L80B50	50000 h

<b>Application Conditions</b>	
Ambient temperature range	-20 to +45 °C
Maximum dimming level	Not applicable
Suitable for random switching	No
<b>Product Data</b>	
Full product code	911401721612
Order product name	RS378B P42 927 PSU-E NB M102
Order code	911401721612
SAP numerator – quantity per pack	1
Numerator – packs per outer box	12
SAP material	911401721612



Dimensional drawing

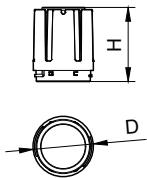

Modular Type	D, mm	H, mm
RS378B P6/P11 M55	55	49
RS378B P15 M55	55	49
RS378B P24 M70	70	90
RS378B P33 M87	87	107
RS378B P42 M102	102	116

RS378B P42 927 PSU-E NB M102

