



MONSTER CENTRAL®
CONTROL SYSTEMS

USER GUIDE

**Monster® Home Theater
Controller AV 100**

**Monster Home Theater
and Lighting Controller
AVL 300**

Monster Central® OmniLink™

A NOTE FROM THE HEAD MONSTER

Dear Enthusiast,

THANK YOU for purchasing your Monster Central® Control product. Monster Central Control opens up a whole new world where you command your home entertainment and environment—from operating audio/video components across your entire home, to accessing and distributing media libraries, to commanding lighting with the touch of a button, and more. User-friendly and future-ready, Monster Central Control products enhance your lifestyle at home today and tomorrow:



Monster® Home Theater Controller AV 100—Activity-Based Controller with easy, online setup lets you command home A/V components with the touch of a button.

Monster Home Theater and Lighting Controller AVL 300—Activity-Based Controller with easy, online setup lets you command all of your A/V components, even all the lights in your home, with a touch of a button.

Monster Central OmniLink™ (for AVL300 only)—included—RF-to-IR bridge and IR signal blaster/extender transmits Controller commands through cabinet doors, walls, ceilings and floors—even from different rooms.

Monster Central Wireless PC Link (for AVL300 only)—optional—
Enables your Controller 300 to control your PC from remote locations, and wirelessly transmits new component configurations, name changes, customized titles, music playlists, and even the latest firmware from your PC to your Controller.

IlluminEssence™ Lighting Systems—not included—To enhance your home environment. These easy-to-install lighting modules can be controlled using the same Monster Central Controller you use to command your home A/V from any room in the house. You can create lighting scenes like “entry” or “away” to control a series of lights with the touch of a button, or set the mood with lifestyle scenes like “dining” or “romance” that pair lighting with A/V activities. IlluminEssence Lighting consists of “easy to use” in wall dimmers, switches and plug in dimmer/switches that are enabled to work with the MCCA/VL for Lifestyle-based A/V and lighting control.

I know you’ll enjoy your new Monster Central Control product and find commanding your home entertainment and environment easier than ever. Welcome to the home of the future!

A stylized, handwritten signature in black ink, appearing to read 'Noel Lee'.

Noel Lee,
The Head Monster

Contents

English

Monster HomeTheater Controller AV 100 and AVL 300	1
Monster Central OmniLink	6

Audio/Video Remote Controller

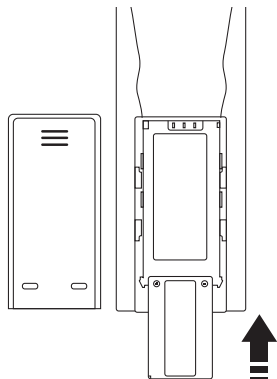

Step 1

Install battery in remote.

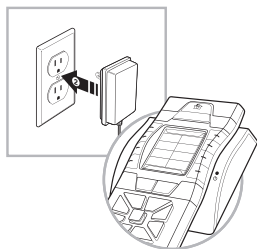

Step 2

Charge the Remote:

- 1.** Plug AC cable into back of base station.
- 2.** Plug AC adapter into outlet.
- 3.** Place remote in base station to charge internal battery.

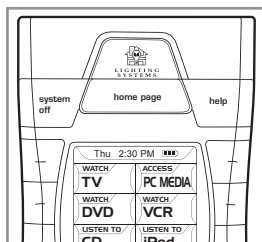

Step 3

Charge Mode-green bar will blink in sequence. When fully charged, battery meter will be fully green. When battery is low, battery meter will turn red.

Step 4

For AVL 300 only. If you have purchased a Monster Central HomeTheater and Lighting Controller, Wireless PC Link or additional OmniLinks, refer to the installation guide for each product. After you start the software, you will receive additional instructions for these products.

Step 5

Write down entertainment device information (see example).

Device Type	Manufacturer	Model Number	Connects to	Connection Name	Connection Type
DVD	Pioneer	DV-414	TV	Input 1	Component video/ stereo audio

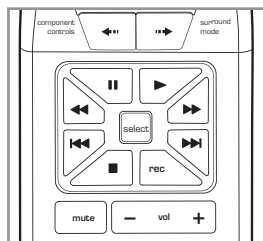

Step 6

Press “select” on the remote to view a tutorial on the display.

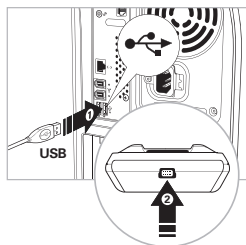

Step 7

Turn ON computer, and ensure that an Internet connection is active.

- 1.** Connect the USB cable to a USB port on the computer.
- 2.** Connect the other end of the cable to the remote.



Step 8

To begin setting up your Monster Central Remote, install the software and follow guided instructions

Macintosh

1. Insert software CD into CD-ROM drive. **2.** Double click CD-ROM icon on desktop to display CD contents. **3.** Double click Mac folder followed by Monster Central Remote Software.mpkg icon. **4.** After installation, the software starts and the Monster Central icon displays in the Dock. If not, use Finder to open the Applications folder. Double-click the Monster Central Remote application. **5.** Click Monster Central Remote from the menu bar, and then select Preferences. **6.** In the Preferences dialog, set Download Folder to match the downloads folder. **7.** For the Safari web browser (Safari > Preferences > General > Save downloaded files to), place a check mark next to Watch download folder and Cleanup downloaded folder. **8.** Please launch Web Browser and type in **<http://members.monstercentral.com>**.

Website

If the Monster Central remote software does not start after software installation, do the following: **1.** Click Start on the Windows® taskbar. **2.** Click All Programs. **3.** Click Monster Central Control, and then Monster Central Control Software.

After Installation

Using the Monster Central remote after competing installation:

- 1.** Press Activities for easy, one-touch control.
- 2.** Press Help for troubleshooting solutions.

Warnings

Warning! Read the battery warning in the Important Information document. Consult the Important Information document for tips on care and maintenance.

Warranty and FCC. Your product comes with a limited warranty, is UL tested, and is FCC compliant. For more information, refer to the Important Information document.

Monster Central Omnilink Wireless RF-to-IR Bridge and IR Blaster

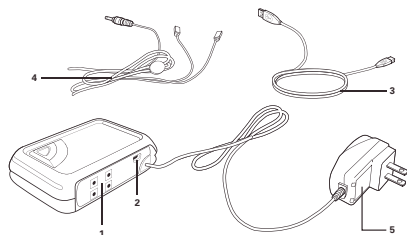

- 1.** Ports for Monster Central Control Link IR Extenders
- 2.** USB port
- 3.** USB cable
- 4.** Monster Central Control Link IR Extenders
- 5.** AC cable and adapter

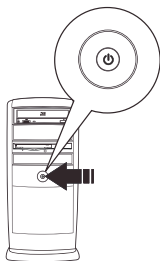

Step 1

Turn ON computer, and ensure that an Internet connection is active.

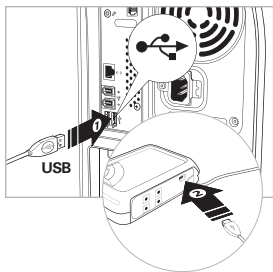

Step 2

1. Connect USB cable to a USB port on your computer.
2. Connect other end of USB cable to Omnilink.



Step 3

To start setup, install the software.



Step 4 Macintosh®

- 1.** Insert software CD into CD-ROM drive.
- 2.** Double click CD-ROM icon on desktop to display CD contents.
- 3.** Double click Mac folder followed by Monster Central Software.mpkg icon.
- 4.** After installation, the software starts and the Monster icon displays in the Dock. If not, use Finder to open the Applications folder. Double-click the Monster Central application.
- 5.** Click Monster Central from the menu bar, and then select Preferences.
- 6.** In the Preferences dialog, set Download Folder to match the downloads folder.
- 7.** For the Safari web browser (Safari > Preferences > General > Save downloaded files to), place a check mark next to Watch download folder and Cleanup downloaded folder.
- 8.** Please Launch Web Browser and type in **<http://members.monstercentral.com>**.

Step 5

If the Monster Central remote software does not start after software installation, do the following: **1.** Click Start on the Windows® taskbar. **2.** Click All Programs. **3.** Click Monster Central Control, and then Monster Central Control Software.

Step 6

Choose a place to mount the Omnilink (e.g., inside your A/V cabinet or on a wall near your A/V equipment).

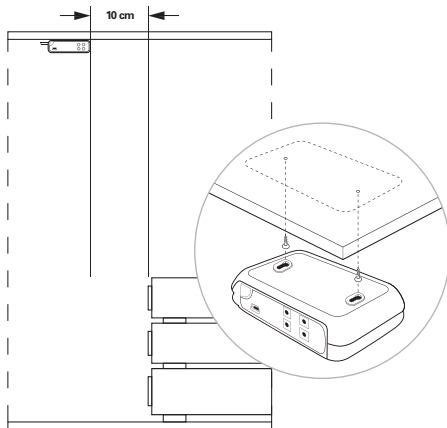

Step 7

For A/V cabinet installation, mount the Omnilink on underside of top shelf, facing down and toward A/V devices, with a minimum of 10 cm between Omnilink and your entertainment equipment.

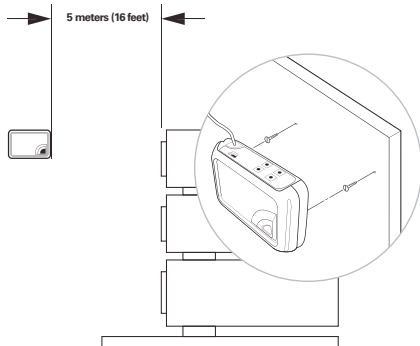

Step 8

For wall mounting, place the Omnilink no more than 5 meters from your A/V equipment.

Step 9

The four, dual-head Monster Control Link IR Extenders can control up to eight devices. (One extender controls two devices.) To use the extenders, do the following:

- 1.** Locate the area on the device where signals are received.
- 2.** Attach an extender directly to this area, or if you do not want to place the extender on the device, attach it to a surface above, below, or in front of this area on the device.
- 3.** Connect the other end of the IR extender cable to a port on the Omnilink.

Step 10

Plug AC adapter into an electrical outlet.

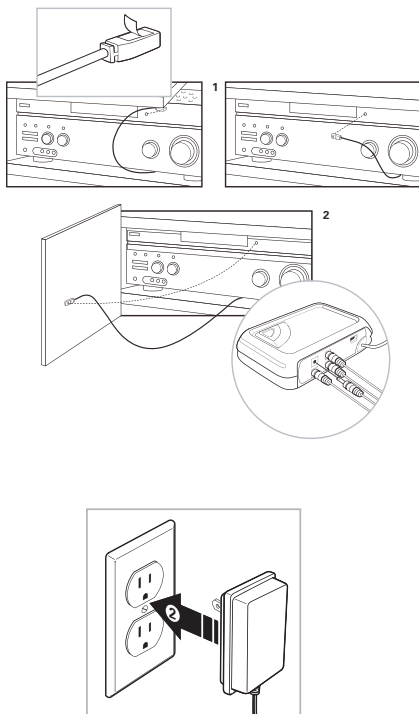

Warnings/Notices

Care and Maintenance. Do not open your device. There are no user-serviceable parts inside. Do not allow moisture to enter the unit. Moisture will corrode the inner electronics. To clean the unit, wipe gently with a dry cloth. Any changes or modifications not expressly approved by Monster, LLC., void the user's authority to operate the equipment and could void the warranty.

Power Supply Warning. The power supply for this product is for indoor use only. Use the power supply that comes with your product; do not use any other power supply. Do not use a damaged power supply or attempt to repair one that is damaged. Do not immerse the power supply in water or subject it to physical abuse. Inspect the power supply regularly for damage to its cable, plug, and body.

UL Testing. Your product is UL tested and must be used with other UL tested devices.

FCC Notice: This device complies with Part 15 of the FCC rules. Operation is subject to the following two conditions: (1) this device may not cause harmful interference, and (2) this device must accept any interference received, including interference that may cause undesired operation. Caution: changes or modifications not expressly approved by Monster Cable Products Inc. may void the users authority to operate this device.

Note: This equipment has been tested and found to comply with the limits for a class B digital device pursuant to Part 15 of the FCC rules. These limits are designed to provide reasonable protection against harmful interference in a residential installation. This equipment generates, uses, and can radiate radio frequency energy and, if not installed and used in accordance with the instructions, may cause harmful interference to radio communications. However, there is no guarantee that interference will not occur in a particular installation. If this equipment does cause harmful interference to radio or television reception, which can be determined by tuning the equipment off and on, the user is encouraged to try to correct the interference by one or more of the following measures:

- Reorient or relocate the receiving antenna
- Increase the separation between the equipment and receiver
- Connect the equipment into an outlet on a circuit different from that to which the receiver is connected
- Consult the dealer or an experienced radio/TV technician for help.

FCC ID : RJE160836-00

Canadian DOC Statement. This digital device does not exceed the Class B limits for radio noise emissions from digital apparatus specified in the interference-causing equipment standard entitled "Digital Apparatus," ICES-003 of the Department of Communications. This device complies with RSS-210 of Industry and Science Canada. Operation is subject to the following two conditions: 1) this device may not cause interference, and 2) this device must accept any interference, including interference that may cause undesired operation of the device.



www.MonsterCentral.com

© 2005 Monster, LLC
7251 West Lake Mead Blvd.
Las Vegas, NV 89128, USA
1-877-800-8989

Monster Central products are designed in the USA
and manufactured for Monster to its quality specifications.

Manufactured in China.

Monster, Monster Central, the Monster Central logo and the product design, Omnilink, Monster System Tracking Memory, IlluminEssence, ControlNet, are registered or unregistered trademarks of Monster Cable Products, Inc. or its subsidiaries in the US and other countries.

Microsoft and Windows are registered trademarks of Microsoft Corporation. Pentium is a registered trademark of Intel Corporation. Harmony is a registered trademark of Logitech, Inc. Macintosh is a registered trademark of Apple Computer, Inc. All other company and product names may be trademarks of their respective companies.

rm 162809