

PHILIPS

hue personal
wireless
lighting



Quick start guide

Guide de démarrage rapide

Guía de inicio rápido

1

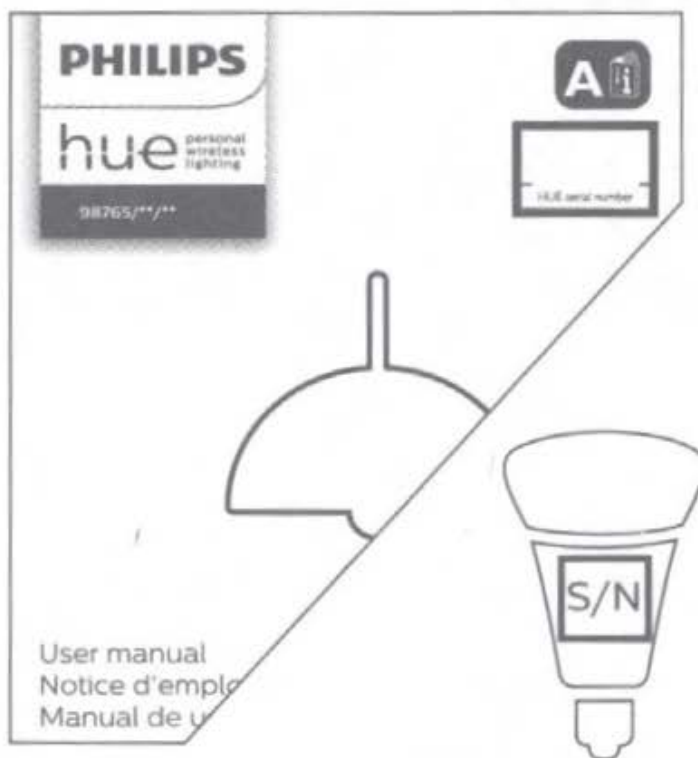

2

Philips Hue serial number



3

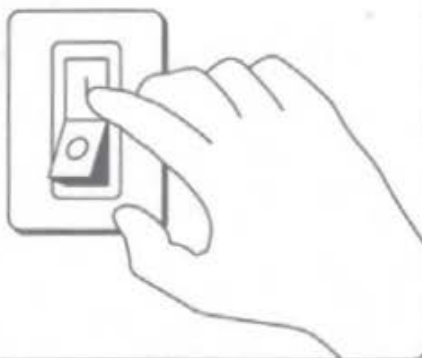

4



www.philips-hue.com/connectproduct



Signify North America Corporation
200 Franklin Square Drive
Somerset, NJ 08873, USA

Signify Canada Ltd./Signify Canada Ltée.
281 Hillmount Road,
Markham, ON, Canada L6C 2S3
Questions or Comments /
Questions ou commentaires:
1-800-555-0050

Importado y/o distribuido en México por:
Signify Mexico S.A. de C.V.
Av. La Palma N° 6-Col. San Fernando,
La Herradura Huixquilucan
Edo. De México, C.P. 52784 - R.F.C. PME-620620-E84
Centro de contacto:
01-800-508-9000

www.philips-hue.com

© 2021 Signify Holding
All rights reserved

3222 639 07751
Last update: 03/2021

PHILIPS

hue personal
wireless
lighting

Bridge



User manual
Notice d'emploi
Manual de usuario

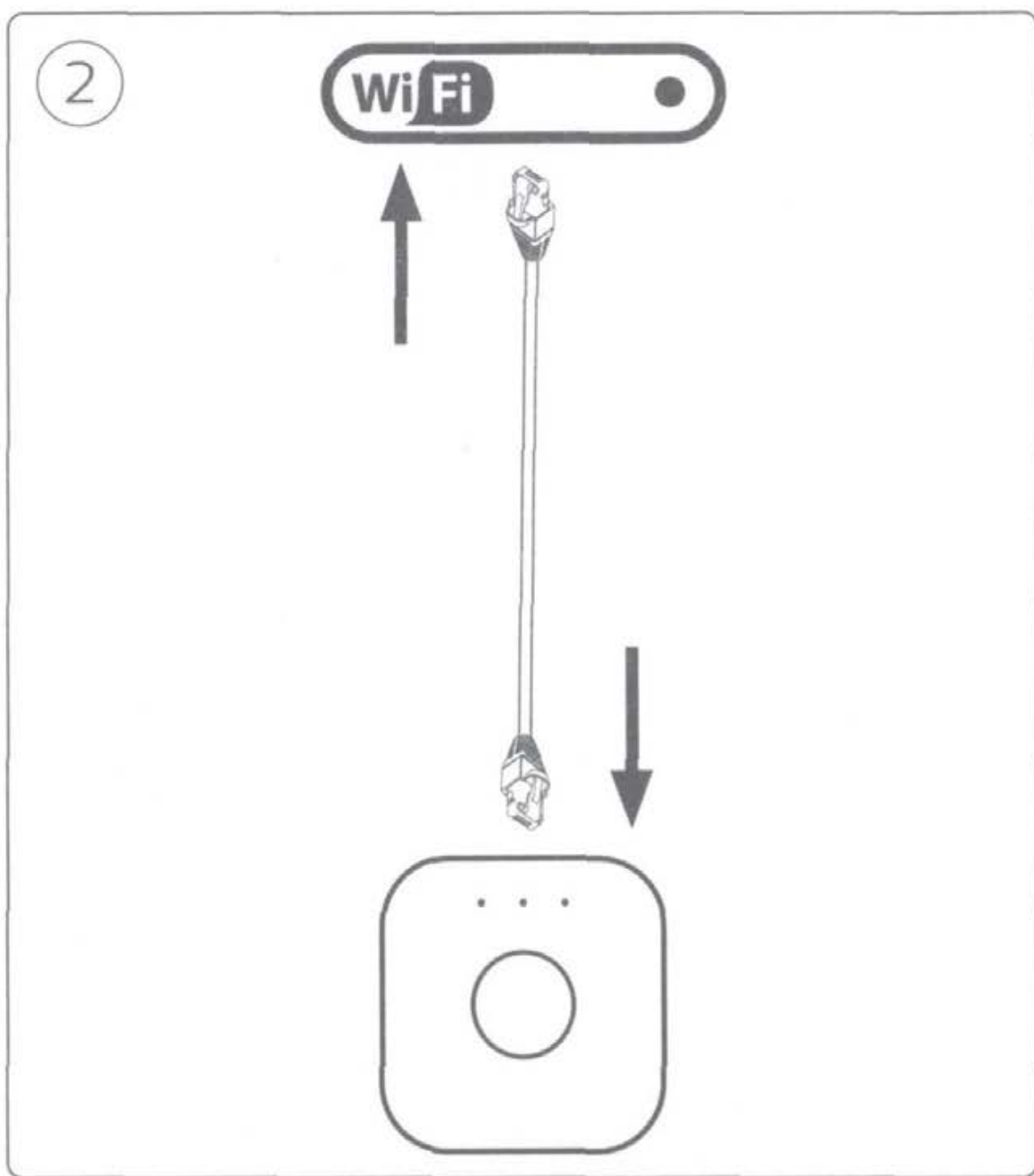
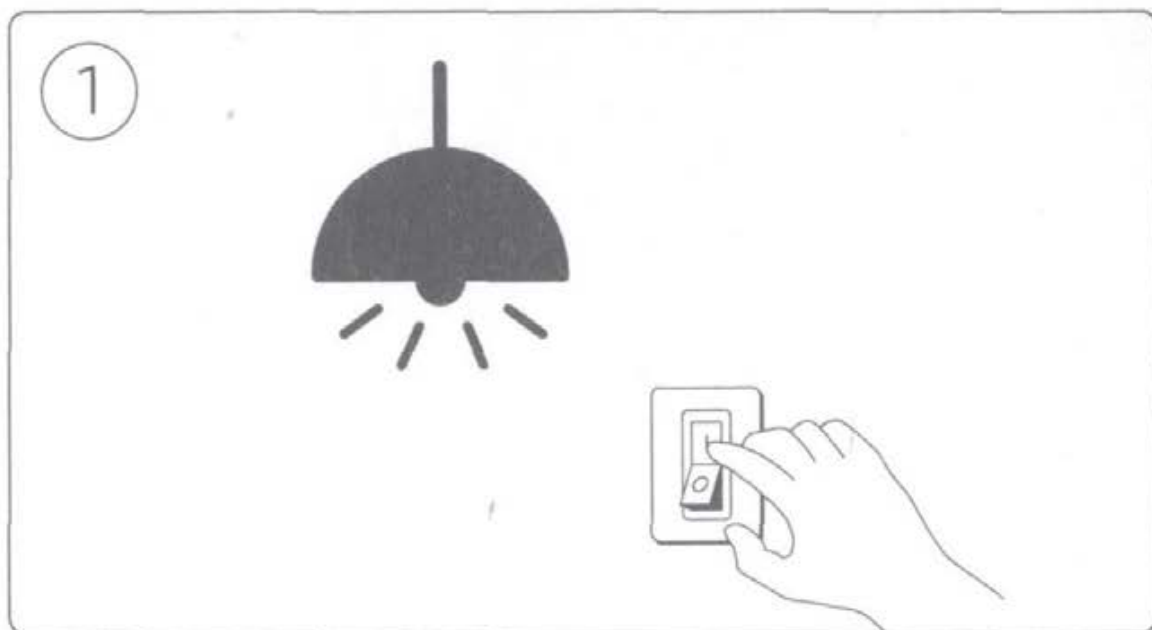

3



4





www.philips-hue.com/support





Signify North America Corporation
200 Franklin Square Drive
Somerset, NJ 08873, USA

Signify Canada Ltd./Signify Canada Ltée.
281 Hillmount Road,
Markham, ON, Canada L6C 2S3
Questions or Comments / Questions ou commentaires :
1-800-555-0050

Importado y/o distribuido en México por:
Signify Mexico S.A. de C.V.
Av. La Palma N° 6-Col. San Fernando,
La Herradura Huixquilucan
Edo. De México, C.P. 52784 - R.F.C. PME-620620-E84
Centro de contacto :
01-800-508-9000

www.philips-hue.com

© 2021 Signify Holding
All rights reserved

3222 639 07431
Last update: 03/2021

PHILIPS

hue personal
wireless
lighting

Legal Manual



please go to www.philips-hue.com to learn more about Hue and how to use it. This device complies with Part 15 of the FCC Rules and with RSS of Industry Canada.

Operation is subject to the following two conditions: (1) this device may not cause harmful interference, and (2) this device must accept any interference received, including interference that may cause undesired operation.

The advanced interface module complies with FCC radiation exposure limits set forth for an uncontrolled environment.

This equipment should be installed and operated with minimum distance of 8" or 20cm between the radiator and your body.

IMPORTANT NOTE: accessories such as Hue Bridge, Hue Smart Button, Hue Smart Plug, Hue Dimmer Switch and Hue Motion Sensor: this Class B digital apparatus complies with Canadian ICES-003.

IMPORTANT NOTE BULBS: This Class B digital apparatus complies with CAN ICES-005 (B) / NMB-005 (B).

This digital apparatus does not exceed the class B limits for radio-noise emissions from digital apparatus as set out in the Radio Interference Regulations of the Canadian Department of Communications.

NOTICE: Changes or modifications made to this device not expressly approved by Signify North America Corporation ("Signify") may void the U.S. FCC and Canadian authorization to operate this device.

This device has been tested and found to comply with the limits for a Class B digital device pursuant to Part 15 of the FCC rules. These limits are designed to provide reasonable protection against harmful interference in a residential installation.

This device generates, uses, and can radiate radio frequency energy and, if not installed and used in accordance with the instructions, may cause harmful interference to radio communications.

However, there is no guarantee that interference will not occur in a particular installation. If this equipment does cause harmful interference to radio or television reception, which can be determined by turning the equipment off and on, the user is encouraged to try to correct the interference by one or more of the following measures:

- Reorient or relocate the receiving antenna.
- Increase the separation between the equipment and receiver.
- If applicable, connect the equipment into an outlet on a circuit different from that to which the receiver is connected.
- Consult the dealer or an experienced radio/television technician for help

LIMITED WARRANTY

Signify warrants that this device's hardware components will be free from defects in material and workmanship for a period of two (2) years from the date of purchase, unless a different period is stated in or on the packaging of the product, based on up to 3 hours average working time per day/7 days per week, when used as directed (the "Warranty Period"). Notwithstanding the foregoing, the Warranty Period for all Energy Star-certified products is three (3) years from the date of purchase. This limited warranty only applies to the hardware components contained in the original packaging. This limited

warranty does not apply to any software, even if packaged or sold with the hardware components. Signify does not warrant that use of this device will be uninterrupted or error-free. If this device does not conform to this limited warranty, Signify will send you, at its election, a replacement device or refund your original price upon receipt of the returned device, register receipt and proof of purchase. Please call our toll-free number, 1-800-555-0050, or write to us (address indicated on the packaging) to find out how to return the device. This limited warranty does not cover devices subject to accident, neglect, abuse, misuse or acts of God. REPLACEMENT OR REFUND IS YOUR SOLE REMEDY. EXCEPT TO THE EXTENT PROHIBITED BY APPLICABLE LAW, ANY IMPLIED WARRANTIES ARE LIMITED IN DURATION TO THE DURATION OF THIS LIMITED WARRANTY. LIABILITY FOR INCIDENTAL OR CONSEQUENTIAL DAMAGES IS HEREBY EXPRESSEDLY EXCLUDED. Some states and provinces do not allow exclusion of incidental or consequential damages, so the above limitation or exclusion may not apply to you. This limited warranty gives you specific legal rights, and you may also have other rights which vary from state to state and province to province. This limited warranty is subject to, and may be superseded by, our End of Support policy to the extent Signify decides to terminate support for this device in accordance with its End of Support policy, available here: www.philips-hue.com/endofsupportpolicy

WARNINGS AND CAUTIONS

The product is for indoor use only. Do not use in a wet location, areas directly exposed to water or outdoors.

Keep away from liquids and humidity.

This product is not a toy designed to be played with by children.

Keep away from young children

Do not place on hot surfaces.

Do not place on a thick rug or carpet.

For safety reasons and under the terms of the warranty, none of the enclosed devices should be opened.

Caution:

do not use this bulb (E26 base) in a 3 way lamp socket (E26d)

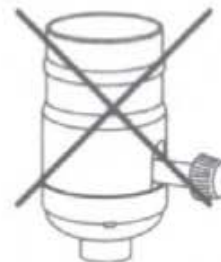

WARNINGS AND CAUTIONS FOR PRODUCTS USING BATTERIES:

Risk of explosion if the battery is replaced by an incorrect type.

Batteries should be installed by an adult.

Different types of batteries and new and used batteries must not be mixed.

Batteries are to be inserted with the correct polarity.

The supply terminals must not be short-circuited.

Exhausted batteries are to be removed from the product.

Do not use rechargeable batteries.

Non-rechargeable batteries must not be charged.

Disposal of your old product:

Manage in accordance with disposal laws in your area.

Remove the batteries when you discard the product. Do not throw the batteries away with normal household waste. They must be handed in at an official collection point or at a Philips Dealer, both of which will dispose of the batteries in an environmentally friendly way.

EXTRA WARNINGS AND CAUTIONS FOR PRODUCTS USING COIN/BUTTON BATTERIES:

CAUTION: Do not ingest battery – Chemical burn hazard

Keep new and used batteries away from children.

If the coin/button cell battery is swallowed, it can cause severe internal burns in just two hours and can lead to death.

If you think that batteries might have been swallowed or placed inside any part of the body, seek immediate medical attention.

If the battery compartment does not close securely, stop using the product and keep it away from children.

WIRELESS SPECIFICATIONS for all Philips Hue products

Wireless RF mode frequency band: 2,400–2,483.5 MHz

Operating channels Zigbee if applicable: channels 11 – 26

Operating channels Bluetooth if applicable : channels 0–39

Maximum transmitted power <20 dBm

EXTRA WIRELESS SPECIFICATIONS for Hue Dimmer Switch, Hue Smart button, Hue Motion Sensor

Range: 12 m indoor

Installing on or near metal surfaces may lead to reduced range.

ENVIRONMENTAL SPECIFICATIONS FOR ALL Philips Hue PRODUCTS

Temperature (operation): 32... 104°F (0...40 °C)

Temperature (storage): -40...176°F (-40...80 °C)

Relative humidity (operation): 0–80%

Relative humidity (storage): 0–90%

EXTRA ENVIRONMENTAL SPECIFICATIONS for Hue Smart Plug

Temperature (storage): -4...158°F (-20...70 °C)

Relative humidity: 5–95% non-condensing

Type 1 enclosure

Pollution degree 2

Operating Control: Type 1.B action

Standby power: <0.5W per device

EXTRA ENVIRONMENTAL SPECIFICATIONS for Hue Bulbs

Temperature (operation): -4...113°F (-20... 45 °C)

Temperature (storage): -13...140°F (-25... 60 °C)

Relative humidity: 5-95% non-condensing

ADDITIONAL PRODUCT SPECIFICATIONS for Hue Dimmer Switch and Smart Button

Wall plate installation

Always switch off power prior to installation.

If in doubt, consult a qualified or licensed electrician.

Ensure the product is always installed according to relevant regulations.

Perchlorate Material-special handling may apply.

ADDITIONAL PRODUCT SPECIFICATIONS for Hue Smart Plug

The equipment must be connected to a mains socket outlet with a protective earthing connection.

Before replacing, turn off power and unplug the appliance connected to the device.

Do not exceed the maximum load as indicated on the product.

The product is designed to switch on and off light sources. We recommend not to connect other appliances to the plug.

Do not connect any Hue lamp to the product.



Do not connect multiple devices one after the other.

CLEANING AND MAINTENANCE:

Do not clean the device when it is on and connected to the power supply.

To avoid scratching the device, clean only with a soft dry cloth.

Do not use cleaning agents to clean the device.

Manage in accordance with disposal laws in your area.

The Bluetooth® word mark and logos are registered trademarks owned by Bluetooth SIG, Inc. and any use of such marks by Signify is under license. Other trademarks and trade names are those of their respective owners.

Hue Personal Wireless Lighting is a trademark owned by Signify Holding B.V.

Philips and the Philips shield emblem are registered trademarks of Koninklijke Philips N.V.

CUSTOMER SUPPORT:

For more information, please visit our website at www.philips-hue.com/support, or call our customer service (1-800-555-0050)



Signify North America Corporation
200 Franklin Square Drive
Somerset, NJ 08873, USA

Signify Canada Ltd./Signify Canada Ltée.
281 Hillmount Road,
Markham, ON, Canada L6C 2S3
Questions or Comments /
Questions ou commentaires:
1-800-555-0050

Importado y/o distribuido en México por:
Signify Mexico S.A. de C.V.
Av. La Palma N° 6-Col. San Fernando,
La Herradura Huixquilucan
Edo. De México,
C.P. 52784 - R.F.C. PME-620620-E84
Centro de contacto:
01-800-508-9000

www.philips-hue.com

© 2021 Signify Holding
All rights reserved

3222 639 07741
Last update: 04/2021