

VersaConnect – 8FT LED Type B T8 Installation Instructions



INCLUDED PARTS/COMPONENTS

- LED T8 Lamp (2 pieces – A and B).
 - Side A: Tube labeled “L Pin Shorted” and “to this line” T-shaped line at the connection end.
 - Side B: Tube with the with CCT selection switch, labeled “N Pin Shorted”, and “arrow” at the connection end.
- FA8 Adaptor (2 pieces), for G13 to FA8 conversion.
- R17D Adaptor (2 pieces), for G13 to R17D conversion.
- Anti-rotating Clip (1 piece), use at the midpoint of the lamp to prevent sagging or drooping and rotation.
- Installation Instruction.
- Luminaire Labels. Please apply the lamp replacement label on the retrofit luminaire after the retrofit has been installed, where readily visible by the user during relamping and after installation.

MARKINGS/WARNING:

- a. Please keep this Quick Installation Guide for future reference.
- b. Suitable to replace fluorescent lamps as specified on the product label.
- c. Risk of fire or electric shock. LED Retrofit Kit installation requires knowledge of luminaires electrical systems. If not qualified, do not attempt installation. Contact a qualified electrician.
- d. Risk of fire or electric shock. Install this kit only in the luminaires that have the construction features and dimensions shown in the photographs and/or drawings and where the input rating of the retrofit kit does not exceed the input rating of the luminaire.
- e. Do not make or alter any open holes in an enclosure of wiring or electrical components during kit installation.
- f. To prevent wiring damage or abrasion, do not expose wiring to edges of sheet metal or other sharp objects.
- g. To avoid potential fire or shock hazard, do not use this retrofit kit in luminaires employing shunted bi-pin lampholders. Note: Shunted lamp holders are found only in fluorescent luminaires with Instant-Start ballasts. Instant-start ballasts can be identified by the words “Instant Start” or “I.S.” marked on the ballast. This designation may be in the form of a statement pertaining to the ballast itself, or may be combined with the marking for the lamps with which the ballast is intended to be used, for example F40T12/IS. For more information, contact the LED luminaire retrofit kit manufacturer.
- h. Installers should not disconnect existing wires from lampholder terminals to make new connections at lampholder terminals. Instead, installers should cut existing lampholder leads away from the lampholder and make new electrical connections to lampholder lead wires by employing applicable connectors.
- i. For a linear tubular LED lamp conversion, there shall be text or a diagram showing how the supply connections were made to the lampholders so the correct connections will be made to the lamp when the lamp is installed or replaced.
- j. This retrofit kit is accepted as a component of a luminaire where the suitability of the combination shall be determined by authorities having JURISDICTION.

VersaConnect – 8FT LED Type B T8 Installation Instructions

VersaConnect Assembly Instructions:

- 1) Base Selection
 - a) Determine needed base type of current fixture and lamp (Fa8 Single Pin or R17d Recessed Double Contact).
 - b) If the lamp holder is Fa8, insert Fa8 adaptors to G13 pins at both ends of the lamp; if it's R17d, insert R17d adaptors.
- 2) Connect/Assemble the Tubes
 - a) Put the two parts of the tube (Part A and Part B) in straight line with the end caps in two ends.
 - b) Align the two tubes so the “arrow” and “straight line” line up (Note: If lined up correctly the white glue strip at the back of the lamps will line up with each other)
 - c) Insert the end with the “arrow” (B) into the narrower connector (A) until (B) overlaps the “to this line” vertical line completely.



- d) Assembly is completed.

IMPORTANT: ONCE THE TWO PIECES ARE CONNECTED, THE TUBE CANNOT BE SEPARATED OR DISCONNECTED.

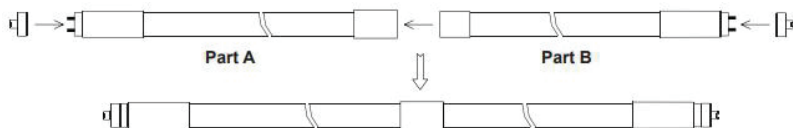

Installation Introduction:

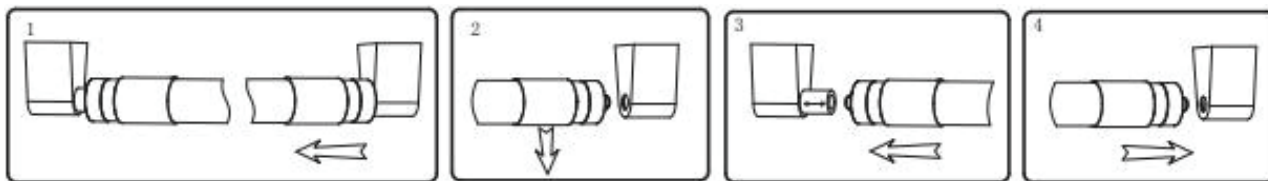

1. DISCONNECT POWER OF LUMINAIRE

Disconnect power to luminaire or circuit (if possible). Ensure all power is off by using a voltmeter or other method to confirm.

VersaConnect – 8FT LED Type B T8 Installation Instructions



2. REMOVE EXISTING TUBE LAMP(S)

- Remove troffer lens, if present.
- Remove existing fluorescent tube.
- Remove ballast cover (Cover may be secured with screws or tabs).

3. REWIRE THE FIXTURE

- Disconnect the wires between starter and ballast.
- Connect two wires to branch circuit L and N according to the below figure.

Case 1: Direct AC wiring diagram without dimming

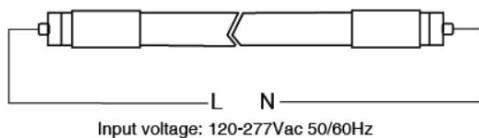

Case 2: Direct AC wiring diagram with 0-10V dimming system

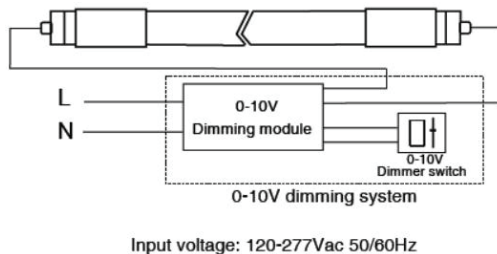

Note: Dimming module must be purchased for dimming. Do not dim without the proper module. Contact Halco for more information.

Select the color temperature through the CCT switch on the LED lamp's base

Using the color (CCT) selector switch on the base, select the desired color temperature.

To prevent damage to lamp, lamp must not be energized when color (CCT) selector switch is changed.

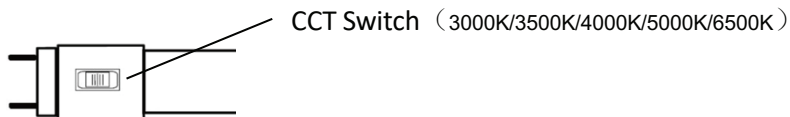

5. INSERT LED TUBES

- Read label on the LED tube to ensure the power end of LED is aligned with powered tube socket, then insert LED lamp in the normal way by sliding adaptors into sockets until LED tube locks in place.
- Clip the anti-rotating clip on the middle of the tube and make sure the magnet is attached to the fixture to prevent tube droop and rotation.
- LED lamps are now fully installed.
- Replace troffer lens, if present.
- After modification completed. Attach the Replacement Marking and cautionary Label to a visible place on the luminaire and keep it visible after installation.

6. RESTORE THE POWER OF LUMINAIRE

Restore power to circuit/luminaire and test light. If necessary, adjust position of LED tube.