

Quick Start Guide



V810A and V810AD by ATEL

4G LTE Cat-4 Fixed Wireless Access Router

Models Covered:

Model	LTE Bands
V810A	B2/4/5/12/13/14/66/71
V810AD	B2/4/5/12/13/14/66/71



About your V810A: Device Display

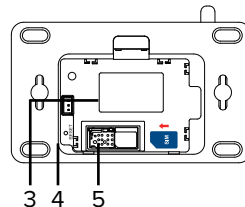
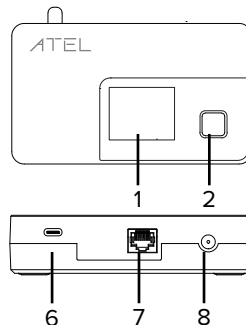

1. LCD Display Displays Home, Device Information, Hotspot login information, and Online Portal login information.	3. Battery Port This battery port is used to connect to a Ni-MH rechargeable battery pack (may be sold separately).
2. Power Button Power the V810A on/off by pressing and holding this button. You can also short press this button to wake up the screen and toggle screens to check device information	4. Reset Button Use a pin to push and hold this button for 3 seconds for factory reset.

<p>5. SIM Card Slot Insert your 4FF SIM card into this spring-loaded SIM slot. To remove a SIM, press the edge of the SIM inward and the SIM would pop outward from the SIM slot.</p>	<p>7. Ethernet Port (RJ45) Insert an ethernet cable to this Port and plug the other end into your computer for internet access.</p>
<p>6. Type-C Port Use this port to connect the USB-C cable to a wall adapter for external power.</p>	<p>8. Antenna Connector Install an optional antenna (may be sold separately) to increase signal strength.</p>

Setting up your V810A

Install SIM Card

1. Remove the V810A back cover.
2. Install the 4FF Nano SIM card into the spring-loaded SIM slot as the image shows. To remove a SIM, press the edge of the SIM inward and the SIM will pop outward from the SIM slot.

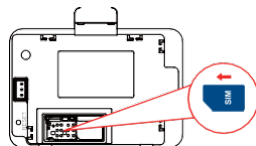

Installing a NiMH Battery

1. Remove battery cover.
2. Properly align and install the NiMH battery (with three pin sockets). Make sure to align the pin sockets correctly.
3. Put the NiMH battery in place as shown below.
4. Replace the back cover of the V810A and make sure it's aligned with the bottom of the device.

Note: the NiMH Battery may be sold separately.

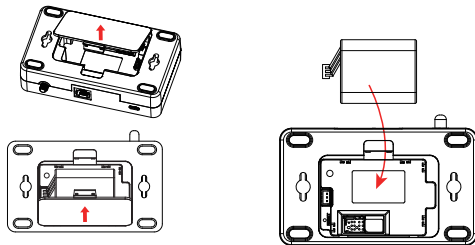

Note: During a power outage or if the wall charger is unplugged, the V810A continues to run off of the batteries to support data functions.

Equipment External Power

To connect your V810A to the power outlet, insert your USB cable to the device USB-C port and plug the other end into a wall adapter.

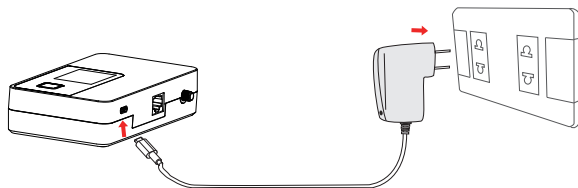

WARNING! Please only use the provided USB adapter for the V810A. The use of other incompatible adapters may cause damage to your device and void the warranty.

Turning your V810A On/Off

To turn on your V810A press and hold the Power button. To turn off your V810A, press and hold the Power button until you see the screen turn of.

Optional Add-On's: Install an Antenna

To increase signal strength, you can install an optional antenna.

1. Align the antenna with the antenna port and screw securely into place (in a clockwise direction).
2. Restart the V810A after the antenna is installed.

Note: Antenna may be sold separately. Using optional accessories (antenna and battery pack) by ATEL are recommended, available at ATEL website, <https://www.atel-usa.com/>.

LCD Display Icons Overview:

	Icon	Definition
Network Signal		Indicates the signal strength of your wireless provider in your location. More bars represent a stronger signal.
WiFi		WiFi available for connection.
Battery		Battery Level (Applies to NiMH Battery Only)
		Battery Charging (Applies to NiMH Battery Only)
Power Key		Press the Power Key to switch menu screens.

Connect your Computer to the V810A Using the Ethernet Port

The V810A provides 1 Ethernet port (RJ45). For internet access, plug an ethernet cable to the Ethernet port of your V810A and connect it to the Ethernet port of your computer.

Note: the computer and ethernet cable are not included.

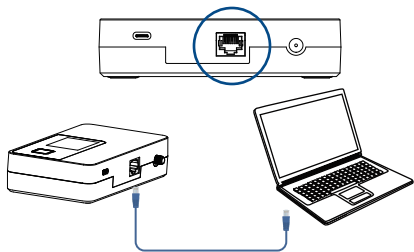

Connecting to Your V810A Hotspot Wi-Fi

Your V810A Hotspot supports up to 15 Wi-Fi connected devices. To connect to the Hotspot Wi-Fi;

1. Locate your Network Name (SSID) / Password from your V810A LCD Display or device label under the battery holder.
2. Open the Wi-Fi Settings of your Wi-Fi capable devices.
3. Select the SSID of your V810A from the available network list.
4. When prompted, enter the password of your V810A.
5. You are connected to the Internet.

Device Display

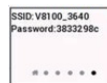

Portal URL:
http://192.168.0.1/
Username: admin
Password: 547e14

Device Label

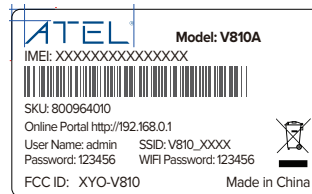

Direct Connect Device Management Portal

You can access your V810A Direct Connect Portal to view device status, change your device settings, and perform manual software upgrades.

1. First connect your computer to the V810A Hotspot Wi-Fi and then enter <http://192.168.0.1> in the browser URL address bar. Note that you can also connect your V810A to a computer with a USB-C or ethernet (RJ45) cable to access the Direct Connect portal.
2. The login username is "admin". The unique password can be found in the LCD Display menu or on the device label (under the battery holder).

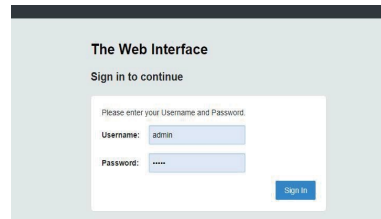

Changing Your Direct Connect Portal Login Password

You can change the Direct Connect Portal login password by going to Settings > Device Settings > Admin Password. Once changed, you must use the new password to login to the portal.

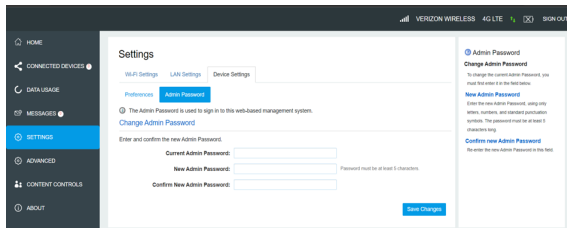

Managing Wi-Fi Networks and Connections

In the Wi-Fi Settings tab, you can change the Wi-Fi name (SSID) and password. You can also set the device to be working on the 2.4GHz or 5GHz of the 802.11 mode.

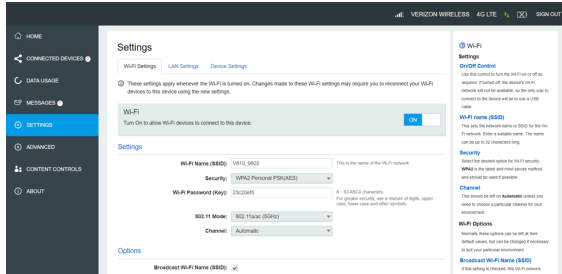

ATRACS Cloud Connect Remote Management

You can manage the device using the ATEL Remote Management Platform ATRACS, by visiting <http://aags.a-tracs.com> or <https://aags.a-tracs.com>. Please refer to the ATRACS User Manual for details.

Factory Resetting of Your V810A

You can reset your V810A to factory default from the Online Portal or reset button.

Note: Resetting your V810A will disconnect devices and reset network names and passwords.

- To reset the device from the Online Portal, click About > Backup and Restore > Restore to Factory Defaults. Click on "Restore Factory Defaults" to

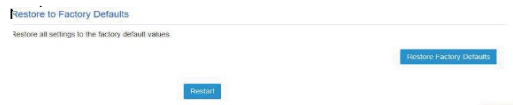

- To reset the device from the reset button, make sure your V810A is powered on. Remove the battery cover from the back of your V810A. Insert a pin into the Reset pin hole, push down and hold for 3 seconds. The device will restore the factory defaults and reboot.

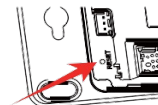

Regulatory Statements

Please review the Regulatory Statements for this device in the device User Manual, available at www.ATEL-USA.com.

Voice/Emergency calls:

ATEL cannot guarantee the voice or E911 calls availability. Making a successful call depends on your hardware (telephone) availability, physical location, wireless signal strength, and/or network services. You should never rely solely on any wireless mobile device for essential communications (medical emergencies, for example). Check with your wireless service providers. When making an emergency call, remember to give all the necessary information as accurately as possible.

Disclaimer:

Certain variations may be present between the device and user manual description depending on software release or specific network services. ATEL shall not be held legally responsible for such deviations, if any, nor for their potential consequences.

Limited Warranty:

The full ATEL USA Warranty Policy can be found at www.atel-usa.com/warranty. On this page you can "Start a Warranty Claim", "Check on an Existing Claim" and read our Warranty Policy by clicking on "ATEL's Warranty Policy". Please follow all warranty instructions available and if you have any questions contact us at support@atel-usa.com.



@AsiatelcoUSA



@atel-asiatelco



@ATEL USA



@ATEL_USA

Our Website: www.atel-usa.com Contact us at: support@atel-usa.com
For Warranty information, see our website under the Support tab.

© 2023 Asiatelco Technologies, Inc. All Rights Reserved