

# Kadlun Stylus Pen for iPad



## User Manual

Please Read it carefully Before Using Products

# Product Structure

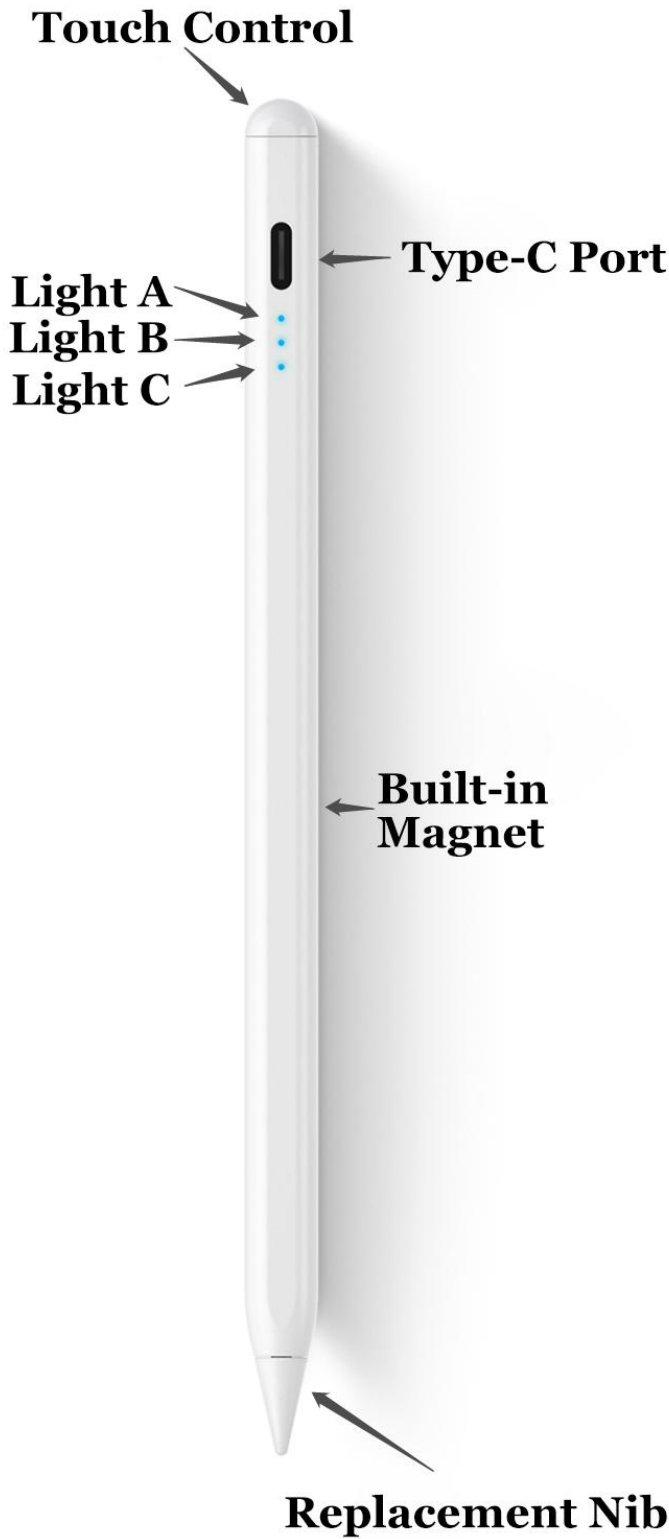

## Touch Key

Double Tap the top to turns on/off easily



## Type-C Port

Built-in high quality rechargeable battery. Working time is 8 hours

## Magnetic Attaches

The stylus pencil can be attached to the side of your tablet, avoid loss, convenient to carry



## Easy to replace

1.5mm fine tip easy to replace more precisely and smoothly

# LED Indicator Instruction



**the three blue lights are all lighting up**  
**The Battery Capacity is 70%~100%**



**the two of them are lighting up**  
**The Battery Capacity is 30%~70%**



**the one of them is lighting up**  
**The Battery Capacity is 5%~30%**

Low Battery	Light A flashing	Battery 0%~5%
Being Charged	Light A flashing	Battery 5%~30%
	Light A on , light B flashing	Battery 30%~70%
	Light A & B on , light C flashing	Battery 70%~95%
Fully Charged	Light A ,B & C on	Battery 100%

# Compatible Models

## 1. How to check the model number (AXXX)

- 1) [Settings]→[About]→[Model Number] (click the Code MXXX/X once)
- 2) Check it on the back of your iPad



## 2. Compatible models

iPad Mini

**iPad Mini 5th**--A2133/A2124/A2126/A2125

**iPad Mini 6th** --A2569

iPad

**iPad 2018/2019 6th/7th**-- A1893/A1954 /A2197/A2200/A2198

**iPad 2020 8th** --A2270/A2428/A2429/A2430

**iPad 2021 9th** -- A2605 A2604 A2603

iPad Air

**iPad Air 3rd**--A2152/A2123/A2153/A2154

**iPad Air 4th**--A2316/A2325

**iPad Air 5th**--A2588/A2591

iPad Pro

**iPad Pro 11" 1st** A2013 A1934 A1979

**iPad Pro 11"2rd** A2228 A2231 A1980

**iPad Pro 11"3rd** A2377 A2459 A2301 A2406

**iPad Pro 12.9' (3rd)**--A1876/A2014/A1895/A1983

**iPad Pro 12.9" (4th)**-- A2229/A2233/A2069/A2232

**iPad Pro 12.9" (5th)**-- A2379/A2461/A2462

### 3. Incompatible models

**iPad 1st / 2nd / 3rd / 4th / 5th :**

A1219 / A1337 / A1395 / A1396 / A1397 / A1416/ A1430 / A1403/  
A1458 / A1459 / A1460 / A1822 / A1823

**iPad Air 1st / 2nd :**

A1474 / A1475 / A1476 / A1566/ A1567

**iPad Pro 9.7"/10.5" :**

A1673 / A1674 / A1675/ A1701 / A1709 / A1852

**iPad Pro 12.9" 1st / 2nd :**

A1584 / A1652 / A1670 / A1671 / A1821

**iPad Mini 1st / 2nd / 3rd / 4th :**

A1432 / A1454 / A1455/ A1489 / A1490/ A1491 / A1599 / A1600 /  
A1538

**iPhone Android Microsoft and Anyother touchscreen devices** because  
it is specially designed for iPad launched and first sold in 2018 ~ 2021

# Question & Answers

1. Q: Does this pencil need for iPad Bluetooth pairing?

A: No, Just Double touch the top of pen once. it will automatically connect to the tablet

2. Q: Why is this pen not automatically connect with iPad?

A: First check if the pen is fully charged.

Second, whether your tablet is compatible with pencil.

Third, if you have connected an Apple Pencil pencil with Bluetooth, disconnect it and disable "Drawing Only with Appencil" as follows:

[Setting] → [Apple Pencil] → Disable [Only Draw Apple Pencil]

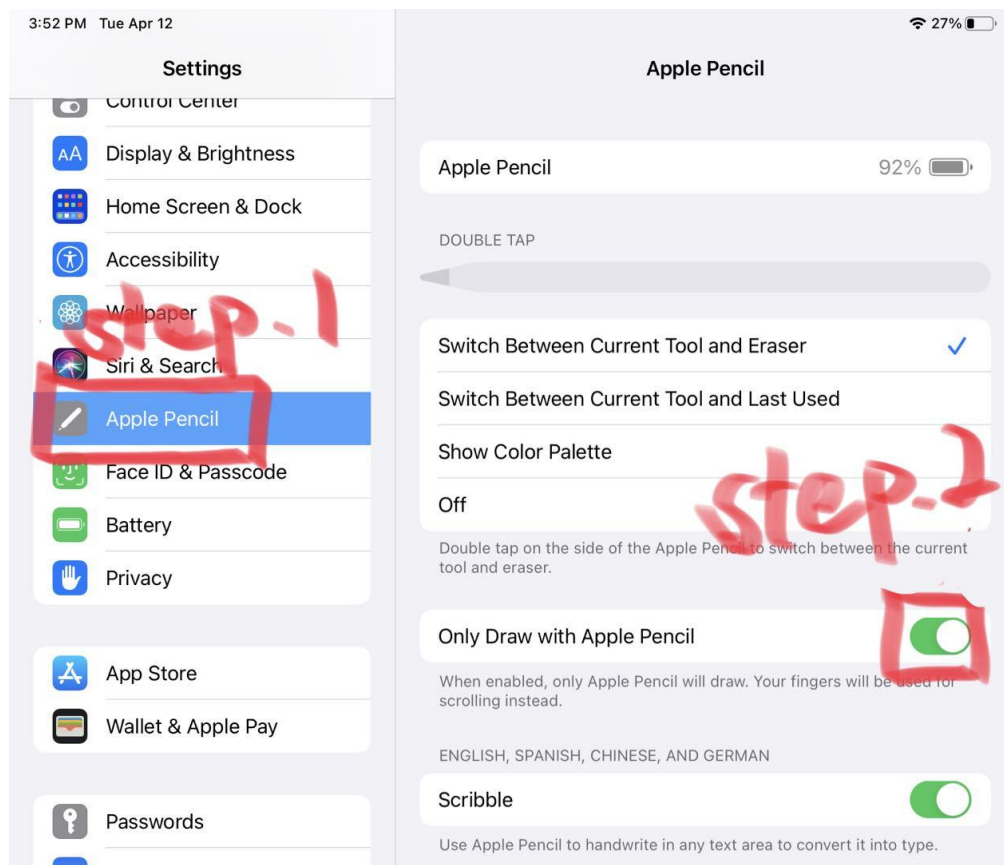

3. Q: Do I need to turn off the Bluetooth when using this pen?

A: No, You can use the pen when the Bluetooth is on, as follow

[Setting] → [Bluetooth] → [ⓘ of Apple Pencil] → [Foget this Device]

→ Click [Forget Device]

