

USE AND CARE GUIDE

DROP-IN BASIN

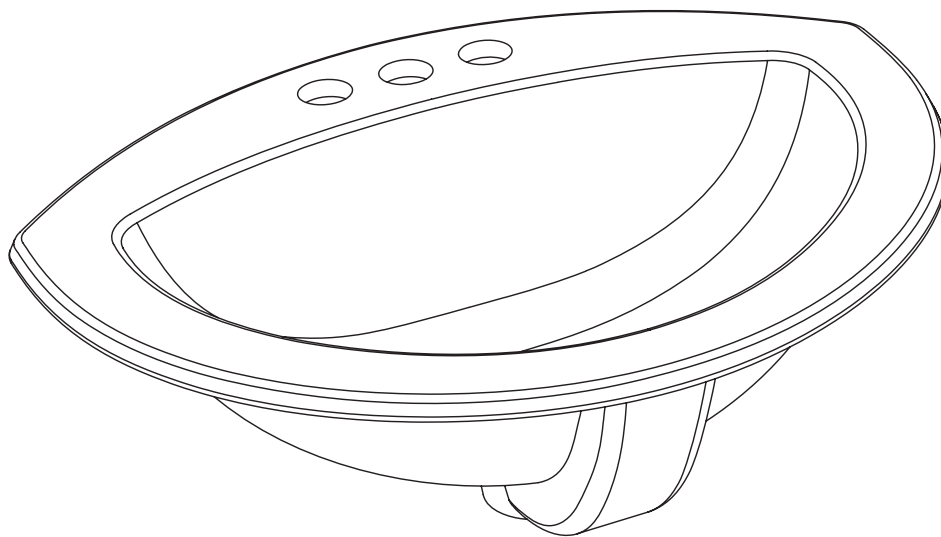

Questions, problems, missing parts? Before returning to the store,
call Glacier Bay Customer Service
8 a.m. - 7 p.m., EST, Monday - Friday, 9 a.m. - 6 p.m., EST, Saturday

1-855-HD-GLACIER

HOMEDEPOT.CA

THANK YOU

We appreciate the trust and confidence you have placed in Glacier Bay through the purchase of this sink. We strive to continually create quality products designed to enhance your home. Visit us online to see our full line of products available for your home improvement needs. Thank you for choosing Glacier Bay!

Table of Contents

Table of Contents	2	Installation	4-5
Safety Information	2	Care and Cleaning	5
Warranty	2		
Pre-Installation	3		
Planning Installation	3		
Tools Required	3		
Package Contents	3		

Safety Information

Please read and understand all safety precautions and instructions in this manual before you begin the installation of this product.



CAUTION: Handle with care. Vitreous chinaware is glass-like with sharp edges if broken. Do not drop or handle roughly.

NOTICE: Observe local plumbing and building codes.

Warranty

LIMITED LIFETIME WARRANTY

Glacier Bay products are manufactured with superior quality standards and workmanship and are backed by our limited lifetime warranty.

Glacier Bay products are warranted to the original consumer purchaser to be free of defects in materials or workmanship. We will replace **FREE OF CHARGE** any product or parts that proves defective. Simply, return the product / part to any of The Home Depot retail locations or call 1-855-HD-GLACIER to receive the replacement item. Proof of purchase (original sales receipt) from the original consumer purchaser must be made available for all Glacier Bay warranty claims.

This warranty excludes incidental/inconsequential damages and failures due to misuse, abuse or normal wear and tear. This warranty excludes all industrial, commercial & business usage, whose purchasers are hereby, extended a five year limited warranty from the date of purchase, with all other terms of this warranty applying except the duration of warranty.

Some states and provinces do not allow the exclusion or limitation of incidental or consequential damages, so the above limitations may not apply to you. This warranty gives you specific legal rights and you may also have other rights that vary from state to state and province to province. Please see a store or contact 1-855-HD-GLACIER for more details.

Pre-Installation



NOTE: This sink can be handicapped installed. To comply the ADA requirements, the sink shall be installed at 34 inches (865 mm) height maximum measured from the floor to top of front rim.

PLANNING INSTALLATION

Before beginning installation of this product, ensure all parts are present. If any part is missing or damaged, do not attempt to assemble, install, or operate the product. Contact customer service for replacement parts.

If you have a marble or stone countertop that does not have a cutout to accommodate the sink, it is recommended this be done by a professional. Install so future removal is possible. Do not use adhesives or adhesive sealant. This will avoid damage to the top.

TOOLS REQUIRED

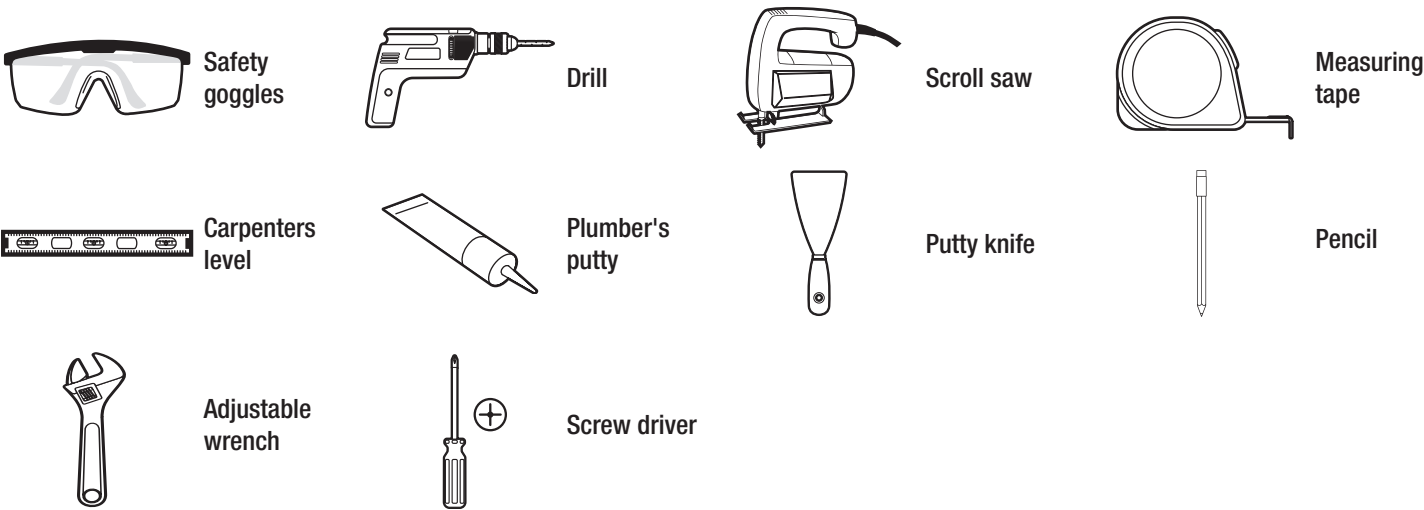

PACKAGE CONTENTS

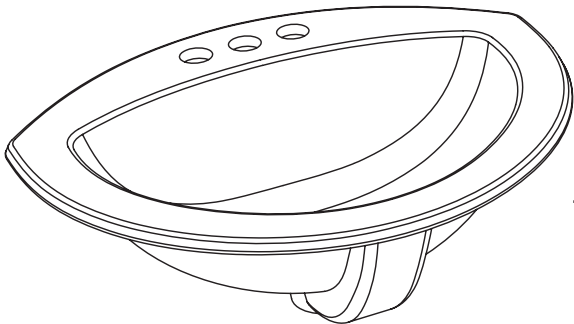

A

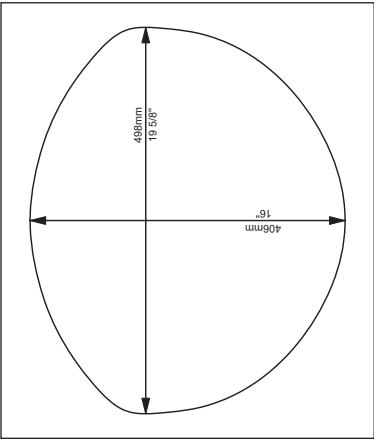

B

Part	Description	Quantity
A	Drop-in Sink	1
B	Template	1

Installation

1 Cutting the counter top



NOTE: To avoid possible damage to the cabinet, cut the counter top before installing the counter top to the cabinet.

- Affix the template (B) provided to the counter top at the desired location with cellophane tape.
- Using a pencil, mark guidelines on the counter top following the template (B).
- Drill a clearance hole approximately 1/4 in. to 1/2 in. inside the perimeter line of the template.
- Cut an opening following the perimeter line of the template (B).



NOTE: For harder surfaces, have the counter top professionally cut following the template provided.

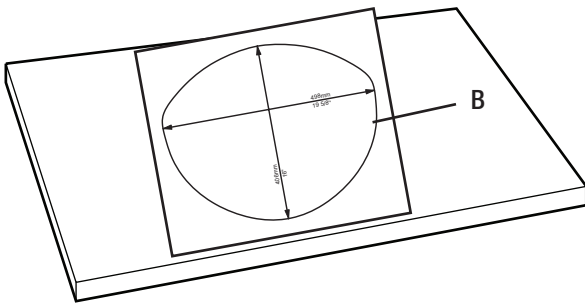

2 Positioning the sink

- Center the sink (A) and line up the drain over the cutout to ensure the sink (A) fits easily into the opening.



NOTE: It is recommended to practice the proper insertion two or three times before applying sealant.

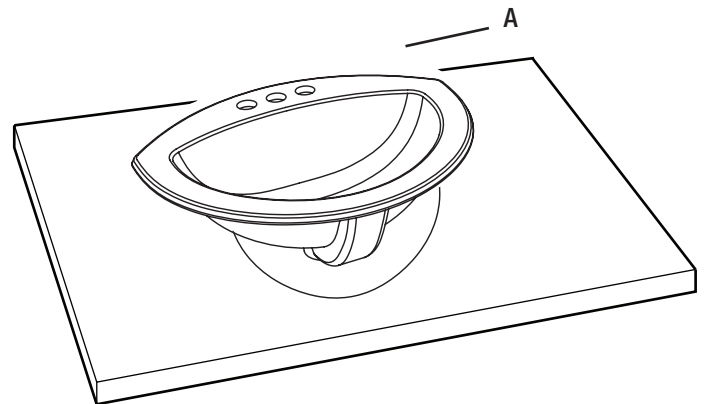

3 Installing the drain and plumbing

- Install the drain (not provided) according to the manufacturer's installation instructions.



CAUTION: Do not overtighten the drain assembly. This may cause the bowl to forcefully crack during installation or at some time in the future.

- Install the waste system, faucet, and the water supply (not provided) according to the manufacturer's installation instructions.



Faucet
(not included)

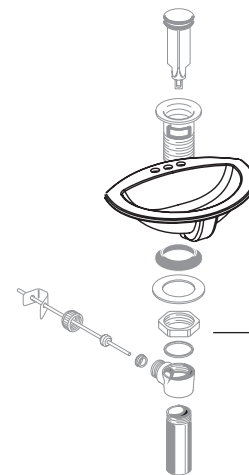

Drain assembly
(not included)

Installation (continued)

4 Installing the sink

- ☐ Apply plumber's putty or caulking around the underside rim of the sink (A) near the edge, as shown.
- ☐ Carefully lower the sink (A) in place, align it, and press down firmly to adhere the sink (A) to the counter top.
- ☐ Wipe off excess sealant.
- ☐ Connect the water supply and P-Trap (not provided) as required.
- ☐ Check for leaks.

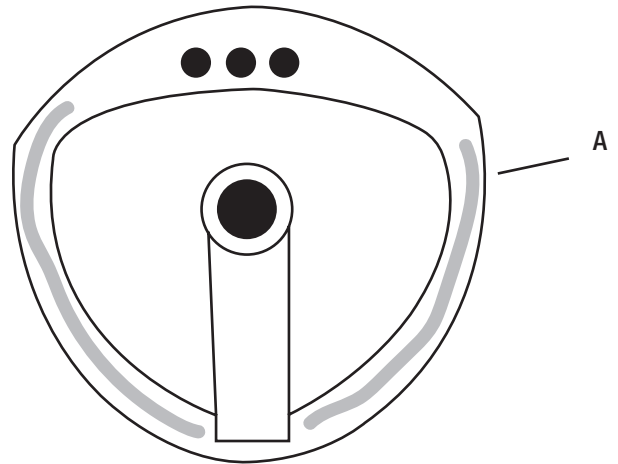

Care and Cleaning

For best results in caring for your sink, we suggest the following:

- ☐ Clean the outside surface with mild soap, warm water and a soft cloth.
- ☐ On stubborn stains use a powdered detergent and damp sponge or nylon scouring pad.
- ☐ Never use abrasive scouring powders, cleansers, or pads because they will scratch, damage, and dull the surface.



Questions, problems, missing parts? Before returning to the store,
call Glacier Bay Customer Service
8 a.m. - 7 p.m., EST, Monday - Friday, 9 a.m. - 6 p.m., EST, Saturday

1-855-HD-GLACIER

HOMEDEPOT.CA

Retain this manual for future use.