



INSTANT MATCH[®]
wireless

SDS131T

Instant Match Transformer



QUICK CONNECT GUIDE

WITH
Active Link

Wireless System Registration

Important Information



Please read the following information before setting up a wireless connection between the Whale Instant Match® wireless transformer and Mira® Advance Flex Extra Wireless (J97P)

- The electrical wiring must conform to EU wiring regulations BS7671:2008 Part 7 (17th Edition).
- This Whale Instant Match® Wireless transformer **cannot be** connected wirelessly to the Bluetooth® wireless technology enabled Mira Advance Flex Extra Shower (J09N).
- Bluetooth® wireless technology enabled transformers can be easily identified by the blue test button.
- Wireless enabled transformers can be easily identified by the yellow test button.
- Locating the transformer outside of a 5 metre radius may cause a communication breakdown between the transformer and shower, resulting in intermittent or complete failure to operate.
- Be aware that in very rare situations, dense building material, metallic objects such as steel baths and foil lined plaster board, or electronic devices may interfere with the wireless signal and result in intermittent failure. In this situation you should relocate the transformer closer to the shower.
- A hardwired connection should be established if a wireless connection cannot be made between the shower and transformer.
- If any components or cords are damaged, it must be replaced by a qualified person to avoid a hazard.

Set Up

1. Shower settings

- Before beginning the registration process, please move the jumper to the "wireless" position inside the Mira® Advance Flex Extra wireless shower as per the diagram shown.
- At this stage please ensure that your transformer is set to be used with wireless: the flow sensor setting must be set to 7 for "wireless" and the pipe inlet diameter must be set to 1 for 15mm.

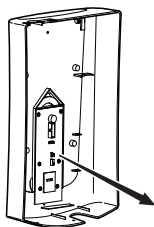

Please set jumper on the rear of the front cover to "Wireless" position

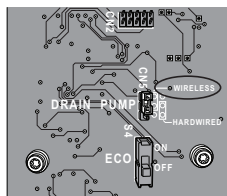

SIGNAL



2. Transformer set up

- Switch the mains electric supply to the transformer **ON**. The light on the transformer will now flash **red** to indicate that a wireless connection has not yet been established.

- Press and **HOLD** the yellow test button on the transformer until the light flashes red and green to indicate that the transformer is now in pairing mode.

NOTE: You now have 120 seconds to pair the transformer to the shower.



3. Shower set up

- Ensure that the electric supply to the shower is turned **OFF**. Then turn the dial on the shower to **FULL COLD**.

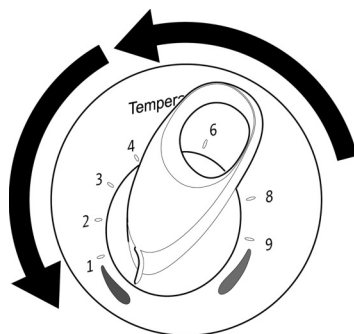

4. Configuring the shower

- Switch the mains electric supply to the shower **ON**.
- Press the Start/Stop button on the shower. The Mira shower and wireless transformer will now pair automatically.
- The green LED on the transformer will now flash green.

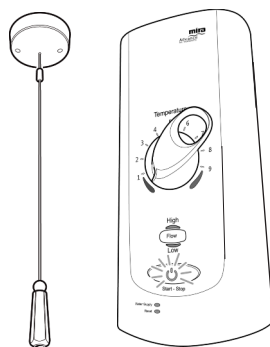

Wireless technology Unpairing

Some service work that may need to be carried out on the Mira Advance shower e.g. the renewal of the control PCB board may require the wireless connection between the shower and Whale Instant Match® transformer to be terminated and paired again once the work has been completed. To unpair the transformer from the shower, please follow these steps.

1. Switch the mains electric supply to the shower OFF.

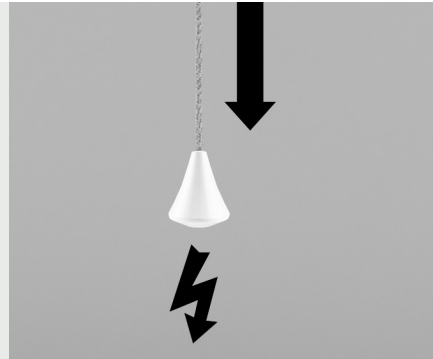

2. The mains electric supply to the pump OFF.

- Remove hatch to access jumper settings.



3. De-registration sequence

- Move jumper from position 7 to any other position.
- Power ON the transformer.
- Press and Hold yellow test button for 5 seconds to de-register.
- Power OFF the transformer.
- Move the jumper to position 7
- Replace and secure hatch.
- Power ON the transformer. Red light will flash to show unpaired.



Shower Hardwired Connections Cont'd

Mira® Advance Flex Extra wireless (J97P)

Wired Connections to the WHALE INSTANT MATCH® Transformer

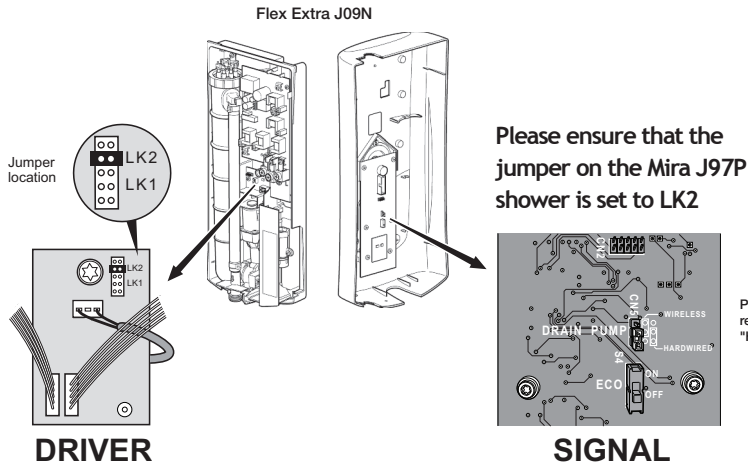

Whale Transformer Settings

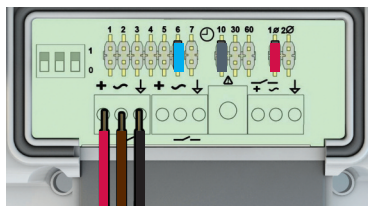

Blue Jumper - Sensor Position 6
Grey Jumper - Over run 10 Seconds
Red Jumper - Pipe inlet 15mm

Shower Hardwired Connections



Triton® Safeguard + Omnicare Design, Omnicare Style, T150Z+

Wired Connections to the Whale
Instant Match® Transformer

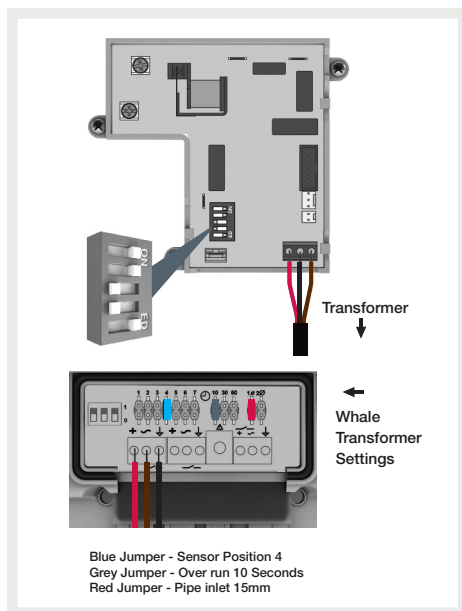

Redring® Selectronic WP (SEL85WP or SEL95WP)

Wired Connections to the Whale
Instant Match® Transformer

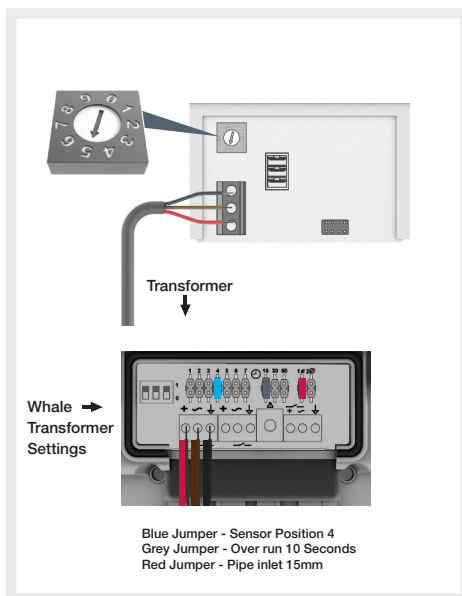

Whale Instant Match® Transformer Flow Sensor Connections

Sika® Sensor Connection

Please see below for jumper and wiring connections.

Whale[®] Transformer Settings

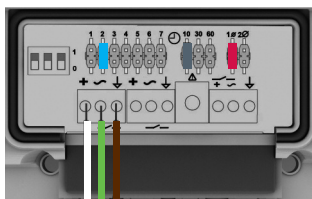

Blue Jumper - Sensor Position 2
Grey Jumper - Over run 10 Seconds
Red Jumper - Pipe inlet 15mm



Please ensure that water flow through the sensor is in the direction of the arrow.

Gems® Sensor Connection

There are two versions of Gems® flow sensor:

1000 pulses per litre (ppl) and 2200 ppl.

Blue jumper position 3 = 1000ppl

Blue jumper position 4 = 2200ppl (shown below)

Whale[®] Transformer Settings

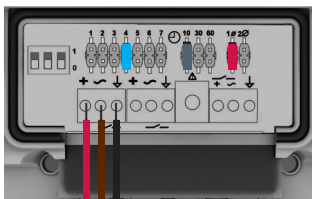

Blue Jumper - Sensor Position 4
Grey Jumper - Over run 10 Seconds
Red Jumper - Pipe inlet 15mm

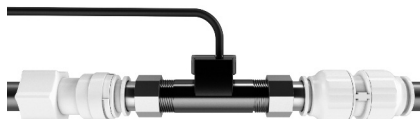

Gems® Sensor

Please ensure that water flow through the sensor is in the direction of the arrow.

Whale Instant Match® Transformer Flow Sensor Connections Cont'd



Grundfos® (Venturi) Connection

When connecting to the Grundfos® Venturi sensor it is important to connect an earth wire from the Venturi sensor to the signal earth connection on Whale® transformer (shown below).

Whale® Transformer Settings

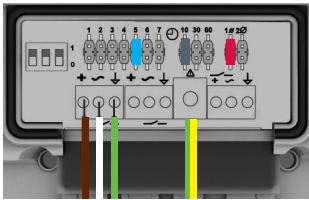

Blue Jumper - Sensor Position 5
Grey Jumper - Over run 10 Seconds
Red Jumper - Pipe inlet 15mm



Venturi sensor

Please ensure that water flow
through the sensor is in the
direction of the arrow.

Whale Instant Match® Transformer Flow Switch Connections

In a situation where a Bluetooth® wireless technology or hardwired connection with the shower cannot be established, or a suitable flow sensor has not been fitted, the Whale SDS236T Instant Match transformer can be used with an AK1568 flow switch to activate the pump.

Electric Shower Settings

- Step 1: Turn Dip switch 2 to the 'ON' position.
- Step 2: Move red jumper to pipe size '1' for 15mm inlet pipe.
- Step 3: Move the blue jumper to increase or decrease the pump speed as required, using the table below as a guide.
- Step 4: Move the grey jumper to increase or decrease the pump overrun if necessary.

Jumper Position	Flow Rate (LPM)
1.	4.5 - As shown opposite
2.	5.0
3.	5.5
4.	6.0
5.	6.5
6.	7.0
7.	7.5

- Flow rates are nominal values only. This will vary depending on pipework.



Please ensure that water flow through the sensor is in the direction of the arrow on the sensor.

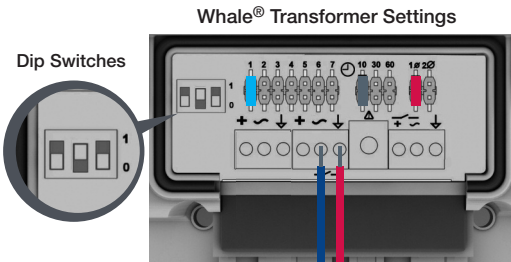

Whale Instant Match® Transformer Flow Switch Connections Cont'd



Mixer Shower Settings

- Step 1:** Turn Dip switch 2 to the 'ON' position.
- Step 2:** Move red jumper to pipe size '2' for 22mm inlet pipe.
- Step 3:** Move the blue jumper to increase or decrease the pump speed as required, using the below table as a guide.
- Step 4:** Move the grey jumper to increase or decrease the pump overrun if necessary. 30 is the recommended setting for use on mixer showers.

Note: An additional flow switch is available in the AK1570 Mixer Valve Conversion kit (sold separately).

Flow Switch x 2



Please ensure that water flow through the sensor is in the direction of the arrow on the sensor.

Jumper Position	Flow Rate (LPM)
1.	7.5 - As shown opposite
2.	8.0
3.	8.5
4.	9.0
5.	9.5
6.	10.0
7.	11.0

- Flow rates are nominal values only. This will vary depending on pipework.

Whale® Transformer Settings

Dip Switches

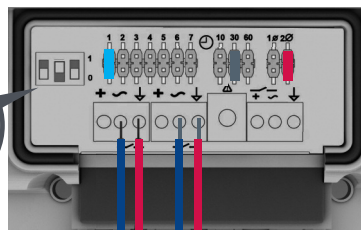

Blue Jumper - Sensor Position 1
Grey Jumper - Over run 30 Seconds
Red Jumper - Pipe inlet 22mm

©Copyright Whale 2019 - All rights reserved. Reproduction in whole or in part without permission is prohibited. WHALE® and WHALE INSTANT MATCH® are registered trademarks of Munster Simms Engineering Limited, Bangor, Northern Ireland trading as Whale. Whale's policy is one of continuous improvement and we reserve the right to change specifications without prior notice. Illustrations are for guidance purposes only. Neither the accuracy nor completeness of the information contained in this or any product literature is guaranteed by the Company and may be subject to change at its sole discretion.

The Bluetooth® word mark and logos are registered trademarks owned by Bluetooth SIG, Inc. and any use of such marks by Munster Simms Engineering Ltd (trading as Whale) is under licence. Other trademarks and trade names are those of their respective owners.

MIRA® is a registered trade mark of Kohler Mira Limited.

TRITON® is a registered trade mark of Triton Showers a division of Norcros Group (Holdings).

REDRING® is a registered trade mark of Redring Xpelair Group Limited.

SIKA® is a registered trade mark of Dr. Siebert & Kuhn GmbH & Co. KG

GEMS® is a registered trademark of Gems Sensors & Controls.

GRUNDFOS® is a registered trademark owned by Grundfos Management A/S or Grundfos A/S, Denmark.



0345 9090 912



drainagesupport@whalepumps.com



www.whalepumps.com



@Whalecare



**Whale, 2 Enterprise Road,
Bangor, Co. Down,
BT19 7TA, N.Ireland**

Ref. 182.605_v3_0619