

# *the Toast & Melt™ Sandwich Press*

Instruction Book - LSG525/LSG545



**Breville®**



## Contents

- 2 Breville Recommends Safety First
- 6 Components
- 7 Functions
- 8 Hints & Tips
- 9 Care, Cleaning & Storage

## BREVILLE RECOMMENDS SAFETY FIRST

At Breville we are very safety conscious. We design and manufacture consumer products with the safety of you, our valued customer, foremost in mind. In addition, we ask that you exercise a degree of care when using any electrical appliance and adhere to the following precautions.

## IMPORTANT SAFEGUARDS

### READ ALL INSTRUCTIONS BEFORE USE AND SAVE FOR FUTURE REFERENCE

- Carefully read all instructions before operating the sandwich press for the first time and save for future reference.
- Remove and safely discard any packaging material and promotional stickers before using the sandwich press for the first time.
- Do not place the sandwich press near the edge of a bench or table during operation.
- Ensure that the surface is level, clean and free of water, etc.
- Keep the sandwich press clear of walls, curtains and other heat or steam sensitive materials.
- The sandwich press must be used on a properly grounded outlet. If you are not sure if the power outlets are properly grounded, please consult your electrician.
- Do not, under any circumstances, modify the power plug or use an adapter.
- Do not place the sandwich press on or near a hot gas or

- electric burner, or where it could touch a heated oven. Use the sandwich press well away from walls.
- Provide adequate space above and on all sides around the sandwich press for air circulation.
  - Do not place the sandwich press on any surface that may be affected by heat. The use of a heat resistant matt under the sandwich press is recommended on these surfaces.
  - Always operate the sandwich press on a stable and heat resistant surface. Do not use on a cloth-covered surface, near curtains or other flammable materials.
  - Do not use on a sink drain board.
  - Do not touch hot surfaces. Use the handles to lift and open the top plate. Take care when using the height-adjustable control.
  - Do not leave the sandwich press unattended when in use.
  - Do not allow the power cord to come in contact with the hot cooking plates. Ensure the power cord does not become trapped between the cooking plates during use and storage.
  - Always keep the power cord away from any heat source including the accessible surfaces of the sandwich press, and those of other appliances nearby.
  - The sandwich press is not suitable to be used in a small appliance enclosure. Ensure to leave adequate space all around the sandwich press. Minimum space of 20cm is recommended.
  - Do not place anything on top of the sandwich press when the lid is closed, during operation and when storing.
  - Always switch the sandwich press off at the power outlet, then unplug the power cord and allow to cool. Ensure the unit has cooled down before cleaning, attempting to move the appliance, disassembling, assembling and when storing the appliance
  - Do not use chemicals, steel wool, metal scouring pad, harsh abrasives, caustic cleaners or oven cleaners to clean the sandwich press as these can damage the housing or the coating of the cooking plates.
  - Always remove the food from the sandwich press with a heatproof utensil e.g., silicone spatula or tongs. Never use your hands.

- Do not use sharp objects or utensils inside the sandwich press as they may scratch or damage the surface of the cooking plates.
- The sandwich press is not intended to be operated by means of an external timer or separate remote control system.
- Do not place the sandwich press in direct sunlight. Colour fading and discolouration may occur when the sandwich press is consistently exposed to UV light.
- Keep the exterior housing and the non-stick cooking plates clean. Follow the cleaning instructions provided in this book. Refer to Care, Cleaning and Storage (Page 9).



#### CAUTION

- Do not touch hot surfaces. The accessible surfaces will be hot when the sandwich press is operating and for some time after use.



**CAUTION:** Hot Surfaces. Do not Touch.

This appliance is marked with a hot surface symbol.



#### WARNING

Fully unwind the power cord from the cord wrap on base before use.

## IMPORTANT SAFEGUARDS FOR ALL ELECTRICAL APPLIANCES

- Fully unwind the power cord before use.
- Connect only to a 230V or 240V power outlet.
- Do not let the power cord hang over the edge of a bench or table, touch hot surfaces or become knotted.
- To protect against electric shock, do not immerse the power cord, power plug or appliance in water or any other liquid or allow moisture to come in contact with the part, unless it is recommended in the cleaning instructions.
- Children should be supervised to ensure that they do not play with the appliance.
- It is recommended to regularly inspect the appliance. To avoid a hazard do not use the appliance if power cord, power plug or appliance becomes damaged in any way. Return the entire appliance to the nearest authorised Breville Service Centre for examination and/or repair.
- The appliance is not intended for use by persons

(including children) with reduced physical, sensory or mental capabilities, or lack of experience and knowledge, unless they have been given supervision or instruction concerning use of the appliance by a person responsible for their safety.

- Any maintenance other than cleaning should be performed at an authorised Breville Service Centre.
  - This appliance is for household use only. Do not use this appliance for anything other than its intended use. Do not use in moving vehicles or boats. Do not use outdoors.
- Misuse may cause injury.**
- The installation of a residual current device (safety switch) is recommended to provide additional safety protection when using electrical appliances. It is advisable that a safety switch with a rated residual operating current not exceeding 30mA be installed in the electrical circuit supplying the appliance. See your electrician for professional advice.

- During electrical storms, the appliance should be disconnected from the power source at the wall socket to prevent any electrical surges that may arise during the storm and which may inadvertently cause damage to the appliance and its electronic componentry.
- Always turn the appliance to the off position by switching off at the power outlet and unplugging from the power outlet
- Before cleaning, always turn the appliance to the off position, switch off at the power outlet, unplug at the power outlet and remove the power cord, if detachable, from the appliance and allow all parts to cool.
- Do not place this appliance on or near a heat source, such as hot plate, oven or heaters.
- Position the appliance at a minimum distance of 20cm away from walls, curtains and other heat or steam sensitive materials and provide adequate space above and on all sides for air circulation.

**FOR HOUSEHOLD USE ONLY  
SAVE THESE INSTRUCTIONS**



## Components

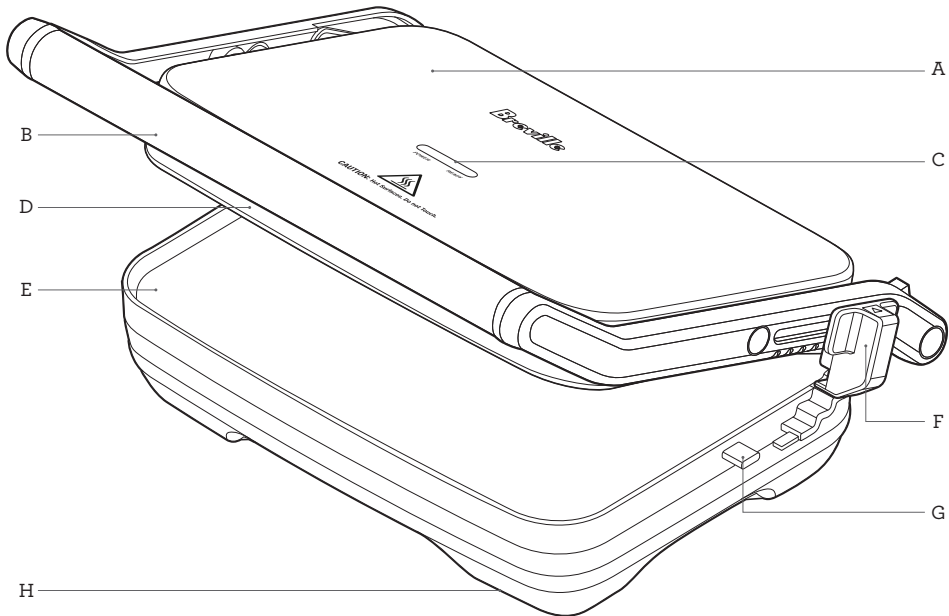

LSG525 pictured

- A. 2000W of power (LSG525)  
2200W of power (LSG545)  
For fast heat up and quick and even toasting.
- B. Heavy-duty stainless-steel arms  
For durability and strength.
- C. 'Power' and 'Ready' lights  
Indicate when the sandwich press is heating or ready to use.
- D. 'Floating hinge' top plate  
Automatically adjusts to thick or thin sandwiches.
- E. Flat, non-stick cooking plates  
Premium non-stick coating for a quick cleaning.
- F. Height-adjustable control with 4 settings (LSG525) or 7 settings (LSG545)  
To accommodate open sandwich melts, toasted sandwiches, artesian breads & wraps, and everything in between.
- G. Safety storage lock  
To lock the plates closed for upright storage.
- H. Non-slip feet with convenient cord wrap on base.



## Functions

### BEFORE FIRST USE

Remove any promotional materials and packaging materials before use. Check that the cooking plates are clean and free of dust. If necessary, wipe over the plates with a damp cloth.

### HEIGHT-ADJUSTABLE CONTROL

Your sandwich press features a height-adjustable control located on right-side arm which allows the top plate to sit one of the 4 (LSG525) or 7 (LSG545) different height positions above the bottom plate. This allows your sandwich press to be used to toast a variety of bread sizes and thicknesses, and also works for open sandwich melts (see Fig 1).

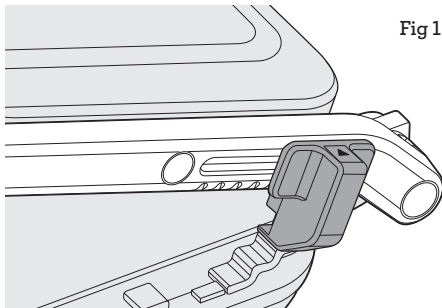

Fig 1

### TOASTED SANDWICH

1. Move the locking clip from the LOCK to OPEN position, but leave the lid closed.
2. Insert the power plug into a 230V or 240V power outlet and then turn the power ON. The orange 'POWER' light will illuminate.
3. Allow the sandwich press to pre-heat with the top cooking plate in the closed position until the green 'READY' light illuminates.

4. Whilst the sandwich press is pre-heating prepare the sandwich. When the sandwich press has pre-heated, the 'READY' light will illuminate. Open the top plate and place using the handle the sandwich onto the bottom cooking plate. Always place sandwiches towards the rear of the bottom cooking plate.
5. Adjust the height-adjustable control to the setting of choice for the sandwich being toasted. Close the top cooking plate using the handle. Do not press down. The top cooking plate has a floating hinge that is designed to evenly press down on the sandwich (see Fig 2).

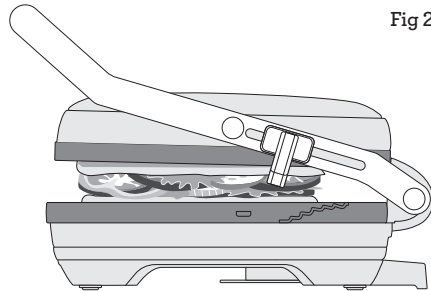

Fig 2

6. Toasting should take approximately 3-5minutes. Exact toasting time will be a matter of personal taste. It will also depend on the type of bread and filling used.
7. When the sandwich is cooked, use the handle to raise the top cooking plate. Remove the sandwich with the help of a plastic, silicone or wooden spatula. Never use metal tongs or a knife as these can cause damage to the non-stick coating.
8. When finished using, turn the sandwich press off at the power outlet and allow to cool before cleaning. See cleaning instructions found in this book.



## NOTE

- Always allow the sandwich press to pre-heat until the green 'READY' light illuminates.
- The safety storage lock should not be used to clamp down the top cooking plate when the sandwiches are in the sandwich press. The weight of the top cooking plate will gradually press down the sandwich during the cooking process.
- When using the sandwich press for the first time you may notice a fine smoke haze. This is caused by the heating of some of the components. There is no need for concern.



## WARNING



**CAUTION: Hot Surfaces. Do not Touch.**

**HOT SURFACE** - The accessible surfaces will be hot when the sandwich press is operating and for some time after use.



## NOTE

Fully unwind the cord from the cord wrap on the base before use.

## OPEN MELT SANDWICH

1. Unlock the sandwich press and turn on at the power outlet. Allow the sandwich press to pre-heat until the green 'READY' light illuminates.
2. Open the top plate using the handle and place the open sandwich with topping to be melted on the bottom plate.
3. Move the height-adjustable control to a higher height whereby the top plate sits above, but not touching the sandwich.
4. Slowly lower the top plate until it rests on the height-adjustable control.
5. The top plate will radiate the heat to melt ingredients for the open melt, such as cheese.
6. Toasting melts should take approximately 6-8minutes, however, exact toasting time will vary depending on the toppings used.



## Hints & Tips

### BREAD

Most types of bread can be used; white, wholemeal, wholegrain, raisin loaf and so on. The sandwich press is also ideal for toasting artisan breads such as focaccia, Turkish bread, baguettes as well as bread rolls. Raisin bread, brioche or other sweet breads which contain a higher sugar content will tend to brown quicker.

### FILLINGS

If using fruit as a filling, try to use canned or pre-cooked fruit as fresh fruit may produce excessive liquid during cooking. Be careful when biting into sandwiches that contain fillings such as cheese and tomato or jam as they retain heat and may cause harm if eaten too quickly.

### FAT-FREE TOASTING

Due to the non-stick flat plate design, it is not necessary to use butter or margarine on the outside of your toasted snacks.





## Care, Cleaning & Storage

Before cleaning, ensure the power is switched off and then remove the power plug from the power outlet.

Allow your sandwich press to mostly cool before cleaning however, the sandwich press is easier to clean when still slightly warm.

Always clean your sandwich press after each use to prevent a build-up of baked-on foods.

Wipe cooking plates with a soft, damp cloth to remove food residue.



### WARNING

Do not immerse any part of the Breville sandwich press or the power cord in the dishwasher, in water or in any other liquid.

### PFOA-FREE NON-STICK COATING

Cooking on a non-stick surface minimises the need for oil as food does not stick and cleaning is easier. Any discolouration that may occur will only detract from the appearance of the sandwich press and will not affect the cooking performance. When cleaning the non-stick coating, do not use metal (or other abrasive) scourers. Wash with warm soapy water and dry thoroughly. Remove stubborn residue using a damp cloth.

### SEASON THE PLATES

Seasoning the plates occasionally, although not necessary, may help to prevent sticking and to make cleaning easier. To season, brush the cooking plates with a little vegetable oil and rub off the excess with absorbent paper. Do this after preheating the unit.



### NOTE

The cooking plates and hinges are coated with a non-stick surface; do not use abrasive cleansers or scourers.



### WARNING

Allow the unit to cool down before attempting to move.

### STORAGE

To store your sandwich press:

1. Switch off at power outlet and unplug power cord from the wall.
2. Allow the sandwich press to mostly or fully cool, then clean as directed.
3. For storing, lock the cooking plates together by sliding the height-adjustable control to the front LOCK position (see Fig 3).

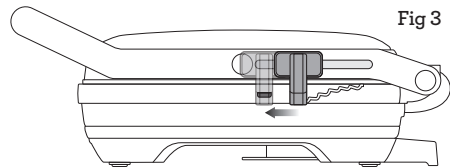

Fig 3

4. Wrap the power cord in the cord storage area on the base (see Fig 4).

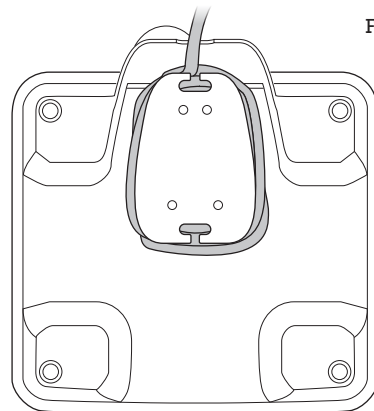

Fig 4

5. Store on a flat, dry, level surface. The sandwich press is designed to be stored standing on its edge for space saving.



## NOTE

The storage lock should not be used to clamp down the top plate when sandwiches are in the sandwich press.



## WARNING

Do not immerse any part of your sandwich press or the power cord in water or any other liquid.



Notes

## Breville Customer Service Centre

### **Australian Customers**

**Phone:** 1300 139 798

**Fax:** (02) 9700 1342

**Web:** [www.breville.com](http://www.breville.com)

### **New Zealand Customers**

**Phone:** 0800 273 845

**Fax:** 0800 288 513

**Web:** [www.breville.com](http://www.breville.com)

# **Breville®**

**Master Every Moment™**

Breville, the Breville logo, Master Every Moment and Toast & Melt are registered trademarks of Breville Pty. Ltd. A.B.N. 98 000 092 928.  
Copyright Breville Pty. Ltd. 2022.

Due to continued product improvement, the products illustrated/photographed in this booklet may vary slightly from the actual product.

LSG525/LSG545 A22