



The Smart Choice for UPS Protection

Tripp Lite SmartPro and SmartOnline UPS

Systems offer the most reliable and cost-efficient solutions available for protecting and supporting mission-critical equipment in any environment.

Tripp Lite's superior-quality products, unmatched customer support and 80-year service history have built a trusted reputation for reliability among network managers worldwide.



Index Select the perfect UPS system by operation or application

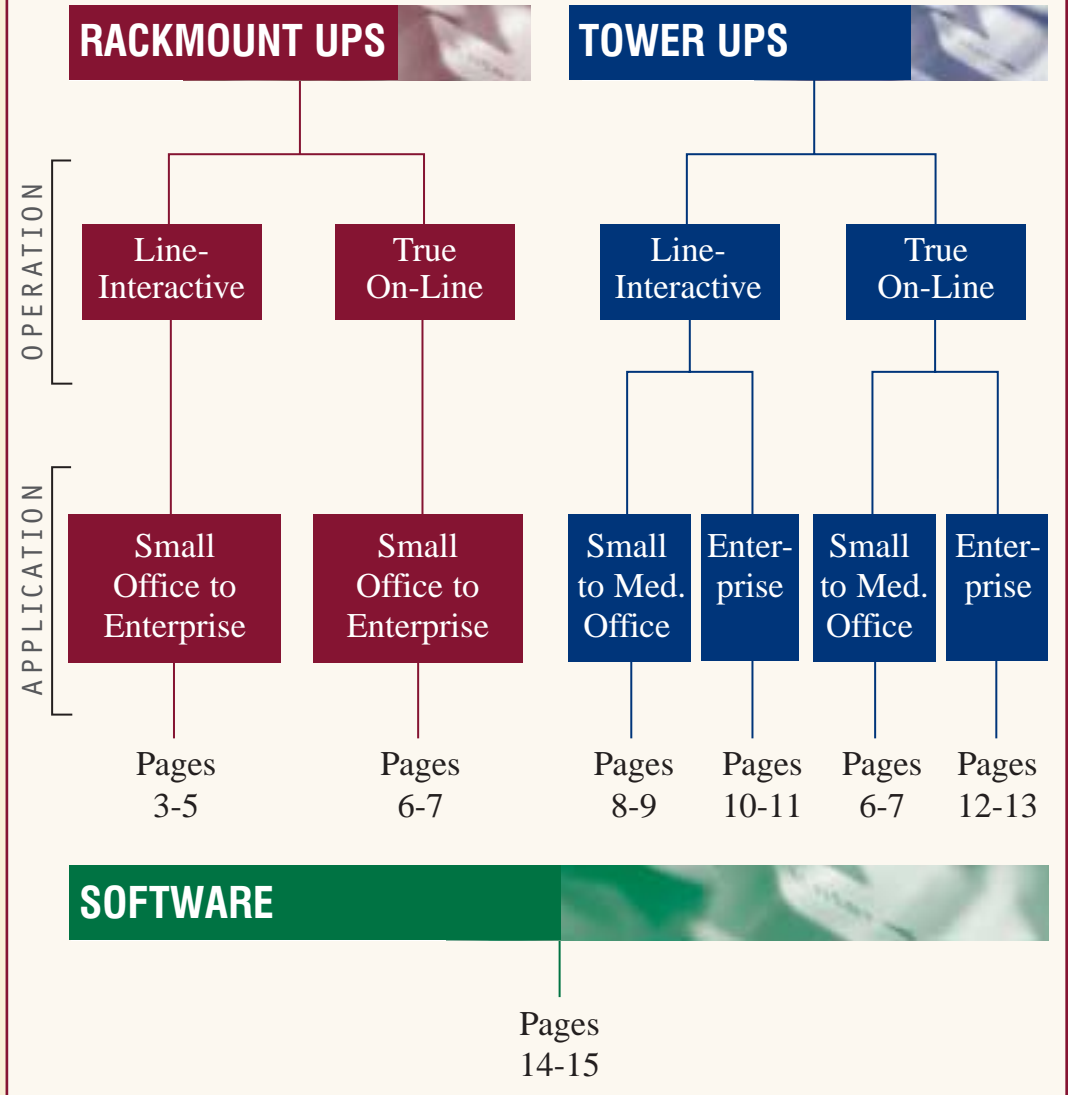

Protect and Support Mission-Critical Equipment . . .

. . . More Reliably

Tripp Lite UPS Systems ensure the 100% availability of your mission-critical systems and continued productivity of your business:

- Support your system longer with more extended runtime options
- Include superior power management software that allows you to control any UPS, regardless of brand

. . . In Less Space

Tripp Lite UPS Systems feature greater power density (packing more VA capacity into smaller cabinets) conserving valuable rackmount or server room space:

- Occupy less "U" rack spaces (rackmount)
- Occupy less floor or desk space (tower)

. . . For Less Money

Tripp Lite UPS Systems reduce your initial investment and speed your payback period by including premium features often offered as expensive extras on competitors' UPS systems:

- Save hundreds of dollars in accessory costs by providing more communication ports, more outlet configurations and individually controllable outlets on select models

SmartPro®

Intelligent Line-Interactive UPS Systems



SMART1000RM1U



SMART3000RM2U *Optional black bezel available.*



SMART5000RT3U *Optional black bezel available.*

- ▶ 450 – 5,000 VA
- ▶ Extended Runtime Options

On-line solutions? See pages 6 - 7.

Application:

SMALL OFFICE to ENTERPRISE

Conserve Space—Slim as 1U!

New Tripp Lite SmartPro Slim Rackmount UPS Systems make the best use of available rack space by providing more battery backup (up to 5000VA) and premium product features in a compact case—as slim as 1U! Select models are compact and shallow enough to allow users to mount two UPS systems (or a UPS and external battery pack) back-to-back to double the power protection in the same rack space.

Protect Every Application

Whatever your application, there's a SmartPro Slim Rackmount solution designed for you—from 450VA models to protect hubs, routers and internetworking equipment to 5000VA models to protect critical servers and telecom equipment. SmartPro Rackmount UPS Systems offer everything you need to protect rackmount equipment in a single box. SmartPro provides complete protection against all types of power problems (brownouts blackouts, surges and line noise).

Line-interactive operation—also known as automatic voltage regulation (AVR)—supports your equipment during brownouts.* SmartPro UPS Systems provide reliable battery power to keep networks up safely through short blackouts and allow enough time to safely shut down during longer ones. In addition, all AC outlets stop damaging lightning and surges and filter disruptive line noise, guaranteed with up to \$50,000 Ultimate Lifetime Insurance.

* SMART700RM1U and SMART1000RM1U models supply battery power during brownouts.

Protect Telecom Applications

Protect large 208V telecom equipment and servers with a specially designed SmartPro Rackmount UPS System—SMART5000TEL3U. The SMART5000TEL3U allows you to power and protect multiple pieces of high-voltage equipment from a single 208V circuit. In addition, the SMART5000TEL3U features two 120V receptacles which supply up to 400VA of battery power, plenty of runtime to support the low-power monitors and peripherals which serve the high-voltage equipment.

Control Individual Outlets

Prioritize the uptime of your most mission-critical loads during a power failure. Select models feature special receptacles that you control independently through PowerAlert Software. Program PowerAlert to reboot a locked up computer or to shut down less important systems, preserving battery runtime for more critical equipment.

Additional SmartPro features: see pages 4 and 5.



3000VA UPS (front) and extended run external battery pack (rear)—only 2U

A W A R D - W I N N I N G T R I P P L I T E R E L I A B I L I T Y



"I found Tripp Lite's product quality and customer support to be head-and-shoulders above the field."
Kraft Foods Alane Watkins, Systems Administrator



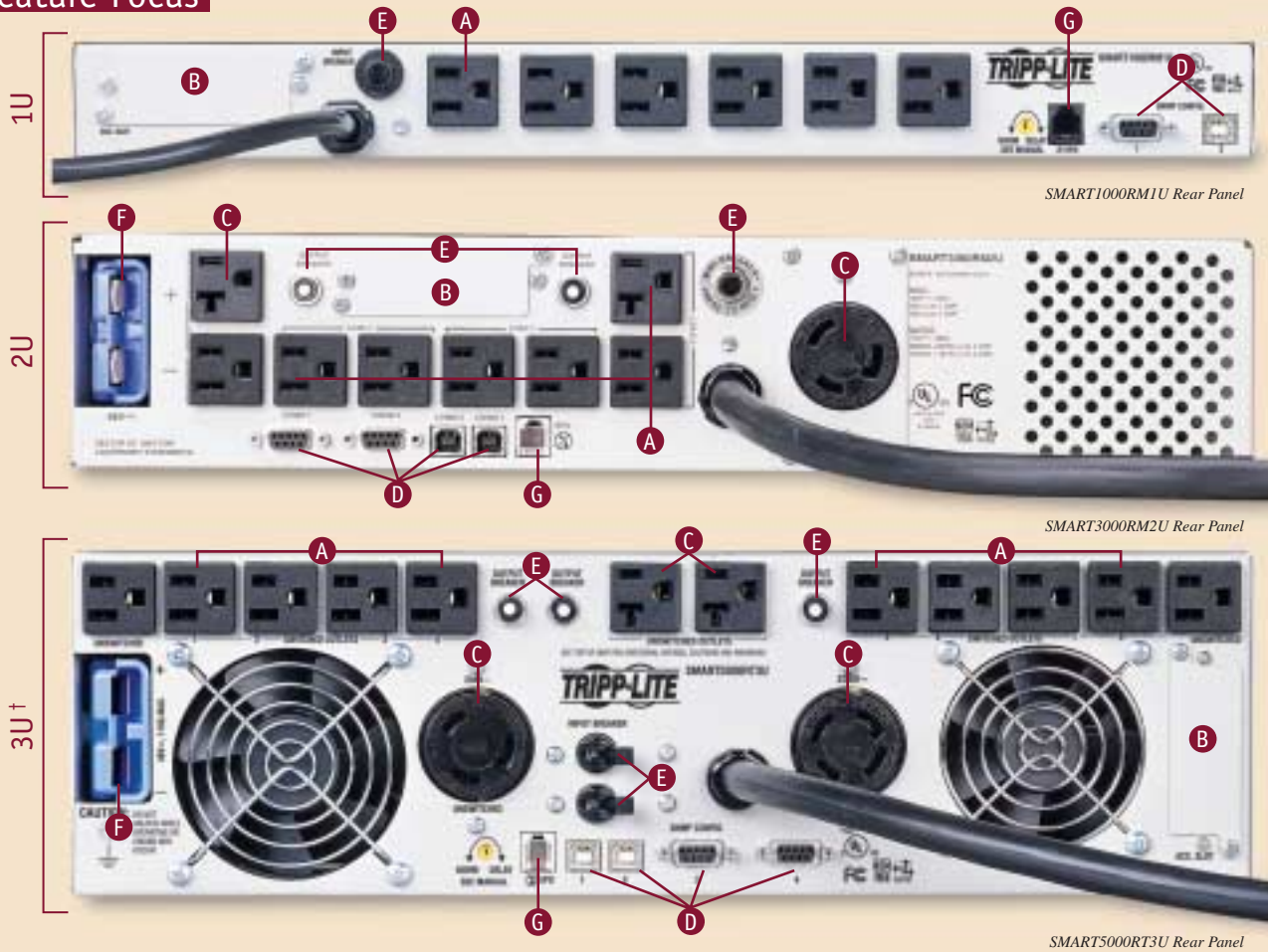

A Customized Load Management
Prioritize the uptime of your most mission-critical loads during a power failure. Select models feature special receptacles that you control independently through PowerAlert Software. Program PowerAlert to reboot a locked up computer or to shut down less important systems, preserving battery runtime for more critical equipment.

B NMS Integration
Accessory slot on all Slim Rackmount models accepts optional internal SNMP/Web Card* for remote shutdowns, reboots and more. Use card with optional environmental sensor** to remotely monitor environmental conditions (temperature and humidity) or to control and monitor alarm/security systems. Dry contact interface works with most alarm, security and telecom devices.

* Model: SNMPWEBCARD. ** Model: ENVIROSENSE.

C Variety of Output Options
15-, 20- and 30-amp receptacles on select models ensure maximum connection flexibility.

D Multiple Server Support
Up to four built-in communication ports on select models simultaneously provide shutdown commands and reporting on multiple servers without the need for costly accessories.

Up to 17 Performance Conditions Displayed



Front panel LEDs alert you to 17 separate performance conditions, including battery charge, AC line voltage, automatic voltage regulation, UPS load, replace battery and line fault.

E Short Circuit Protection
Breakers safeguard your equipment and the UPS from damage due to input/output short circuits.

F Expandable Battery Capability
Select models feature connectors to accept optional external battery packs for additional runtime. See Extended Runtime Chart on page 5 to locate the perfect SmartPro model that fits your runtime needs.

G Emergency Power Off
RJ11 modular jack on select models allows remote emergency shutdown.

Convenient Front Panel Battery Replacement

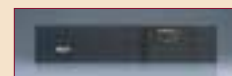

Tripp Lite UPS batteries will constantly protect your equipment for

up to six years with normal use. Removable front panel access saves the hassle of uninstalling and returning the UPS for battery replacement and service. Optional black bezel available.

† Rack space occupied by SMART5000RT3U power module only. Requires installation of BP48V60RT-3U external battery pack, included, which occupies an additional 3U rack space.

Adapt to Tower or Rackmount



Adapt select models* from rackmount to stack, wallmount or tower applications. Included brackets conveniently mount these UPS on a wall, in a rack enclosure or under a counter.

- Removable rack hardware
- Optional base stands
- Optional black bezel available

*SMART450RT, SMART1400RM2U, SMART2200RM2U and SMART3000RM2U.

Manage Up to 4 Servers

Manage up to four servers simultaneously at no extra cost with multiple built-in communication ports. Using PowerAlert Software, SmartPro Rackmount UPS Systems will simultaneously provide intelligent communication, shutdown commands and reporting on up to four servers even if they are running different operating systems.*

* Additional PowerAlert features: pages 14 and 15.

Extend Runtime

Without enough runtime, you stand to lose up to \$50,000 per hour according to a recent Yankee Group survey on the cost of lost productivity for an hour of network downtime. Select SmartPro Slim Rackmount models accept additional external battery packs to provide all the runtime you need!*

* Additional Extended-Run solutions up to 10kVA are available: pages 6 – 7 (rackmount); pages 10 – 13 (tower).



Extending runtime is as simple as plugging in additional external battery packs

Load (VA/Watts)	Runtime (minutes) with included batteries*	Runtime (minutes) with additional external battery packs				
		BP48V24-2U Battery** 1	BP48V60RT-3U Battery**			
			1	2	3	4
SMART1400RMXL2U Extended Runtime						
700/490	30	122	264	530	773	1025
1400/940	12	55	130	272	399	531
SMART2200RM2U Extended Runtime						
1100/770	20	73	167	343	502	667
2200/1600	8	28	74	165	243	328
SMART3000RM2U Extended Runtime						
1500/1125	13	49	119	252	369	494
3000/2250	4	10	34	93	139	184
SMART5000RT3U Extended Runtime						
2500/1750	38	N/A	86	138	195	240
5000/3500	16	N/A	36	64	86	109

* SMART5000RT3U models do not include internal batteries; they include an external battery pack, standard.
 ** BP48V24-2U is not expandable; BP48V60RT-3U is expandable (allowing multiple cabinets to be connected together).

Call Tripp Lite's Application Specialists at (773) 869-1236 for additional extended runtime solutions to fit your specific load requirements.

Model	Output Capacity (VA/Watts)	Backup Time (Typical Minutes) Half/Full Load*	Rack Space	Input/Output Voltage/Frequency (Hz)	AC Receptacles		Customized Load Management Receptacles	"Smart" Communication Ports		Input Plug (NEMA)	Power Cord Length (ft)	Dimensions H x W x D (in)***	Shipping Weight (lb)
					Quantity	NEMA Type		RS-232 (DB9)	USB (B)				

Slim Rackmount UPS Systems

SMART450RT	450/270	14/4	1U	120 (60)	5**	5-15R	–	1	–	5-15P	6	1.75 x 17 x 11	18.5
SMART700RM1U	700/450	18/7	1U	120 (60)	6	5-15R	–	1	–	5-15P	10	1.75 x 17 x 16	23
SMART1000RM1U	1000/700	13/5	1U	120 (60)	6	5-15R	1 single	1	1	5-15P	10	1.75 x 17 x 16	25
SMART1400RM2U	1400/940	30/12	2U	120 (60)	8	5-15R	1 single	1	1	5-15P	10	3.5 x 17 x 15.5	49
SMART1400RMXL2U	1400/940	30/12+	2U	120 (60)	8	5-15R	2 single	2	2	5-15P	10	3.5 x 17 x 15.5	57
SMART2200RM2U	2200/1600	20/8+	2U	120 (60)	8	6 (5-15R), 2 (5-20R)	3 pairs	2	2	5-20P	10	3.5 x 17 x 15.5	59
SMART3000RM2U	3000/2250	13/4+	2U	120 (60)	9	6 (5-15R), 2 (5-20R), 1 (L5-30R)	3 pairs	2	2	L5-30P	10	3.5 x 17 x 15.5	61
SMART5000RT3U	5000/4000	38/16+	3U (power module) & 3U (battery pack)	208/240 (In); 208 & 120 (Out) (60)	14	10 (5-15R), 2 (5-20R), 1 (L6-30R), 1 (L14-30R)	8 single	2	2	L6-30P	10	5.25 x 17.5 x 22.5 (power module) & 5.25 x 17.5 x 22.5 (battery pack)	121 (power module) & 170 (battery pack)
SMART5000TEL3U	5000/3750	16/6	3U (including internal batteries)	208/240 (In); 208 & 120 (400VA max.) (Out) (60)	5	2 (5-15R), 2 (L6-20R), 1 (L6-30R)	2 single	2	2	L6-30P	10	5.25 x 17 x 22.5	85

Model	Output Capacity (VA/Watts)	Backup Time (Typical Minutes) Half/Full Load*	Rack Space	Input/Output Voltage/Frequency (Hz)	AC Receptacles		Customized Load Management Receptacles	Communication Ports		Input Plug (NEMA)	Power Cord Length (ft)	Dimensions H x W x D (in)***	Shipping Weight (lb)
					Quantity	NEMA Type		"Smart" RS-232 (DB9)	Contact Closure (DB9)				

Rackmount UPS Systems

SMART700RM	700/450	28/12	3U	120 (60)	8	5-15R	–	1	–	5-15P	6	5.25 x 15.75 x 10.5	32
SMART1050RM	1050/680	23/8	3U	120 (60)	8	5-15R	–	1	–	5-15P	6	5.25 x 15.75 x 10.5	38
SMART1400RM	1400/940	26/10	3U	120 (60)	8	5-15R	1	1	1	5-15P	6	5.25 x 15.75 x 10.5	43
SMART2200RM	2200/1700	29/13+	4U	120 (60)	8	5-15R	2	1	2	5-15P	8	7 x 14.75 x 17.75	96
SMART2200RMXL	2200/1700	29/13+	4U	120 (60)	8	6 (5-15R), 2 (5-20R)	2	1	2	5-20P	8	7 x 14.75 x 17.75	104
SMART3000RM	3000/2400	23/7+	4U	120 (60)	8	4 (5-15R), 4 (5-20R)	2	1	2	L5-30P	8	7 x 14.75 x 17.75	105

External Battery Packs

BP48V24-2U	48V standard run external battery pack and cables, 2U rack space (for SMART1400RMXL2U, SMART2200RM2U and SMART3000RM2U models)											3.5 x 17.25 x 12.75	70
BP48V60RT-3U	48V extended run external battery pack and cables, 3U rack space, rack/tower mount (for SMART1400RMXL2U, SMART2200RM2U, SMART3000RM2U and SMART5000RT3U models)											5.25 x 17.5 x 22.5	170
BP24V33	24V standard run external battery pack and cables, tower mount. Requires BP-RM to rackmount (for SMART2200RM, SMART2200RMXL and SMART3000RM models)											8 x 11.5 x 13	66

Accessories

PAM1	Power accessory module for SMART5000RT3U (provides a variety of outlet configurations including 20- and 30-amp twist lock)												8
BP-RM	5U rackmount shelf. Holds BP24V33 battery pack											8.75 x 19 x 13.5	7
SNMPWEBCARD	Internal SNMP/Web management accessory card (connects all Slim Rackmount UPS systems to Ethernet)												
ENVIROSENSE	Allows UPS to monitor external temperature/humidity and contact-closure inputs (requires SNMPWEBCARD)												
2USTAND	Tower kit with 2 base stands (for SMART1400RM2U, SMART1400RMXL2U, SMART2200RM2U and SMART3000RM2U models)												

+ Backup times are expandable using external battery packs. * Backup times will vary depending on battery condition and load. ** Includes 1 "surge-only" receptacle to protect printers, scanners or other peripherals that do not require battery backup. *** All models are designed with mounting hardware to fit standard 19 in. racks. Model widths are for the UPS case only, without mounting hardware. The policy of Tripp Lite is one of continuous improvement. Specifications are subject to change without notice.

Complete 230 Volt model line and detailed 120 Volt specifications available: www.tripplite.com/info/smart

SmartOnline™

Intelligent True On-Line UPS Systems



SU2200RT2U



SU3000RT3U

Application:

SMALL OFFICE to ENTERPRISE

Deliver True On-Line Operation

SmartOnline UPS Systems provide mission-critical equipment with the highest level of power protection for rackmount systems. Dual-conversion technology continually converts incoming AC power into filtered DC power, and then resynthesizes it back into AC power with a pure sine wave. Constant on-line operation completely isolates sensitive equipment from every power problem on the AC line. SmartOnline models accept the widest range of incoming voltage and frequency variations, generating the most consistently pure AC power ($\pm 2\%$ V and ± 0.2 Hz).

SmartOnline UPS Systems provide reliable battery power to keep networks up safely through short blackouts and allow enough time to safely shut down during longer ones.

In addition, all AC outlets stop damaging lightning and surges and filter disruptive line noise, guaranteed with up to \$100,000 Ultimate Lifetime Insurance.

Control Individual Outlets

Prioritize the uptime of your most mission-critical loads during a power failure. Select models feature special receptacles that you control independently through PowerAlert Software. Program PowerAlert to reboot a locked up computer or to shut down less important systems, preserving battery runtime for more critical equipment.

Manage Multiple Servers

Manage up to two servers simultaneously at no extra cost with multiple built-in communication ports. Using PowerAlert Software, SmartOnline UPS Systems will simultaneously provide intelligent communication, shutdown commands and reporting on up to two servers—even if they are running different operating systems.*

* Additional PowerAlert features: pages 14 and 15.

TRUE ON-LINE

- ▶ 1,000 – 6,000 VA
- ▶ Extended Runtime Options

On-line solutions to 10kVA? See pages 12 and 13.



September 25, 2001
Tripp Lite UPS System
Model: SU2200RT2U

"After weeks of testing, we favored the Tripp Lite SmartOnline 2200 Rack/Tower 2U, which incorporates all the features you could want at an astonishingly low price. For just \$1,100 (street), you get the power you need—2.2 kVA—in a slim rackmount package that does not compromise serviceability. Best of all, the software package is one of the most versatile we tested."

PC Magazine Editor's Choice Award Logo is a trademark of Ziff Davis Publishing Holdings Inc. Used under license.

Adapt to Tower or Rackmount

Adapt select models from rackmount to stack or tower applications. Included base stands transform select SmartOnline models into slim tower models.

- Removable rack hardware
- Included base stands



Optional tower mount

A W A R D - W I N N I N G T R I P P L I T E R E L I A B I L I T Y



"All of our Tripp Lite products have performed flawlessly."
Movie Gallery Ben Harris, System Administrator



Feature Focus



A Customized Load Management

Independently control special receptacles through PowerAlert Software, shutting down less important systems first, preserving battery runtime for more critical equipment.

B NMS Integration

Accessory slot accepts an optional internal SNMP/Web card* for remote shutdowns, reboots and more. Use card with optional environmental sensor** to remotely monitor environmental conditions or to control alarm/security systems.

*Model: SNMPWEBCARD. ** Model: ENVIROSENSE.

C Variety of Output Options

15-, 20- and 30-amp receptacles ensure maximum connection flexibility. Optional step-down transformer provides 120 volt power from SU6000RT3U models.

D Multiple Server Support

Up to two built-in communication ports on select models simultaneously provide shutdown commands and reporting on multiple servers.

E Expandable Battery Capability

All models feature connectors to accept optional external battery packs for additional runtime.

F Short Circuit Protection

Critical Performance Conditions Displayed (not shown)

Front panel LEDs or digital LCD display alert you to battery charge, AC line voltage, UPS load, replace battery, line fault and more.

Emergency Power Off Jack (not shown)

SU6000RT3U models allow remote shutdown.

Convenient Front Panel Battery Replacement (not shown)

SU1000RT2U, SU2200RT2U and SU3000RT3U feature a convenient front access door.

Extend Runtime

Without enough runtime, you stand to lose up to \$50,000 per hour according to a recent Yankee Group survey on the cost of lost productivity for an hour of network downtime. SmartOnline models accept external battery packs to provide all the additional runtime you need!*

* Extended-run on-line solutions up to 10kVA are available on pages 12 – 13.

Load (VA/Watts)	Runtime (minutes) with included batteries*	Runtime (minutes) with additional external battery packs				
		1	2	3	4	5
SU1000RT2U Extended Runtime (with BP36V14-2U battery pack)						
500/400	18	89	163	237	313	388
1000/800	6	37	74	110	150	189
SU2200RT2U Extended Runtime (with BP72V12-2U battery pack)						
1100/800	18	51	103	140	190	322
2200/1600	6	14	39	53	81	143
SU3000RT3U Extended Runtime (with BP72V12-2U battery pack)						
1500/1050	17	37	63	86	109	128
3000/2100	6	17	28	37	48	63
SU6000RT3U Extended Runtime (with BP240V7RT3U battery pack)						
3000/2100	24	57	90	118	165	195
6000/4200	10	24	40	57	73	90

*SU6000RT3U models do not include internal batteries; they include an external battery pack, standard.
Call Tripp Lite's Application Specialists at (773) 869-1236 for additional extended runtime solutions to fit your specific load requirements.

Model	Output Capacity (VA/Watts)	Backup Time (Typical Minutes) Half/ Full Load*	Rack Space	Input/ Output Voltage/ Frequency (Hz)	Quantity	AC Receptacles NEMA Type	Customized Load Management Receptacles	Communication Ports "Smart" RS-232 (DB9)	Contact Closure (DB9)	Input Plug (NEMA)	Power Cord Length (ft)	Dimensions H x W x D (in)***	Shipping Weight (lb)
UPS Systems													
SU1000RT2U	1000/800	18/6+	2U	120 (50/60)	6	5-15R	6	1	-	5-15P	10	3.5 x 17.5 x 17	62
SU2200RT2U	2200/1600	18/6+	2U	120 (50/60)	6	4 (5-15R), 2 (5-20R)	6	1	-	5-20P	10	3.5 x 17.5 x 26	99
SU3000RT3U	3000/2100	17/6+	3U	120 (50/60)	9	4 (5-15R), 4 (5-20R), 1 (L5-30R)	8	1	1	L-5-30P	10	5.2 x 17.3 x 20.1	87
SU6000RT3U	6000/4200	24/10+	3U (power module) & 3U (battery pack)**	200/208/ 220/ 230/240 (50/60)	Hardwire	Hardwire	-	1	1	Hardwire	Hardwire	5.25 x 17.5 x 22.75 (power module) & 5.25 x 17.5 x 22.75 (battery pack)	58 (power module) & 170 (battery pack)
External Battery Packs and Accessories													
BP36V14-2U	36V external battery pack and cables, 2U rack space (for SU1000RT2U model only)											54	
BP72V12-2U	72V external battery pack and cables, 2U rack space (for SU2200RT2U and SU3000RT3U models only)											59	
BP240V7RT3U	240V external battery pack and cables, 3U rack space (for SU6000RT3U model only)											170	
ENVIROSENSE	Allows UPS to monitor external temperature/humidity and contact-closure inputs (requires SNMPWEBCARD)												
SNMPWEBCARD	Internal SNMP/Web management accessory card (connects UPS systems to Ethernet)												
SU6000XFMRRRT3U	Step-down transformer for SU6000RT3U model only. 3U rackmount. 200-240V hardwire input. 120 & 240V hardwire output											120	

+ Backup times are expandable using external battery packs. * Backup times will vary depending on battery condition and load. ** SU6000RT3U models feature a separate 3U rackmount power module and 3U rackmount battery module (included). *** All models are designed with mounting hardware to fit standard 19 in. racks. Model widths are for the UPS case only, without mounting hardware. The policy of Tripp Lite is one of continuous improvement. Specifications are subject to change without notice.

Complete 230 Volt model line and detailed 120 Volt specifications available: www.tripplite.com/info/smart

SmartPro® USB, NET & XL

Intelligent Line-Interactive UPS Systems



- ▶ 500 – 5,000 VA
- ▶ Extended Runtime Options

Rackmount solutions? See pages 3 – 5.

Application:

SMALL to MEDIUM OFFICE

Match Every Installation Size

Whatever size network environment you manage, the SmartPro family of UPS systems has the perfect power protection solution. From a single server in small-office/home-office environments to multiple servers in large departmental and telecom installations, choose SmartPro to protect your computer investment and maintain your productivity.

Offer Plenty of Room to Grow

As your network grows, SmartPro UPS Systems provide plenty of protected AC outlets and VA capacity to accommodate your entire system. Included PowerAlert Software and cabling provide additional flexibility as you add diverse servers, operating systems and UPS systems. PowerAlert supports all major operating systems and controls every UPS system, regardless of manufacturer.*

* Additional PowerAlert features: pages 14 and 15.

Protect Every Application

SmartPro UPS Systems offer everything you need to protect servers in a single box. SmartPro provides complete protection against all types of power problems (brownouts, blackouts, surges and line noise).

Prolonged exposure to fluctuating voltage levels can degrade electronic equipment over time. SmartPro UPS Systems feature a built-in microprocessor to monitor incoming voltage and adjust it when necessary to provide connected equipment with nominal computer-grade AC power. Line-interactive operation—also known as automatic voltage regulation (AVR)—keeps network equipment working through low voltage (brownouts) and high voltage indefinitely, without draining battery power. SmartPro UPS Systems provide reliable battery power to keep networks up safely through short blackouts and allow enough time to safely shut down during longer ones. In addition, all AC outlets stop damaging lightning and surges and filter disruptive line noise, guaranteed with up to \$50,000 Ultimate Lifetime Insurance.

Control Individual Outlets

Prioritize the uptime of your most mission-critical loads during a power failure. Select models feature special receptacles that you control independently through PowerAlert Software. Program PowerAlert to reboot a locked up computer or to shut down less important systems, preserving battery runtime for more critical equipment.

Manage Up to 4 Servers

Manage up to four servers simultaneously at no extra cost with multiple built-in communication ports. Using PowerAlert Software, SmartPro UPS Systems will simultaneously provide intelligent communication, shutdown commands and reporting on up to four servers even if they are running different operating systems. Many competitive manufacturers offer multiple server control only by adding expensive accessories.



"I can't say enough good things about Tripp Lite UPS Systems."
Ameritech Small Business Division Dan Erhart, Account Executive



Feature Focus

Customized Load Management

Prioritize the uptime of your most mission-critical loads during a power failure. Select models feature special receptacles that you control independently through PowerAlert Software. Program PowerAlert to shut down less important systems first, preserving battery runtime for more critical equipment.

Multiple Server Control

Up to four built-in communication ports on select models simultaneously provide shutdown commands and reporting on multiple servers without the need for costly accessories.

Expandable Battery Capability

Select models feature connectors to accept optional external battery packs for additional runtime.

Variety of Output Options

15- 20- and 30-amp receptacles ensure maximum connection flexibility.

NMS Integration

Accessory slot on SMART2200, SMART3000, SMART5000RT3U and SMART5000TEL3U models accepts optional internal SNMP/Web Card* for remote shutdowns, reboots and more. Use card with optional environmental sensor** to remotely monitor environmental conditions or to control alarm/security systems. Dry contact interface works with most alarm, security and telecom devices.

* Model: SNMPWEBCARD. ** Model: ENVIROSENSE.

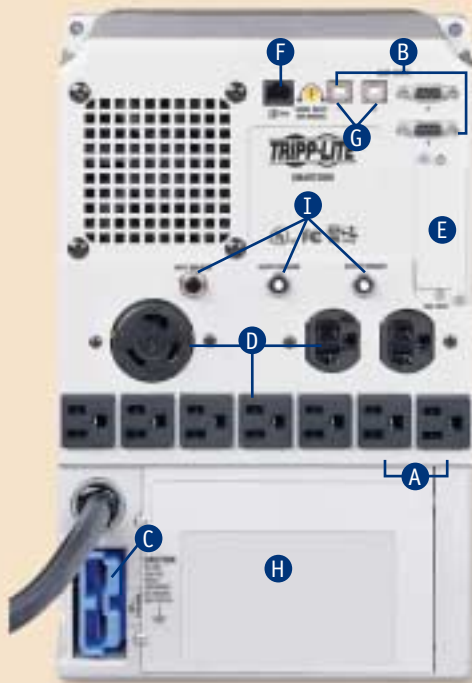

SMART3000 Rear Panel

F Emergency Power Off

RJ11 modular jack on SMART2200, SMART3000, SMART5000RT3U and SMART5000TEL3U models allows remote emergency shutdown.

G USB Support

Select models include built-in USB ports to provide shutdown commands and reporting on USB computers without the need for costly accessories.

H Convenient Battery Replacement

Tripp Lite UPS batteries will constantly protect your equipment for up to six years with normal use. The convenient access door saves the hassle of returning the UPS for battery replacement and service.

I Short Circuit Protection

Up to 17 Separate Performance Conditions Displayed



Front panel LEDs alert you to 17 separate performance conditions, including battery charge, AC line voltage, automatic voltage regulation, UPS load, replace battery and line fault.

Modem/Fax Surge Protection (not shown)

SMART500USB and SMART700USB include built-in RJ11 jacks to protect computers connected to the Internet against surge damage.

Dedicated Peripheral Protection (not shown)

SMART500USB and SMART700USB feature three unique "surge-only" outlets, protecting all your equipment (including peripherals) with one UPS.

Extend Runtime

Without enough runtime, you stand to lose up to \$50,000 per hour according to a recent Yankee Group survey on the cost of lost productivity for an hour of network downtime. Select models accept external battery packs to provide all the additional runtime you need!

Load (VA/Watts)	Runtime (minutes) with included batteries	Runtime (minutes) with additional external battery packs				
		1	2	3	4	5
SMART1400XL Extended Runtime (with BP36V27 battery pack)						
700/490	25	117	224	333	446	557
1400/940	10	55	108	170	226	282
SMART2200 and SMART3000 Extended Runtime (with BP48V24 battery pack)						
1000/700	29	176	323	469	616	763
1400/980	20	120	220	320	420	520
2200/1600	11	66	121	176	231	286
3000/2250	6	36	66	96	126	156

Call Tripp Lite's Application Specialists at (773) 869-1236 for additional extended runtime solutions to fit your specific load requirements.

Model	Output Capacity (VA/Watts)	Backup Time (Typical Minutes) Half/Full Load*	Input/Output Voltage/Frequency (Hz)	AC Receptacles Quantity	NEMA Type	Customized Load Management Receptacles	Modem/Fax Port (RJ11)	Communication Ports "Smart" RS-232 (DB9) or USB (B)	Contact Closure (DB9)	Input Plug (NEMA)	Power Cord Length (ft)	Dimensions H x W x D (in)	Shipping Weight (lb)
UPS Systems for Small-Office/Home-Office Workstation or Server													
SMART500USB	500/300	17/5	120 (60)	6	3 UPS/3 surge-only, 5-15R	—	1-line	1 (USB)**	—	5-15P	6	8.25 x 4.75 x 7	15.5
SMART700USB	700/450	17/5	120 (60)	6	3 UPS/3 surge-only, 5-15R	—	2-line	1 (USB)**	—	5-15P	6	10.25 x 4.75 x 7	20.5
SMART700	700/450	20/6	120 (60)	6	5-15R	—	—	1 (DB9)	—	5-15P	6	11.75 x 7 x 7.25	24
UPS Systems for Departmental Server													
SMART1050	1050/680	23/8	120 (60)	6	5-15R	—	—	1 (DB9)	—	5-15P	6	11.75 x 7 x 7.25	34
SMART1400	1400/940	25/10	120 (60)	6	5-15R	1	—	1 (DB9)	1	5-15P	6	12.5 x 7.5 x 8.75	48
SMART1400XL	1400/940	25/10+	120 (60)	6	5-15R	1	—	2 (DB9)	—	5-15P	6	12.5 x 7.5 x 8.75	51
UPS Systems for Multiple Servers in Large Departmental/Telecom Installations													
SMART2200	2200/1600	23/11+	120 (60)	9	7 (5-15R); 2 (5-20R)	2	—	2 (DB9) & 2 (USB)	—	5-20P***	8	14.12 x 9.12 x 11.52	57
SMART2200XLNET	2200/1700	28/11+	120 (60)	6	4 (5-15R); 2 (5-20R)	2	—	1 (DB9)	2	5-20P	8	14.12 x 9.12 x 11.52	91
SMART3000	3000/2250	17/6+	120 (60)	10	7 (5-15R); 2 (5-20R); 1 (L5-30R)	2	—	2 (DB9) & 2 (USB)	—	L5-30P***	8	14.12 x 9.12 x 11.52	61
SMART5000RT3U	5000/4000	38/16+	208/240 (In); 208 & 120 (Out) (60)	14	10 (5-15R); 2 (5-20R); 1 (L6-30R); 1 (L14-30R)	8	—	2 (DB9) & 2 (USB)	—	L6-30P	10	5.25 x 17.5 x 22.5 (power module) 5.25 x 17.5 x 22.5 (battery pack)	121 (power module) & 170 (battery pack)
SMART5000TEL3U	5000/3750	16/6	208/240 (In); 208 & 120 (400VA max.) (Out) (60)	5	2 (5-15R); 2 (L6-20R); 1 (L6-30R)	2	—	2 (DB9) & 2 (USB)	—	L6-30P	10	5.25 x 17.5 x 22.5 with internal batteries	85
External Battery Packs and Accessories													
BP24V33	24V external battery pack and cables (for SMART2200XLNET only)											8 x 11.5 x 13	66
BP36V27	36V external battery pack and cables (for SMART1400XL only)											13.5 x 14.5 x 21.5	60
BP48V24	48V external battery pack and cables (for SMART2200 and SMART3000 only)											7.25 x 8.5 x 16.25	74
BP48V60RT-3U	48V external battery pack and cables, rack/tower mount (for SMART5000RT3U only)											5.25 x 17.5 x 22.5	170
ENVIROSENSE	Allows UPS to monitor external temperature/humidity and contact-closure inputs (requires SNMPWEBCARD)												
SNMPWEBCARD	Internal SNMP/Web management accessory card (connects compatible UPS systems to Ethernet)												

+ Backup times are expandable with additional external battery packs. * Backup times will vary depending on battery condition and load. ** The USB ports on SMART500USB and SMART700USB models provide intelligent "smart" communications with a limited list of PowerAlert features. Contact Tripp Lite for details. *** SMART2200 includes separate 5-15P plug, and SMART3000 includes separate 5-20P plug. The policy of Tripp Lite is one of continuous improvement. Specifications are subject to change without notice.

Complete 230 Volt model line and detailed 120 Volt specifications available: www.tripplite.com/info/smart

SmartPro® DataCenter™ & SmartPro® XL

Intelligent Line-Interactive Network UPS Systems



- ▶ 1,400 – 5,000 VA
- ▶ Extended Runtime

On-line solutions? See pages 12 and 13.

Application:

ENTERPRISE

Extend Runtime

Without enough runtime, you stand to lose up to \$50,000 per hour according to a recent Yankee Group survey on the cost of lost productivity for an hour of network downtime. All models feature connectors to accept external battery packs to provide all the additional runtime you need! Locate your planned load and optimal runtime on the charts below.



Extending runtime is as simple as plugging in additional external battery packs

Control Individual Outlets

Prioritize the uptime of your most mission-critical loads during a power failure. Select models feature special receptacles that you control independently through PowerAlert Software. Program PowerAlert to reboot a locked up computer or to shut down less important systems, preserving battery runtime for more critical equipment.

Manage Up to 4 Servers

Manage up to four servers simultaneously at no extra cost with multiple built-in communication ports. Using PowerAlert Software, SmartPro UPS Systems provide shutdown commands and reporting on up to four servers—even if they are running different operating systems.*

* Additional PowerAlert features: pages 14 and 15.

Protect Every Application

SmartPro UPS Systems offer everything you need to protect mission-critical equipment in a single box. SmartPro UPS Systems feature a built-in microprocessor to monitor incoming voltage and adjust it when necessary to provide nominal computer-grade AC power. Line-interactive operation—also known as automatic voltage regulation (AVR)—keeps equipment working through low voltage (brownouts) and high voltage without draining battery power. SmartPro UPS Systems provide reliable battery power to keep networks up through short blackouts and allow enough time to safely shut down during longer ones. In addition, all AC outlets stop damaging lightning and surges and filter disruptive line noise, guaranteed with up to \$75,000 Ultimate Lifetime Insurance.

Load (VA/Watts)	Runtime (minutes) with included batteries*	Runtime (minutes) with additional external battery packs				
		1	2	3	4	5
SMART1400XL Extended Runtime (with BP36V27 battery pack)						
700/490	25	117	221	333	446	557
1400/940	10	55	108	170	226	282
SMART2200 and SMART3000 Extended Runtime (with BP48V24 battery pack)						
1000/700	29	176	323	469	616	763
1400/980	20	120	220	320	420	520
2200/1600	11	66	121	176	231	286
3000/2250	6	36	66	96	126	156

Load (VA/Watts)	Runtime (minutes) with included batteries*	Runtime (minutes) with additional external battery packs				
		1	2	3	4	5
SMARTDC5000 and SMARTDC5000HW Extended Runtime (with BP36VXR battery pack)						
2500/1750	42	60	96	126	156	192
5000/3500	18	25	37	49	62	78
SMARTDC5000XR and 5000HWXR Extended Runtime (with BP36VXR battery pack)						
2500/1750	108	194	270	348	426	504
5000/3500	42	78	114	156	192	234

* SMARTDC models do not include internal batteries; they include an external battery pack, standard. Call Tripp Lite's Application Specialists at (773) 869-1236 for additional extended runtime solutions to fit your specific load requirements.

A W A R D - W I N N I N G T R I P P L I T E R E L I A B I L I T Y



"Tripp Lite protected us in a situation we weren't expecting."
Union Pacific Jerry Mann, Project Engineer



Customized Load Management

(not shown)

Select models feature special receptacles that you control independently through PowerAlert Software. Program PowerAlert to shut down less important systems first, preserving battery runtime for more critical equipment.

A Multiple Server Control

Up to four built-in communication ports on select models simultaneously provide shutdown commands and reporting on multiple servers without the need for costly accessories.

B Expandable Battery Capability

All models feature connectors to accept optional external battery packs for additional runtime. See Extended Runtime Chart. "Hot-Swap" capability allows you to expand runtime while keeping systems up and running.

C Variety of Output Options

15-, 20- and 30-amp receptacles on select models ensure maximum connection flexibility.

D Maintenance-Bypass Switch

Ensures zero downtime during hot-swap battery replacement. (SmartPro DataCenter models only.)

E System-Enable Switch

Maintains battery charge during storage. (SmartPro DataCenter models only.)

F Short Circuit Protection

Breakers on select models protect against system overloads.

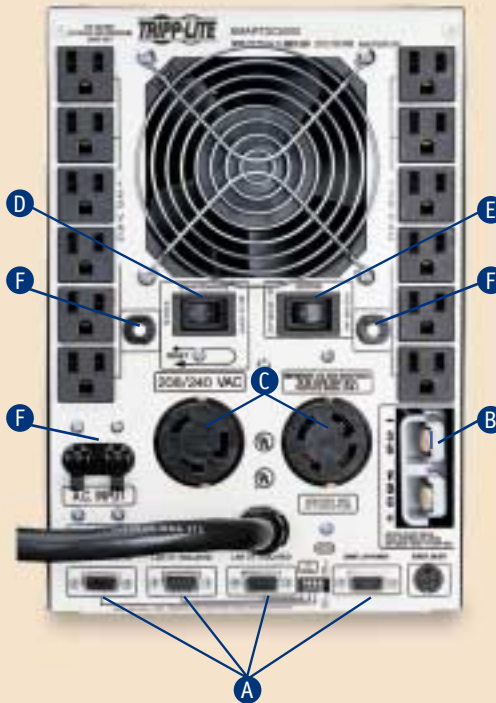

SMARTDC5000 Rear Panel

Up to 18 Performance Conditions Displayed

Front panel LEDs alert you to 18 separate performance conditions, including battery charge, AC line voltage, automatic voltage regulation, UPS load, replace battery and line fault.



NMS Integration (not shown)

Accessory slot in SMART2200, SMART3000, SMART5000RT3U and SMART5000TEL3U models accepts optional internal SNMP/Web Card* for remote shutdowns, reboots and more. Use card with optional environmental sensor** to remotely monitor environmental conditions or to control alarm/security systems.

* Model: SNMPWEBCARD. ** Model: ENVIROSENSE.

Emergency Power Off (not shown)

RJ11 modular jack on SMART2200, SMART3000, SMART5000RT3U and SMART5000TEL3U models allows remote emergency shutdown.

Convenient Battery Replacement

Tripp Lite UPS batteries will constantly protect your equipment for up to six years with normal use. The convenient access door featured on all SmartPro XL models saves the hassle of returning the UPS for internal battery replacement and service.



Model	Output Capacity (VA/Watts)	Input/Output Voltage/Frequency (Hz)	Backup Time (Typical Minutes) Half / Full Load*	AC Receptacles Quantity/ NEMA Type	Customized Load Management Receptacles	Communication Ports "Smart" RS-232 (DB9) or USB (B)	Contact Closure (DB9)	Input Plug (NEMA)	Power Cord Length (ft)	Dimensions H x W x D (in)**	Shipping Weight (lb)
SmartPro DataCenter UPS Systems											
SMARTDC5000	5000/3700	208/240 (In); 208/240 & 120 (Out) (60)	42/18+	14 12 (5-15R); 1 (L6-30R); 1 (L14-30R)	-	1 (DB9)	3	L6-30P	10	23 x 11 x 22	311
SMARTDC5000XR	5000/3700	208/240 (In); 208/240 & 120 (Out) (60)	108/42+	14 12 (5-15R); 1 (L6-30R); 1 (L14-30R)	-	1 (DB9)	3	L6-30P	10	34 x 11 x 22	496
SMARTDC5000HW	5000/3700	208/240 (In); 208/240 & 120 (Out) (60)	42/18+	Hardwire	-	1 (DB9)	3	Hardwire	N/A	23 x 11 x 22	311
SMARTDC5000HWXR	5000/3700	208/240 (In); 208/240 & 120 (Out) (60)	108/42+	Hardwire	-	1 (DB9)	3	Hardwire	N/A	34 x 11 x 22	496
SmartPro XL UPS Systems											
SMART1400XL	1400/940	120 (60)	25/10+	6 5-15R	1	2 (DB9)	-	5-15P	6	12.5 x 7.5 x 8.75	49
SMART2200	2200/1600	120 (60)	23/11+	9 7 (5-15R); 2 (5-20R)	2	2 (DB9) & 2 (USB)	-	5-20P***	8	14.12 x 9.12 x 11.62	57
SMART2200XLNET	2200/1700	120 (60)	28/11+	6 4 (5-15R); 2 (5-20R)	2	1 (DB9)	2	5-20P	8	14.12 x 9.12 x 11.62	91
SMART3000	3000/2250	120 (60)	17/6+	10 7 (5-15R); 2 (5-20R); 1 (L5-30R)	2	2 (DB9) & 2 (USB)	-	L5-30P***	8	14.12 x 9.12 x 11.62	61
SMART5000RT3U	5000/4000	208/240 (In); 208 & 120 (Out) (60)	38/16+	14 10 (5-15R); 2 (5-20R); 1 (L6-30R); 1 (L14-30R)	8	2 (DB9) & 2 (USB)	-	L6-30P	10	5.25 x 17.5 x 22.5 (power module) 5.25 x 17.5 x 22.5 (battery module)	121 (power module & 170 (battery module)
SMART5000TEL3U	5000/3750	208/240 (In); 208 & 120 (400VA max.) (Out) (60)	16/6	5 2 (5-15R); 2 (L6-20R); 1 (L6-30R)	2	2 (DB9) & 2 (USB)	-	L6-30P	10	5.25 x 17.5 x 22.5 with internal battery	85
External Battery Packs											
BP24V33	24V external battery pack and cables (for SMART2200XLNET only)									8 x 11.5 x 13	66
BP36V27	36V external battery pack and cables (for SMART1400XL only)									13.5 x 14.5 x 21.5	60
BP36VXR	36V external battery pack and cables (for SMARTDC5000, 5000XR, 5000HW and 5000HWXR only)									11 x 11 x 22	185
BP48V60RT-3U	48V external battery pack and cables, rack/tower mount (for SMART5000RT3U only)									5.25 x 17.5 x 22.5	170
Accessories											
PAM1	Power accessory module for SmartPro DataCenter (provides a variety of outlet configurations including 20- and 30-amp twist lock)										
DCOW	Caster base for SmartPro DataCenter (provides convenient storage and transportation)										
UPSWM	Wallmount bracket for SMART1400XL										
ENVIROSENSE	Allows UPS to monitor external temperature/humidity and contact-closure inputs (requires SNMPWEBCARD)										
SNMPWEBCARD	Internal SNMP/Web management accessory card (connects compatible UPS systems to Ethernet)										

+ Backup times are expandable with additional external battery packs. * Backup times will vary depending on battery condition and load. ** Overall SmartPro DataCenter dimensions are for power module stacked on top of external battery packs. *** SMART2200 includes separate 5-15P plug, and SMART3000 includes separate 5-20P plug. The policy of Tripp Lite is one of continuous improvement. Specifications are subject to change without notice.

Complete 230 Volt model line and detailed 120 Volt specifications available: www.tripplite.com/info/smart

SmartOnline™ 6kVA & 10kVA

Intelligent True On-Line UPS Systems



TRUE ON-LINE

- ▶ 6,000 – 10,000 VA
- ▶ Extended Runtime

On-line rackmount solutions? See pages 6 and 7.

Application:

ENTERPRISE

Extend Runtime

SmartOnline 6kVA and 10kVA UPS Systems ensure the 100% availability of your mission critical systems and the continued productivity of your business. Extended runtime and premium features elevate the SmartOnline from a simple contingency to an integral part of day-to-day operations. Compared to the competition, the superior amp-hour capacity of the SmartOnline's battery modules keeps your systems running up to four times longer during a blackout.* Without enough runtime, you stand to lose up to \$50,000 per hour according to a recent Yankee Group survey on the cost of lost productivity for an hour of network downtime. SmartOnline models accept additional external battery modules to provide all the runtime you need—from 10 minutes to 2 days!

* Battery-Sizing Tip: When researching competitors, look at the voltage and amp/hour capacities of the individual internal batteries that make up each battery module. It will give you a better comparison of capacity and runtime.

EXTENDED RUNTIME CHART

Load (VA/Watts)	Runtime (minutes) with included batteries*	Runtime (minutes) with additional external SUBP battery modules				
		1	2	3	4	5
SU6K						
3000/2100	25	98	184	272	360	439
6000/4200	10	42	80	119	164	200
SU10K						
5000/3500	31	73	122	168	226	282
10000/7000	12	30	52	71	98	123

* SU6K models feature internal batteries; SU10K models feature an external battery module, standard. Call Tripp Lite's Application Specialists at (773) 869-1236 for additional extended runtime solutions to fit your specific load requirements.

Deliver True On-Line Operation

SmartOnline UPS Systems provide mission-critical equipment with the highest level of power protection for rackmount systems. Dual-conversion technology continually converts incoming AC power into filtered DC power, and then resynthesizes it back into AC power with a pure sine wave. Constant on-line operation completely isolates sensitive equipment from every power problem on the AC line. SmartOnline models accept the widest range of incoming voltage and frequency variations, generating the most consistently pure AC power ($\pm 3\%$ V and ± 0.2 Hz).

SmartOnline UPS Systems provide reliable battery power to keep networks up safely through short blackouts and allow enough time to safely shut down during longer ones. In addition, all AC outlets stop damaging lightning and surges and filter disruptive line noise, guaranteed with up to \$100,000 Ultimate Lifetime Insurance. SmartOnline UPS Systems include PowerAlert Software and cabling, providing IT managers with unparalleled control over network power. PowerAlert supports all major operating systems and controls every UPS system, regardless of manufacturer.*

* Additional PowerAlert features: pages 14 and 15.

A W A R D - W I N N I N G T R I P P L I T E R E L I A B I L I T Y



"Tripp Lite was the only power protection company I wanted to deal with."
Xerox Engineering Systems Rick Santina, Network Manager



Expanded Communications

- A Smart RS-232 Communication**
Intelligent RS-232 port allows complete network UPS management when used with PowerAlert Software.
- B AS-400 Support**
Port supports power management communications with an IBM AS-400 computer through PowerAlert Software.
- C Multiple Server Support**
Dry contact interface supports power management communications with an additional server through PowerAlert.
- D NMS Integration**
Accessory slot accepts optional internal SNMP/Web Card* for remote shutdowns, reboots and more. Use card with optional environmental sensor** to remotely monitor environmental conditions (temperature and humidity) or to control and monitor alarm/security systems. Dry contact interface works with most alarm, security and telecom devices.
* Model: SNMPWEBCARD.
** Model: ENVIROSENSE.

Front Panel Digital LCD Display

Alerts you to over 45 UPS operational modes and conditions in easy-to-read text display and operational diagram.

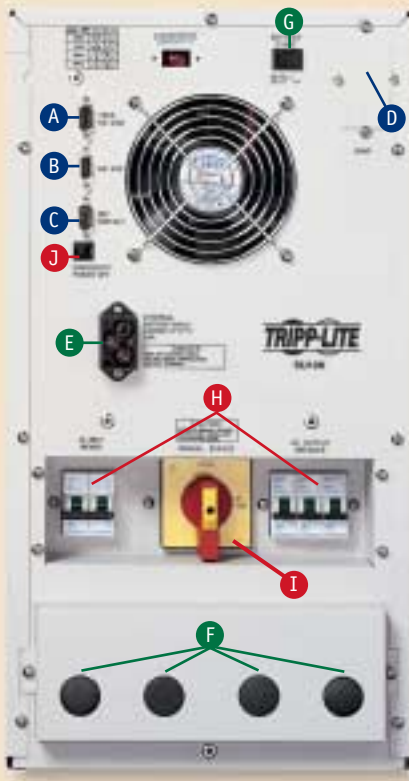

SU10K Rear Panel

Varied Input/Output Options

- E Extended Runtime**
Connect optional Tripp Lite SUBP battery modules for additional runtime. Contact Tripp Lite for application and sizing assistance or to specify a custom battery cabinet to fit your unique needs.
- F Hardwire, Single-Phase Input/Output**
Provides 208 or 240V AC input and simultaneous 120V and 208V/240V AC output.
- G Battery Cold Start**
Restart your UPS during a prolonged blackout to utilize its batteries for periodic system access or data retrieval.

Critical Safety Features

- H Short Circuit Protection**
Double-pole breakers safeguard your equipment and the UPS from damage due to input/output short circuits.
- I Bypass Operation**
Manual and additional automatic bypass allow you to safely pass through AC power, ensuring 100% availability of connected equipment if the UPS requires maintenance.
- J Emergency Power Off**
RJ11 modular jack allows remote emergency shutdown.

Recharge Batteries Within 4 Hours

Each SmartOnline battery module recharges itself—featuring an AC power cord and integrated battery charger. This is in contrast to most manufacturers' battery modules that are charged by the UPS system. With multiple individual chargers, a SmartOnline multiple battery system will recharge itself within four hours after an extended blackout—dramatically faster than competitive models!

Choose Flexible Input/Output Options

With SmartOnline UPS Systems you can choose between the dedicated safety of standard hardwired input/output or the flexibility of optional plug and outlet solutions. Tripp Lite offers optional power accessory modules (stocked and custom-order models) which wire directly to the SmartOnline's output terminals to provide a variety of 120V and 208/240V outlet configurations. Use Tripp Lite's optional 30-amp twist lock cord to connect to the 6000VA model for additional management flexibility.

Model	Output Capacity (VA/Watts)	Backup Time (Typical Minutes) Half/Full Load*	Input Voltage	Output Voltage/Frequency (Hz)	Voltage Regulation	Communication Ports		Dimensions H x W x D (in)	Shipping Weight (lb)
						"Smart" RS-232 (DB9)	Contact Closure or AS-400 (DB9)		
UPS Systems									
SU6K	6000/4200	25/10+	208/240	208/240 & 120 (50/60)	+/- 3%	1	1 (contact closure) & 1 (AS-400)	29.5 x 17.25 x 31	350
SU10K	10,000/7000	31/12+	208/240	208/240 & 120 (50/60)	+/- 3%	1	1 (contact closure) & 1 (AS-400)	29.5 x 35 x 31	610**
External Battery Pack and Accessories									
SUBP	240V external battery module with integrated charger for SU6K and SU10K models							29.25 x 17.5 x 31	325
ENVIROSENSE	Allows UPS to monitor external temperature/humidity and contact-closure inputs (requires SNMPWEBCARD)								
SNMPWEBCARD	Internal SNMP/Web management accessory card (connects compatible UPS systems to Ethernet)								
SU30ACORD	AC power cord (6 ft. with L6-30P plug) for use with SU6K model only								

+ Backup times are expandable using external battery packs. * Backup times will vary depending on battery condition and load. ** Total weight includes power module and external battery module. The policy of Tripp Lite is one of continuous improvement. Specifications are subject to change without notice.

Detailed specifications available: www.tripplite.com/info/smart

Several comprehensive start-up and 2-, 3- and 5-year on-site service plans are available to ensure years of trouble-free operation. Contact Tripp Lite for details.

PowerAlert (Version 11.0)

Universal UPS Power Management Software



Wireless
Wireless Interface



LAN/WAN
Main Screen



Enterprise
NMS-Style Interface



Web
Web Interface

Unique features:

PowerAlert builds on a full list of standard features (unattended system shutdown, power condition reporting, etc.) with a longer list of unique features guaranteed to make PowerAlert the most versatile and valuable power management tool you will ever use.

- ▶ Controls Every Brand of UPS System
- ▶ FREE Linux® Source Code
- ▶ Palm-Powered® & Web Phone Compatible
- ▶ FREE "Watchdog" Application
- ▶ FREE Enterprise Application
- ▶ Communicates Remotely Through TCP/IP

A Controls Every Brand of UPS System

PowerAlert, included FREE with all SmartPro and SmartOnline UPS Systems, is the only UPS software that allows you to control every brand of UPS system from every manufacturer. Mix and match UPS systems (based on the features, price and availability you need) and control them all through one consistent, easy-to-use application—PowerAlert.

B FREE Linux Source Code

PowerAlert supports every operating system—including major Linux distributions. This allows managers to use a single Tripp Lite UPS System and PowerAlert Software to simultaneously manage multiple diverse systems. PowerAlert is the only UPS software with its entire Linux open source code, including intelligent functions, available as a FREE website download (www.tripplite.com/linux).

C FREE "Watchdog" Application

Managers of remote, unattended stand-alone retail kiosks or corporate web/e-mail servers can keep their systems constantly productive—improving customer satisfaction and reducing costly service calls. PowerAlert includes a FREE "watchdog" application that automatically resets locked-up applications. If the application cannot be reset, PowerAlert will safely and automatically power down the UPS and connected equipment and reboot the system.

D Palm-Powered & Web Phone Compatible

PowerAlert is the only certified Palm-Powered compatible UPS management software. PowerAlert offers full wireless UPS monitoring and control, FREE, without the added expense of UPS network cards. Check UPS status, reboot outlets or reset critical settings from any Web-enabled device, including wireless phones and Personal Digital Assistants (PDAs).

E FREE Enterprise Application

PowerAlert integrates all network UPS systems into your Network Management System (NMS). If you don't have an NMS installed, PowerAlert provides a FREE enterprise application which provides a similar easy-to-use graphic interface to manage all UPS systems network wide.

F Communicates Remotely Through TCP/IP

In addition to communicating with equipment directly connected to a Tripp Lite UPS System, PowerAlert can communicate with every workstation on your network, no matter how remote, over existing network cables using TCP/IP. This provides significant cost savings because you enjoy shutdown command centralization while eliminating the need to directly connect high-end intelligent UPS systems (better reserved for critical applications) to every single workstation.

A W A R D - W I N N I N G T R I P P L I T E R E L I A B I L I T Y



"We are very pleased with Tripp Lite and the way their products perform."
lomega R.J. Mendenhall, Telecommunications Engineer

Unique PowerAlert Features Impact Every Enterprise Segment

Corporate Enterprise Applications

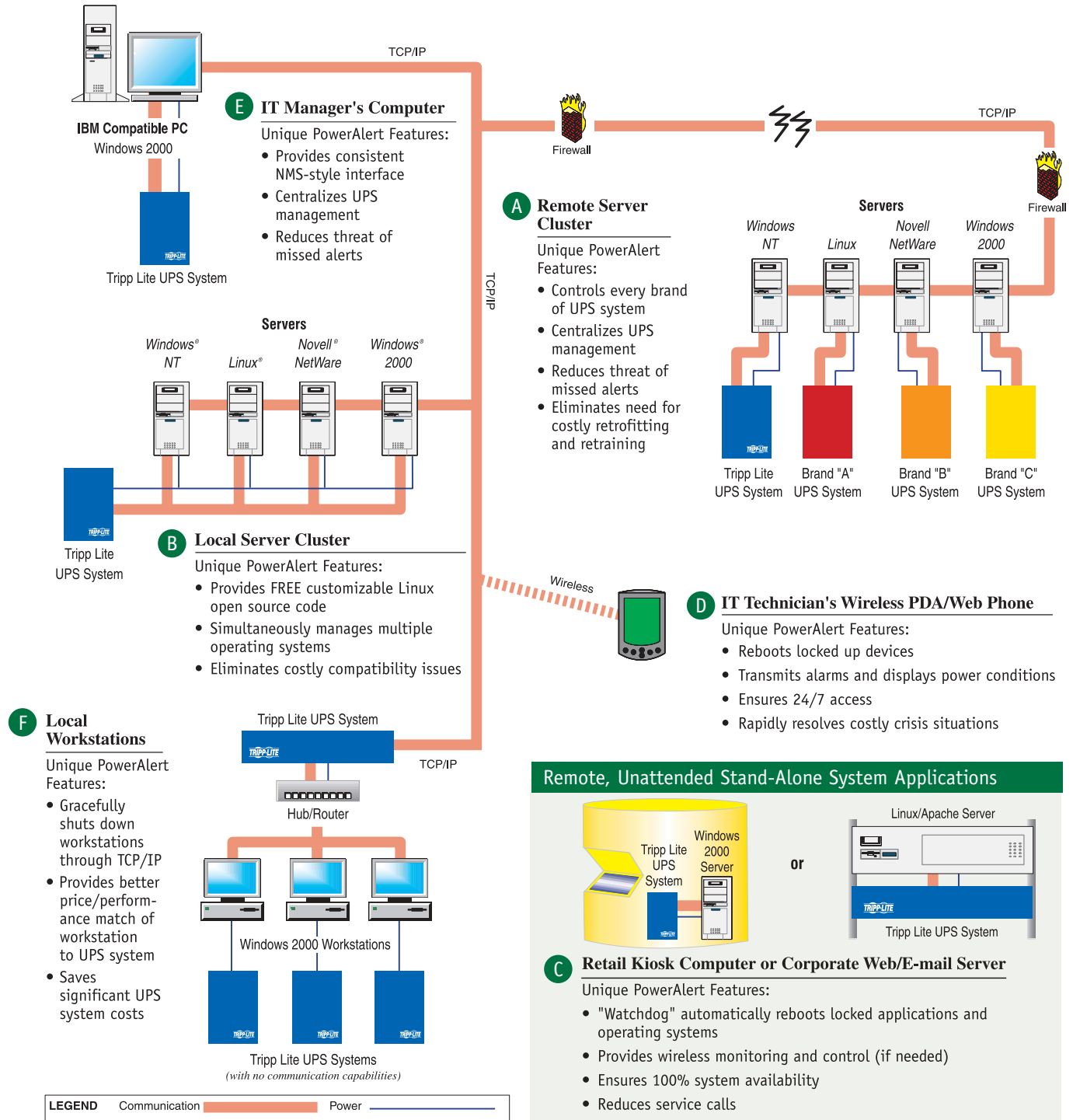

Model	Description
PowerAlert Software	
75-0195	Universal PowerAlert Software CD-ROM and cabling for use with all Tripp Lite UPS Systems with communication ports (included FREE with all SmartPro and SmartOnline models)
SNMP and UPS Accessories	
SNMPWEBCARD	Internal SNMP/Web management accessory card (connects compatible UPS systems to Ethernet)
SNMP-2	PowerAlert SNMP adapter (connects compatible UPS systems to Ethernet; allows SNMP management systems to communicate with up to 4 UPS systems)
ENVIROSENSE	Allows UPS to monitor external temperature/humidity and contact-closure inputs (requires SNMPWEBCARD)
UPS-USB	Adapter cable converts a Tripp Lite UPS system's DB9 port into a USB port

All trademarks are the property of their respective owners. The policy of Tripp Lite is one of continuous improvement. Specifications are subject to change without notice.

Tripp Lite Rackmount Solutions

In addition to the SmartPro and SmartOnline UPS Systems featured in this brochure, Tripp Lite manufactures over 600 other award-winning power protection and connectivity products for every segment of your enterprise, including a full line of rackmount solutions.

Power Strips



Supply Power To Every Application

Tripp Lite Power Strips provide convenient multiple outlets wherever they're needed: in rack enclosures, along walls, or on desks or workbenches. 1U rackmount models mount horizontally in a standard 19 inch rack; all other models can be permanently mounted along rails or any other rack, wall or work surface to conserve space. Simply mount the included clips and snap power strips into place. Hardwire models are available which can be connected directly to your AC wiring for permanent installation. All models feature rugged, all-metal cases to stand up to the most demanding environments.

Deliver Premium Features

Tripp Lite combines all of the premium features found separately in competitive models into one versatile power strip series. Premium features include more outlets, longer power cords and an illuminated on/off switch on select models. All models (except hardwire) feature either a locking safety cover or switch guard to eliminate the risk of accidental shut off, especially important for environments with specific "no switch" requirements.

► 8 – 24 Outlets

► 24 – 72 Inches Long

Full line of additional power strip models available; call (773) 869-1234 or visit www.tripplite.com for details.

Model	Case Length	Electrical Rating*	AC Receptacles**		Power Cord		Input Plug NEMA Type
			Quantity	NEMA Type	Length	Type	
19 in. Rackmount Models (1U)							
RS1215	19 in.	1800 watts (15 amp)	12 (6 front/6 rear)	5-15R	15 ft.	14/3 SJT	5-15P
RS1215-20	19 in.	2400 watts (20 amp)	12 (6 front/6 rear)	5-15/20R	15 ft.	12/3 SJT	5-20P
RS1215-RA	19 in.	1800 watts (15 amp)	12 (6 front/6 rear)***	5-15R	15 ft.	14/3 SJT	5-20P
Standard Models							
PS2408	24 in./2 ft.	1800 watts (15 amp)	8	5-15R	15 ft.	14/3 SJT	5-15P
PS3612	36 in./3 ft.	1800 watts (15 amp)	12	5-15R	15 ft.	14/3 SJT	5-15P
PS4816	48 in./4 ft.	1800 watts (15 amp)	16	5-15R	15 ft.	14/3 SJT	5-15P
PS6020	60 in./5 ft.	1800 watts (15 amp)	20	5-15R	15 ft.	14/3 SJT	5-15P
PS7224	72 in./6 ft.	1800 watts (15 amp)	24	5-15R	15 ft.	14/3 SJT	5-15P
PS7224-20	72 in./6 ft.	2400 watts (20 amp)	24	5-15/20R	15 ft.	12/3 SJT	5-20P
PS7224-20T	72 in./6 ft.	2400 watts (20 amp)	24	5-15/20R	15 ft.	12/3 SJT	L5-20P (twist lock)
Hardwire Models							
PS3612-20HW	36 in./3 ft.	2400 watts (20 amp)	12	5-15/20R	Hardwire	Hardwire	Hardwire
PS7224-20HW	72 in./6 ft.	2400 watts (20 amp)	24	5-15/20R	Hardwire	Hardwire	Hardwire

* All models are rated to 120V AC, 50/60 Hz. ** All standard and hardwire models feature 2.5 inch outlet centers. *** Features right-angle outlets to accept transformer blocks without covering other outlets. Note: Power Strips do not provide surge or line noise protection. The policy of Tripp Lite is one of continuous improvement. Specifications are subject to change without notice.



Isobar® Surge Suppressors (1U)



• Isobar: over 14 million in use worldwide!

- Stop damaging surges and filter disruptive line noise
- Eliminate interference between connected equipment

KVM Switch (1U)



• Controls up to 8 computers with 1

- keyboard/monitor/mouse console
- Expandable option to control up to 512 computers

SmartRack™ Premium Enclosures



- Organize and secure rackmount server, storage and network/telecom equipment
- 100% server compatibility
- Ship fully equipped and assembled

Complete product specifications available: www.tripplite.com



September 25, 2001
Tripp Lite UPS Systems
Model RS1215/20

Distributed By:



1111 W. 35th Street, Chicago, IL 60609
(773) 869-1234 www.tripplite.com



SmartOnline™ (6kVA & 10kVA)

Intelligent True On-Line UPS Systems



SU6000RT3U, SU6000RT3UHV, SU10KRT3U & SU10KRT3UHV

TRUE ON-LINE

- ▶ 6,000 – 10,000 VA
- ▶ Rack/Tower/Stack Adaptable
- ▶ External Batteries (Included) and Extended Runtime Capability*
- ▶ 156 – 276V, 45 – 65 Hz. Input with Precision-Regulated Output**

* With additional optional external battery modules. ** ± 3% V and ± 0.2 Hz.

Application:

ENTERPRISE

- Servers • Datacenters
- Internetworking Equipment
- ISP/Telecom/Lab Equipment

Deliver True On-Line, Pure Sine Wave, Zero Transfer Time Operation

SmartOnline UPS Systems provide mission-critical equipment with the highest level of power protection for rackmount systems. Dual-conversion technology continually converts incoming AC power into filtered DC power, and then resynthesizes it back into AC power with a pure sine wave. Constant on-line operation completely isolates sensitive equipment from every power problem on the AC line. SmartOnline models accept the widest range of incoming voltage (between 156V and 276V) and frequency variations, delivering the most consistently pure, highly-regulated AC power: ± 3% V and ± 0.2 Hz.

SmartOnline UPS Systems provide reliable battery power with zero transfer time to keep networks up and running through short blackouts and allow enough time to safely shut down during longer ones. In addition, they stop damaging lightning and surges and filter disruptive line noise.

Extend Runtime

Without enough runtime, you stand to lose up to \$50,000 per hour according to a recent Yankee Group survey on the cost of lost productivity for an hour of network downtime. SmartOnline UPS Systems accept additional external battery packs to provide all the runtime you need! Locate your planned load and optimum runtime on the chart below.

EXTENDED RUNTIME	Load (VA/Watts)	Runtime (minutes) with included batteries*	Runtime (minutes) with additional external battery modules				
			1	2	3	4	5
SU6000RT3U and SU6000RT3UHV Extended Runtime (with BP240V7RT-3U battery module)							
	3000/2100	25	58	94	138	174	213
	6000/4200	10	23	41	58	77	95
SU10KRT3U and SU10KRT3UHV Extended Runtime (with BP240V10RT-3U battery module)							
	5000/3500	20	45	71	98	130	156
	10000/7000	8	19	32	45	58	74

* All models include an external battery module, standard; they do not include internal batteries. Call Tripp Lite for additional extended runtime solutions and custom battery module options to fit your specific load requirements.

Provide 100% Availability During Maintenance

SU6000RT3U and SU10KRT3U models include 3 modules: a power module, a battery module and a transformer module. A manual bypass switch on the transformer module ensures 100% availability by allowing you to remove or replace the power module and/or battery module while still continuously supporting connected equipment with filtered AC utility power.

Manage Multiple Servers

Using PowerAlert Software, SmartOnline UPS Systems will simultaneously provide intelligent communications, shutdown commands and reporting on up to two servers—even if they are running different operating systems.

Adapt to Rack/Tower/Stack Applications

Adapt the SmartOnline UPS System from 19 inch rackmount to stack or tower applications. An included base stand adjusts to accept both the power module and battery module (standard with all models). The base stand adjusts to accept a third module which can be either an isolation multi-voltage power distribution transformer module (standard with SU6000RT3U and SU10KRT3U models) or an additional battery module (sold separately).



- Removable rack hardware
- Included base stands

A W A R D - W I N N I N G T R I P P L I T E R E L I A B I L I T Y



September 25, 2001
Tripp Lite UPS System
Model: SU2200RT2U

"After weeks of testing, we favored the Tripp Lite SmartOnline 2200 Rack/Tower 2U, which incorporates all the features you could want at an astonishingly low price. For just \$1,100 (street), you get the power you need—2.2 kVA—in a slim rackmount package that does not compromise serviceability. Best of all, the software package is one of the most versatile we tested."

PC Magazine Editors' Choice Award Logo is a trademark of Ziff Davis Publishing Holdings Inc. Used under license.

Feature Focus

Power Module (standard with all models)

The power module includes the UPS system's control panel, communication ports and inverter/charger components. The power module works in conjunction with the battery module to deliver true on-line, pure sine-wave power to connected equipment.



Battery Module (standard with all models)

The battery module works in conjunction with the power module to deliver true on-line, pure sine wave power to connected equipment. It also supplies battery power to connected equipment during a blackout.

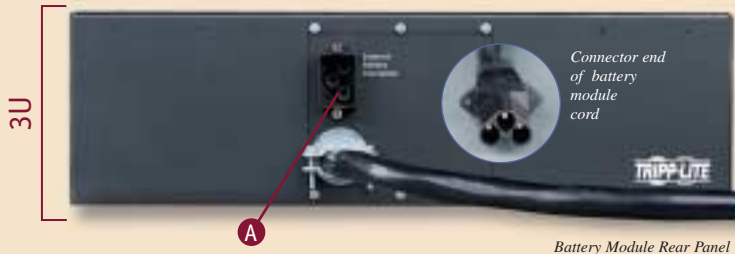

Isolation Multi-Voltage Power Distribution Transformer Module (standard with SU6000RT3U & SU10KRT3U models only)

The transformer module accepts regulated input from the power module and provides 200/208/220/230/240V and 100/120V output.



A Extended Runtime Capability

Connect the single included battery module to the connector on the power module. A connector on the battery module accepts an additional battery module. Connect several battery modules in a series (daisy-chain) for extended runtime. Contact Tripp Lite for application and sizing assistance.



B Multiple Server Support

Two built-in communication ports simultaneously provide shutdown commands and reporting on multiple servers without the need for costly accessories.

C NMS Integration

Accessory slot accepts an optional internal SNMP/Web card* for management via SNMP or Web browser, including remote shutdowns, reboots and more. Use card with optional environmental sensor** to remotely monitor environmental conditions or to control alarm/security systems. * Model: SNMPWEBCARD. ** Model: ENVIROSENSE.

Front Panel Digital LCD Display

Alerts you to more than 45 UPS operational modes and conditions in an easy-to-read liquid crystal text display and operational diagram. Display rotates for horizontal (rackmount/stack) or vertical (tower) viewing.



D Short Circuit Protection

Circuit breakers help guard building wiring, your equipment and the UPS system's power module and transformer module (when used) from damage due to input/output short circuits. The UPS system's battery modules include internal fuses to help guard against short circuits.

E Bypass Operation (Transformer Module)

The manual bypass switch allows you to circumvent the power module while still continuously supporting connected equipment when performing maintenance. While this switch is set to "BYPASS," connected equipment will receive filtered AC utility power, but will not receive battery power in the event of a blackout.

F Emergency Power Off

Modular jack allows remote emergency shutdown.

G Hardwire, Single-Phase Input/Output (Power Module)

Connects the power module output to your equipment or a PDU (power distribution unit). Also connects the power module input to a transformer module or directly to the utility power source. Accepts 156V - 276V input and provides 200/208/220/230/240V output.

H Hardwire, Single-Phase Input/Output (Transformer Module)

Connects the transformer module output to your equipment or a PDU (power distribution unit), the power module and the utility power source. Accepts 156V - 276V input and provides 200/208/220/230/240V and 100/120V output.

Model	Output Capacity (VA/Watts)	Backup Time (Typical Minutes) Half/ Full Load ^(A)	Rack Space ^(B)	Input Voltage / Frequency (Hz) Range	Output Voltage/ Frequency (Hz)	Communication Ports		SNMP Connection	Dimensions H x W x D (in) ^(D)	Shipping Weight (lb)
						"Smart" RS-232 (DB9)	Contact Closure (DB9)			
UPS Systems										
☞ SU6000RT3U	6000/4200	25/10+	3U (power module), 3U (battery module) & 3U (transformer module)	156-276 (45-65)	200/208/220/230/240 & 100/120 (50/60)	1	1	Internal ^(C)	5.14 x 17.5 x 22.5 (power module) 5.16 x 17.5 x 22.5 (battery module) 5.14 x 17.5 x 26 (transformer module)	42 (power module), 137 (battery module) & 90 (transformer module)
☞ SU6000RT3UHV	6000/4200	25/10+	3U (power module) & 3U (battery module)	156-276 (45-65)	200/208/220/230/240 (50/60)	1	1	Internal ^(C)	5.14 x 17.5 x 22.5 (power module) 5.16 x 17.5 x 22.5 (battery module)	42 (power module) & 137 (battery module)
☞ SU10KRT3U	10000/7000	20/8+	3U (power module), 3U (battery module) & 3U (transformer module)	156-276 (45-65)	200/208/220/230/240 & 100/120 (50/60)	1	1	Internal ^(C)	5.14 x 17.5 x 22.5 (power module) 5.16 x 17.5 x 22.5 (battery module) 5.14 x 17.5 x 26 (transformer module)	54 (power module), 153 (battery module) & 90 (transformer module)
☞ SU10KRT3UHV	10000/7000	20/8+	3U (power module) & 3U (battery module)	156-276 (45-65)	200/208/220/230/240V (50/60)	1	1	Internal ^(C)	5.14 x 17.5 x 22.5 (power module) 5.16 x 17.5 x 22.5 (battery module)	54 (power module) & 153 (battery module)
External Battery Packs and Accessories										
BP240V7RT-3U	240V external battery module and cables, 3U rack space (for SU6000RT3U & SU6000RT3UHV models only)								5.16 x 17.5 x 22.5	137
BP240V10RT-3U	240V external long runtime battery module and cables, 3U rack space (for all models)								5.16 x 17.5 x 22.5	153
PDU6K	208/240V input, 240/120V output, 7 outlets (L5-30, L5-20, L6-30, L6-20, 6-20) (for SU6000RT3U & SU6000RT3UHV models only)								3.5 x 17.25 x 3.5	4.5
SNMPWEBCARD	Internal SNMP/Web management accessory card (connects UPS system to Ethernet)									
ENVIROSENSE	Allows UPS to monitor external temperature/humidity and contact-closure inputs (requires SNMPWEBCARD)									

☞ = Accepts External Battery Modules for extended runtime. + Backup times are expandable using external battery packs. ^(A) Backup times will vary depending on battery condition and load. ^(B) All models feature a separate 3U rackmount power module and 3U rackmount battery module (standard). SU6000RT3U & SU10KRT3U models also include a 3U rackmount transformer module (standard). ^(C) An internal accessory slot accepts optional internal SNMP/Web management card (model: SNMPWEBCARD). ^(D) All models are designed with mounting hardware to fit standard 19 inch racks. Model widths are for the case only, without mounting hardware. The policy of Tripp Lite is one of continuous improvement. Specifications are subject to change without notice.

Complete specifications and additional SmartOnline models from 1,000 VA to 10,000 VA available: www.tripplite.com



1111 W. 35th Street Chicago, IL 60609
(773) 869-1234 • www.tripplite.com



ISO 9001
CERTIFIED QUALITY SYSTEM
200303060 95-2229