

英文

S100 User Manual

1. Appearance description

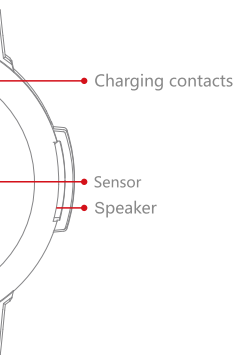
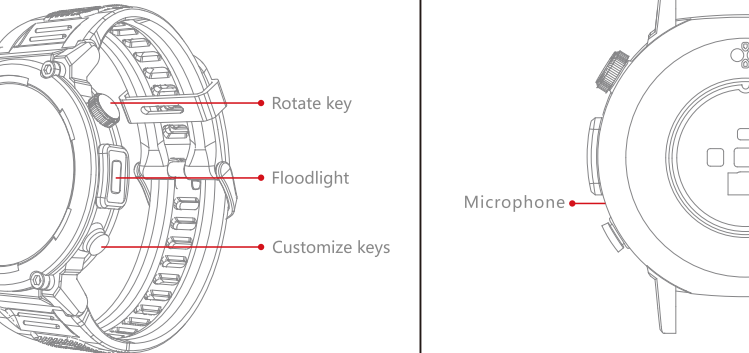

2. Charging instructions

Thank you for choosing our smart health watch. Please read the manual carefully when using it for the first time; First, long press the rotary button for 5 seconds to start the machine. If the battery is low or exhausted, please charge it first.

After connecting the charging cable, insert the USB interface (such as the computer host, mobile power supply, or standard power adapter) for charging. The input voltage is required to be 5V1A or 5V2A.

3. Download APP and Bluetooth pairing

Install APP

Before using this device, please download the APP and install it, scan the QR code on the right with your mobile phone, and select the corresponding software to install according to the mobile phone system.

You can also search for "FitCloudPro" in the Apple AppStore and install it. Android phones can be downloaded from other stores. For example, search for "FitCloudPro" in the Android market to download and install.(Compatible system: iOS11.4+Android6.0 and above)

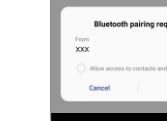

FitCloudPro
(Scan the code to download on the bracelet interface)

The first step: APP Bluetooth pairing.

1. When a new user uses this device for the first time, after downloading and installing the APP, start the APP and register as required. After the registration is completed, enter the account and password to log in.
2. Turn on the Bluetooth status of the phone, and then open the APP to connect to the watch to complete the pairing.

Step 2: Call/media audio settings

After Bluetooth pairing, you can set the audio options on your watch. (As shown in the figure below)

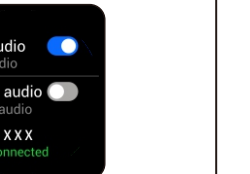

1. Pop up the window and click Pairing.



2. Set the audio options on the watch.

4. Main interface selection

In the main dial interface, long press the screen for 2 seconds/rotary key to select different main interfaces; After the watch is connected to the APP, more main interfaces can be selected in the center of the APP dial.

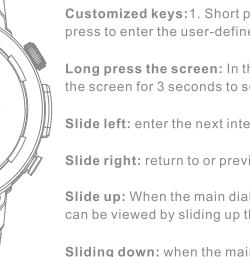

5. Operation method

Rotate the key: 1. Press and hold for 5 seconds to turn on/off; 2. Rotate the browse function list.

Customized keys: 1. Short press on/off the screen; 2. Long press to enter the user-defined function interface.

Long press the screen: In the main dial status, long press the screen for 3 seconds to select different dials.

Slide left: enter the next interface.

Slide right: return to or previous page.

Slide up: When the main dial is in the status, the information can be viewed by sliding up the screen.

Sliding down: when the main dial is in the status, sliding down the screen can quickly enter the setting menu.

6. Product parameters

Display screen: 1.45 inch TFT display
Resolution: 360 * 360
Waterproof grade: IP67
Wrist strap material: TPU
Heart rate sensor: Hx3605
Compatibility: iOS11.4+Android 8.0 or above

Main control chip: RTL8763EWE
Battery capacity: 300mAh
Working time: about 7-9 days
Synchronization mode: Bluetooth 5.0
Working temperature: - 10 °C~50 °C
Package list: *Host * Charging line*
Wrist strap * Instruction manual

7. APP language

APP supports languages: Simplified Chinese, English, German, Spanish, French, Italian, Japanese, Polish, Portuguese, Russian, and more languages will be added in the future.

8. The main function

- | | | | |
|----------------------|------------------------|----------------------|---------------------------|
| ⌚ Time | ⌚ Timer | 🚶 Long seat reminder | 👩 Menstrual cycle |
| 👣 Steps | 📞 Find the phone | 📞 Bluetooth calling | 🧮 Calculator |
| 📏 Distance | 🌐 Multilingual | ✉ Information push | 📷 Remote photography |
| 🔥 Calories | ❤ Heart rate | 🎵 Play music | 📅 Drinking water reminder |
| 🌙 Sleep | 📅 Calendar | ☁ Weather forecast | 💳 Payment function |
| 🏃 Multi- sport modes | 🔄 Respiratory training | 🩺 Blood pressure | 💧 Blood oxygen |

9. Precautions

1. Do not hit the main unit seriously.
2. Do not touch chemicals such as benzene or thinner.
3. Please do not approach strong magnetic fields and electric shock stations.
4. Please avoid direct light or heat appliances.
5. Do not disassemble, repair or modify it yourself.
6. Dispose of packaging, batteries, and old electronic products, please sort them properly.
7. It is not suitable to wear when taking a bath. (The temperature cannot exceed 45 ° C)

Warranty card

Product name: _____

Model: _____

Name: _____

Contact phone number: _____

Address: _____

Distribution company: _____

Contact phone number: _____

Address: _____

Sales date: _____