

PHILIPS

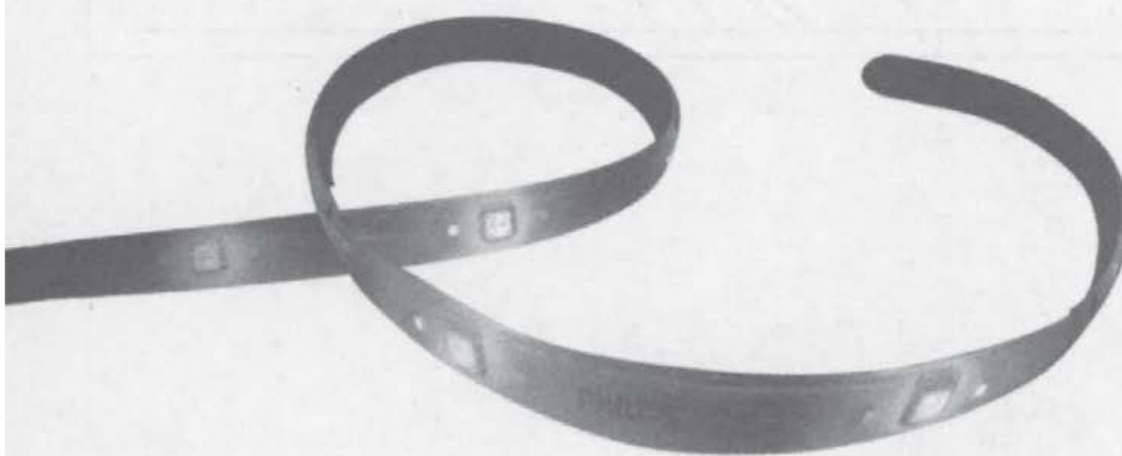

hue personal
wireless
lighting

Lightstrip Plus
Extension



User manual
Notice d'emploi
Manual de usuario

Incl.

A 

B 

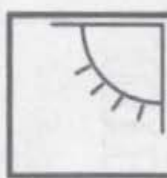
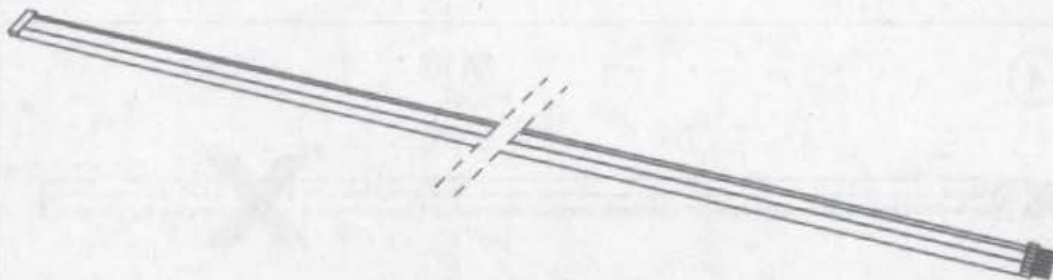

DRY



DAMP



WET



 **B** 

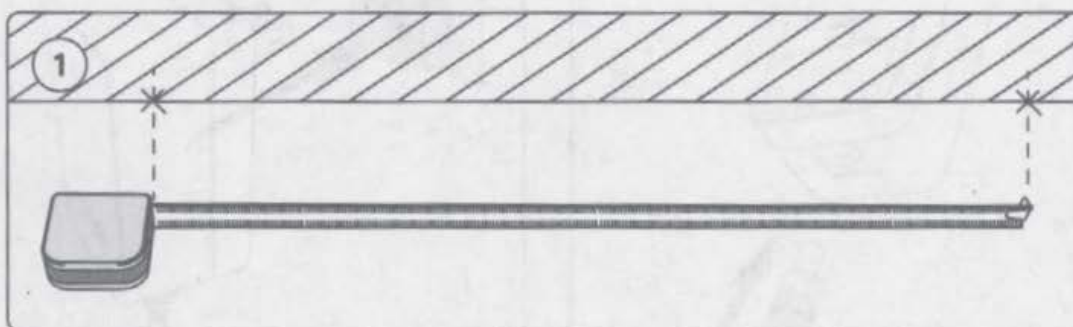
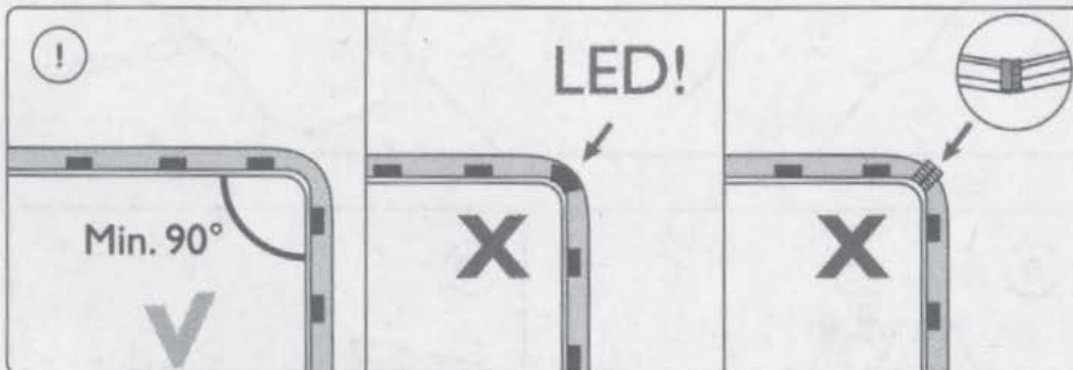
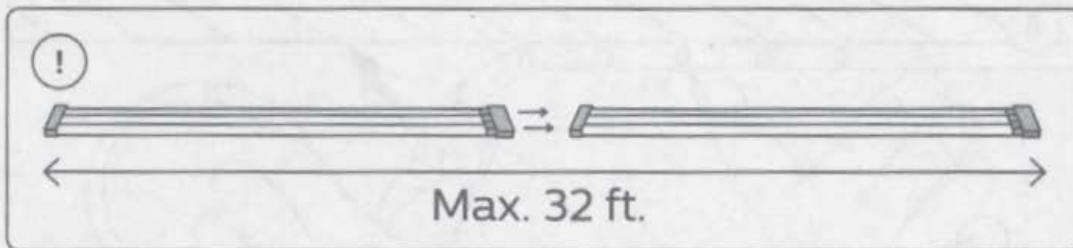

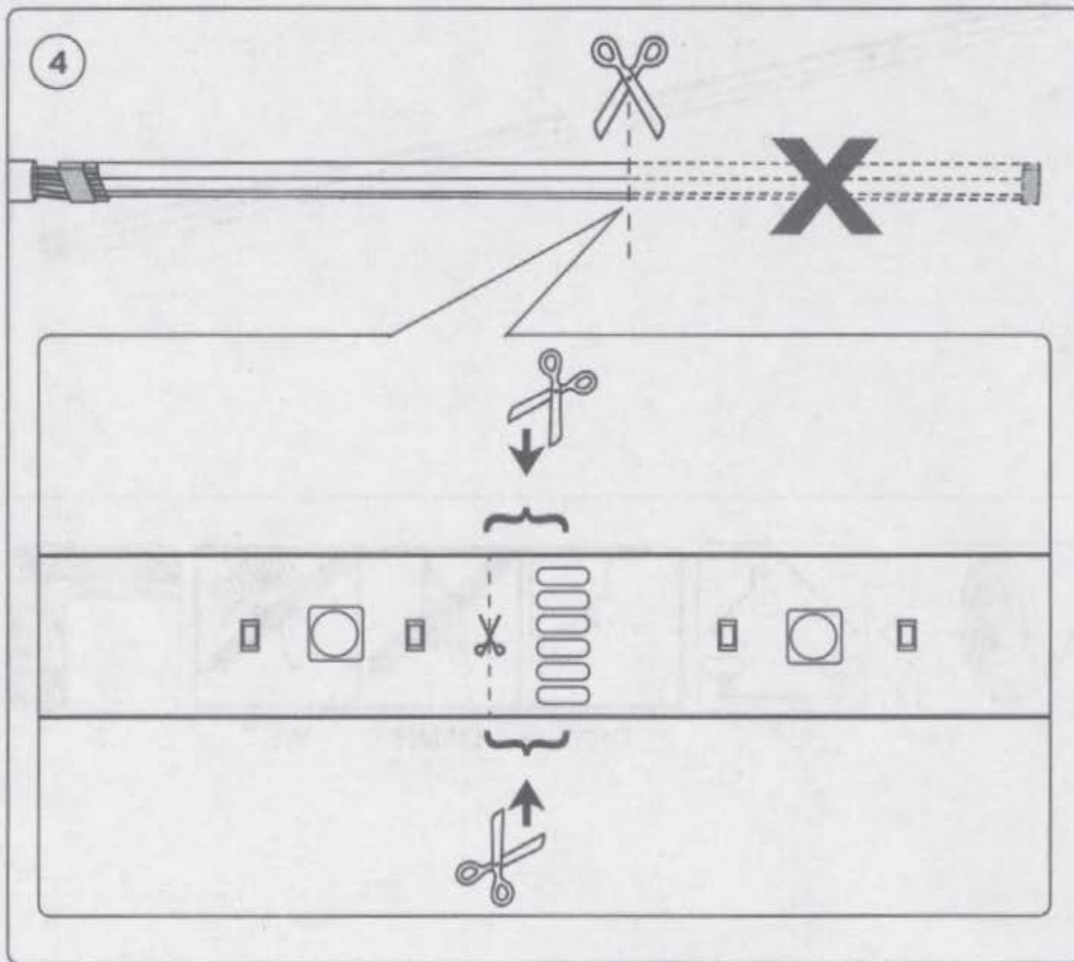
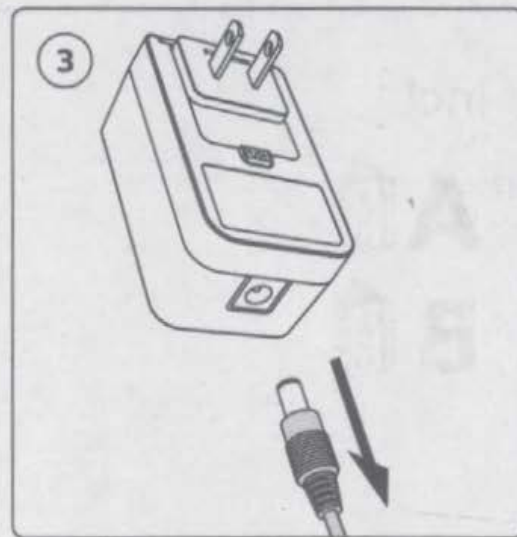
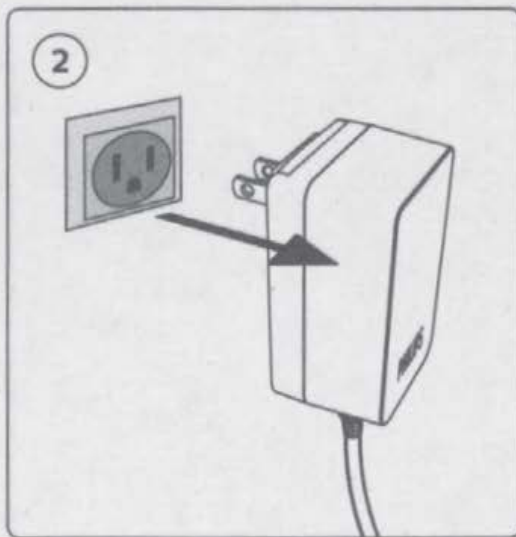

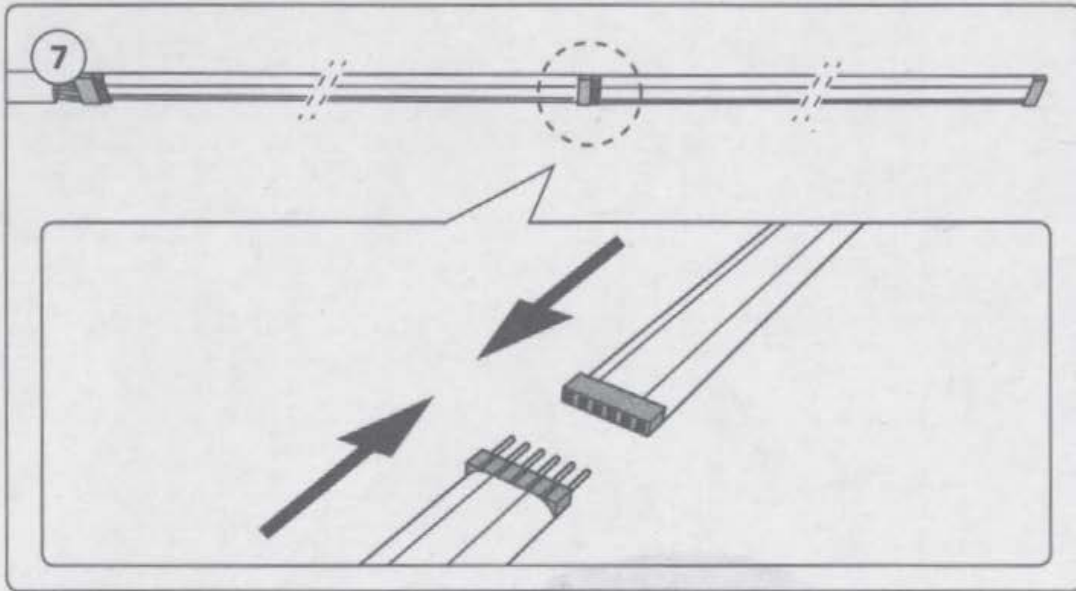
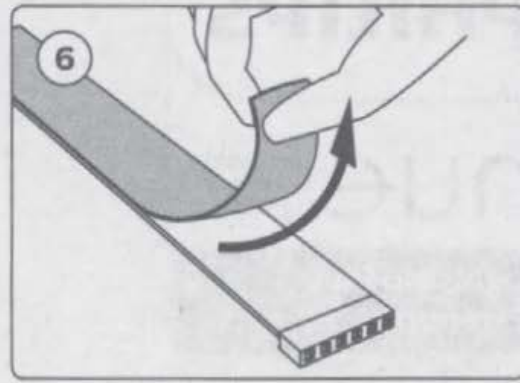
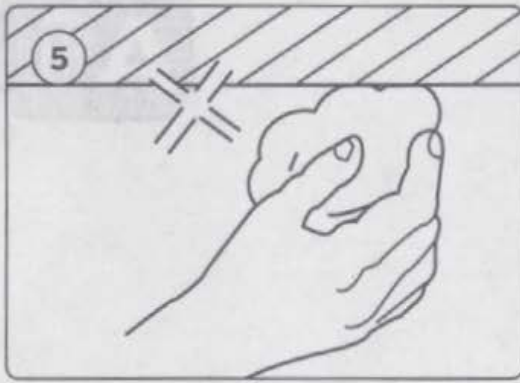

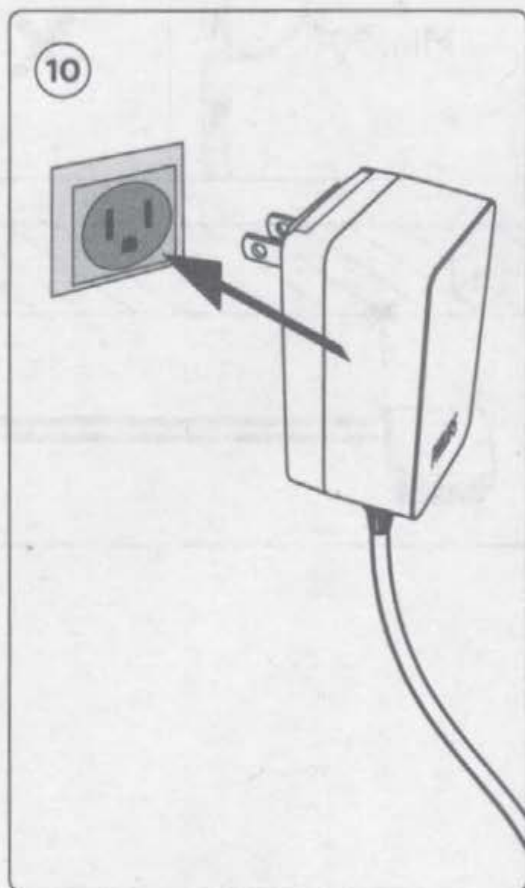
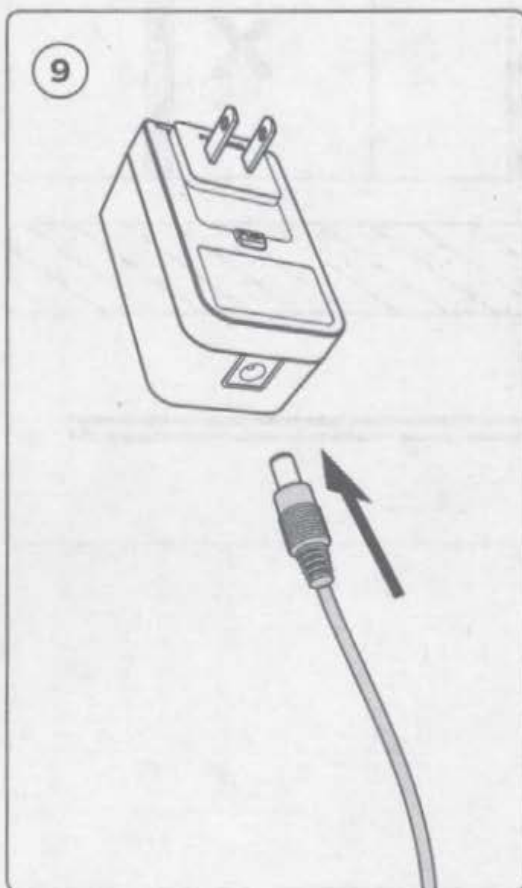
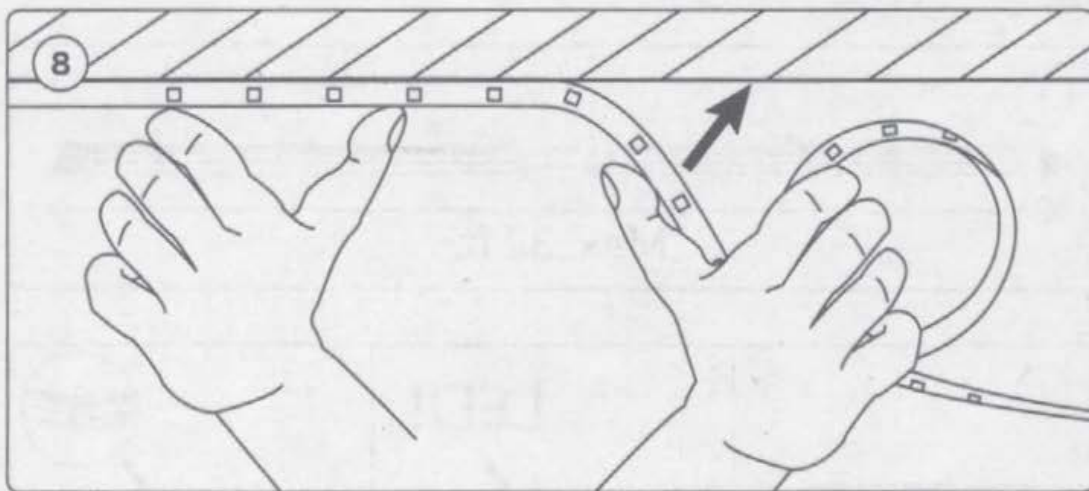

EN Connect to Hue bridge:

Control with smart devices.

- Switch on Hue Lightstrip Plus.
- Plug in the Hue Bridge and connect to your Wi-Fi router.
- Download and start the latest Philips Hue app, and follow the instructions on your smart device.
- Visit meethue.com to discover more Hue products and popular apps.

FR Connexion au pont Hue:

Commande depuis un smartphone/une tablette.

- Branchement de Hue Lightstrip Plus.
- Branchez le pont Hue et connectez-le à votre routeur Wi-Fi.
- Téléchargez et lancez la dernière application Philips Hue, puis suivez les instructions sur votre smartphone/tablette.
- Rendez-vous sur meethue.com pour découvrir plus de produits et d'applications populaires pour Hue.

ES Conexión al Hue bridge:

Control con dispositivos inteligentes.

- Activa Hue Lightstrip Plus.
- Enchufa el Hue bridge y conéctalo a tu router Wi-Fi.
- Descarga e inicia la versión más reciente de la aplicación Philips Hue y sigue las instrucciones en el dispositivo inteligente.
- Visita meethue.com para descubrir más aplicaciones y productos Hue.



Signify North America Corporation
200 Franklin Square Drive
Somerset, NJ 08873, USA

Signify Canada Ltd./Signify Canada Ltée.
281 Hillmount Road,
Markham, ON, Canada L6C 2S3

Questions or comments / Questions ou commentaires :
1-800-555-0050

Importado y/o distribuido en México por:
Signify Mexico S.A. de C.V.
Av. La Palma N° 6-Col. San Fernando,
La Herradura Huixquilucan
Edo. De México, C.P. 52784 – R.F.C. PME-620620-E84

Centro de Contacto:
01-800-508-9000

www.meethue.com

© 2019 Signify Holding
All rights reserved.

3222 639 05781
Last update: 11/10/2019

PHILIPS

hue personal
wireless
lighting

Lightstrip Plus

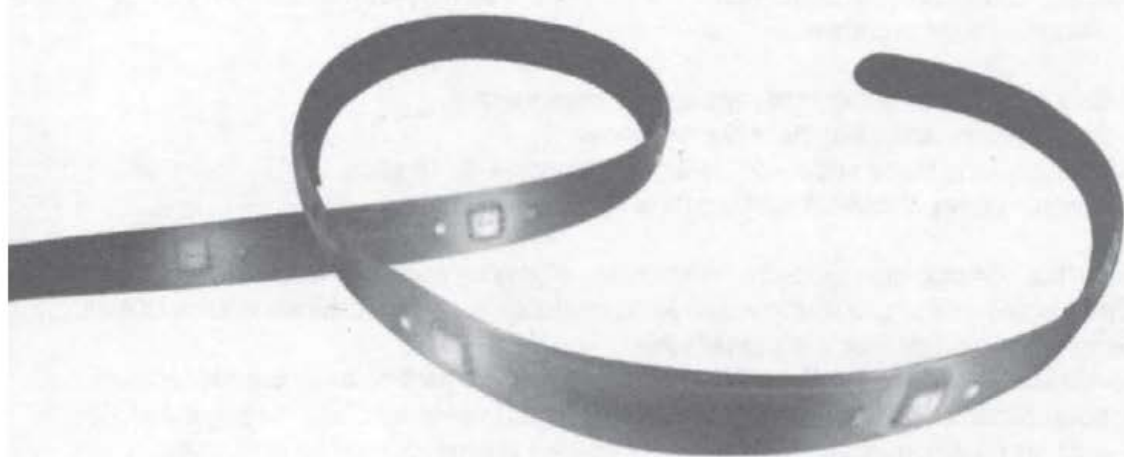

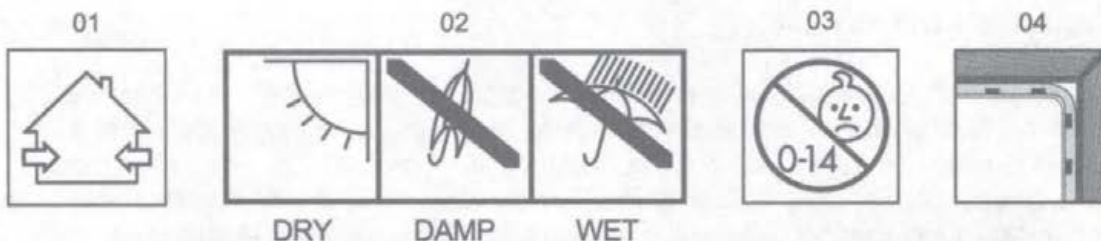

EN SAFETY INSTRUCTIONS – PART B

- The manufacturer advises the correct use of luminaires lighting fixtures! Therefore always follow these instructions to ensure correct and safe installation and functioning of the luminaire and keep it for future reference.
- Turn off electrical power at main fuse or circuit breaker box before commencing installation, maintenance or repair.
- If in doubt, consult a qualified electrician or contact your retail outlet. Ensure that you always install the luminaire to the local electrical code. Certain regulations indicate that luminaires should be installed by a qualified electrician.
- Always use wire nuts/connectors rated for the correct gauge and number of wires used. CAUTION: Be certain that no bare wire strands are exposed outside of the wire nuts/connections (if applicable).
- Be careful not to damage or cut the wire insulation (covering) during installation. Do not permit wires to contact any sharp edges.
- Do not remove thermal insulation pad(s). Doing so will result in increased temperatures and possible risk of fire.
- Maintain interior lighting with a dry cloth duster, do not use abrasives or solvents. Avoid liquid on all electrical parts.
- Always consider all the technical specifications of the luminaire. Verify the stated icons on the identification label on the luminaire and the icons that are shown in part A of your safety instructions.

ATTENTION: Below you will find all the explanations with numeric reference to the icons respectively in front of these PART-B safety instructions. Applicable icons to your fixture are shown in PART-A safety instructions.

- 01 - This luminaire should only be installed indoors.
- 02 - Only suitable for dry locations.
- 03 - This product is not suitable for children under 14 years.
- 04 - Suitable for under-cabinet mounting.

Thank you for purchasing this Philips Hue product, we highly appreciate your choice for the Philips brand and wish you lots of pleasure using your product. Please go to www.meethue.com to learn more about HUE and how to use it. This manual B contains definitions of all potentially applicable parameters & specifications with icons, as per International norms and safety standards. However not all of them may be applicable for the product you purchased - please refer to the icons in the Manual A, for the ones which are particularly applicable for this product.

FCC ID: 2AGBW9290022691X
IC ID: 20812-2691X

This device complies with Part 15 of the FCC Rules and with RSSs of Industry Canada. Operation is subject to the following two conditions:

- (1) this device may not cause harmful interference, and
- (2) this device must accept any interference received, including interference that may cause undesired operation.

This equipment has been tested and found to comply with the limits for a Class B digital device, pursuant to part 15 of the FCC Rules.

These limits are designed to provide reasonable protection against harmful interference in a residential installation. This device generates, uses, and can radiate radio frequency energy and, if not installed and used in accordance with the instructions, may cause harmful interference to radio communications.

This Class B digital apparatus complies with CAN ICES-005 (B) / NMB-005 (B).

This digital apparatus does not exceed the class B limits for radio-noise emissions from digital apparatus as set out in the Radio Interference Regulations of the Canadian Department of Communications.

NOTICE: Changes or modifications made to this device not expressly approved by Signify North America (USA) and Signify Canada Ltd./Signify Canada Ltée. (collectively "Signify") may void the U.S. FCC and Canadian authorization to operate this device.

The advanced interface module complies with FCC radiation exposure limits set forth for an uncontrolled environment.

This device should be installed and operated with a minimum distance of 20 centimeters between the radiator and your body.

The manufacturer is not responsible for any radio or TV interference caused by unauthorized modifications to this equipment. Such modifications could void the user's authority to operate the equipment.

However, there is no guarantee that interference will not occur in a particular installation. If this device does cause harmful interference to radio or television reception, which can be determined by turning the device off and on, the user is encouraged to try to correct the interference by one or more of the following measures:

- Reorient or relocate the receiving antenna
- Increase the separation between the device and receiver
- Connect the device into an outlet on a circuit different from that to which the receiver is connected
- Consult the dealer or an experienced radio/television technician for help

WARNINGS AND CAUTIONS:

- Risk of electric shock – Do not use device where directly exposed to water.
- The device is for indoor use only.
- Dry location use only.

OPERATING INSTRUCTIONS:

- This device is not a toy designed to be played with by children.
- Do not place the device on hot surfaces.
- For safety reasons, do not open device, which will also void the warranty.
- Only use the adaptor supplied; using a different adaptor can damage the device.
- In case an electrostatic discharge occurs, the product may malfunction and require the user to reset the product.

LIMITED WARRANTY:

Signify warrants that this device will be free from defects in material and workmanship and will operate for 2 years based on up to 3 hours average usage per day/7 days per week, when used as directed. If this device does not conform to the warranty, Signify will send you, at its election, a replacement device or refund your original purchase price upon receipt of the returned device, registered receipt and proof of purchase. Please call our toll free number 1-800-555-0050, write to Signify (address indicated on the packaging) or send an email at the website www.meethue.com/warranty to find out how to return the device. This limited warranty does not cover devices subject to accident, neglect, abuse, misuse or acts of God. REPLACEMENT OR REFUND IS YOUR SOLE REMEDY. EXCEPT TO THE EXTENT PROHIBITED BY APPLICABLE LAW, ANY IMPLIED WARRANTIES ARE LIMITED IN DURATION TO THE DURATION OF THIS WARRANTY. LIABILITY FOR INCIDENTAL OR CONSEQUENTIAL DAMAGES IS HEREBY EXPRESSLY EXCLUDED. Some states and provinces do not allow exclusion of incidental or consequential damages, so the above limitation or exclusion may not apply to you. This warranty gives you specific legal rights, and you may also have other rights which vary from state to state and province to province.

CLEANING AND MAINTENANCE:

Do not clean the device when it is on and connected to the power supply.
To avoid scratching the device, clean only with a soft dry cloth.
Do not use cleaning agents to clean the device.

Manage in accordance with disposal laws in your area.

"Hue Personal Wireless Lighting" is a trademark owned by Signify Holding B.V.

Wireless specification:

Wireless RF mode frequency band: 2400~2483.5 MHz

Operating channels Zigbee: channels 11-26

Operating channels Bluetooth: channels 0-39

Bluetooth® enabled product.

The Bluetooth® word mark and logos are registered trademarks owned by Bluetooth SIG, Inc. and any use of such marks by Signify is under license. Other trademarks and trade names are those of their respective owners.

Environmental specification:

Temperature (operation): -20 °C to 40 °C / -4 °F to 104 °F

Temperature (Storage): -25 °C to 60 °C / -13 °F to 140 °F

Relative humidity: 5 - 95% non condensing



Signify North America Corporation
200 Franklin Square Drive
Somerset, NJ 08873, USA

Signify Canada Ltd./Signify Canada Ltée.
281 Hillmount Road,
Markham, ON, Canada L6C 2S3

Questions or comments /
Questions ou commentaires :
1-800-555-0050

Importado y/o distribuido en México por:
Signify Mexico S.A. de C.V.
Av. La Palma N° 6-Col. San Fernando,
La Herradura Huixquilucan
Edo. De México, C.P. 52784 –
R.F.C. PME-620620-E84

Centro de Contacto:
01-800-508-9000

©2019 Signify Holding
All rights reserved.

www.meethue.com

3222 639 05751
Last update: 10/10/19