

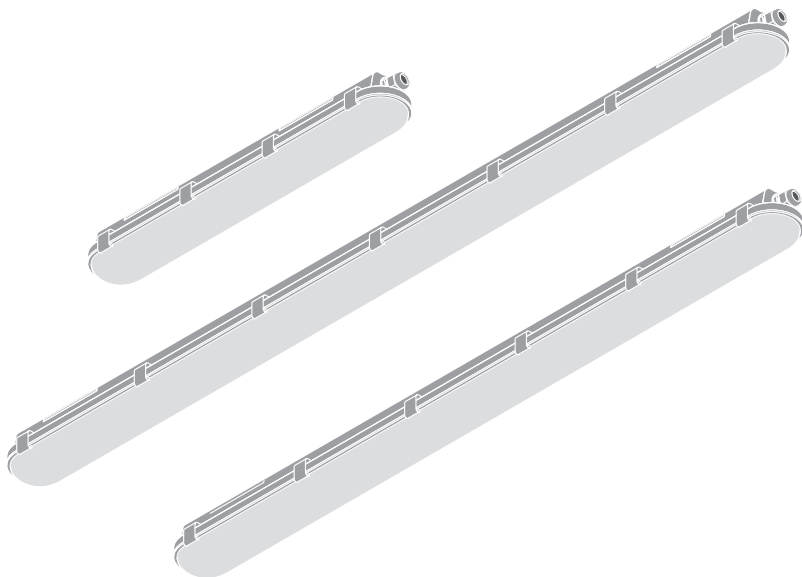

LEDVALUE IP65 POWER AND CCT CHANGE WEATHERPROOF BATTEN



	EAN	W	K	L x W x H (mm)	V _{AC}	Hz	lm/W	IP	IK	Beam angle	Ta (°C)	PF	
LDVWP600PC918WTRI	4058075393486	9/18	3000/ 4000/ 5000	600x96x79	220-240	50/60	120	65	08	115°	-20... +40	>0.9	0.7 kg
LDVWP1200PC2040WTRI	4058075393547	20/40	3000/ 4000/ 5000	1200x96x79	220-240	50/60	120	65	08	115°	-20... +40	>0.9	1.5 kg
LDVWP1500PC2550WTRI	4058075393578	25/50	3000/ 4000/ 5000	1500x96x79	220-240	50/60	120	65	08	115°	-20... +40	>0.9	2.0 kg



LEDVANCE

LEDVALUE IP65 POWER AND CCT CHANGE WEATHERPROOF BATTEN

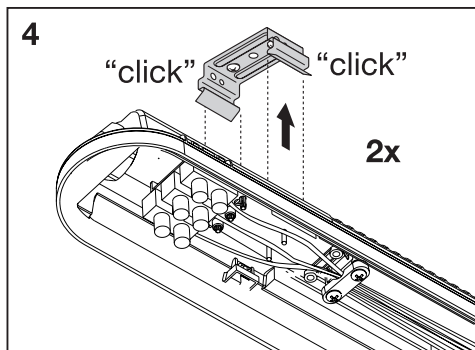
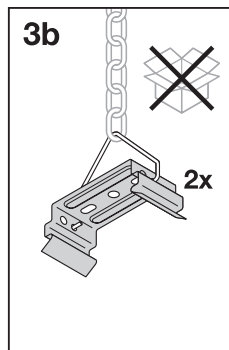
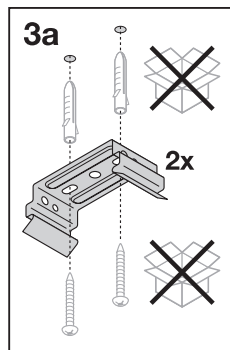
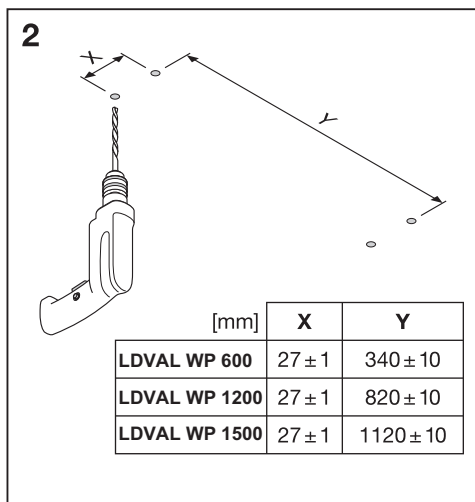
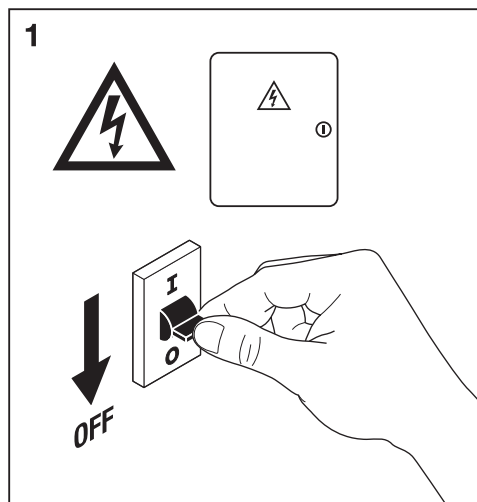
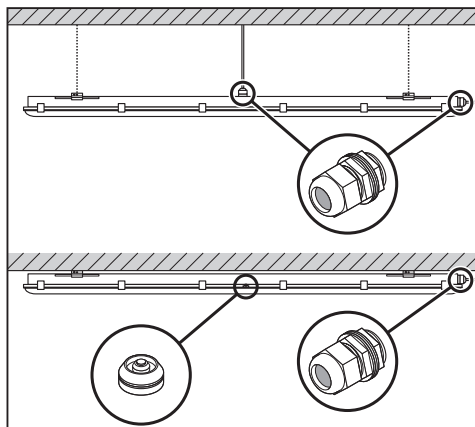
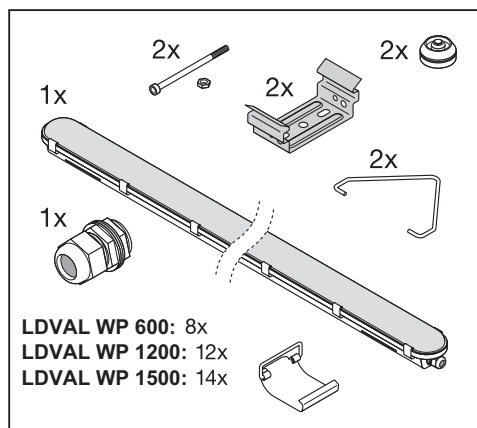

LEDVALUE IP65 POWER AND CCT CHANGE WEATHERPROOF BATTEN

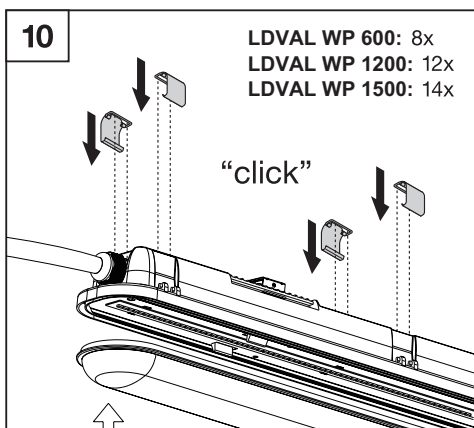
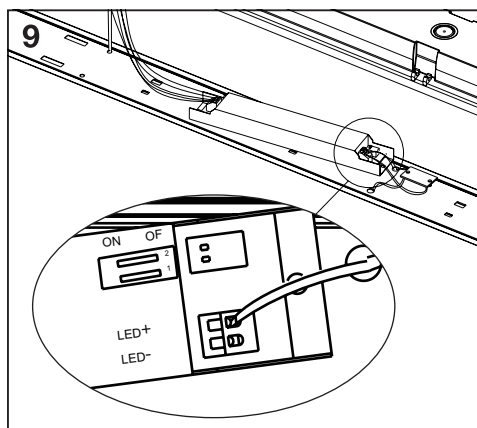
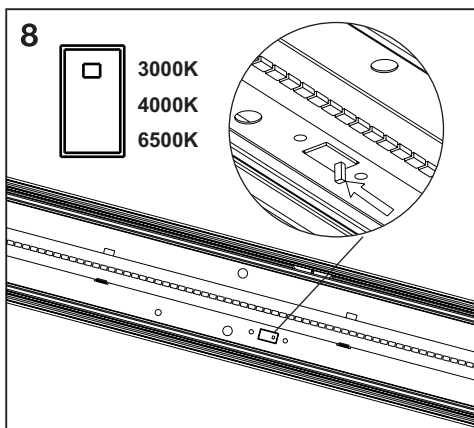
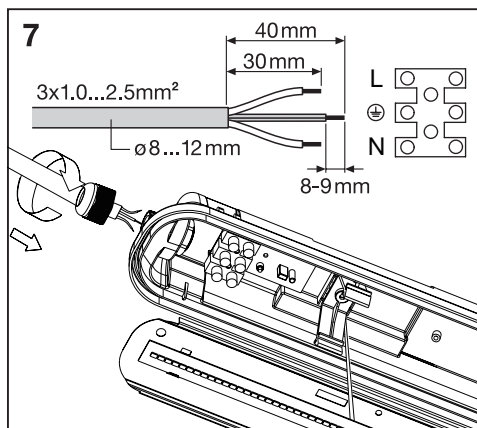
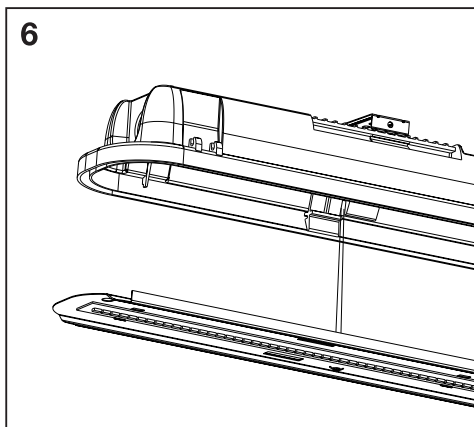
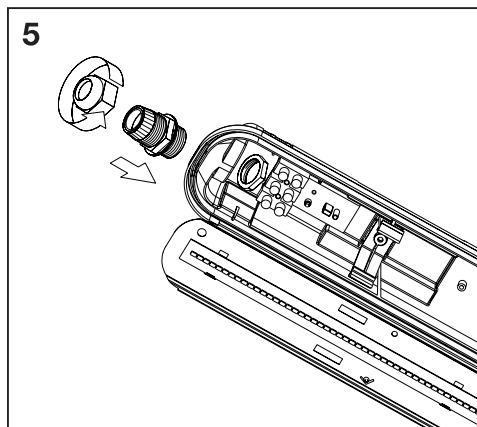

LEDVALUE IP65 POWER AND CCT CHANGE WEATHERPROOF BATTEN

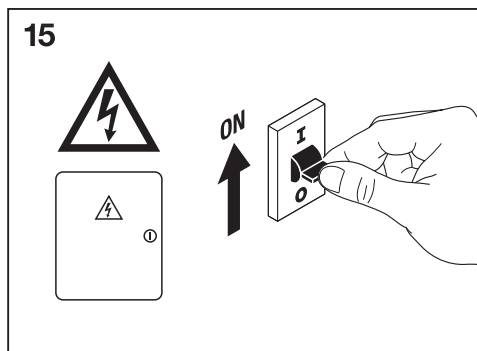
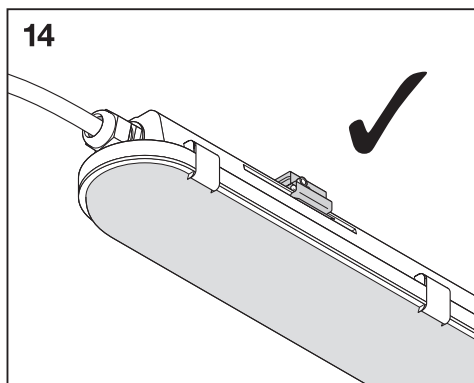
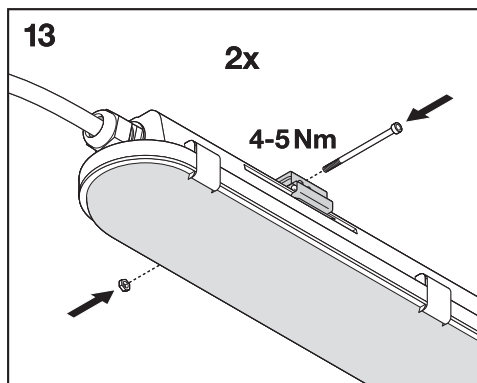
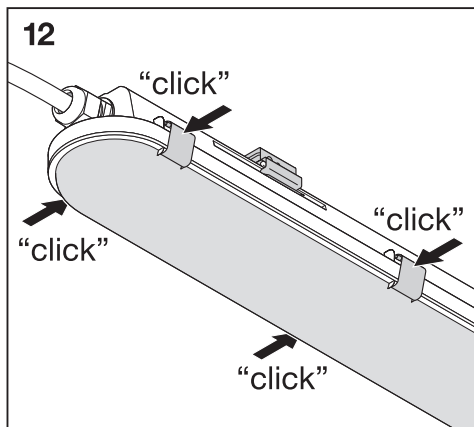
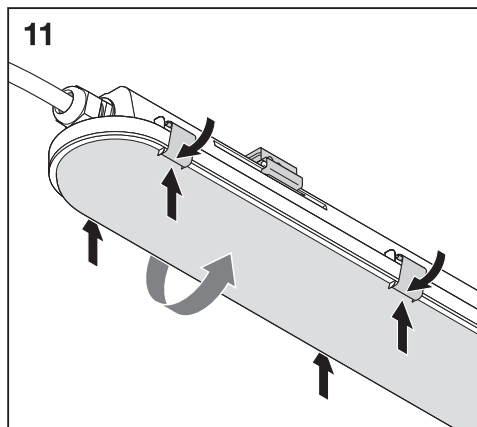

LEDVALUE IP65 POWER AND CCT CHANGE WEATHERPROOF BATTEN

WARNINGS:

- The light source contained in this luminaire shall only be replaced by the manufacturer or his service agent or a similar qualified person.
- Connect to the power supply in accordance with national regulations. And make sure the power supply is off when connecting.
- This product is to be installed by a licensed electrician in strict accordance with local wiring rules.
- Installation note (applicable to Australia and New Zealand only):
This product is not intended for use in household or similar environments.
- Please note that the fixture is equipped with standard surge protection only. To protect the fixture from sags, surges, and lightning strikes, additional surge protectors must be deployed on the primary side.



WARRANTY AGAINST DEFECTS:

Your LEDVALUE IP65 POWER AND CCT CHANGE WEATHERPROOF BATTEN fitting from LEDVANCE comes with a product warranty ("Warranty") for quality assurance, the terms and conditions of which are set out in this document. The Warranty applies exclusively to LED Light Fittings from LEDVANCE purchased within Australia and New Zealand for normal domestic or commercial use. The Warranty is offered to you by:

LEDVANCE Pty Ltd
Suite 2, 21A, 394 Lane Cove Road
Macquarie Park NSW 2113
Phone contact: 1300 467 726 or +61 2 9481 780
Email address: technical.au@ledvance.com

IMPORTANT: Our goods come with guarantees that cannot be excluded under the Australian Consumer Law. You are entitled to a replacement or refund for a major failure and compensation for any other reasonably foreseeable loss or damage. You are also entitled to have the goods repaired or replaced if the goods fail to be of acceptable quality and the failure does not amount to a major failure.

LEDVANCE Pty Ltd
ABN 34 050 103 181
Suite 2.1A
394 Lane Cove Road
Macquarie Park NSW 2113
Australia
Ph +61 29481 8399
www.ledvance.com.au



RoHS



C10449057
G11083692
2019-09-06

www.ledvance.com.au