

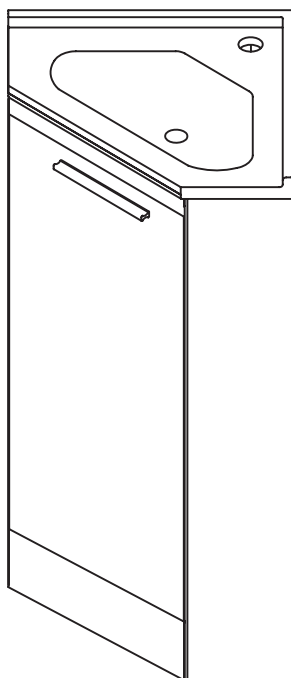

Item # 1001608942
Model # LVGVT2316

USE AND CARE GUIDE

LAVERTON 23 IN. CORNER VANITY



Questions, problems, missing parts? Before returning to the store,
call Glacier Bay Customer Service
8 a.m. - 7 p.m., EST, Monday - Friday, 9 a.m. - 6 p.m., EST, Saturday

1-855-HD-GLACIER

HOMEDEPOT.CA

THANK YOU

We appreciate the trust and confidence you have placed in Glacier Bay through the purchase of this vanity. We strive to continually create quality products designed to enhance your home. Visit us online to see our full line of products available for your home improvement needs. Thank you for choosing Glacier Bay!

Table of Contents

Table of Contents	2	Installation	4
Safety Information	2	Maintenance	5
Warranty	2	Care & Cleaning	5
Pre-Installation	3		
Tools Required	3		
Hardware Included	3		
Package Contents	3		

Safety Information



WARNING: Handle with care. Do not drop, handle roughly, or overtighten screws as this will cause damage to wood.

NOTICE: Observe local plumbing and building codes.

Warranty

LIMITED LIFETIME WARRANTY

Glacier Bay products are manufactured with superior quality standards and workmanship and are backed by our limited lifetime warranty.

Glacier Bay products are warranted to the original consumer purchaser to be free of defects in materials or workmanship. We will replace FREE OF CHARGE any product or parts that proves defective. Simply, return the product / part to any of The Home Depot retail locations or call 1-855-HD-GLACIER to receive the replacement item. Proof of purchase (original sales receipt) from the original consumer purchaser must be made available for all Glacier Bay warranty claims.

This warranty excludes incidental/inconsequential damages and failures due to misuse, abuse or normal wear and tear. This warranty excludes all industrial, commercial & business usage, whose purchasers are hereby, extended a five year limited warranty from the date of purchase, with all other terms of this warranty applying except the duration of warranty.

Some states and provinces do not allow the exclusion or limitation of incidental or consequential damages, so the above limitations may not apply to you. This warranty gives you specific legal rights and you may also have other rights that vary from state to state and province to province. Please see a store or contact 1-855-HD-GLACIER for more details.

Pre-Installation

PLANNING INSTALLATION

Before beginning installation of this product, ensure all parts are present. Compare all parts with the Hardware Included and Package Contents section of this manual. If any part is missing or damaged, do not attempt to assemble, install or operate the product. Contact customer service for replacement parts at 1-855-HD-GLACIER or visit www.HomeDepot.ca.

Estimated Assembly Time: 30 minutes

TOOLS REQUIRED

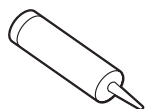

Silicone Sealant



Clean Rag

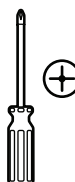

Phillips
Screwdriver



Flat Blade
Screwdriver

HARDWARE INCLUDED



NOTE: Hardware is not shown to actual size.

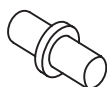

AA

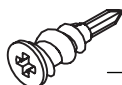

BB

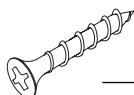

CC

Part	Description	Quantity
AA	Shelf Pins	4
BB	Anchor	1
CC	Screw	1

PACKAGE CONTENTS

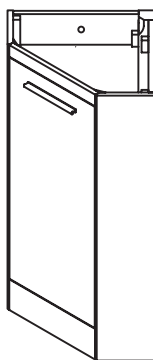

A

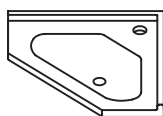

B

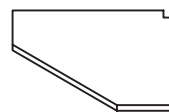

C

Part	Description	Quantity
A	Vanity	1
B	Sink	1
C	Shelf	1

Installation

1 Installing Vanity to Wall

- Place the vanity (A) against the corner of the wall and secure it by screwing the anchor (BB) into the wall then using the screw (CC) to secure the vanity (A) to the wall to prevent it from tipping over.

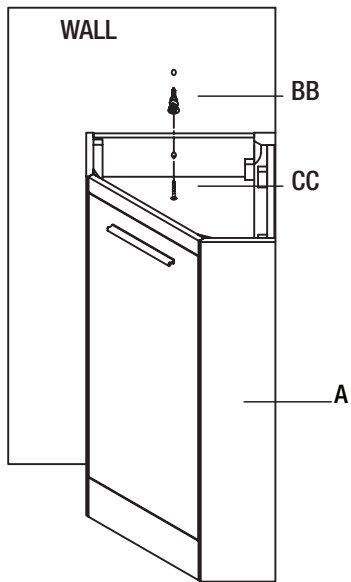

2 Applying the silicone & Installation of Sink

- Wipe off the top edges of the vanity (A) that will be in contact with the top using a clean rag.
- Apply a layer of silicone along all of the top edges.
- Align the sink (B) with the vanity (A).
- Slowly lower the sink (B) onto the vanity (A).

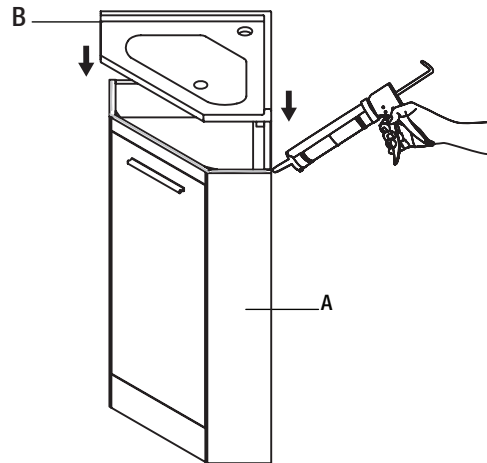

3 Shelf Installation

- Insert shelf pins (AA) in the desired location and place shelf (C) on the pins

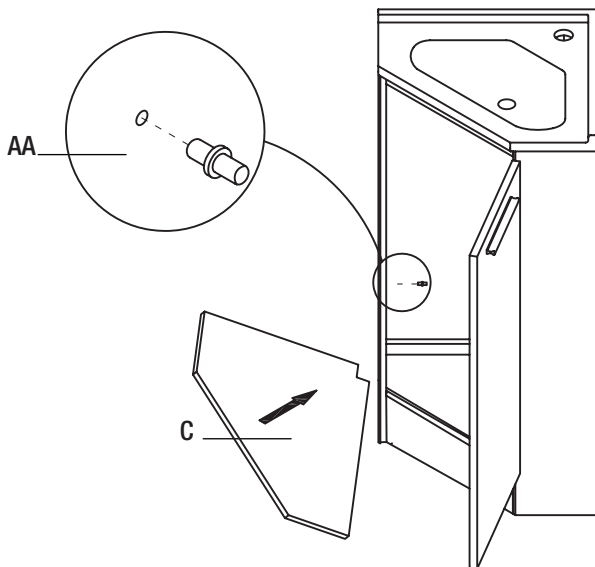

4 Installation of Foot Levelers

- Adjust foot levelers on each leg for any floor inconsistencies.

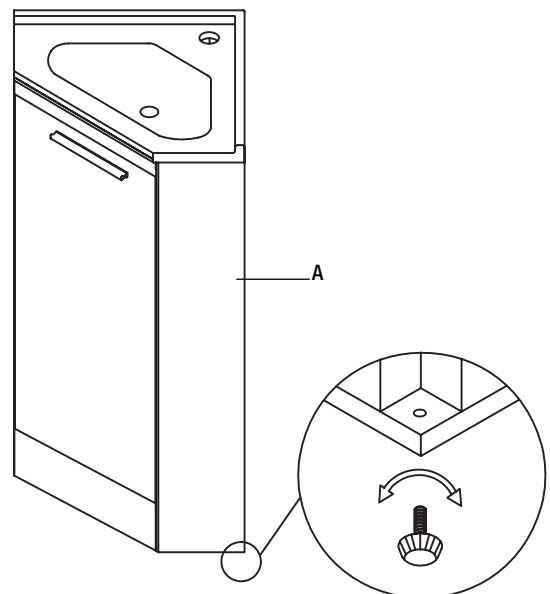

Maintenance

To protect your bath furniture, we suggest the following:

- Avoid placing your furniture in direct sunlight, as sunlight causes fading.
- Clean up spills immediately. Use a blotting rather than a wiping action. Water left over a long period of time will cause white spots in the finish.
- Alcohol, perfume, after shave and medications can cause severe finish damage.

Care and Cleaning

For best results in cleaning and polishing your bath furniture, we recommend the following:

- Dust frequently with a clean, soft, dry, lint-free cloth. Clean the surface by rubbing in the direction of the grain.
- Polish your furniture approximately every six months with a product that contains detergents, emulsifiers and mineral oil. The detergents clean dirt from the furniture; the emulsifiers give it body to clean and last longer; the mineral oil is left behind as a barrier for dirt and moisture that can harm the finish. There is no grit to harm the finish, no wax build up, and no silicone to raise the sheen and act as a barrier for touch-ups and refinishing.
- Clean the outside surface with mild soap, warm water, and a soft cloth.
- On stubborn stains, use a powdered detergent and damp sponge or nylon scouring pad.
- Never use abraasive scouring powders, cleansers, or pads because they will scratch, damage, and dull the surface.



Questions, problems, missing parts? Before returning to the store,
call Glacier Bay Customer Service
8 a.m. - 7 p.m., EST, Monday-Friday, 9 a.m. - 6 p.m., EST, Saturday

1-855-HD-GLACIER

HOMEDEPOT.CA

Retain this manual for future use.