

BEDIENUNG UND INSTALLATION
OPERATION AND INSTALLATION
UTILISATION ET INSTALLATION
BEDIENING EN INSTALLATIE
OBSLUHA A INSTALACE
OBSŁUGA I INSTALACJA
ОБСЛУЖИВАНИЕ И УСТАНОВКА
HASZNÁLATI ÉS TELEPÍTÉSI ÚTMUTATÓ

Händetrockner | Hand dryer | Sèche-mains | Handendroger | Osoušeč rukou | Suszarka do rąk |
Сушилки для рук | Kézi szárító

- » Ultronic S
- » Ultronic W

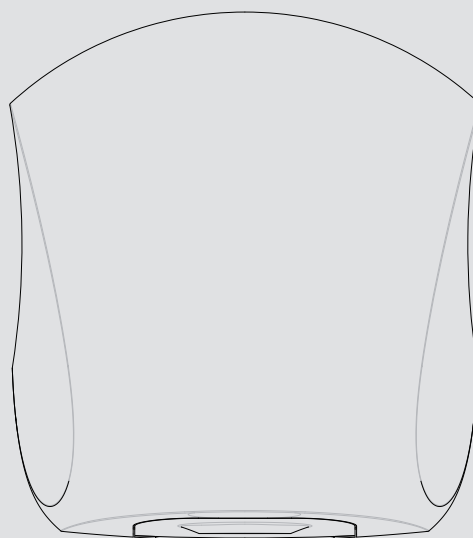

STIEBEL ELTRON

SPECIAL INFORMATION

OPERATION

1.	General information	13
1.1	Safety instructions	13
1.2	Other symbols in this documentation	13
1.3	Information on the appliance	13
1.4	Units of measurement	13
2.	Safety	13
2.1	Intended use	13
2.2	General safety instructions	13
2.3	Safety clearances	14
2.4	CE designation	14
2.5	Test symbols	14
3.	Appliance description	14
4.	Operation	14
5.	Cleaning, care and maintenance	14
6.	Troubleshooting	14

INSTALLATION

7.	Safety	15
7.1	General safety instructions	15
7.2	Regulations, standards and instructions	15
8.	Preparations	15
8.1	Installation wall	15
8.2	Installation in bathrooms	15
8.3	Minimum clearances	15
9.	Installation	16
9.1	Dismantling the casing cover	16
9.2	Wall mounting	16
9.3	Power supply	17
9.4	Assembling the casing cover	17
10.	Handover	17
11.	Specification	18
11.1	Wiring diagram	18
11.2	Minimum clearances and detection range	18
11.3	Guidelines for installation height	18
11.4	Dimensions and connections	19
11.5	Data table	19

WARRANTY

ENVIRONMENT AND RECYCLING

SPECIAL INFORMATION

- The appliance may be used by children aged 8 and up and persons with reduced physical, sensory or mental capabilities or a lack of experience provided that they are supervised or they have been instructed on how to use the appliance safely and have understood the resulting risks. Children must never play with the appliance. Children must never clean the appliance or perform user maintenance unless they are supervised.

OPERATION

1. General information

The chapter "Operation" is intended for appliance users and heating contractors.

The chapter "Installation" is intended for heating contractors.



Note

Read these instructions carefully before using the appliance and retain them for future reference.
Pass on the instructions to a new user if required.

1.1 Safety instructions

1.1.1 Structure of safety instructions



KEYWORD Type of risk

Here, possible consequences are listed that may result from failure to observe the safety instructions.

► Steps to prevent the risk are listed.

1.1.2 Symbols, type of risk

Symbol	Type of risk
	Injury
	Electrocution
	Fire

1.1.3 Keywords

KEYWORD	Meaning
DANGER	Failure to observe this information will result in serious injury or death.
WARNING	Failure to observe this information may result in serious injury or death.
CAUTION	Failure to observe this information may result in non-serious or minor injury.

1.2 Other symbols in this documentation



Note

General information is identified by the symbol shown on the left.

► Read these texts carefully.

Symbol



Damage to the appliance and environment



Appliance disposal

► This symbol indicates that you have to do something. The action you need to take is described step by step.

1.3 Information on the appliance

Symbol



Appliance disposal

Appliances with this marking are not suitable for general waste disposal, and should therefore be collected and disposed of separately.

1.4 Units of measurement



Note

All measurements are given in mm unless stated otherwise.

2. Safety

2.1 Intended use

The appliance is used to dry wet hands.

This appliance is designed for domestic use. It can be used safely by untrained persons. The appliance can also be used in a non-domestic environment, e.g. in a small business, as long as it is used in the same way.

Any other use beyond that described shall be deemed inappropriate. Observation of these instructions and of instructions for any accessories used is also part of the correct use of this appliance.

2.2 General safety instructions



WARNING Electrocution

Never insert any objects into apertures in the appliance.



WARNING Fire

Never operate this appliance

- in rooms where the appliance is at risk from fire or explosion as a result of chemicals, dust, gases or vapours.
- in the direct proximity of pipes or receptacles that carry or contain flammable or explosive materials.
- if work such as laying cables, grinding or sealing is carried out in the installation room.
- if naphtha, sprays, floor polish or similar products are handled. Ensure the room is adequately ventilated before using the appliance.



WARNING Combustion

Never place any flammable, combustible or insulating objects or materials, such as laundry, blankets, magazines, containers with floor polish or naphtha, spray cans or similar on the appliance or in direct proximity to it.



WARNING Electrocutation

Never lean any objects against the appliance or insert them between the appliance and the fixing wall.



WARNING Injury

The appliance may be used by children aged 8 and up and persons with reduced physical, sensory or mental capabilities or a lack of experience provided that they are supervised or they have been instructed on how to use the appliance safely and have understood the resulting risks. Children must never play with the appliance. Children must never clean the appliance or perform user maintenance unless they are supervised.



Never cover the appliance

Never cover the appliance to prevent overheating of the appliance.



Note

If the appliance is installed in rooms where flue gas, oil or petrol vapours occur or where work involves solvents and chemicals, the operation of the appliance can result in long-lasting nuisance through odours or contamination of the appliance.

2.3 Safety clearances



Damage to the appliance and environment

Maintain the required minimum clearances. The appliance's air inlet and outlet must not be obstructed by any objects.

The minimum clearances of the appliance can be found in chapter "Specification / Minimum clearances and detection range".

2.4 CE designation

The CE designation shows that the appliance meets all essential European requirements:

- Low Voltage Directive
- Electromagnetic Compatibility Directive

The maximum permissible mains impedance is indicated in chapter "Specification".

2.5 Test symbols

See type plate.

3. Appliance description

The appliance works without contact. If you hold your hands in the IR sensor detection range, the appliance fan is automatically enabled.

Heated air is discharged from the appliance at high speed. Any moisture left on your hands is removed and your hands are dried.

When you move your hands away from the IR sensor detection range, the appliance stops automatically after approx. 3 seconds.

4. Operation

- Shake your wet hands over the sink before drying to reduce the drying time.
- Hold your hands under the air outlet and rub them together in the air current.



Note

The IR sensor response area is located approx. 3-4 cm below the air outlet. More information on the detection range of the IR sensor can be found in chapter "Specification / Minimum clearances and detection range".

5. Cleaning, care and maintenance



Damage to the appliance and environment

Never spray the appliance using a water hose or other tools. This would let water penetrate the appliance.

A damp cloth is sufficient for cleaning the casing. Never use abrasive or corrosive cleaning agents. Go over with a soft cloth if required.

6. Troubleshooting

Problem	Cause	Remedy
The appliance does not start.	No power supply	Check whether a fuse or RCD has blown or tripped in your fuse box.
	Covering the optical proximity sensor impairs the function of the appliance. In this case, the appliance stops after approx. 3 seconds to avoid constant operation.	Check whether the sensor surface is clear. Once you have re-moved any objects, the appliance will work correctly again.

If you cannot remedy the fault, notify your contractor. To facilitate and speed up your enquiry, please provide the serial number from the type plate (000000-0000-000000).

The type plate is located at the bottom of the appliance.

INSTALLATION

7. Safety

Only a qualified contractor should carry out installation, commissioning, maintenance and repair of the appliance.

7.1 General safety instructions

We guarantee trouble-free operation and operational reliability only if the original accessories and spare parts intended for the appliance are used.

7.2 Regulations, standards and instructions



WARNING Electrocutation

Carry out all electrical connection and installation work in accordance with relevant regulations.



WARNING Electrocutation

Only use a permanent connection to the power supply. The appliance must be able to be separated from the power supply by an isolator that disconnects all poles with at least 3 mm contact separation.



Damage to the appliance and environment

Observe the type plate. The specified voltage range must match the mains voltage.



Note

Observe all applicable national and regional regulations and instructions.

8. Preparations

8.1 Installation wall



Note

Observe the information in chapter "Operation / Safety".

Always install the appliance on a vertical wall.

The back panel of the appliance must be flush with the wall to ensure that the appliance cannot be pulled off.

- Ensure that the wall on which the appliance is mounted is solid and has no recesses.

8.2 Installation in bathrooms



WARNING Electrocutation

Install the appliance exclusively outside safety zone 2.

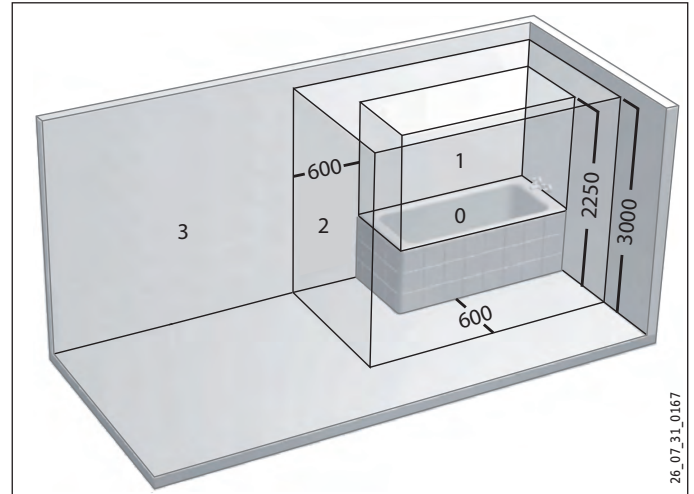

- 0 Safety zone 0
- 1 Safety zone 1
- 2 Safety zone 2
- 3 Safety zone 3

- Ensure that you maintain the safety clearances of safety zone 2 towards bath tubs and shower cubicles.

8.3 Minimum clearances

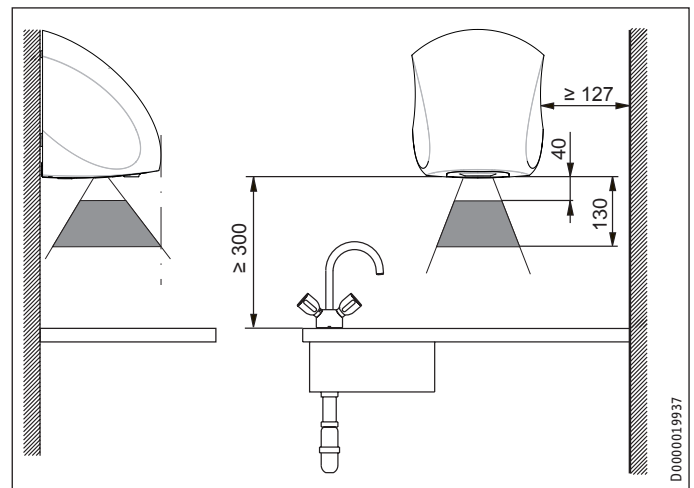

- Prior to installing the appliance, ensure the minimum permissible clearances to adjacent objects are observed.
- Ensure that the ambient air can enter the inlet on the bottom of the appliance without obstruction.
- Ensure that the air can escape from the appliance without obstruction.

9. Installation

9.1 Dismantling the casing cover

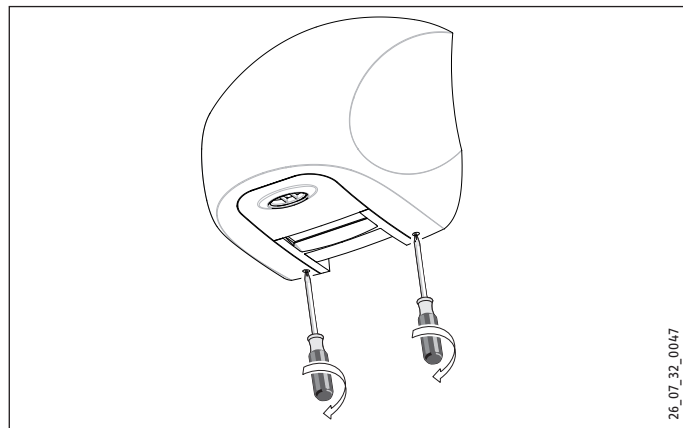

26_07_32_0047

- Undo the 2 internal torx screws with a torx screwdriver 25, turning it clockwise as far as it will go.

The torx screws are rotated into the casing and remain in the casing.

9.1.1 Connecting the appliance back panel and casing cover



Note

The casing cover has 2 internal fixing eyes at the top, which are hooked into place in the 2 hooks on the appliance back panel.

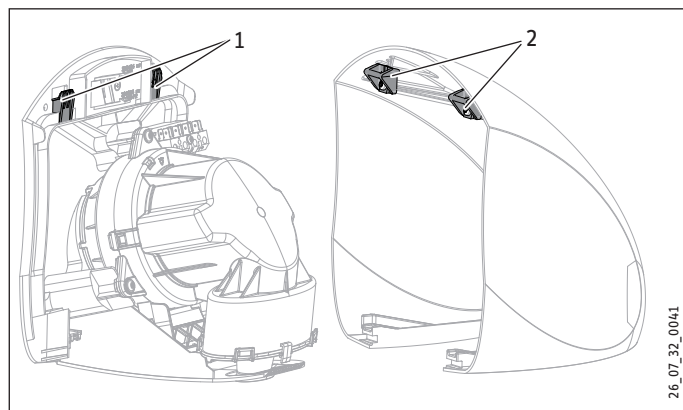

26_07_32_0041

- 1 Hook
- 2 Fixing eye

9.1.2 Removing the casing cover

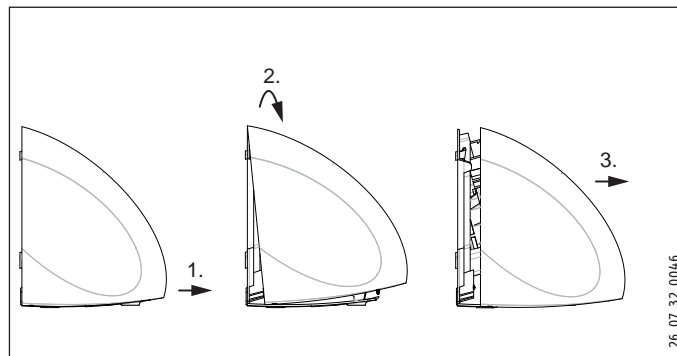

26_07_32_0046

- Detach the casing cover from the appliance at the bottom.
- Lift the casing cover up until the cover's fixing eyes have come free of the hooks on the appliance back panel.
- Pull the casing cover forwards to remove it from the appliance.

9.2 Wall mounting

You can find a drilling template in the appendix to these instructions.

- When positioning the drilling template, be aware of the location and length of the power cable (see chapter "Electrical connections / Power cable").
- Use our standard values as a guide for the installation height (see chapter "Specification / Standard values for the installation height").
- Use suitable fixing screws and rawl plugs.

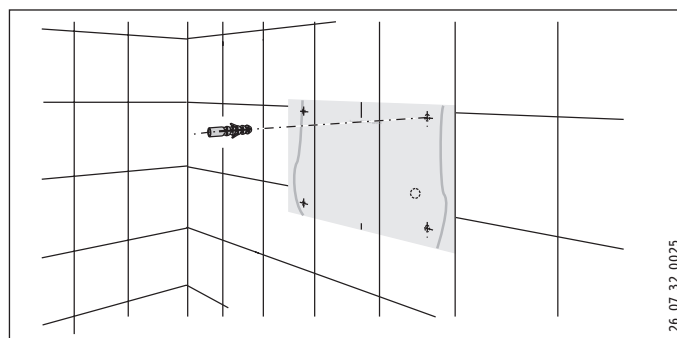

26_07_32_0025

- Cut out the drilling template and mark the 4 fixing points on the wall.
- Drill the 4 holes and insert rawl plugs.
- Screw the 2 lower fixing screws into the wall.

INSTALLATION

Handover

9.3 Power supply



WARNING Electrocutation

Only use a permanent connection to the power supply. The appliance must be able to be separated from the power supply by an isolator that disconnects all poles with at least 3 mm contact separation.

9.3.1 Power cable

The length of the power cable must be at least 100 mm.

The individual wires of the power cable must be stripped approx. 6.5 mm so they can be connected to the mains terminal.

9.3.2 Connecting the appliance

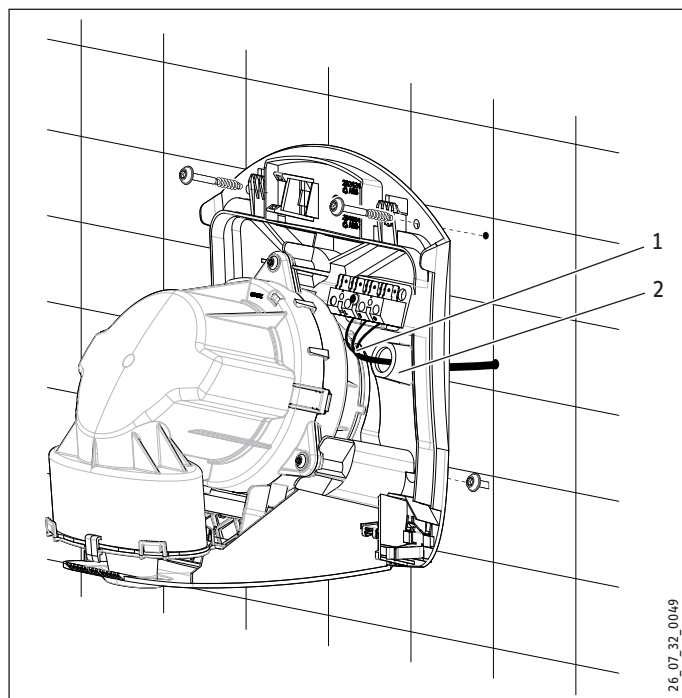

1 Power cable

2 Cable entry

- Pull the power cable through the cable entry in the back panel of the appliance.
- Fit the appliance by placing the keyhole eyelets on to the fixing screws.
- Secure the appliance to the wall with the 2 upper fixing screws and then tighten the 2 lower screws.
- Connect the appliance to the power supply according to the wiring diagram (see chapter "Specification / Wiring diagram").

9.4 Assembling the casing cover

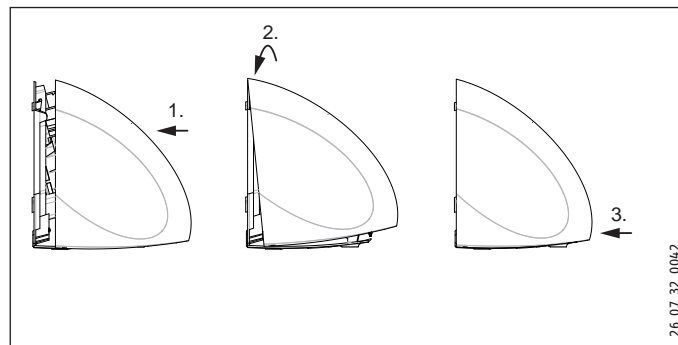

- Push the casing cover on to the appliance from the front.
- Place the top of the casing cover on the back panel of the appliance so that the fixing eyes lock under the hooks (see chapter "Dismantling the casing cover").
- Press the bottom of the casing cover on to the appliance so that it clicks into place.

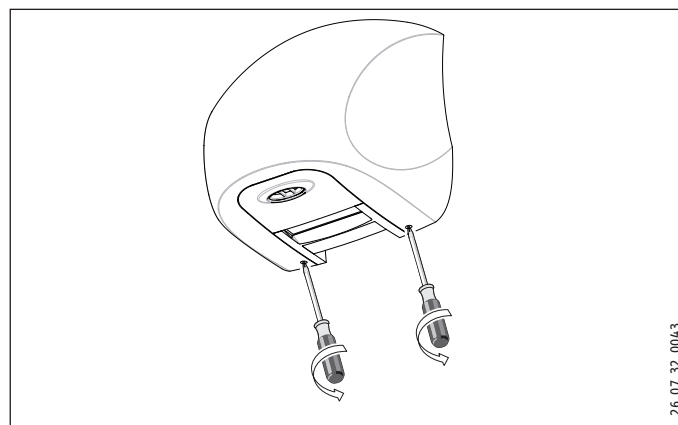

- Check that the casing cover is fitted correctly on the appliance.
- Tighten the 2 internal torx screws with a torx screwdriver 25, turning it anti-clockwise as far as it will go.

10. Handover

Explain the functions of the appliance to the user. Draw special attention to the safety instructions. Hand over these operating and installation instructions to the user.

11. Specification

11.1 Wiring diagram

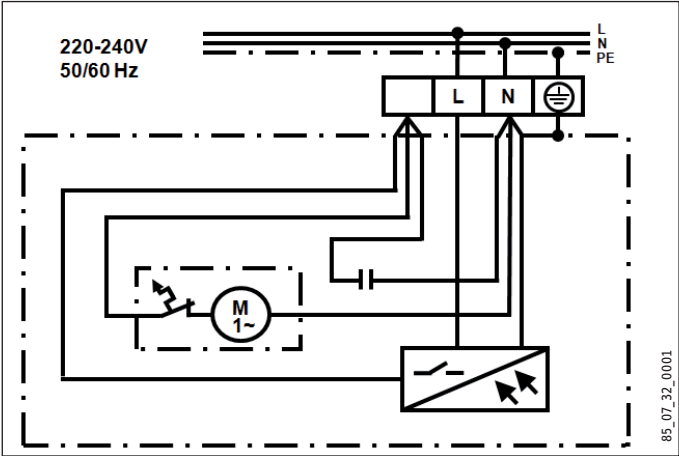

11.2 Minimum clearances and detection range

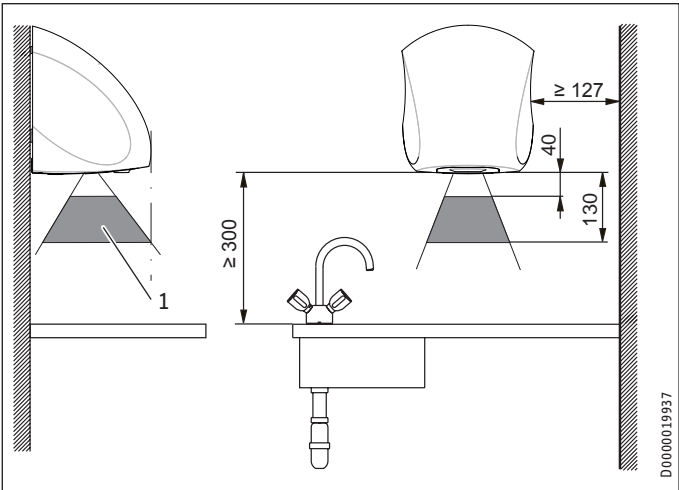

1 IR sensor detection range

11.3 Guidelines for installation height

Note
Height (mm) indicates the clearance between the bottom of the appliance and the floor.

Age	Age	Height (mm)
	Adult man	1350
	Adult woman	1250
	Nursery school	4 - 7 810
	Primary school	7 - 10 910
	High school	10 - 13 1120
	High school	13 - 16 1250

INSTALLATION Specification

11.4 Dimensions and connections

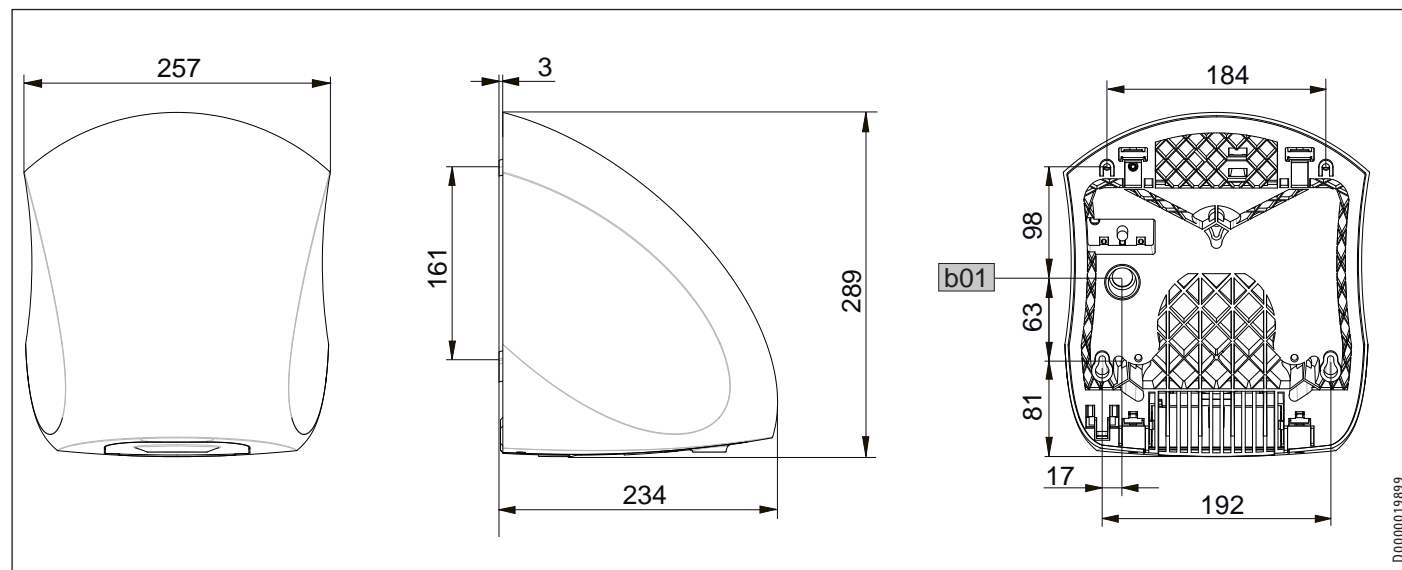

b01 Entry electrical cables
(view from the back of the appliance)

11.5 Data table

		Ultronic S	Ultronic W
		231582	231583
Electrical details			
Power connection		1/N/PE ~ 220-240V	1/N/PE ~ 220-240V
Frequency	Hz	50/60	50/60
Rated voltage	V	230	230
Rated current	A	4,0	4,0
Rated output	W	910	910
Max. mains impedance Zmax to DIN EN 61000-3-11	Ohm	257	257
Dimensions			
Height	mm	289	289
Width	mm	257	257
Depth	mm	234	234
Weights			
Weight	kg	4,4	4,4
Versions			
Colour		Stainless steel	off white, RAL 9003
Casing material		Diecast aluminium	Diecast aluminium
IP-Rating		IP24	IP24
Protection class		I	I
Values			
Operating noise	dB(A)	82	82
Air velocity	m/s	94	94
Air flow rate	m³/h	200	200
Drying time	s	15	15

Warranty

The warranty conditions of our German companies do not apply to appliances acquired outside of Germany. In countries where our subsidiaries sell our products, it is increasingly the case that warranties can only be issued by those subsidiaries. Such warranties are only granted if the subsidiary has issued its own terms of warranty. No other warranty will be granted.

We shall not provide any warranty for appliances acquired in countries where we have no subsidiary to sell our products. This will not affect warranties issued by any importers.

Environment and recycling

We would ask you to help protect the environment. After use, dispose of the various materials in accordance with national regulations.

Stiebel Eltron Warranty for Hand Dryers & Space Heaters – Models HTE, ULTRONIC, CNS, CK & CK Z.

Who gives the warranty

1. The warranty is given by Stiebel Eltron (Aust) Pty Ltd (A.B.N. 82 066 271 083) of 6 Prohasky Street, Port Melbourne, Victoria, 3207 (“we”, “us” or “our”).

The warranty

2. This warranty applies to Stiebel Eltron Hand Dryers and Space Heaters – Models HTE 4, HTE 5, ULTRONIC, CNS 100, CNS 150, CNS 200, CNS 250, CK 20S and CKZ 20S (the “unit”) manufactured after 1 May 2015.

3. Subject to the warranty exclusions we will repair or replace, at our absolute discretion, a faulty component in your unit free of charge if it fails to operate in accordance with its specifications during the warranty period.

4. If we repair or replace a faulty component to your unit under this warranty, the warranty period is not extended from the time of the repair or replacement.

5. The warranty period commences on the date of purchase of the unit. Where the date of purchase is not known, then the warranty period will commence 2 months after the date of manufacture.

6. The warranty period for a unit is shown in the table below.

Component	Warranty period
All components	5 years from the date of purchase of the unit.

Your entitlement to make a warranty claim

7. You are entitled to make a warranty claim if:

7.1. you own the unit or if you have the owner’s consent to represent the owner of the unit;

7.2. you contact us within a reasonable time of discovering the problem with the unit;

How you make a warranty claim

8. To make a warranty claim you must provide us with the following information:

8.1. The model number of the unit;

8.2. A description of the problem with the unit;

8.3. The name, address and contact details (such as phone number and e-mail address) of the owner;

8.4. The address where the unit is installed and the location (e.g. in living room);

8.5. The serial number of the unit;

8.6. The date of purchase of the unit and the name of the seller of the unit;

8.7. The date of installation of the unit where appropriate;

8.8. A copy of the certificate of compliance when the unit was installed where appropriate.

9. The contact details for you to make your warranty claim are:

Name: Stiebel Eltron (Aust) Pty Ltd
Address: 6 Prohasky Street, Port Melbourne, Victoria, 3207
Telephone: 1800 153 351
(8.00 am to 5.00 pm AEST Monday to Friday)
Contact person: Customer Service Representative
E-mail: service@stiebel.com.au

10. We will arrange a suitable time with you to inspect and test the unit.

Warranty exclusions

11. We may reject your warranty claim if:

11.1. The unit was not installed by registered and qualified tradespeople, where required.

11.2. The unit was not installed and commissioned:

(a) in Australia;

(b) in accordance with the Operating and Installation Guide; and

(c) in accordance with the relevant statutory and local requirements of the State or Territory in which the unit is installed.

11.3. The unit has not been operated or maintained in accordance with the Operating and Installation Guide.

11.4. The unit does not bear its original Serial Number or Rating Label.

11.5. The unit was damaged by any or any combination of the following:

(a) normal fair wear and tear;

(b) connection to an incorrect power supply;

(c) connection to faulty equipment, such as faulty circuit breaker;

(d) accidental damage;

(e) act of God, including damage by flood, storm, fire, lightning strike and the like;

(f) wiring not to AS3000 Standards

11.6. The unit was damaged before it was installed e.g. it was damaged in transit.

11.7. An unauthorised person has modified, serviced, repaired or attempted to repair the unit without our consent.

11.8. Non genuine parts other than those manufactured or approved by us have been used on the unit.

12. We may charge you:

12.1. for any additional transport costs if the unit is installed more than 30 kilometres from our closest authorised service technician.

12.2. for the extra time it takes our authorised service technician to access the unit for inspection and testing if it is not sited in accordance with the Operating and Installation Guide and not readily accessible for inspection.

12.3. for any extra costs of our authorised service technician to make the unit safe for inspection.

13. You must ensure that access to the unit by our authorised service technician is safe and free from obstruction.

14. Our authorised service technician may refuse to inspect and test the unit until you provide safe and free access to it, at your cost.

15. If we reject your warranty claim in accordance with clause 11, we may charge you for our authorised service technician's labour costs to inspect and test the unit.

16. In order to properly test the unit we may remove it to another location for testing.

Australian Consumer Law

17. Our goods come with guarantees that cannot be excluded under the Australian Consumer Law. You are entitled to a replacement or refund for a major failure and compensation for any other reasonably foreseeable loss or damage. You are also entitled to have the goods repaired or replaced if the goods fail to be of acceptable quality and the failure does not amount to a major failure.

18. The Stiebel Eltron warranty for the unit is in addition to any rights and remedies you may have under the Australian Consumer Law.

Deutschland

STIEBEL ELTRON GmbH & Co. KG
Dr.-Stiebel-Straße 33 | 37603 Holzminden
Tel. 05531 702-0 | Fax 05531 702-480
info@stiebel-eltron.de
www.stiebel-eltron.de

Verkauf

Tel. 05531 702-110 | Fax 05531 702-95108 | info-center@stiebel-eltron.de

Kundendienst

Tel. 05531 702-111 | Fax 05531 702-95890 | kundendienst@stiebel-eltron.de

Ersatzteilverkauf

Tel. 05531 702-120 | Fax 05531 702-95335 | ersatzteile@stiebel-eltron.de

Australia

STIEBEL ELTRON Australia Pty. Ltd.
6 Prohasky Street | Port Melbourne VIC 3207
Tel. 03 9645-1833 | Fax 03 9645-4366
info@stiebel.com.au
www.stiebel.com.au

Austria

STIEBEL ELTRON Ges.m.b.H.
Eferdinger Str. 73 | 4600 Wels
Tel. 07242 47367-0 | Fax 07242 47367-42
info@stiebel-eltron.at
www.stiebel-eltron.at

Belgium

STIEBEL ELTRON bvba/sprl
't Hofveld 6 - D1 | 1702 Groot-Bijgaarden
Tel. 02 42322-22 | Fax 02 42322-12
info@stiebel-eltron.be
www.stiebel-eltron.be

Czech Republic

STIEBEL ELTRON spol. s r.o.
K Hájem 946 | 155 00 Praha 5 - Stodůlky
Tel. 251116-111 | Fax 235512-122
info@stiebel-eltron.cz
www.stiebel-eltron.cz

Denmark

Pettinaroli A/S
Mandal Allé 21 | 5500 Middelfart
Tel. 06341 666-6 | Fax 06341 666-0
info@stiebel-eltron.dk
www.stiebel-eltron.dk

Finland

STIEBEL ELTRON OY
Kapinakuja 1 | 04600 Mäntsälä
Tel. 020 720-9988
info@stiebel-eltron.fi
www.stiebel-eltron.fi

France

STIEBEL ELTRON SAS
7-9, rue des Selliers
B.P. 85107 | 57073 Metz-Cédex 3
Tel. 0387 7438-88 | Fax 0387 7468-26
info@stiebel-eltron.fr
www.stiebel-eltron.fr

Hungary

STIEBEL ELTRON Kft.
Gyár u. 2 | 2040 Budaörs
Tel. 01 250-6055 | Fax 01 368-8097
info@stiebel-eltron.hu
www.stiebel-eltron.hu

Japan

NIHON STIEBEL Co. Ltd.
Kowa Kawasaki Nishiguchi Building 8F
66-2 Horikawa-Cho
Saiwai-Ku | 212-0013 Kawasaki
Tel. 044 540-3200 | Fax 044 540-3210
info@nihonstiebel.co.jp
www.nihonstiebel.co.jp

Netherlands

STIEBEL ELTRON Nederland B.V.
Daviottenweg 36
5222 BH 's-Hertogenbosch
Tel. 073 623-0000 | Fax 073 623-1141
info@stiebel-eltron.nl
www.stiebel-eltron.nl

Poland

STIEBEL ELTRON Polska Sp. z o.o.
ul. Działkowa 2 | 02-234 Warszawa
Tel. 022 60920-30 | Fax 022 60920-29
stiebel@stiebel-eltron.pl
www.stiebel-eltron.pl

Russia

STIEBEL ELTRON LLC RUSSIA
Urzhumskaya street 4,
building 2 | 129343 Moscow
Tel. 0495 7753889 | Fax 0495 7753887
info@stiebel-eltron.ru
www.stiebel-eltron.ru

Slovakia

TATRAMAT - ohrievače vody, s.r.o.
Hlavná 1 | 058 01 Poprad
Tel. 052 7127-125 | Fax 052 7127-148
info@stiebel-eltron.sk
www.stiebel-eltron.sk

Switzerland

STIEBEL ELTRON AG
Industrie West
Gass 8 | 5242 Lupfig
Tel. 056 4640-500 | Fax 056 4640-501
info@stiebel-eltron.ch
www.stiebel-eltron.ch

Thailand

STIEBEL ELTRON Asia Ltd.
469 Moo 2 Tambol Klong-Jik
Amphur Bangpa-In | 13160 Ayutthaya
Tel. 035 220088 | Fax 035 221188
info@stiebel-eltronasia.com
www.stiebel-eltronasia.com

United Kingdom and Ireland

STIEBEL ELTRON UK Ltd.
Unit 12 Stadium Court
Stadium Road | CH62 3RP Bromborough
Tel. 0151 346-2300 | Fax 0151 334-2913
info@stiebel-eltron.co.uk
www.stiebel-eltron.co.uk

United States of America

STIEBEL ELTRON, Inc.
17 West Street | 01088 West Hatfield MA
Tel. 0413 247-3380 | Fax 0413 247-3369
info@stiebel-eltron-usa.com
www.stiebel-eltron-usa.com

STIEBEL ELTRON



Irrtum und technische Änderungen vorbehalten! | Subject to errors and technical changes! | Sous réserve d'erreurs et de modifications techniques! | Onder voorbehoud van vergissingen en technische wijzigingen! | Salvo error o modificación técnica! | Excepto erro ou alteração técnica | Zastrzeżone zmiany techniczne i ewentualne błędy | Omyly a technické změny jsou vyhrazeny! | A muszaki változtatások és tévedések jogát fenntartjuk! | Отсутствие ошибок не гарантируется. Возможны технические изменения. | Chyby a technické zmeny sú vyhradené!

Stand 8845