

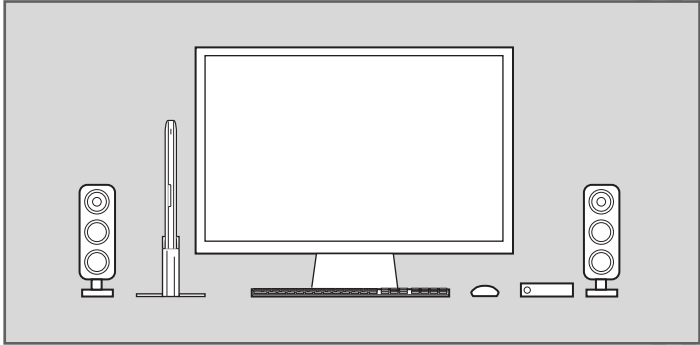

# HENGE • DOCKS™

Instruction Manual and User Guide





Whether you want to clean up your desktop or integrate your MacBook into your home theater system, Henge Docks has you covered. We've designed the Henge Dock system to be as flexible as possible, allowing you to choose only the connections you need, making docking and undocking your MacBook as smooth as possible. For more information email [info@HengeDocks.com](mailto:info@HengeDocks.com) or visit our Support Page at [www.HengeDocks.com](http://www.HengeDocks.com)

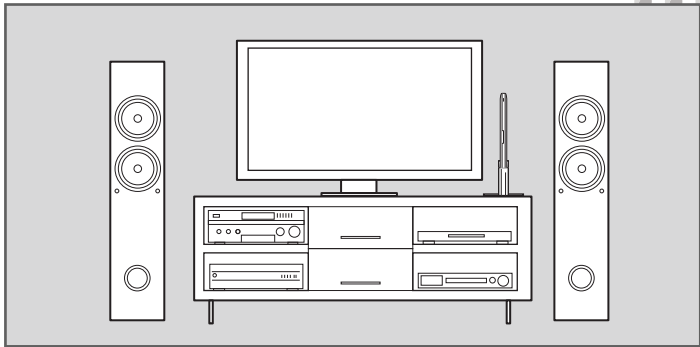

## Port Layouts by Model

**MacBook, Plastic, Version A**  
HD01VAMB  
(Early 2006 to Mid 2009)



**MacBook, Plastic, Version B**  
HD01VBMB  
(Mid 2009 to Current)

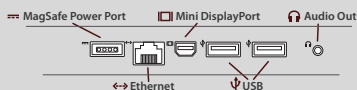

**13-inch MacBook**  
HD01VA13MB  
(Late 2008 to Mid 2009)

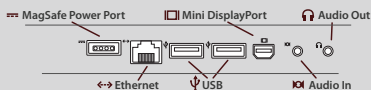

**13-inch MacBook Pro**  
HD01VA13MBP  
(Mid 2009 to Current)

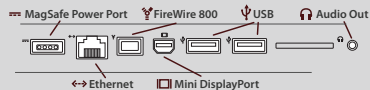

**15-inch MacBook Pro, Version A**  
Model Number - HD01VA15MBP  
(Late 2008 to Mid 2009)

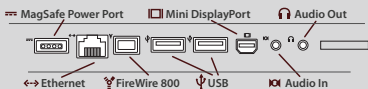

**15-inch MacBook Pro, Version B**  
Model Number - HD01VB15MBP  
(Mid 2009 to Current)

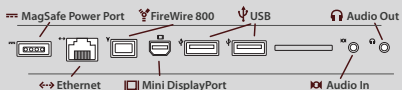

**17-inch MacBook Pro, Version A**  
Model Number - HD01VA17MBP  
(Early 2009 to Mid 2009)

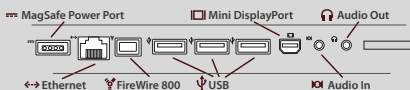

**17-inch MacBook Pro**  
Model Number - HD01VB17MBP  
(Mid 2010 to Current)

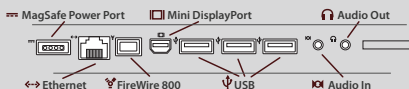

## Included Hardware Chart by Model

### Icon Chart Key

**2x** Quantity Included

**na** Not Applicable



MacBook  
HD01VAMB  
(Early 2006 to  
Mid 2009)

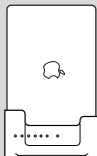

13-inch MacBook  
HD01VA13MB  
(Late 2008 to  
Mid 2009)

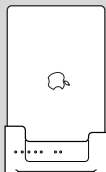

15-inch MacBook Pro  
HD01VA15MBP  
(Late 2008 to  
Mid 2009)

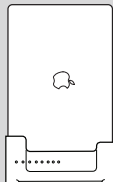

17-inch MacBook Pro  
HD01VA17MBP  
(Early 2009 to  
Mid 2009)

### USB 2.0 Cable



2x

2x

2x

2x

2x

2x

3x

3x

### FireWire Cable



1x

na

na

1x

1x

1x

1x

1x

### Audio In / Out Cable



2x

1x

2x

1x

2x

2x

2x

2x

### Ethernet Cable



1x

1x

1x

1x

1x

1x

1x

1x

### MagSafe Adapter Tool

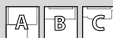

3x

3x

3x

3x

3x

3x

3x

3x



MacBook  
HD01VBMB  
(Mid 2009 to  
Current)

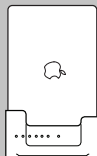

13-inch MacBook Pro  
HD01VA13MBP  
(Mid 2009 to  
Current)

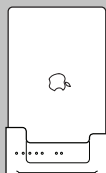

15-inch MacBook Pro  
HD01VB15MBP  
(Mid 2009 to  
Current)

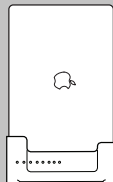

17-inch MacBook Pro  
HD01VB17MBP  
(Mid 2010 to  
Current)

## Internal Port Alignment Notice

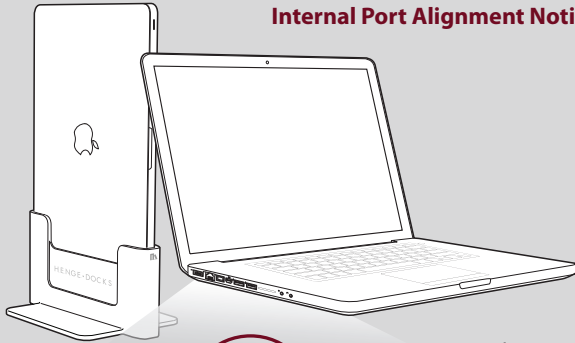

Sample Port Layout



Proper Internal Port Alignment

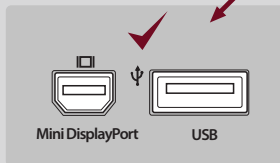

Mini DisplayPort

USB

Example of Internal Port Misalignment

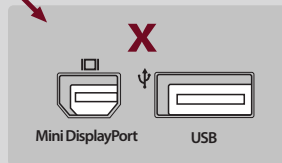

Mini DisplayPort

USB

Apple's line of MacBook computers are designed with ports positioned behind voids in the outer case of the computer for durability and aesthetic purposes. The ports are mounted inside of the case and can become misaligned to their corresponding voids through damage during use or manufacturing variances. While rare, major internal misalignment of the MacBook's ports can cause the connections to bind when used with a Henge Dock, leading to further alignment issues or damage. Henge Docks recommends that users repair and resolve any internal port alignment issues before attempting to setup their Henge Dock.

Do not install Ethernet cable heads fitted with a locking tab into the dock. Use only the tabless head of the included Ethernet cable. Installing a cable head with a locking tab into the dock could result in port damage.

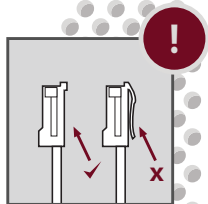

All cable heads installed into this Henge Docks unit will be marked by the set screw during installation, leaving a light cosmetic indentation on the surface of the connector.

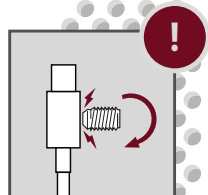

Make sure your grip on the computer is secure before docking and undocking. Dropping the MacBook can damage the ports and dock connectors. Never force the computer onto the dock.

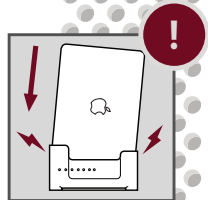

Install only original Henge Docks and Apple sourced accessories into the dock body. Third party cables and accessories may not fit properly in the dock, possibly leading to damaged ports.

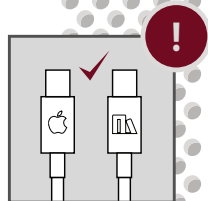

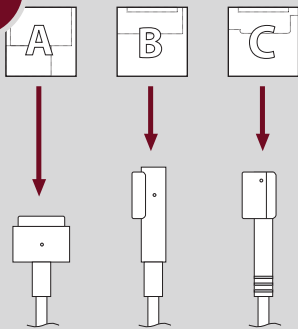
**A**

Select the correct MagSafe Adapter Tool for your type of power supply. Square style MagSafe connectors use style A. Cylindrical style MagSafe connectors included with current MacBooks use style B. MagSafe connectors included with Apple Cinema Displays use style C.

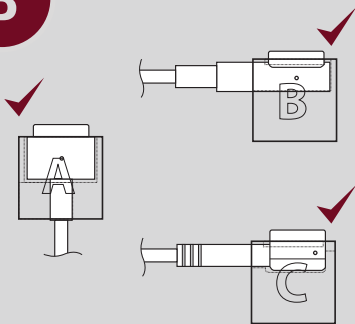
**B**

Clip the selected MagSafe Adapter Tool around the MagSafe connector head as shown.

Place the MacBook into the empty dock, port side facing down.

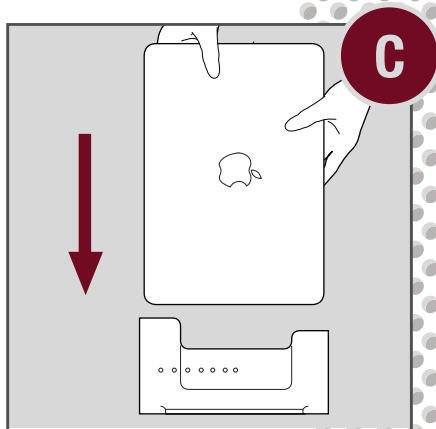

While seated, carefully pick up the dock and MacBook as one unit and flip them over into your lap. The ports on the computer should be visible through the bottom of the dock and lined up with their corresponding voids in the dock.

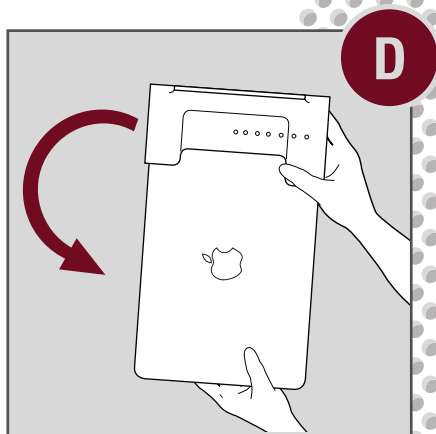

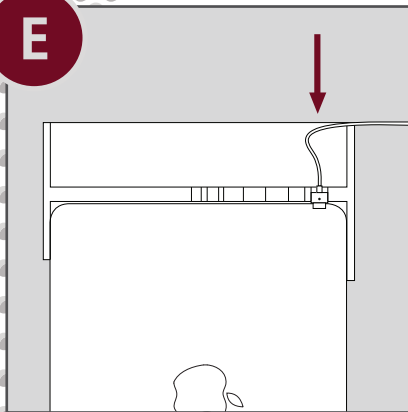

**E**

With the computer and dock inverted, select the MagSafe connector and the Mini Display Port plug. Feed both through the corresponding voids in the dock, plugging them directly into the computer.

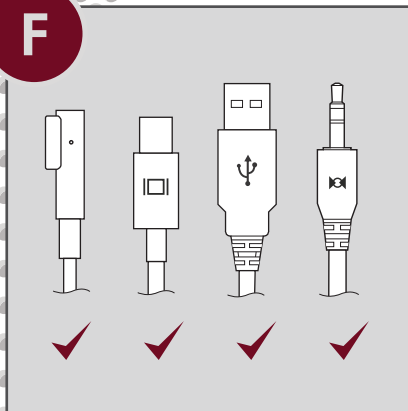
**F**

To ensure proper port alignment all users must install at least one included USB cable into the dock even if no peripherals will be attached.

*Henge Docks recommends that 15-inch and 17-inch MacBook Pro users also install the Line In, Line Out or both Audio Cables to prevent port binding.*

Select and install the other desired connectors in the same manner.

*If installing the Ethernet cable, locate the tabless end of the cable for the setup process.*

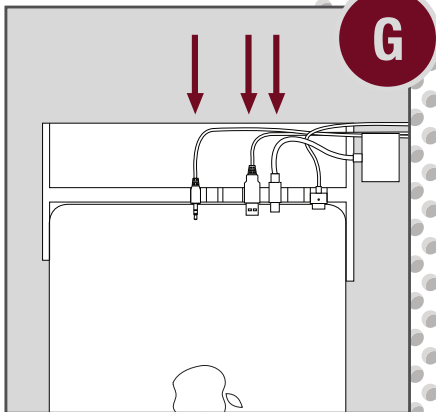

Using the included hex key, insert and carefully tighten a setscrew into each port being installed. Very little effort is required to secure the cable head.

*Over-tightening the setscrew could damage the connector and cause port alignment issues.*

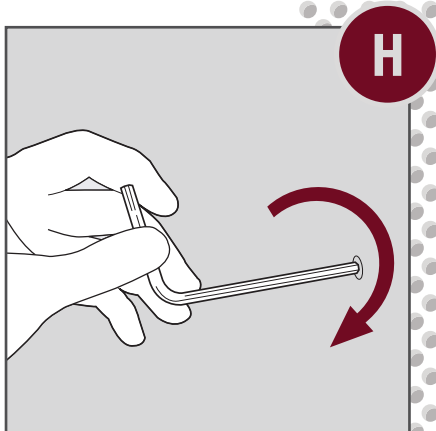

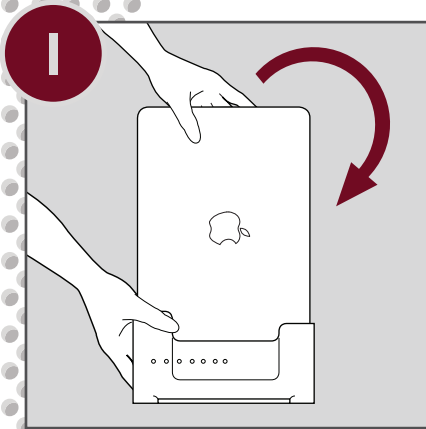

Carefully flip the computer and dock back over, placing the unit on a stable, flat surface. Gather the exiting cables into the channel under the dock.

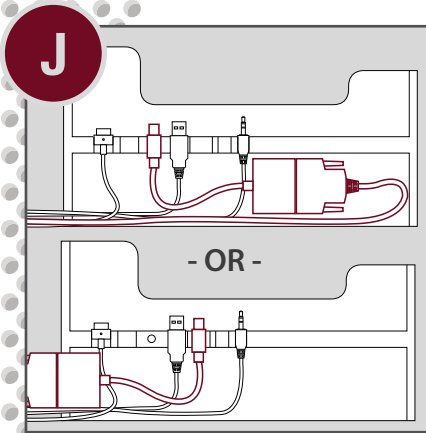

When using an Apple Mini DisplayPort Adapter for an external display, route the cable as shown. All Mini DisplayPort Adapters made by Henge Docks may simply be routed out the rear of the dock.

To undock the computer, place one hand flat on the wing and grasp the upper end of the computer securely with the other hand. Firmly pull the computer vertically to disconnect the ports, then remove the computer from the dock with both hands.

*Never walk or rock the MacBook out of the dock!*

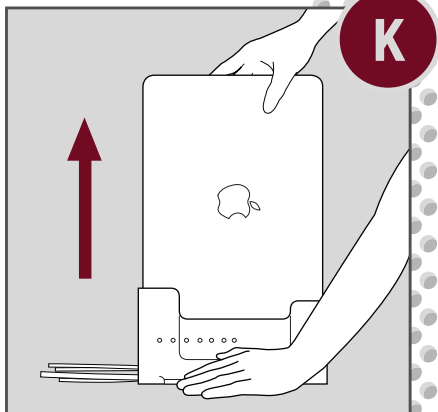

To place the computer in the dock, gently lower the computer vertically onto the connections. No downward force is necessary. The weight of the computer will make all of the connections.

*Dropping, forcing, walking or wobbling the computer into the dock could result in damage to the ports.*

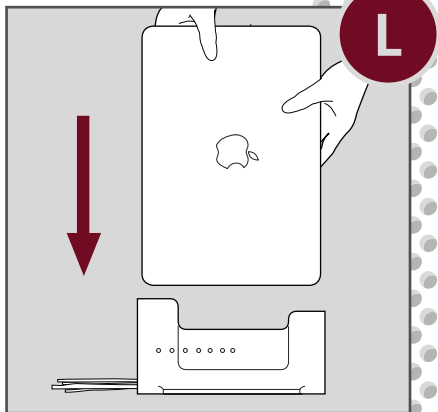

**M**

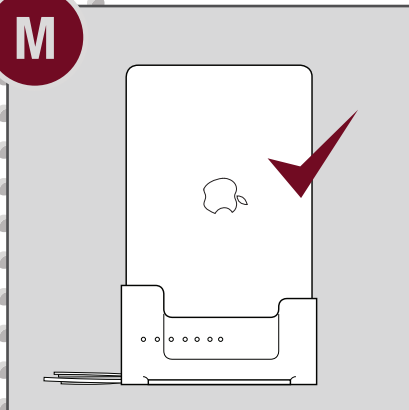

Docking the computer should be effortless. If any resistance is encountered remove and reinstall any connections that may be binding by repeating steps D through H.

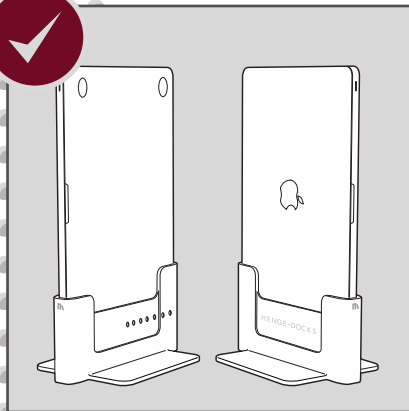

Congratulations, your Henge Docks setup is complete!

## **Trouble Shooting Guide**

### **For all sleep/wake issues -**

All MacBook computers must be connected to a power source, external display, external keyboard and mouse to run in the closed position. Most sleep to wake issues can be resolved by simply repositioning the MagSafe connector in the dock before waking the computer.

If the problem persists remove all of the connections from the dock and reconnect them to the computer in the same configuration, without the dock. With the MacBook still closed, attempt to wake the computer again. If the computer wakes and runs one or more connections was not properly seated in the dock.

If the computer will still not wake properly, remove the cables supplied by Henge Docks and connect the peripherals directly to computer. If the MacBook still fails to wake the issue is independent of the docking system, seek service help for your computer.

### **Mini DisplayPort adapter positioning -**

Due to the short length of the Apple Mini DisplayPort adapters the female end must be placed under the dock body with limited space. The best solution is to purchase the dock specific Mini DisplayPort adapter from Henge Docks, however Apple Adapters can be used.

Position the adapter toward the top of the cutout at the rear of the dock and route the surrounding cables under the adapter (as shown in Step F). The cables may spring back slightly after installation, but they will relax over time.

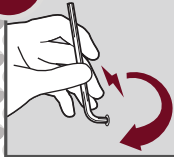

Do not over-tighten the setscrews. Permanent connector damage can result from over-tightening. Very little pressure is required to hold the cable heads into the docking station.

### **Warranty Information and Limitation of Liability**

#### **Warranty -**

This product is warranted for a period of 90 days from date of original purchase. An original sales receipt is required for warranty service. Henge Docks will, at its sole discretion, repair or replace the defective product, or issue a refund of the original purchase price excluding shipping and taxes. Shipping costs to return this product to Henge Docks shall be borne by the warranty claimant.

#### **Limitation of Liability -**

Use this product at your own risk. Henge Docks is not liable for any damage caused by use of a Henge Docks product. In all cases, Henge Docks' liability for any and all damages resulting from the use or misuse of this product shall be limited to the lesser of the original purchase price or \$100.00. The venue for all legal proceedings shall be a court of competent jurisdiction in Virginia, USA. Continued use of this product implies consent to these terms. If you do not agree to these terms, please return this product to the place of purchase within 5 days for a full refund.



[www.HengeDocks.com](http://www.HengeDocks.com) • Designed in the USA by Henge Docks • Manual v3.2  
Manufactured in China • Patent Pending • TM and © Henge Docks, LLC 2011

