

CT1503 Wall Mount ChargePoint™ Networked Charging Station



Installation Instructions



365 Energy N.V.
Bogert 1
5612 LX Eindhoven
Netherlands
0049-30 889 249 523
www.365-energy.com



Coulomb Technologies Inc.
1692 Dell Ave.
Campbell, CA 95008-6901 USA
US toll free: +1-877-370-3802
www.coulombtech.com
www.mychargepoint.net

IMPORTANT SAFETY INSTRUCTIONS SAVE THESE INSTRUCTIONS

This manual contains important instructions that must be followed during installation of the ChargePoint™ Networked Charging Station.

Install using 2mm (12AWG) or larger copper conductors rated for at least 75°C.

Grounding instructions

The ChargePoint™ Networked Charging Station must be connected to a grounded, metal, permanent wiring system; or an equipment-grounding conductor is to be run with circuit conductors and connected to the equipment grounding terminal or lead on the Electric Vehicle Supply Equipment (EVSE). Connections to the EVSE shall comply with all local codes and ordinances.

©2009 COULOMB TECHNOLOGIES INC. All rights reserved. This material is protected by the copyright laws of the United States and other countries. It may not be modified, reproduced or distributed without the prior, express written consent of Coulomb Technologies, Inc.

Safety and compliance

This document provides instructions to install the ChargePoint™ Networked Charging Station and should not be used for any other product. Before installing the ChargePoint™ Networked Charging Station, you should review this manual carefully and consult with a licensed contractor, licensed electrician and trained installation expert to ensure compliance with local building practices, climate conditions, safety standards, and state and local codes.

The ChargePoint™ Networked Charging Station should be installed only by a licensed contractor and a licensed electrician and in accordance with all local and national codes and standards. The ChargePoint™ Networked Charging Station should be inspected by a qualified installer prior to the initial use. Under no circumstances will compliance with the information in this manual relieve the user of his/her responsibility to comply with all applicable codes or safety standards.

No accuracy guarantee

Reasonable effort was made to ensure that the specifications and other information in this manual are accurate and complete at the time of its publication. However, the specifications and other information in this manual are subject to change at any time without prior notice.

Warranty information and disclaimer

Your use of, or modification to, the ChargePoint™ Networked Charging Station in a manner in which the ChargePoint™ Networked Charging Station is not intended to be used or modified will void the limited warranty. Other than any such limited warranty, the Coulomb products are provided "AS IS," and Coulomb and its distributors expressly disclaim all implied warranties, including any warranty of design, merchantability, fitness for a particular purposes and non-infringement, to the maximum extent permitted by law.

Limitation of liability

IN NO EVENT SHALL COULOMB TECHNOLOGIES, INC. OR ITS AUTHORIZED DISTRIBUTORS BE LIABLE FOR ANY INDIRECT, INCIDENTAL, SPECIAL, PUNITIVE, OR CONSEQUENTIAL DAMAGES, INCLUDING WITHOUT LIMITATION LOST PROFITS, LOST DATA, LOSS OF USE, COST OF COVER, OR LOSS OR DAMAGE TO THE CHARGEPOINT™ NETWORKED CHARGING STATION, ARISING OUT OF OR RELATING TO THE USE OR INABILITY TO USE THIS MANUAL, EVEN IF COULOMB TECHNOLOGIES, INC. OR ITS AUTHORIZED DISTRIBUTORS HAVE BEEN ADVISED OF THE POSSIBILITY OF SUCH DAMAGES.

Trademarks

"Coulomb Technologies" and "ChargePoint" are trademarks or service marks of Coulomb Technologies, Inc. in the U.S. and other countries. All other trademarks or service marks mentioned in this document or on the Coulomb Technologies, Inc. website are the property of their respective owners.

Before you start

You will need:

- CT1503 Wall Mount ChargePoint™ Networked Charging Station (2 boxes)
- 20 mm (¾") coupling
- conduit
- 6 mm x 39 mm (¼" x 1 ½") lag screws (6), McMaster P/N 95526A125
- lag screw anchors (6), McMaster P/N 97039A029
- Torx Driver T15 - Tamper-Resistant
- #2 Phillips screwdriver
- #2 Slotted screwdriver

Overview of steps

Installing the CT1503 Wall Mount ChargePoint™ Networked Charging Station involves a few simple steps:

1. Check boxes for correct contents ([see page 4](#))
2. Prepare body assembly for mounting ([see page 5](#))
3. Attach bracket to wall ([see page 7](#))
4. Drill holes in body assembly ([see page 9](#))
5. Attach body assembly to wall bracket ([see page 10](#))
6. Attach coupler and connect conduit ([see page 11](#))
7. Connect wires to wiring terminals ([see page 12](#))
8. Replace bottom plate and front panel ([see page 14](#))
9. Slide head assembly into body ([see page 16](#))
10. Secure head assembly ([see page 17](#))

These steps are detailed on pages 4 to 17 of this document.

Specifications

Charging connection: CEE7 or BS1363 outlet

AC charging power output: 3.7kW (230V at 16A)

AC power input: 230V 16A

Required Panel Mount RCCB with integrated overcurrent protection, ETI Model KZS-2M-B16 rated 230V, 16A, trip curve B, 30mA RCD

Integrated supplementary hardware RCD: 20mA with auto reset (15 minute delay, 3 tries)

EMC compliance: IEC 61851-22:2001; CISPR 22 Class B; CISPR 16 Class B; EN55022; EN61000-3-2; EN61000-3-3; EN301-489-1 V1.8.1; EN301-489-3 V1.4.1

Operating temperature: -30 °C to +50 °C (-22 °F to 122 °F)

Operating humidity: Up to 95%

Voltage and current rating: 230VAC, 16A

Approximate shipping weight: 15 kg (33 lbs)

Outdoor rated: IP44 per IEC 60529

Safety compliance: IEC 61851-1, -22; EN60950-1; EN60950-22

Surge protection: 6kV @ 3000A per IEC1000-4-5. In geographic areas subject to frequent thunder storms supplemental surge protection at service panel is recommended

Step 1 - Check boxes for correct contents

Box 1 - Body Assembly

Box 1 contains:

- Main body
- Wall mount bracket
- Screws and washers (6)
- Template for drilling wall holes
- Allen key
- Installation instructions

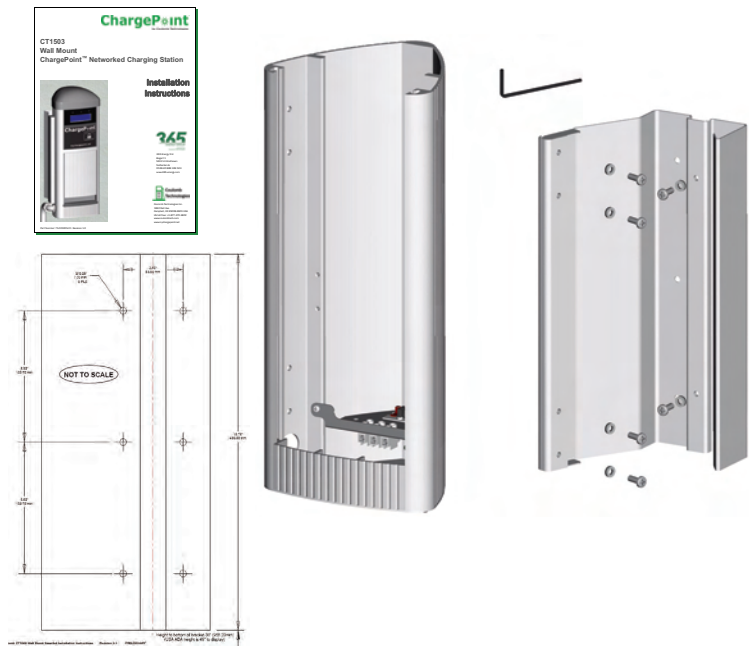

Box 2 - Head Assembly

Box 2 contains:

- Head assembly
- Security screws (4)
- Rubber plugs (4)
- Spare label (keep this label for future reference—it contains important MAC address and serial number information that is needed for system provisioning)



Step 2 - Prepare body assembly for mounting

Remove the front panel:

- Use the supplied allen key to loosen the two screws that fasten the panel to the body.
- Loosen the bonding screw and disconnect the bonding wire.

Slide the front panel upwards to remove.

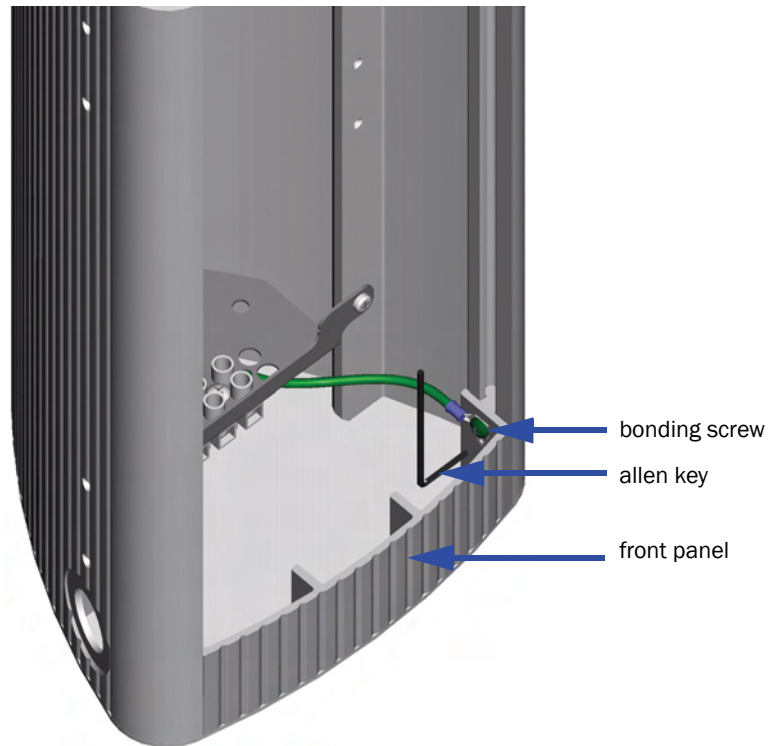

Step 2 cont'd

Remove the bottom plate.

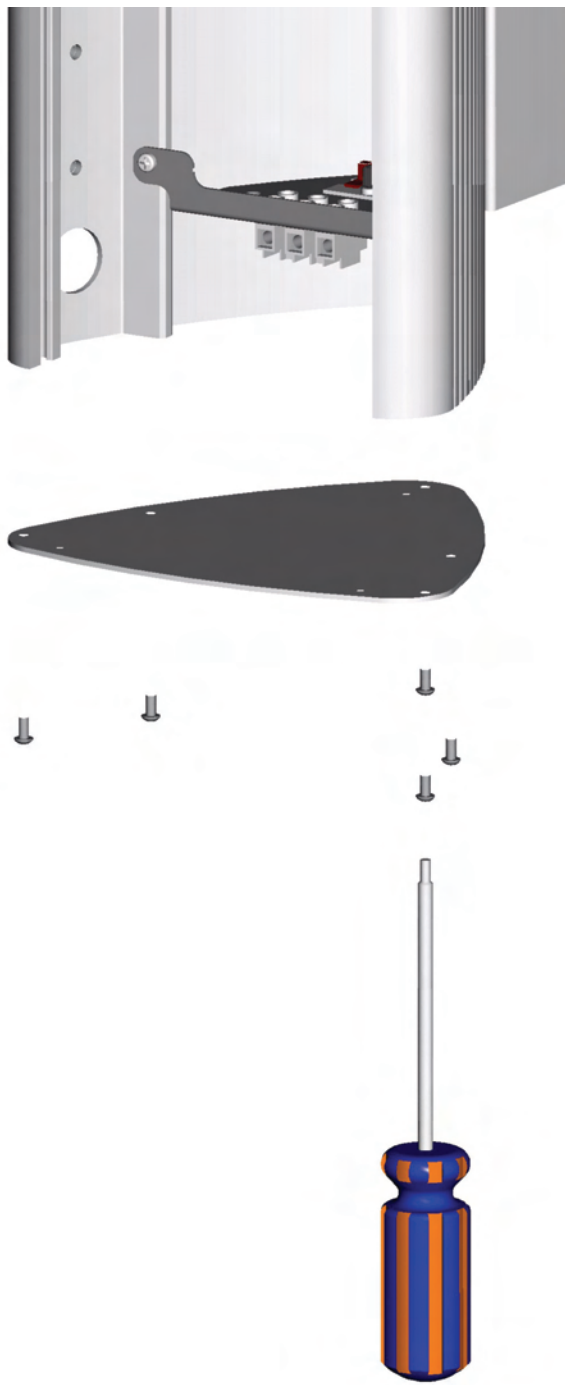

Step 3 - Attach bracket to wall

Drill 6 holes in the wall, as illustrated. Use the supplied template to ensure correct alignment.

! **IMPORTANT:** The maximum height above the surface should be set to meet any local or national requirements for persons with disabilities.

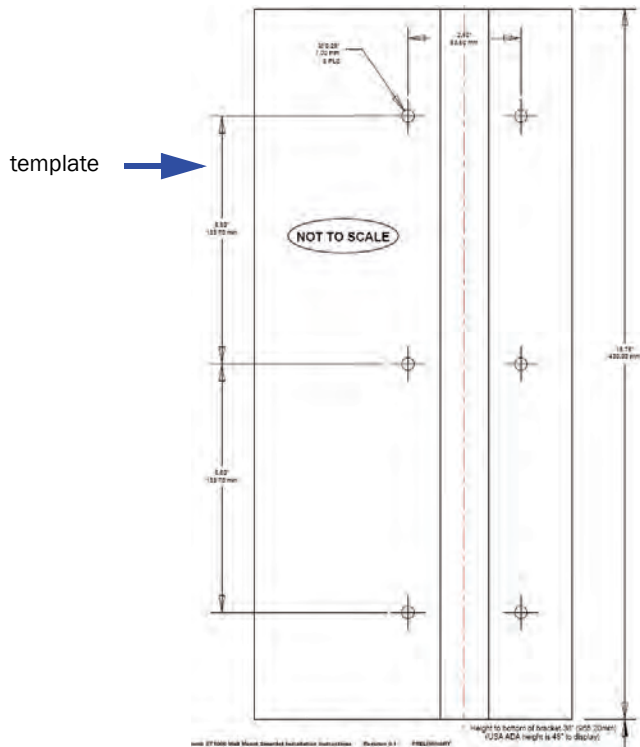

Step 3 cont'd

Using the 6 installer-supplied lag screws and anchors, fasten the wall bracket to the wall.

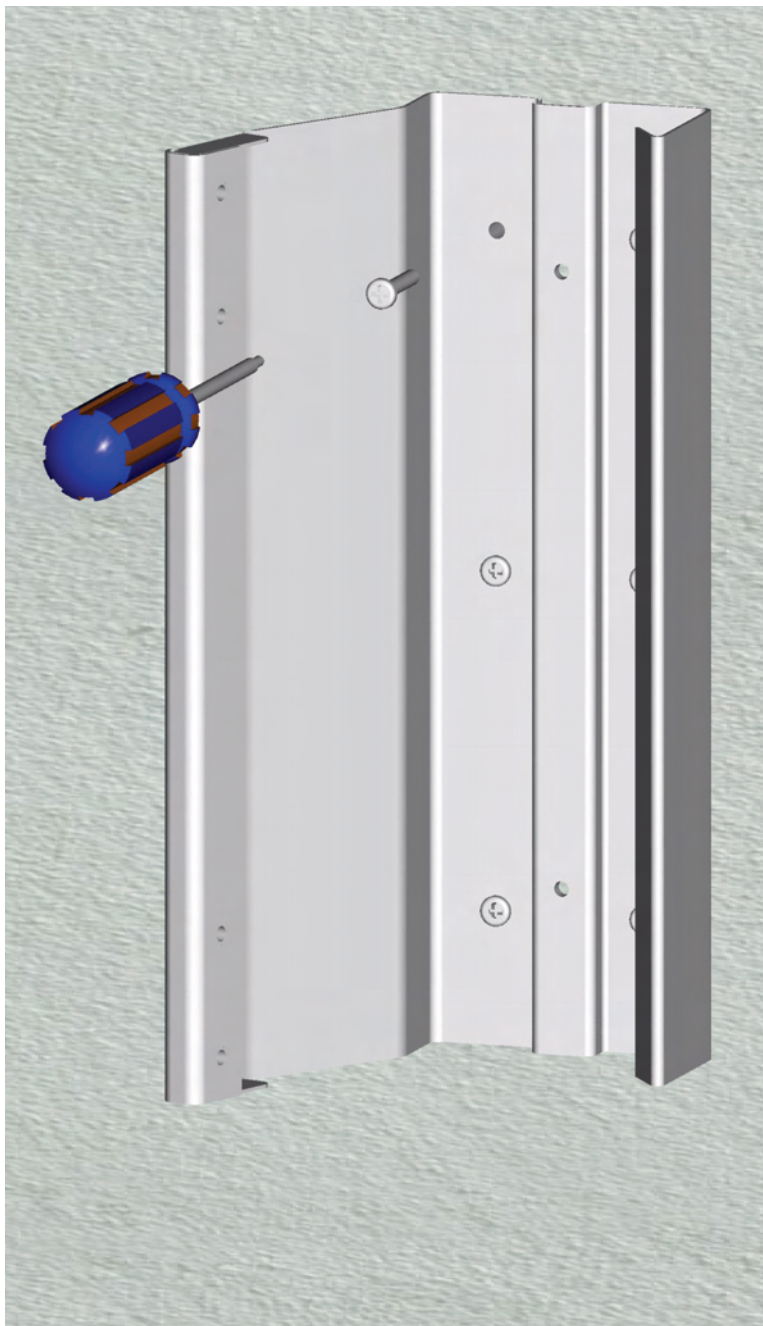

Step 4 - Drill holes in body assembly

Use a 6.5 mm (¼") drill to drill out the 2 mounting holes in the back of the body assembly. These holes are partially pre-drilled.

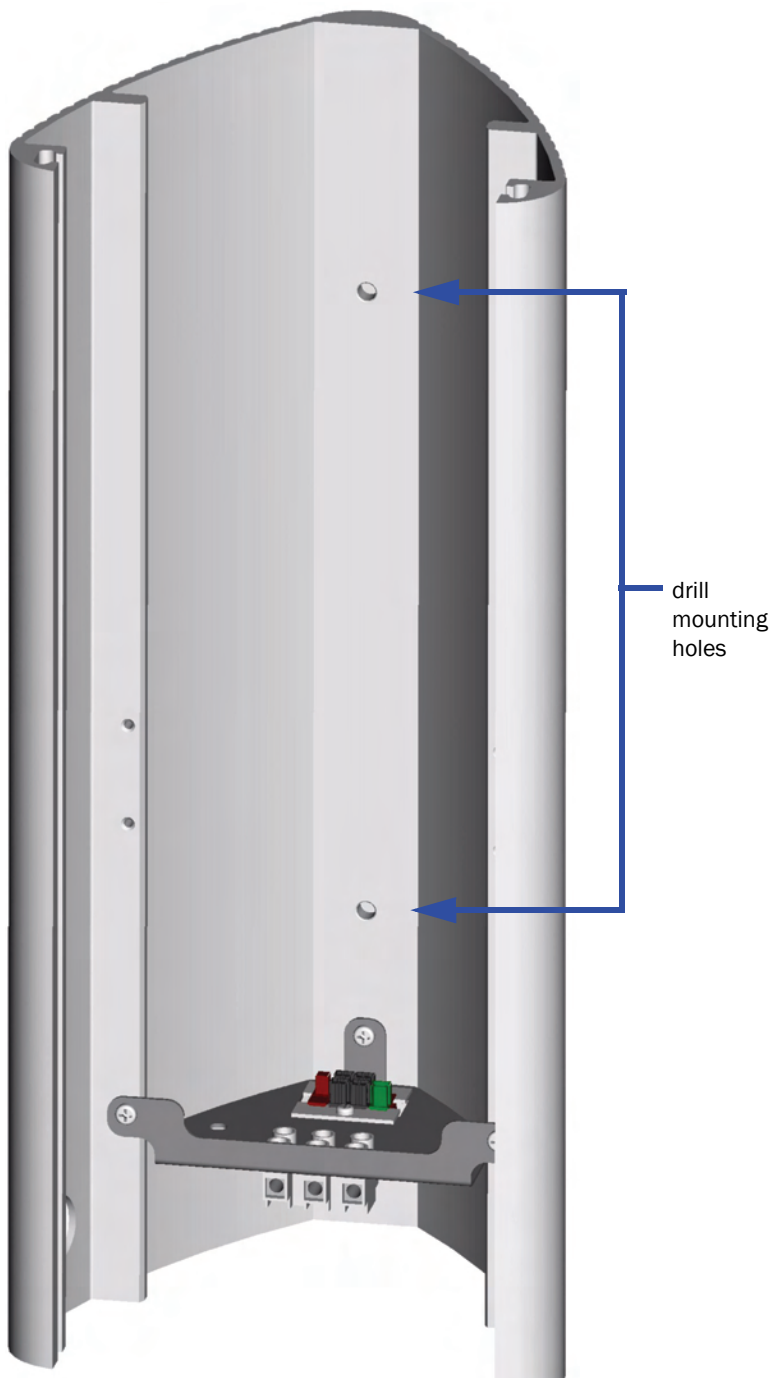

Step 5 - Attach body assembly to wall bracket

Attach the body assembly to the wall bracket using the 6 supplied screws and washers.



Step 6 - Attach coupler and connect conduit

Attach 20 mm ($\frac{3}{4}$ ") installer-supplied coupler to the body assembly, as shown, and connect the conduit.

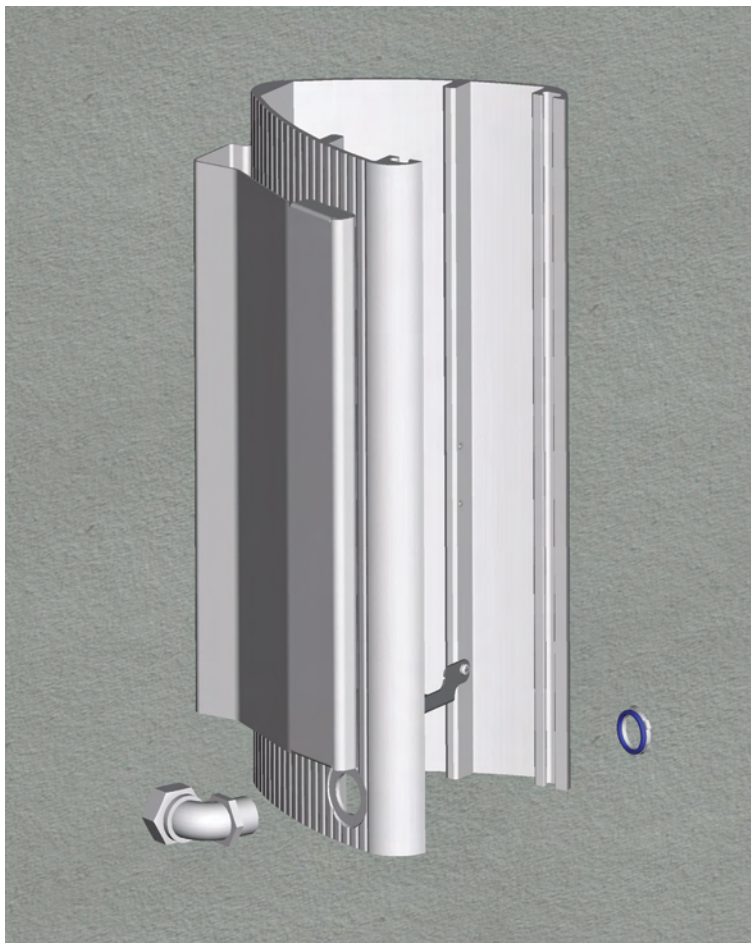

Step 7 - Connect wires to wiring terminals

Pull Line (brown), Neutral (blue), and Protective Earth (green/yellow) wires into body assembly and connect to wiring terminals.

Solid wires are preferred but stranded wires with crimp-on PIN terminators are also OK.



IMPORTANT:

- Requires dedicated 16A, trip curve B, breaker with integral 30mA RCD. Install ETI Model KZS-2M-B16 integrated RCCB in building panel. This Equipment has been evaluated as Overvoltage Category II—do not connect directly to power distribution network without additional surge protection (Overvoltage Category III per IEC 60664). See label located on power plate.

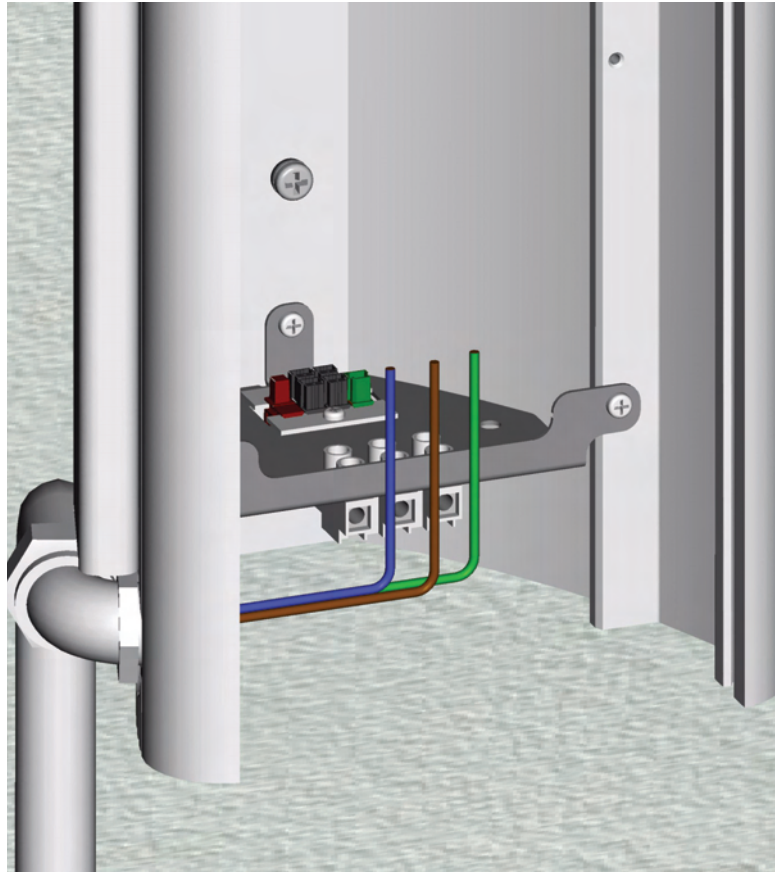

Step 7 cont'd

Strip wires, insert in terminal block, and tighten screws to 2.1 Nm (18.5 inch-lbs).

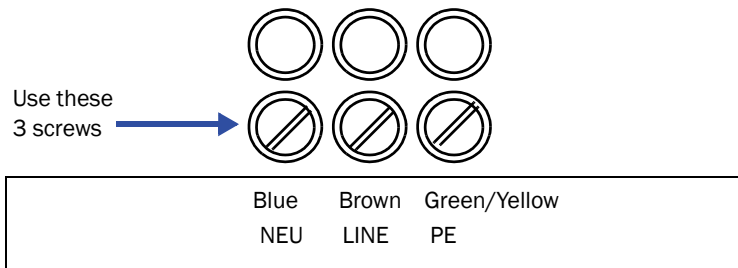
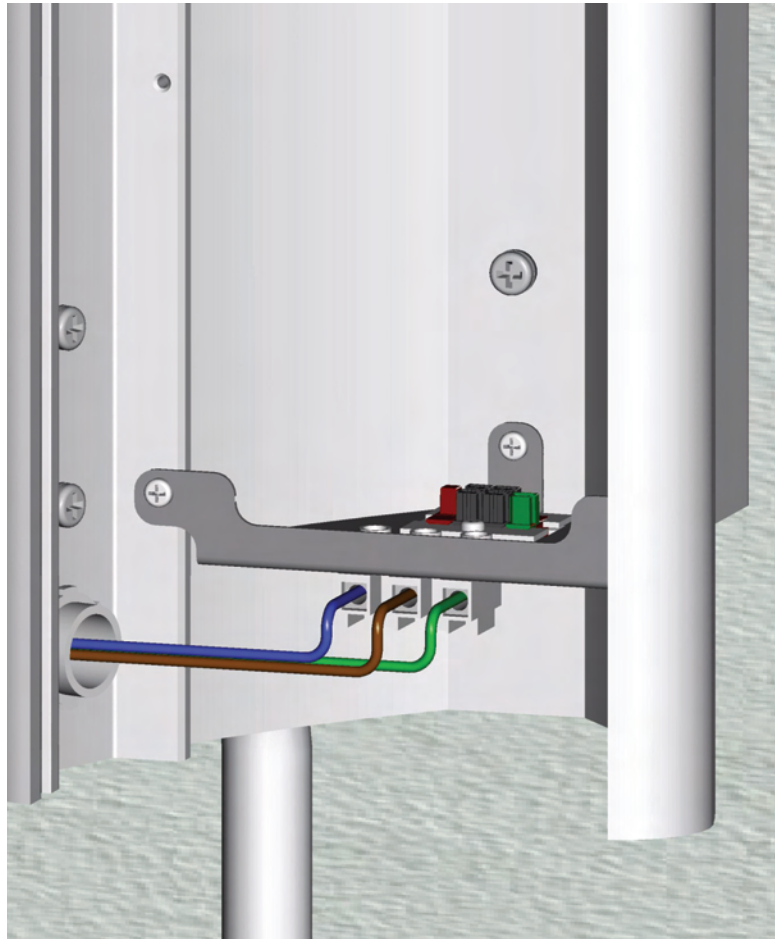

Step 8 - Replace bottom plate and front panel

Using a Torx driver, secure the bottom plate to the body assembly with the 5 supplied tamper-resistant security screws.

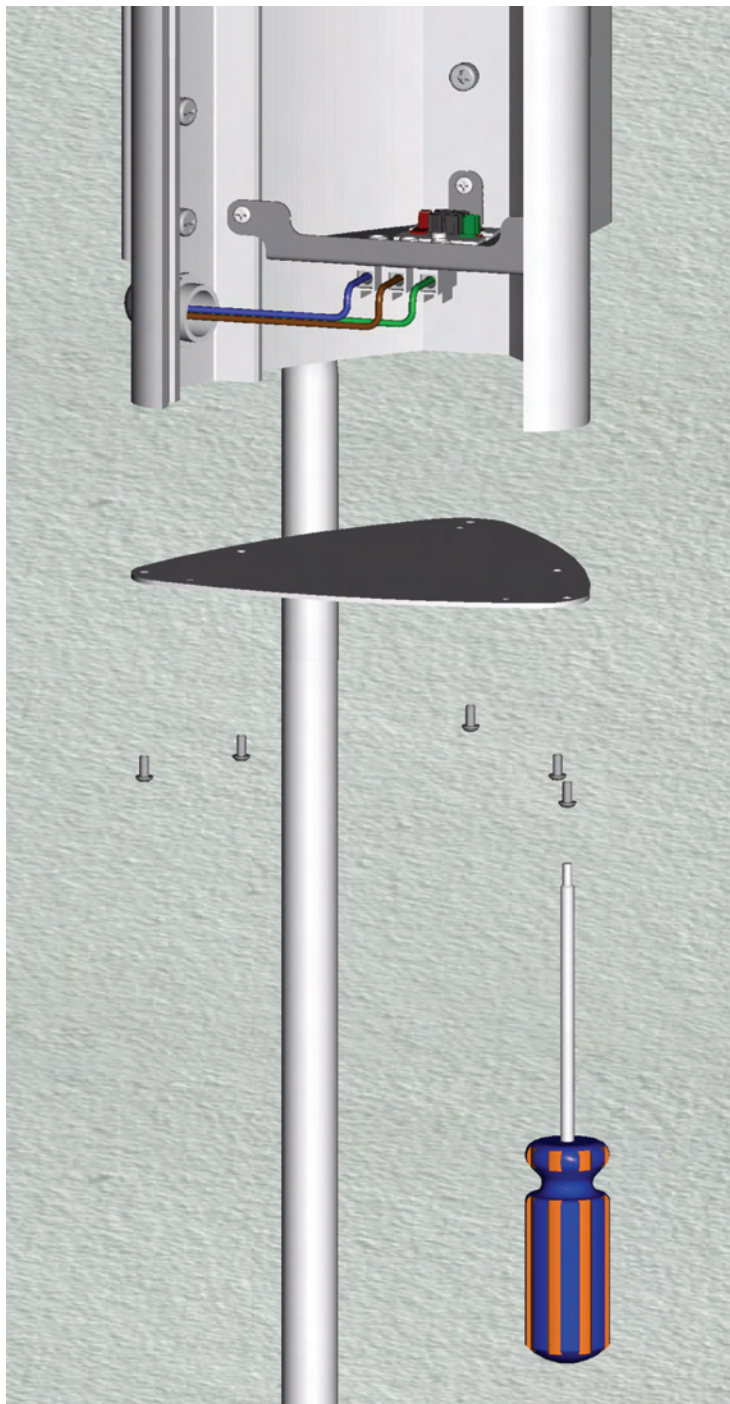

Step 8 cont'd

Slide the front panel into place. Use the supplied allen key to tighten the two set screws.

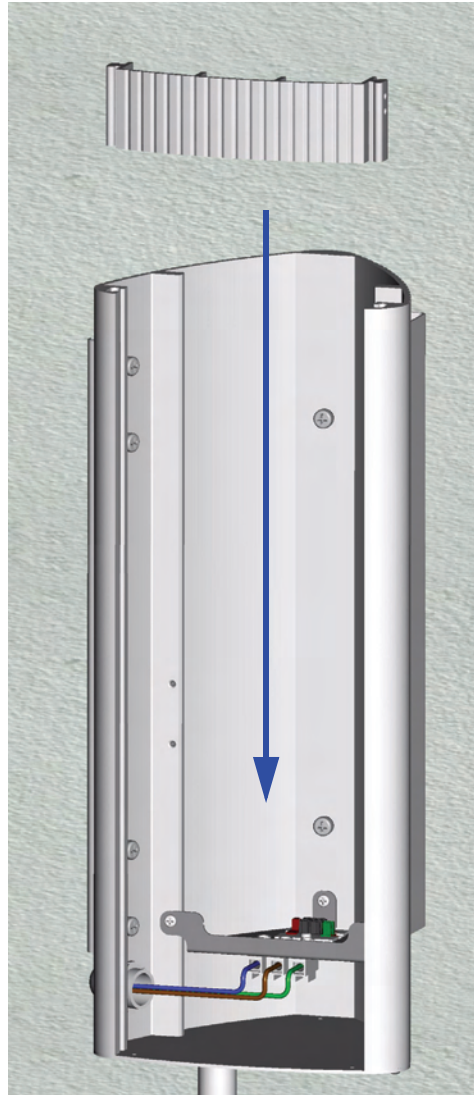

Re-attach bonding wire and tighten screw.

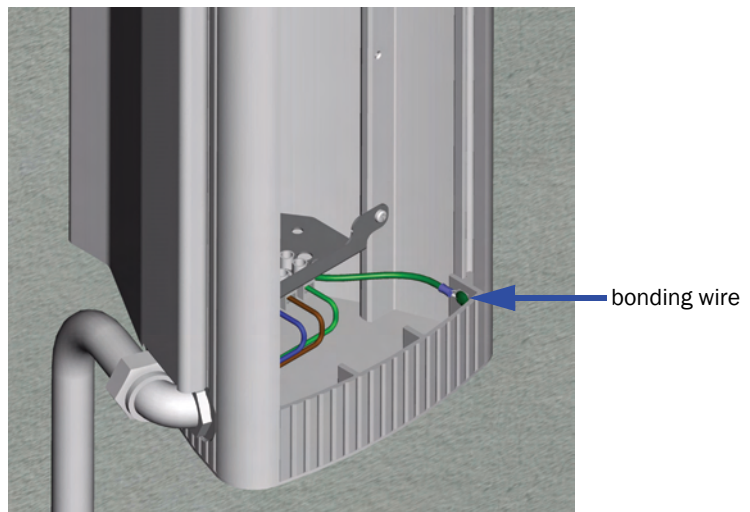

Step 9 - Slide head assembly into body

Slide the head assembly into body far enough to connect “pigtail” connector.

Connect pigtail connector.

The head assembly will power-up.

Firmly slide head module all the way into body.

Open door and check alignment of security screw holes.

Press down on head assembly to seat gaskets, if necessary.

TIP: The door remains unlocked for 30-60 seconds after you plug in the pigtail connector. By holding it open, you can proceed with Step 10 without having to open it with the smart card.



Step 10 - Secure head assembly

If necessary, open the door using the smart card.

Using a Torx driver, secure the head assembly with the 4 supplied tamper-resistant security screws.

 **IMPORTANT:** Do NOT overtighten. Lightly finger-tighten only.

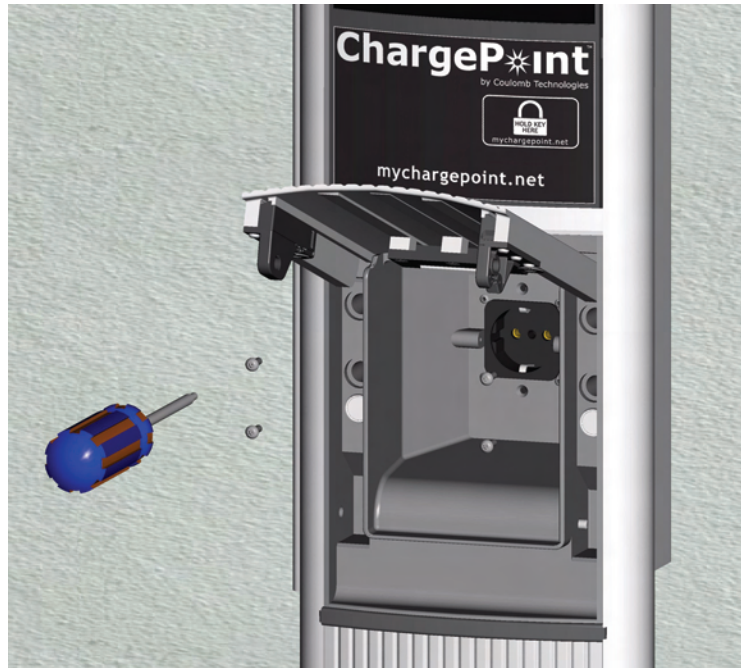

Insert the 4 supplied rubber plugs and press firmly into place.

 **IMPORTANT:** The plugs MUST be flush with the surface or the door will not close properly.

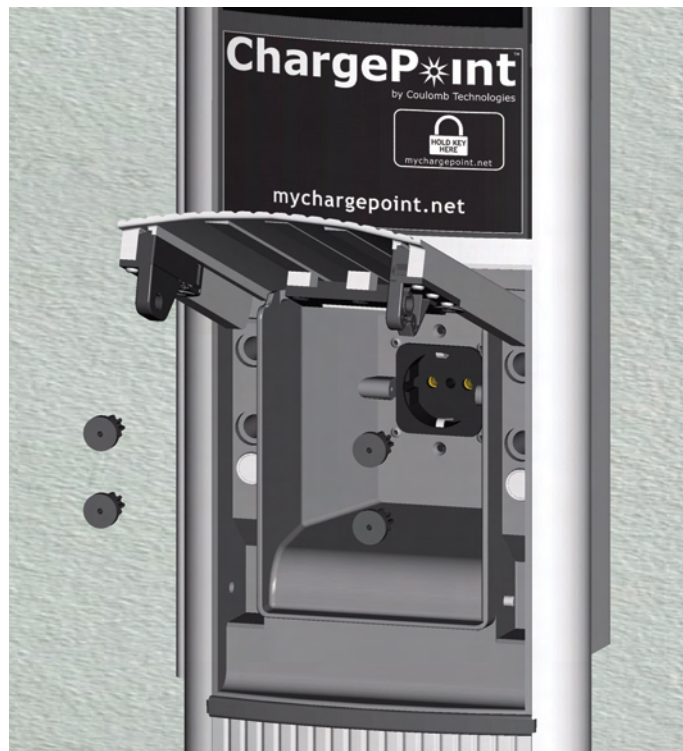

You have now finished installing the CT1503 ChargePoint™ Networked Charging Station.