

BESPOKE FAQs

What type of warranty do the Bespoke panels include?

A: All Bespoke panels come with a 7-day cosmetic warranty. If there are any issues, customers can call 1-800-SAMSUNG(726-7864).

Can I put my own custom panels on the Bespoke panel-ready fridges?

A: No, you cannot. Bespoke panel-ready fridges require Bespoke panels to be installed. There will be 11 colours available for the French Door models and 6 colours for the Column models.

What type of material do the Bespoke panels use?

A: Bespoke panels are made of stainless steel or durable tempered glass depending on the colour chosen.

Are the Bespoke panels fingerprint resistant?

A: All Bespoke panels are fingerprint resistant.

What is required for installation?

A: Nothing is required to install a Bespoke panel on a French Door Fridge, but it is recommended to use a suction cup when installing on a Column model. You can purchase Samsung's RA-A00UAAAA suction cup if you do not already have one.



What is required to remove a Bespoke panel?

A: A suction cup is required in order to safely remove the Bespoke panel from the fridge. Make sure to remove the caps on the door before removing the Bespoke panel. You can purchase Samsung's RA-A00UAAAA suction cup if you do not already have one.



Can you pair the Bespoke Column Models together?

A: Yes, you can! You can pair Bespoke Column Models with the RA-C07K1BAA pairing kit. You will need another pairing kit for every extra Bespoke Column Model. For example, if you are pairing 3 Bespoke Column Fridges together, you will need 2 Column Pairing Kits.

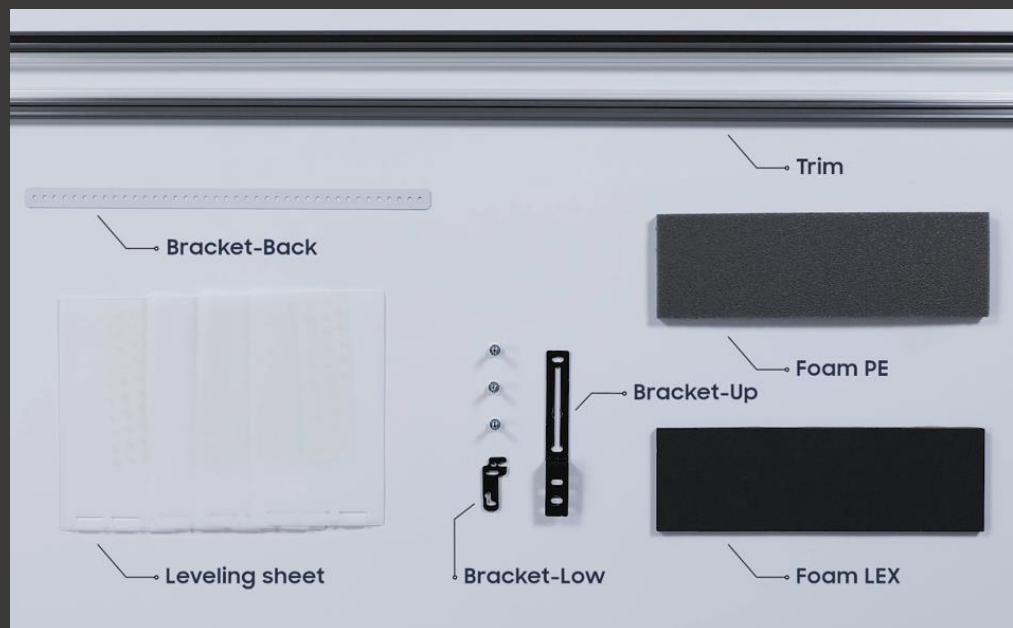

What panel colours are available for Bespoke fridges?

A: Bespoke French Door Models have 11 panel colours to choose from. These include Emerald Green Steel, Black Matte Steel, Navy Steel, Stainless Steel, Sunrise Yellow Glass, Pink Glass, Clementine Glass, Morning Blue Glass, White Glass, Charcoal Glass and Grey Matte Glass.

There will be 6 panel colours to choose from for the Bespoke Column models. These include White Glass, Rose Pink Glass, Navy Glass, Grey Matte Glass, Sky Blue Glass and Beige Matte Glass.

What is the difference between QL and AP in Bespoke fridge models?

A: Bespoke fridge models containing the letters QL (e.g. RF23BB8200QLAA) will come with pre-installed Stainless Steel Bespoke Panels. You will find this option for the 3-Door or 4-Door French Bespoke Fridges. Where as, Bespoke fridge models containing the letters AP (e.g. RF23BB8200APAA) will require Bespoke panels to be purchased.



What colours are available for the Bespoke dishwasher?

A: The DW80B7070AP Bespoke Dishwasher allows you to install one of three Bespoke Panels. These include Navy Steel, White Glass and Grey Matte Glass. If you are looking for Stainless Steel or Black Stainless Steel, you can go with the DW80B7070US or DW80B7070UG respectively. Keep in mind that these 2 colours do not offer removable Bespoke panels.

Bespoke Dishwasher Panels

Navy Steel:

White Glass:

Grey Matte Glass:

Can you remove panels from all Bespoke appliances?

A: You can only remove panels from the Bespoke Fridges or Dishwasher and will require a suction cup in order to do so. These models will contain the letters AP (e.g. DW80B7070AP).

What colours are available for the Bespoke ranges?

A: Bespoke ranges are currently available in Navy Steel and White Glass. Keep in mind that these colours are not removable Bespoke panels.

Bespoke Electric Ranges

Navy Steel

White Glass

Bespoke Gas Ranges

Navy Steel

White Glass



NE63A8711QN



NE63BB87112AC

What colours are available for the Bespoke OTRs?

A: Bespoke OTRs are currently available in Navy Steel and White Glass. Keep in mind that these colours are not removable Bespoke panels.

Bespoke OTRs

Navy Steel

White Glass



ME21A706BQN



ME21A706B12

Can you remove the Bespoke panel on the Family Hub screen door?

A: No, you cannot. The 4-Door Family Hub Bespoke Fridge only allows you to customize panels on the other doors (i.e. left fridge, middle drawer and freezer). This means that you will need to determine if you would prefer a White Glass or Charcoal Glass on the Family Hub screen door.

4-Door Family Hub Bespoke Fridge

White Glass (C/D): RF23BB8900AWAC

White Glass (F/D): RF29BB8900AWAC

Charcoal Glass (C/D): RF23BB8900ACAC

Charcoal Glass (F/D): RF29BB8900ACAC

Pre-installed Bespoke Panels

RF29BB89008MAC (F/D Only)

Charcoal Glass for the Fridge Doors and Black Matte Steel for the FlexZone Drawer and Freezer.

