



Peppa's Big Day



Instruction Manual

This guide contains important information. Please save it for future reference.

© 2023 ABD Ltd/Ent. One UK Ltd/Hasbro

Licensed by:



INTRODUCTION

Thank you for purchasing the **Peppa Pig Peppa's Big Day** learning video game! Join Peppa Pig as she gets ready for school, engages in fun-filled activities at her playgroup, goes on field trips with her classmates and more!

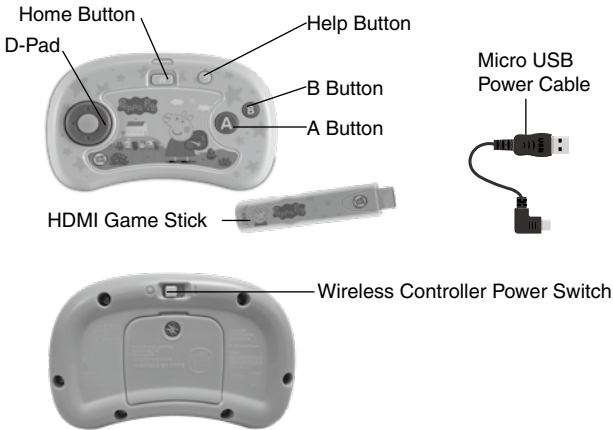

INCLUDED IN THE PACKAGE

- 1 wireless controller
- 1 HDMI game stick
- 1 micro USB power cable
- Quick Start Guide

WARNING

All packing materials such as tape, plastic sheets, packaging locks, removable tags, cable ties, cords and packaging screws are not part of this toy and should be discarded for your child's safety.

NOTE

Please save this Instruction Manual as it contains important information.

GETTING STARTED

Initial Setup

1. Plug the USB B Connector end of the **Micro USB Power Cable** into the USB B port on the **HDMI Game Stick**.
2. Plug the **HDMI Game Stick** into an HDMI port on your television.
3. Plug the USB A Connector end of the **Micro USB Power cable** into a USB port on your television.
4. Make sure your television is set to display the same HDMI port that the **HDMI Game Stick** is plugged into.
5. Find the battery cover located on the back of the **Wireless Controller**, use a screwdriver to loosen the screw and then open the battery cover.*
6. Remove old batteries by pulling up on one end of each battery.
7. Install 2 new AA (AM-3/LR6) batteries following the diagram inside the battery box. (For best performance, alkaline batteries or fully charged Ni-MH rechargeable batteries are recommended.)
8. Replace the battery cover and tighten the screw to secure.
9. Turn the power switch on the device to On.

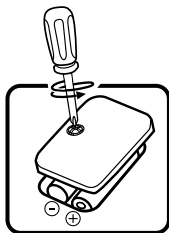
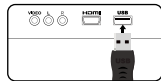
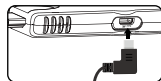

* To ensure proper connectivity, install batteries in the device after the **HDMI Game Stick** has been plugged into the television.

NOTE

The **HDMI Game Stick** is only compatible with television sets and is not compatible with computers or computer monitors.

WARNING:

Adult assembly required for battery installation.
Keep batteries out of reach of children.

IMPORTANT: BATTERY INFORMATION

- Insert batteries with the correct polarity (+ and -).
- Do not mix old and new batteries.
- Do not mix alkaline, standard (carbon-zinc) or rechargeable batteries.
- Only batteries of the same or equivalent type as recommended are to be used.
- Do not short-circuit the supply terminals.
- To save battery power, turn off the controller when it is not in use.
- Remove batteries during long periods of non-use.
- Remove exhausted batteries from the toy.
- Dispose of batteries safely. Do not dispose of batteries in fire.
- Disposal of a battery into fire or a hot oven, or mechanically crushing or cutting of a battery, that can result in an explosion;
- Leaving batteries in extremely high temperatures may result in an explosion or can cause leakage of flammable liquids or gas.
- A battery subjected to extremely low air pressure may result in an explosion or the leakage of flammable liquid or gas.

RECHARGEABLE BATTERIES

- Remove rechargeable batteries (if removable) from the toy before charging.
- Rechargeable batteries are only to be charged under adult supervision.
- Do not charge non-rechargeable batteries.

NOTE

If the **Wireless Controller** turns itself off or if the light fades out during play, please install a new set of batteries.

Disposal of batteries and product



The crossed-out wheellie bin symbols on products and batteries, or on their respective packaging, indicates they must not be disposed of in domestic waste as they contain substances that can be damaging to the environment and human health.



The chemical symbols Hg, Cd or Pb, where marked, indicate that the battery contains more than the specified value of mercury (Hg), cadmium (Cd) or lead (Pb) set out in the Batteries and Accumulators Regulation.

The solid bar indicates that the product was placed on the market after 13th August, 2005.



Please dispose of your product and batteries responsibly.

In the UK, give this toy a second life by disposing of it at a small electricals collection point* so all of its materials can be recycled.

Learn more at:

www.leapfrog.com/en-gb/recycle

www.leapfrog.com/en-au/recycle

* Visit www.recyclenow.com to see a list of collection points near you.





Safety information when using power supply for toys

LeapFrog recommend a power supply (AC/DC adaptor) of the below specification:

Power rating: 5V/500mA or 5V/1A DC output

- Use Leapfrog or any standard adaptor that complies with EN61558
- This toy shall only be used with a power supply for toys.
- The power supply is not a toy.
- This toy is not intended for use by children under 3 years old.
- Do not connect the toy to more than the recommended number of power supplies.
- Never clean a plugged in toy with liquid.
- Please examine the power supply periodically for conditions that may result in the risk of fire, electric shock, or injury to persons (such as damage to the supply cord, output cord, plug, blades, housing, or other parts) and that, in the event of such conditions, the power supply should be scrapped.
- Power supplies for toys are not intended to be used as toys, and the use of these products by children shall be under the full supervision of parents.

This toy is only to be connected to equipment bearing either of the following symbols:  or 

Warning! Not suitable for children under 36 months. Transformer toy. Electric shock hazard.

PRODUCT FEATURES

1. D-Pad

- Press the **D-Pad** on the **Wireless Controller** to select an item on the Menu screen.
- See Games section below for **D-Pad** usage in individual games.

2. Home Button

- Press the **Home Button** on the **Wireless Controller** to quit a level, quit the game, or return to the previous Menu screen.

3. Help Button

- Press the **Help Button** on the **Wireless Controller** to hear hints and tips on how to play the game or navigate the Menu screen.

4. A Button

- Press the **A Button** on the **Wireless Controller** to select the highlighted objects on the Menu screen.
- See Games section below for **A Button** usage in individual games.

5. B Button

- Press the **B Button** on the **Wireless Controller** to return to the previous Menu screen.
- See Games section below for **B Button** usage in individual games.

6. Menu Screens

- The following Menu screens appear in the game.

Profile Selection Screen

- Create or delete a saved profile on the Save Selection screen.
- If a saved file has been accidentally deleted, highlight a New save slot and press the following buttons on the Wireless Controller: Home + Home + Help + Help + B + B + Help + Home + B. This will also unlock all the missions in the game.



Game Mode Screen

- Play games sequentially by selecting Play, or individual games in Quick Play mode.



Week Menu Screen

- Access the different games from the Week menu screen.
- The player will need to get one star in each game per day before the next day is unlocked.

Day Menu Screen

- Select a game within a specific day.
- Stars earned during gameplay will display below each game's icon.

Quick Play Menu

- Access individual games in the Quick Play menu.



7. Games

Game 1: Fix the Path

- Press the **D-Pad** to select a piece of the path to fix
- Press the **A Button** to turn the piece
- Press the **B Button** to send Peppa down the path

Game 2: Archery

- Press the **D-Pad** up and down to aim at a target
- Press the **A Button** to send an arrow towards the target

Game 3: Tidying Up

Searching

- Press the **D-Pad** to move the magnifying glass
- Press the **A Button** to select an item that's highlighted by the magnifying glass

Sorting

- Press the **D-Pad** left and right to select a basket
- Press the **A Button** to put the item into the basket

Game 4: Cooking

- Press the **D-Pad** down to slice the ingredients
- Press the **D-Pad** left and right to stir
- Press the **A Button** to add/shake/crack the ingredients
- Press the **B Button** to blend the ingredients

Game 5: Sack Race

Matching

- Press the **D-Pad** left and right to choose the matching sack
- Press the **A Button** to select the matching sack

Racing

- Press the **A Button** to make Peppa jump faster

Game 6: Keepy Uppy

- Press the **D-Pad** left and right to move Peppa
- Press the **A Button** to jump up

Game 7: Pirate Island

- Press the **D-Pad** up and down to move the boat
- Press the **A Button** to speed up the boat

Game 8: Freeze Dance

Rhyming

- Press the **D-Pad** left and right to select the picture of the word that completes the rhyme
- Press the **A Button** to confirm the selection

Dancing

- Press the **A Button** to make Peppa dance
- Press the **B Button** to perform a special dance move

8. Automatic Shut-Off

To preserve battery life, the **Wireless Controller** will automatically go into sleep mode after approximately 1 minute without input. The unit can be turned on again by pressing the **D-Pad**, **Home Button**, **A Button**, or **B Button**.

9. Screen Saver Mode

Peppa's Big Day learning video game will automatically save and quit the current game, then go into Screen Saver mode after approximately 20 minutes without input. To exit Screen Saver mode, press the **D-Pad**, **Home Button**, **A Button**, or **B Button** on the **Wireless Controller**.

Recommended AC Adapter Electrical Ratings:

Input: ~ 120VAC, 60Hz (for US); ~ 230VAC, 50Hz (for UK or EU);

~ 240VAC, 50Hz (for AS/NZL)

Output:  DC5V, 1.5A, 7.5VA or  DC5V, 1A, 5VA or

 DC5V, 0.5A, 2.5VA

CARE & MAINTENANCE

1. Keep the unit clean by wiping it with a slightly damp cloth.
2. Keep the unit out of direct sunlight and away from any direct heat sources.
3. Remove the batteries if the unit will not be in use for an extended period of time.
4. Do not drop the unit on hard surfaces and do not expose the unit to moisture or water.
5. Always keep the **Wireless Controller** and **HDMI Game Stick** away from water.
6. Examine the **Micro USB Power Cable** regularly, checking for damage to the cable, plugs and other parts. Do not use a third party adapter. Do not use the **Micro USB Power Cable** if there is any damage.

TROUBLESHOOTING

If you are unable to insert the **HDMI Game Stick** directly into the HDMI port on your television due to clearance issues, a third-party HDMI extension cable may be a good solution. A short HDMI extension cable can be purchased from major electronics retailers.



If for some reason the unit stops working or malfunctions, please follow these steps:

HDMI Game Stick

1. Interrupt the power supply by unplugging the USB A Connector end of the **Micro USB Power Cable** from the USB port on your television.
2. Unplug the **HDMI Game Stick** from the HDMI port on your television.
3. Wait for 10 Seconds, then plug the **HDMI Game Stick** into the HDMI port on your television.

4. Plug the USB A Connector end of the **Micro USB Power Cable** into the USB port on your television. The unit will now be ready to play again.

Wireless Controller

1. Turn off the **Wireless Controller** using the **Power Switch** on the back of the controller.
2. Interrupt the power supply by removing the batteries.
3. Let the unit stand for 10 seconds, then replace the batteries.
4. The unit will now be ready to play with again.
5. If the unit still does not work, replace with an entire set of new batteries.

OTHER NOTES

Static electricity may cause the **HDMI Game Stick** to malfunction. In cases where the **HDMI Game Stick** is malfunctioning due to static electricity, disconnect the **Micro USB Power Cable**, wait for 10 seconds, then reconnect the **Micro USB Power Cable** to reboot the **HDMI Game Stick**.

DECLARATION OF CONFORMITY

Hereby, Leapfrog, a division of VTech Electronics Europe Plc, declares that the radio equipment type 6088 is in compliance with The Radio Equipment Regulations 2017 (2017 No.1206). The full text of the Declaration of conformity is available at the following internet address:

www.leapfrog.com/en-gb/legal/eudoc

Frequency Band: 2408 MHz – 2472 MHz

Maximum RF power: <0.01 W

Hereby, Leapfrog, a division of VTech Electronics Europe BV, declares that the radio equipment type 6088 is in compliance with Directive 2014/53/EU. The full text of the EU declaration of conformity is available at the following internet address : www.leapfrog.com/en-gb/legal/eudoc

Frequency Band: 2408 MHz – 2472 MHz

Maximum RF power: <0.01 W



The terms HDMI, HDMI High-Definition Multimedia Interface, HDMI trade dress and the HDMI Logos are trademarks or registered trademarks of HDMI Licensing Administrator, Inc.

 HDMI game stick connects TV USB A or 3rd party AC adapter with DC 5V 1A output through Micro USB Power cable

CONSUMER SERVICES

Creating and developing **LeapFrog®** products is accompanied by a responsibility that we at **LeapFrog®** take very seriously. We make every effort to ensure the accuracy of the information, which forms the value of our products. However, errors sometimes can occur. It is important for you to know that we stand behind our products and encourage you to call our Consumer Services Department with any problems and/or suggestions that you might have. A service representative will be happy to help you.

UK Customers:

Phone: 01702 200244 (from UK) or +44 1702 200244 (outside UK)

Website: www.leapfrog.co.uk/support

Australian Customers:

Phone: 1800 862 155

Website: support.leapfrog.com.au

NZ Customers:

Phone: 0800 400 785

Website: support.leapfrog.com.au

PRODUCT WARRANTY/ CONSUMER GUARANTEES

UK Customers:

Read our complete warranty policy online at leapfrog.com/warranty.

Australian Customers:

VTECH ELECTRONICS (AUSTRALIA) PTY LIMITED –
CONSUMER GUARANTEES

Under the Australian Consumer Law, a number of consumer guarantees apply to goods and services supplied by VTech Electronics (Australia) Pty Limited. Please refer to leapfrog.com/en-au/legal/warranty for further information.



***Visit our website for more
information about our products,
downloads, resources and more.***

leapfrog.com

***Read our complete warranty and privacy
policies online at:***

leapfrog.co.uk/warranty

www.leapfrog.com/en-gb/legal/privacy

LeapFrog Enterprises, Inc.,
a subsidiary of VTech Holdings Limited.
TM & © 2023 LeapFrog Enterprises, Inc.
All rights reserved.

Printed in China.

IM-608800-001

Version:0