

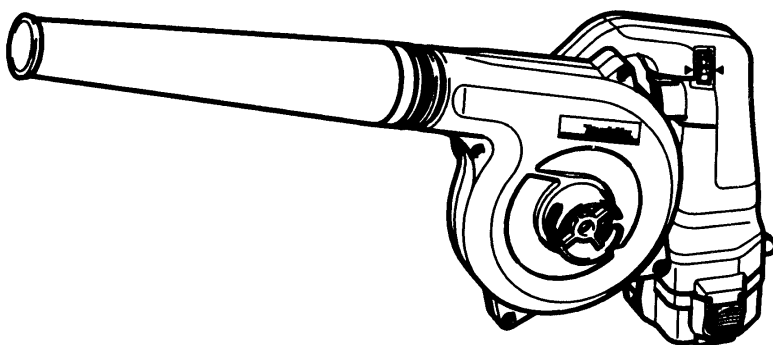

Cordless Blower

12 V UB120D

14.4 V UB140D



SPECIFICATIONS

Model	UB120D	UB140D
Capacities		
Air pressure (water column)	0 – 610 mm	0 – 610 mm
Air volume	0 – 2.2 m ³ /min.	0 – 2.2 m ³ /min.
No load speed (min ⁻¹)	0 – 18,000	0 – 18,000
Overall length	516 mm	516 mm
Net weight (with battery cartridge)	1.8 kg	1.9 kg
Rated voltage	D.C.12 V	D.C.14.4 V

- Due to our continuing programme of research and development, the specifications herein are subject to change without notice.
- Note: Specifications may differ from country to country.

For European countries only

Noise and Vibration of Models UB120D / UB140D

The typical A-weighted noise levels are
sound pressure level: 81 dB (A)
sound power level: 94 dB (A)
– Wear ear protection. –

The typical weighted root mean square acceleration
value is not more than 2.5 m/s².

EC-DECLARATION OF CONFORMITY

The undersigned, Yasuhiko Kanzaki, authorized by
Makita Corporation, 3-11-8 Sumiyoshi-Cho, Anjo,
Aichi 446-8502 Japan declares that this product

(Serial No. : series production)

manufactured by Makita Corporation in Japan is in
compliance with the following standards or standard-
ized documents,

EN50260, EN55014

in accordance with Council Directives, 89/336/EEC
and 98/37/EC.

Yasuhiko Kanzaki **CE 99**



Director

MAKITA INTERNATIONAL EUROPE LTD.

Michigan Drive, Tongwell, Milton Keynes,
Bucks MK15 8JD, ENGLAND

EC-DECLARATION OF CONFORMITY

The undersigned, Yasuhiko Kanzaki, authorized by
Kao Lung Tamura Electronics Co., Ltd. No. 4 Industry
1st Street, Ping Tung Industry District Chiao Nan Li,
Ping Tung City, Taiwan declares that this battery-
charger

(Serial No. : series production)

manufactured by Kao Lung Tamura Electronics Co.,
Ltd. in Taiwan is in compliance with the following
standards or standardized documents,

EN60335, EN55014, EN61000

in accordance with Council Directives, 73/23/EEC
and 89/336/EEC.

Yasuhiko Kanzaki **CE 94**



Director

MAKITA INTERNATIONAL EUROPE LTD.

Michigan Drive, Tongwell, Milton Keynes,
Bucks MK15 8JD, ENGLAND

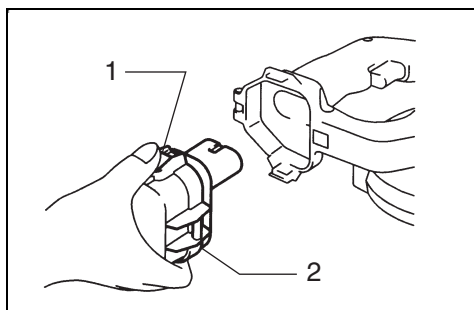

1

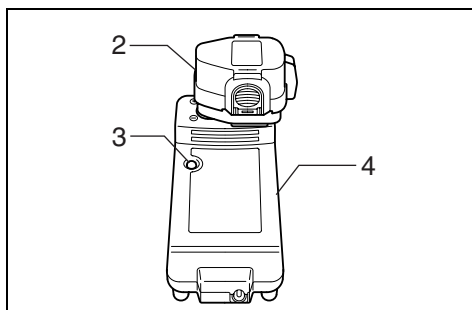

2

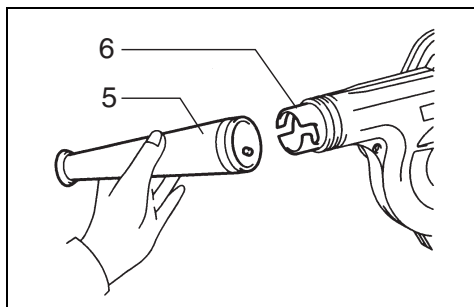

3

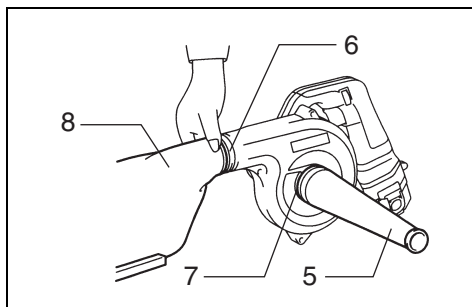

4

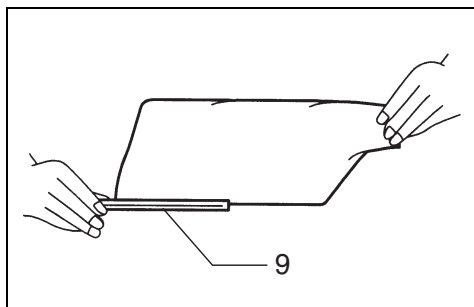

5

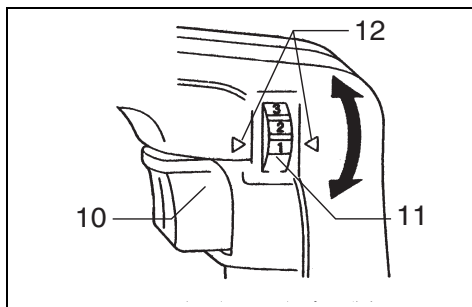

6

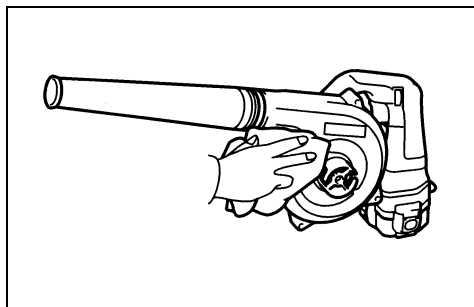

7

Symbols

The followings show the symbols used for the tool. Be sure that you understand their meaning before use.



Indoor use only



Delay charge (too hot battery)



Read instruction manual.



Defective battery



DOUBLE INSULATION



Do not short batteries.



Ready to charge



Always recycle batteries.



Charging



Do not discard batteries into garbage can or the like.



Charging complete

Note:

The recycling method may differ from country to country, or state (province) to state (province). Consult with your nearest Makita Authorized Service Center or Distributor.

Explanation of general view

1	Push button	5	Nozzle	9	Fastener
2	Battery cartridge	6	Blower outlet	10	Switch trigger
3	Charging light	7	Suction inlet	11	Air volume adjusting dial
4	Battery charger	8	Dust bag	12	Pointers

SAFETY INSTRUCTIONS

ENAA002-1

WARNING! When using battery operated tools basic safety precautions, including the following, should be followed to reduce the risk of fire, leaking batteries and personal injury: Read these instructions before operating this product and save these instructions.

For safe operation:

- 1. Keep work area clean**
 - Cluttered areas and benches invite injuries.
- 2. Consider the work environment**
 - Do not expose the tool to rain. Keep work area well lit. Do not use tools in the presence of flammable liquids or gases.
- 3. Keep children away**
 - Do not let visitors touch the tool. Keep visitors away from work area.
- 4. Store batteries or idle tools**
 - When not in use, tools and batteries should be stored separately in a dry, high or locked up place, out of reach of children.
 - Ensure that battery terminals cannot be shorted by other metal parts such as screws, nails, etc.
- 5. Do not force the tool**
 - It will do the job better and safer at the rate for which it was intended.
- 6. Use the right tool**
 - Do not force small tools or attachments to do the job of a heavy duty tools. Do not use tools for purposes not intended.
- 7. Dress properly**
 - Do not wear loose clothing or jewellery, they can be caught in moving parts. Non-skid footwear is recommended when working outdoors. Wear protecting hair covering to contain long hair.
- 8. Use protective equipment**
 - Use safety glasses and if the cutting operation is dusty, a face or dust mask.
- 9. Connect dust extraction equipment**
 - If devices are provided for the connection of dust extraction and collection ensure these are connected and properly used.
- 10. Do not abuse the supply cord (if fitted)**
 - Never carry the tool by the cord or yank it to disconnect from the socket. Keep the cord away from heat, oil and sharp edges.
- 11. Secure the work**
 - Use clamps or a vice to hold the work. It is safer than using your hand and it frees both hands to operate the tool.
- 12. Do not over-reach**
 - Keep proper footing and balance at all times.

13. Maintain tools with care

- Keep cutting tools sharp and clean for better and safer performance. Follow instructions for lubrication and changing accessories. Inspect tool cords periodically and if damaged have repaired by an authorized service facility.

14. Disconnect tools

- Where the design permits, disconnect the tool from its battery pack when not in use, before servicing and when changing accessories such as blades, bits and cutters.

15. Remove adjusting keys and wrenches

- Form the habit of checking to see that keys and adjusting wrenches are removed from the tool before turning it on.

16. Avoid unintentional starting

- Do not carry the tool with a finger on the switch.

17. Stay alert

- Watch what you are doing. Use common sense. Do not operate the tool when you are tired.

18. Check damaged parts

- Before further use of the tool, a guard or other part that is damaged should be carefully checked to determine that it will operate properly and perform its intended function. Check for alignment of moving parts, free running of moving parts, breakage of parts, mounting and any other condition that may affect its operation. A guard or other part that is damaged should be properly repaired or replaced by an authorized service facility unless otherwise indicated in this instruction manual. Have defective switches replaced by an authorized service facility. Do not use the tool if the switch does not turn it on and off.

19. Warning

- The use of any accessory or attachment, other than recommended in this instruction manual or the catalogue, may present a risk of personal injury.
- Ensure that the battery pack is correct for the tool.
- Ensure that the outside surface of battery pack or tool is clean and dry before plugging into charger.
- Ensure that batteries are charged using the correct charger recommended by the manufacturer. Incorrect use may result in a risk of electric shock, overheating or leakage of corrosive liquid from the battery.

20. Have your tool repaired by a qualified person

- This tool is constructed in accordance with the relevant safety requirements. Repairs should only be carried out by qualified persons using original spare parts, otherwise this may result in considerable danger to the user.

21. Disposal of battery

- Ensure battery is disposed of safely as instructed by the manufacturer.

IMPORTANT SAFETY INSTRUCTIONS FOR CHARGER & BATTERY CARTRIDGE

ENC001-3

1. **SAVE THESE INSTRUCTIONS** — This manual contains important safety and operating instructions for battery charger.
2. Before using battery charger, read all instructions and cautionary markings on (1) battery charger, (2) battery, and (3) product using battery.
3. **CAUTION** — To reduce risk of injury, charge only MAKITA type rechargeable batteries. Other types of batteries may burst causing personal injury and damage.
4. Do not expose charger to rain or snow.
5. Use of an attachment not recommended or sold by the battery charger manufacturer may result in a risk of fire, electric shock, or injury to persons.
6. To reduce risk of damage to electric plug and cord, pull by plug rather than cord when disconnecting charger.
7. Make sure cord is located so that it will not be stepped on, tripped over, or otherwise subjected to damage or stress.
8. Do not operate charger with damaged cord or plug — replace them immediately.
9. Do not operate charger if it has received a sharp blow, been dropped, or otherwise damaged in any way; take it to a qualified serviceman.
10. Do not disassemble charger or battery cartridge; take it to a qualified serviceman when service or repair is required. Incorrect reassembly may result in a risk of electric shock or fire.
11. To reduce risk of electric shock, unplug charger from outlet before attempting any maintenance or cleaning. Turning off controls will not reduce this risk.
12. The battery charger is not intended for use by young children or infirm persons without supervision.
13. Young children should be supervised to ensure that they do not play with the battery charger.
14. If operating time has become excessively shorter, stop operating immediately. It may result in a risk of overheating, possible burns and even an explosion.
15. If electrolyte gets into your eyes, rinse them out with clear water and seek medical attention right away. It may result in loss of your eyesight.

ADDITIONAL SAFETY RULES FOR CHARGER & BATTERY CARTRIDGE

1. Do not charge Battery Cartridge when temperature is **BELOW 10°C (50°F)** or **ABOVE 40°C (104°F)**.
2. Do not attempt to use a step-up transformer, an engine generator or DC power receptacle.
3. Do not allow anything to cover or clog the charger vents.
4. Always cover the battery terminals with the battery cover when the battery cartridge is not used.

5. Do not short the battery cartridge:
 - (1) Do not touch the terminals with any conductive material.
 - (2) Avoid storing battery cartridge in a container with other metal objects such as nails, coins, etc.
 - (3) Do not expose battery cartridge to water or rain.

A battery short can cause a large current flow, overheating, possible burns and even a breakdown.
6. Do not store the tool and battery cartridge in locations where the temperature may reach or exceed 50°C (122°F).
7. Do not incinerate the battery cartridge even if it is severely damaged or is completely worn out. The battery cartridge can explode in a fire.
8. Be careful not to drop, shake or strike battery.
9. Do not charge inside a box or container of any kind. The battery must be placed in a well ventilated area during charging.

ADDITIONAL SAFETY RULES FOR TOOL

ENB030-1

1. Be aware that this tool is always in an operating condition, because it does not have to be plugged into an electrical outlet.
2. Always use protective goggles, a cap and mask when using the blower.
3. Never point the nozzle at anyone in the vicinity when using the blower.
4. Always use the dust bag when collecting dust, chips and the like.
5. Do not collect still smoldering cigarette ashes, freshly cut metals shavings, screws, nails and the like.
6. Never block suction inlet and/or blower outlet. Increased motor revolution may cause dangerous fan breakage.

SAVE THESE INSTRUCTIONS.

OPERATING INSTRUCTIONS

Installing or removing battery cartridge (Fig. 1)

- Always switch off the tool before insertion or removal of the battery cartridge.
- To remove the battery cartridge, withdraw it from the tool while pressing the push buttons on both sides of the cartridge.
- To insert the battery cartridge, align the tongue on the battery cartridge with the groove in the housing and slip it into place. Always insert it all the way until it locks in place with a little click. If not, it may accidentally fall out of the tool, causing injury to you or someone around you.
- Do not use force when inserting the battery cartridge. If the cartridge does not slide in easily, it is not being inserted correctly.

Charging (Fig. 2)

Plug the battery charger into the proper A/C voltage source. The charging light will flash in green color. Insert the battery cartridge so that the plus and minus terminals on the battery cartridge are on the same sides as their respective markings on the battery charger. Insert the cartridge fully into the port so that it rests on the charger port floor. When the battery cartridge is inserted, the charging light color will change from green to red and charging will begin. The charging light will remain lit steadily during charging. When the charging light color changes from red to green, the charging cycle is complete. If you leave the battery cartridge in the charger after the charging cycle is complete, the charger will switch into its "trickle charge (maintenance charge)" mode. After charging, unplug the charger from the power source. Refer to the table below for the charging time.

Battery type	Capacity (Ah)	Number of cells	Charging time
1222 (Ni-cd)	2.0	10	Approx. 45 min.
1233 (Ni-MH)	2.2	10	Approx. 50 min.
1234 (Ni-MH)	2.6	10	Approx. 60 min.
1235 (Ni-MH)	3.0	10	Approx. 70 min.
1422 (Ni-cd)	2.0	12	Approx. 45 min.
1433 (Ni-MH)	2.2	12	Approx. 50 min.
1434 (Ni-MH)	2.6	12	Approx. 60 min.
1435 (Ni-MH)	3.0	12	Approx. 70 min.

CAUTION:

- The battery charger is for charging Makita battery cartridge. Never use it for other purposes or for other manufacturer's batteries.
- When you charge a new battery cartridge or a battery cartridge which has not been used for a long period of time, it may not accept a full charge. This is a normal condition and does not indicate a problem. You can recharge the battery cartridge fully after discharging it completely and recharging a couple of times.
- If you charge a battery cartridge from a just-operated tool or a battery cartridge which has been left in a location exposed to direct sunlight or heat for a long time, the charging light may flash in red color. If this occurs, wait for a while. Charging will begin after the battery cartridge cools. The battery cartridge will cool faster if you remove the battery cartridge from the battery charger.
- If the charging light flashes alternately in green and red color, a problem exists and charging is not possible. The terminals on the charger or battery cartridge are clogged with dust or the battery cartridge is worn out or damaged.

Trickle charge (Maintenance charge)

If you leave the battery cartridge in the charger to prevent spontaneous discharging after full charge, the charger will switch into its "trickle charge (maintenance charge)" mode and keep the battery cartridge fresh and fully charged.

Tips for maintaining maximum battery life

1. Charge the battery cartridge before completely discharged.
Always stop tool operation and charge the battery cartridge when you notice less tool power.
2. Never recharge a fully charged battery cartridge.
Overcharging shortens the battery service life.
3. Charge the battery cartridge with room temperature at 10°C – 40°C (50°F – 104°F).
Let a hot battery cartridge cool down before charging it.
4. Charge the Nickel Metal Hydride battery cartridge when you do not use it for more than six months.

Blowing (Fig. 3)

For dust blowing, attach the nozzle to blower outlet, turning clockwise to lock it in place.

Dust suction (Fig. 4 & 5)

For dust suction, fit nozzle onto suction inlet and dust bag onto blower outlet.

After the bag fills with dust, empty the contents of the dust bag into a dust bin by releasing the fastener.

CAUTION:

Empty the dust bag before it becomes too full, or the suction force weakens.

Switch action (Fig. 6)

CAUTION:

Before inserting the battery cartridge into the tool, always check to see that the switch trigger actuates properly and returns to the "OFF" position when released.

To start the tool, simply pull the trigger. Tool speed is increased by increasing pressure on the trigger. Release the trigger to stop.

Air volume adjusting dial (Fig. 6)

Air volume can be adjusted to any of three settings by turning the adjusting dial with the switch trigger fully depressed. Refer to the table below for the relationship between the number on the dial and the air volume.

Number on the dial	Air volume
3	High
2	Medium
1	Low

CAUTION:

- Use the adjusting dial only after the switch trigger returns to the “OFF” position. Turning the dial before the trigger returns may damage the tool.
- If the tool is operated continuously until the battery cartridge has discharged, rest the tool for at least 15 minutes before proceeding with a fresh battery.

MAINTENANCE

CAUTION:

Always be sure that the tool is switched off and the battery cartridge is removed before carrying out any work on the tool.

Cleaning (Fig. 7)

From time to time, wipe off the outside of the tool using a cloth dampened in soapy water. Never use gasoline, thinner or the like, or discoloration and/or cracks can take place.

To maintain product safety and reliability, repairs, maintenance or adjustment should be carried out by a Makita Authorized Service Center.

ACCESSORIES

CAUTION:

- These accessories or attachments are recommended for use with your Makita tool specified in this manual. The use of any other accessories or attachments might present a risk of injury to persons. Only use accessory or attachment for its stated purpose.

If you need any assistance for more details regarding these accessories, ask your local Makita service center.

- Nozzle
- Dust bag
- Corner nozzle
- Straight pipe
- Flexible hose
- Joint
- Various type of Makita genuine batteries and chargers

Makita Corporation

884283A224