

Important!

Breville

BMF600XL A11

1

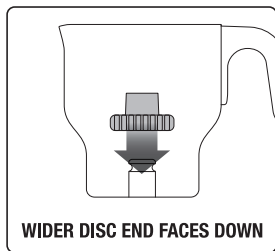

- Select disc
- Insert disc so the wider end faces downwards
- Push until it 'clicks'
- Turn disc with fingers, it should spin freely. If not, call 1-866-273-8455

2

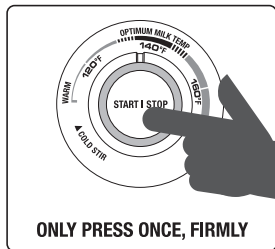

- Fill jug to at least the 'MIN' level
- Select temperature
- Only press START | STOP dial once, firmly
- Wait for the dial to flash slowly
- Milk will swirl after a few seconds

3

Adding dense ingredients like thick syrups, heavy powders and large flakes can significantly reduce the amount of foam. This is normal.

Also, different milks (2%, soy, rice etc.), milk brands and quantity of milk in the jug will produce varying amounts of froth. For maximum foam, use whole milk, the "CAPP" disc and fill to the "CAPP / LATTE MAX" jug marking.

Important!

Breville

BMF600XL A11

1

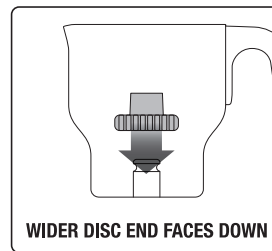

- Select disc
- Insert disc so the wider end faces downwards
- Push until it 'clicks'
- Turn disc with fingers, it should spin freely. If not, call 1-866-273-8455

2

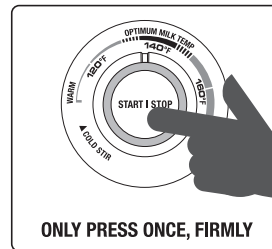

- Fill jug to at least the 'MIN' level
- Select temperature
- Only press START | STOP dial once, firmly
- Wait for the dial to flash slowly
- Milk will swirl after a few seconds

3

Adding dense ingredients like thick syrups, heavy powders and large flakes can significantly reduce the amount of foam. This is normal.

Also, different milks (2%, soy, rice etc.), milk brands and quantity of milk in the jug will produce varying amounts of froth. For maximum foam, use whole milk, the "CAPP" disc and fill to the "CAPP / LATTE MAX" jug marking.

Important!

Breville

BMF600XL A11

1

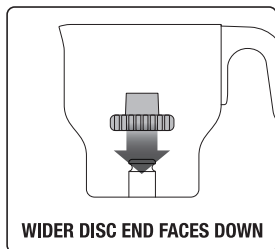

- Select disc
- Insert disc so the wider end faces downwards
- Push until it 'clicks'
- Turn disc with fingers, it should spin freely. If not, call 1-866-273-8455

2

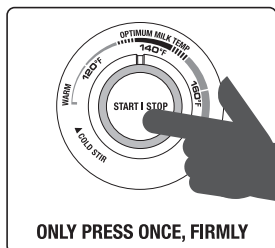

- Fill jug to at least the 'MIN' level
- Select temperature
- Only press START | STOP dial once, firmly
- Wait for the dial to flash slowly
- Milk will swirl after a few seconds

3

Adding dense ingredients like thick syrups, heavy powders and large flakes can significantly reduce the amount of foam. This is normal.

Also, different milks (2%, soy, rice etc.), milk brands and quantity of milk in the jug will produce varying amounts of froth. For maximum foam, use whole milk, the "CAPP" disc and fill to the "CAPP / LATTE MAX" jug marking.

Important!

Breville

BMF600XL A11

1

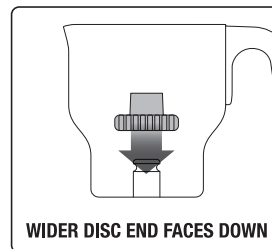

- Select disc
- Insert disc so the wider end faces downwards
- Push until it 'clicks'
- Turn disc with fingers, it should spin freely. If not, call 1-866-273-8455

2

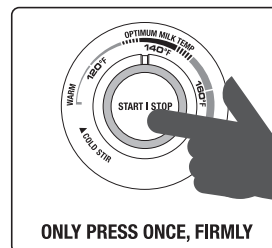

- Fill jug to at least the 'MIN' level
- Select temperature
- Only press START | STOP dial once, firmly
- Wait for the dial to flash slowly
- Milk will swirl after a few seconds

3

Adding dense ingredients like thick syrups, heavy powders and large flakes can significantly reduce the amount of foam. This is normal.

Also, different milks (2%, soy, rice etc.), milk brands and quantity of milk in the jug will produce varying amounts of froth. For maximum foam, use whole milk, the "CAPP" disc and fill to the "CAPP / LATTE MAX" jug marking.