

130MM

58MM

## Magnetic Fast Charging Active Stylus User Manual

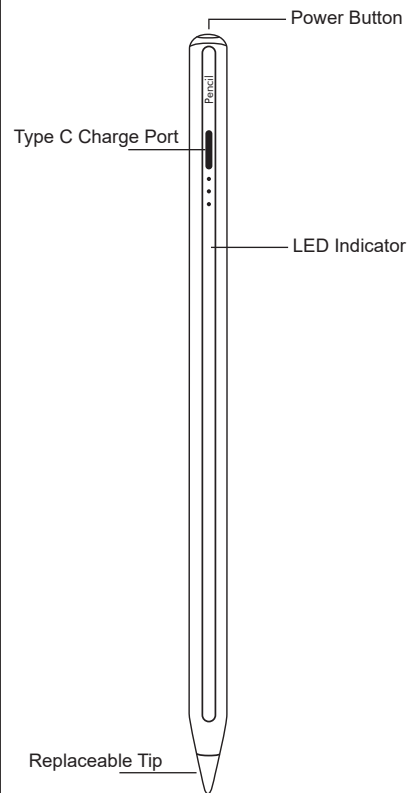

### Compatibility

- \* The iPad system needs to be upgraded to iPadOS 12.2 and above.
- \* This stylus pen is only compatible with the iPads below

Model Name	Model Number
iPad Pro 12.9(6th)	A2436/A2764/A2437/A2766
iPad Pro 12.9(5th)	A2378/A2461/A2379/A2462
iPad Pro 12.9(4th)	A2229/A2069/A2232/A2233
iPad Pro 12.9(3rd)	A1876/A2014/A1895/A1983
iPad Pro 11(4th)	A2759/A2435/A2761/A2762
iPad Pro 11(3rd)	A2377/A2459/A2301/A2460
iPad Pro 11(2nd)	A2228/A2068/A2230/A2231
iPad Pro 11	A1980/A2013/A1934/A1979
iPad Air 5	A2589/A2591
iPad Air 4	A2324/A2072/A2325/A2316
iPad Air 3	A2152/A2123/A2153/A2154
iPad 10	A2696/A2757/A2777
iPad 9	A2602/A2603/A2604/A2605
iPad 8	A2270/A2428/A2429/A2430
iPad 7	A2197/A2198/A2200
iPad 6	A1893/A1954
iPad mini 6	A2567/A2568/A2569
iPad mini 5	A2133/A2124/A2126/A2125

Please confirm the model number on the back of the iPad

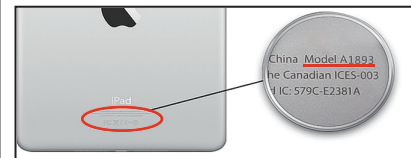

### Note:

Not compatible with models released before 2018: iPad Pro 12.9" 1st&2nd, iPad Pro 10.5", iPad Pro 9.7", iPad 1 to 5 Gen, iPad Mini 1 to 4 Gen, iPad Air 1st&2nd.  
Not Compatible with iPhone, Android, Microsoft devices.

### How to Connect

1. This stylus pen doesn't have Bluetooth.
2. If your iPad has never been connected to the Apple Pencil, you can turn on and use this stylus pen by single pressing the button on the top.
3. If your iPad has been connected to the Apple Pencil before, please follow step 1 or step 2 to disconnect it before using the stylus pen.

- ① Settings > Bluetooth > Apple Pencil > tap "i" > Forget this device.

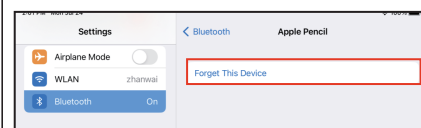
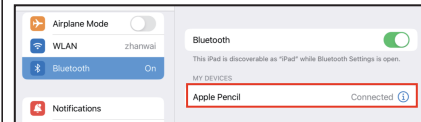

- ② Settings > Bluetooth > turn off Bluetooth.

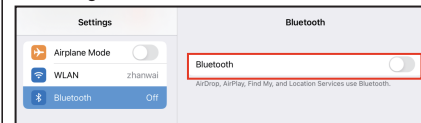

### About the Active Stylus

**Size:** 6.5\*0.35 inch/166\*9mm

**Weight:** 0.51oz/14.6g

**Battery:** 65400 Li-polymer battery, 125mAH

**Charging Time:** 10 minutes

**Continuous Use Time:** about 12 hours

### Quick Guide

#### ① Power On & Off

- a. If the iPad has been connected to the Apple Pencil before: Settings> Bluetooth > Find "Apple Pencil" and Tap "i" in a blue circle> Tap Forget This Device.

- b. Single press the Power Button. Once the indicator light turns on, the stylus is on.
- c. When the stylus is on, press the Power Button, the light goes off, the stylus is off.

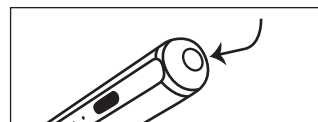

#### ② 10 Mins Auto Sleep

- a. If the stylus is not used in the power-on state, it will automatically enter sleep mode for 10 minutes and the indicator will blink slowly in the last minute.
- b. The stylus will automatically wake up and enter work mode if it is used within 10 minutes.
- c. The stylus will automatically **turn off** if it is not used within 10 minutes.

#### ③ Fast Charging

- a. Connect the Charging Cable to the Charge Port.
- b. The indicator light will flash in turn when charging. When all three indicators are on, it is fully charged.
- c. Usually it only takes 10 minutes to charge, and it can be used continuously for 12 hours after being fully charged.

#### ④ Replace the Stylus Tip

Unscrew the old tip counterclockwise to replace.

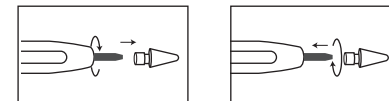

The tips is an alternative to original pencil tip

### Indicator Light

- ① **Three lights on:**  
60%-100% power  
(Available for 12 Hours)

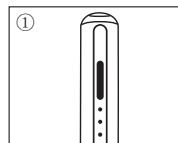

- ② **Two lights on:**  
20%-59% power  
(Available for 6 Hours)

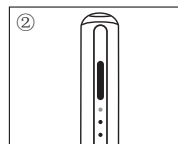

- ③ **One light on:**  
less than 20% power  
(Available for 1 Hours)

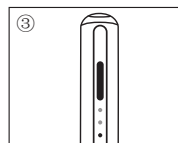

### Magnetic Function

The stylus can be magnetically attached to the side of iPad Pro and iPad Air for easy carry.

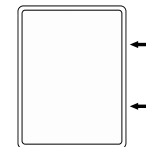

\* This function is only available for iPads with magnetic suction on the side.

### Packing List:

- ① Stylus Pen\*1
- ② Replaceable Tip\*3
- ③ Type C Cable\*1
- ④ Dust Plug
- ⑤ User Manual\*1

