

NEBULA

NEBULA

For FAQs and more information, please visit:

www.SeeNebula.com

✉ support@SeeNebula.com

☎ +1(800) 988 7973 (US) Mon-Fri 9:00-17:00 (PT)



Mars Lite Owner's Manual

© Anker Technology Co., Limited. All rights reserved.
NEBULA and the NEBULA logo are trademarks of
Anker Technology Co., Limited, registered in the
United States and other countries.
Mode: D2321

51005000706 V01

Table of Content

01	Safety Instructions
04	What's Included
04	Overview
09	Get Started
11	Settings
12	Enjoy
15	Specifications
16	Troubleshooting
17	Notice
18	Trademarks
18	Warranty

Safety Instructions

Read and understand all instructions before you use this device. Do not make any changes or settings that are not described in this manual. If physical injury, loss of data or damage is caused by failure to follow instructions, the warranty does not apply.

Setup

- To reduce the risk of fire and/or electric shock, do not expose the device to rain or moisture, and objects filled with liquids, such as vases, should not be placed on the device.
- Do not place this device on soft surfaces such as tablecloths or carpets. Otherwise the device could catch fire.
- Do not place this device in areas susceptible to excessive dust and dirt or near any appliance generating a strong magnetic field.
- To prevent overheating, do not block or clog the ventilation openings.
- Never place this device in a confined space. Always leave enough space around the device for ventilation.
- Protect the device against direct sunlight, heat, large temperature fluctuations and moisture.
- When the device is running for a long period of time, the surface becomes hot. Shut it down immediately and unplug the power cord. Only after the device has cooled down, you can continue to operate.
- Always handle the device with care. Avoid touching the lens.
- Never place heavy or sharp objects on the device or the power cord.
- To avoid electric shock, do not disassemble.
- Use attachments or accessories specified by the manufacturer only.
- Avoid extreme vibrations. It may damage the internal components.
- Do not allow children to handle the device without supervision.
- Under the following conditions, a layer of moisture can appear inside the device which can lead to malfunctions: a) if the device is moved from a cold to a warm area; b) after a cold room is heated; c) when the device is placed in a damp room. To avoid any moisture, seal the device in a plastic bag before moving it to another room, and wait for one to two hours before you take it out of the bag.

Power Supply

- Use only the provided power adapter.
- Power off the device before removing the power supply from the socket.
- Protect the power cord from being walked on or pinched, particularly at plugs, convenience receptacles, and the point where they exit from this device.
- Unplug this device during lightning storms or when unused for a long period of time.
- Where the MAINS plug or an appliance coupler is used as the disconnect device, the disconnect device shall remain readily operable.
- Before you make or change any connections, ensure that all devices are disconnected from the power outlet.
- Never touch the mains cable of the mains connection with wet hands.

Hearing Safety

- To avoid hearing damage, do not listen for extended periods at high volume. Set the volume at a safe level.

Battery

- Do not replace the built-in battery yourself. Contact an authorized service center to replace it.
- The remote control contains coin type batteries, which can be swallowed. Keep the batteries out of reach of children.
- Risk of explosion! Keep batteries away from heat, sunshine or fire. Never discard batteries in fire.
- When the remote control is not used for a long period of time, remove the batteries.
- Danger of explosion if battery is incorrectly replaced. Replace only with the same or equivalent type.
- Batteries contain chemical substances, they should be disposed of properly.
- Charge the device regularly. Do not store the device with a completely discharged battery.

Cleaning

- Power off the device and remove it from the power supply before cleaning the surface.
- Use a soft, lint-free cloth. Never use liquid, gaseous or easily flammable cleansers (sprays, abrasives, polishes, alcohol).
- Do not use any liquid cleaning agents for cleaning the lens, to avoid damaging the coating film on the lens.
- Wipe over the surfaces gently. Be careful that you do not scratch the surfaces.
- Use lens cleaning paper to clean the lens of the projector.

Repairs

- Do not make any repairs to the device yourself. Only have your device repaired by an authorized service center.
- Improper maintenance can result in injuries or damage to the device.

Class II equipment symbol



This symbol indicates that the unit has a double insulation system.

Laser Safety



IEC 60825-1:2014. Complies with IEC 62471:2006 Risk Group 2.

Caution:

- Possibly hazardous optical radiation emitted from this device.
- Do not stare at operating beam. The bright light may hurt your eyes.

What's Included

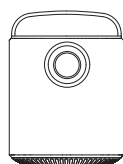

Main unit



Remote control with batteries

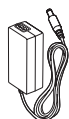

Power Adapter



Power cord



Manual

Overview

1. Front View

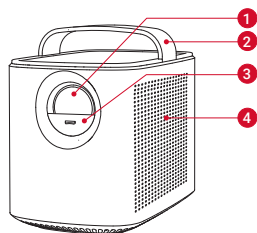

- 1 Lens
- 2 Handle
- 3 Lens cover
 - Slide down to power on and automatically adjust focus
 - Slide up to power off
- 4 Loudspeaker

04

2. Rear View

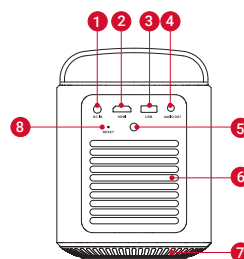





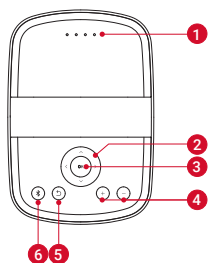

- 1 DC IN
 - Connect to power supply
- 2 HDMI
 - Connect to a playback device with HDMI output
- 3 USB
 - Connect to a USB storage device
 - Charge a USB device as a power bank
- 4 AUDIO OUT
 - Connect to headphone or external speaker
- 5 Infrared Receiver
- 6 Air ventilation (outlet)
- 7 Air ventilation (inlet)
- 8 RESET

05

3. Top View

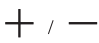

- 1** LED indicators
 - Power level
- 2**     Navigation buttons
 - Navigate menus or adjust the selected contents
- 3** **OK**
 - Press to confirm a selection or entry
 - Press and hold to adjust focus
 - Pause / resume during play
- 4** 
 - Volume up / down
- 5** 
 - Return to a previous menu
- 6** 
 - Long press to enter Bluetooth mode
 - Press again to access the home menu

06

4. Bottom View

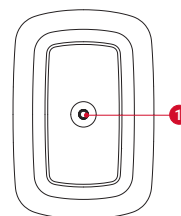

- 1** Tripod socket

5. Remote Control

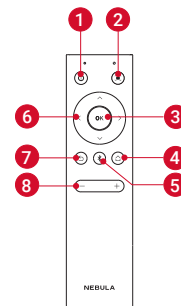

07

1 ①

- Power on / off or switch to standby

2 []

- Adjust focus

3 OK

- Press to confirm a selection or entry
- Press and hold to adjust focus
- Pause / resume during play

4 []

- Press to access the home menu

5 []

- Long press to enter Bluetooth mode
- Press again to access the home menu

6 [] [] [] [] Navigation buttons

- Navigate menus or adjust the selected contents

7 []

- Return to a previous menu

8 [] []

- Volume down / up

Get Started

1. Placement

Place this device on a stable, flat table in front of the projection surface. For best results, the projection surface shall be white and flat. The distance between the device and the projection surface must be a minimum of 1 meters (39.4 inches) and a maximum of 3 meters (118 inches).

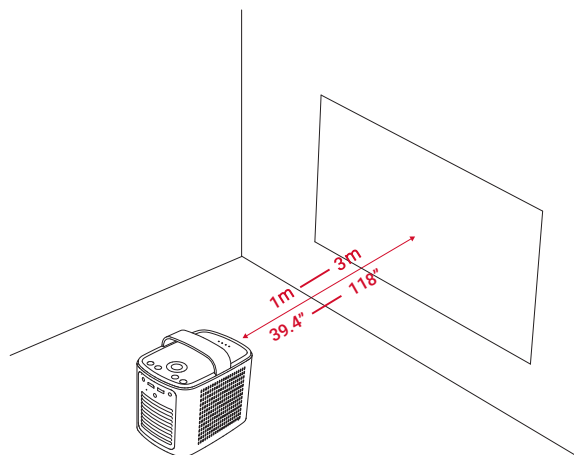

- It is unnecessary to tilt it towards the projection surface. You can correct the projection image with the built-in keystone correction.
- The distance between the device and the projection surface determines the projection image size.

2. Prepare the Remote Control

- ① For the first time use, remove the protective tab to activate the remote control batteries.
- ② To replace battery, slide to open the battery compartment, insert new batteries with correct polarity (+/-) as indicated, and close the battery compartment.

3. Power On

- ① Connect the device to the mains by using the provided power adapter and power cord, the built-in battery will be charged and the LED indicators will light on.

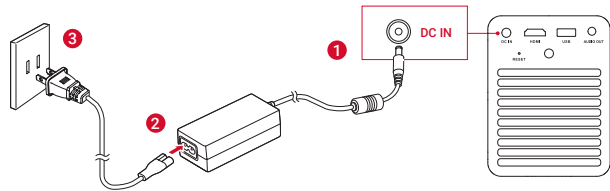

- ② Press ① on remote control or slide down the lens cover to power on.
- ③ Turn the device towards a suitable projection surface or wall.
- ④ To focus the image, press [■] (or press and hold OK) and then < , >.

Fully charge the built-in battery before using for the first time, which will prolong the battery lifespan.

Settings

Finish the main settings when you power on the device for the first time.

[Image Mode]	Adjust brightness in 3 modes: Brightest / Standard / Battery
[Auto Keystone Correction]	Enable / disable auto keystone correction.
[Keystone Correction]	Correct keystone manually. Default value is 0.
[Language]	English
[Project mode]	[Front Ceiling]: The device is hanging from the ceiling in an upside down position. The image is rotated by 180 degrees. [Rear Ceiling]: The device is hanging from the ceiling in an upside down position behind the projection surface. The image is rotated by 180 degrees and horizontal mirrored. [Front]: The device is located in front of the projection surface. [Rear]: The device is located behind the projection surface.
[Recovery]	[Recovery]: All data on the built-in storage will be erased. [Cancel]: Quit the action.

Enjoy

1. Connect to HDMI Playback Devices

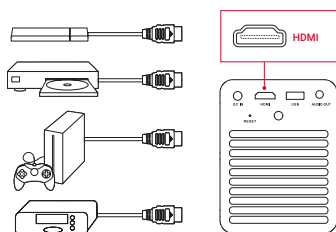

This device supports connections with various HDMI playback devices such as TV stick, TV box, DVD player, set-top box (STB), game machine or other devices.

- ① Connect this device to an HDMI playback device with an HDMI cable (not provided).
- ② Press  to access the home menu, select **[HDMI]** and press **OK**.



2. Connect to USB Storage Device

With this device, you can enjoy music, video, and pictures that are stored on a USB storage device.

- ① Plug the USB storage device to the USB socket of the device.
- ② Press  to access the home menu, select **[USB]** and press **OK**.
- ③ Select a file, then press **OK**.
- ④ To stop play, press .

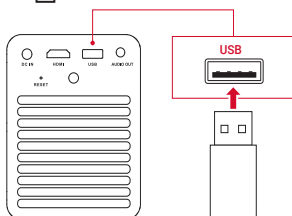

3. Connect Headphones

- ① Before connecting headphones, turn down the volume on this device.
- ② Connect headphones (not provided) into the **AUDIO OUT** connector of the device to enjoy music through the headphones.

4. Wireless Cast

You can wirelessly mirror the screen of your smartphone or tablet onto the projection surface.

- ① Press  to access the home menu, select **[Wireless Cast]** and press **OK**.
- ② Follow the on-screen instructions to complete the connection.

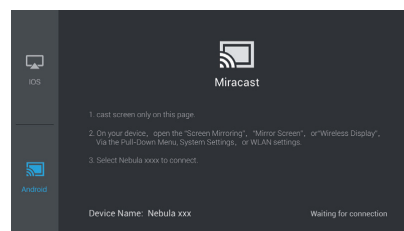
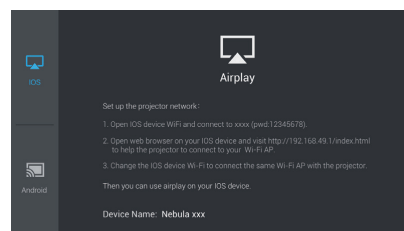

5. Charge Your Devices

This device can also be used as a power bank to charge your USB devices.

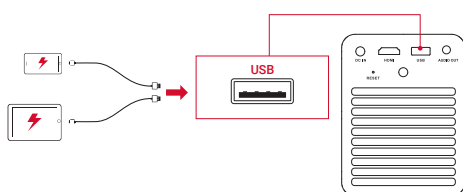



Specifications

Specifications are subject to change without notice.

Power supply: DC 19V
 Power consumption: < 57W
 Standby power consumption: < 0.5W
 Display technology: 0.45inch 1280*800p DLP
 Light source: RGB LED
 Projection image size: 12 - 150 inch
 Resolution: 1280 x 800 Pixel
 Brightness: 500 ANSI Lumens
 Contrast ratio: 1000:1
 Throw ratio: 1.2
 Throw distance: 1m to 3m
 Speaker drivers: 10W x 2
 Bluetooth version: V4.0
 Built-in battery type: Li-Polymer
 Capacity: 19500 mAh 3.8V
 Operating time: 3 hours
 Remote control batteries: CR2032 x 2
 Recommended ambient: 5°C to 35°C / 41°F to 95 °F
 Relative humidity: 15% ~ 85% (non-condensing)
 Storage temperature and humidity: < 65°C / 149°F, < 90% humidity
 Dimensions (W*H*D): 122 * 138 * 178 mm / 4.8 * 5.4 * 7 in
 Weight: 1,483 g / 52.3 oz

Troubleshooting

- ① Fail to power on by the remote control?
 - Make sure that the device is connected to the power supply.
 - Slide down the lens cover.
- ② Fail to power on by sliding down the lens cover?
 - Make sure that the device is connected to the power supply.
 - Slide up the lens cover and wait for 10 seconds, then try again.
- ③ The remote control doesn't work?
 - Remove the protective tab to activate the remote control batteries.
 - Replace new batteries.
- ④ Blurred image?
 - Press  on remote control (or press and hold **OK** on the device) and then **<**, **>** to focus the image.
- ⑤ Reversed projection image?
 - Press  to access the home menu, select **[Project mode]** and switch to a correct state.
- ⑥ Cannot paired with smartphone via Bluetooth?
 - This device cannot be used as a Bluetooth speaker. It can only pair with an external Bluetooth speaker or headphone.

Notice

FCC notice

This device complies with the FCC rules, Part 15. Operation is subject to the following two conditions: (1) This device may not cause harmful interference, and (2) This device must accept any interference received, including interference that may cause undesired operation.

Warning: Changes or modifications not expressly approved by the partly responsible for compliance could void the user's authority to operate the equipment.

Note: This equipment has been tested and found to comply with the limits for a Class B digital device, pursuant to part 15 of the FCC Rules. These limits are designed to provide reasonable protection against harmful interference in a residential installation.

This equipment generates, uses and can radiate radio frequency energy and, if not installed and used in accordance with the instruction manual, may cause harmful interference to radio communications. However, there is no guarantee that interference will not occur in a particular installation. If this equipment does cause harmful interference to radio or television reception, which can be determined by turning the equipment off and on, the user is encouraged to try to correct the interference by one or more of the following measures:

- Reorient or relocate the receiving antenna.
- Increase the separation between equipment and receiver.
- Connect the equipment into an outlet on a circuit different from that to which the receiver is connected.
- Consult the dealer or an experienced radio/TV technician for help.

FCC Radiation Exposure Statement:

This equipment complies with FCC radiation exposure limits set forth for an uncontrolled environment. This equipment should be installed and operated with a minimum distance of 20cm between the radiator and your body. This transmitter must not be co-located or operated in conjunction with any other antenna or transmitter.

Notice: Shielded cables

All connections to other computing devices must be made using shielded cables to maintain compliance with FCC regulations.

Trademarks



HDMI, and HDMI logo and High-Definition Multimedia Interface are trademarks or registered trademarks of HDMI licensing LLC in the United States and other countries.



The Bluetooth® word mark and logos are registered trademarks owned by Bluetooth SIG, Inc.

Other trademarks and trade names are those of their respective owners.

Warranty

30-Day Money-Back Guarantee for Any Reason

You may return your undamaged product and packaging within 30 days of purchase to receive a FULL REFUND for any reason. If the reason for return isn't quality-related, the customer must pay for the return shipping.

12-Month Warranty for Quality-Related Issues

Nebula's products are warrantied to be free from material and workmanship defects for 12 months from the date of purchase. Within this period, Nebula will provide a replacement and cover any return shipping costs for products that fail in normal use.

Please Note: Any provided shipping labels must be used within 20 days from the date they're issued by Nebula Support.

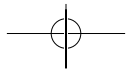

English

English

